

4 Operation

4.1 Before The First-time Use

- (A) Turn on the cold water supply and ensure the supply adapter valve is open.
- (B) Connect the system with power. You will hear a long beep, and all indicators will light up for 3s. The system will automatically flush for 30s.
- Wipe all the joints and connections with tissue to check for leakage. If the tissue stays dry, the system is installed correctly.
- (C) After the auto-flush is completed, turn on the faucet to allow water to run for 30 minutes to flush the air and carbon fines through the filters. After that, the system is ready, and you can start to consume the pure water.

**NOTICE**

Initially, the water may appear cloudy. This is a result of air trapped in the RO filter. It is not harmful and will disappear in a matter of minutes. It may take up to a week after installing a new RO filter for the trapped air to dissipate.

4.2 User Interface

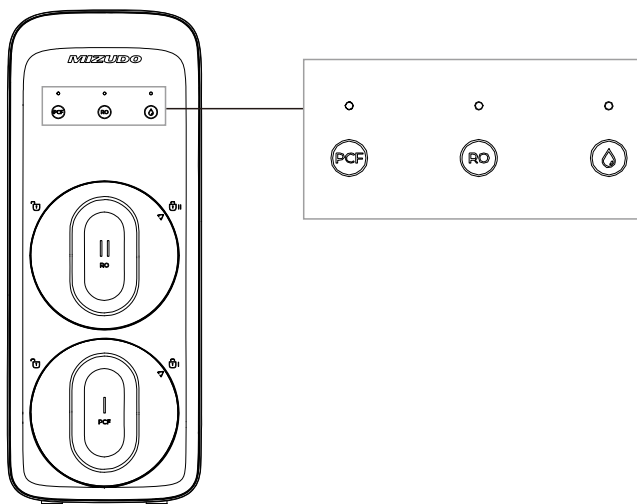

Indicator	Indication	Status
PCF lifetime indicator & Reset button	Constant blue light	Lifetime > 95%
	Flash red light	0 < Lifetime ≤ 5%
	Constant red light	Lifetime = 0
RO lifetime indicator & Reset button	Constant blue light	Lifetime > 5%
	Flash red light	0 < Lifetime ≤ 5%
	Constant red light	Lifetime = 0
Power indicator	Constant blue light	Power on
	Flash red light	System Malfunction

Reset button

To reset the filter lifetime, long press the reset button for 3s. You will hear a beep, and the indicator will flash a constant blue light. The filter lifetime has been reset.

RO Faucet Indicator

Constant blue light	Flash blue light	Constant red light
Filtering water (Pure water quality is good)	Flush mode	System malfunction (Pure water quality is bad)

