



ITEM #0437512

20-VOLT CORDLESS IMPACT DRIVER

KOBALT® and the K Design® are registered trademarks of LF, LLC. All Rights Reserved.

MODEL #K20ID-26A

Français p. 15

Español p. 31

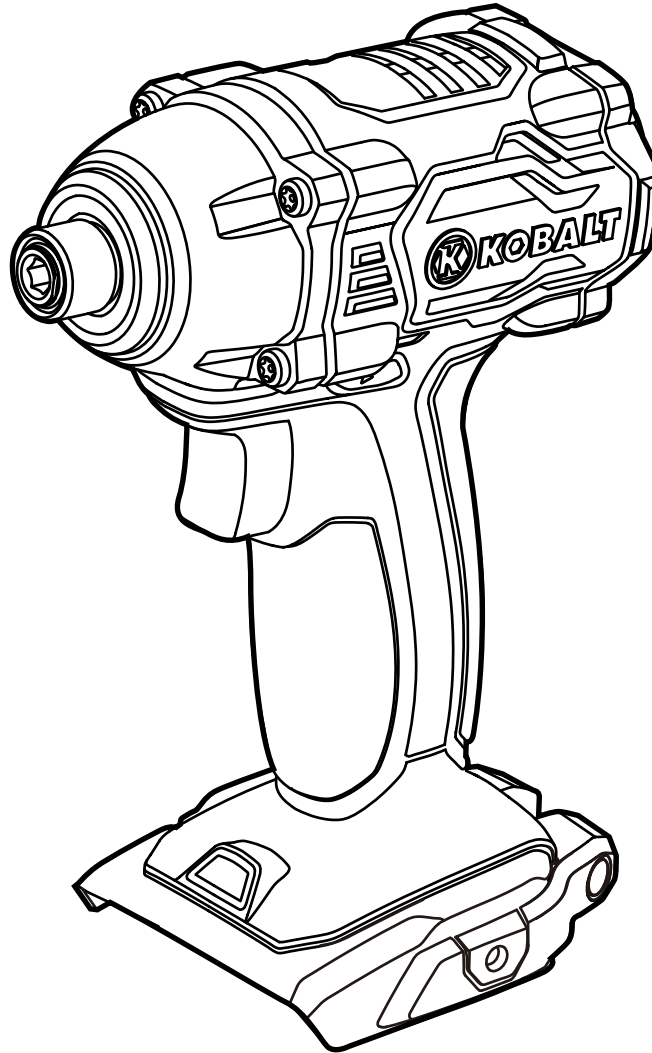

ATTACH YOUR RECEIPT HERE

Serial Number _____ Purchase Date _____



Questions, problems, missing parts? Before returning to your retailer, call our customer service department at 1-888-3KOBALT (1-800-356-2258), 8 a.m.-8 p.m., EST, Monday - Friday.

AB12445

kobalttools.com



TABLE OF CONTENTS

Product Specifications	2
Safety Information	3
Preparation	6
Package Contents	7
Operating Instructions	8
Care and Maintenance	14
Troubleshooting	14
Warranty	14

PRODUCT SPECIFICATIONS

COMPONENT	SPECIFICATION
Motor	20 V DC
Switch	VSR (Variable Speed Reversible)
No-load speed	0-2,500 RPM
Impacts per minute	0-3,300 IPM
Maximum torque	1,550 in. lbs
Collet size	1/4 inch
Impact driver weight (without battery)	2 lbs. 5 oz.



SAFETY INFORMATION

Please read and understand this entire manual before attempting to assemble or operate this product. If you have any questions regarding the product, please call customer service at 1-888-3KOBALT, 8 a.m. - 8 p.m., EST, Monday - Friday.



WARNING





- The operation of any power tool can result in foreign objects being thrown into your eyes, which can result in severe eye damage. Before beginning power-tool operation, always wear safety goggles or safety glasses with side shields and a full-face shield, when needed. We recommend using a wide vision safety mask over eyeglasses or standard safety glasses with shields. Always use eye protection marked to comply with ANSI Z87.1.
- Some dust created by power sanding, sawing, grinding, drilling and other construction activities contains chemicals known to the State of California to cause cancer, birth defects or other reproductive harm. Some examples of these chemicals are:
 - Lead from lead-based paints.
 - Crystalline silica from bricks, cement, and other masonry products.
 - Arsenic and chromium from chemically-treated lumber.
- Your risk from these exposures varies, depending upon how often you do this type of work. To reduce your exposure to these chemicals:
 - Work in a well-ventilated area.
 - Work with approved safety equipment, such as dust masks that are specially designed to filter out microscopic particles.
 - Avoid prolonged contact with dust from power sanding, sawing, grinding, drilling, and other construction activities. Wear protective clothing and wash exposed areas with soap and water. Allowing dust to get into your mouth or eyes or to lie on the skin may promote absorption of harmful chemicals.

Know the Tool

To operate this tool, carefully read this manual and all labels affixed to the driver before using it. Keep this manual available for future reference.

SAFETY INFORMATION

Some of the following symbols may be used on this tool. Please study them and their meaning. Proper interpretation of these symbols will allow you to operate the tool better and more safely.

SYMBOL	DEFINITION	SYMBOL	DEFINITION
V	Volts		Direct Current
A	Amps	n_o	No-load Speed
Hz	Hertz		Class II Construction
W	Watts	/min	Revolutions or Strokes per Minute
	A danger, warning or caution. It means 'Attention! Your safety is involved.'		Alternating Current

IMPORTANT: This tool should only be serviced by a qualified service technician.

General Safety Rules for All Power Tools

 **WARNING:** Read all safety warnings and all instructions. Failure to follow the warnings and instructions may result in electric shock, fire and/or serious injury.

Save all warnings and instructions for future reference

The term “power tool” in the warnings refers to your mains-operated (corded) power tool or battery-operated (cordless) power tool.

Work Area Safety

- **Keep your work area clean and well lit.** Cluttered benches and dark areas invite accidents.
- **Do not operate power tools in explosive environments, such as in the presence of flammable liquids, gases or dust.** Power tools create sparks, which may ignite the dust or fumes.
- **Keep children and bystanders away while operating a power tool.** Distractions can cause you to lose control.

Electrical Safety

- **Power tool plugs must match the outlet. Never modify the plug in any way. Do not use any adaptor plugs with earthed (grounded) power tools.** Unmodified plugs and matching outlets will reduce the risk of electric shock.
- **Avoid body contact with earthed or grounded surfaces such as pipes, radiators, ranges and refrigerators.** There is an increased risk of electric shock if your body is earthed or grounded.
- **Do not expose power tools to rain or wet conditions.** Water entering a power tool will increase the risk of electric shock.



SAFETY INFORMATION

- **Do not abuse the cord.** Never use the cord for carrying, pulling or unplugging the power tool. Keep the cord away from heat, oil, sharp edges or moving parts. Damaged or entangled cords increase the risk of electric shock.
- **When operating a power tool outdoors, use an extension cord suitable for outdoor use.** Use of a cord suitable for outdoor use reduces the risk of electric shock.
- **If operating a power tool in a damp location is unavoidable, use a ground-fault circuit interrupter (GFCI) protected supply.** Use of a GFCI reduces the risk of electric shock.

Personal Safety

- **Stay alert, watch what you are doing and use common sense when operating a power tool. Do not use a power tool while you are tired or under the influence of drugs, alcohol or medication.** A moment of inattention while operating power tools may result in serious personal injury.
- **Use personal protective equipment. Always wear eye protection.** Protective equipment, such as a dust mask, non-skid safety shoes, a hard hat, or hearing protection, used for appropriate conditions, will reduce personal injuries.
- **Prevent unintentional starting. Ensure that the switch is in the off-position before connecting to a power source and/or battery pack, picking up or carrying the tool.** Carrying power tools with your finger on the switch or energizing power tools that have the switch on invites accidents.
- **Remove any adjusting keys or wrenches before turning the power tool on.** A wrench or a key left attached to a rotating part of the power tool may result in personal injury.
- **Do not overreach. Keep proper footing and balance at all times.** This enables better control of the power tool in unexpected situations.
- **Dress properly. Do not wear loose clothing or jewelry. Keep your hair, clothing and gloves away from moving parts.** Loose clothing, jewelry or long hair can be caught in moving parts.
- **If devices are provided for the connection of dust-extraction and collection facilities, ensure that these are connected and properly used.** Use of these devices can reduce dust-related hazards.

Power Tool Use and Care

- **Do not force the power tool. Use the correct power tool for your application.** The correct power tool will do the job better and more safely at the rate for which it was designed.
- **Do not use the power tool if the switch does not turn it on and off.** Any power tool that cannot be controlled with the switch is dangerous and must be repaired.
- **Disconnect the plug from the power source and/or the battery pack from the power tool before making any adjustments, changing accessories, or storing power tools.** Such preventive safety measures reduce the risk of starting the power tool accidentally.
- **Store idle power tools out of the reach of children and do not allow persons unfamiliar with the power tool or these instructions to operate the power tool.** Power tools are dangerous in the hands of untrained users.
- **Maintain power tools. Check for misalignment or binding of moving parts, breakage of parts and any other condition that may affect the power tool's operation. If damaged, have the power tool repaired before use.** Many accidents are caused by poorly maintained power tools.
- **Keep cutting tools sharp and clean.** Properly maintained cutting tools with sharp cutting edges are less likely to bind and are easier to control.
- **Use the power tool, accessories, tool bits, etc., in accordance with these instructions, taking into account the working conditions and the work to be performed.** Use of the power tool for operations different from those intended could result in a hazardous situation.



SAFETY INFORMATION

Battery Tool Use and Care

- **Recharge only with the charger specified by the manufacturer.** A charger that is suitable for one type of battery pack may create a risk of fire when used with another battery pack.
- **Use power tools only with specifically designated battery packs.** Use of any other battery packs may create a risk of injury and fire.
- **When a battery pack is not in use, keep it away from other metal objects such as paper clips, coins, keys, nails, screws or other small metal objects that can make a connection from one terminal to another.** Shorting the battery terminals together may cause burns or a fire.
- **Under abusive conditions, liquid may be ejected from the battery; avoid contact. If contact accidentally occurs, flush with water. If liquid contacts eyes, flush with water and seek medical help.** Liquid ejected from the battery may cause irritation or burns.

Service

- **Have your power tool serviced by a qualified repair person using only identical replacement parts.** This will ensure that the safety of the power tool is maintained.

Specific Safety Rules for the Cordless Impact Driver

- **Hold the power tool by the insulated gripping surfaces when performing an operation where the cutting tool may contact hidden wiring or its own cord.** Contact with a “live” wire may make exposed metal parts of the power tool “live” and could give the operator an electric shock.
- **Secure the workpiece.** Clamping devices or a vise will hold the workpiece in place better and more safely than holding it by hand.
- **Always wait until the machine has come to a complete stop before placing it down.** The tool insert can jam and lead to loss of control over the power tool.
- **Before performing any kind of work on the machine (e.g., maintenance, tool change, etc.), as well as when transporting and storing it, always set the rotational direction switch to the center (locked) position.** Unintentional activation of the On/Off switch may result in personal injury.
- **Do not open the battery.** There is risk of a short circuit.
- **Protect the battery from heat and fire.** There is risk of explosion.
- **When working with the power tool, always hold it firmly with both hands and provide a secure stance.** The power tool is guided more securely with both hands.

PREPARATION

Before attempting to use the driver, familiarize yourself with all of its operating features and safety requirements.



WARNING: Always be careful, an injury can happen in a second.

Helpful Tools (not included): Phillips Screwdriver

PACKAGE CONTENTS

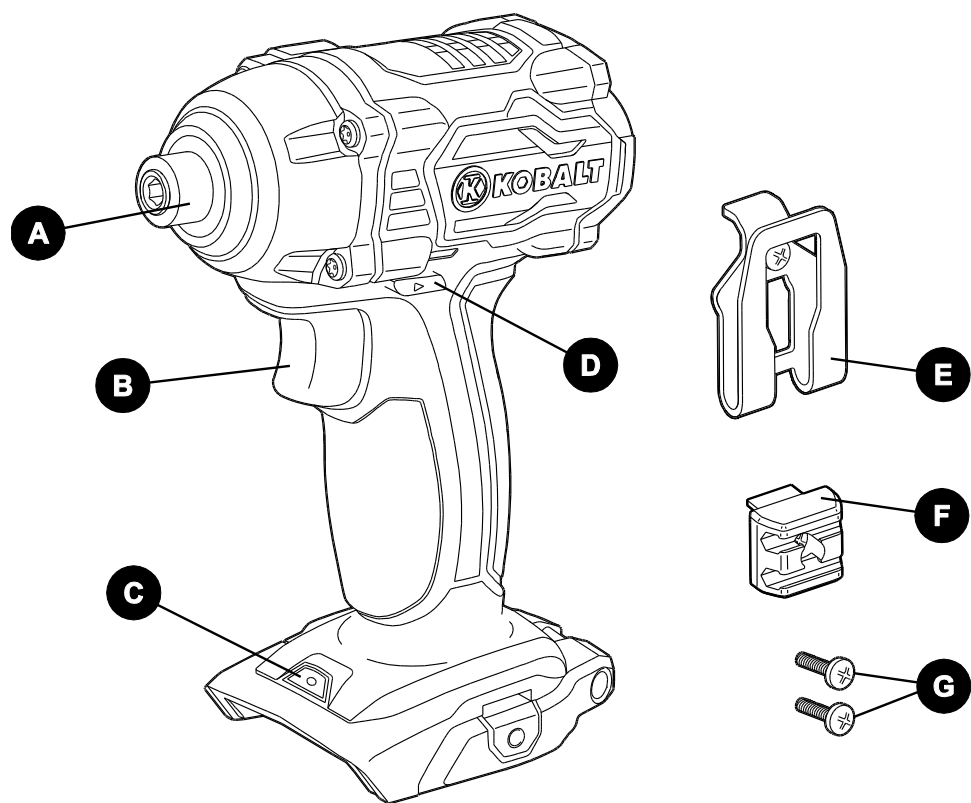

PART	DESCRIPTION
A	Sleeve
B	Variable-speed trigger switch
C	LED work light
D	Direction-of-rotation selector
E	Belt clip (1)
F	Bit holder (1)
G	Screws (2)

OPERATING INSTRUCTIONS

1. Attaching the Battery Pack (sold separately)

NOTICE: This 20 V Impact Driver is compatible with Kobalt Compact Lithium-ion Battery (0352546), Kobalt Extended Run Lithium-ion Battery (0352548), Kobalt 18V NiCd Battery (0005667), Kobalt Compact Lithium-Ion Battery (0437530), and Kobalt Extended Run Lithium-Ion Battery (0437531).

- Place the direction-of-rotation selector (D) in the center (locked) position.
- Align the raised portion on the battery pack with the grooves on the bottom of the impact driver, then slide the battery pack onto the impact driver as shown.
- Ensure that the battery-release button on the battery pack snaps into place and the battery pack is secured to the impact driver before beginning operation.

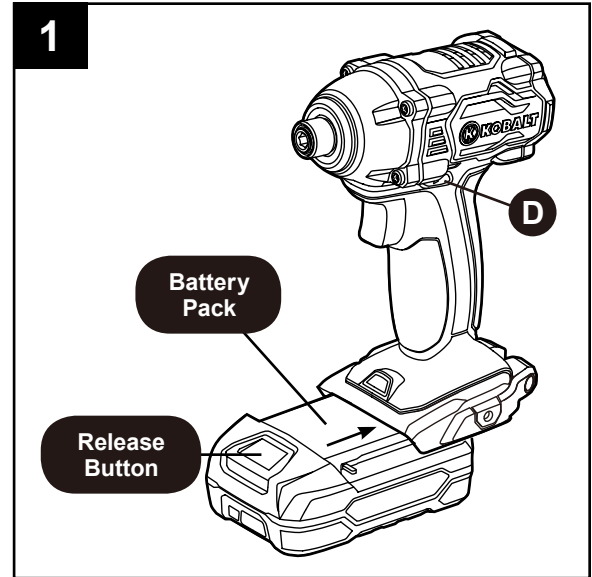

NOTICE: When placing the battery pack on the tool, be sure that the raised rib on the battery pack aligns with the groove on the impact driver and the latches snap into place properly. Improper assembly of the battery pack can cause damage to internal components.

2. Detaching the Battery Pack (sold separately)

- Place the direction-of-rotation selector (D) in the center (locked) position.
- Press the battery-release button to release the battery pack.
- Pull forward on the battery pack to remove it from the impact driver.

! WARNING: Battery tools are always in operating condition. Therefore, the direction-of-rotation selector should always be locked (center) when the tool is not in use or when carrying the tool at your side.

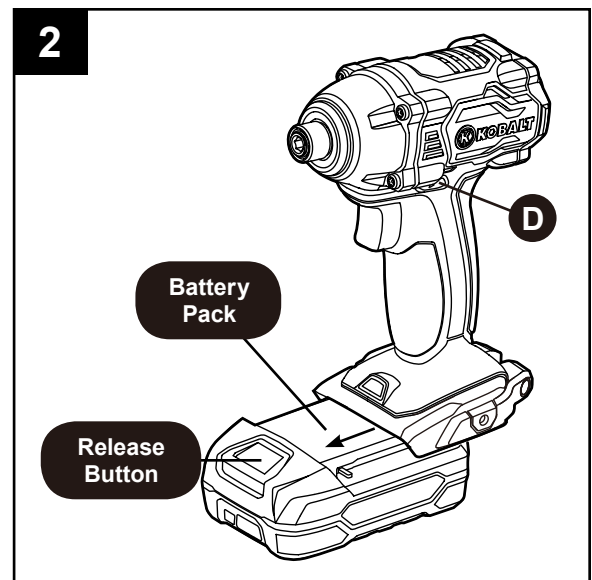

OPERATING INSTRUCTIONS

3. Installing the Belt Clip

- Align the rib of the belt clip (E) with the hole on the base of the driver.
- Insert the screw (G) and tighten the screw securely with a Phillips screwdriver (not included).

NOTICE: The belt clip and drill bit holder are interchangeable between the left and right side of the driver.

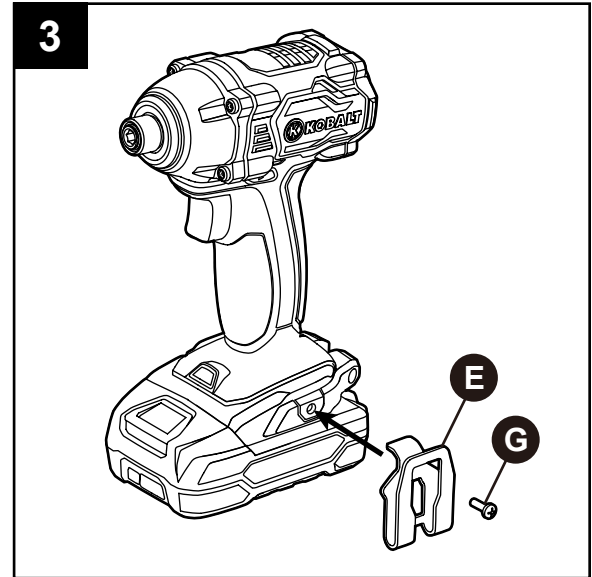

4. Removing the Belt Clip

- Use a Phillips screwdriver to loosen the screw holding the belt clip (E) to the driver.
- Remove the screw and the belt clip (E).

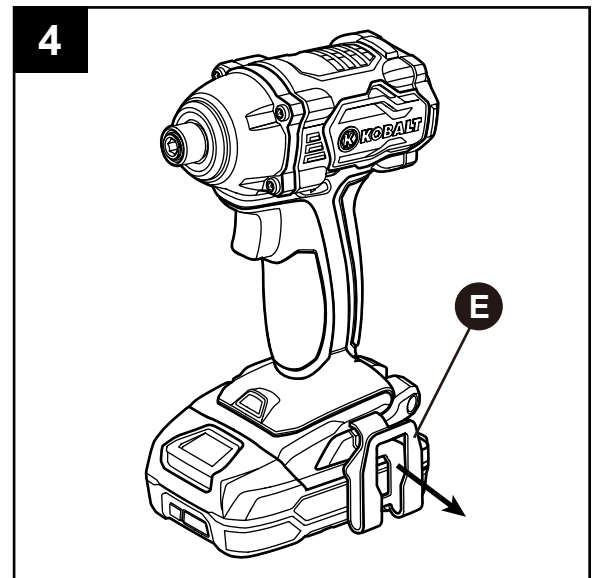

5. Installing the Bit Holder

- Align the rib of the bit holder (F) with the hole on the base of the impact driver.
- Insert the screw (G) and tighten the screw securely with a Phillips screwdriver (not included).

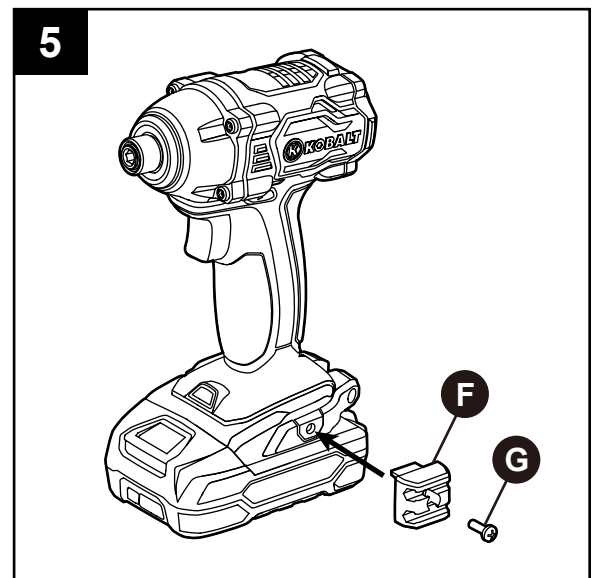

OPERATING INSTRUCTIONS

6. Removing the Bit Holder

- a. Use a Phillips screwdriver to loosen the screw that attaches the bit holder (F) to the impact driver.
- b. Remove the screw and the bit holder (F).

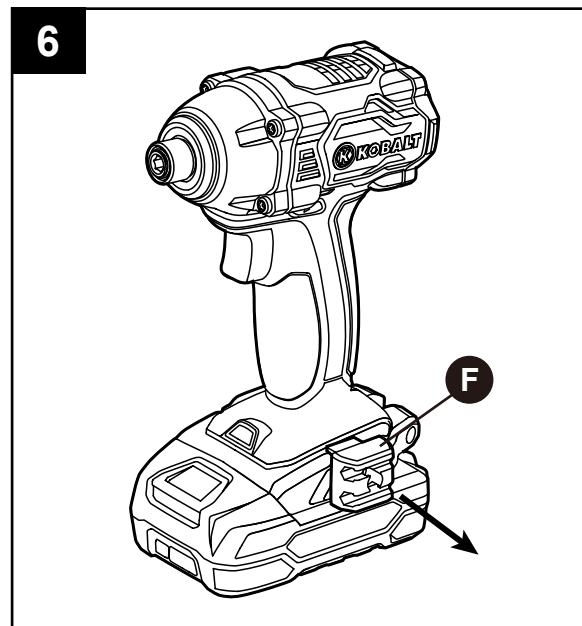

7. Trigger Switch

- a. To turn the impact driver ON, depress the trigger switch (B).
- b. To turn it OFF, release the trigger switch.

NOTICE: The variable-speed trigger switch delivers higher speed with increased trigger pressure and lower speed with decreased trigger pressure.

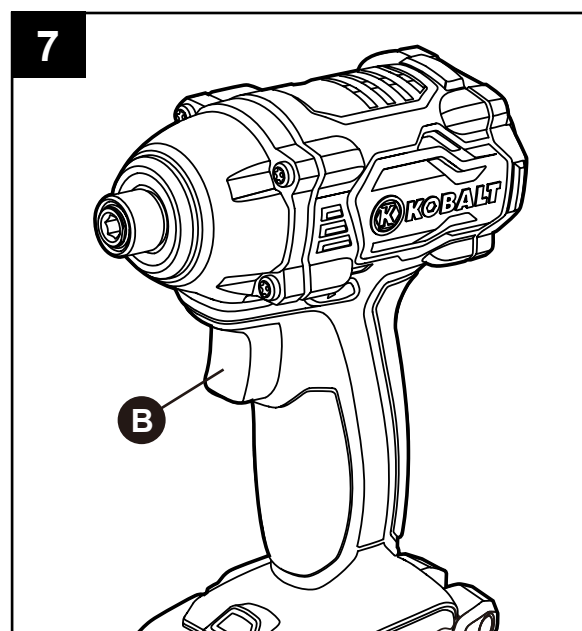

8. Direction-of-Rotation Selector (Forward/Center Lock/Reverse)

The direction of bit rotation is reversible and is controlled by a selector located above the trigger switch (B). With the impact driver held in the normal operating position, pointing away from you:

- Position the direction-of-rotation selector (D) to the left of the tool for forward rotation.
- Position the direction-of-rotation selector to the right of the tool for reverse rotation.
- Setting the switch in the OFF (center lock) position helps reduce the possibility of accidental start-up when not in use.

NOTICE: To prevent gear damage, always allow the impact driver to come to a complete stop before changing the direction of rotation.

NOTICE: The impact driver will not run unless the direction-of-rotation selector is engaged fully to the left or right.

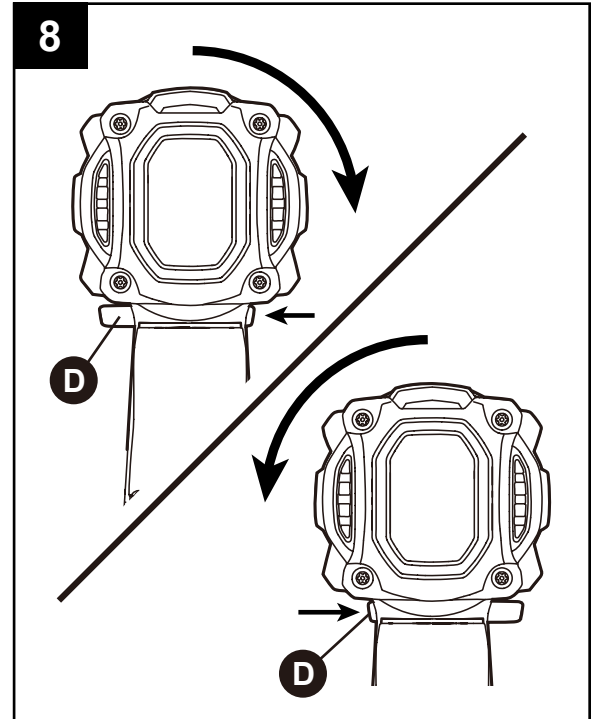

Electric Brake

To stop the impact driver, release the trigger switch (B) and allow the tool to come to a complete stop.

The electric brake quickly stops the rotation. This feature engages automatically when you release the trigger switch.

NOTICE: This impact driver is equipped with an electric brake. When the brake is functioning properly, sparks may be visible through the vent slots in the housing. This is normal and is the action of the brake.

9. LED Worklight

- a. The LED worklight (C), located on the base of the impact driver, illuminates when you press the trigger switch (B). This provides additional light on the surface of the workpiece for operation in lower-light areas.
- b. The LED worklight (C) will turn off when the trigger switch is released.

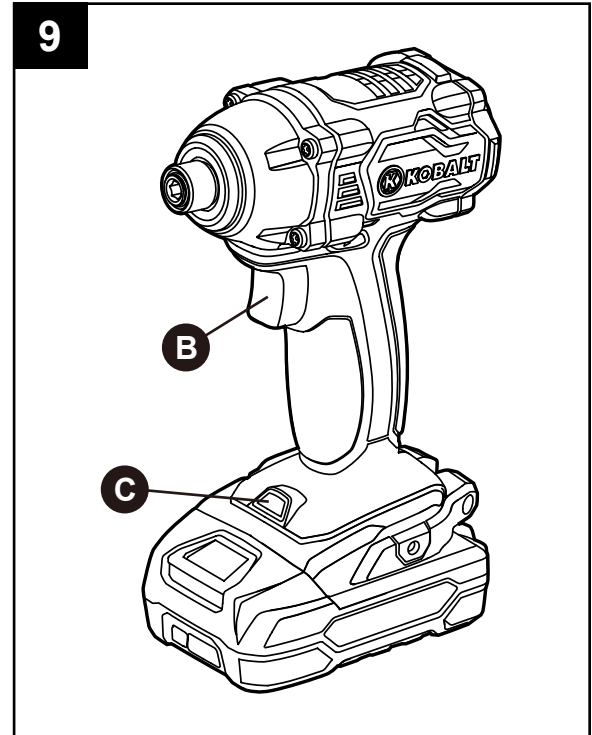

10. Installing Bits

- a. Lock the trigger switch by placing the direction-of-rotation selector (D) in the OFF (center) position.
- b. With one hand, pull the sleeve (A) toward the front of the tool and hold it in place.
- c. With the other hand, insert a 1/4 in. bit into the hexagonal hole in the bit retainer.
- d. Release the sleeve (A) and check that it returns to its original position.

! WARNING: If the sleeve does not return to its original position, the bit is not correctly installed. Retry until the bit is properly installed and the sleeve returns to its original position.

! WARNING: Use protective gloves when removing the bit from the tool, or first allow the bit to cool down. The bit may be hot after prolonged use.

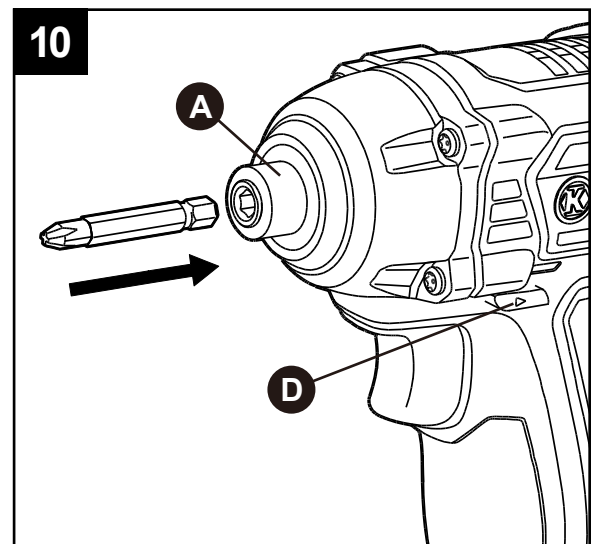

11. Removing Bits

- Lock the trigger switch by placing the direction-of rotation selector (D) in the OFF (center) position.
- Pull the sleeve (A) towards the front of the tool and hold it in place.
- Remove the bit from the hexagonal hole in the bit retainer.
- Release the sleeve.

Tightening and Loosening Screws and Nuts

- Install the correct bit.
- Apply just enough pressure to keep the bit engaged on the screw or nut.
- Apply minimal pressure to the trigger switch (A) initially. Increase the speed only when you can maintain full control.

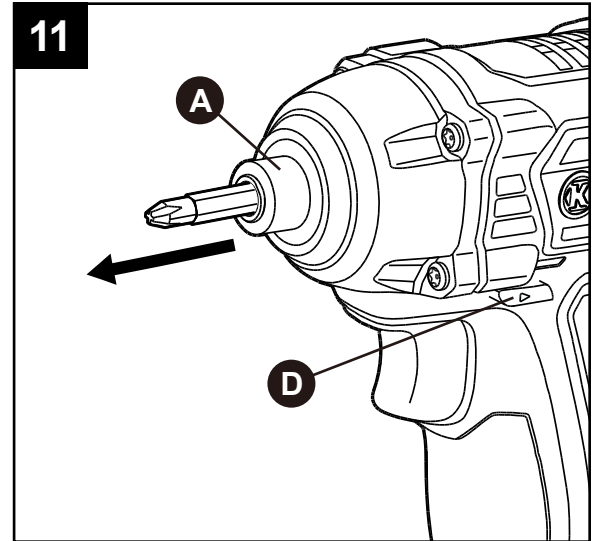

! WARNING: Do not overtighten, as the force of the vimpact driver can break the fastener. Keep the Impact driver at a right angle to the fastener to avoid damaging the fastener head.

CARE AND MAINTENANCE



All maintenance should only be carried out by an authorized service organization.

Cleaning

Before cleaning or performing any maintenance, remove the battery pack from the tool. For safe and proper working, always keep the tool and its ventilation slots clean. Always use only a soft, dry cloth to clean your impact driver. Never use any detergent or alcohol.

TROUBLESHOOTING

If you have any questions regarding this product, please call customer service at 1-888-3KOBALT, 8 a.m. - 8 p.m., EST, Monday - Friday.

PROBLEM	POSSIBLE CAUSE	CORRECTIVE ACTION
The driver does not work.	The battery is depleted.	Charge the battery.
The bit cannot be installed.	1. The sleeve is not released. 2. The bit does not fit the sleeve.	1. Release the sleeve. 2. Use a suitable adapter.
The motor is overheating.	Be sure cooling vents are free of dust and obstacles.	Clean and clear the vents. Do not cover the vents with your hand during operation.

5-YEAR HASSLE-FREE WARRANTY

This impact driver is warranted to the original purchaser from the original purchase date for five (5) years subject to the warranty coverage described herein.

This impact driver is warranted for the original user to be free from defects in material and workmanship.

If you believe that the impact driver is defective at any time during the specified warranty period, simply return the impact driver along with proof of purchase to the place of purchase for a free replacement or refund, or call 1-888-3KOBALT (1-888-356-2258) for warranty service.

This warranty is void if: defects in materials or workmanship or damages result from repairs or alterations which have been made or attempted by others or the unauthorized use of nonconforming parts; the damage is due to normal wear, damage is due to abuse (including overloading of the tool beyond capacity), improper maintenance, neglect or accident; or the damage is due to the use of the tool after partial failure or use with improper accessories or unauthorized repair or alteration.

This warranty excludes belt clip and bulbs.

This warranty gives you specific legal rights, and you may also have other rights that vary from state to state.

Printed in China

KOBALT® and the K Design® are registered trademarks of LF, LLC. All Rights Reserved.

kobalttools.com

