

# DISHWASHER USER INSTRUCTIONS

THANK YOU for purchasing this high-quality product. Register your new dishwasher at [www.kitchenaid.com/customer-service/register-products](http://www.kitchenaid.com/customer-service/register-products). In Canada, register your dishwasher at [www.kitchenaid.ca](http://www.kitchenaid.ca) in the Service and Support section.

For future reference, please make a note of your product model and serial numbers. These can be located on the label located near the door on the right-hand or left-hand side of the dishwasher interior.

Model Number \_\_\_\_\_ Serial Number \_\_\_\_\_

## Table of Contents

DISHWASHER SAFETY .....	1
PARTS AND FEATURES .....	3
START-UP/QUICK REFERENCE .....	5
QUICK STEPS .....	6
DISHWASHER USE .....	6
CYCLE AND OPTION DESCRIPTIONS .....	9
DISHWASHER FEEDBACK SECTION .....	12
DISHWASHER FEATURES .....	13
FILTRATION SYSTEM .....	15
DISHWASHER CARE .....	16
TROUBLESHOOTING .....	18
WARRANTY .....	21

## Dishwasher Safety

### Your safety and the safety of others are very important.

We have provided many important safety messages in this manual and on your appliance. Always read and obey all safety messages.



This is the safety alert symbol.

This symbol alerts you to potential hazards that can kill or hurt you and others.

All safety messages will follow the safety alert symbol and either the word "DANGER" or "WARNING."

These words mean:

**⚠ DANGER**

You can be killed or seriously injured if you don't immediately follow instructions.

**⚠ WARNING**

You can be killed or seriously injured if you don't follow instructions.

All safety messages will tell you what the potential hazard is, tell you how to reduce the chance of injury, and tell you what can happen if the instructions are not followed.

## GROUNDING INSTRUCTIONS

### ■ For a grounded, cord-connected dishwasher:

The dishwasher must be grounded. In the event of a malfunction or breakdown, grounding will reduce the risk of electric shock by providing a path of least resistance for electric current. The dishwasher is equipped with a cord having an equipment-grounding conductor and a grounding plug. The plug must be plugged into an appropriate outlet that is installed and grounded in accordance with all local codes and ordinances.

**WARNING:** Improper connection of the equipment-grounding conductor can result in a risk of electric shock.

Check with a qualified electrician or service representative if you are in doubt whether the dishwasher is properly grounded. Do not modify the plug provided with the dishwasher; if it will not fit the outlet, have a proper outlet installed by a qualified electrician.

### ■ For a permanently connected dishwasher:

The dishwasher must be connected to a grounded metal, permanent wiring system, or an equipment-grounding conductor must be run with the circuit conductors and connected to the equipment-grounding terminal or lead on the dishwasher.

## SAVE THESE INSTRUCTIONS

## IMPORTANT SAFETY INSTRUCTIONS

**WARNING:** When using the dishwasher, follow basic precautions, including the following:

- Read all instructions before using the dishwasher.
- Use the dishwasher only for its intended function.
- Use only detergents or rinse agents recommended for use in a dishwasher, and keep them out of the reach of children.
- When loading items to be washed:
  - 1) Locate sharp items so that they are not likely to damage the door seal; and
  - 2) Load sharp knives with the handles up to reduce the risk of cut-type injuries.
- Do not wash plastic items unless they are marked "dishwasher safe" or the equivalent. For plastic items not so marked, check the manufacturer's recommendations.
- Do not touch the heating element during or immediately after use.
- Do not operate the dishwasher unless all enclosure panels are properly in place.
- Do not tamper with controls.
- Do not abuse, sit on, or stand on the door, lid, or dish racks of the dishwasher.
- To reduce the risk of injury, do not allow children to play in or on the dishwasher.
- Under certain conditions, hydrogen gas may be produced in a hot water system that has not been used for two weeks or more. **HYDROGEN GAS IS EXPLOSIVE.** If the hot water system has not been used for such a period, before using the dishwasher turn on all hot water faucets and let the water flow from each for several minutes. This will release any accumulated hydrogen gas. As the gas is flammable, do not smoke or use an open flame during this time.
- Remove the door or lid to the washing compartment when removing an old dishwasher from service or discarding it.

## SAVE THESE INSTRUCTIONS



## ⚠ WARNING

### Tip Over Hazard

**Do not use dishwasher until completely installed.**

**Do not push down on open door.**

**Doing so can result in serious injury or cuts.**

State of California Proposition 65 Warnings:

**WARNING:** This product contains one or more chemicals known to the State of California to cause cancer.

**WARNING:** This product contains one or more chemicals known to the State of California to cause birth defects or other reproductive harm.

## Parts and Features KDTE104E, KDTE204E, KDFE204E, KDTE254E

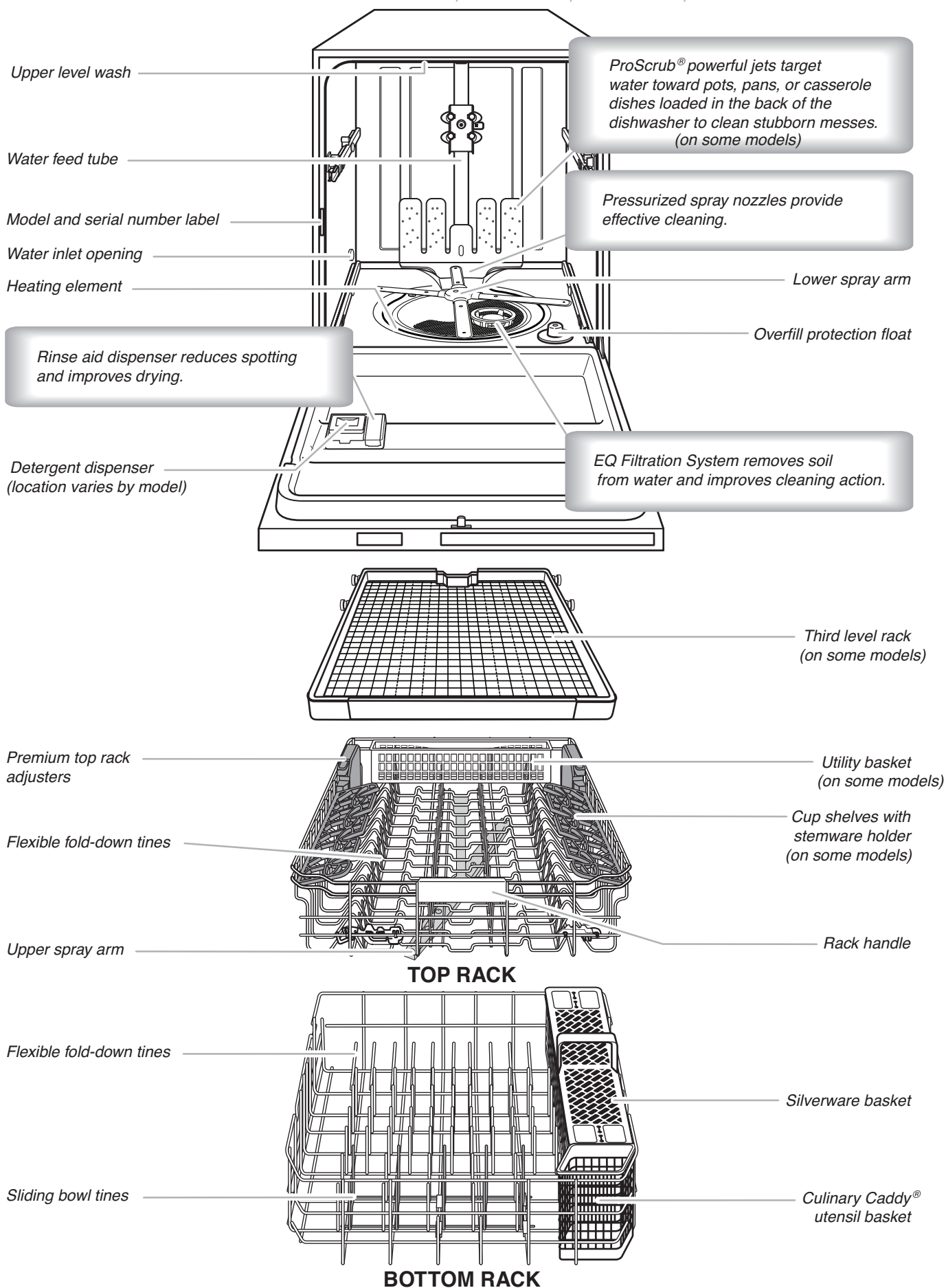

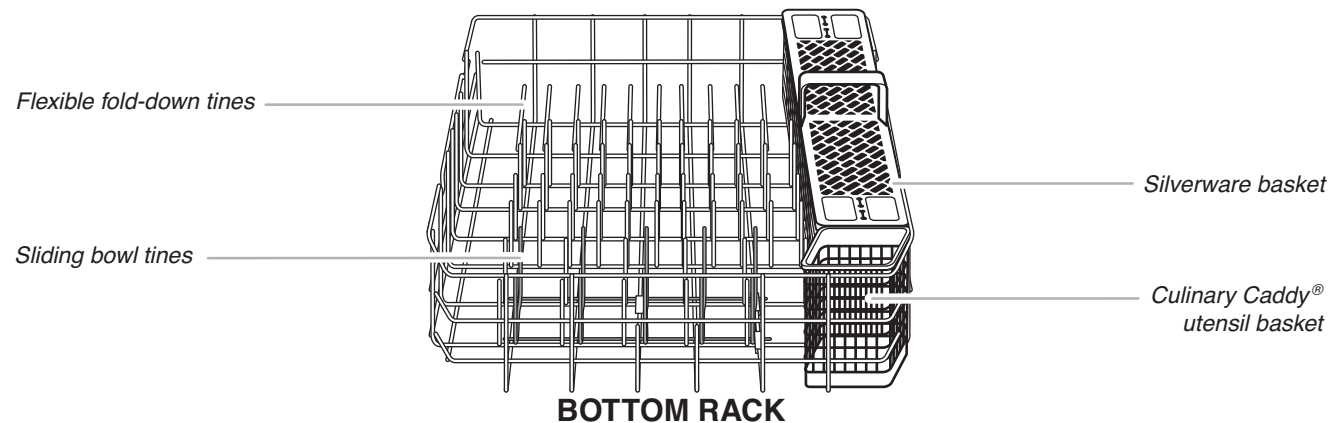
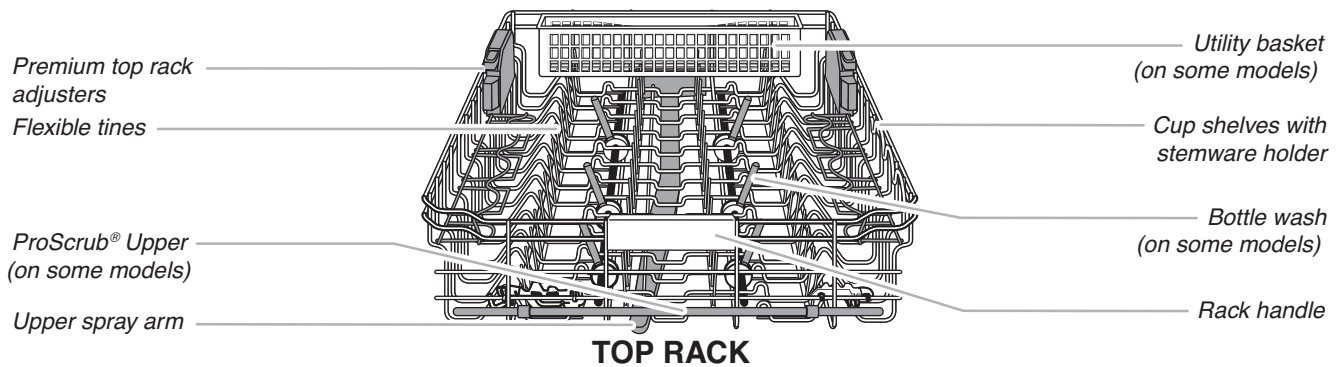
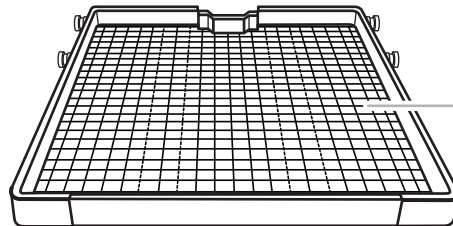
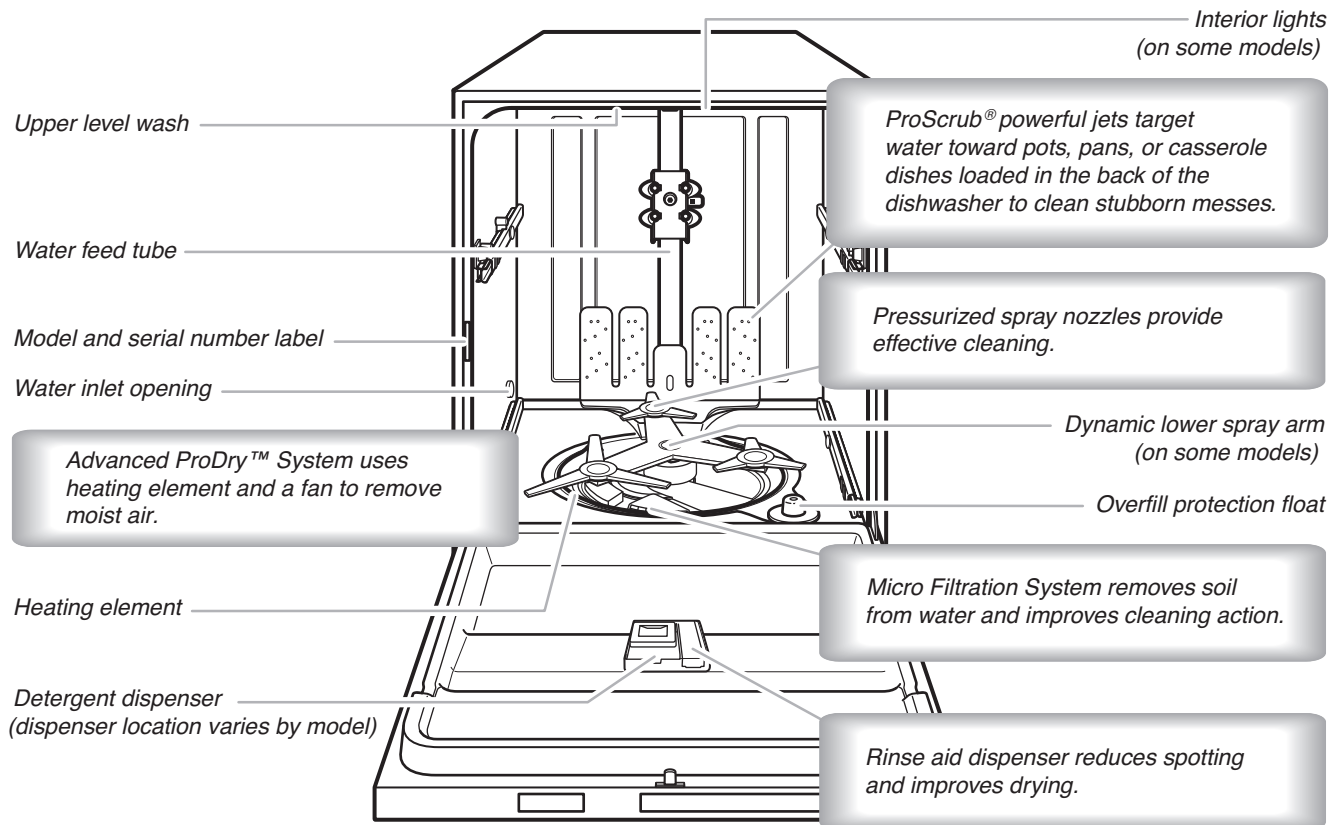

## Clean EQ Wash System removable filters to maintain peak performance

Cleaning the filters periodically helps keep the dishwasher working at peak performance. The filters can be found at the bottom center of your dishwasher.

See “Filtration System” section for information on removing and maintaining the filters.

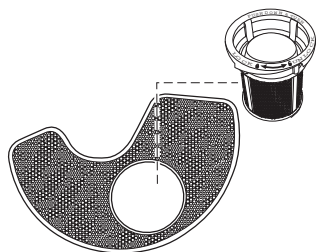

## Drying - Rinse Aid is essential

You must use a drying agent such as a rinse aid for good drying performance (sample included). Rinse aid along with the ProDry™ option will provide best drying and avoid excessive moisture in the dishwasher interior.

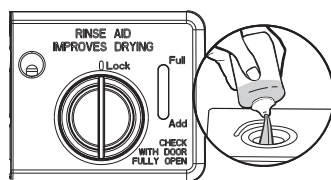

## ProDry

For best drying use the ProDry™ option.

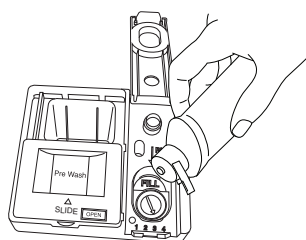

Dispensers vary by model

## Express Wash - When you need fast results.

Efficient dishwashers run longer to save water and energy, just as driving a car slower saves on gas. When you need fast results, the Express Wash will clean your dishes using slightly more water and energy. Select the ProDry™ option to include automatic drying (adds approximately 38 to 45 minutes to the Express Wash cycle).

## Express Wash

## ProWash™ cycle for optimal cleaning

The most advanced and versatile cycle. ProWash™ cycle senses the soil amount and toughness of soil to adjust the cycle for optimal cleaning using only the amount of water and energy needed. The ProWash™ and Tough cycles are recommended for tough soil. No need to pre-rinse dishes; just scrape leftover food into the trash or disposal and load.

## ProWash

Soil - Sense

## ProScrub® Option to clean baked-on food

When the ProScrub® option is selected, it provides a concentrated wash on the back of the lower dish rack for hard-to-clean dishes. Place these dishes with the soiled surface of the dish toward the ProScrub® spray jets in the lower rack of the dishwasher.

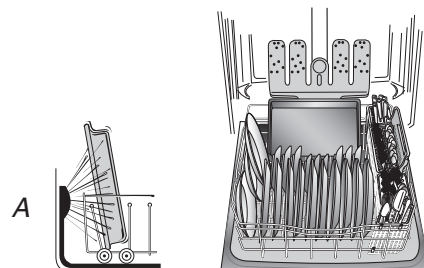

A. Back of dishwasher

## Press START/RESUME every time you add a dish

**IMPORTANT:** If anyone opens the door (such as, to add a dish, even during the Delay option), the Start/Resume button must be pressed each time.

Push door firmly closed within 3 seconds of pressing START/RESUME. If the door is not closed within 3 seconds, the Start/Resume button LED will flash, an audible tone will be heard, and the cycle will not start.

## Start RESUME

Repeat Last  
Cycle

## Proper Detergent Dosing

We recommend quality tablets and packs for convenience and improved performance.

It is possible to use too much detergent in your dishwasher. This can lead to etching of your dishes. See “Add Detergent” and “Add Rinse Aid” in the “Dishwasher Use” section, to determine the amount of detergent needed based on your water hardness.

## Quick Steps

### 1 Prepare and load dishwasher.

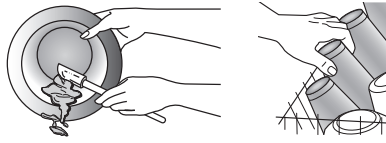

### 3 Select a cycle and option.

SOIL CYCLES			SPEED CYCLES		
• ProWash <small>Soil - Sense</small>	• Tough	• Normal	• Light	• Express Wash	• Rinse Only
OPTIONS					
• ProDry	• ProScrub	• Hi-Temp Wash <small>Sound On/Off Hold 3 Sec</small>	• Sani Rinse	• Top Rack Only <small>Control Lock Hold 3 Sec</small>	• 2-4-8 Hr. Delay

### 2 Add detergent for cleaning and rinse aid for drying.

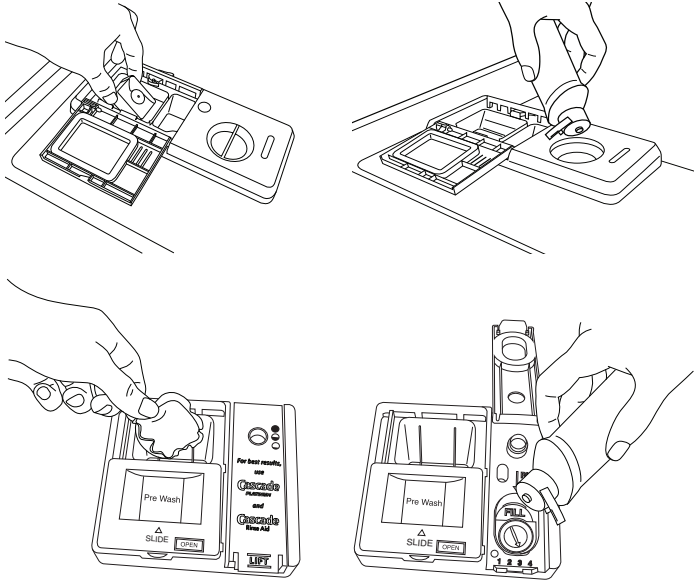

Dispensers vary by model.

### 4 Start dishwasher.

**NOTE:** If the Start/Resume button is located on the top of the door, ensure the light beside the button is lit and firmly push the door closed within 3 seconds of pressing START/RESUME.

**Start**  
RESUME  
Repeat Last Cycle

## Dishwasher Use

### STEP 1

#### Prepare and Load the Dishwasher

**IMPORTANT:** Remove leftover food, bones, toothpicks and other hard items from the dishes. Remove labels from containers before washing.

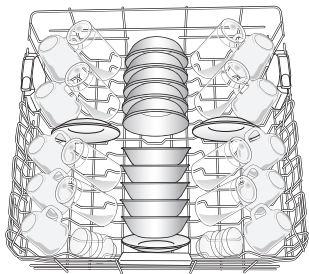

10 place load - upper rack

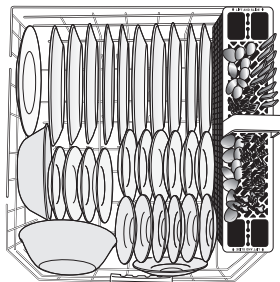

10 place load - lower rack

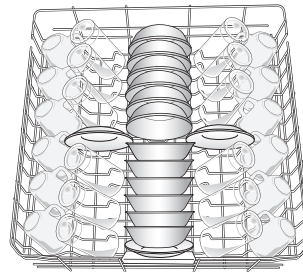

12 place load - upper rack

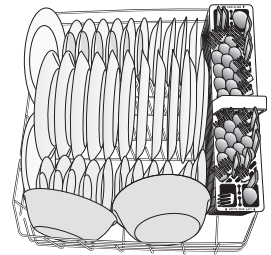

12 place load - lower rack



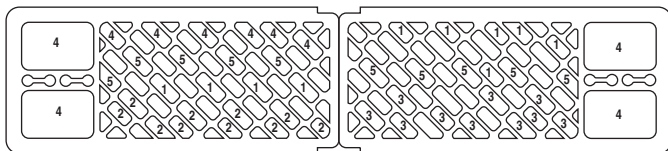

10 place load - silverware basket

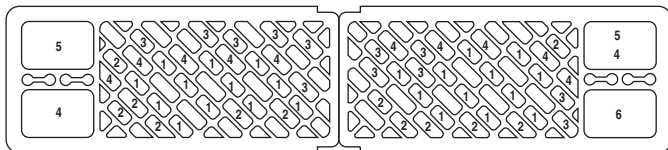

12 place load - silverware basket

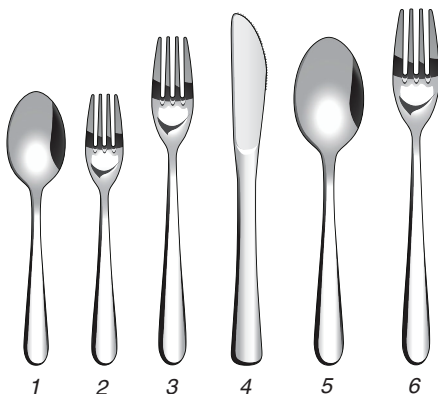

1. Teaspoon
2. Salad fork
3. Dinner fork
4. Knife
5. Tablespoon/large serving spoon
6. Large serving fork

- Be sure that items in the rack do not block the upper or lower spray arms.
- Make sure that when the dishwasher door is closed no items are blocking the detergent dispenser.
- Items should be loaded with soiled surfaces facing down and inward to the spray as shown. This will improve cleaning and drying results.
- Avoid overlapping items like bowls or plates that may trap food.
- Place plastics, small plates and glasses in the upper rack. Wash only plastic items marked "dishwasher safe."
- To avoid thumping/clattering noises during operation, load dishes so they do not touch one another. Make sure lightweight load items are secured in the racks.
- Improper loading can cause dishes to be chipped or damaged. When loading glasses or mugs, it is best to load these items in between rows of tines instead of loading them over tines.
- If you do not want to use the covers you can remove them. Load the silverware with sharp items pointed down and avoid "nesting" of spoons and forks by alternating some up and some down.

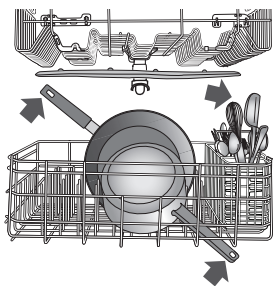

Do not block spray arms

## STEP 2

### Add Detergent

**NOTE:** If you do not plan to run a wash cycle soon, run a rinse cycle. Do not use detergent.

- Use automatic dishwasher detergent only. Add powder, liquid or tablet detergent just before starting a cycle.
- Fresh automatic dishwasher detergent results in better cleaning. Store tightly closed detergent container in a cool, dry place. We recommend tablets and packs for convenience and improved performance.

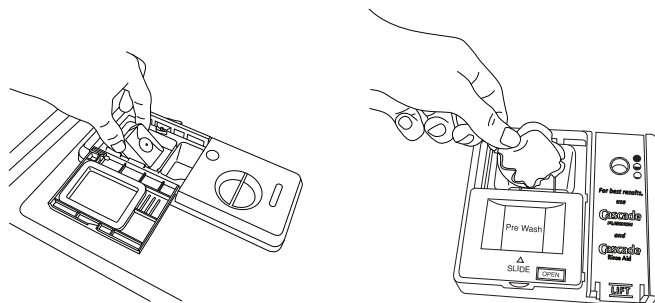

### Premeasured Detergents

Many detergents now come in several forms (gel packs, tablets, or powder packs).

We recommend that you use high quality tablets or packs for convenience and improved performance. High quality tablets and packs have been proven better than powder, liquid or gel detergents at reducing filming on dishes. Using tablets and packs over time will start to reduce or eliminate white film. Also, by using a rinse aid, you can minimize repeat buildup of white film. These forms are suitable for all hardness and soil levels. Always place detergents in the main compartment and slide lid to close.

#### To close lid

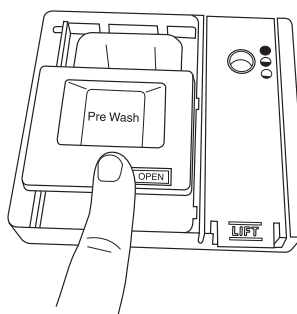

Place selected detergent in the dispenser. Place finger, as shown, and slide lid closed. Press firmly until it clicks.

#### To open lid

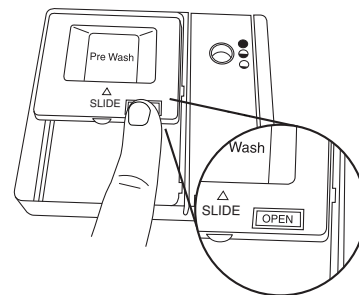

Push OPEN, as shown, and the lid will slide open.

### Powders and Gels

- The amount of detergent to use depends on:
  - How much soil remains on the items - Heavily soiled loads require more detergent.
  - The hardness of the water - If you use too little in hard water, dishes won't be clean. If you use too much in soft water, glassware can etch.
  - Soft to Medium Water (0-6 grains per U.S. gallon)  
[typical water softener water and some city water]
  - Medium to Hard Water (7-12 grains per U.S. gallon)  
[well water and some city water]
- Depending on your water hardness, fill the Main Wash section of the dispenser as shown. Fill the Pre-Wash section to the level shown if needed.

**NOTE:** Fill amounts shown are for standard powdered detergent. Follow instructions on the package when using gel dishwasher detergents. Premeasured forms are suitable for all hardness and soil levels. Always place premeasured detergents in the main compartment and close the lid.

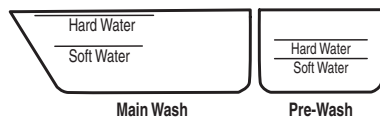

### Add Rinse Aid (Dispenser varies by model)

- Your dishwasher is designed to use rinse aid for good drying performance. Without rinse aid your dishes and dishwasher interior will have excessive moisture. The Heat Dry option will not perform as well without rinse aid.
- Rinse aid keeps water from forming droplets that can dry as spots or streaks. It also improves drying by allowing water to drain off of the dishes after the final rinse.
- Rinse aid helps to reduce excess moisture on the dish racks and interior of your dishwasher.
- Check the rinse aid indicator with the door down (varies by model). Add rinse aid when indicator drops to "Add" level.



- Add rinse aid to this style dispenser by twisting the dispenser cap ¼ turn clockwise to open and lift off. Pour rinse aid into the opening until the indicator level is at "Full." Replace the dispenser cap and turn to "Lock." Make sure cap is fully locked

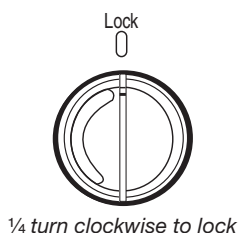

- To add rinse aid to this style dispenser, open the rinse dispenser lid by gently pushing in the center of the lid with your thumb and pulling up on the edge. Pour rinse aid into the opening until the dispenser is full. Then, close the dispenser by pushing down gently on the lid.

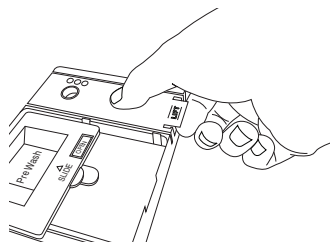

**NOTE:** For most water conditions, the factory setting will give good results. If you have hard water or notice rings or spots, try a higher setting. Turn the arrow adjuster inside the dispenser by either using your fingers or inserting a flat-blade screwdriver into the center of the arrow and turning.

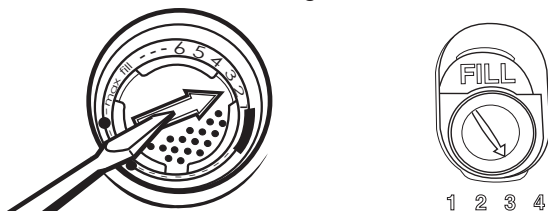

Higher numbers dispense more rinse aid. You should change this setting only a little at a time and then run a few cycles before changing it again because just enough rinse aid is more effective than too much.

## STEP 3

### Select a Cycle

See "Cycle and Option Descriptions" charts in the following section.

Efficient dishwashers run longer to save water and energy, just as driving a car slower saves on gas. Typical cycle time is approximately 2 hours, but can take less or more time to complete depending on selections.

SOIL CYCLES				SPEED CYCLES	
• ProWash	• Tough	• Normal	• Light	• Express Wash	• Rinse Only
Soil - Sense					

### Select Options

See "Cycle and Option Descriptions" charts in the following section.

You can customize your cycles by pressing the options desired. If you change your mind, press the option again to turn off the option. Not all options are available for every cycle. If an invalid option is selected for a given cycle, the lights will flash.

OPTIONS					
• ProDry	• ProScrub	• Hi-Temp Wash	• Sani Rinse	• Top Rack Only	• 2-4-8 H Delay
		Sound On/Off Hold 3 Sec	Control Lock Hold 3 Sec		

## STEP 4

### Start or Resume a Cycle

- Run hot water at the sink nearest your dishwasher until the water is hot. Turn off water.
- After selecting the cycle and options, press START/RESUME to start the dishwasher.  
OR  
Press START/RESUME once to show which selections you previously used and press START/RESUME again to repeat the same cycle.
- To resume a cycle press START/RESUME and close the door within 3 seconds.

**IMPORTANT:** If anyone opens the door (such as, for adding a dish, even during the Delay Hours option), the Start/Resume button must be pressed each time.

- If the Start/Resume button is located on the top of the door, press START/RESUME. Ensure the light beside the button is lit and the countdown timer (on some models) is counting down while you firmly push the door closed. The door must be closed within 3 seconds of pressing START/RESUME or you will hear a series of beeps and the cycle will not start.

**NOTE:** For best results, press the buttons lightly with the flat part of your finger instead of with your fingertip.

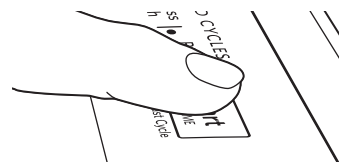



## Cycle and Option Descriptions



KDTM704E, KDTM804E

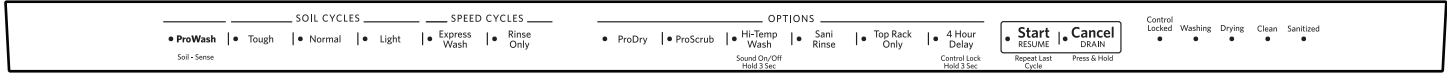

KDTM504E



KDTM404E



KDTM354E, KDTM384E

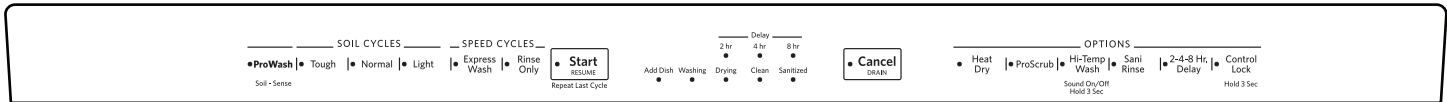

KDTE204E, KDTE254E



KDTE204E Custom door model

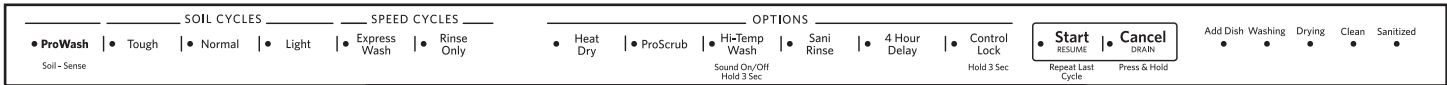

KDFE204E

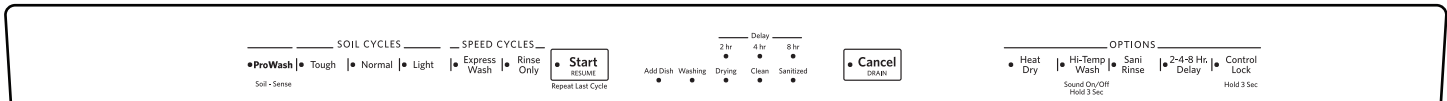

KDTE104E

This information covers several different models. Your dishwasher may not have all of the cycles and options described.

### CYCLE SELECTIONS

CYCLES		SOIL LEVEL	ESTIMATED TIME* (HH:MM)		WATER USAGE GALLONS (Liters)
Dishwasher senses the soil amount and adjusts cycle times.			Min Soil Level**	Max Soil Level	
<b>ProWash</b> Soil - Sense	The most advanced and versatile cycle. ProWash™ cycle senses the soil amount and toughness of soil to adjust the cycle for improved performance using only the amount of water and energy needed. Includes Heat Dry.	<b>Light to Heavy</b>	2:31	3:16	3.7-4.2 (14.0 - 15.9)
<b>Tough</b>	Use for hard-to-clean, heavily soiled pots, pans, casseroles, and regular tableware. Includes Heat Dry.	<b>Heavy/Baked-On</b>	2:59	3:59	4.2 (15.9)

CYCLE SELECTIONS					
CYCLES		SOIL LEVEL	ESTIMATED TIME* (HH:MM)		WATER USAGE GALLONS (Liters)
Dishwasher senses the soil amount and adjusts cycle times.			Min Soil Level**	Max Soil Level	
<b>Normal</b>	This cycle, with only the Heat Dry option selected, and without other options selected, is recommended to completely wash and dry a full load of normally soiled dishes. The energy usage label is based on this cycle and option combination. Includes Heat Dry.	<b>Light to Heavy</b>	2:22	3:27	2.7 - 4.2 (10.2- 15.9)
<b>Light</b>	Use for lightly soiled items or china and crystal. Includes Heat Dry.	<b>Light to Heavy</b>	2:22	3:27	2.7 - 4.2 (10.2 - 15.9)
<b>Express Wash</b>	When you need fast results, the Express Wash will clean dishes using slightly more water and energy. Does not include Heat Dry. Select the Heat Dry or ProDry™ option to include automatic drying.	<b>All soil levels</b>	:57	:62	5.2 (19.8)
<b>Rinse Only</b>	Use for rinsing dishes, glasses, and silverware that will not be washed right away. Does not include Heat Dry. Do not use detergent.	<b>All soil levels</b>	:15	:15	2.1 (8.1)

Wash times depend on water temperature, heavy soil condition, dish load size and options selected.

\*Adding options will add time to the cycle. See options information section.

\*\*This is the approximate cycle time obtained with 120°F (49°C) hot water available at the dishwasher. Increase in time results from low temperature of the incoming water.

OPTION SELECTIONS						
OPTIONS		CAN BE SELECTED WITH	WHAT IT DOES	ADDED TIME TO CYCLE*** (HH:MM)		ADDED WATER GALLONS (LITERS)
				MIN	MAX	
<b>Heat Dry</b>	Dries dishes with the heating system of the dishwasher. For models having only the Heat Dry option, this option, with the use of rinse aid, will provide the best drying performance. Plastic items are less likely to deform when loaded in the top rack.  Turn the Heat Dry option off for air dry.	<b>Use Heat Dry with any cycle except Rinse Only</b>	Uses the heating system of the dishwasher to remove moist air. The Heat Dry option defaults to on for all cycles, except for Express Wash and Rinse Only.	:48	:48	<b>0</b>
<b>ProDry</b> (on some models)	Uses the Advanced ProDry™ system to dry dishes with heat and a fan. For the very best drying performance, use rinse aid and the ProDry™ option	<b>Use ProDry with Heat Dry and with any cycle except Light or Rinse Only</b>	The ProDry™ option adds extra time to the drying cycle.	:32	:32	
<b>ProScrub and (on some models)</b> ● ProScrub Upper ● Control Lock Hold 3 Sec	Lower jets spray, from behind the lower rack, to clean pans, casseroles, etc. that have tough food soil to eliminate the need for soaking and scrubbing of dirty, baked-on dishes.  The upper rack has two spray zones in the front corners to reach into deeper or oddly shaped items.	<b>ProWash™ Tough Normal Top Rack Only</b>	Activates the ProScrub® spray jets to provide intensified cleaning power to specific wash areas.	:30	:40	<b>0 - 1.5 (0 - 5.7)</b>
<b>Hi-Temp Wash</b> Sound On/Off Hold 3 Sec	Raises the main wash temperature to improve cleaning for loads containing tough, baked-on food.	<b>ProWash™ Tough Normal</b>	Raises the main wash temperature from 105°F to either 130°F or 140°F (41°C to 55°C or 60°C).	:00	:12	<b>0 - 1.5 (0 - 5.7)</b>
● <b>Bottle Wash</b> ● Control Lock Hold 3 Sec	(on some models) The upper rack has six retractable spray nozzles that reach into deeper items such as sports bottles, baby bottles or oddly shaped items. Flip the nozzles up to use them and down to move them out of the way.	<b>ProWash™ Tough Normal</b>	Bottle Wash nozzles ensure interior wash and rinse coverage inside taller items, such as bottles.	:03	:05	<b>0</b>

OPTION SELECTIONS						
OPTIONS		CAN BE SELECTED WITH	WHAT IT DOES	ADDED TIME TO CYCLE*** (HH:MM)		ADDED WATER GALLONS (LITERS)
				MIN	MAX	
<b>Sani Rinse</b>	<p>Sanitizes dishes and glassware in accordance with NSF International NSF/ANSI Standard 184 for Residential Dishwashers. Certified residential dishwashers are not intended for licensed food establishments. Only sanitizing cycles have been designed to meet the requirements of the NSF/ANSI 184 performance standard for soil removal and for sanitization efficacy. There is no intention, either directly or indirectly, that all cycles on a NSF/ANSI 184 certified dishwasher meet the NSF/ANSI 184 performance standard for soil removal and for sanitization efficacy.</p> <p>The Sani indicator glows at the end of the cycle if the Sani Rinse option was successfully completed. If the indicator does not activate, it is probably due to the cycle being interrupted.</p>	<b>ProWash™ Tough Normal Top Rack Only</b>	Increases the main wash temperature from 105°F to 140°F (41°C to 60°C) and the final rinse from 140°F to 155°F (60°C to 68°C).	:10	:50	<b>0 - 1.5 (0 - 5.7)</b>
<b>Top Rack Only</b>  Control Lock Hold 3 Sec	(on some models) For added convenience, use for washing a small load of dishes in the top rack to help keep the kitchen continuously clean.	<b>Available with any cycle</b>	Slightly faster wash for smaller loads	:-03	:-08	<b>0</b>
● <b>1-24 Hr. Delay</b> or (on some models) <b>4 Hour Delay</b>	<p>Runs the dishwasher at a later time or during off-peak electrical hours. Select a wash cycle and options. Press the Delay button. Press START/RESUME. Close the door firmly.</p> <p><b>NOTE:</b> Anytime the door is opened (such as, to add a dish), the Start/Resume button must be pressed again to resume the delay countdown.</p>	<b>Available with any cycle</b>	Delays the start of a cycle to the specified time.	1:00	24:00	<b>0</b>
<b>Control Lock</b>  Hold 3 Sec	<p><b>IMPORTANT:</b> Control lock button varies by model. Your model may require you to press and hold PROSCRUB UPPER, 4 HOUR DELAY or BOTTLE WASH to lock the controls. The Control Lock light will turn on when the Control Lock is active.</p> <p>Use Control lock to avoid unintended use of the dishwasher between cycles, or cycle and option changes during a cycle.</p> <p>To turn on Lock, press and hold the control lock button designated for your model for 3 seconds. The Control Lock light will stay on for a short time, indicating that it is activated, and all buttons are disabled. If you press any button while your dishwasher is locked, the light flashes 3 times. The dishwasher door can still be opened/closed while the controls are locked.</p> <p><b>NOTE:</b> You may need to disable Sleep Mode by pressing either Start/Resume or Cancel, or by opening and closing the door before you are able to turn Control Lock off.</p> <p>To turn off Control Lock, press and hold the control lock button designated for your model for 3 seconds. The light turns off.</p>					

\*\*\*Cycle times may increase depending on water temperature, heavy soil condition, and options selected. Adding options will add time to the cycle. See the options information.

CONTROLS AND CYCLE STATUS		
CONTROL	PURPOSE	COMMENTS
<b>Start</b> RESUME  Repeat Last Cycle	To start or resume a wash cycle	<p>If the door is opened during a cycle for any reason or if the power is interrupted, the Start/Resume indicator flashes. The cycle will not resume until the Start/Resume button is pressed and the door is closed.</p> <p><b>NOTE:</b> (for models with controls on top of the door) Push door firmly closed within 3 seconds of pressing Start/Resume. If the door is not closed within 3 seconds, the Start/Resume light will flash, an audible tone will be heard, and the cycle will not start.</p>

CONTROLS AND CYCLE STATUS		
CONTROL	PURPOSE	COMMENTS
<b>Cancel</b> DRAIN	To reset any cycle and options during selection or to cancel a wash cycle and drain the dishwasher after it has started.	Press and hold CANCEL/DRAIN to reset any control selections made.  See the “Canceling A Cycle After Dishwasher Is Started” and “Changing A Cycle After Dishwasher Is Started” sections.
<b>Hi-Temp Wash</b>  Sound On/Off Hold 3 Sec	To turn the audible tones on or off.	Press and hold the HI TEMP WASH button for 3 seconds to turn the audible tones on or off. Only audible tones for confirming button presses can be turned on/off. Important audible tones, such as indicating a cycle has been interrupted, cannot be deactivated.

## Dishwasher Feedback Section

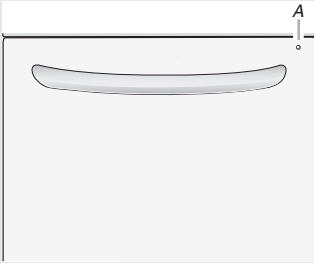
CONTROLS AND CYCLE STATUS		
CONTROL	PURPOSE	COMMENTS
	The Cycle Status Indicator Light is used to follow the progress of the dishwasher cycle. It is located on the front of the door.	The single indicator light on the front of the door panel (A) will remain blue during wash/rinse, red during dry, and white when complete.
<div>Sanitized</div> <div>Washing</div> <div>Sanitized</div> <div>Washing</div>	<div>Clean</div> <div>Drying</div> <div>Clean</div> <div>Drying</div>	<p>The Cycle Status Display is used to follow the progress of the dishwasher cycle, and to show other information.</p> <p>The Time Display is used for estimated cycle time and also for delay hours. Estimated cycle time is displayed in hours and minutes as you make cycle and option selections. After you start the dishwasher, the display counts down the time.</p> <p>After you press the Start/Resume button, the Time Display counts down seconds to close the door. If the door is not closed by the end of the countdown you will hear a series of beeps and the cycle will not start.</p> <p>When you select the Delay feature, the Time Display will give the number of hours followed by an “H”.</p>

### Canceling a Cycle

1. Open the door slightly to stop the cycle. Wait for the spraying action to stop before completely opening the door.
2. Press and hold CANCEL/DRAIN button once. The Cancel/Drain light will light up.
3. Close the door and the dishwasher starts a drain cycle (if water remains in bottom of dishwasher). Let the dishwasher drain completely. The Cancel/Drain light turns off after 2 minutes.

### Changing a Cycle After Dishwasher Is Started

1. You can interrupt a cycle and restart your dishwasher from the beginning using the following procedure.
2. Open the door slightly to stop the cycle. Wait for the spraying action to stop, then open the door completely.
3. Check that detergent dispenser cover is still closed. If cover is open, you will need to refill the detergent dispenser before restarting your new cycle.
4. Press CANCEL/DRAIN and wait approximately 2 minutes until the machine drains and the Cancel/Drain light turns off.
5. Select new cycles and options.
6. Press START/RESUME.

### Adding a Dish After Dishwasher Is Started

#### If your dishwasher has an “Add Dish” indicator:

1. Open the door slightly to stop the cycle. Wait for the spraying action to stop and then completely open the door.
2. Add a dish to the load while the indicator is lit.
3. Press the START/RESUME button and close the door. If the door is not closed before the countdown timer ends you will hear a series of beeps and the dishwasher will not start.

#### If your dishwasher does not have “Add Dish” indicator:

1. Open the door slightly to stop the cycle. Wait for the spraying action to stop and then completely open the door.
2. If the detergent dispenser door is closed you may add a dish. If the detergent dispenser door is already opened an added dish might not be cleaned.
3. Press the START/RESUME button and close the door. If the door is not closed before the countdown timer ends you will hear a series of beeps and the dishwasher will not start.

## Dishwasher Features

Your KitchenAid dishwasher may have some or all of these features.

### ProScrub® Option Wash Area

The ProScrub® option wash area is located at the back of the lower level rack and the front corners of the upper level rack.

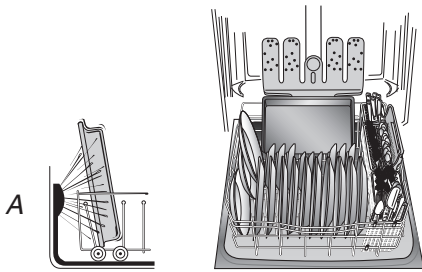

A. Back of dishwasher

**NOTE:** You must select the ProScrub® or ProScrub® Upper (on some models) option to use these features. Make sure items do not interfere with the water feed tube, spray arms, or the lower rack ProScrub® spray jets.

- Keep the last tine row in the back of the lower rack in the 60° angled position when using the ProScrub® option.
- In the back of the lower rack, load pans, casserole dishes, etc. with the soiled surfaces facing the ProScrub® spray jets and resting on the last row of tines in the angled position.
- Only one row of items may face the ProScrub® spray jets. Stacking, overlapping or nesting items will keep the ProScrub® spray jets from contacting all of the surfaces.
- When using ProScrub® Upper place tall or oddly shaped glasses or bottles in the front corners of the upper rack face down. It is best to load these items in between rows of tines.

### Silverware Basket

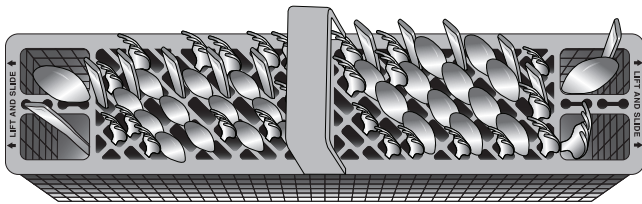

#### Silverware basket lids:

Use silverware basket lids to provide optimal spacing and best cleaning performance.

**NOTE:** If your silverware does not fit into the designated slots, push tabs inward on either end and lift lid off of the silverware baskets. Mix silverware types to keep them separated. Load knives down, forks up, and alternate spoons for best cleaning results.

### Easy To Remove Third Level Rack (on some models)

If additional space is needed in the upper rack, the third level rack can easily be removed.

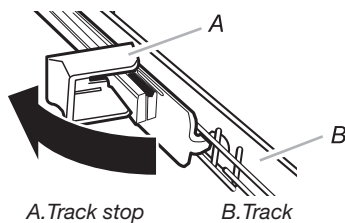

To remove, fully extend rack until it stops. Then, open the track stops on each side and lift to remove.

Low profile items such as serving utensils and silverware may be loaded on the third level rack.

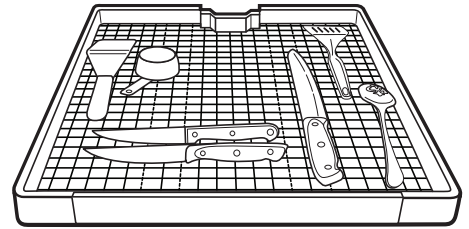

### SURE-HOLD® Cup and Stemware Holder

Fold down the extra shelf on the left-hand or right-hand side of the upper level rack to hold additional cups, stemware or long items such as utensils and spatulas.

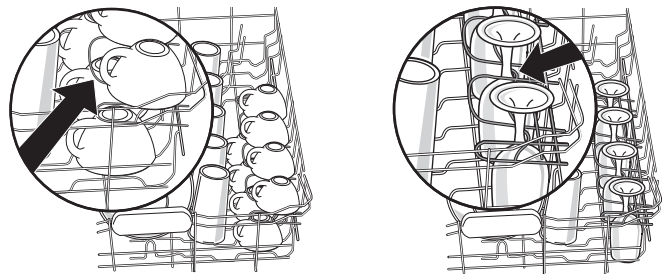

### FLEXI-FOLD DOWN™ Flexible Tines

The row of tines on the left-hand and right-hand sides of the top rack can be adjusted to make room for a variety of dishes.

#### To adjust the fold-down tines:

1. Grasp the tip of the tine that is in the tine holder.
2. Gently push the tine out of the holder.
3. Lay the tines down, toward the center of the rack.

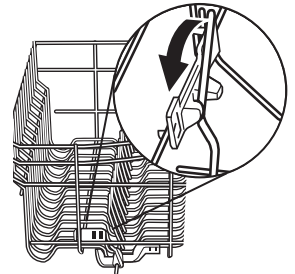

**NOTE:** The bottom rack may also have 1 or 2 rows of flexible tines located in the back of the rack. Follow the same instructions to adjust.

### Premium Adjustable 2-Position Top Rack

You can raise or lower the top rack to fit tall items in either the top or bottom rack. Adjusters are located on each side of the top rack. Each adjuster has 2 preset positions.

To raise the rack, press both rack adjusters and lift the rack until it is in the up position and level.

To lower the rack, press both rack adjusters and slide the rack to its down position and level.

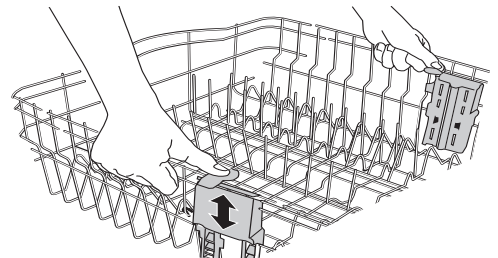



### Sliding Bowl Tines (on some models)

Sliding lower-rack tines that move left or right to fit your dishes. You can use this feature to fit larger items like cereal bowls or other odd shaped items.

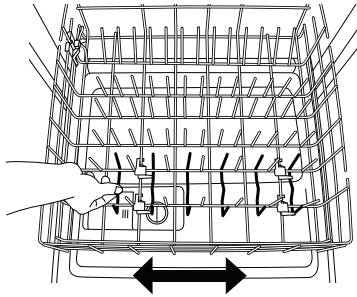

### CULINARY CADDY® Utensil Basket (on some models)

Use the utensil basket to hold specialty cooking utensils (serving spoons, spatulas, and similar items), or overflow silverware items.

The basket hangs on the bottom rack in the right-hand corner. Load the basket while it is on the bottom rack or remove the basket for loading on a counter or table.

**NOTE:** Spin the spray arms. Be sure items in the basket do not stop the rotation of the spray arms.

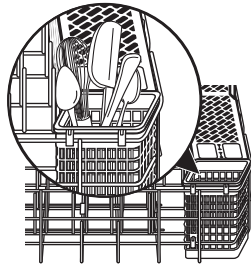

### Dynamic Lower Spray Arm (on some models)

The Dynamic Lower Spray Arm is motor driven and will not spin unless the dishwasher is running.

The motor assures just the right spin for thorough and effective cleaning.

**NOTE:** If the spray arm becomes blocked for any reason during the cycle, you may hear a ticking sound. Open the dishwasher and remove the blockage. Press START/RESUME and close the door to continue the cycle.

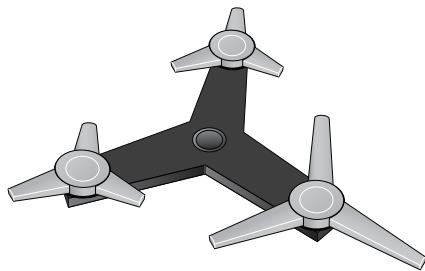

### Removable Top Rack

The removable top rack allows you to wash larger items such as pots, roasters, and cookie sheets in the bottom rack.

**IMPORTANT:** Remove dishes prior to removing the top rack from the dishwasher.

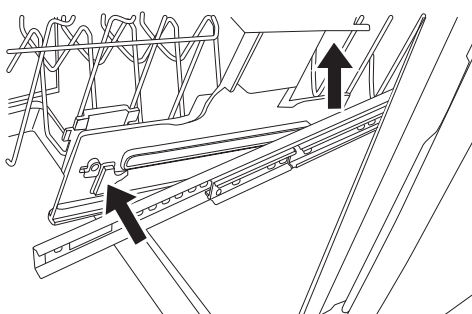

#### To remove the rack:

To gain access to the removable tabs on the tracks/rails, pull the upper rack forward about halfway out of the tub.

On one side, press the tab on the track in and pull up the front end of the rack out of the track. Then repeat this step on the other side to completely remove the front end of the rack.

Then remove the rack by pulling the back end out using a forward and upward motion.

#### To replace the rack:

Pull the tracks forward about halfway out of the tub.

Along the sides of the racks are round attachment tabs. Align the rack's back end attachment tabs with the cutout in the track. Push down into place.

Pull the tracks completely out, and align the rack's front end attachment tabs with the cutout in the track. Push down into place. You will hear a snap when the front end of the rack is secured into place on each side.

### Using the Bottle Wash Feature (on some models)

Up to 6 sports bottles, baby bottles or other narrow items may be washed in the upper rack with this feature.

#### To wash bottles:

1. Select BOTTLE WASH on the control panel.
2. Flip up any or all six of the nozzles just far enough to fit inside your particular item.
3. Securely place items over the nozzles.

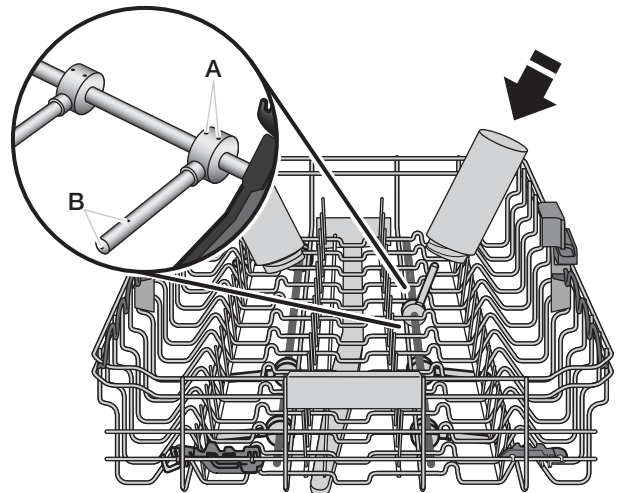

A. Water flows through these holes when the nozzle is flipped down.

B. Water flows through these holes when the nozzle is flipped up.

When you do not need to wash bottles, flip the nozzles down until they stop.

### Interior Lighting (on some models)

On models with a window, interior lighting will automatically come on for 10 minutes when the cycle completes. For all models with interior lighting the lights will come on when the door is opened and will shut off when the door is shut or after 10 minutes of inactivity.

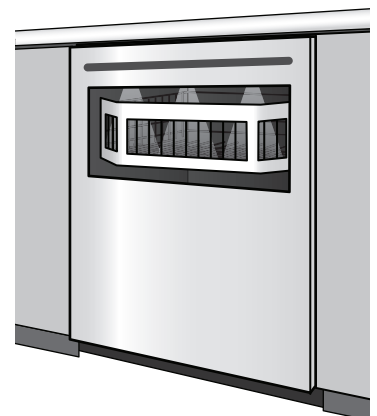

## Filtration System

(for models with EQ filtration system)

Your dishwasher has the latest technology in dishwasher filtration. This triple filtration system minimizes sound and optimizes water and energy conservation while providing superior cleaning performance. Throughout the life of your dishwasher, the filter will require maintenance to sustain peak cleaning performance.

The triple filter system consists of 2 parts, an upper filter assembly and a lower filter.

- The upper filter assembly keeps oversized items and foreign objects, along with very fine food particles, out of the pump.
- The lower filter keeps food from being recirculated onto your dishware.

The filters may need to be cleaned when:

- Visible objects or soils are on the Upper Filter Assembly.
- There is degradation in cleaning performance (that is, soils still present on dishes).
- Dishes feel gritty to the touch.

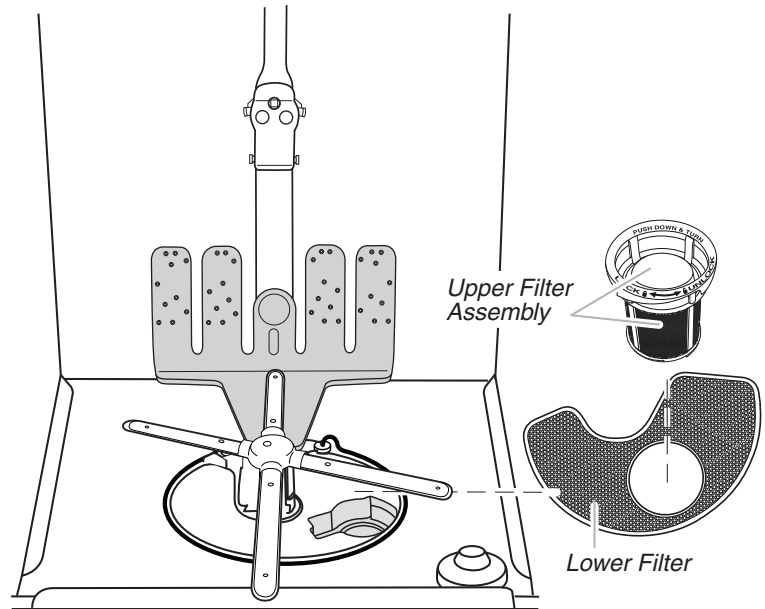

It is very easy to remove and maintain the filters. The chart below shows the recommended cleaning frequency.

### RECOMMENDED TIME INTERVALS TO CLEAN YOUR FILTER

Number of Loads Per Week	If you wash before loading	If you scrape and rinse before loading	If you only scrape before loading*	If you do not scrape or rinse before loading
1-3	Once per year	Once per year	Twice per year	Every two months
4-7	Once per year	Once per year	Twice per year	Once per month
8-12	Once per year	Twice per year	Every three months	Every two weeks
13-14	Once per year	Twice per year	Every three months	Once per week

\*Manufacturer's recommendation: This practice will conserve the water and energy that you would have used to prepare your dishes. This will also save you time and effort.

### Very Hard Water

If you have hard water (above 15 grains), clean your filter at least once per month. Building up of white residue on your dishwasher indicates hard water. For tips on removing spots and stains, see "Troubleshooting" section.

### Filter Removal Instructions

1. Turn the Upper Filter Assembly  $\frac{1}{4}$  turn counter-clockwise and lift out.
2. Grasp the Lower Filter in the circular opening, lift slightly, and pull forward to remove.
3. Clean the filters as shown below.

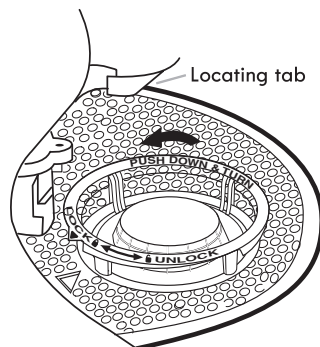

To remove Upper Filter Assembly

### Cleaning Instructions

**IMPORTANT:** Do not use wire brush, scouring pad, etc., as they may damage the filters.

Rinse filter under running water until most soils are removed. If you have hard-to-remove soils or calcium deposits from hard water, a soft brush may be required.

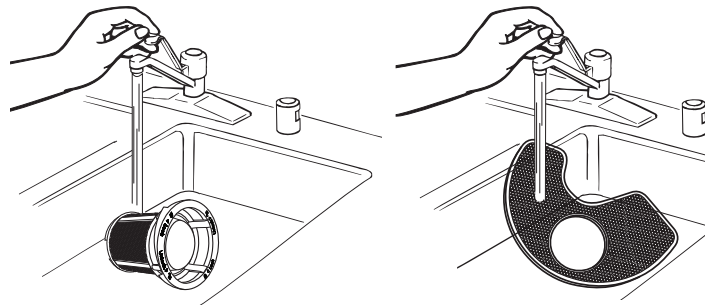

## Filter Reinstallation Instructions

1. Noting the previous illustrations, place the Lower Filter under the Locating Tabs in the bottom of the dishwasher so the round opening for the Upper Filter Assembly lines up with the round opening in the bottom of the tub.

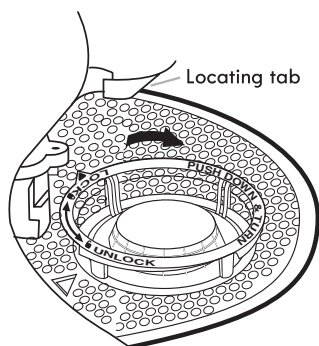

To replace Upper Filter Assembly

2. Insert the Upper Filter Assembly into the circular opening in the Lower Filter.
3. Slowly rotate the filter clockwise until it drops into place. Continue to rotate until the filter is locked into place. If the filter is not fully seated (still turns freely), continue to turn the filter clockwise until it drops and locks into place.

**NOTE:** The Upper Filter Assembly arrow does not have to align with the arrow in the Lower Filter as long as the filter is locked.

**IMPORTANT:** To avoid damage to dishwasher, do not operate your dishwasher without the filters properly installed. Be sure the Lower Filter is securely in place and the Upper Filter Assembly is locked into place. If the Upper Filter Assembly turns freely, it is not locked into place.

---

## Dishwasher Care

---

### Cleaning

#### Cleaning The Exterior

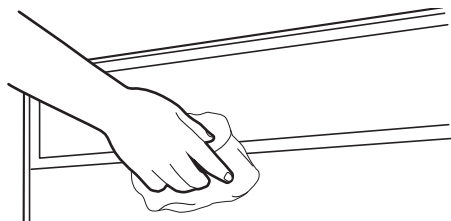

In most cases, regular use of a soft, damp cloth or sponge and a mild detergent is all that is necessary to keep the outside of your dishwasher looking nice and clean. If your dishwasher has a stainless steel exterior, a stainless steel cleaner is recommended, such as affresh<sup>®</sup>† Stainless Steel Cleaner.

---

#### Cleaning The Interior

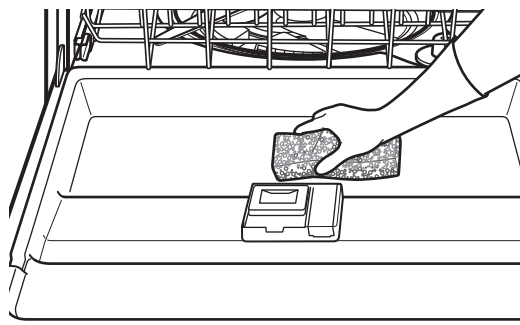

Hard water minerals can cause a white film to build up on the inside surfaces, especially just beneath the door area.

Do not clean the dishwasher interior until it has cooled. You may want to wear rubber gloves. Do not use any type of cleanser other than dishwasher detergent because it may cause foaming or sudsing.

#### Removal of Hard Water/Filming:

We recommended to use a monthly maintenance product such as affresh<sup>®</sup> Dishwasher Cleaner.

- Load your dishwasher (preferably with dishes affected by filming/ hard water).
- Place tablet in main wash compartment of detergent dispenser.
- Select the cycle/option best for heavily soiled dishes and start the dishwasher.

#### To Manually Clean Interior:

Make a paste with powdered dishwasher detergent on a damp sponge and clean.

**OR**

Use liquid automatic dishwasher detergent and clean with a damp sponge.

**OR**

See the vinegar rinse procedure in “Cloudy or spotted dishware (and hard water solution)” in the “Troubleshooting” section.

**NOTE:** Run a normal cycle with dishwasher detergent after cleaning the interior.

†<sup>®</sup> affresh is a registered trademark of Whirlpool, U.S.A.

---

## Cleaning Advanced Racks (on some models)



If you would like to clean hard water filming or other soil buildups from the interior surfaces of the dishwasher, we recommend using a monthly maintenance product such as affresh® Dishwasher Cleaner. If you desire routine cleaning, use a soft damp cloth.

---

## Drain Air Gap

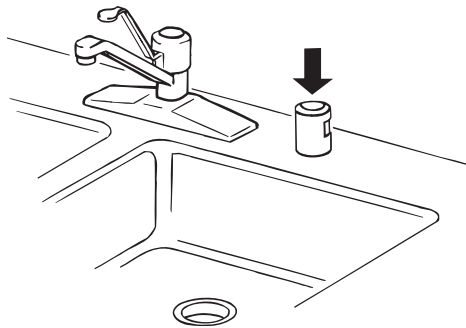

Some state or local plumbing codes require the addition of a drain air gap between a built-in dishwasher and the home drain system. Check the drain air gap when your dishwasher is not draining well.

The drain air gap is usually located on top of the sink or countertop near the dishwasher.

**NOTE:** The drain air gap is an external plumbing device that is not part of your dishwasher. The warranty provided with your dishwasher does not cover service costs directly associated with the cleaning or repair of the external drain air gap.

---

## To clean the drain air gap

Clean the drain air gap periodically to ensure proper drainage of your dishwasher. With most types, you lift off the chrome cover. Unscrew the plastic cap. Then check for any soil buildup. Clean if necessary.

---

## Vacation or Extended Time Without Use

### To reduce the risk of property damage

- If you will not be using the dishwasher during the summer months, turn off the water and power supply to the dishwasher.
- Make sure the water supply lines are protected against freezing conditions. Ice formations in the supply lines can increase water pressure and damage your dishwasher or home. Damage from freezing is not covered by the warranty.
- When storing your dishwasher in the winter, avoid water damage by having your dishwasher winterized by authorized service personnel.

## Troubleshooting

First try the solutions suggested here. If you need further assistance or more recommendations that may help you avoid a service call, refer to the warranty page in this manual and scan the code with your mobile device, or visit <http://kitchenaid.custhelp.com>. In Canada, visit [www.kitchenaid.ca](http://www.kitchenaid.ca) (website may not be compatible with some mobile devices).

Contact us by mail with any questions or concerns at the address below:

In the U.S.A.:

KitchenAid Brand Home Appliances  
Customer eXperience Center  
553 Benson Road  
Benton Harbor, MI 49022-2692

In Canada:

KitchenAid Brand Home Appliances  
Whirlpool Canada LP  
200 – 6750 Century Ave.  
Mississauga, Ontario L5N 0B7

Please include a daytime phone number in your correspondence.

PROBLEM	SOLUTION
<b>DISHWASHER DOES NOT RUN</b>	<p><b>NOTE:</b> It is normal for the dishwasher to repeatedly pause several times during a cycle.</p> <p>If the Start/Resume light is blinking, close the door and push START/RESUME.</p> <p>Be sure the door is closed and latched.</p> <p>Be sure you have disabled Sleep Mode by pressing either START/RESUME or CANCEL, or opening and closing the door before selecting your cycle/option.</p> <p>Check that there is not an interference with large casserole dishes and the wash system at the back of the dishwasher. Adjust loading as necessary to ensure door is closed and latched.</p> <p>Be sure you have selected a cycle. See “Cycle and Option Descriptions” section.</p> <p>Be sure there is power to the dishwasher. A circuit breaker or fuse may have tripped.</p> <p>If lights other than Start/Resume blink and the unit will not run, you will need to call for service.</p>
<b>DETERGENT REMAINS IN THE DISPENSER OR TABLET IS ON BOTTOM OF TUB</b>	<p>Check for dishware such as cookie sheets, cutting boards, or large containers, etc., that may be blocking the detergent dispenser from opening properly.</p> <p>Be sure your detergent is fresh and lump free.</p> <p>Be sure the cycle has completed (the Clean light is on). If it has not completed, you will need to resume the cycle by closing the door and pressing START/RESUME.</p>
<b>CYCLE RUNS TOO LONG</b>	<p><b>NOTES:</b></p> <ul style="list-style-type: none"><li>■ To use less water and reduce energy consumption you will encounter cycles that typically run for up to 3 hours.</li><li>■ A water heater setting of 120°F (49°C) is best, the dishwasher will delay longer while heating cooler water.</li><li>■ Some options will add time to the cycle. See “Cycle and Option Descriptions” section. The ProDry™ option adds approximately ½ hour.</li></ul> <p>Try the Express Wash cycle.</p> <p>Run the hot water at a faucet close to the dishwasher before starting the cycle.</p>
<b>DISHWASHER NOT DRYING</b>	<p><b>NOTE:</b> Plastic and items with nonstick surfaces are difficult to dry because they have a porous surface which tends to collect water droplets. Towel drying may be necessary.</p> <p>Use of rinse aid along with the ProDry™ option is needed for proper drying.</p> <p>Proper loading of items can affect drying. See specific loading instructions within this guide.</p> <p>Glasses and cups with concave bottoms hold water. This water may spill onto other items when unloading.</p> <ul style="list-style-type: none"><li>■ Unload the bottom rack first.</li><li>■ Locate these items on the more slanted side of the rack for improved results.</li></ul>
<b>WILL NOT FILL</b>	<p>Be sure the water is turned on to the dishwasher.</p> <p>Check that the Overfill Protection Float is free from obstructions. See “Parts and Features”.</p> <p>Check for suds in the dishwasher. If foam or suds are detected, the dishwasher may not operate properly or may not fill with water. See “Blinking Lights” in “Troubleshooting” section.</p>
<b>WATER REMAINS IN THE TUB/WILL NOT DRAIN</b>	<p>Be sure the cycle has completed (the Clean light is on). If it has not, you will need to resume the cycle by pressing START/RESUME and closing the door; or you can press CANCEL/DRAIN to cancel the current cycle.</p> <p>If dishwasher is connected to a food waste disposer, be sure the knockout plug has been removed from the disposer inlet.</p> <p>Check for kinks in the drain hose.</p> <p>Check for food obstructions in the drain or disposer.</p> <p>Check your house fuse or circuit breaker.</p>



PROBLEM	SOLUTION
<b>HARD WATER (WHITE RESIDUE ON DISHWASHER INTERIOR OR GLASSWARE)</b>	<p><b>NOTE:</b> Extremely hard water mineral deposits can cause damage to your dishwasher and make it difficult to achieve good cleaning. A water softener is strongly recommended if your hardness is 15 grains or more. If a water softener is not installed, the following steps may help:</p> <p>Use a commercial cleaner designed for dishwashers once per month.</p> <p>Always use a rinse aid.</p> <p>Always use a high-quality, fresh detergent.</p> <p>Use a detergent booster/water softener additive designed for dishwashers.</p> <p>See “Cleaning the interior” section to use an automatic dishwasher cleaner.</p>
<b>ODORS</b>	<p><b>NOTE:</b> If the dishwasher is not used daily, you can run a rinse cycle with the partial load until a full load is ready to run, or use the Top Rack Only option (on some models) for partial loads.</p> <p>Run a vinegar rinse through the dishwasher by putting 2 cups (500 mL) of white vinegar in an upright glass measuring cup in the lower rack. Run a normal cycle with the ProDry™ option turned off. Do not use detergent.</p> <p>The dishwasher may not be draining properly, see “Water Remains In The Tub/Will Not Drain” in the “Troubleshooting” section.</p>
<b>NOISY</b>	<p><b>NOTES:</b></p> <ul style="list-style-type: none"> <li>■ Surging sounds can occur periodically throughout the cycle while the dishwasher is draining.</li> <li>■ Normal water valve hissing may be heard periodically.</li> <li>■ A normal snap sound may be heard when the detergent dispenser opens during the cycle and when the door is opened at the end of the cycle.</li> <li>■ Improper installation will affect noise levels.</li> </ul> <p>A thumping sound may be heard if items extend beyond the racks and interfere with the wash arms. Readjust the dishware and resume the cycle.</p>
<b>FOOD SOILS REMAIN ON DISHES</b>	<p>Be sure the dishwasher is loaded correctly. Improper loading can greatly decrease the washing performance. See “Dishwasher Use” section.</p> <p>Check filter to ensure it is properly installed. Clean it if needed. See “Cleaning Instructions” in “Filtration System” section.</p> <p>Select the proper cycle and option for the type of soils. The ProWash™ or the Tough cycle with the ProScrub® (on some models) option can be used for tougher loads.</p> <p>Be sure the incoming water temperature is at least 120°F (49°C).</p> <p>Use the proper amount of fresh detergent. More detergent is needed for heavier-soiled loads and hard water conditions.</p> <p>Scrape food from dishes prior to loading (do not prerinse).</p>
<b>DISHES DIRTY/SUDS IN DISHWASHER/CYCLE NOT COMPLETE</b>	<p>If foam or suds are detected by the dishwasher sensing system, the dishwasher may not operate properly or may not fill with water.</p> <p>Suds can come from:</p> <ul style="list-style-type: none"> <li>■ Using the incorrect type of detergent, such as dish detergent for hand washing dishes, laundry detergent, or hand soap.</li> <li>■ Not replacing the rinse aid dispenser cap after filling (or refilling) the rinse aid.</li> <li>■ Using an excessive amount of dishwasher detergent.</li> </ul> <p>Call for service.</p> <p>If no water was present in the machine at any time during a heated wash cycle, the cycle will end and the Clean LED will not come on. See “Will Not Fill” in the “Troubleshooting” section.</p>
<b>SANITIZED LIGHT BLINKING</b>	<p>If the sanitized light is blinking, the load is <i>NOT</i> sanitized. The cycle was interrupted in the final rinse, or the temperature for your water heater is set too low. Set your water heater to 120°F (49°C).</p>
<b>DAMAGE TO DISHWARE</b>	<p>Improper loading can cause dishes to become chipped or damaged. See specific loading instructions within this guide.</p>
<b>BLINKING LIGHTS</b>	<p>Blinking LED(s) will occur when the cycle is paused or when the cycle has been interrupted by opening the door. In this case, the Start/Resume button LED, the Cycle Status Indicator LED(s), and the countdown bars on the Cycle Status Display all blink together to indicate that attention is needed. See “Start or Resume a Cycle” in the “Dishwasher Use” section.</p> <p>Blinking LED's can also occur when certain errors have been detected. In this case, the Clean/Complete LED will blink 4 times in a row with a pause in between each set of blinks. When this error occurs, the controls will lock out and not allow another cycle to be started.</p> <p>Call for service.</p>

PROBLEM	SOLUTION
<b>CLOUDY OR SPOTTED DISHWARE (AND HARD WATER SOLUTION)</b>	<p><b>NOTES:</b></p> <ul style="list-style-type: none"> <li>■ Liquid rinse aid is necessary for drying and to reduce spotting.</li> <li>■ Use the correct amount of detergent.</li> </ul> <p>Confirm that the cloudiness is removable by soaking the item in white vinegar for 5 minutes. If the cloudiness disappears, it is due to hard water. Adjust the amount of detergent and rinse aid. See “Hard Water (White Residue On Dishwasher Interior Or Glassware)” in the “Troubleshooting” section. If it does not come clear, it is due to etching (see below).</p> <p>Be sure the incoming water temperature is set at 120°F (49°C).</p> <p>Try using the High Temp and Sani Rinse options.</p> <p>To remove spotting, run a vinegar rinse through the dishwasher.</p> <ul style="list-style-type: none"> <li>■ Wash and rinse the affected dishware and load into dishwasher. Remove all silverware and metal items. Put 2 cups (500 mL) of white vinegar in a glass measuring cup in the lower rack. Run a normal cycle with the ProDry™ option turned off. No detergent is needed.</li> </ul>
<b>ETCHING (PERMANENT CLOUDINESS)</b>	<p>This is an erosion of the surface of the glassware and can be caused by a combination of: water that is too hot, from using too much detergent with soft water or by pre-washing. Detergent needs food soil to act upon. If etching has occurred, the glassware is permanently damaged. To avoid further etching, adjust the detergent amount to match the water hardness, stop pre-washing, and use water heating options only when incoming water temperature is below 120°F (49°C).</p>
<b>LEAKING WATER</b>	<p>Be sure dishwasher has been installed properly and is level.</p> <p>Suds can cause the dishwasher to overflow. Measure the detergent accurately and use only detergents designed for use in a dishwasher. Less detergent is needed in soft water. Try another brand of detergent if sudsing continues.</p> <p>To avoid rinse aid leaking from the dispenser, be sure the lid is securely attached and avoid overfilling.</p>
<b>TUB IS DISCOLORED</b>	<p><b>NOTES:</b></p> <ul style="list-style-type: none"> <li>■ High iron content in the water can discolor the tub.</li> <li>■ Tomato-based foods can discolor the tub or dishware.</li> <li>■ A citrus-based cleaner can be used to clean.</li> </ul>

# KITCHENAID® DISHWASHER LIMITED WARRANTY

ATTACH YOUR RECEIPT HERE. PROOF OF PURCHASE IS REQUIRED TO OBTAIN WARRANTY SERVICE.

Please have the following information available when you call the Customer eXperience Center:

- Name, address and telephone number
- Model number and serial number
- A clear, detailed description of the problem
- Proof of purchase including dealer or retailer name and address

## IF YOU NEED SERVICE:

1. Before contacting us to arrange service, please determine whether your product requires repair. Some questions can be addressed without service. Please take a few minutes to review the Troubleshooting or Problem Solver section of the Use and Care Guide, scan the QR code on the right to access additional resources, or visit <http://kitchenaid.custhelp.com>.
2. All warranty service is provided exclusively by our authorized KitchenAid Service Providers. In the U.S. and Canada, direct all requests for warranty service to:

**KitchenAid Customer eXperience Center**

**In the U.S.A., call 1-800-422-1230. In Canada, call 1-800-807-6777.**

If outside the 50 United States or Canada, contact your authorized KitchenAid dealer to determine whether another warranty applies.



<http://kitchenaid.custhelp.com>

## LIFETIME LIMITED WARRANTY

### WHAT IS COVERED

#### FIRST YEAR LIMITED WARRANTY (PARTS AND LABOR)

For one year from the date of purchase, when this major appliance is installed, operated and maintained according to instructions attached to or furnished with the product, KitchenAid brand of Whirlpool Corporation or Whirlpool Canada, LP (hereafter "KitchenAid") will pay for factory specified replacement parts and repair labor to correct defects in materials or workmanship that existed when this major appliance was purchased, or at its sole discretion replace the product. In the event of product replacement, your appliance will be warranted for the remaining term of the original unit's warranty period.

#### SECOND THROUGH FIFTH YEAR LIMITED WARRANTY (CERTAIN COMPONENT PARTS ONLY - LABOR NOT INCLUDED)

In the second through fifth years from the date of original purchase, when this major appliance is installed, operated and maintained according to instructions attached to or furnished with the product, KitchenAid will pay for factory specified parts for the following components to correct non-cosmetic defects in materials or workmanship in these parts that prevent function of this major appliance and that existed when this major appliance was purchased. This is a limited 5-year warranty on the below named parts only and does not include repair labor.

- Nylon dish racks
- Electronic controls

#### LIFETIME LIMITED WARRANTY (STAINLESS STEEL TUB AND INNER DOOR LINER ONLY)

For the lifetime of the product from the date of original purchase, when this major appliance is installed, operated and maintained according to instructions attached to or furnished with the product, KitchenAid will pay for factory specified parts and repair labor for the following components to correct non-cosmetic defects in materials or workmanship that existed when this major appliance was purchased:

- Stainless steel tub
- Inner door liner

**YOUR SOLE AND EXCLUSIVE REMEDY UNDER THIS LIMITED WARRANTY SHALL BE PRODUCT REPAIR AS PROVIDED HEREIN.** Service must be provided by a KitchenAid designated service company. This limited warranty is valid only in the United States or Canada and applies only when the major appliance is used in the country in which it was purchased. This limited warranty is effective from the date of original consumer purchase. Proof of original purchase date is required to obtain service under this limited warranty.

### WHAT IS NOT COVERED

1. Commercial, non-residential or multiple-family use, or use inconsistent with published user, operator or installation instructions.
2. In-home Instruction on how to use your product
3. Service to correct improper product maintenance or installation, installation not in accordance with electrical or plumbing codes or correction of household electrical or plumbing (i.e. house wiring, fuses or water inlet hoses).
4. Consumable parts (i.e. light bulbs, batteries, air or water filters, etc.).
5. Defects or damage caused by the use of non-genuine KitchenAid parts or accessories.
6. Damage from accident, misuse, abuse, fire, floods, acts of God or use with products not approved by KitchenAid.
7. Repairs to parts or systems to correct product damage or defects caused by unauthorized service, alteration or modification of the appliance.
8. Cosmetic damage including scratches, dents, chips, and other damage to appliance finishes unless such damage results from defects in materials and workmanship and is reported to KitchenAid within 30 days.
9. Discoloration, rust or oxidation of surfaces resulting from caustic or corrosive environments including but not limited to high salt concentrations, high moisture or humidity or exposure to chemicals.
10. Pick-up or delivery. This product is intended for in-home repair.
11. Travel or transportation expenses for service in remote locations where an authorized KitchenAid servicer is not available.
12. Removal or reinstallation of inaccessible appliances or built-in fixtures (i.e. trim, decorative panels, flooring, cabinetry, islands, countertops, drywall, etc.) that interfere with servicing, removal or replacement of the product.
13. Service or parts for appliances with original model/serial numbers removed, altered or not easily determined.

**The cost of repair or replacement under these excluded circumstances shall be borne by the customer.**

## DISCLAIMER OF IMPLIED WARRANTIES

IMPLIED WARRANTIES, INCLUDING ANY IMPLIED WARRANTY OF MERCHANTABILITY OR IMPLIED WARRANTY OF FITNESS FOR A PARTICULAR PURPOSE, ARE LIMITED TO ONE YEAR OR THE SHORTEST PERIOD ALLOWED BY LAW. Some states and provinces do not allow limitations on the duration of implied warranties of merchantability or fitness, so this limitation may not apply to you. This warranty gives you specific legal rights, and you also may have other rights that vary from state to state or province to province.

## DISCLAIMER OF REPRESENTATIONS OUTSIDE OF WARRANTY

KitchenAid makes no representations about the quality, durability, or need for service or repair of this major appliance other than the representations contained in this warranty. If you want a longer or more comprehensive warranty than the limited warranty that comes with this major appliance, you should ask KitchenAid or your retailer about buying an extended warranty.

## LIMITATION OF REMEDIES; EXCLUSION OF INCIDENTAL AND CONSEQUENTIAL DAMAGES

**YOUR SOLE AND EXCLUSIVE REMEDY UNDER THIS LIMITED WARRANTY SHALL BE PRODUCT REPAIR AS PROVIDED HEREIN.** KITCHENAID SHALL NOT BE LIABLE FOR INCIDENTAL OR CONSEQUENTIAL DAMAGES. Some states and provinces do not allow the exclusion or limitation of incidental or consequential damages, so these limitations and exclusions may not apply to you. This warranty gives you specific legal rights, and you also may have other rights that vary from state to state or province to province.

11/14