

Check that you have all your parts and accessories.

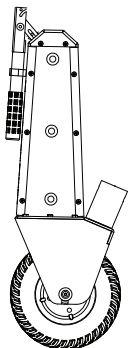

XL UNIT

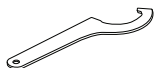

SPANNER WRENCH



DRILL ATTACHMENT



ROTATION PIN



2" BALL



2-5/16" BALL CONVERTER

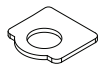

COUPLING PLATE



BALL BASE



HAND CRANK



MANUAL



TRAILER VALET XL w/ BALL MOUNT

Quick Start Guide

Rev 12.11.24
TVXLBOTH

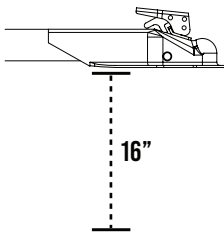

1. Check trailer height and raise the trailer tongue to where the frame is about 16 inches off the ground to give adequate space to attach the dolly.

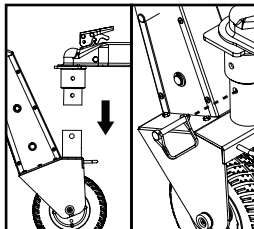

4. Using your trailer jack, lower the hitch towards the unit's rotating coupler and attach Rotation Pin to secure.

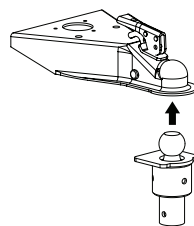

2. Attach Hitch Ball w/ Ball Base and Coupling Plate to coupler.

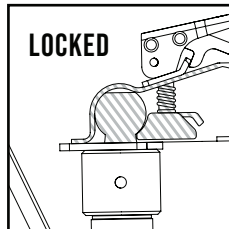

5. Make sure the XL is securely tightened and not rocking.

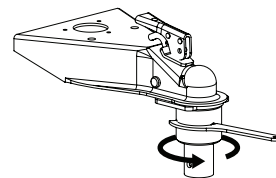

3. Use Spanner Wrench and tighten that base!

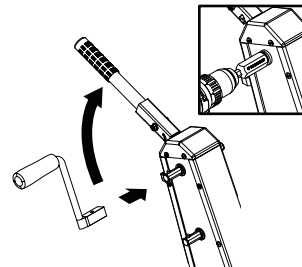

6. Attach the Hand Crank or Drill Attachment, lift the steering handle to disengage brakes, and start moving!

IMPORTANT SAFETY INFORMATION

For information and assistance, please visit our support page at TrailerValet.com or give us a call at (844) 846-9344. Scan the QR code to the right for detailed safety and usage information.





TRAILER VALET XL w/ MOUNT BRACKET

Quick Start Guide

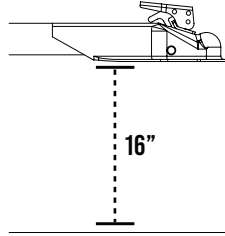

1. Check trailer height and raise the trailer tongue to where the frame is about 16 inches off the ground to give adequate space to attach the dolly.

2. Install the XL Mount Bracket to your trailer frame.

3. Attach Mounting Joint to the rotating coupler on the XL unit using the Rotation Pin.

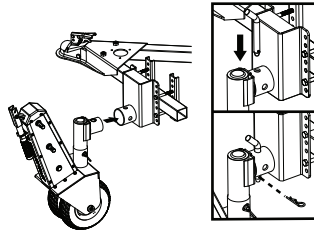

4. Connect XL unit to Mount Bracket and secure with stop pin.

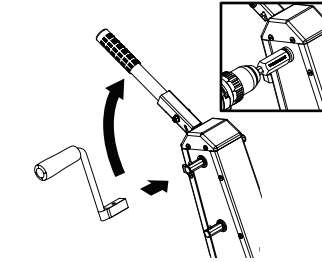

5. Attach the Hand Crank or Drill Attachment, lift the steering handle to disengage brakes, and start moving!

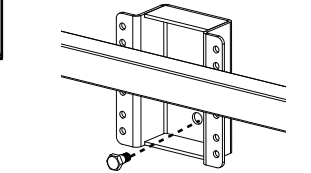

6. **OPTIONAL:** Lock with Security Bolt located in the back of the bracket to prevent removal.

<p>Check that you have all your parts and accessories.</p>		<p>SECURITY BOLT</p>	<p>ROTATION PIN</p>
<p>XL UNIT</p>	<p>HAND CRANK</p>	<p>DRILL ATTACHMENT</p>	
	<p>MANUAL</p>	<p>BRACKET CLAMPS (2X)</p>	
	<p>FOAM STRAP</p>		
<p>MOUNT BRACKET</p>	<p>BRACKET BOLTS (4X)</p>		
<p>MOUNTING JOINT</p>	<p>STOP PIN</p>		

IMPORTANT SAFETY INFORMATION

For information and assistance, please visit our support page at TrailerValet.com or give us a call at (844) 846-9344. Scan the QR code to the right for detailed safety and usage information.

