

The 3100 & 3500 Series Aluminum Window Awning

The 3100 Series,
shown here, has support arms

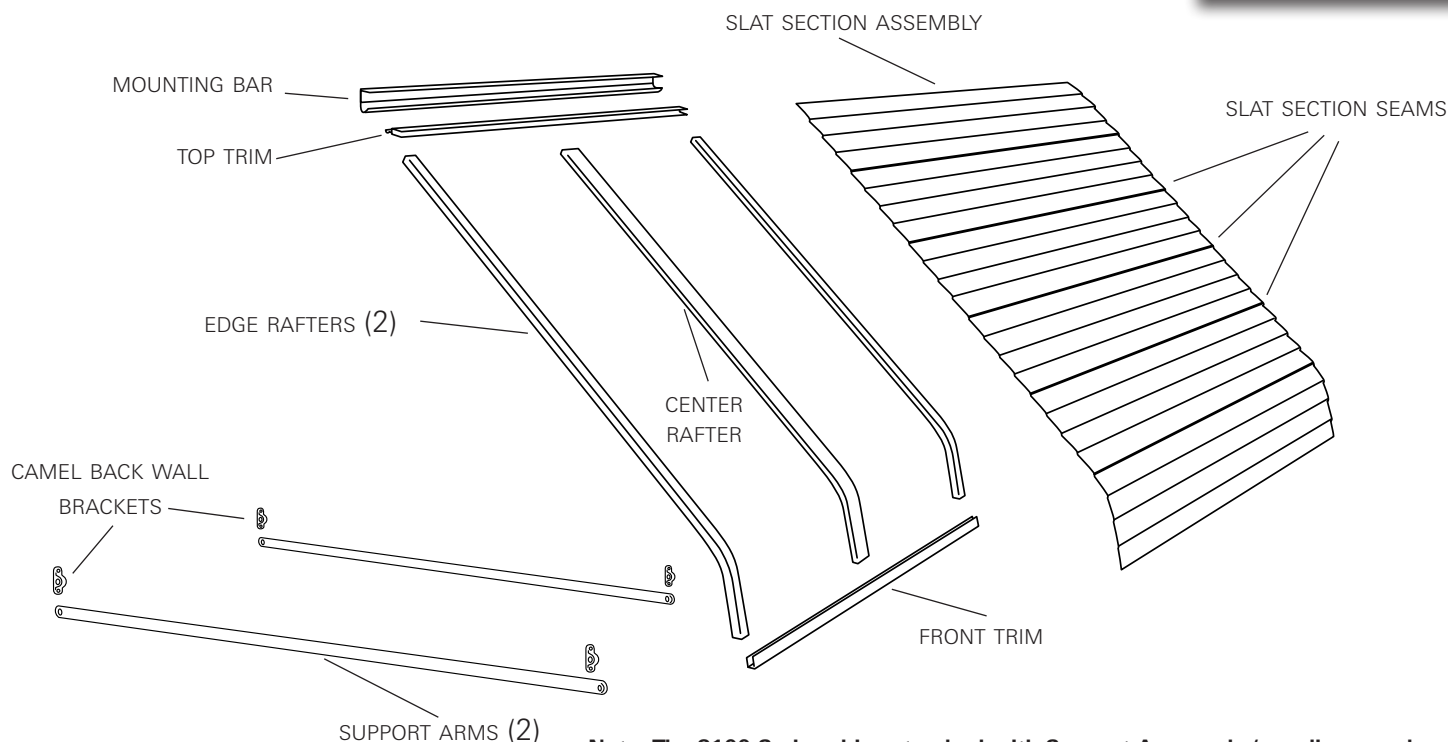

It is our recommendation that you read instructions carefully prior to assembly and installation



Note: The 3100 Series ships standard with Support Arms only (see diagram above)
The 3500 Series ships standard with Sidewings only (see reverse side)

The 3100/3500 Series Parts Check List:

Note: Take inventory of all parts prior to assembly

- | | | | |
|---------------------------------------|--|--|--|
| <input type="checkbox"/> Mounting Bar | <input type="checkbox"/> Edge Rafters (2) | <input type="checkbox"/> Support Arms/Sidewings (2)* | <input type="checkbox"/> Small Screws* |
| <input type="checkbox"/> Top Trim | <input type="checkbox"/> Center Rafter* | <input type="checkbox"/> Camel Back Wall Brackets (2)* | <input type="checkbox"/> Large Screws* |
| <input type="checkbox"/> Front Trim | <input type="checkbox"/> Slat Section Assembly | <input type="checkbox"/> Interlock Clips* | |

*** Quantities & parts may vary
by awning size and model series**

Actual Size End Views of Awning/Canopy parts for easy reference and assembly:



Mounting
Bar



Top
Trim



Front
Trim



Edge
Rafter



Center
Rafter

Required Tools:

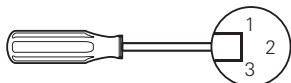

Phillips, Regular & Hex Head
Screw Drivers or Drill Bits

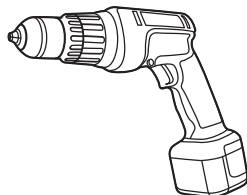

Power Drill

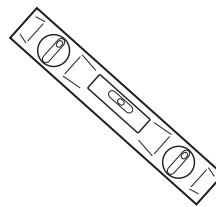

Level

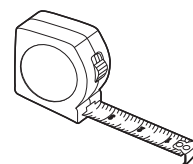

Tape Measure

Assembly Instructions

The 3100-3500 Series Aluminum Window Awning

1

Packed
Hardware

Slat
Section
Assembly

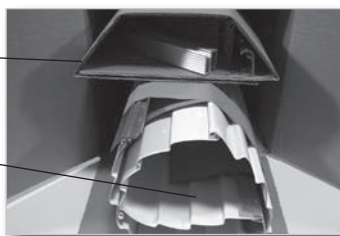

The 3100/3500 Series Aluminum Window Awning is packaged with the **Slat Section Assembly** rolled with the underside of the Awning to the inside of the roll. Keep the underside **up** when laying the awning out for assembly, especially if your awning is white. White is always the underside when ordering colored awnings.

This is very important as you will be assembling the Awning upside down.

2

Top Trim

Front
Trim

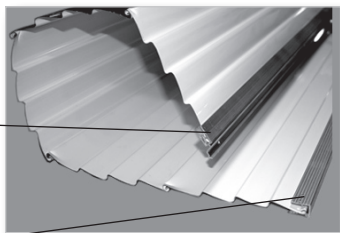

It is important that the Awning is assembled properly so that rain water will not leak through the seams where the slats join.

Note: The **Top Trim** and **Front Trim** are already attached to the Slat Section Assembly.

Remove the parts from the carton, organize and inventory them.

Caution: *Awning parts may have sharp edges.
Use care during assembly.*

3

Top Trim

Edge
Rafter

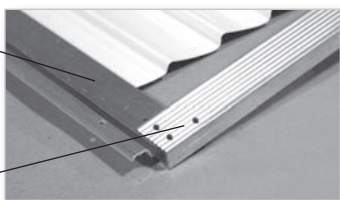

TIP: use the palm of your hand flat on slats pressing down & pulling toward you to help snug them into edge rafter.

Slide the **Top Trim** out from **Slat Section** about 2 inches to provide clearance. Next slide the non-curved end of the **Edge Rafter** onto Top Trim making sure the opposite, curved end, of the Edge Rafter is up.

Next slide both Top Trim and Edge Rafter back toward Slat Section and push Edge Rafter onto Slat Section edge evenly until Slat Section & the Top Trim are completely **FLUSH** into Edge Rafter.

4

Front
Trim

Edge
Rafter

Illustrated
here to show
assembly -
These parts are
NOT flush and
therefore will not
align to fasten
screws

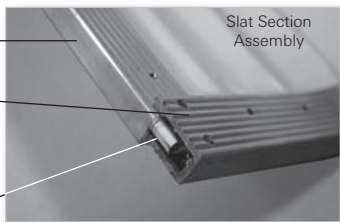

NOTE: it is very important that both ends of the awning; (the top trim and the front trim) along with the slat section are completely flush in the edge rafters to be able to align pre-punched holes for fastening

Now, connect the **Edge Rafter** and Slat Section with the **Front Trim**. Again, Slat Section and Front Trim **MUST** be **FLUSH** in the Edge Rafter. With Slat Section still secured **FLUSH** in Edge Rafter slide Front Trim toward you and flush into the Edge Rafter, aligning pre-punched holes, it will fit snug.

Note: Only the outside edge of the Front Trim and the curled edge of the slat is inserted into the Edge Rafter, as shown in figure 4.

Next, secure **Edge Rafter** in place & secure **Top Trim** and **Front Trim** with small screws in the larger pre-punched holes at **each end** of the Edge Rafter.

5

Edge
Rafter



Next fasten small screws in the **two** larger pre-punched holes along Edge Rafter. (Pairs of **small holes** are for siding connections - sold separately)

Note: Support the underside of the **Slats Section** and apply pressure while fastening screws

Repeat Edge Rafter assembly on the other side.

6

Center
Rafter



Now attach **Center Rafter**.

Align Center Rafter with pre-punched holes in the center of the **Top Trim** first and secure with small screws, then do the same at the other end of the Center Rafter in the center on the **Front Trim** and secure with small screws.

Note: Window Awnings wider than 60" need more than one Center Rafter and will be provided. Pre-punched holes will guide installation of multiple Center Rafters

7

Interlock Clip

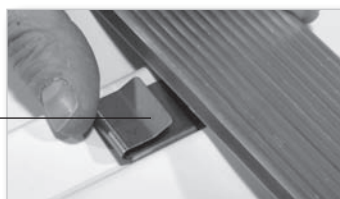

Next install **Interlock Clips** to secure frame to Awning.

Connect Awning Slat Section Assembly to the center rafter frame using interlock clips at each joint **where the slats interlock**. Installing clips is a three-step process: first, find the slat joints, insert the curved part of clip into slat joint, then slide clip onto Center Rafter. Interlock clips are installed on the flat section of the Awning only, not up on the curve. If stubborn, make sure they are straight and parallel with the slat joint.

Installation Instructions with Support Arms - The 3100 Series

1

Caulk

Mounting Bar

Window Frame

Mounting Bar

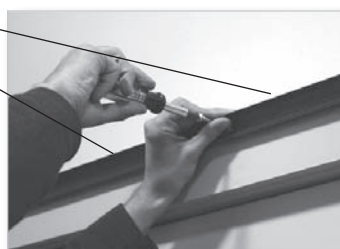

Install **Mounting Bar** and secure with large screws on the window frame **or** in strong sheathing on the house around the window if you measured for placement of your awning on the **outside** of the window frame. In that case install the mounting bar on the house above the window frame.

Be sure the Mounting Bar is level and centered over the opening.



Caulk the top of the Mounting Bar against the house.

2

Camel Back Wall Bracket

Support Arm

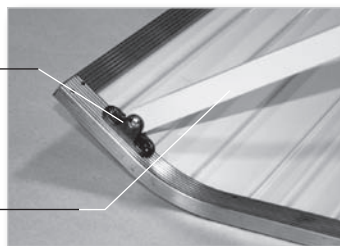

Attach **Camel Back Wall Brackets** (all four) to **Support Arm** ends using machine screws, provided. The head end of the machine screw should be on the outside of the awning when inserted into the bracket. Then attach one end of the support arm with bracket to the Awning with small screws. Repeat this step for the second Support Arm. The two opposite ends with camel back brackets will be attached to the house with larger screws during installation.

3

Mounting Bar

Top Trim Inserted

Small Phillips Screwdriver



Apply a bead of caulking in the trough of the mounting bar prior to installation of the awning's top trim placement into the mounting bar

Align the front of the Awning above the **Mounting Bar** and insert the **Top Trim** (the back portion of the awning) into the Mounting Bar, as shown, (allow Support Arms to rest on the house). Align holes and secure Mounting Bar to Top Trim with small screws from below..

(Front) - Awning Frame Views - (Side)

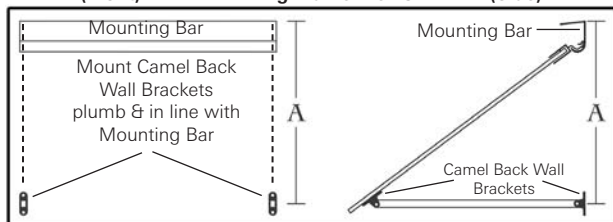

Attach the (2) two loose Camel Back Wall Brackets, temporarily, to the other end of the Support Arms using a machine screws. Before securing to your house please refer to the mounting chart here for model number and correct mounting points for your Awning.

Note: Mounting dimension 'A' is measured from the top of the Mounting Bar to the center of the Camel Back Wall Bracket.

WINDOW AWNING MOUNTING CHART

MODEL NUMBER	4	5	6	7	8
MOUNTING POINT	21 1/2"	25"	30"	33"	37"

Now attach mounting brackets to the house using large screws (provided) making sure the Brackets are secured in solid sheathing at the proper points from the reference chart.

4

Camel Back Wall Bracket

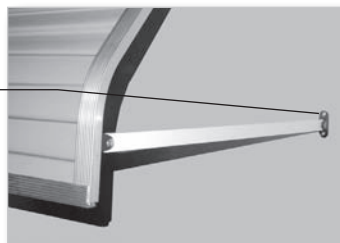

Align **Camel Back Wall Brackets** and secure it to the wall with large screws at the correct mounting point. Making sure they are plumb and square.

Installation is now complete.

See back page for assembly and installation instructions for "Sidewings" if you ordered The 3500 Series Window Awning.



Assembly & Installation Instructions - The 3500 Series with Sidewings

1

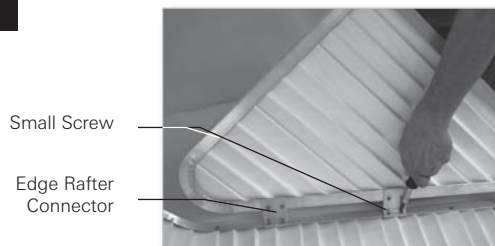

Sidewings will come fully assembled. However, they need to be attached to the **Edge Rafters** of your pre-assembled awning with small screws using the pre-drilled holes.

Please note: Extra Support Arms are included with Awnings in excess of 90 inches wide, depending on the window and the specifications used when the awning was ordered.

2

Please refer to STEP # 1 from Page 3 for Mounting Bar installation instructions and cautions.

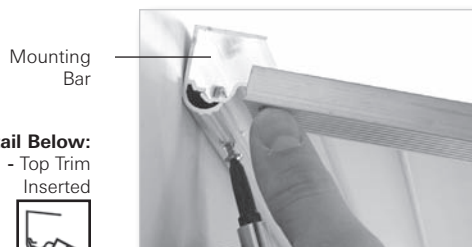

! Apply a bead of caulking in the trough of the mounting bar prior to installation of the awning's top trim placement into the mounting bar

Align the front of the Awning above the **Mounting Bar** and insert the **Top Trim** (the back portion of the awning) into the Mounting Bar, as shown, (allow Support Arms or Sidewings to rest on the house). Align holes and secure Mounting Bar to Top Trim with small screws from below..

3

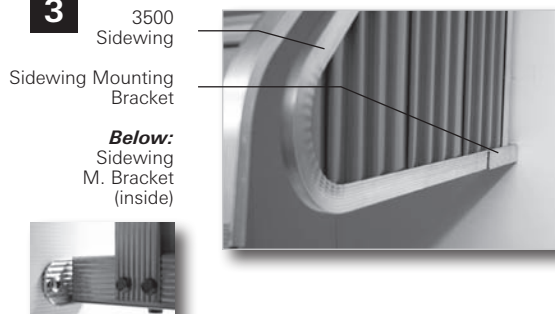

Attach them to the house using the sidewing mounting bracket with large lag screws.

Installation is now complete.

Limited Warranty Information

Futureguard® Awnings and Canopies are manufactured under the highest standards of production, after comprehensive research and development, and will be warranted by Futureguard® to the original purchaser from date of purchase for a period of Five (5) years against the occurrence of manufacturing defects directly resulting in peeling, flaking, blistering or rusting under conditions of normal use and service, subject to the terms and conditions contained in this Limited Warranty.

Futureguard® does not warrant installation nor defects caused by installation. This Limited Warranty does not cover any other defects as specified herein. This Limited Warranty does not cover any other damage or material failure resulting from, but not limited to, normal weathering, oxidation, accidental damage or intentional damage, fire or flood, windblown objects, windstorm, hail, sleet or chemical pollutants, mildew or structural defects, negligent maintenance or misuse or abuse, or any other causes or occurrences beyond the control of Futureguard®.

Normal weathering may cause any surface to oxidize, chalk, gradually fade or accumulate surface dirt or stains due to varying exposures to sunlight, weather or atmospheric conditions. The geographic location, the quality of the atmosphere and other local factors in the area, over which Futureguard® has no control, contribute to the severity of these conditions.

This Limited Warranty is void if incompatible accessory products are installed which cause defects to occur.

The provisions of this Limited Warranty are the full and complete warranty policy extended by Futureguard®.

This Limited Warranty shall be null and void if harmful cleaning compounds are used.

THE WARRANTY STATEMENTS CONTAINED IN THIS LIMITED WARRANTY SET FORTH THE ONLY EXPRESS WARRANTIES EXTENDED BY FUTUREGUARD®, IN LIEU OF ALL OTHER WARRANTIES, AND THE PROVISIONS OF THIS LIMITED WARRANTY SHALL CONSTITUTE THE ENTIRE LIABILITY OF FUTUREGUARD® AND THE PROPERTY OWNER'S EXCLUSIVE REMEDY FOR BREACH OF THIS WARRANTY. FUTUREGUARD® SHALL NOT BE LIABLE TO THE PROPERTY OWNER FOR INCIDENTAL OR CONSEQUENTIAL DAMAGES OF ANY KIND FOR BREACH OF ANY EXPRESS OR IMPLIED WARRANTY.

Some states do not allow the exclusion or limitation of incidental or consequential damages, so the above limitations or exclusions may not apply to you. This Warranty gives you the specific legal rights and you may also have other rights, which vary from state to state.



Customer Service 1-800-901-3313

