

Ceiling Fan with Light

Instruction Manual

TABLE OF CONTENTS

Package Contents.....	2
Safety Information	3
Preparation	4
Bracket Installation	5
Downrod Mounting	6
Circuit Connections	7
Receiver Installation	8
Arm installation	8
Fan blades installation.....	9
LED light kit installation	10
Glass lamp shade installation	11
Remote Control Operation	11
Troubleshooting.....	12

Before beginning installation of this product, read the package list on page 2 and ensure all parts are present and display no defects. If any part is missing or damaged, do not attempt to install the product. Read all of the safety information on page 3 before installation or use.

Estimated assembly time: 120 minutes

Additional tools required for assembly:

Electrical tape, flathead & Phillips screwdriver, pliers, safety glasses, step ladder, and wire strippers

Additional helpful tools:

AC tester light, tape measure, wiring handbook, and wire cutters

- Electrical tape
- Phillips screwdriver
- Flathead screwdriver
- 11 mm wrench
- Step ladder
- Wire cutters
- Protective eyewear

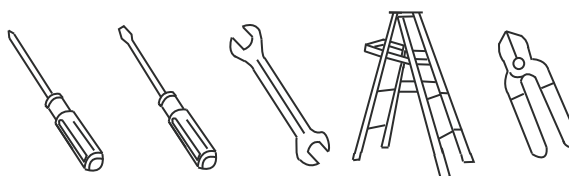

PACKAGE CONTENTS



(A) Fan blades (x8)

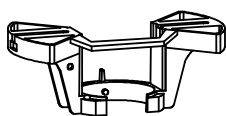

(B) Ceiling mounting bracket



(C) Downrod



(D) Coupling cover

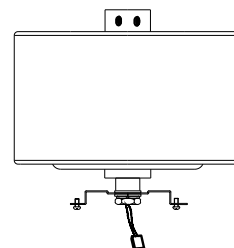

(G) Fan motor assembly



(E) Canopy



(F) Canopy cover

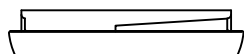

(H) Glass lamp shade

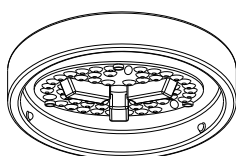

(I) LED light kit

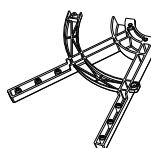

(J) Arm(X4)

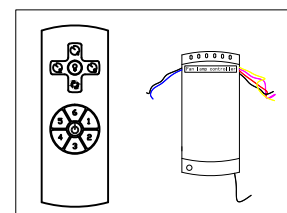

(K) controller

ACCESSORIES PACKAGE

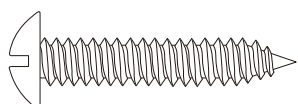

(L) Wood screws (4)



(M) Spring washers (4)



(N) Metal washers (4)



(O) Star washers (4)



(P) Steel screws (2)



(Q) Wiring caps (8)



(R) Blade arm screws(1)



(S) Blade screws (9)



(T) Blade screws (25)



(U) gasket(25)

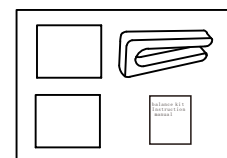

(V) Balance kit



(W) spare part-12- Inch downrod(1)

SAFETY INFORMATION

WARNING

1. To reduce the risk of electric shock, insure electricity has been turned off at the circuit breaker or fuse box before beginning.
2. All wiring must be in accordance with national and local electrical codes. Electrical installation should be performed by a qualified licensed electrician.
3. Suitable for use with solid-state speed controls.
4. To reduce the risk of personal injury, use only the two steel screws (and lock washers) provided with the outlet box for mounting to the outlet box. Most outlet boxes commonly used for the support of lighting fixtures are not acceptable for fan support and may need to be replaced, consult a qualified electrician if in doubt.
5. The outlet box and support structure must be securely mounted and capable of reliably supporting a minimum of 50 pounds. Use only UL listed outlet boxes marked "FOR FAN SUPPORT".
6. After marking electrical connections, spliced conductors should be turned upward and pushed carefully up into outlet box. The wires should be spread apart with the grounded conductor and the equipment-grounding conductor on one side of the outlet box.
7. The fan must be mounted with a minimum of 7 feet clearance from the trailing edge of the blades to the floor.
8. Do not use the reverse switch while the fan blades are in motion. To prevent damage and ensure long use, the fan must be turned off and the blades stopped before reversing direction.
9. Do not place objects in the path of the blades.
10. Exercise caution when working around or cleaning the fan.
11. Use a soft dry cloth to clean the fan body and blades. Do not use water or detergent.
12. The electrical diagrams provided herein are for reference only. Light kits that are not packaged with the fan must be UL listed and suitable for use with this fan. Switches must be UL general use switches. Refer to their separate instructions for proper assembly.

TO REDUCE THE RISK OF FIRE, ELECTRIC SHOCK OR PERSONAL INJURY, MOUNT FAN TO OUTLET BOX MARKED "ACCEPTABLE FOR FAN SUPPORT".

NEVER BEND THE BLADE BRACKETS/ FLANGES DURING ASSEMBLY OR AFTER INSTALLATION.

PREPARATION

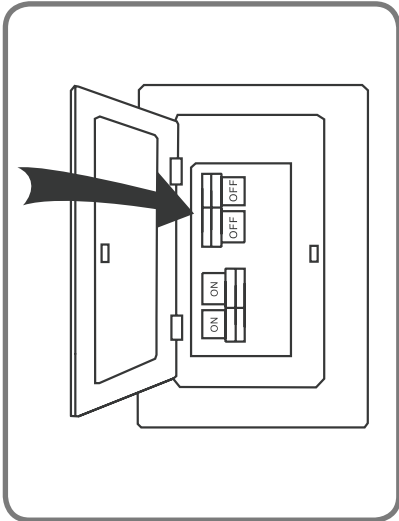

1. Turn power off

Begin installation by removing fuses or turning off circuit breakers to the wiring you will be using. Use your compatible UL listed mounting box if you already have one installed.

Failure to disconnect the power supply prior to installation may result in serious injury or death.

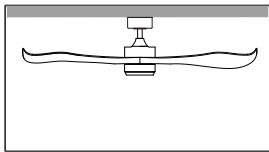

ONLY for flat ceilings

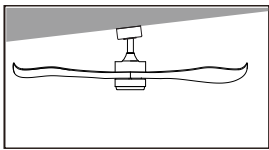

DO NOT use with sloped or vaulted ceilings

2. Choose mounting position

If you need to install a new UL listed mounting box, secure it directly to your building's structure using appropriate fasteners and materials. Do not use plastic boxes. The outlet box and its supports must be able to support the MOVING weight of the fan (at least 50 lb.) and be rated for fan support.

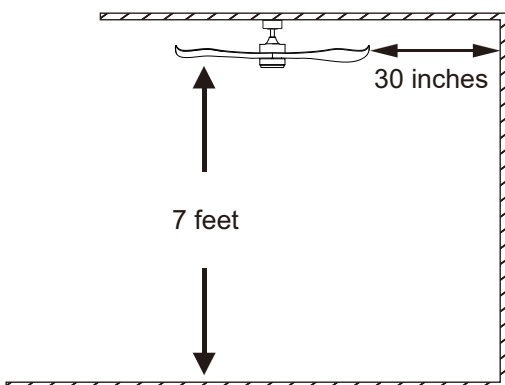

3. Choose suitable location

Ensure the blades will be at least 30 inches from any obstruction and at least 7 feet above the floor.

BRACKET INSTALLATION

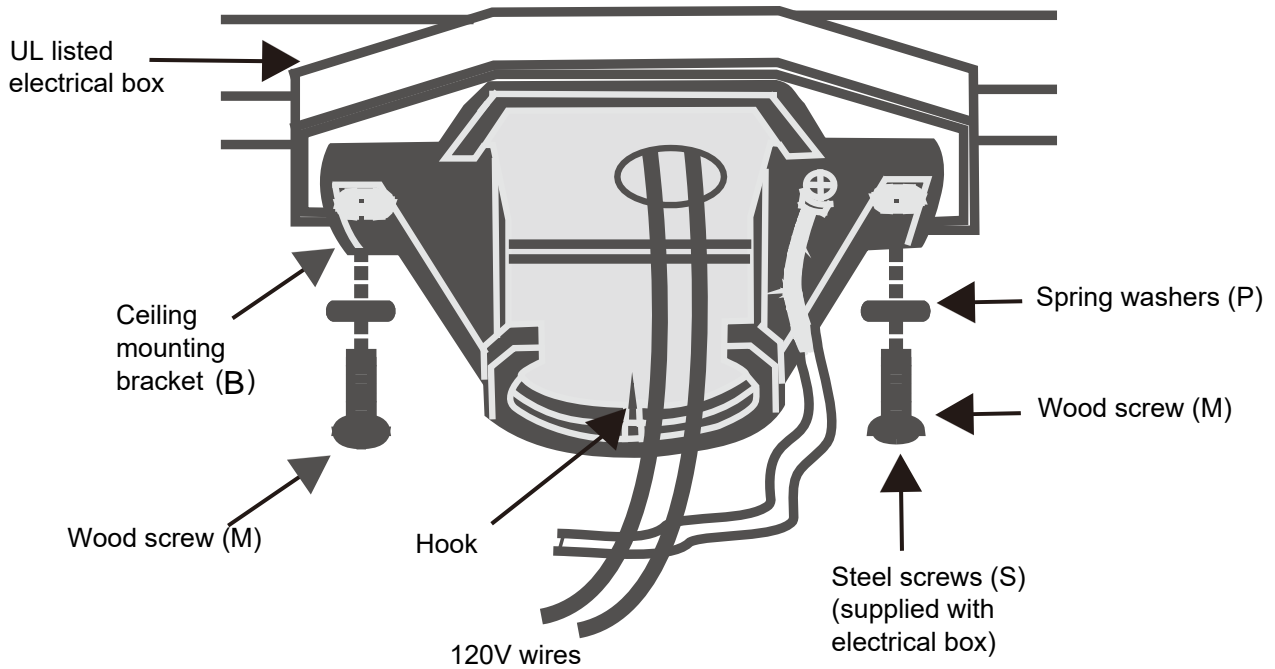

Loosen the screws on the fan hanger and fix the fan hanger to the ceiling outlet box with the wood screws (M) and spring washers (P). Pass the 120V supply wires through the center hole in the ceiling mounting bracket.

DOWNROD OR ANGLE MOUNTING

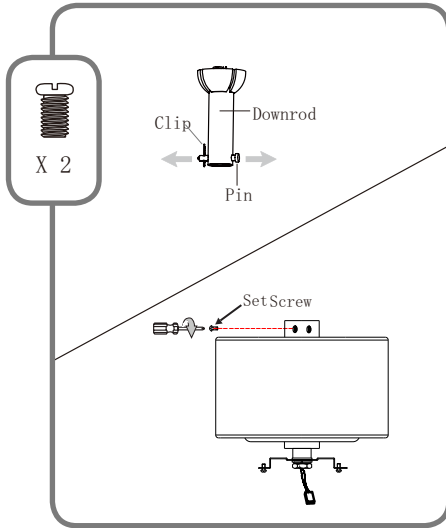

1. Loosen set screws and remove the pin and clip from the downrod. Remove the clip and pin from the downrod. Then partially loosen the two set screws in the yoke at the top of the motor assembly.

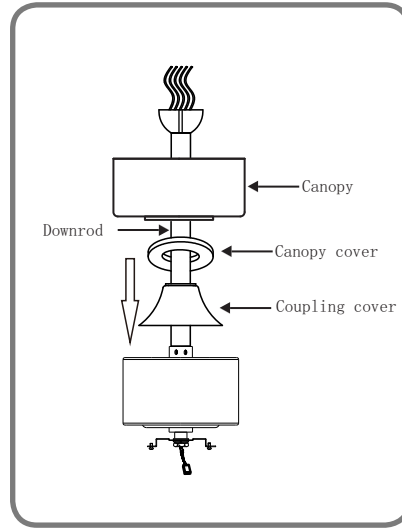

2. Feed the wires through the canopy and downrod. Insert the downrod through the canopy. Then, feed the fan wires through the downrod.

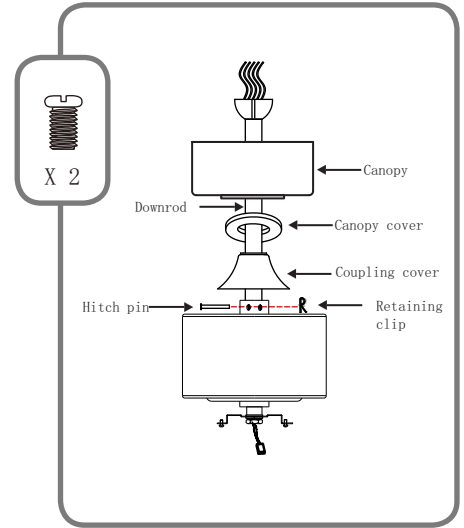

3. Install the downrod into yoke.

Slide the downrod into the yoke at the top of the motor assembly. Align the holes, and reinstall the pin and clip. Then tighten both set screws.

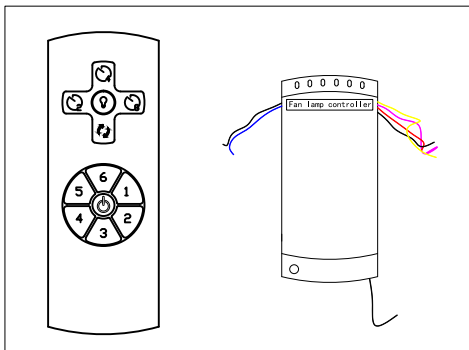

Remove the ceiling fan receiver from the remote control set and prepare to connect to the main unit. Please see the picture below for details:

CIRCUIT CONNECTION

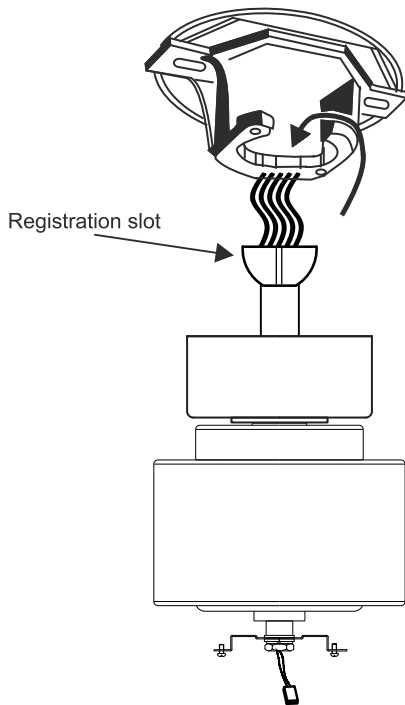

Attach the installed main body to the hanger through the derrick to facilitate the wiring in the next step.

Route wires exiting from the top of the fan motor through the canopy and then through the ball/downrod.

Align the holes at the bottom of the downrod with the holes in the collar on top of the motor housing. Carefully insert the hitch pin through the holes in the collar and downrod. Be careful not to jam the pin against the wiring inside the downrod. Insert the locking pin through the hole near the end of the hitch pin until it snaps into its locked position, as noted in the circle inset of the picture on the right.

Tighten two set screws on top of the fan motor firmly.

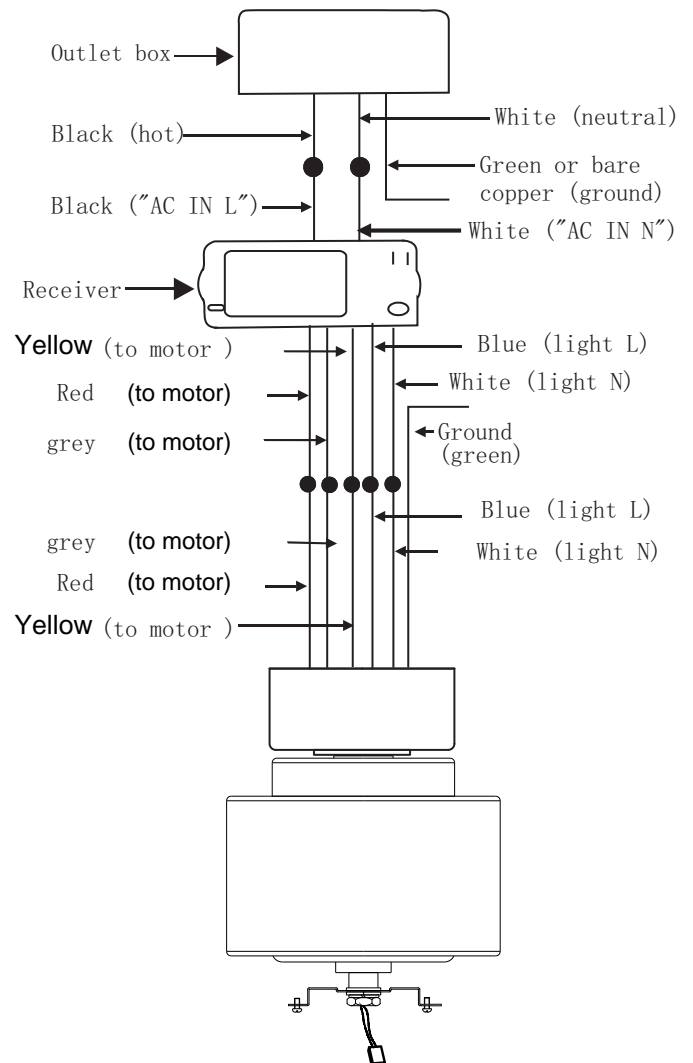

Wiring diagram

RECEIVER INSTALLATION

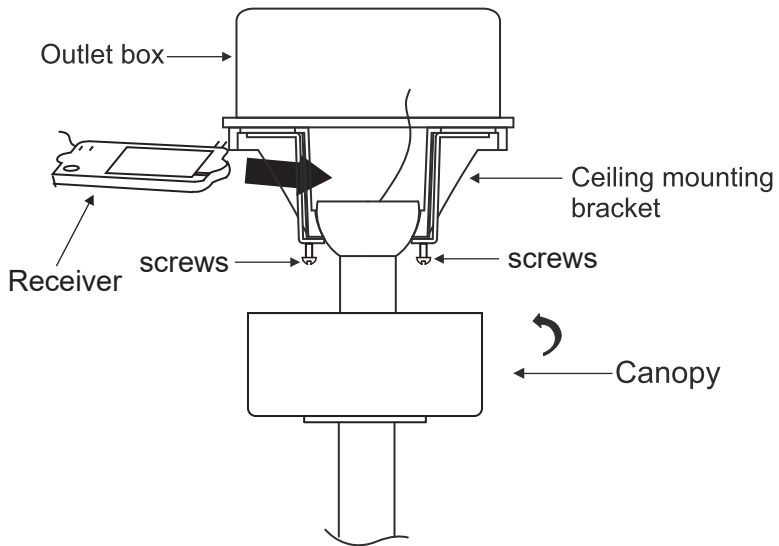

Insert the receiver into the tray with the receiver facing the ceiling. For best performance, make sure the White antenna, on the end of the receiver, remains extended and not tangled with any of the electrical wires.

ARM INSTALLATION

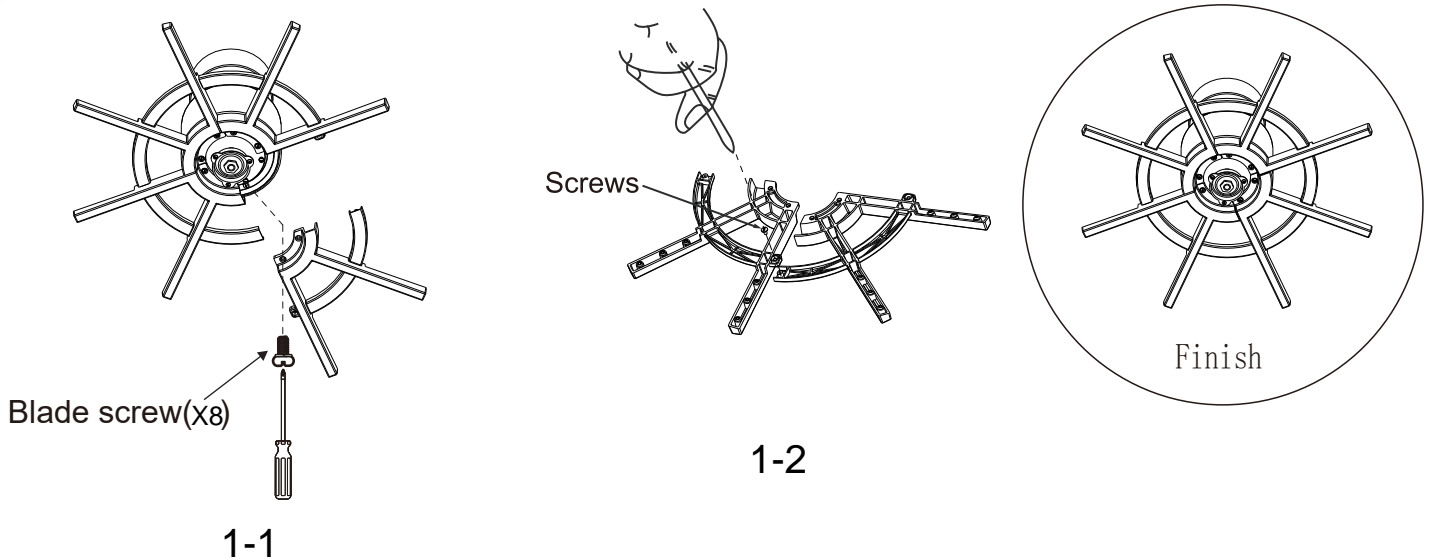

1. Install the blade arm on the fan motor with screws and lock it tightly, as shown in Figure 1-1.
2. Lock the blade arms with screws, as shown in Figure 1-2

FAN BLADES INSTALLATION

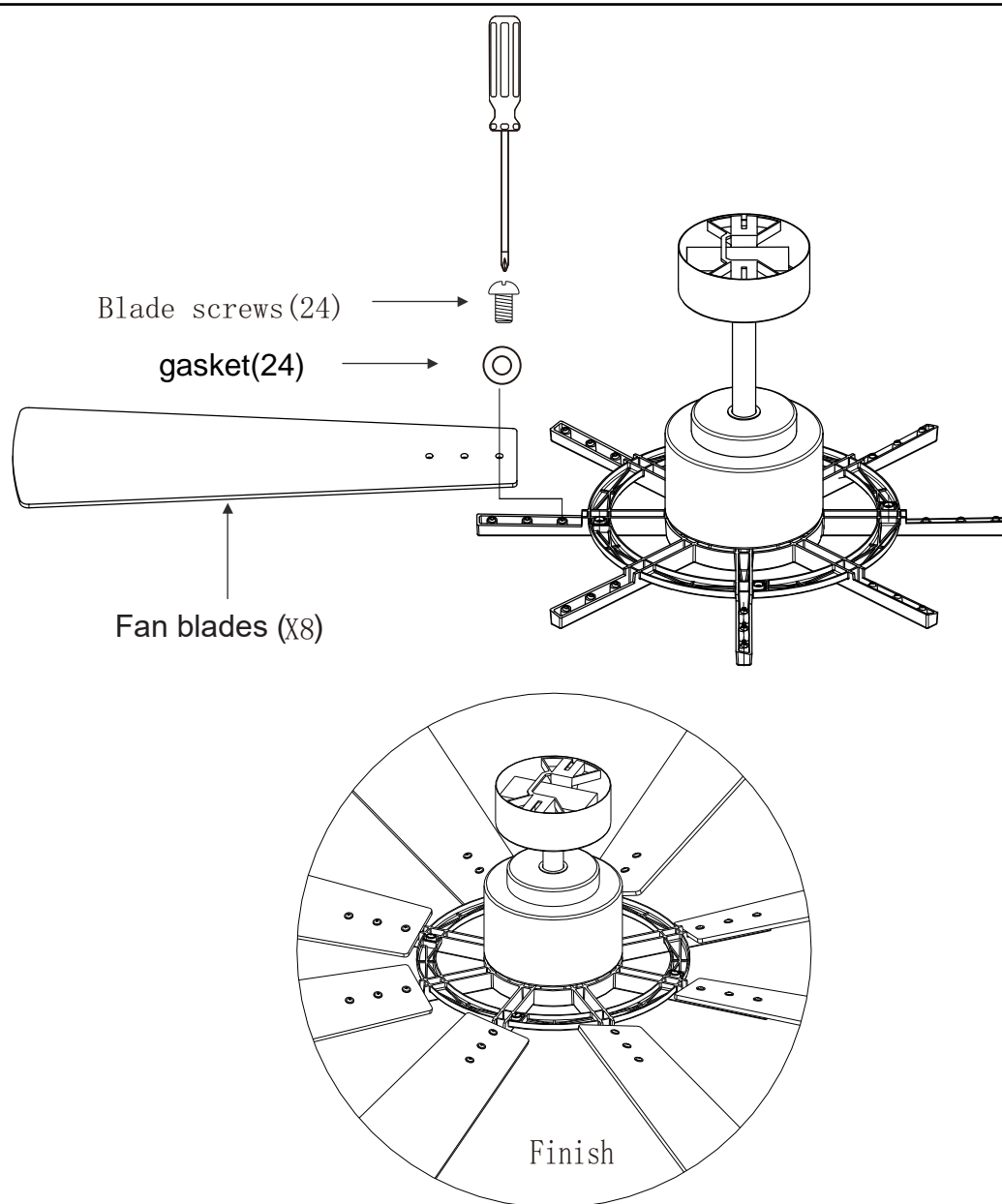

1. Install the fan blades on the rack with 3 blade screws and 3 gaskets
2. Repeat the previous step 7 times

LED LIGHT KIT INSTALLATION

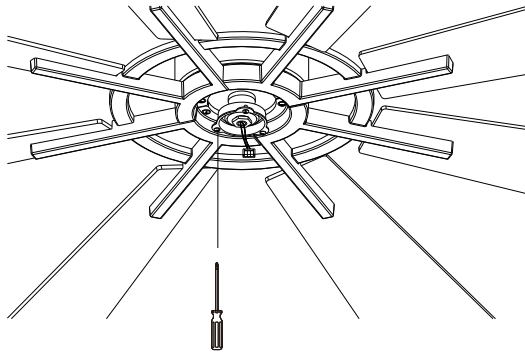

loosen 3 screws

2-1

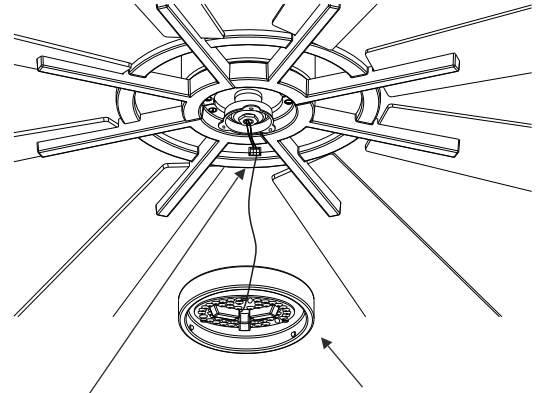

Wire connector

LED light kit

2-2

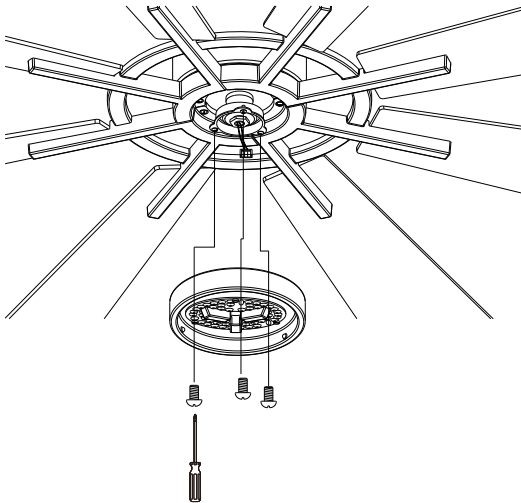

2-3

1. Loosen the 3 screws, as shown in Figure 2-1
2. Connect wire Connector to LED light kit, as shown in Figure 2-2
3. Lock the LED light kit to the fan motor with 3 screws, as shown in Figure 2-3

GLASS LAMP SHADE INSTALLATION

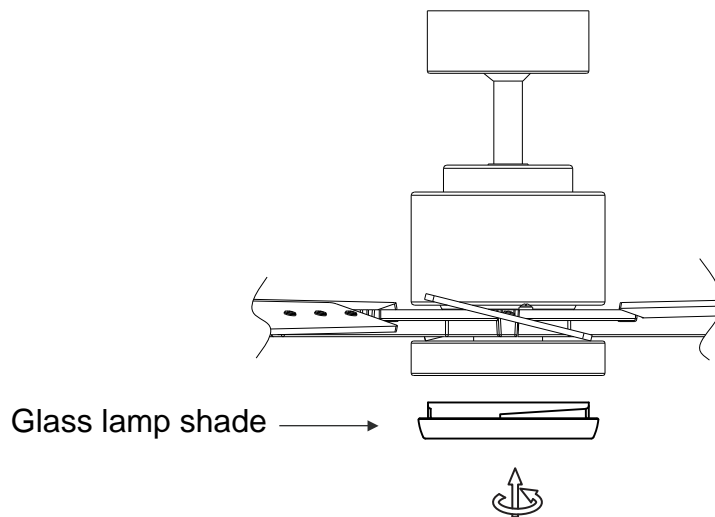

Install the lampshade on the light bracket by turning it clockwise into position .
Make sure it is tightly in place.

REMOTE CONTROL OPERATION

Install the remote control holder onto any wall or suitable flat surface using the two steel screws. Upon first use, connect the remote control to its receiver in the fan by pressing the emitter's "⏻" button for 3-10 seconds. There should be a beep to announce that the remote has successfully connected to its receiver.

1, 2, 3, 4, 5, 6: Starts the fan at one speed

⏻ : ON/OFF the lamp

⏻ : Turns off the fan

⌚ : Runs the fan for 2/4/8 hours and then turns it off

↺↻ : Reverses the fan's direction "Forward and Reverse"

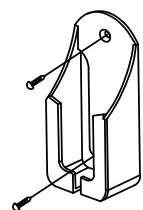
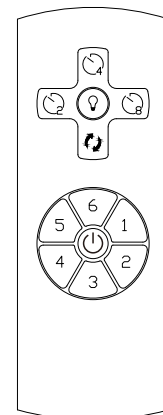

DO NOT press the F/R button while the fan is in operation. Wait for the blades to fully stop their movement before reversing their direction.

This remote operates with a range of 30 feet (10 m). It uses 12V 23A batteries (not included). If the remote will not be used for a prolonged period, it is recommended to remove the batteries for better service life.

TROUBLESHOOTING

Problem

Common Solutions

Fan blades
don't rotate

1. Check fuses and/or circuit breakers and reset if needed.
2. Cut off power to the fan and check its internal electrical connections.
3. Replace one of the remote control batteries.
4. Check that the fan cover is correctly placed and no screws interfere with the movement of the blades.
5. Contact customer service to replace a faulty remote control.

Fan is too noisy

1. Check that all screws and fasteners are well tightened.
2. Ensure the canopy housing has a short distance between itself and the ceiling.
3. Upon initial installation, allow 24 hours of use for the machine to break itself in.
4. Cut off power to the fan and check that the wire nut connections are not rubbing against one another or the inner housing.
5. If you have installed a solid-state variable-speed control, cut off power to the fan and disconnect this control from the device. See if using the remote resolves the problem, which can be caused by erratic signals from such controls.

Fan wobbles
during use

1. Check that all screws and fasteners are well tightened.
2. Use the provided blade balancing kit to adjust the blades if their tips are found to be an unequal distance from the ceiling while well fastened.
3. Exchange the position of the various blades.

Again, do not bend the blades during any of these procedures.