

# INSTALLATION

HLB-4000EC & HLB-4000ER

## ▲ CAUTION BEFORE INSTALLATION

- Check whether the size and shape of the toilet seat are suitable for installation.
- Ground connection should be done by authorized service person only.
- Do not connect the power until installation is finalized.
- Check all the accessory parts are in place.

## 1. REMOVE THE EXISTING TOILET SEAT.

- Remove the existing toilet seat and lid by unfastening the nuts underneath.
- Keep the detached seat, lid and nuts for later use.

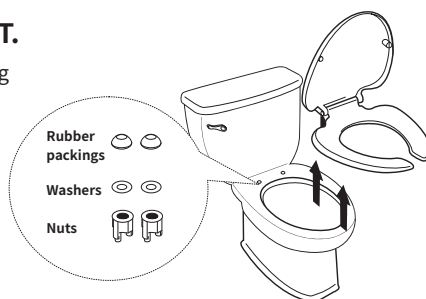

## 2. DRAIN TOILET WATER TANK COMPLETELY AFTER TURNING OFF THE WATER SUPPLY BY TURNING THE SHUT OFF VALVE CLOCKWISE.

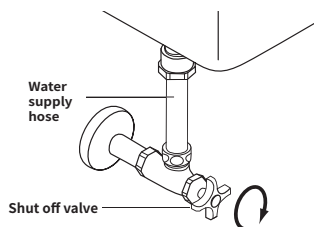

## 3. DISCONNECT THE WATER SUPPLY LINE FROM THE TOILET WATER TANK AND INSTALL A T-VALVE.

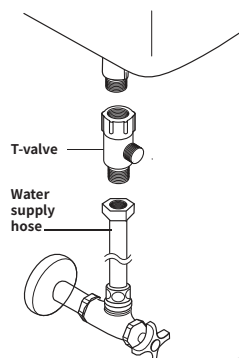

#### 4. (1) LINE UP THE BOLT SLOTS IN THE MOUNTING PLATE WITH THE BOLT HOLES.

- 5.5" (140mm) hole spacing is required for a typical installation.
- If your bolt hole spacing is different, a custom solution is needed to affix mounting plate bracket to toilet. Contact us for additional details.

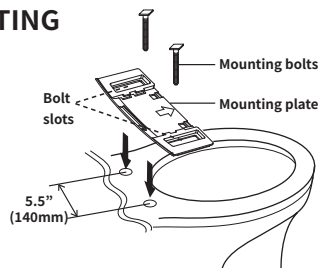

< 4. (1) >

#### (2) INSERT MOUNTING BOLTS THROUGH THE BOLT SLOTS AND INTO THE BOLT HOLES IN THE TOILET.

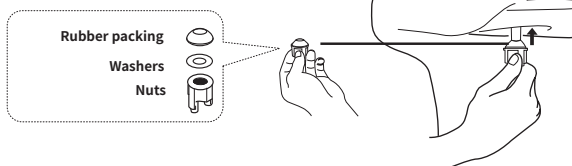

<TOILETS WITH BOLTS TIGHTENED FROM ABOVE>

#### 4\*. Reuse the mounting bolts from the existing toilet seat with the bolt cases included with the bidet.

- Please the mounting plate so that the slots align with the bolt holes in the toilet.
- Place the bolt cases on the mounting plate.
- Fasten the mounting plate using the bolts removed from the existing toilet seat.

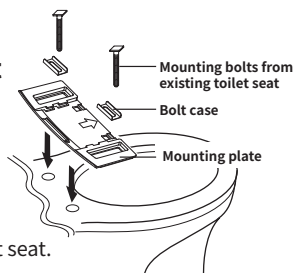

< 4\* >

---

**5. CONNECT THE BIDET SEAT HOSE TO THE BIDET.**

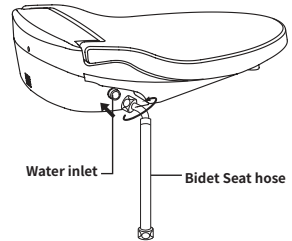

**6. SLIDE THE BIDET UNIT ONTO THE MOUNTING PLATE BY ALIGNING THE GROOVES UNDER THE BIDET UNIT.**

- The bidet seat should slide all the way back and lock into the mounting bracket. It should not be able to slide forward once locked.

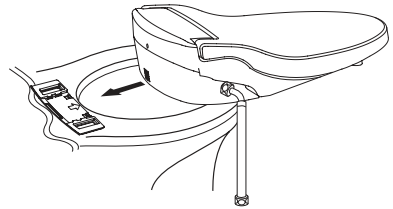

**7. CONNECT THE BIDET SEAT HOSE TO THE T-VALVE.**

