

ITEM #5216229

# HAWKESBURY LED CEILING FAN

MODEL #CFH42MBK3L

Español p. 16

ATTACH YOUR RECEIPT HERE

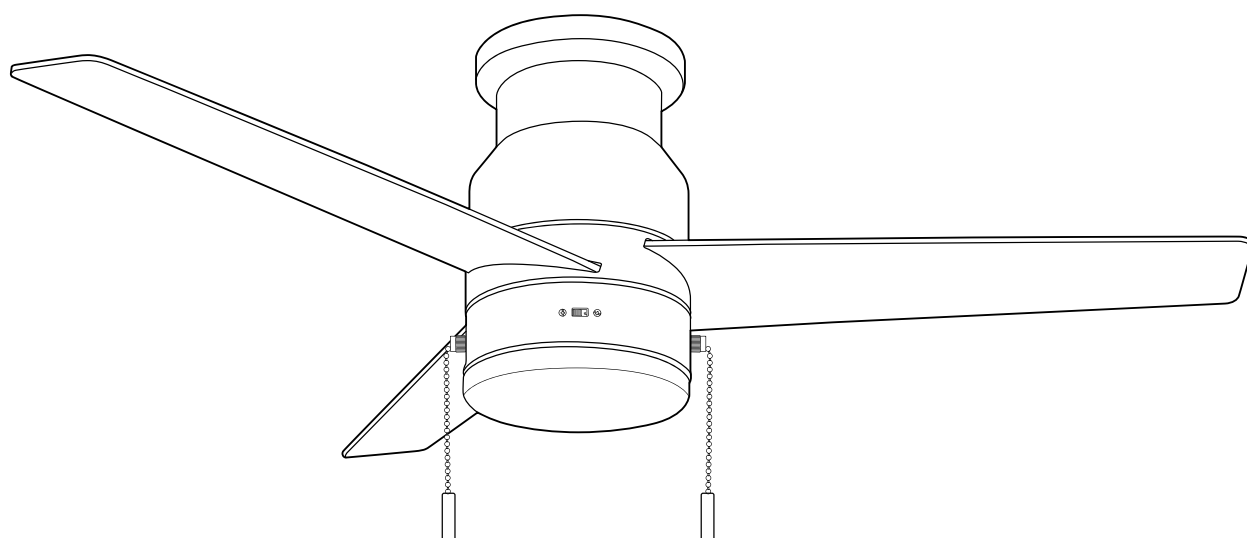

Purchase Date \_\_\_\_\_



**Questions, problems, missing parts?** Before returning to your retailer, call our customer service department at **1-800-527-1292**, 8:30 a.m. - 5 p.m., CST, Monday - Friday.

## TABLE OF CONTENTS

---

Safety Information .....	2
Package Contents .....	4
Hardware Contents .....	5
Preparation .....	5
Initial Installation .....	5
Wiring .....	7
Final Installation .....	9
Operating Instructions .....	12
Care and Maintenance .....	13
Troubleshooting.....	14
Limited Lifetime Warranty .....	15
Replacement Parts List .....	15



## SAFETY INFORMATION

---

### FCC Compliance Notice

CAUTION: Changes or modifications not approved by the party responsible for compliance could void the user's authority to operate the equipment. [The equipment refers to the remote control transmitter and/or LED light kit.]

This device complies with Part 15 of the FCC Rules. Operation is subject to the following two conditions: (1) this device may not cause harmful interference, (2) this device must accept any interference received, including interference that may cause undesired operation.

NOTE: This equipment has been tested and found to comply with the limits for a Class B digital device, pursuant to Part 15 of the FCC Rules. These limits are designed to provide reasonable protection against harmful interference in a residential installation. This equipment generates, uses and can radiate radio frequency energy and, if not installed and used in accordance with the instructions, may cause harmful interference to radio communications. However, there is no guarantee that interference will not occur in a particular installation. If this equipment does cause harmful interference to radio or television reception, which can be determined by turning the equipment off and on, the user is encouraged to try to correct the interference by one or more of the following measures:

- \* Reorient or relocate the receiving antenna.
- \* Increase the separation between the equipment and receiver.
- \* Connect the equipment into an outlet on a circuit different from that to which the receiver is connected.
- \* Consult the dealer or an experienced radio/TV technician for help.

Distributed by: Litex Industries Inc., P.O. Box 535639, Grand Prairie, TX, 75053; 1-800-527-1292

---

### READ AND SAVE THESE INSTRUCTIONS

- Do not discard fan carton or foam inserts. Should this fan need to be returned to the factory for repairs, it must be shipped in its original packaging to ensure proper protection against damage that might exceed the initial cause for return.
- Make sure all electrical connections comply with local codes, ordinances, the National Electrical Code and ANSI/NFPA 70-1999. Hire a qualified electrician or consult a do-it-yourself wiring handbook if you are unfamiliar with installing electrical wiring.
- Make sure the installation site you choose allows a minimum clearance of 7 ft. from the blades to the floor and at least 30 in. from the end of the blades to any obstruction.
- After you install the fan, make sure all connections are secure to prevent the fan from falling.
- The net weight of this fan including the light kit is: 15 lbs.

## SAFETY INFORMATION

### DANGER

When using an existing outlet box, make sure the outlet box is securely attached to the building structure and can support the full weight of the fan. Failure to do this can result in serious injury or death. The stability of the outlet box is essential in minimizing wobble and noise in the fan after installation is complete.

To reduce the risk of serious bodily injury, DO NOT use power tools to assemble any part of the fan, including the blades.

### WARNING



To reduce the risk of fire, electrical shock or personal injury, mount fan to outlet box marked "ACCEPTABLE FOR FAN SUPPORT OF 35 LBS. OR LESS" and use mounting screws provided with the outlet box. Most outlet boxes commonly used for the support of lighting fixtures are not acceptable for fan support and may need to be replaced. Consult a qualified electrician if in doubt.

To avoid personal injury, the use of gloves may be necessary while handling fan parts with sharp edges.

When mounting fan to a ceiling outlet box, use a METAL octagonal outlet box; do NOT use a plastic outlet box. Secure the outlet box directly to the building structure. The outlet box and its support must be able to support the moving weight of the fan (at least 35 lbs.).

To reduce the risk of fire, electrical shock or personal injury, wire connectors provided with this fan are designed to accept only one 12-gauge house wire and two lead wires from the fan. If your house wire is larger than 12-gauge or there is more than one house wire to connect to the corresponding fan lead wires, consult an electrician for the proper size wire connectors to use.

To reduce the risk of fire or electrical shock, do not use the fan with any solid state speed control device or control fan speed with a full range dimmer switch.

To reduce the risk of fire, electrical shock or personal injury, do not bend the blades when installing them, balancing the blades or cleaning the fan. Do not insert objects between the rotating fan blades.

To reduce the risk of personal injury, use ONLY parts provided with this fan. The use of parts OTHER than those provided with this fan will void the warranty.

Before installation, be sure to shut off electricity at main switch or circuit breaker in order to avoid electrical shock.

### CAUTION

Be sure outlet box is properly grounded and that a ground wire (green or bare) is present.

Before beginning installation, carefully check all screws, bolts and nuts on fan motor assembly to ensure that they are secured.

DO NOT tamper with or attempt to repair LED component. The light source is designed for this specific application and should not be serviced by untrained personnel. If any servicing is required, call our customer service department.

## PACKAGE CONTENTS

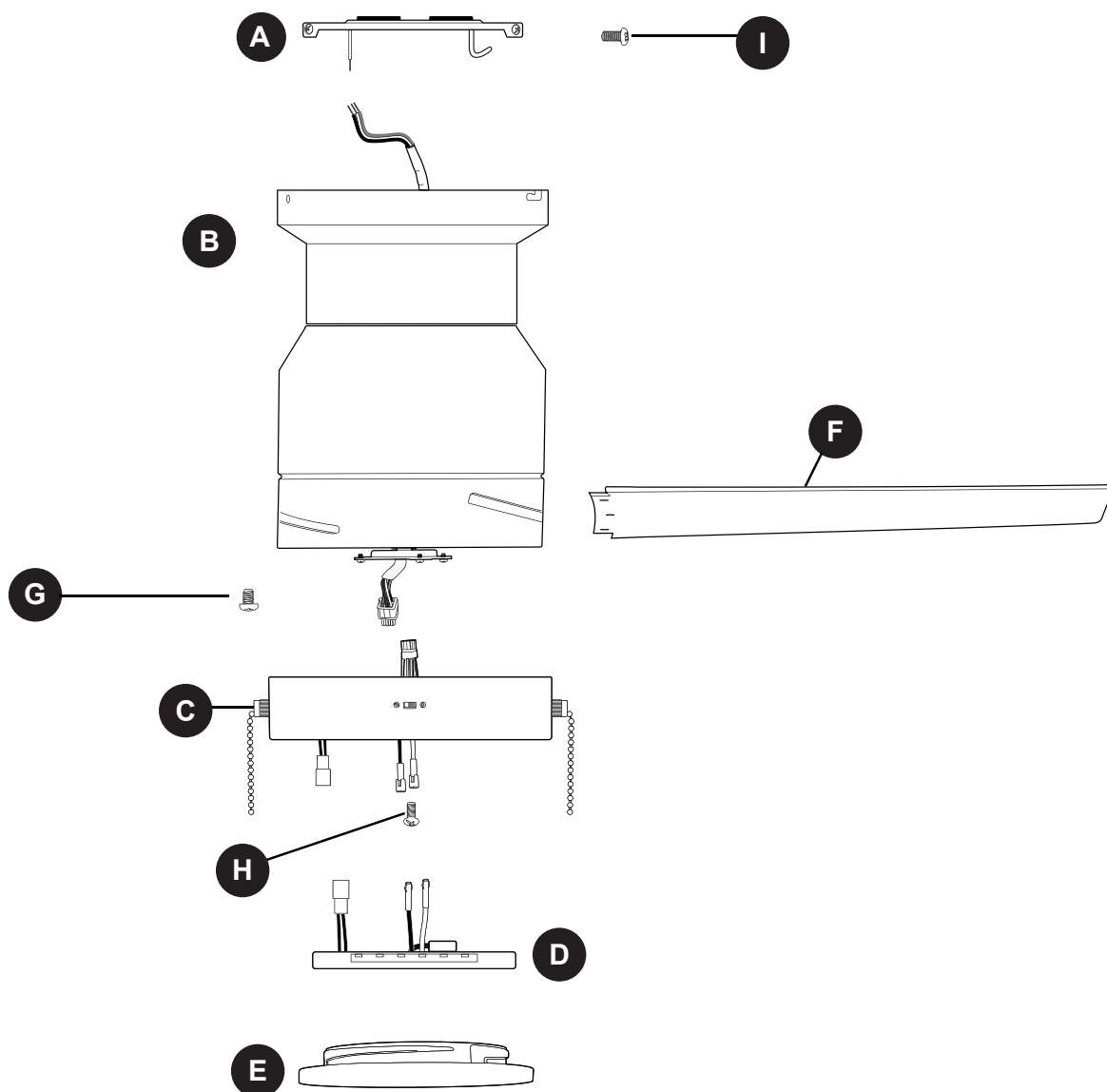

PART	DESCRIPTION	QUANTITY
A	Mounting Plate	1
B	Motor Housing	1
C	Light Kit Fitter	1
D	LED Light Kit	1
E	Shade	1

PART	DESCRIPTION	QUANTITY
F	Blade	3
G	Motor Plate Screw (preassembled)	3
H	Light Kit Fitter Screw (preassembled)	3
I	Mounting Plate Screw (preassembled)	4

**⚠ IMPORTANT REMINDER:** You must use the parts provided with this fan for proper installation and safety.

## HARDWARE CONTENTS (shown actual size)

AA



Blade  
Screw

Qty. 10  
+ 1 extra

BB

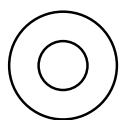

Fiber Blade  
Washer

Qty. 10  
+ 1 extra

CC

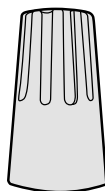

Wire  
Connector

Qty. 4

DD

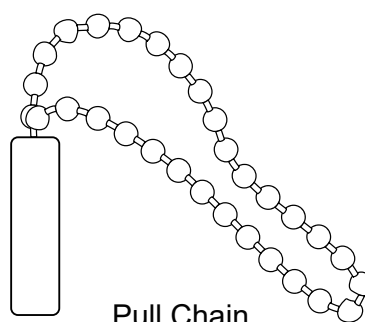

Pull Chain  
Extension

Qty. 2

## PREPARATION

Before beginning assembly of product, make sure all parts are present. Compare parts with package contents list and hardware contents list. If any part is missing or damaged, do not attempt to assemble the product.

**Estimated Assembly Time: 120 minutes**

Tools Required for Assembly (not included): Electrical Tape, Phillips Screwdriver, Pliers, Safety Glasses, Stepladder and Wire Strippers

Helpful Tools (not included): AC Tester Light, Tape Measure, Do-It-Yourself Wiring Handbook and Wire Cutters

## INITIAL INSTALLATION

1. Turn off circuit breakers and wall switch to the fan supply line leads.

**⚠ DANGER:** Failure to disconnect power supply prior to installation may result in serious injury or death.

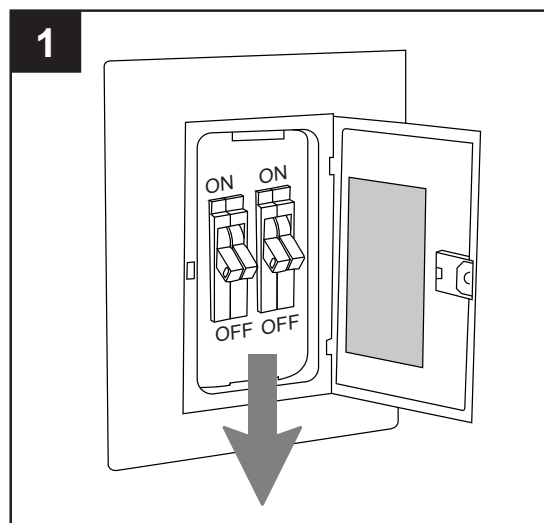

## INITIAL INSTALLATION

- This fan can be mounted as a **flushmount** on a regular (no-slope) ceiling only.

Check to make sure blades (F) will be at least 30 in. from any obstruction and at least 7 ft. above the floor.

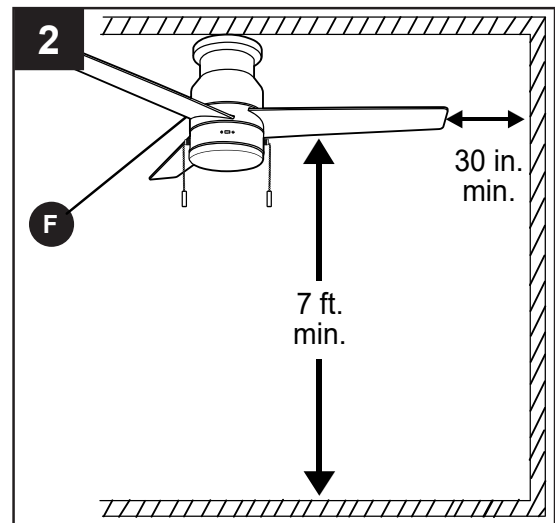

- Locate preassembled mounting plate screw (I) on outer edge of mounting plate (A) closest to the J-hook (located on underside of mounting plate (A)) and remove that mounting plate screw (I). Then, remove mounting plate screw (I) on outer edge of mounting plate (A) directly opposite the mounting plate screw (I) that was just removed.

Partially loosen the other two remaining mounting plate screws (I).

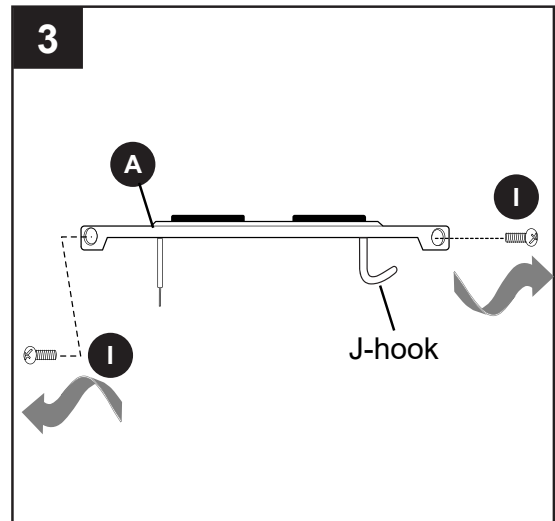

- Secure mounting plate (A) to outlet box using screws, spring washers and flat washers provided with the outlet box.

**NOTE:** It is very important you use the proper hardware when installing the mounting plate (A) as this will support the fan.

Pull electrical wiring from outlet box through center hole in the mounting plate (A).

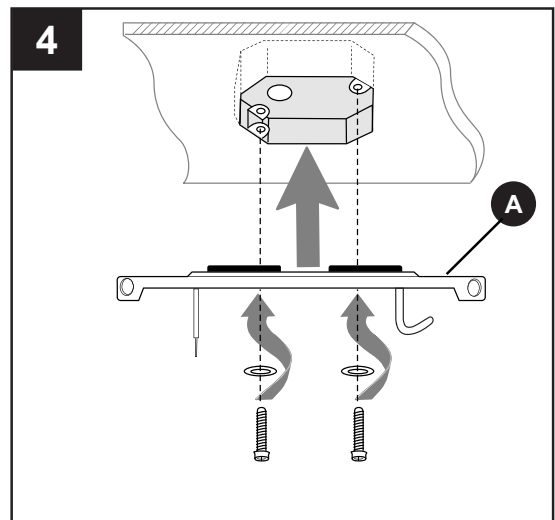

## INITIAL INSTALLATION

5. Lift motor housing (B) to mounting plate (A). Hang motor housing (B) on J-hook on underside of mounting plate (A).

**IMPORTANT:** Use one of the non-slotted holes on the rim of the motor housing (B) to do so. This will allow motor housing (B) to hang out of the way while wiring.

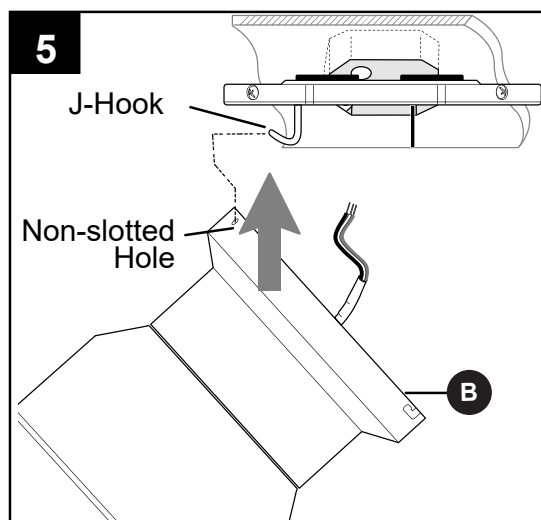

## WIRING

**⚠ WARNING:** To reduce the risk of fire, electrical shock or personal injury, wire connectors provided with this fan are designed to accept only one 12-gauge house wire and two lead wires from the fan. If your house wire is larger than 12-gauge or there is more than one house wire to connect to the corresponding fan lead wires, consult an electrician for the proper size wire connectors to use.

**⚠ CAUTION:** Be sure outlet box is properly grounded and that a ground (green or bare) wire is present.

**⚠ WARNING:** If house wires are different colors than referred to in the following steps, stop immediately. A professional electrician is recommended to determine wiring.

**⚠ WARNING:** Using a full range dimmer switch (not included) to control fan speed will cause a loud humming noise from fan. To reduce the risk of fire or electrical shock, do NOT use a full range dimmer switch to control fan speed.

**NOTE:** This fan is remote control adaptable (remote control not included). Please refer to instructions provided with the remote control before proceeding with these wiring instructions.

1. Choose wiring diagram (Fig. 1a, Fig. 1b or Fig. 1c) that fits your situation and make appropriate wiring connections as follows: **[IMPORTANT:** Use one of the wire connectors (CC) provided to make each wire connection, making sure to screw wire connector (CC) on in a clockwise direction.]

**1a. FAN AND LIGHT CONTROLLED BY PULL CHAINS:** Connect BLACK and BLUE wire from fan to BLACK wire from ceiling. Connect WHITE wire from fan to WHITE wire from ceiling. Connect GROUND (GREEN) wire from mounting plate (A) to BARE/GREEN wire from ceiling.

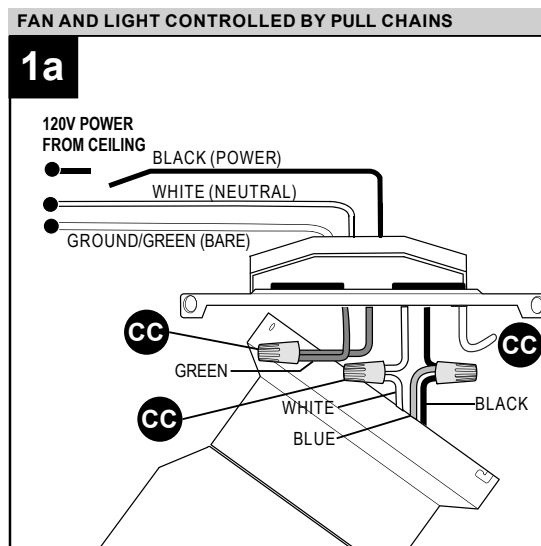

## WIRING

**1b. FAN CONTROLLED BY PULL CHAIN, LIGHT BY WALL SWITCH:** Connect BLACK wire from fan to BLACK wire from ceiling. Connect BLUE wire from fan to the BLACK wire from the independent wall switch for the light. Connect WHITE wire from fan to WHITE wire from ceiling. Connect GROUND (GREEN) wire from mounting plate (A) to BARE/GREEN wire from ceiling.

FAN CONTROLLED BY PULL CHAIN, LIGHT BY WALL SWITCH

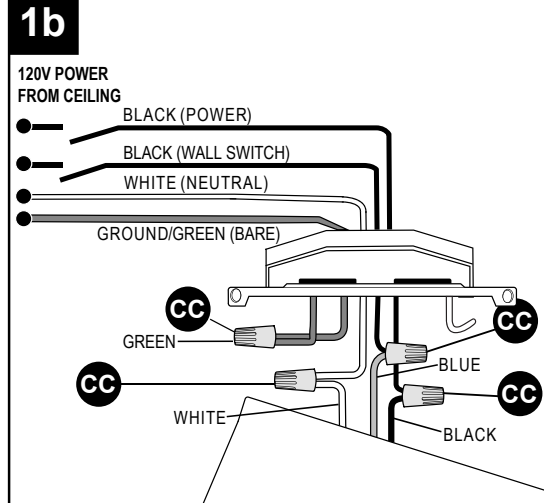

**1c. FAN AND LIGHT CONTROLLED BY TWO WALL SWITCHES:** Connect BLACK wire from fan to BLACK (or RED) wire from the independent wall switch for the fan. Connect BLUE wire from fan to the BLACK (or RED) wire from the other independent wall switch for the light. Connect WHITE wire from fan to WHITE wire from ceiling. Connect GROUND (GREEN) wire from mounting plate (A) to BARE/GREEN wire from ceiling.

FAN AND LIGHT CONTROLLED BY TWO WALL SWITCHES

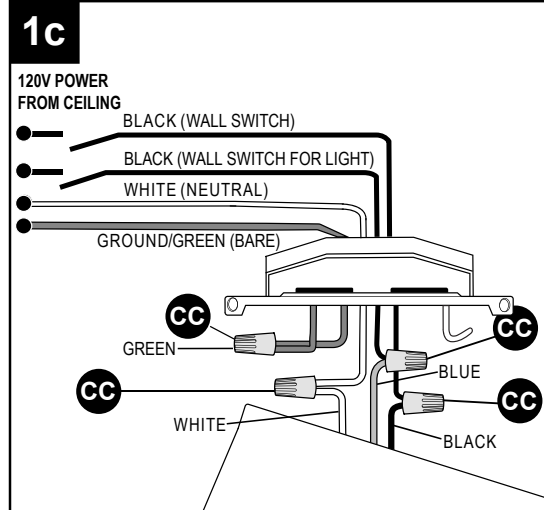

**NOTE:** BLACK wire is hot power for fan. BLUE wire is hot power for light kit. WHITE wire is common for fan and light kit. GREEN or BARE wire is ground.

2. Wrap electrical tape (not included) around each individual wire connector (CC) down to the wire.

**⚠ WARNING:** Make sure no bare wire or wire strands are visible after making connections. Place BARE/GREEN and WHITE connections on opposite side of box from the BLACK and BLUE (if applicable) connections.

### Hardware Used



Wire Connector

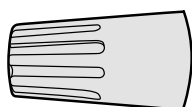

x 4

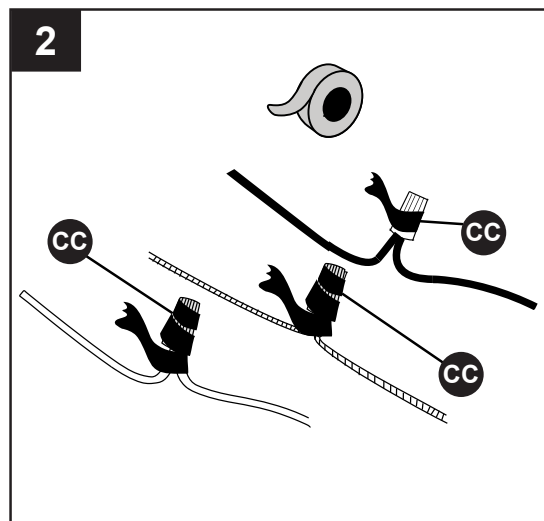

## FINAL INSTALLATION

1. Remove motor housing (B) from J-hook. Lift motor housing (B) to mounting plate (A). Align slotted holes on top rim of motor housing (B) with loosened mounting plate screws (I) in mounting plate (A). Twist motor housing (B) to lock. Re-insert the two mounting plate screws (I) previously removed (step 3, page 6) and then tighten all four mounting plate screws (I) to secure motor housing (B).

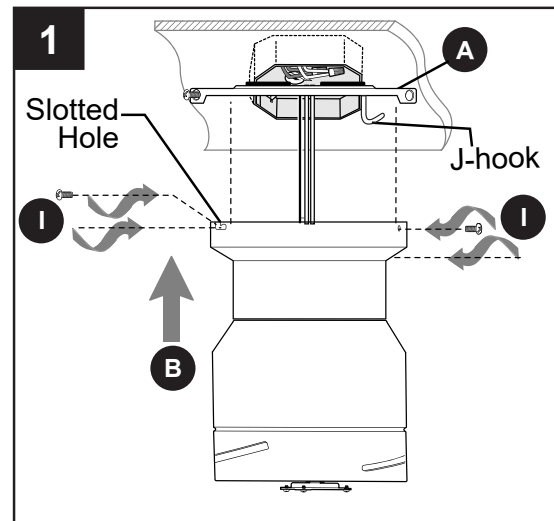

2. Insert a blade (F) through one of the slots on the band on the motor housing (B). Align holes and attach the blade (F) to the motor with blade screws (AA) and fiber blade washers (BB). Then, tighten each blade screw (AA), starting with the one in the middle. Repeat for remaining blades (F).

### Hardware Used

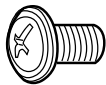
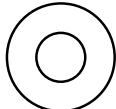
<b>AA</b> Blade Screw		x 10
<b>BB</b> Fiber Blade Washer		x 10

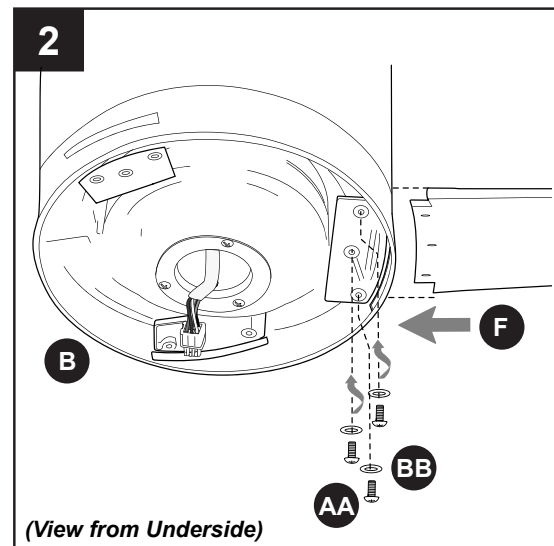

3. Remove one preassembled motor plate screw (G) from motor plate (on underside of motor) and partially loosen the other two motor plate screws (G). Align slotted holes in light kit fitter (C) with loosened motor plate screws (G), allowing male plug from motor housing (B) to come through hole in middle of light kit fitter (C). Twist light kit fitter (C) to lock. Re-insert motor plate screw (G) that was removed and tighten all three motor plate screws (G) securely.

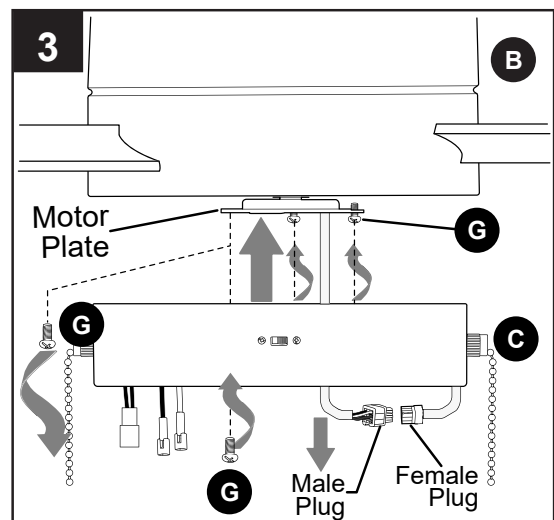

## FINAL INSTALLATION

4. Connect male plug from motor housing (B) to female plug from light kit fitter (C), matching up the colors on the male plug with the colors on the female plug for correct fit. Make sure plugs are connected completely.

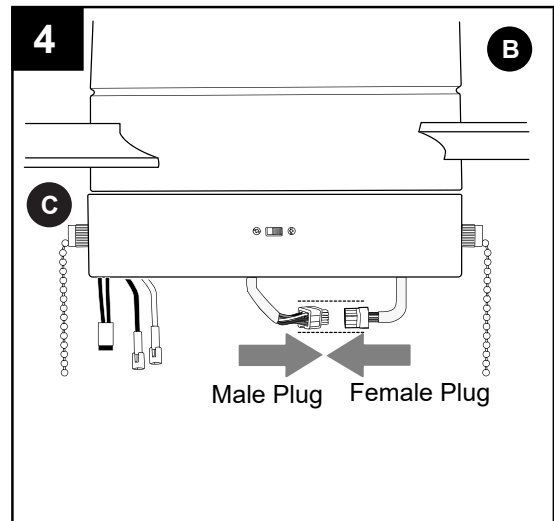

5. Remove one preassembled light kit fitter screw (H) from underside of light kit fitter (C) and partially loosen the other two light kit fitter screws (H).

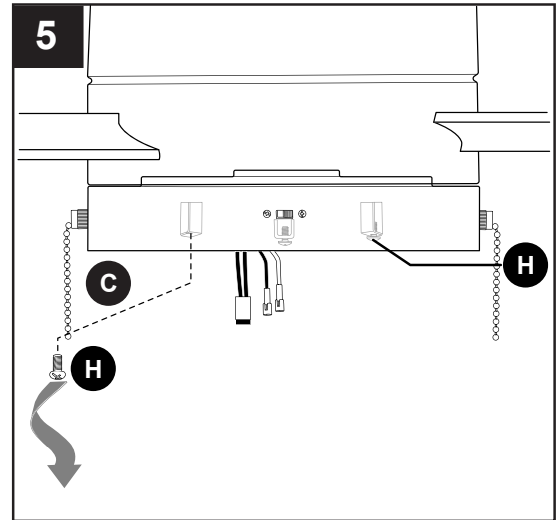

6. Connect WHITE moxex wire from LED light kit (D) to WHITE moxex wire from light kit fitter (C). Connect BLACK moxex wire from LED light kit (D) to BLUE moxex wire from light kit fitter (C). Connect the 2-pin moxex plug from light kit fitter (C) to the 2-pin moxex plug from LED light kit (D). Make sure moxex wire connections snap together securely.

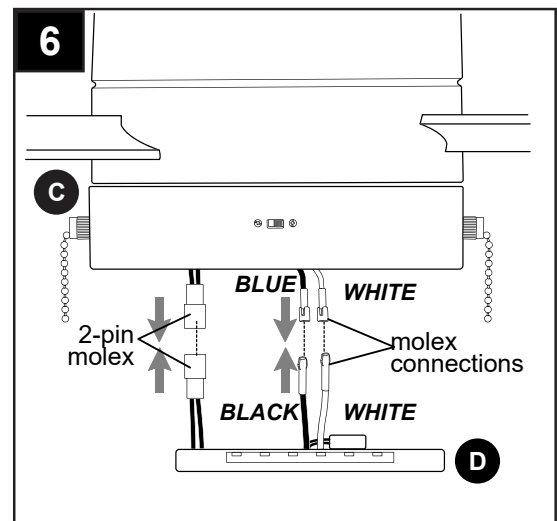

## FINAL INSTALLATION

7. Carefully arrange wires in center of light kit fitter (C). Align slotted holes in edge of LED light kit (D) with loosened light kit fitter screws (H) on light kit fitter (C). Re-insert the other light kit fitter screw (H) previously removed. Tighten all three light kit fitter screws (H) securely.

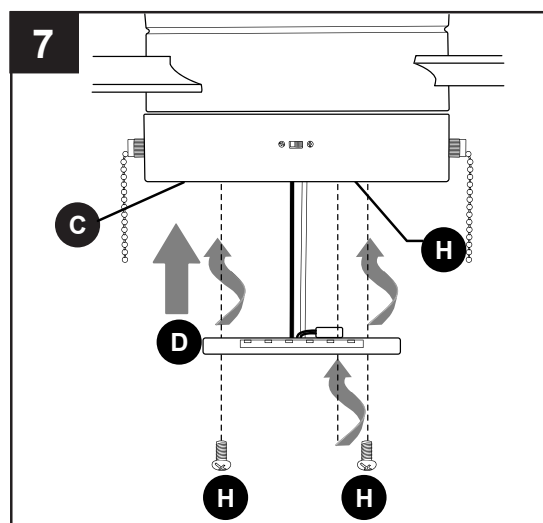

8. Align grooves on shade (E) with nodules on inside of LED light kit (D) and push up gently on shade (E). Turn shade (E) *clockwise* until it no longer turns.

**NOTE:** Pull down **gently** on the shade (E) to make sure that it is secured completely.

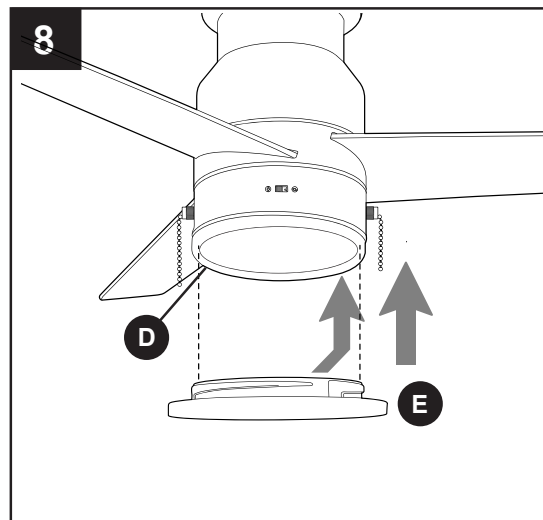

9. Attach pull chain extensions (DD) or custom pull chain extensions (not included) to fan and light pull chains.

Assembly is now complete.

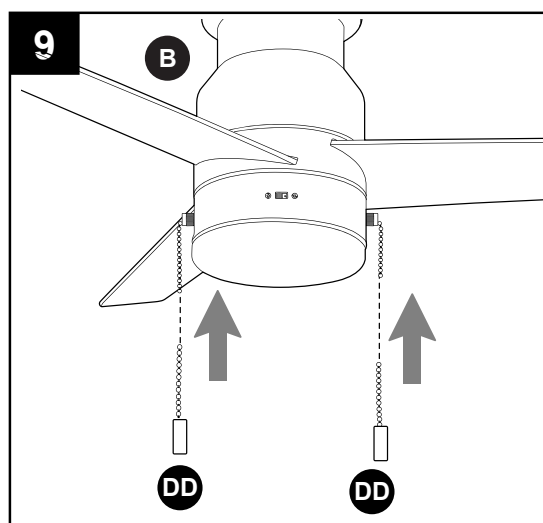

### Hardware Used

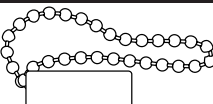
- DD** Pull Chain Extension  x 2

## OPERATING INSTRUCTIONS

1. The fan pull chain, located to the right of the reverse switch, has four positions to control fan speed. One pull is HIGH, two is MEDIUM, three is LOW and four turns the fan OFF.

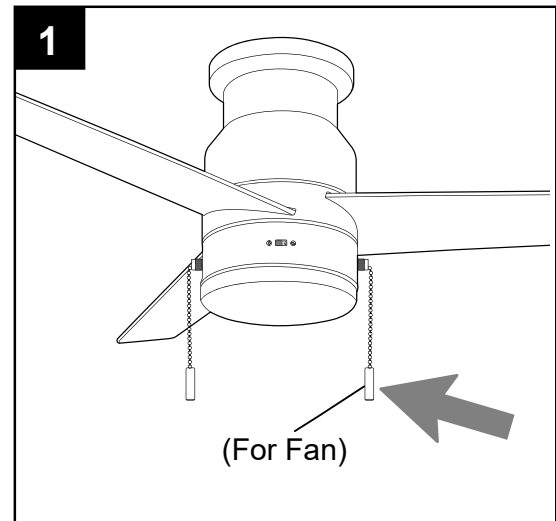

2. The light pull chain, located to the left of the reverse switch, is used to turn the light ON or OFF.

- To activate and change between the light's **five** color-changing temperature (CCT) settings, pull and hold the chain for a minimum of three seconds.
- Release the chain to set the preferred color temperature. The color temperature will be set until activating CCT again.

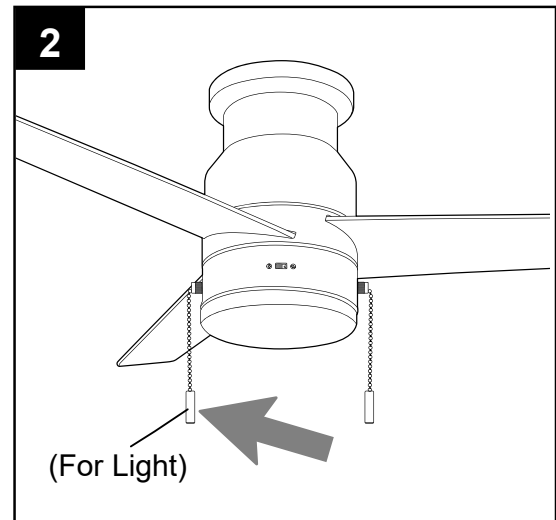

3. Use the fan reverse switch on the light kit fitter (C) to optimize your fan for seasonal performance. A ceiling fan will allow you to raise your thermostat setting in summer and lower your thermostat setting in winter without feeling a difference in your comfort.

**NOTE:** Wait for fan to stop before moving the reverse switch.

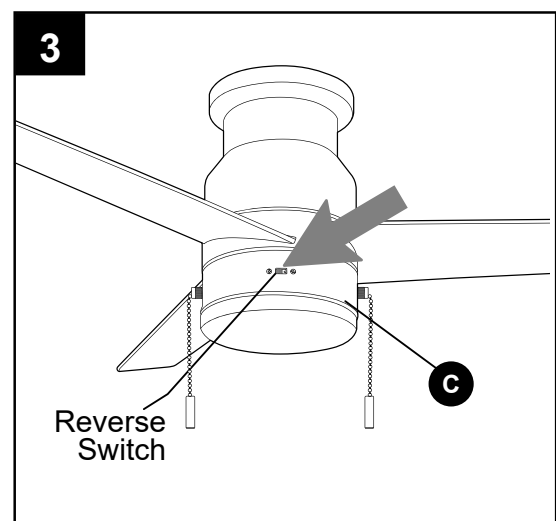

## OPERATING INSTRUCTIONS

---

3a. In **warmer** weather, setting the reverse switch in the LEFT position will result in downward airflow creating a wind chill effect.

3b. In **cooler** weather, setting the reverse switch in the RIGHT position will result in upward airflow that can help move stagnant, hot air off the ceiling area.

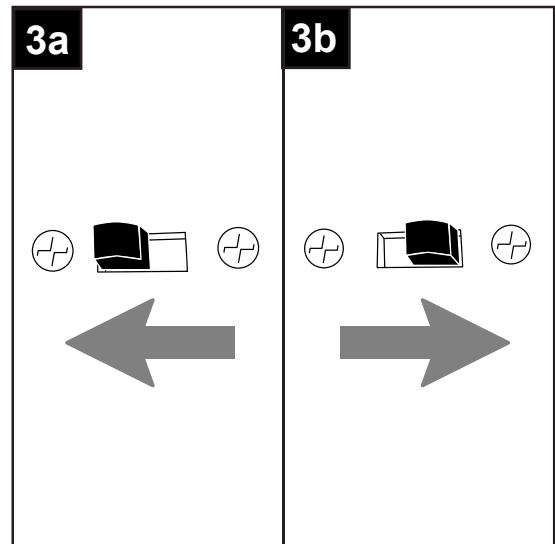

3c. **IMPORTANT:** Reverse switch must be set either completely LEFT or completely RIGHT for fan to function. If the reverse switch is set in the middle position, fan will not operate.

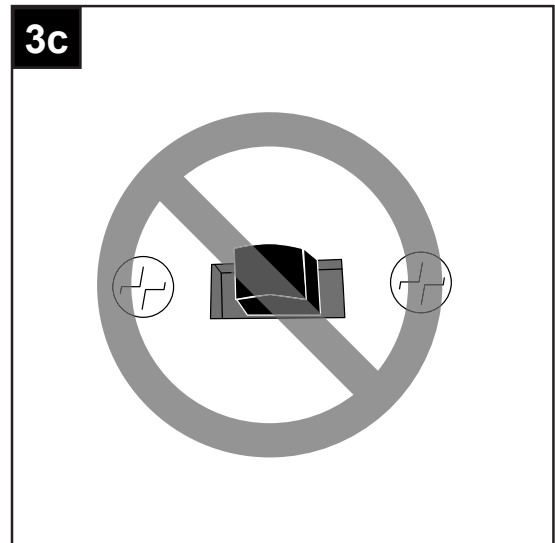

## CARE AND MAINTENANCE

---

At least twice each year, lower motor housing (B) to check mounting plate (A) assembly, and then tighten all screws. Clean motor housing (B) with only a soft brush or lint-free cloth to avoid scratching the finish. Clean blades (F) with a lint-free cloth. You may occasionally apply a light coat of furniture polish to wood blades for added protection.

**IMPORTANT:** Shut off main power supply before beginning any maintenance. Do not use water or a damp cloth to clean the ceiling fan.

- Total wattage for this fixture is 18 watts; do not attempt to replace the LEDs.

## TROUBLESHOOTING

**⚠ WARNING:** Before beginning work, shut off the power supply to avoid electrical shock.

PROBLEM	POSSIBLE CAUSE	CORRECTIVE ACTION
Fan does not move.	<ol style="list-style-type: none"> <li>1. Reverse switch not engaged.</li> <li>2. Power is off or fuse is blown.</li> <li>3. Faulty wire connection.</li> <li>4. Plugs in light kit fitter not connected properly.</li> </ol>	<ol style="list-style-type: none"> <li>1. Push switch firmly either left or right.</li> <li>2. Turn power on or check fuse.</li> <li>3. Turn power off. Loosen canopy and check all connections.</li> <li>4. Check that male and female plugs in light kit fitter are connected properly according to instructions on page 10.</li> </ol>
Noisy operation.	<ol style="list-style-type: none"> <li>1. Blades are loose.</li> <li>2. Cracked blade.</li> <li>3. Full range dimmer switch.</li> <li>4. Fan is new.</li> </ol>	<ol style="list-style-type: none"> <li>1. Tighten all blade screws.</li> <li>2. Replace blade.</li> <li>3. Replace with an approved speed control device.</li> <li>4. Allow fan a "break in" period of a few days, especially when running the fan at Medium and High speeds.</li> </ol>
Excessive wobbling.	<ol style="list-style-type: none"> <li>1. Blades are loose.</li> <li>2. Unbalanced blades.</li> <li>3. Fan not securely mounted.</li> </ol>	<ol style="list-style-type: none"> <li>1. Tighten all blade screws.</li> <li>2. Switch one blade with a blade from the opposite side.</li> <li>3. Turn power off. Carefully loosen motor housing and verify that mounting plate is secure.</li> </ol>
Fan operates but light fails.	<ol style="list-style-type: none"> <li>1. Wires in motor housing not wired properly.</li> <li>2. Wall switch to fan is off.</li> <li>3. Wires in LED light kit not wired correctly.</li> </ol>	<ol style="list-style-type: none"> <li>1. Check wires in motor housing and, if necessary, re-wire according to instructions on pages 7 and 8.</li> <li>2. Make sure that wall switch to fan is on.</li> <li>3. Check that molex connections in LED light kit are connected properly according to instructions on page 10.</li> </ol>

**NOTE:** A small amount of "wobble" is normal and should not be considered a defect.

## LIMITED LIFETIME WARRANTY

The distributor warrants this fan to be free from defects in workmanship and materials present at time of shipment from the factory for Lifetime limited from the date of purchase. This warranty applies only to the original purchaser. The distributor agrees to correct any defect at no charge or, at our option, replace the ceiling fan with a comparable or superior model.

To obtain warranty service, present a copy of your sales receipt as proof of purchase. All cost of removal and reinstallation are the express responsibility of the purchaser. Any damage to the ceiling fan by accident, misuse or improper installation, or by using parts not produced by the manufacturer of this fan or affixing accessories not produced by the manufacturer of this fan, are the purchaser's own responsibility. The distributor assumes no responsibility whatsoever for fan installation during the limited lifetime warranty. Any service performed by an unauthorized person will render the warranty invalid.

Due to varying climatic conditions, this warranty does not cover changes in brass finish, rusting, pitting, tarnishing, corroding or peeling. Brass finish fans maintain their beauty when protected from varying weather conditions. Any glass provided with this fan is not covered by the warranty.

Any replacement of defective parts for the ceiling fan must be reported within the first year from the date of purchase. For the balance of the warranty, call our customer service department (at **1-800-527-1292**) for return authorization and shipping instructions so that we may repair or replace the ceiling fan. Any fan or parts returned improperly packaged is/are the sole responsibility of the purchaser. There is no further express warranty. The distributor disclaims any and all implied warranties. The duration of any implied warranty which cannot be disclaimed is limited to the limited lifetime period as specified in our warranty. The distributor shall not be liable for incidental, consequential or special damages arising at or in connection with product use or performance except as may otherwise be accorded by law. This warranty gives you specific legal rights and you may also have other rights which vary from state to state. This warranty supersedes all prior warranties.

## REPLACEMENT PARTS LIST

For replacement parts, call our customer service department at **1-800-527-1292**, 8:30 a.m. - 5 p.m., CST, Monday - Friday.

PART	DESCRIPTION	PART #
A	Mounting Plate	5216229-A
C	Light Kit Fitter	5216229-C
F	Blade	5216229-F

