

allen + roth[®]

welcoming • sophisticated • inspiring

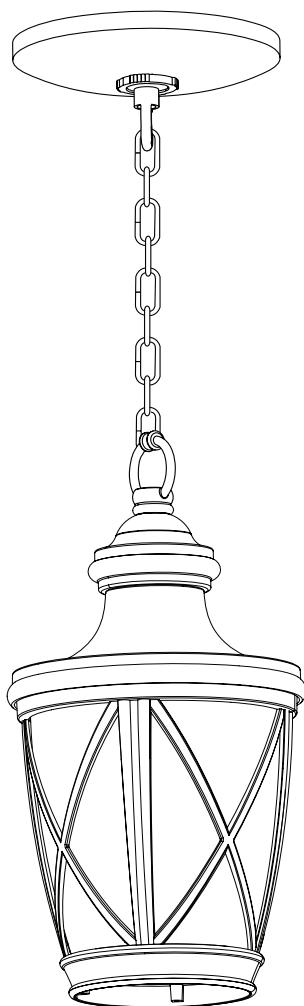

**RATED FOR
DAMP LOCATIONS**

ALLEN + ROTH and logo design are trademarks or registered trademarks of LF, LLC. All rights reserved.

ITEM #616267
MODEL #41995

HANGING LANTERN

Español p. 11

ATTACH YOUR RECEIPT HERE

Purchase Date _____

Thank you for purchasing this ALLEN + ROTH product.
Questions, problems, or missing parts?
Before returning, contact at:
866-439-9800, 8 a.m. - 8 p.m., EST, Monday - Sunday or **ascs@lowes.com**.

SG24886

TABLE OF CONTENTS

Package Contents. 3

Hardware Contents. 3

Preparation 3

Safety Information. 4

Assembly Instructions. 5

Troubleshooting. 10

Warranty. 10

PACKAGE CONTENTS

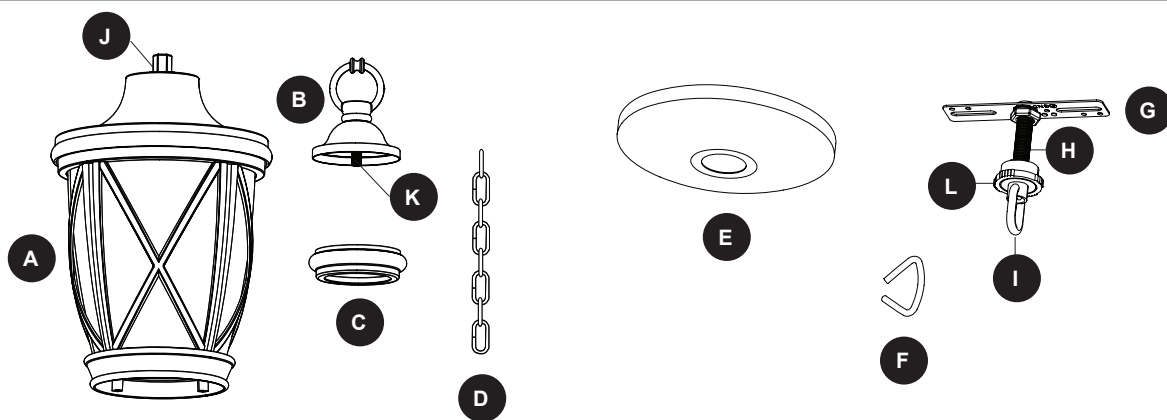

PART	DESCRIPTION	QUANTITY
A	Fixture	1
B	Finial	1
C	Decorative Ring	1
D	Chain	1
E	Ceiling Plate	1
F	Open Link	2
G	Mounting Bracket	1
H	Threaded Rod (preassembled to Mounting Bracket [G])	1
I	Chain Loop (preassembled to Threaded Rod [H])	1
J	Nut (preassembled to Fixture [A])	1
K	Threaded Rod (preassembled to Finial [B])	1
L	Decorative Nut (preassembled to Chain Loop [I])	1

HARDWARE CONTENTS

AA



Wire Connector
Qty. 3

RR



Mounting Screw
Qty. 2

PREPARATION

Estimated Assembly Time: 60 minutes

Tools Required for Assembly (not included):

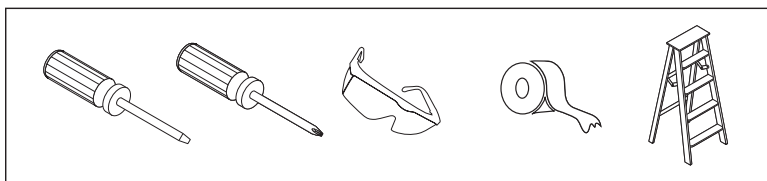

Helpful Tools (not included)

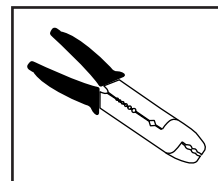

SAFETY INFORMATION

Please read and understand this entire manual before attempting to assemble, operate or install the product. Failure to do so could lead to electrical shock, fire or other injuries that could be hazardous or even fatal.

- Before you begin installing the light kit, disconnect the power by removing fuses or turning off the circuit breakers.
- Make sure that all electrical connections comply with local codes, ordinances, the National Electrical Code, and ANSI/NFPA 70-199. Hire a qualified electrician or consult a do-it-yourself wiring handbook if you are unfamiliar with installing electrical wiring.
- The net weight of the light kit is 5.85 lbs.

LISTED FOR DAMP LOCATION



DANGER:

- DO NOT connect this fixture to an electrical system that does not provide a means for equipment grounding. Never use a fixture in a two-wire system that is not grounded. Installing a fixture into an electrical system not having a proper grounding means could cause metal parts of the fixture to carry electrical currents if any of the fixture wires, wire connections or splices were to become broken, cut or loose during the mounting or normal operation of the fixture. Under this condition, anyone coming in contact with the fixture would be subject to electrical shock, which could cause serious injury or death.
- DO NOT connect the bare or green insulation fixture ground wire to the black (hot) current-carrying wire or the white neutral house wire. Connection of the bare or green fixture ground wire to the black or white house wires may cause metal parts of the fixture to carry electrical currents. Under this condition anyone coming in contact with the fixture will receive electrical shock, which could cause serious injury or death.
- DO NOT damage or cut the wire insulation (covering) during installation of the fixture. DO NOT permit wires to contact any surface having a sharp edge. To do so may damage or cut the wire insulation, which could cause serious injury or death from electrical shock.



WARNING:

- All electrical connections must be in agreement with local codes and ordinances, the National Electric Code (NEC) and ANSI/NFPA 70-1999. Contact your municipal building department to learn about your local codes, permits and/or inspections. Risk of fire - most dwellings built before 1985 have supply wire rated for 140°F. Consult a qualified electrician before installation.
- To avoid personal injury, the use of gloves may be necessary while handling fixture parts with sharp edges.
- DO NOT suspend any fixture by the house wires. A fixture must always be mounted directly to a an outlet box. Wire connectors will not support the weight of a fixture. Suspending a fixture by the house wires and wire connectors will result in the fixture falling, with the possibility of personal injury and the danger of electrical shock or fire.
- To reduce the risk of fire, electrical shock, or personal injury, each wire connector used with this light kit should accept only one 18-gauge wire from the light fixture and one 18-gauge wire from the outlet box. If there are three or more wires to connect or any of the wires is larger than 18 gauges, consult an electrician for the proper size wire connectors to use.

ASSEMBLY INSTRUCTIONS

1. Turn off the circuit breakers and the wall switch to the supply line leads.



DANGER: Failure to disconnect the power supply prior to installation may result in serious injury or death.

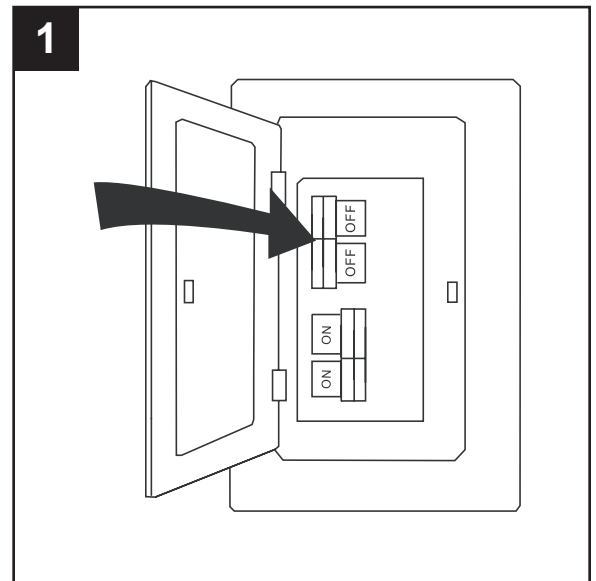

2. Feed the wires coming from the nut (J) through the decorative ring (C) and the threaded rod (K) and out of the top of the finial (B). **Important:** Orient the decorative ring (C) so the wide edge faces the fixture (A) and the narrow edge faces the finial (B).

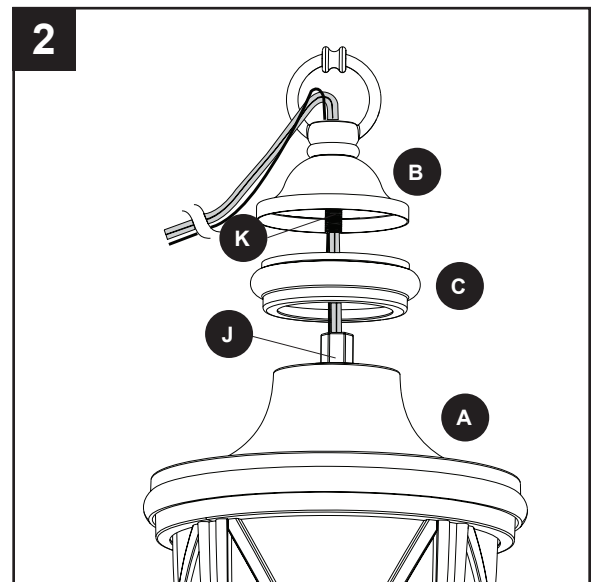

3. Remove the decorative nut (L) from the chain loop (I). Then, attach the mounting bracket (G) to the outlet box using the mounting screws (RR).

Hardware Used



Mounting
Screw



x 2

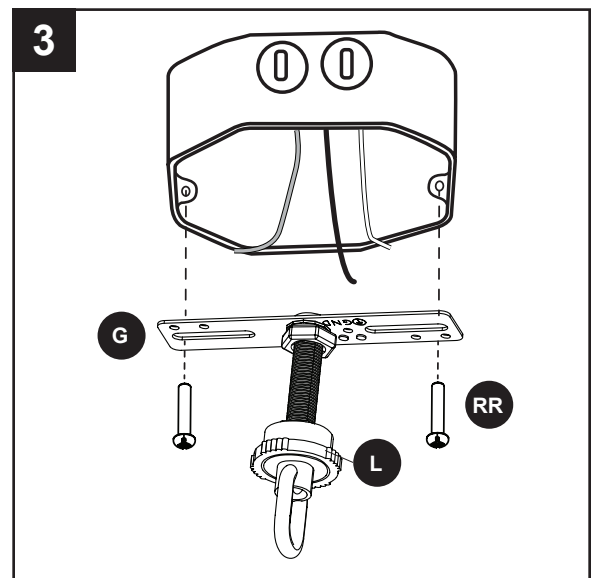

ASSEMBLY INSTRUCTIONS

4. If desired, shorten the chain (D) to desired length. Then, weave the wires from the finial (B) through the loops of the chain (D), decorative nut (L), and ceiling plate (E).

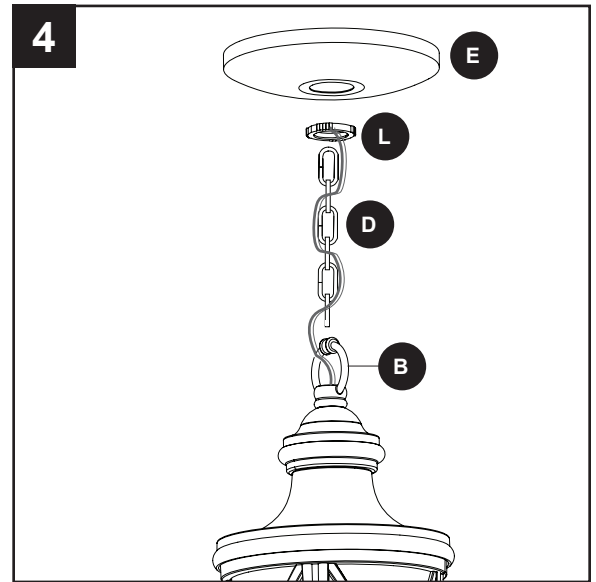

5. Use two open links (F) to attach the chain (D) to the finial (B) and chain loop (I). Twist the wire ends together and feed the wires through the hole in the center of the chain loop (I) and out through the hole in the mounting bracket (G).

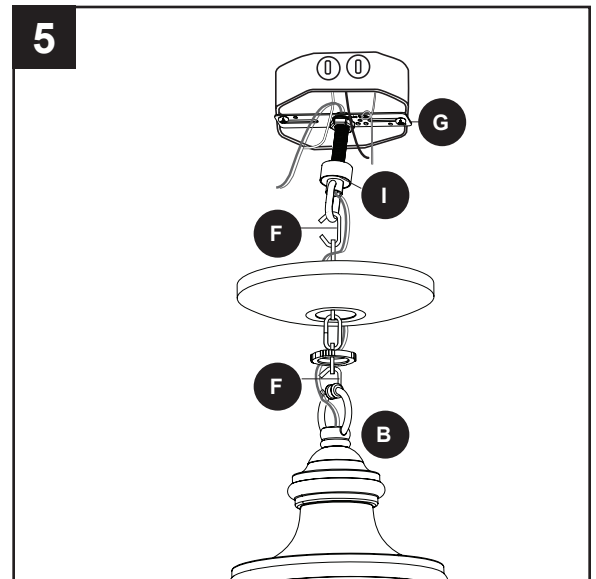

6. Use pliers (not included) to close the two open links (F).

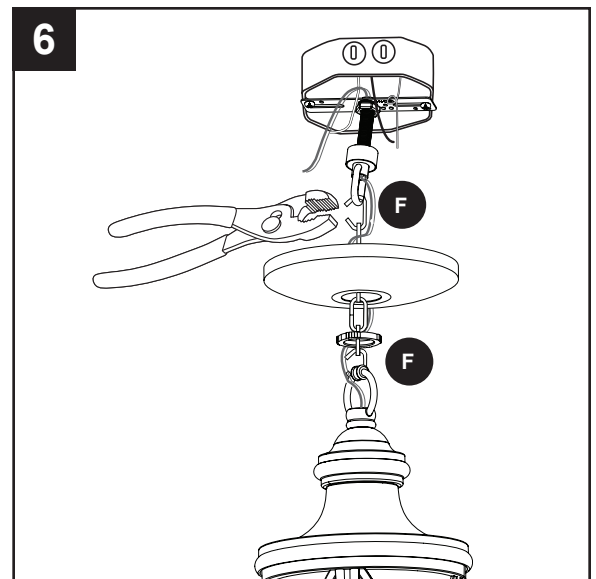

ASSEMBLY INSTRUCTIONS

- Depending on the length of chain (D) you use, you may need to cut the lead wires back to simplify the wiring. Take the lead wires and make sure that you have pulled them all the way through the top of the mounting bracket (G) and measure 8 in. of lead wire, and then cut the excess wire off with wire cutters (not included).

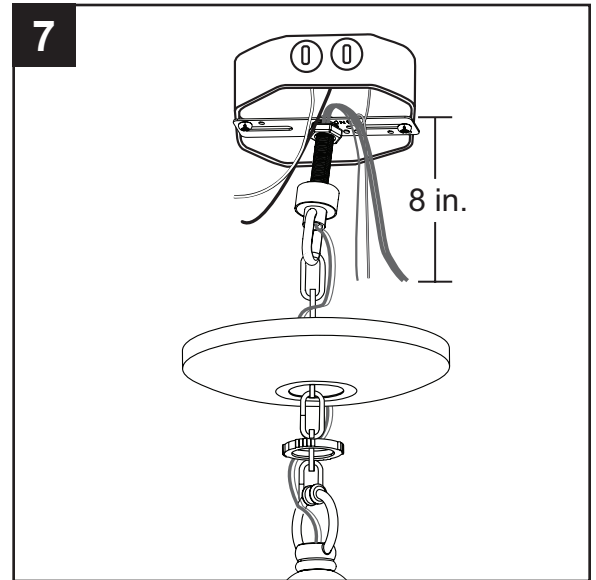

- Separate the two black wires all the way to the mounting bracket (G). Strip 1/2 in. of insulation from the end of the wires. Twist the stripped ends of each strand of wire within the insulation with pliers (not included).

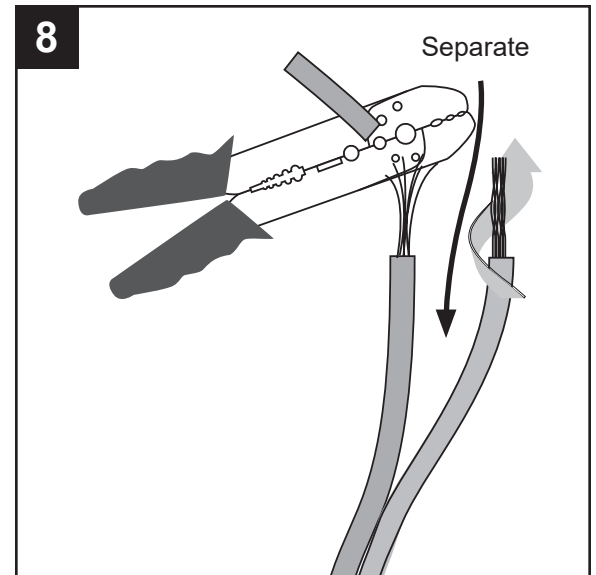

- Notice one wire is smooth and the other has ridges on one side.

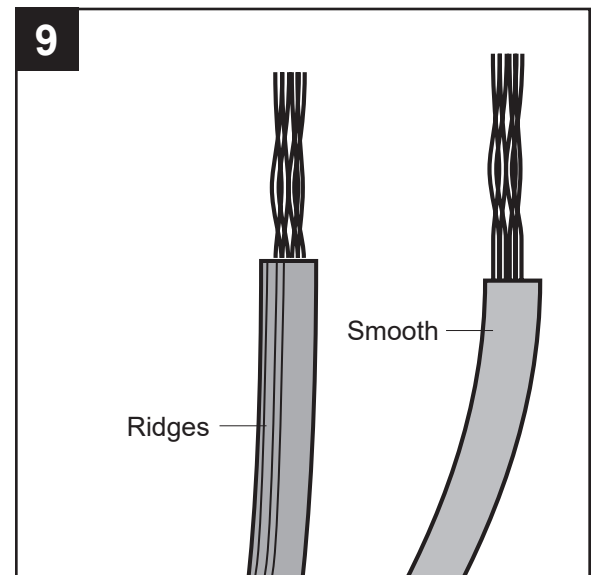

ASSEMBLY INSTRUCTIONS

10. Connect supply and fixture wires according to the diagram and these steps:
- Connect the Bare Copper from the fixture to the Bare/Green (ground) supply wire.
 - Connect the Black wire with ridges from the fixture to the White (neutral) supply wire.
 - Connect the Smooth Black wire from the fixture to the Black (hot) supply wire.

Secure all wiring connections together with wire connectors (AA).

Hardware Used



Wire Connector



x 3

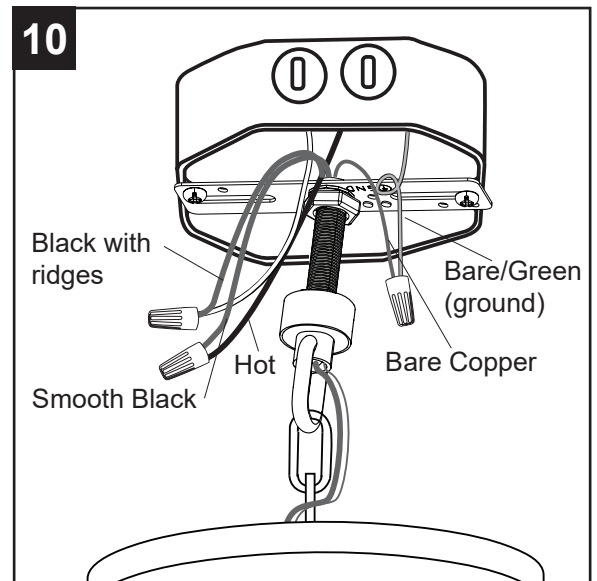

11. Wrap electrical tape (not included) around each individual wire connector (AA) down to the wire.

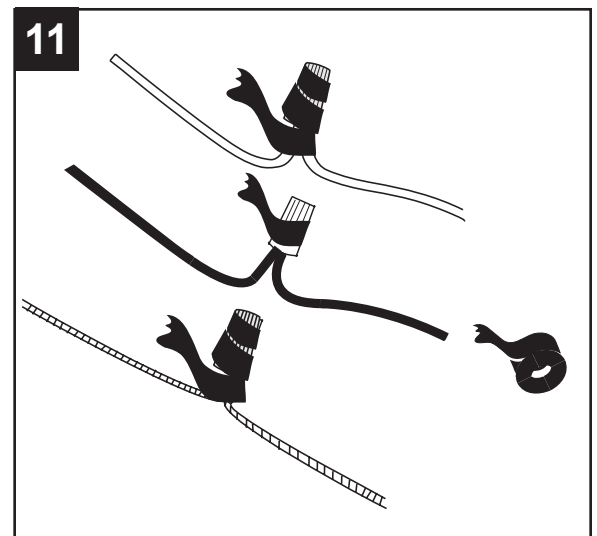

12. Turn the spliced/taped wires upward and gently push the wires and wire connectors (AA) into the outlet box.

WARNING: Ensure no bare wire strands are visible after making connections. Place the ground and neutral supply wire connections on opposite sides of outlet box from the hot wire connection.

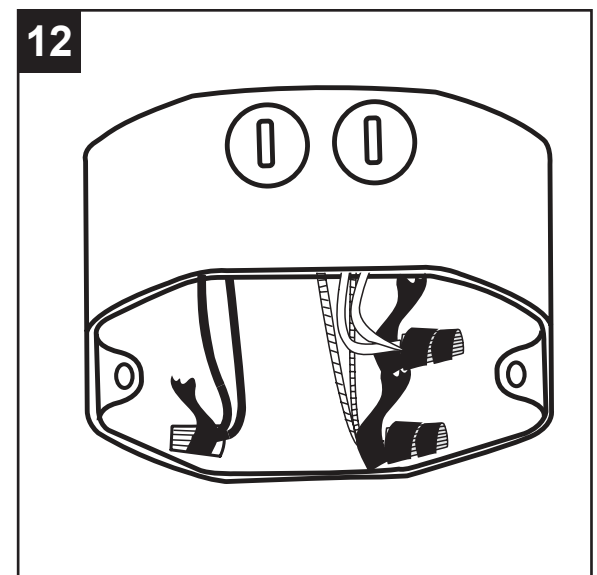

ASSEMBLY INSTRUCTIONS

13. Lift the ceiling plate (E) flush with the ceiling. Use the decorative nut (L) to secure the ceiling plate.

Note: The chain loop (I) was positioned on the threaded rod (H) at the factory. If your ceiling plate (E) doesn't sit flush with the ceiling, see Troubleshooting, page 10.

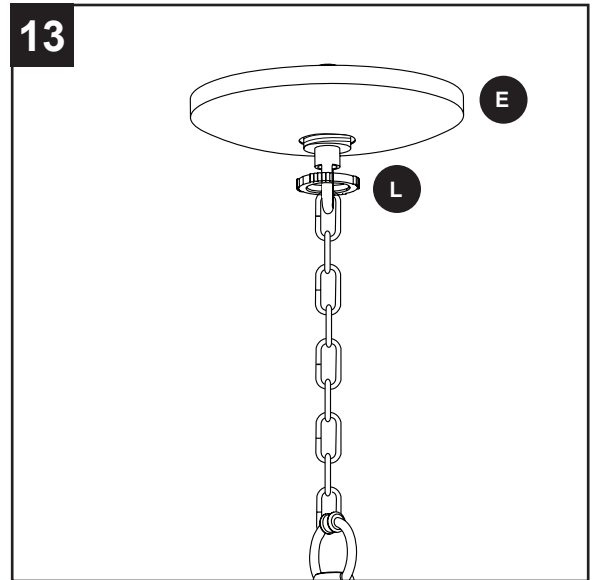

14. Insert the E26-base bulb (not included) into the socket of the fixture (A).

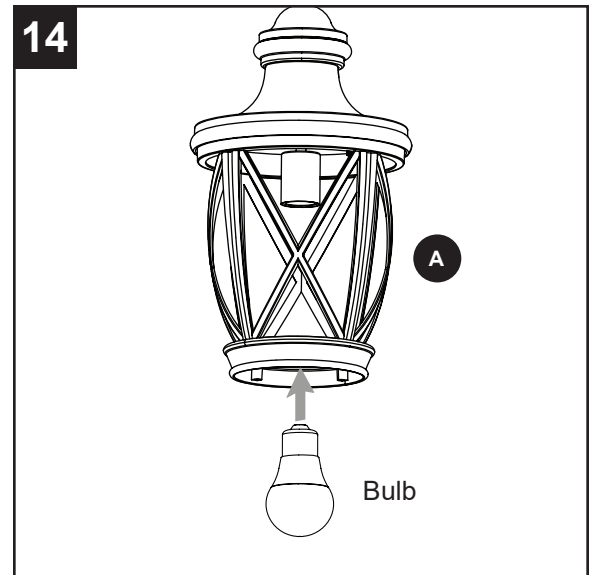

15. Restore the power to the circuit breakers and the wall switch to the supply line leads.

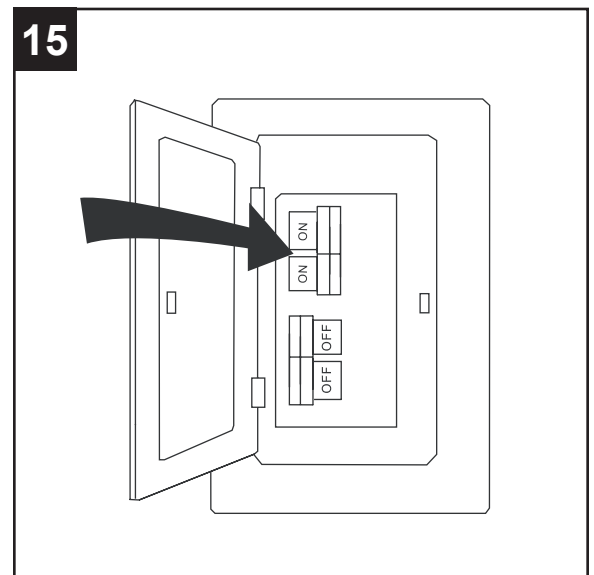

TROUBLESHOOTING

PROBLEM	POSSIBLE CAUSE	CORRECTIVE ACTION
Bulbs will not light.	1. Fixture may be wired incorrectly. 2. Worn or broken bulb.	1. Check wiring. 2. Replace bulb.
Ceiling Plate (E) does not sit flush with ceiling.	Edge of outlet box may not be flush with ceiling.	Remove the chain loop (I) from threaded rod (H) and adjust the hex nuts on the lower part of threaded rod. Reinstall the chain loop (I).

THREE-YEAR LIMITED WARRANTY

The manufacturer warrants all of its lighting fixtures against defects in materials and workmanship for three (3) years from the date of purchase. If within this period the product is found to be defective, take a copy of the bill of sale as a proof of purchase and the product in its original carton to the place of purchase. The manufacturer will, at its option, repair, replace or refund the purchase price to the consumer. All costs of installation and removal of the fixture is the responsibility of the consumer. This warranty does not cover fixtures becoming defective due to misuse, accidental damage or improper handling and/or installation and specifically excludes liability for direct, incidental or consequential damages. As some states do not allow exclusions of limitations on an implied warranty, the above exclusion and limitation may not apply. This warranty gives you specific rights and you may also have other rights which may vary from state to state.