

SAFAVIEH LIGHTING

Assembly Instruction

CAUTION: Read instruction carefully and turn electricity off at main circuit breaker panel before beginning installation.

ITEM#:LIT4192

Product Dimension: Ø16" X 11"H

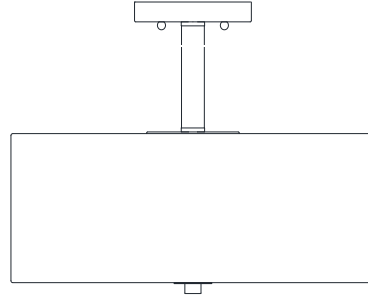

Care and Cleaning

To clean the outside of the fixture, use a dry or slightly dampened clean cloth(use clean water, never a solvent) to wipe the surface of the fixture.

To clear the inside of the fixture, first disconnect power to the fixture by turning off the circuit breaker or by removing the fuse at the fuse box. Next, use a dry or slightly dampened clean cloth(use clean water, never a solvent) to wipe the interior surface of the fixture

Do not use any cleaners with chemical, solvents or harsh abrasives. Use Only a dry soft cloth to dust or wipe carefully.

Estimated Assembly Time:30 minutes

Part List and Hardware List

PIECE	DESCRIPTION	PICTURE	QUANTITY	PIECE	DESCRIPTION	PICTURE	QUANTITY
A	Mounting Plate		1X	J	Tube		1X
B	Wire Nut		3X	K	Threaded Tube		2X
C	Mounting Screw		2X	L	Lamp Body		1X
D	Canopy		1X	M	Bulb		3X
E	Canopy Nut		2X	N	Diffuser		1X
F	Hex nut		1X	O	Rubber washer		1X
G	Spring washer		1X	P	Round Plate		1X
H	Flat washer		1X	Q	Finial		1X
I	Cover		1X				

Installation

Step 1

Unpack all parts from cartons carefully.
Separate the Mounting Plate(A) from the Canopy(D) by removing the Canopy Nut(E) anti-clockwise.

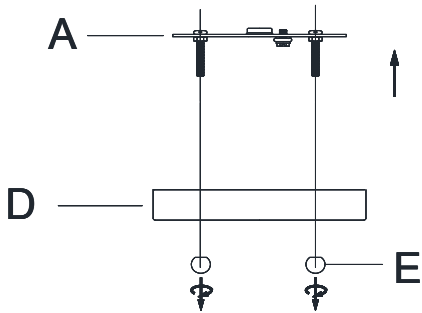

Step 2

Insert the J-box wires through the opening of Mounting Plate (A)
Attach the Mounting Plate (A) onto the J-box and secure it by turning the 2 Mounting Screws (C) clockwise until tight.

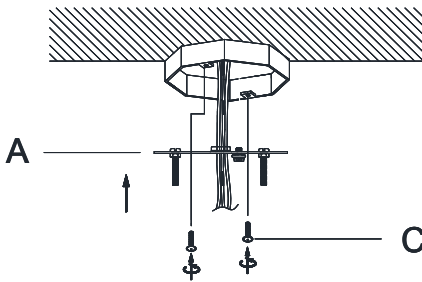

Step 3 Wire connection

Connect,Hot,Black or Red outlet Supply Wire to:	Connect,Neutral,White Outlet Supply Wire to:
Black	White
*Parallel Cord(round&smooth)	*Parallel Cord(square&ridged)
Clear,Brown,Gold or Black without Tracer(colored stripes)	Clear,Brown,Gold or Black without Tracer(colored stripes)
Insulated Wire(not green)with copper metal conductor	Insulated Wire(not green)with Silver metal conductor

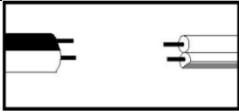

*Note: When parallel wire(SPTI&SPTII)is used. The neutral wire is square shaped and ridged and the hot wire will be round in shape and smooth.(See illustration on left)



Grounding Instructions:

- a) For installation in the United States: Wrap ground wire from outlet box around green ground screw on mounting bracket, no less than 2" from wire end. Tighten ground screw. If fixture is supplied with a ground wire, connect to outlet ground wire with a wire connector.
- b) For installation in Canada: If fixture is supplied with ground wire, wrap ground wire around green grounding screw on mounting bracket. Tighten ground screw.

Step 4

Insert the fixture wires through the Threaded Tube(K), rotate the Threaded Tube(K) clockwise till tight, then go ahead inserting the wires through the Tube(J), Cover(I) and Canopy(D).
Fix the Canopy(D) in place by inserting the wires through Flat Washer(H), Spring Washer(G) and Hex Nut(F), then rotate the Hex Nut(F) clockwise till tight.

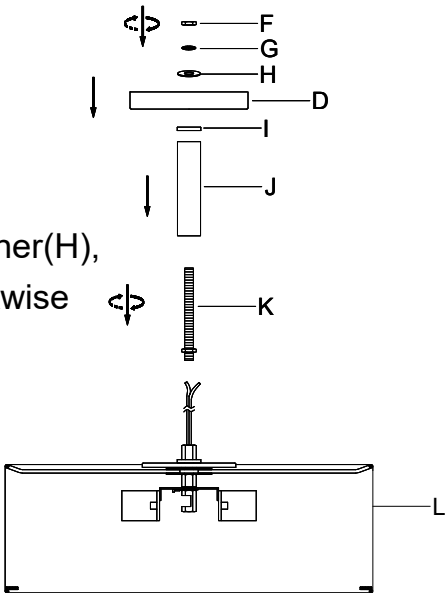

Step 5

Attach the Canopy(D) to the Mounting Plate (A) and fix it by turning the Canopy Nut (E) clockwise.

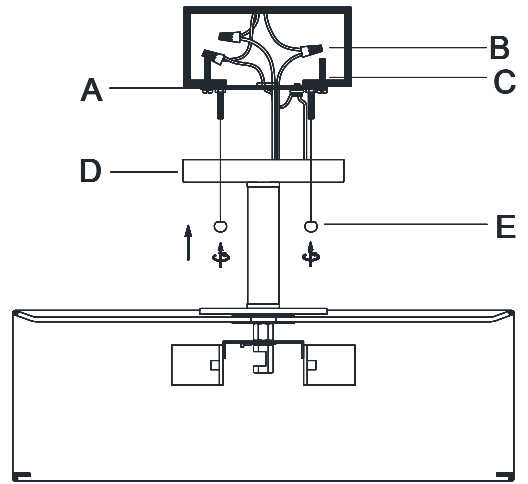

Step 6

Insert the Bulbs (M) into the Sockets as diagram.

**PLEASE USE TYPE "A" BULBS MAX 40-WATT OR CFL
BULBS MAX 13-WATT OR LED MAX 9-WATT
THERE ARE 3 X 9W LED BULBS IN THE BOX.**

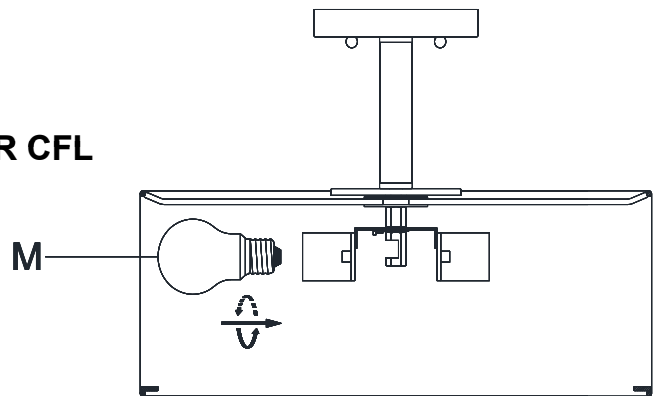

Step 7

Insert the Threaded Tube(K) into the nipple underneath the socket assembly, attach the Diffuser(N) through the Threaded Tube(K).

Fix the Diffuser(N) in place by placing Rubber Washer(O) first then Round Plate (P) to the threaded nipple of the Threaded Tube (K), rotate the Finial(Q) clockwise till tight.

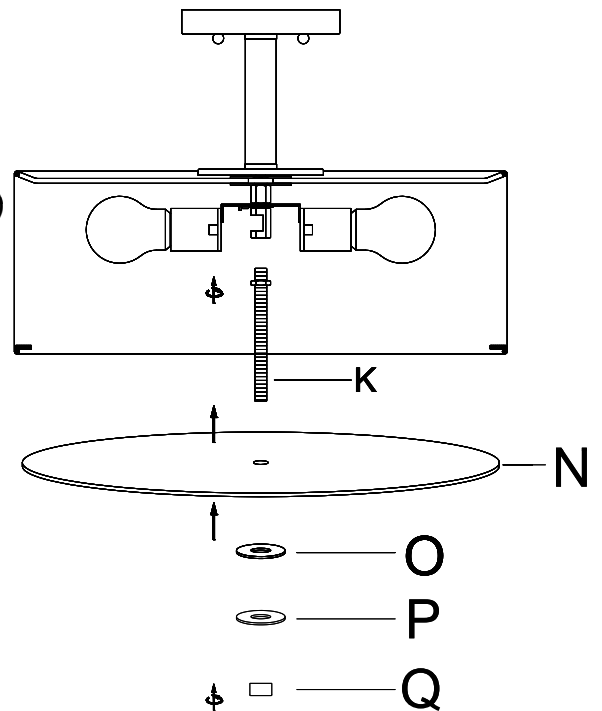

Step 8

Consult a qualified electrician to ensure correct branch circuit conductor

ENJOY YOUR LAMP