

PORTLIN LED CEILING FAN

Español p. 18

ATTACH YOUR RECEIPT HERE

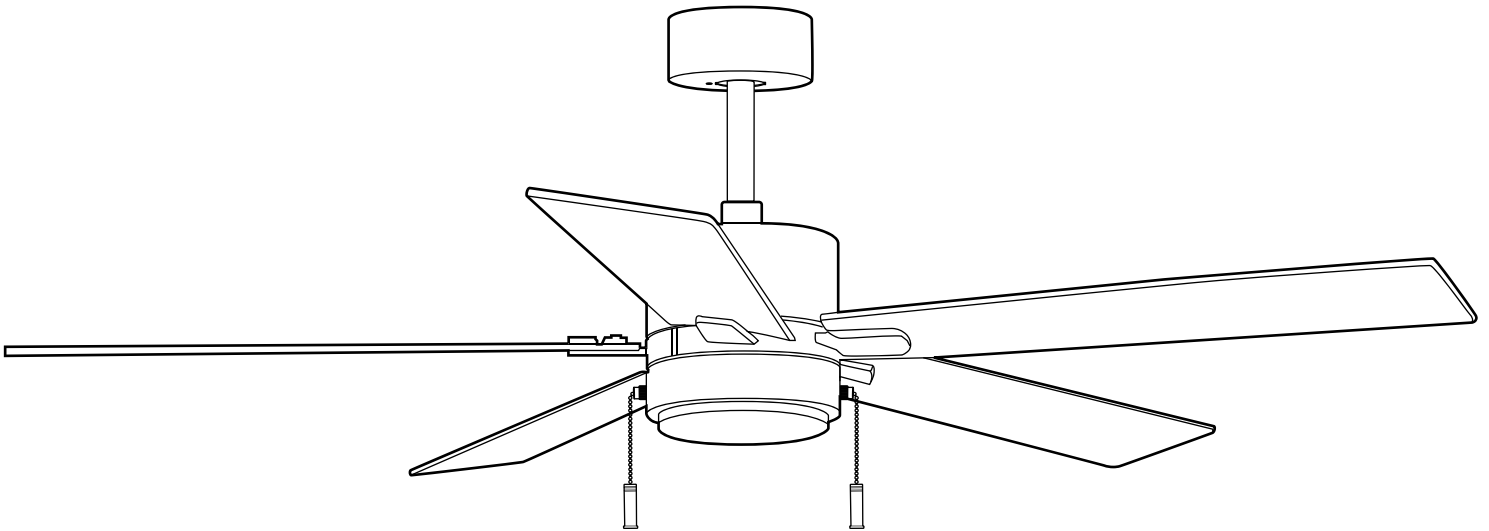

Purchase Date _____



Questions, problems, missing parts? Before returning, contact us on: **800-527-1292**,
8:30 a.m. - 5 p.m., CST, Monday - Friday.

TABLE OF CONTENTS

Safety Information	2
Package Contents	5
Hardware Contents	6
Preparation	6
Initial Installation	6
Wiring	11
Final Installation	13
Operating Instructions	14
Care and Maintenance	16
Troubleshooting	16
Limited Lifetime Warranty	17
Replacement Parts List	17



SAFETY INFORMATION



CAUTION: Changes or modifications not approved by the party responsible for compliance could void the user's authority to operate the equipment.

***NOTE:** This equipment has been tested and found to comply with the limits for a Class B digital device, pursuant to Part 15 of the FCC Rules. These limits are designed to provide reasonable protection against harmful interference in a residential installation. This equipment generates, uses and can radiate radio frequency energy and, if not installed and used in accordance with the instructions, may cause harmful interference to radio communications. However, there is no guarantee that interference will not occur in a particular installation. If this equipment does cause harmful interference to radio or television reception, which can be determined by turning the equipment off and on, the user is encouraged to try to correct the interference by one or more of the following measures:

- * Reorient or relocate the receiving antenna.
- * Increase the separation between the equipment and receiver.
- * Connect the equipment into an outlet on a circuit different from that to which the receiver is connected.

Consult the dealer or an experienced radio/TV technician for help.

The device complies with Part 15 of the FCC Rules. Operation is subject to the following two conditions: (1) this device may not cause harmful interference, (2) this device must accept any interference received, including interference that may cause undesired operation.

Distributed by: Litex Industries Inc., P.O. Box 535639, Grand Prairie, TX, 75050; 800-527-1292

NOTE: Dimmable to 10%.

SAFETY INFORMATION

Please read and understand this entire manual before attempting to assemble, install or operate the product. Review the accompanying assembly diagrams.

- Do not discard fan carton or inserts. Should this fan need to be returned to the factory for repairs, it must be shipped in its original packaging to ensure proper protection against damage that might exceed the initial cause for return.
- Make sure all electrical connections comply with local codes, ordinances, the National Electrical Code and ANSI/NFPA 70-1999. Hire a qualified electrician or consult a do-it-yourself wiring handbook if you are unfamiliar with installing electrical wiring.
- Make sure the installation site you choose allows a minimum clearance of 7 ft. from the blades to the floor and at least 30 in. from the end of the blades to any obstruction.
- After you install the fan, make sure all connections are secure to prevent the fan from falling.
- The net weight of this fan including the light kit is: 13.89 lbs.

DANGER

When using an existing outlet box, make sure the outlet box is securely attached to the building structure and can support the full weight of the fan. Failure to do this can result in serious injury or death. The stability of the outlet box is essential in minimizing wobble and noise in the fan after installation is complete.

Before installation, be sure to shut off electricity at main switch or circuit breaker in order to avoid electrical shock.

To reduce the risk of serious bodily injury, DO NOT use power tools to assemble any part of the fan, including the blades.

WARNING



To reduce the risk of fire, electrical shock or personal injury, mount fan to outlet box marked "ACCEPTABLE FOR FAN SUPPORT OF 35 LBS. (15.9 KG) OR LESS" and use mounting screws provided with the outlet box. Most outlet boxes commonly used for the support of lighting fixtures are not acceptable for fan support and may need to be replaced. Consult a qualified electrician if in doubt.

When mounting fan to a ceiling outlet box, use a METAL octagonal outlet box; do NOT use a plastic outlet box. Secure the outlet box directly to the building structure. The outlet box and its support must be able to support the moving weight of the fan (at least 35 lbs.).

To avoid personal injury, the use of gloves may be necessary while handling fan parts with sharp edges.

To reduce the risk of fire, electrical shock or personal injury, lever wire connectors provided with this fan are designed to accept only one 12-gauge house wire and one lead wire from the fan. If your house wire is larger than 12-gauge or there is more than one house wire to connect to the corresponding fan lead wires, consult an electrician for the proper size wire connectors to use.

WARNING

To reduce the risk of fire or electrical shock, do not use the fan with any solid state speed control device or control fan speed with a full range dimmer switch.

To reduce the risk of fire, electrical shock or personal injury, do not bend the blades when installing them, balancing the blades or cleaning the fan. Do not insert objects between the rotating fan blades.

To reduce the risk of personal injury, use *ONLY* parts provided with this fan. The use of parts *OTHER* than those provided with this fan will void the warranty.

CAUTION

Be sure outlet box is properly grounded and that a ground wire (GREEN or BARE) is present.

Once installation is complete, carefully check all screws, bolts and nuts on fan motor assembly to ensure that they are secured.

Do NOT tamper with or attempt to repair LED component. The light source is designed for this specific application and should not be serviced by untrained personnel. If any servicing is required, call our customer service department.

PACKAGE CONTENTS

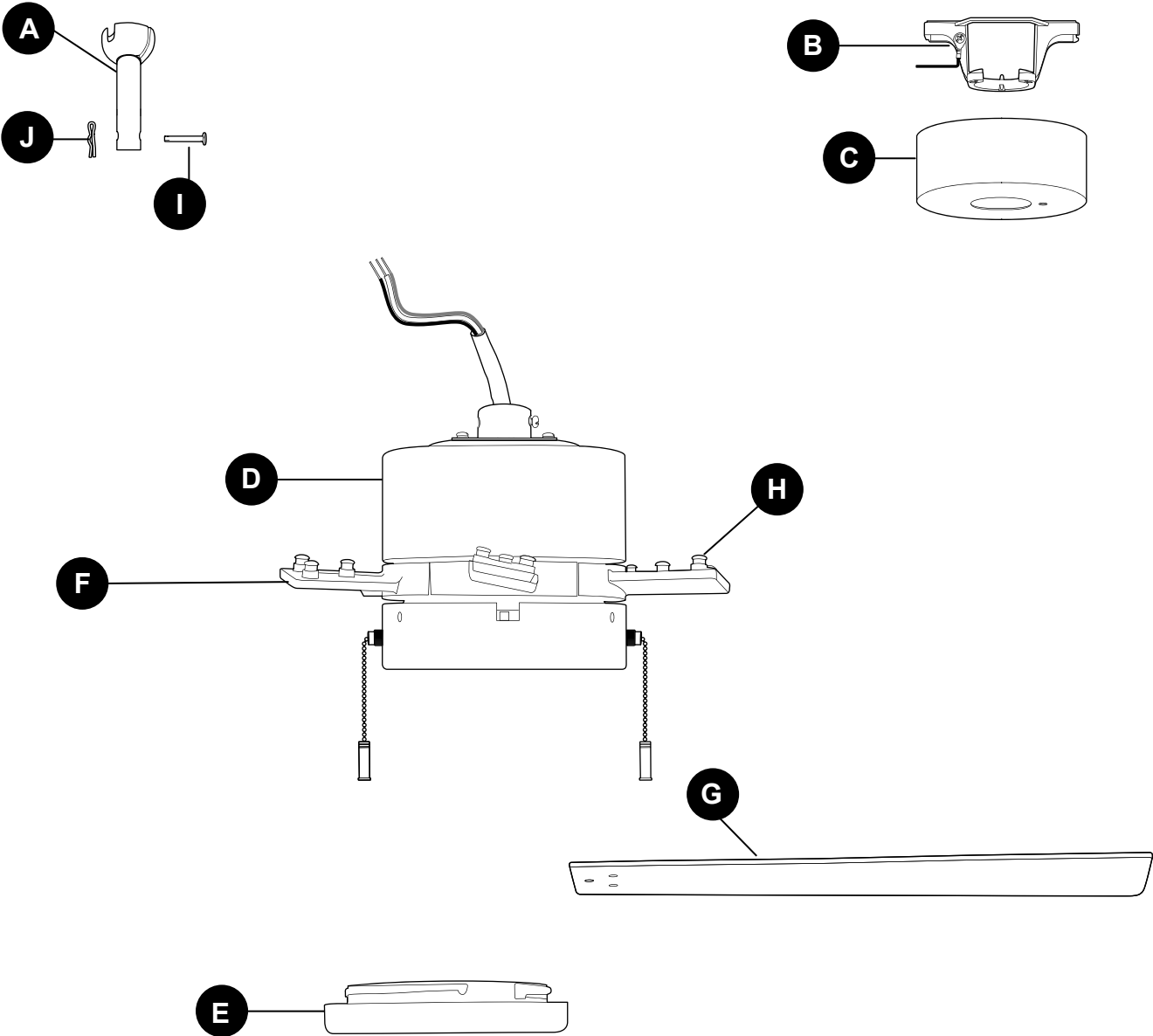

PART	DESCRIPTION	QUANTITY
A	Downrod	1
B	Mounting Bracket	1
C	Canopy	1
D	Motor Housing	1
E	Shade	1

PART	DESCRIPTION	QUANTITY
F	Blade Arm (preassembled)	5
G	Blade	5
H	Blade Screw (preassembled)	15
I	Pin (preassembled)	1
J	Clip (preassembled)	1

⚠ IMPORTANT REMINDER: You must use the parts provided with this fan for proper installation and safety.

HARDWARE CONTENTS (shown actual size)

AA

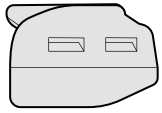

Lever Wire
Connector

Qty. 5

BB

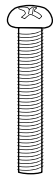

Canopy Mounting
Screw

Qty. 1

CC

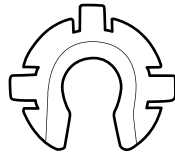

Three-C
Clip

Qty. 15
+ 1 extra

DD

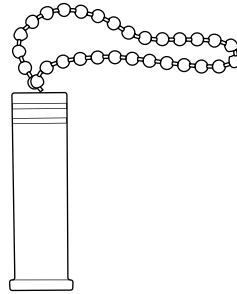

Pull Chain
Extension

Qty. 2

PREPARATION

Before beginning assembly of product, make sure all parts are present. Place motor on carpet or on foam to avoid damage to finish. Compare parts with package contents list and hardware contents list. If any part is missing or damaged, do not attempt to assemble the product.

Estimated Assembly Time: 120 minutes

Tools Required for Assembly (not included): Electrical Tape, Phillips Screwdriver, Pliers, Safety Glasses, Wire Strippers and Stepladder

Helpful Tools (not included): AC Tester Light, Tape Measure, Do-It-Yourself Wiring Handbook and Wire Cutters

INITIAL INSTALLATION

1. Turn off circuit breakers and wall switch to the fan supply line leads.

! DANGER: Failure to disconnect power supply prior to installation may result in serious injury or death.

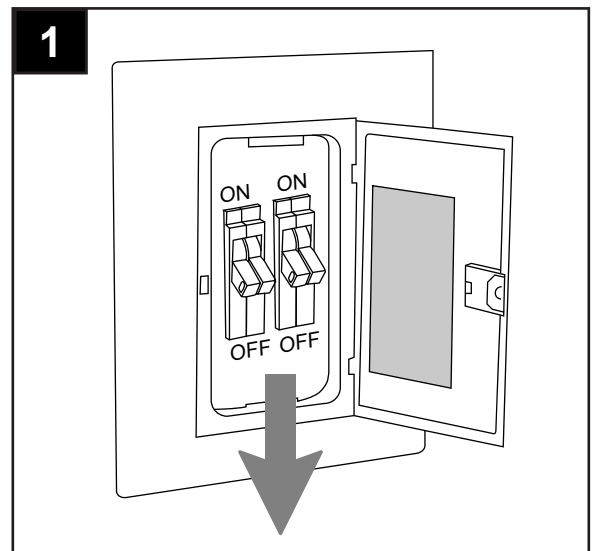

INITIAL INSTALLATION

2. If applicable, remove existing fan and fan parts, including the mounting bracket, from outlet box and disconnect all electrical wiring.

⚠ WARNING: To reduce the risk of personal injury, use *ONLY* parts provided with your new fan. The use of parts *OTHER* than those provided with this fan will void the warranty.

Set aside screws, spring washers and flat washers (provided with the outlet box) for fan installation.

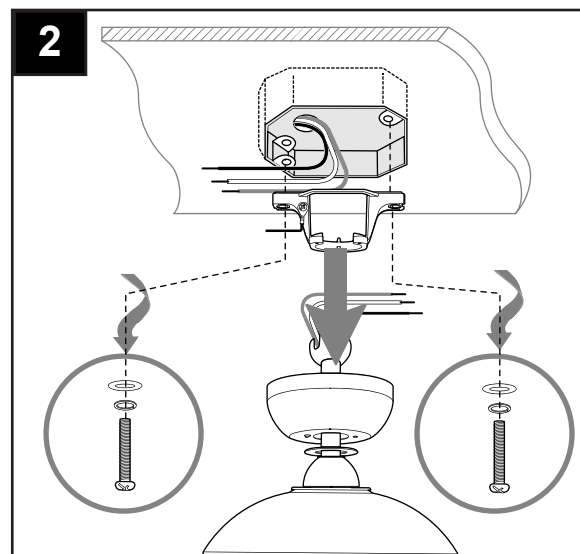

3. Determine mounting method to use for new fan.
 - A. Standard mount
 - B. Angle mount

IMPORTANT: If using the angle mount, ensure the ceiling angle is not steeper than 19°.

NOTE: Closemount option is not available for this fan.

***Helpful Hint:** Downrod-style mounting is best suited for ceilings 8 ft. high or higher. For taller ceilings you may want to use a longer downrod (not included). Angle-style mounting is best suited for angled or vaulted ceilings. A longer downrod is sometimes necessary to ensure proper blade clearance.

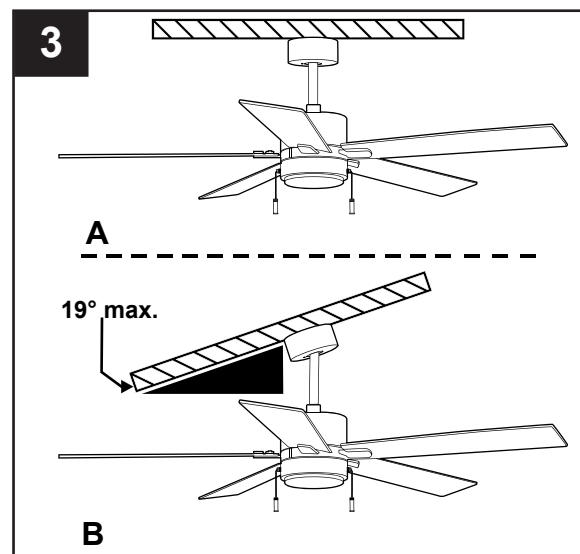

4. Check to make sure blades (G) will be at least 30 inches from any obstruction. Check downrod (A) length to ensure blades (G) will be at least 7 ft. above the floor.

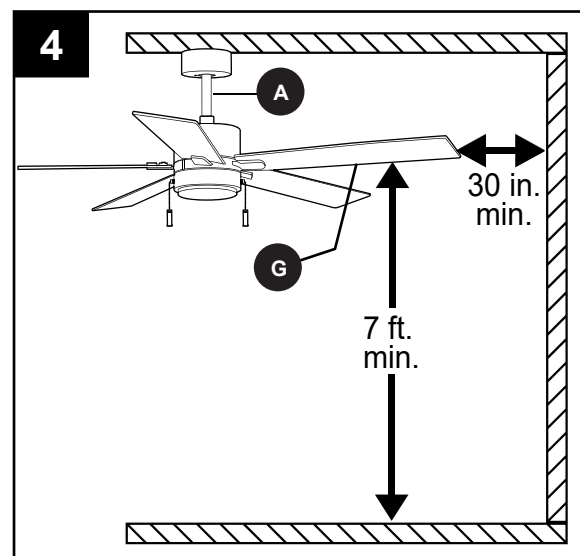

INITIAL INSTALLATION

5. Secure mounting bracket (B) to outlet box (not included) using screws, spring washers and flat washers provided with the outlet box.

***NOTE:** It is very important you use the proper hardware when installing the mounting bracket (B) as this will support the fan.

IMPORTANT: If using the angle mount, make sure open end of mounting bracket (B) is installed facing the higher point of the ceiling, and ensure the ceiling angle is not steeper than 19°.

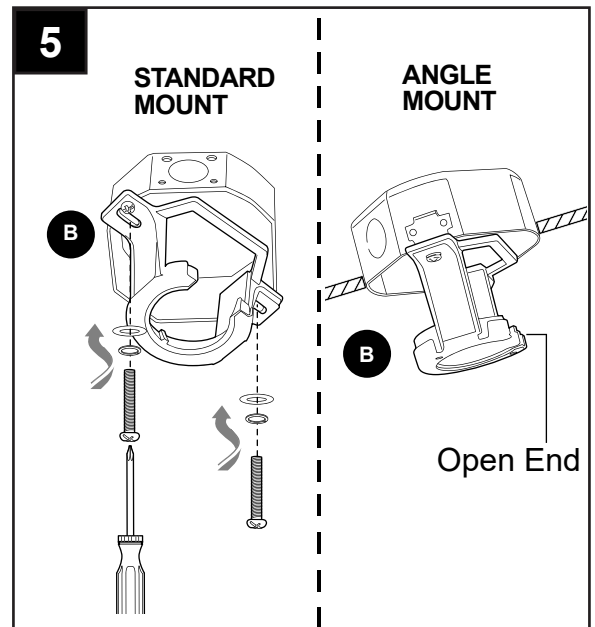

- 6a. Remove pin (I) and clip (J) from downrod (A).
- 6b. Partially loosen preassembled set screws and nuts in motor housing yoke at top of motor housing (D).

Remove all preassembled motor stabilization pieces from motor housing (D). The motor stabilization pieces may be discarded at this time.

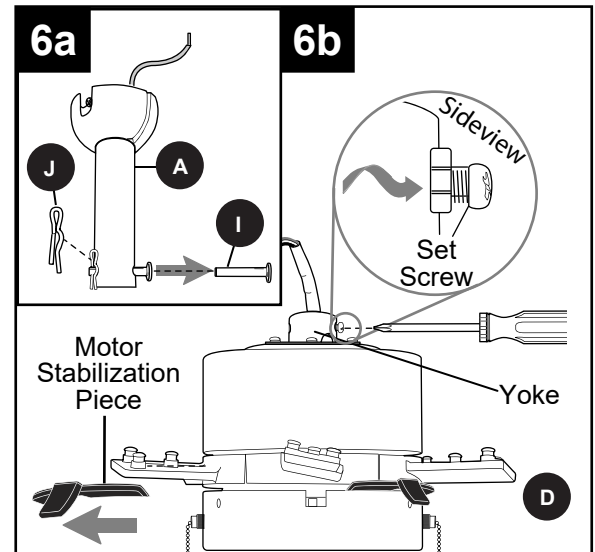

7. Insert downrod (A) through canopy (C).

Then, thread wires from motor housing (D) through downrod (A).

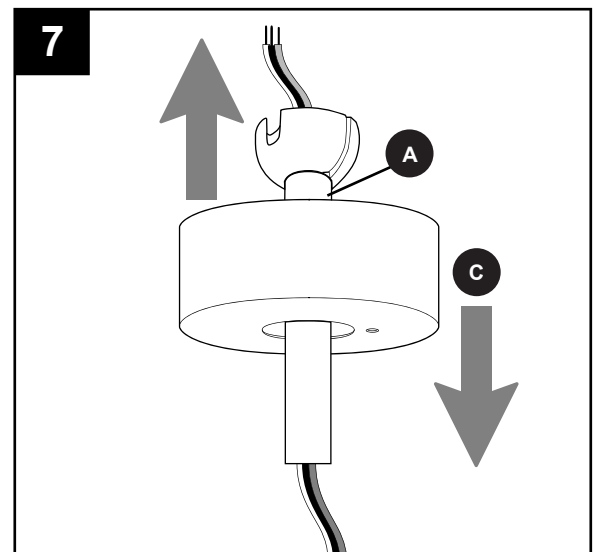

INITIAL INSTALLATION

8. Slip downrod (A) into motor housing yoke, align holes and re-install pin (I) and clip (J). Tighten set screws in motor housing yoke and then tighten preassembled nuts on the set screws.

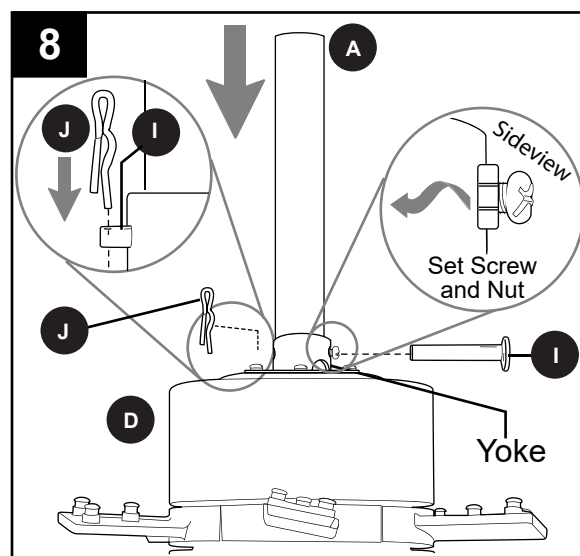

9. **CAUTION:** Do NOT attempt to loosen or remove preassembled blade screws (H) from preassembled blade arms (F).

Align the preassembled blade screws (H) on blade arms (F) with the holes on a blade (G).

Press down on the blade (G) firmly so the blade screws (H) come through the holes in the blade (G), then slide a three-C clip (CC) onto each blade screw (H), starting with the one in the middle. Slide three-C clips (CC) completely under blade screw (H) heads so edges of blade screw (H) heads are captured by the recessed groove on the three-C clips (CC).

Repeat for each blade (G).

WARNING: To reduce the risk of personal injury, make sure the friction detents on three-C clip (CC) face down and recessed groove faces up.

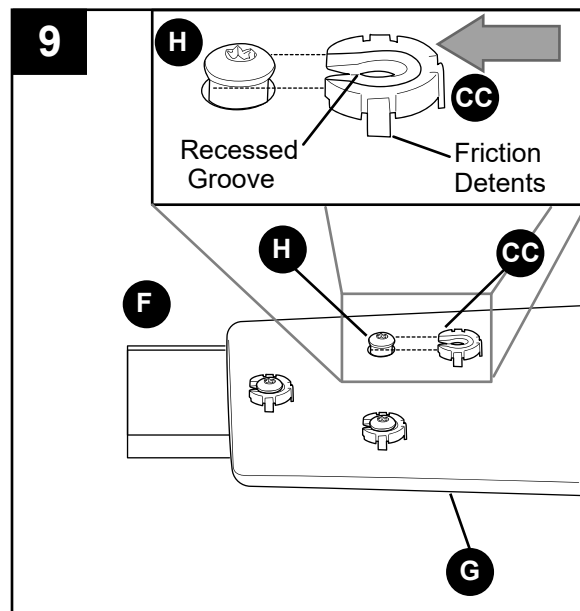

Hardware Used

CC Three-C clip

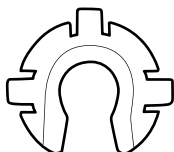

x 15

INITIAL INSTALLATION

10. Depending on the length of downrod you use, you may need to cut the lead wires back to simplify the wiring. If you decide to cut back the lead wires, it is suggested you do so in the following manner:

Take the lead wires and make sure you have pulled them all the way through the top of the downrod. Start at the TOP of the hanging ball on the downrod and measure 8 in. of lead wire, then cut the excess wire off with wire cutters (not included).

NOTE: If you do *not* cut back the lead wires, **Steps 10 and 11 are not necessary and you may proceed to Step 12 instead.**

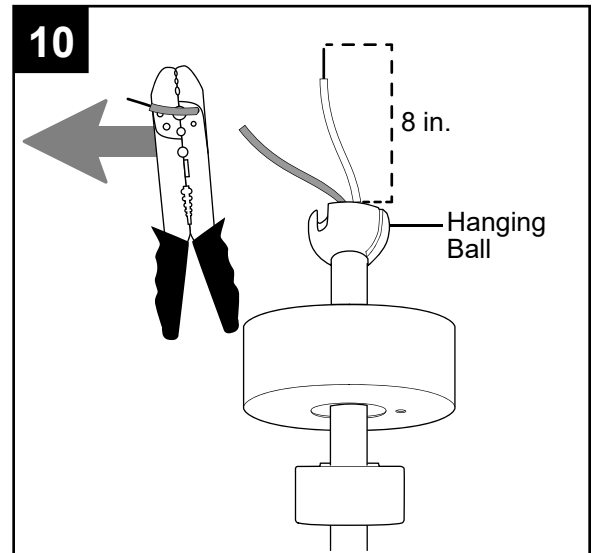

11. If you decided to cut back the lead wires in Step 10, strip 3/8 in. of insulation from end of each wire -- WHITE, BLACK, and BLUE (if applicable). Twist stripped ends of each strand of wire within the insulation with pliers (not included).

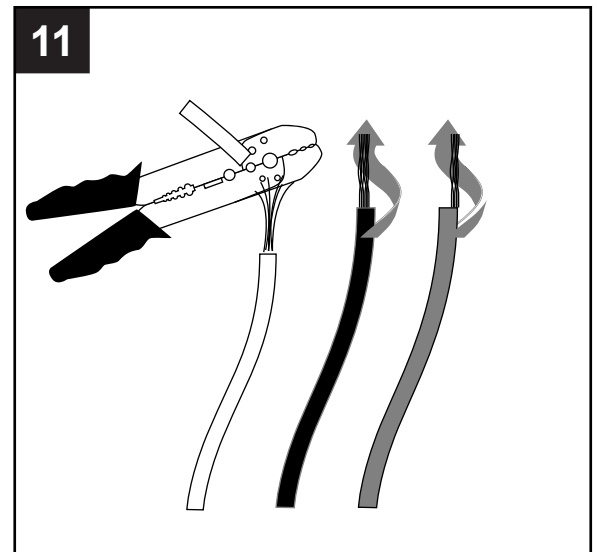

12. Install hanging ball of downrod (A) into opening of mounting bracket (B). Align the slot in hanging ball with the tab in mounting bracket (B).

⚠ DANGER: Failure to align the slot in hanging ball with the tab in mounting bracket (B) may result in serious injury or death.

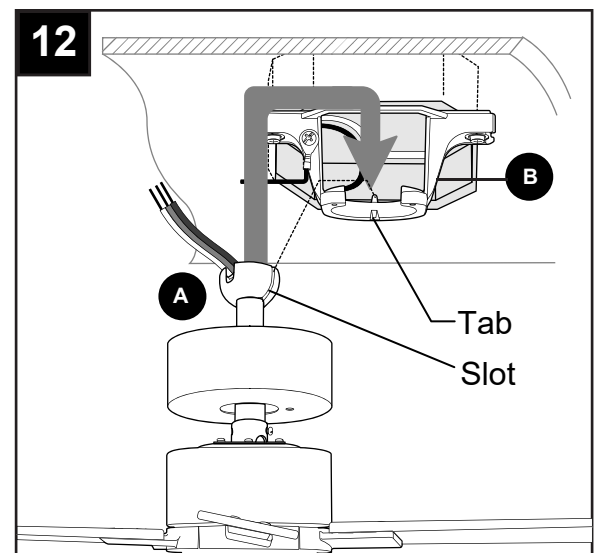

WIRING

⚠ WARNING: To reduce the risk of fire, electrical shock or personal injury, lever wire connectors provided with this fan are designed to accept only one 12-gauge house wire and one lead wire from the fan. If your house wire is larger than 12-gauge or there is more than one house wire to connect to the corresponding fan lead wires, consult an electrician for the proper size lever wire connectors to use.

⚠ CAUTION: Be sure outlet box is properly grounded and that a ground (GREEN or BARE) wire is present.

⚠ WARNING: If house wires are different colors than referred to in the following steps, stop immediately. A professional electrician is recommended to determine wiring.

⚠ WARNING: Using a full range dimmer switch (not included) to control fan speed will cause a loud humming noise from fan. To reduce the risk of fire or electrical shock, do NOT use a full range dimmer switch to control fan speed.

NOTE: This fan is remote control adaptable (remote control not included). Please refer to instructions provided with the remote control before proceeding with these wiring instructions.

1. **IMPORTANT:** Each wire connection is made by firmly raising the levers on each lever wire connector (AA), as shown. Then, ONE wire is inserted into each opening.

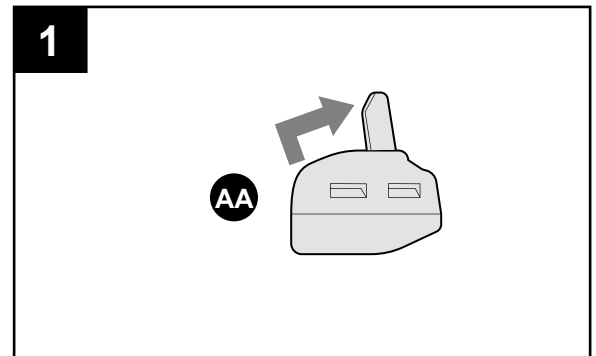

2. Choose wiring diagram (Fig. 2a, Fig. 2b or Fig. 2c) that fits your situation and make appropriate wiring connections per your selection in Step 2.

⚠ WARNING: In order for wire connections to be secure, all levers on the lever wire connectors (AA) must be completely returned to their original position as shown in the wiring diagram, option 2a, 2b or 2c, which corresponds to your wiring needs.

2a. FAN AND LIGHT CONTROLLED BY PULL CHAINS

CHAINS: Insert each GROUND (GREEN) wire from fan (on downrod (A) and mounting bracket (B)) and the BARE/GREEN wire from ceiling into openings in lever wire connector (AA) with three levers.

Insert BLACK wire and BLUE wire from fan and BLACK wire from ceiling into openings in lever wire connector (AA) with three levers.

Insert WHITE wire from fan and WHITE wire from ceiling into openings in lever wire connector (AA) with two levers.

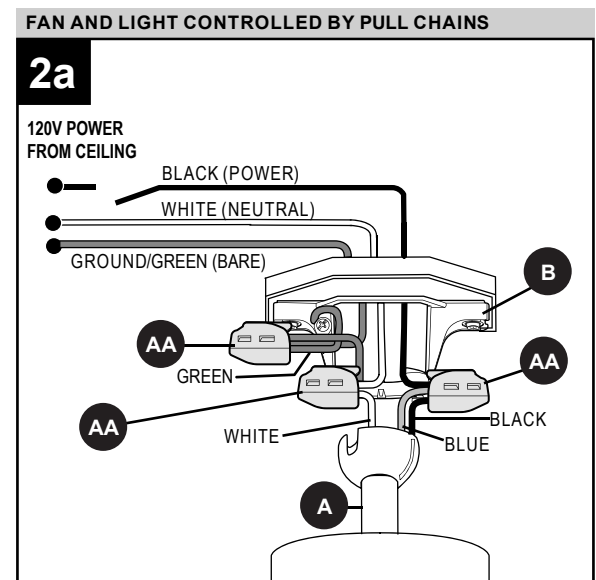

WIRING

2b. FAN CONTROLLED BY PULL CHAIN, LIGHT BY WALL SWITCH: Insert each GROUND (GREEN) wire from fan (on downrod (A) and mounting bracket (B)) and the BARE/GREEN wire from ceiling into openings in lever wire connector (AA) with three levers.

Insert BLACK wire from fan and BLACK wire from ceiling into openings in lever wire connector (AA) with two levers.

Insert WHITE wire from fan and WHITE wire from ceiling into openings in lever wire connector (AA) with two levers.

Insert BLUE wire from fan and BLACK (or RED) wire from the independent wall switch for the light into openings in lever wire connector (AA) with two levers.

2c. FAN AND LIGHT CONTROLLED BY TWO WALL SWITCHES: Insert each GROUND (GREEN) wire from fan (on downrod (A) and mounting bracket (B)) and the BARE/GREEN wire from ceiling into openings in lever wire connector (AA) with three levers.

Insert BLACK wire from fan and BLACK (or RED) wire from the independent wall switch for the fan into openings in lever wire connector (AA) with two levers.

Insert BLUE wire from fan and BLACK (or RED) wire from the other independent wall switch for the light into openings in lever wire connector (AA) with two levers.

Insert WHITE wire from fan and WHITE wire from ceiling into openings in lever wire connector (AA) with two levers.

NOTE: BLACK wire is hot power for fan. BLUE wire is hot power for light kit. WHITE wire is common for fan and light kit. GREEN or BARE wire is GROUND.

⚠ WARNING: GENTLY pull on wire in each lever wire connector (AA) to confirm the lock is engaged and that all wires are secure.

Hardware Used

AA Lever Wire Connector

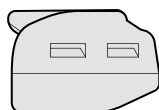

x 5

FAN CONTROLLED BY PULL CHAIN, LIGHT BY WALL SWITCH

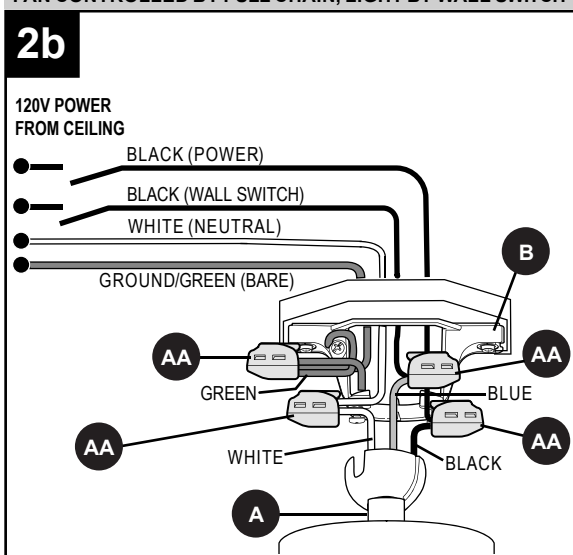

FAN AND LIGHT CONTROLLED BY TWO WALL SWITCHES

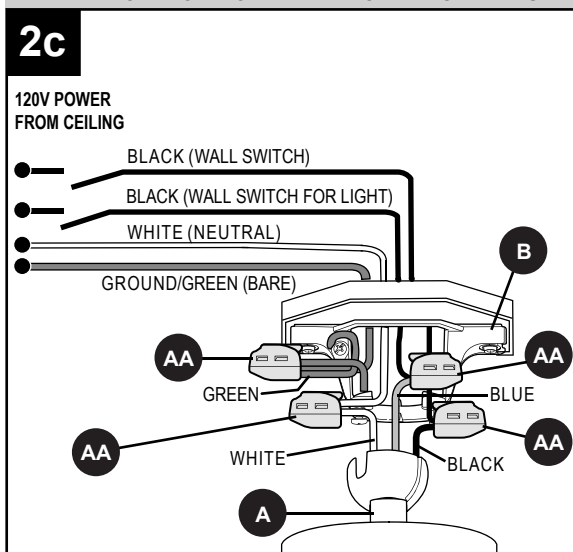

WIRING

3. Wrap electrical tape around each individual lever wire connector (AA) down to the wire.

⚠ WARNING: Make sure no bare wire or wire strands are visible after making connections. Place GREEN and WHITE connections on opposite side of box from the BLACK and BLUE (if applicable) connections.

Turn spliced/taped wires upward and gently push wires and lever wire connectors (AA) into outlet box.

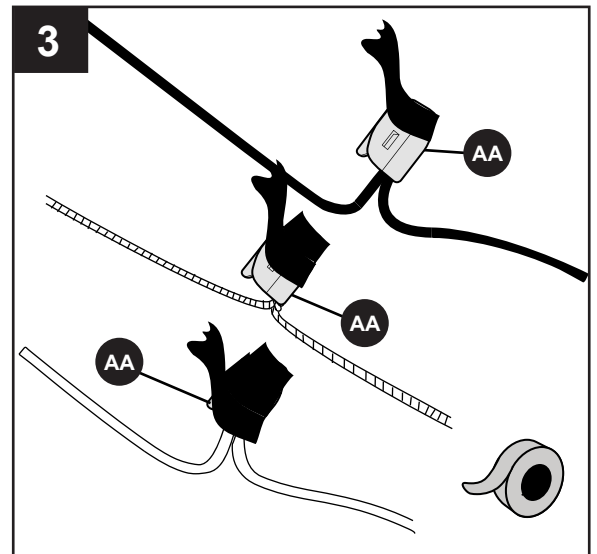

FINAL INSTALLATION

1. Lift canopy (C) to mounting bracket (B) aligning hole in canopy (C) with hole in mounting bracket (B). Insert canopy mounting screw (BB) and tighten securely.

Hardware Used

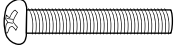
BB Canopy Mounting Screw  x 1

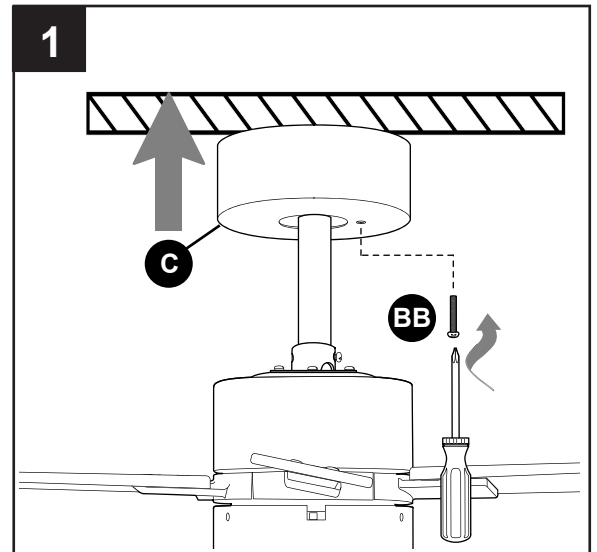

2. Align slots on shade (E) with protrusions on inside of light kit located on the underside of motor housing (D). Turn shade (E) *clockwise* until it no longer turns.

NOTE: Pull down gently on the shade (E) to make sure it is secured completely.

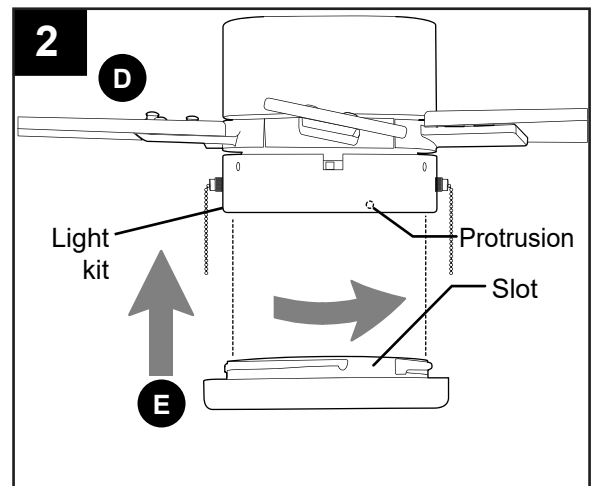

FINAL INSTALLATION

3. Attach pull chain extensions (DD) or custom pull chain extensions (not included) to corresponding fan and light pull chains.

Hardware Used

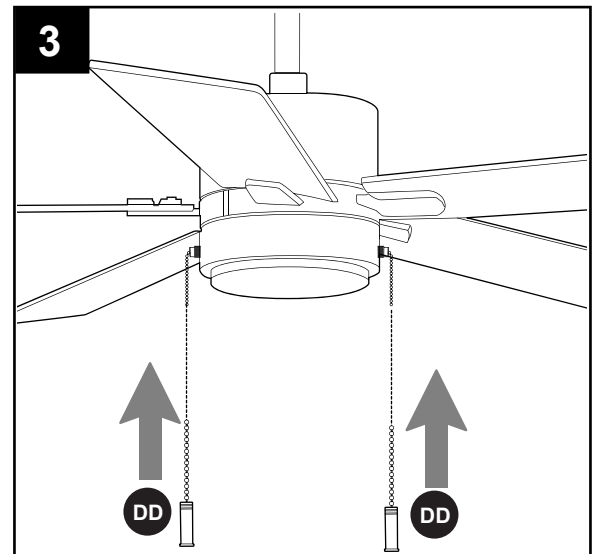
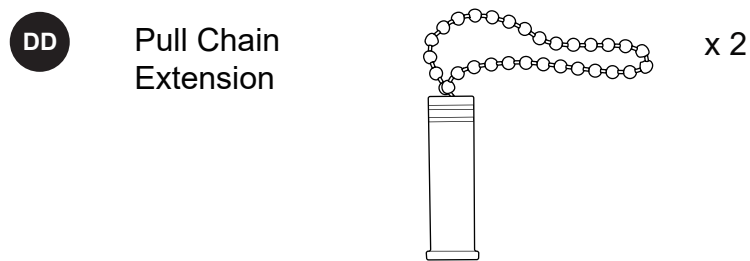

OPERATING INSTRUCTIONS

1. The pull chain located to the left of the reverse switch on the light kit is labeled FAN and has four positions to control fan speed. One pull is HIGH, two is MEDIUM, three is LOW and four turns the fan OFF.

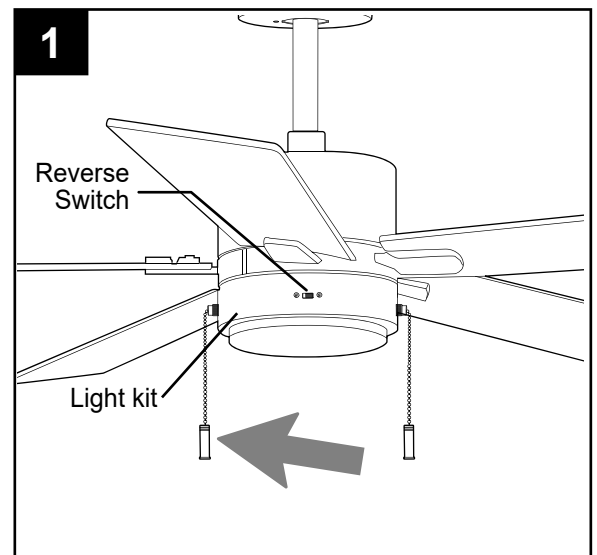

2. The pull chain located to the right of the reverse switch on the light kit is labeled LIGHT and is used to control the light.

To turn the light ON or OFF, simply pull down on and then let go of the light pull chain.

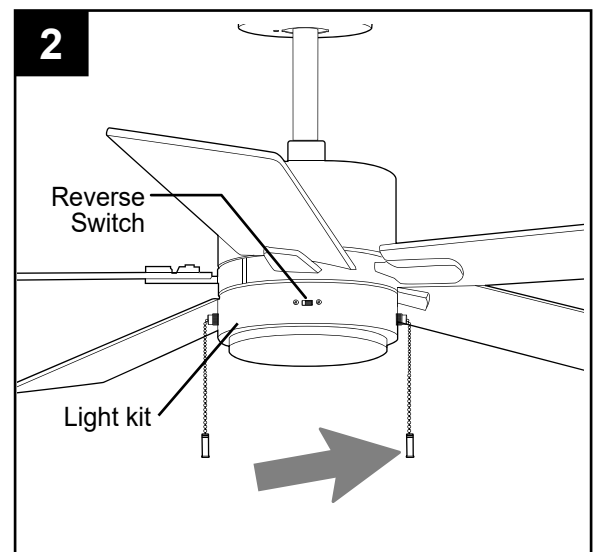

OPERATING INSTRUCTIONS

3. Use the fan reverse switch, located on the side of the light kit, located on the underside of motor housing (D), to optimize the fan for seasonal performance. A ceiling fan will allow you to raise your thermostat setting in summer and lower your thermostat setting in winter without feeling a difference in your comfort.

⚠ CAUTION: Turn fan off at wall switch and let blades (G) come to a complete stop before manually activating the reverse switch.

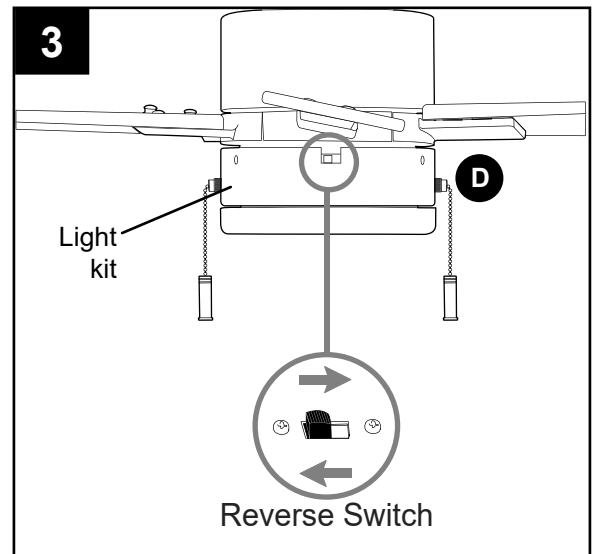

- 3a. In **warmer** weather, setting the reverse switch in the LEFT position will result in downward airflow creating a wind chill effect.

- 3b. In **cooler** weather, setting the reverse switch in the RIGHT position will result in upward airflow that can help move stagnant, hot air off the ceiling area.

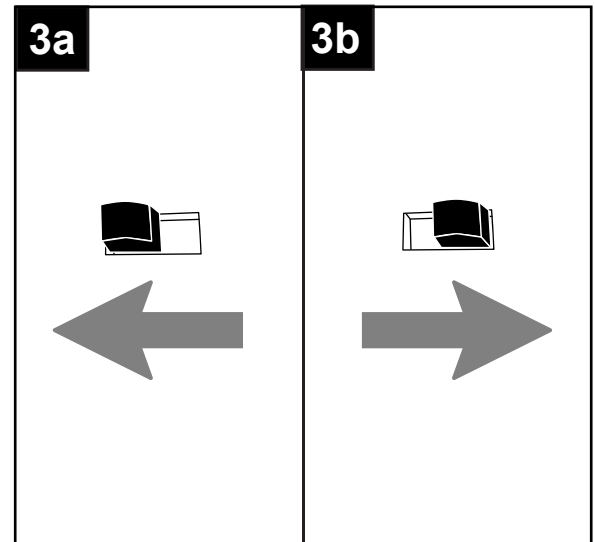

- 3c. **IMPORTANT:** Reverse switch must be set either **completely** LEFT or **completely** RIGHT for fan to function. If the reverse switch is set in the middle position, fan will not operate.

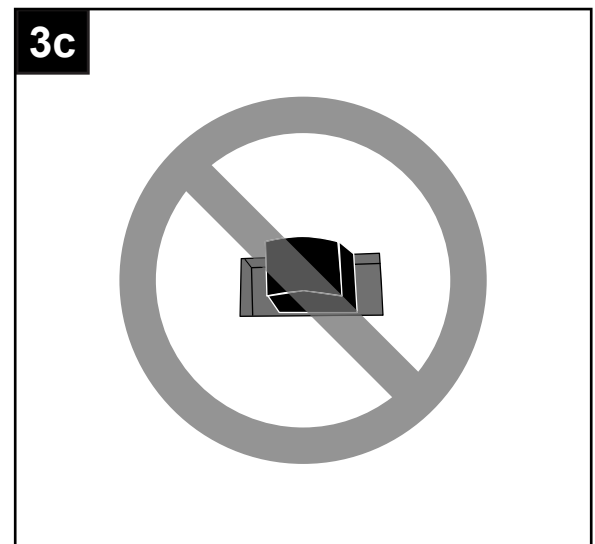

CARE AND MAINTENANCE

At least twice each year, lower canopy (C) to check downrod (A) assembly, and then tighten all screws on fan. Clean motor housing (D) with only a soft brush or lint-free cloth to avoid scratching the finish. Clean blades (G) with a lint-free cloth.

IMPORTANT: Shut off main power supply before beginning any maintenance. Do not use water or a damp cloth to clean the ceiling fan.

Total wattage for the LED light kit on this fan is 18 watts; do not attempt to replace the LEDs.

TROUBLESHOOTING

⚠ WARNING: Before beginning work, shut off the power supply to avoid electrical shock.

PROBLEM	POSSIBLE CAUSE	CORRECTIVE ACTION
Fan does not move.	1. Reverse switch not engaged. 2. Power is off or fuse is blown. 3. Faulty wire connection.	1. Push switch firmly either left or right. 2. Turn power on or check fuse. 3. Turn power off. Loosen canopy and check all connections.
Noisy operation.	1. Blades are loose. 2. Cracked blade. 3. Full range dimmer switch. 4. Fan is new.	1. Make sure three-C clips are installed correctly according to instructions on page 9. 2. Replace blade. 3. Replace with an approved speed control device. 4. Allow fan a "break in" period of a few days, especially when running the fan at Medium and High speeds.
Excessive wobbling.	1. Blades are loose. 2. Blades incorrectly attached. 3. Unbalanced blades. 4. Fan not securely mounted. 5. Fan too close to vaulted ceiling. 6. Set screw(s) on motor housing yoke is (are) not tightened properly. 7. Set screw on hanging ball is not tightened properly.	1. Make sure three-C clips are installed correctly. 2. Re-install blades according to instructions on page 9. 3. Switch one blade with a blade from the opposite side. 4. Turn power off. Carefully loosen canopy and verify that mounting bracket is secure. 5. Use a longer downrod or move fan to another location. 6. Tighten yoke set screw(s) securely. 7. Carefully loosen and lower canopy and verify that set screw on hanging ball is tightened securely.
Fan operates but light fails.	1. Wires in canopy not wired properly. 2. Wall switch to light is off.	1. Check wires in canopy and, if necessary, re-wire according to instructions on pages 11 - 13. 2. Make sure that wall switch to light is on.

NOTE: A small amount of "wobble" is normal and should not be considered a defect.

LIMITED LIFETIME WARRANTY

Set forth below, the manufacture warrants the fan motor for this ceiling fan to be free from defects in workmanship and material for the life of the product. Also, subject to the limitations below, the manufacturer warrants all ceiling fan parts ("ceiling fan parts" excludes the motor and parts made in whole or in part with glass) to be free from defects in workmanship and material for a period of one year after the date of purchase by the original purchaser at retail.

All claims must be made by the original purchaser, whether such purchaser purchased the product through a store or contractor. Ceiling fan part defects must be reported within the first year from the date of purchase. Parts made in whole or in part with glass and the finishes of metal and other surfaces are not warranted.

Purchasers are responsible for all costs of removing and reinstalling the product. Any damage to any part caused by ordinary wear and tear, accident, misuse, or improper installation, is not covered by this warranty. The manufacturer assumes no responsibility whatsoever for fan installation. Any service performed by a non-licensed electrician will render the warranty invalid.

The manufacturer's sole responsibility shall be to repair or replace the motor, parts, or product within the terms stated above. The manufacturer shall not be liable for any loss or damage of any kind, including any incidental or consequential damages resulting directly or indirectly, from any breach of warranty, express or implied, or any other failure of this product. Some states do not allow the exclusion or limitation of incidental or consequential damages so this limitation may not apply to you. If the original purchaser ceases to own the fan, this warranty is voided.

Should the purchaser encounter a problem with your fan related to defects in workmanship or materials within the warranty period associated with the defective part, the manufacturer agrees to replace the defective part without charge, or at its option, to replace the ceiling fan with a comparable or superior model.

The manufacturer's warranties are limited to the written warranties set out in this ceiling fan limited lifetime warranty. All other express and implied warranties, including, without limitation, the implied warranty of fitness for a particular purpose and the implied warranty of merchantability are disclaimed. Some states do not allow the disclaimer of implied warranties, so this disclaimer may not apply to you.

REPLACEMENT PARTS LIST

For replacement parts, call our customer service department at **800-527-1292**, 8:30 a.m. - 5 p.m., CST, Monday - Friday.

		#5709388	#5709392
PART	DESCRIPTION	PART #	PART #
A	Downrod	5709388-A	5709392-A
B	Mounting Bracket	5709388-B	5709392-B
C	Canopy	5709388-C	5709392-C
F	Blade Arm	5709388-F	5709392-F
G	Blade	5709388-G	5709392-G

