



Product Submittal	
Name	
Date	
Architect/Owner	
Contractor	
Tag	
Notes	

Sweat Angle Stop Specification Sheet

Description

Used to control and shut off water flow to fixtures or appliances for maintenance and repair. Featuring a 1/2 in. nominal sweat inlet connection and quarter-turn full-port brass ball valve.

Features And Benefits

- Sleek chrome finish for an attractive appearance.
- Quarter-turn full-port brass ball valve.
- Compatible with copper pipe.

Specification Data

Materials	
Valve body	DZR LF brass
Knurled Handle	ZINC
Valve ball	DZR LF brass
Seat	PTFE



Temperature Performance

- Minimum working temperature 33°F
- Maximum working temperature 160°F
- Maximum working pressure is 125 psi

Flow Rate

- 3/8" Compression 4.0 GPM at 20 psi

Part Listing

☐ NSWTA1238Z 1/2 in. Nominal Sweat x 3/8 in. OD Compression

Dimensions

Part Number	DIM A (IN)	DIM B (IN)
NSWTA1238Z	1.14	1.89

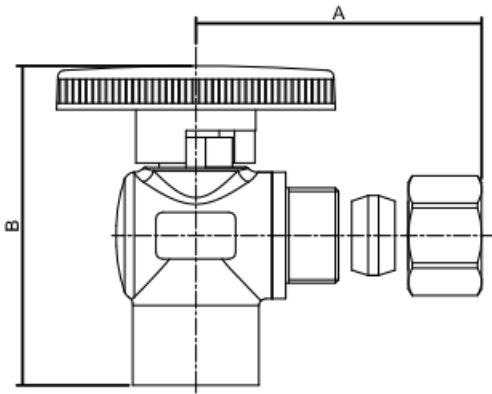

Codes and Listing

cUPC
ASME A112.18.1
CSA B125.1
NSF/ANSI/CAN 61
NSF/ANSI 372

