



Portfolio® is a registered trademark of LF, LLC. All Rights Reserved.

ITEM #0605399

WALL LANTERN

MODEL #ODWW-1BKM

Français p. 10

Español p. 19

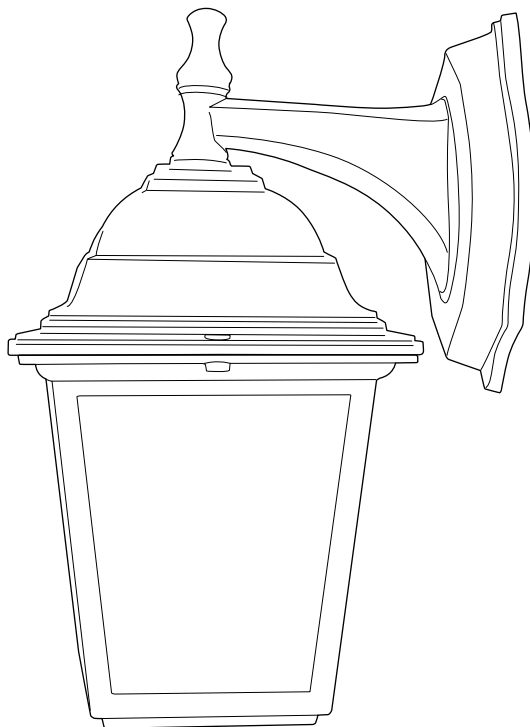

ATTACH YOUR RECEIPT HERE

Serial Number _____ Purchase Date _____



Questions, problems, missing parts? Before returning to your retailer, call our customer service department at **1-800-643-0067**, 8 a.m. - 6 p.m., EST, Monday - Thursday, 8 a.m. - 5 p.m., EST, Friday.

PACKAGE CONTENTS

| PART | DESCRIPTION | QUANTITY |
|------|---|----------|
| A | Fixture | 1 |
| B | Mounting Strap (preassembled to Fixture (A)) | 1 |
| C | Glass Shade | 1 |
| D | Decorative Nut (2 preassembled to Screw (E); 2 preassembled to Glass Shade (C)) | 4 |
| E | Screw (preassembled to Mounting Strap (B)) | 2 |
| F | Nut (preassembled to Screw (E)) | 2 |

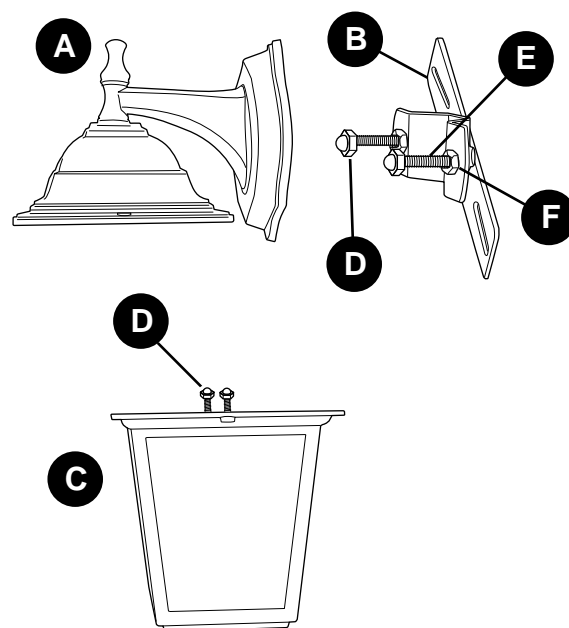

SAFETY INFORMATION

READ AND SAVE THESE INSTRUCTIONS.

DANGER

- For your protection and safety, carefully read and understand the information provided in this manual completely before attempting to assemble, install or operate this product. Failure to do so could lead to electrical shock, fire or other injuries that could be hazardous or even fatal.
- If using this light fixture in a WET or DAMP location, this light fixture must be connected to a supply circuit that is protected by a Ground Fault Circuit Interrupter (GFCI) to reduce the risk of personal injury, electrical shock or death.
- DO NOT connect this fixture to an electrical system that does not provide a means for equipment grounding. Never use a fixture in a two-wire system that is not grounded. Installing a fixture into an electrical system not having a proper grounding means could cause metal parts of the fixture to carry electrical currents if any of the fixture wires, wire connections or splices were to become broken, cut or loose during the mounting or normal operation of the fixture. Under this condition, anyone coming in contact with the fixture would be subject to electrical shock, which could cause serious injury or death.
- DO NOT connect the bare or green insulation fixture ground wire to the black (HOT) current-carrying wire or the white neutral house wire. Connection of the bare or green fixture ground wire to the black or white house wires may cause metal parts of the fixture to carry electrical currents. Under this condition, anyone coming in contact with the fixture will receive electrical shock, which could cause serious injury or death.
- DO NOT damage or cut the wire insulation (covering) during installation of fixture. DO NOT permit wires to contact any surface having a sharp edge. To do so may damage or cut the wire insulation, which could cause serious injury or death from electrical shock.

WARNING

- All electrical connections must be in agreement with local codes and ordinances, the National Electric Code (NEC) and ANSI/NFPA 70-1999. Contact your municipal building department to learn about your local codes, permits and/or inspections. Risk of fire – most dwellings built before 1985 have supply wire rated for 140°F. Consult a qualified electrician before installation.
- To avoid personal injury, the use of gloves may be necessary while handling fixture parts with sharp edges.
- DO NOT suspend any fixture by the house wires. A fixture must always be mounted directly to a mounting strap that is first attached to the outlet box. Wire connectors will not support the weight of a fixture. Suspending a fixture by the house wires and wire connectors will result in the fixture falling, with the possibility of personal injury and the danger of electrical shock or fire.
- To reduce the risk of fire, electrical shock or personal injury, each quick connect clip provided with this light fixture is designed to accept only one 12-gauge house wire and one lead wire from the light fixture. If your house wire is larger than 12-gauge or there is more than one house wire to connect to the corresponding fixture lead wires, consult an electrician.
- Failure to caulk fixture mounting surface with silicone weather sealant may result in water damage in outlet box, which may cause electrical malfunction or electrical shock.

CAUTION

- TURN OFF ELECTRICITY at main fuse box (or circuit breaker box) before beginning installation by removing the fuse (or switching the circuit breaker off).
- If you are not sure the lighting system has a grounding means, DO NOT attempt to install this fixture. Contact a qualified, licensed electrician for information regarding the proper grounding methods as required by the local electrical code in your area.
- All fixtures must be mounted to an outlet box that is supported by the building structure.
- DO NOT use bulbs having a wattage greater than the maximum value stated on the fixture. The use of bulbs with higher wattage than specified will increase temperatures and risk of fire.
- If a dimmer control switch is used with this fixture, obtain professional advice to determine the correct type to use as well as the electrical rating required. Note: Most compact fluorescent bulbs are NOT compatible with dimmer control switches.
- To avoid water damage to fixture or possible electrical malfunction, install fixture at least 4 ft. above the ground/floor.

PREPARATION

Before beginning assembly of product, make sure all parts are present. Compare parts with package contents list. If any part is missing or damaged, do not attempt to assemble the product.

Estimated Assembly Time: 45 minutes

Tools Required for Assembly (not included): Flathead Screwdriver, Phillips Screwdriver, Wire Strippers, Pliers, Wire Cutters, Safety Glasses, Stepladder, Electrical Tape, Silicone Weather Sealant

Helpful Tools (not included): A/C Tester Light, Do-It-Yourself Wiring Handbook, Soft Cloth

ASSEMBLY INSTRUCTIONS

1. Turn off circuit breakers and wall switch to the fixture supply line leads.

⚠ DANGER: Failure to disconnect power supply prior to installation may result in serious injury or death.

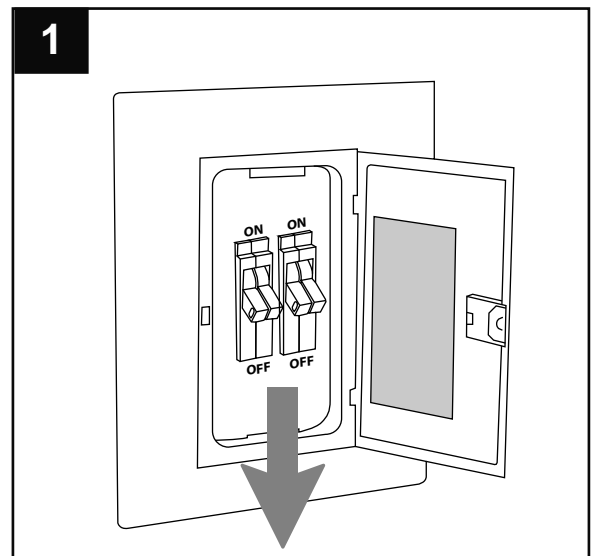

2. Remove existing fixture and disconnect all electrical wiring.

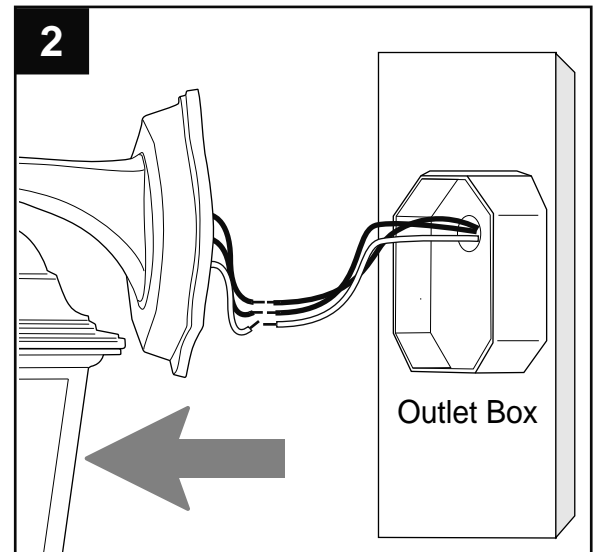

ASSEMBLY INSTRUCTIONS

- 3a. Remove two decorative nuts (D) from front of fixture (A) and remove mounting strap (B) from back of fixture (A).

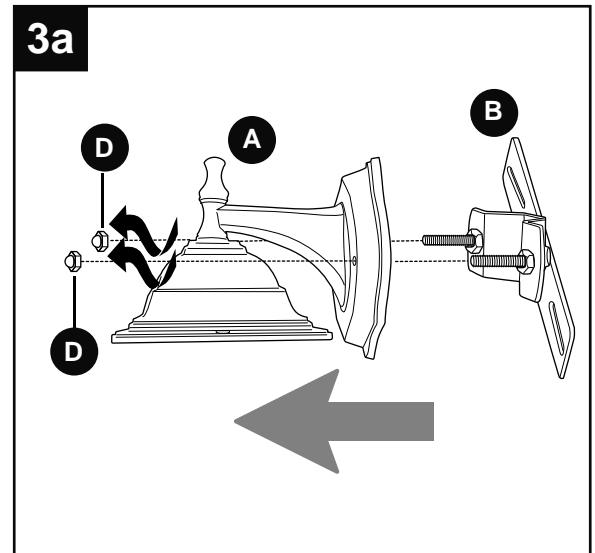

- 3b. Attach mounting strap (B) to outlet box (not included) using the existing outlet box screws and washers. To help ensure that the fixture (A) is level when attached, turn crossbar on mounting strap (B) so that screws (E) are level horizontally. Tighten the two small screws in the center of the mounting strap (B) to secure the cross bar on the mounting strap (B).

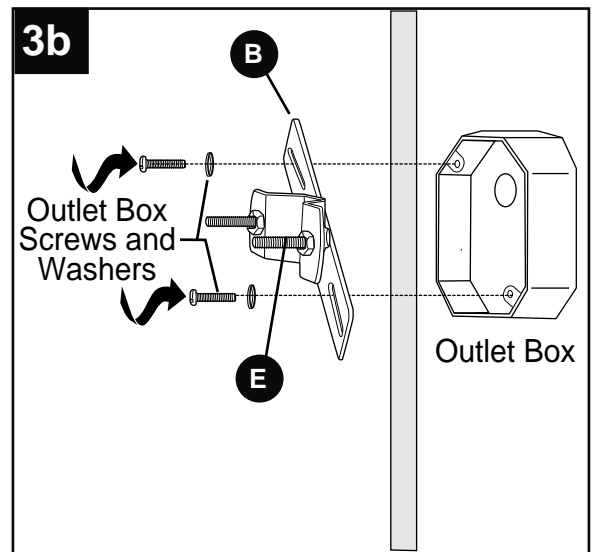

! CAUTION: Make sure the outlet box can support 35 lbs. hanging weight. Use *metal* outlet box; plastic outlet boxes are not recommended.

4. Adjust screws (E) to proper length by screwing them completely into mounting strap (B). Temporarily place fixture (A) over mounting strap (B) to determine amount of adjustment necessary for screws (E); screws (E) should come through holes in top of fixture (A) just enough so that decorative nuts (D) will fit flush against fixture (A) when mounted.

Once screws (E) are adjusted, use pliers (not included) to tighten nuts (F) on screws (E) until nuts (F) touch mounting strap (B).

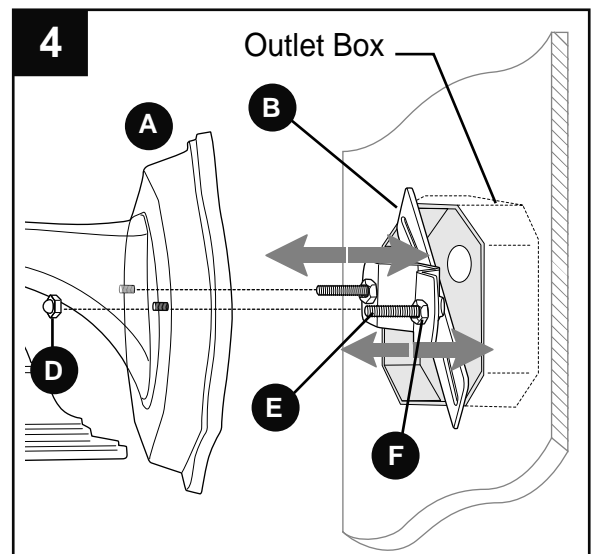

ASSEMBLY INSTRUCTIONS

- 5a. Unwrap BARE wire from BLACK and WHITE wires on fixture (A). Prepare wire by stripping 3/4 inch of insulation from wire ends using wire strippers (not included).

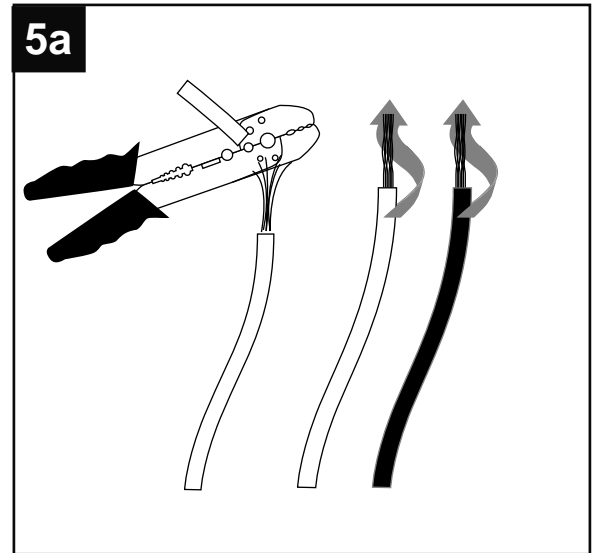

- 5b. For each wire connection below, the wire from the outlet box must be connected to the corresponding wire color in fixture (A) by using the quick connect clip.

IMPORTANT: Be sure wire colors match before making connections.

Connect WHITE wire from outlet box to WHITE wire from fixture (A) using quick connect clip.
Connect BLACK wire from outlet box to BLACK wire from fixture (A) using quick connect clip.
Connect BARE/GREEN ground wire from outlet box to BARE ground wire from fixture (A) using quick connect clip.

NOTE: Pull on each wire to make sure wires are secure in the quick connect clips.

⚠ WARNING: Never connect ground wire to white or black power supply wires.

⚠ WARNING: To reduce the risk of fire, electrical shock, or personal injury, each quick connect clip provided with this light fixture is designed to accept only one 12-gauge house wire and one lead wire from the light fixture. If your house wire is larger than 12-gauge or there is more than one house wire to connect to the corresponding fixture lead wires, consult an electrician.

NOTE: To release a wire from a quick connect clip, twist and pull the wire at the same time. This may require some force.

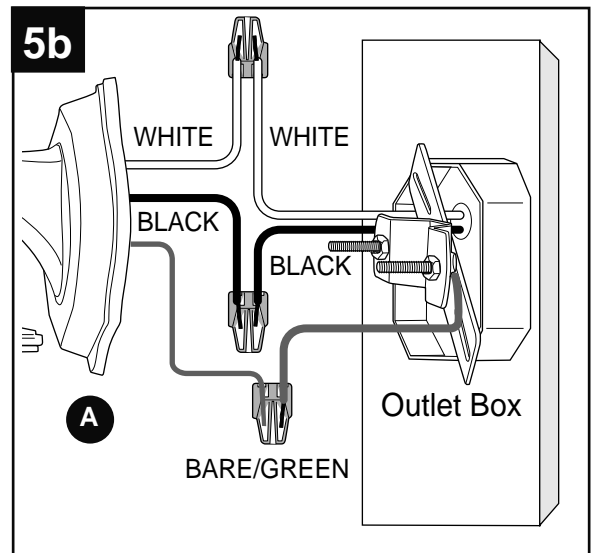

ASSEMBLY INSTRUCTIONS

6. Wrap electrical tape (not included) around each individual quick connect clip down to the wire.

⚠ WARNING: Make sure no bare wire or wire strands are visible after making connections.

Push quick connect clips gently back into outlet box. Carefully push excess wiring into outlet box.

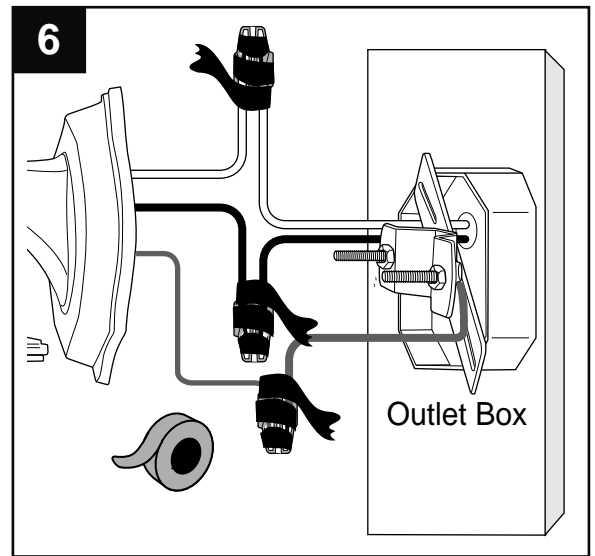

7. Align holes in fixture (A) with screws (E) on mounting plate (B) and push fixture (A) toward wall. Attach fixture (A) to mounting plate (B) using the decorative nuts (D) that were removed in Step 3a on Page 5.

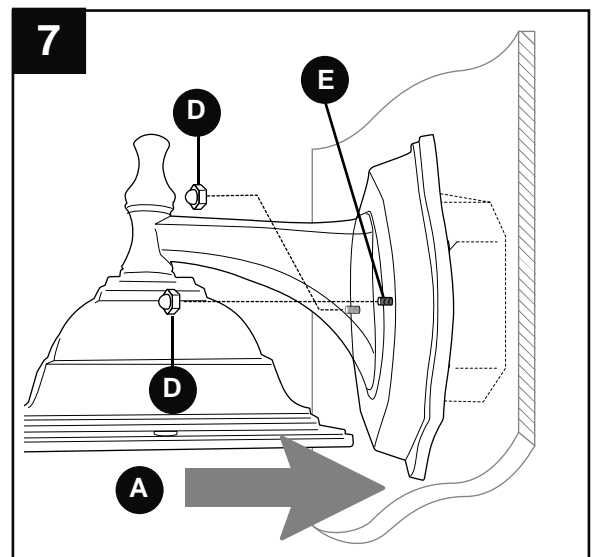

8. Install one standard-base bulb (not included). Use either a 60-watt max. incandescent or a 13-watt CFL.

⚠ CAUTION: When replacing bulb, please allow bulb and glass shade (C) to cool down before touching them.

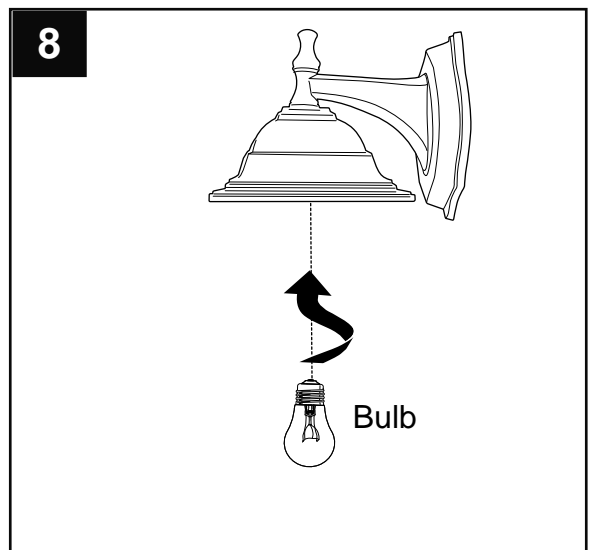

ASSEMBLY INSTRUCTIONS

9. Remove two decorative nuts (D) from the top edge of glass shade (C). Attach glass shade (C) to fixture (A) using decorative nuts (D) that were just removed.

Restore power and test fixture (A).

If light does not function, please refer to the TROUBLESHOOTING guide on the following page.

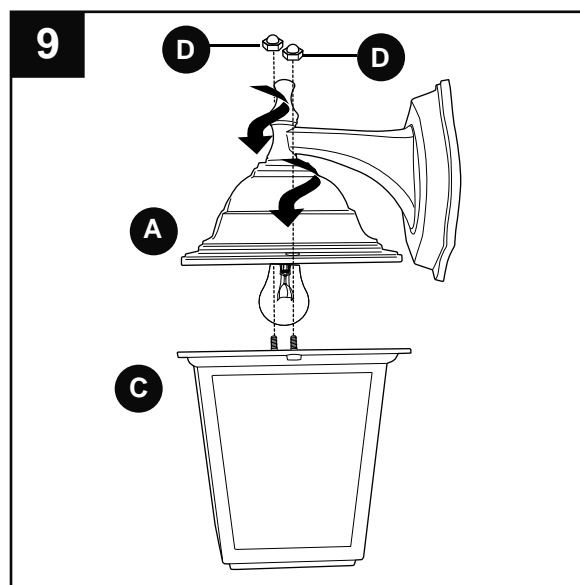

10. After completing installation, caulk fixture (A) mounting surface with silicone weather sealant.

⚠ WARNING: Failure to caulk fixture mounting surface with silicone weather sealant may result in water damage in outlet box, which may cause electrical malfunction or electrical shock.

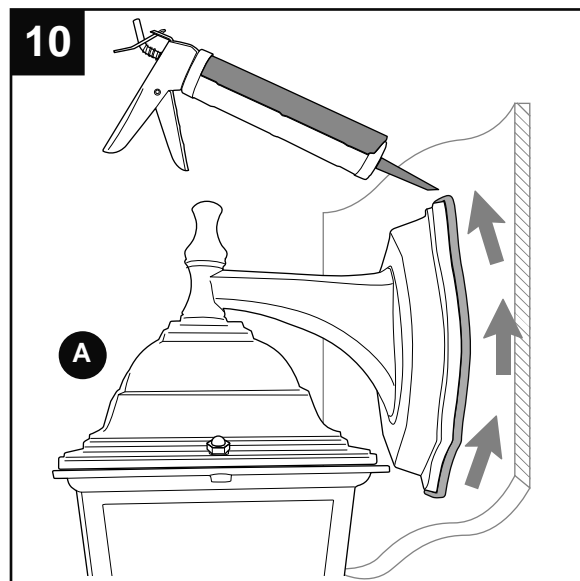

CARE AND MAINTENANCE

- Shut off main power supply. Wipe with soft cloth or use window cleaner. Do not use an abrasive cleaner.

TROUBLESHOOTING

⚠ WARNING: Before beginning work, shut off the power supply to avoid electrical shock.

| PROBLEM | POSSIBLE CAUSE | CORRECTIVE ACTION |
|--|---|--|
| Bulb will not light. | 1. Bulb is burned out. 2. Power is OFF. 3. Faulty connection. | 1. Replace light bulb. 2. Make sure power supply is ON. 3. Check wiring and all connections. |
| Fuse blows out or circuit breaker trips. | 1. Crossed wires. 2. Power wire is grounding out. | 1. Check wiring. 2. Check all connections. |

WARRANTY

The distributor warrants all of its lighting fixtures against defects in materials and workmanship for five (5) years from the date of purchase. If within this period the product is found to be defective, take a copy of the bill of sale as a proof of purchase and the product in its original carton to the place of purchase. The distributor will, at its option, repair, replace or refund the purchase price to the consumer. All costs of installation and removal of the fixture is the responsibility of the consumer. This warranty does not cover fixtures becoming defective due to misuse, accidental damage or improper handling and/or installation and specifically excludes liability for direct, incidental or consequential damages, improper packaging of returned products and acts of God. As some states do not allow exclusions of limitations on an implied warranty, the above exclusion and limitation may not apply. This warranty gives you specific rights and you may also have other rights which may vary from state to state.

Printed in China

Portfolio® is a registered trademark of LF, LLC. All Rights Reserved.