

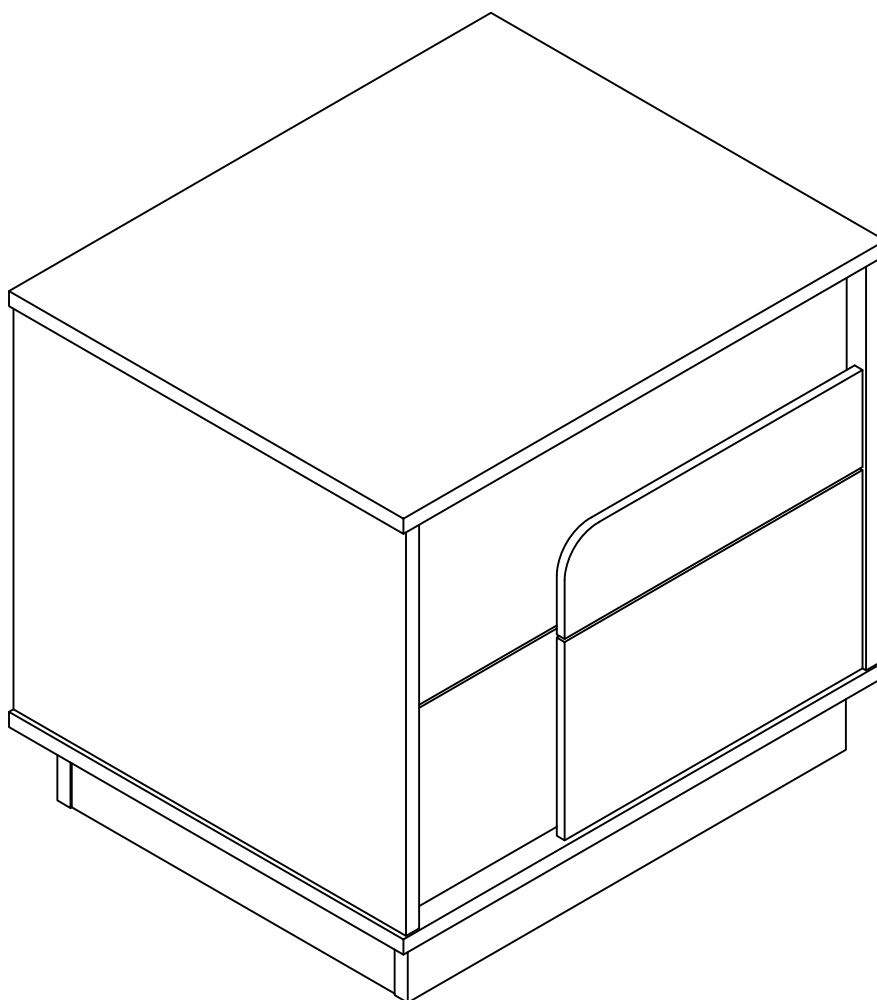

MANHATTAN COMFORT

NS003





STOP!

Before beginning the assembly process,
ensure all boxes and parts have been delivered.

FOR BEST RESULTS:

- Do not throw away packaging materials until assembly is complete.
- Assemble item on a soft surface, such as cardboard or carpet, to protect finish.
- Proper assembly requires two people.

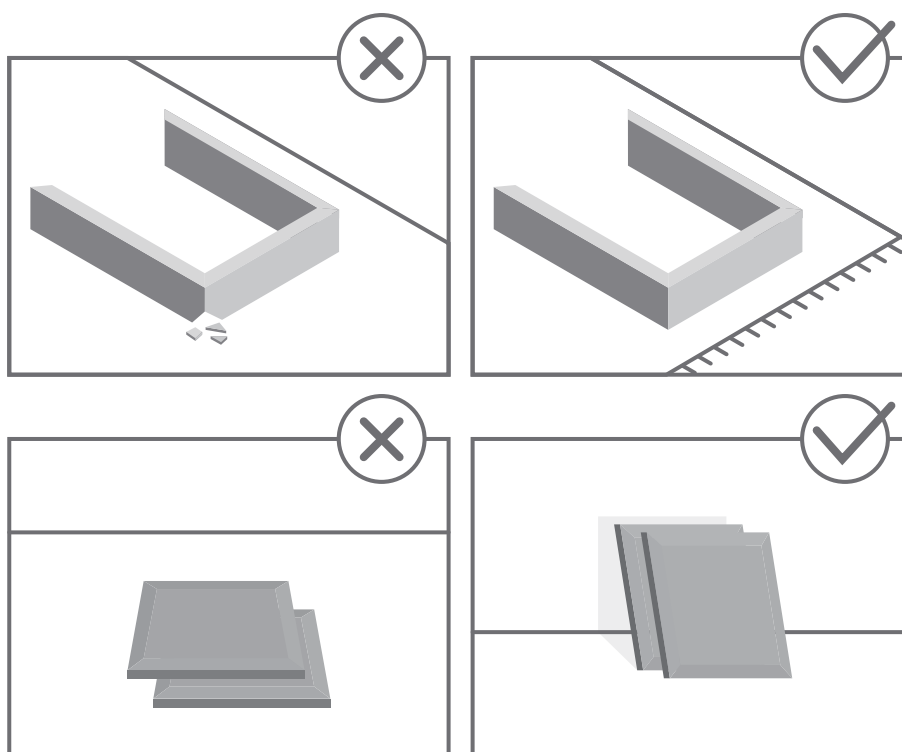

View our assembly video online:
WWW.MANHATTANCOMFORT.COM



Stuck? Question? We are here to help.
tel: 908-888-0818
e-mail: help@manhattancomfort.com

Support Site



Included in this package:

- A. TOP PANEL(1)
- B. BOTTOM PANEL(1)
- C. LEFT AND RIGHT SIDE PANELS (2)
- E. BACK PANEL (1)
- F. FRONT/BACK LOWER HORIZONTAL PANEL (2)
- G.LEFT/RIGHT LOWER HORIZONTAL PANEL (2)
- H. DRAWER UPPER FRONT PANEL (1)
- I. DRAWER LOWER FRONT PANEL (1)
- J. DRAWER LEFT PANEL (2)
- K. DRAWER RIGHT PANEL (2)
- L. DRAWER BACK PANEL (2)
- M. DRAWER BOTTOM PANEL (2)

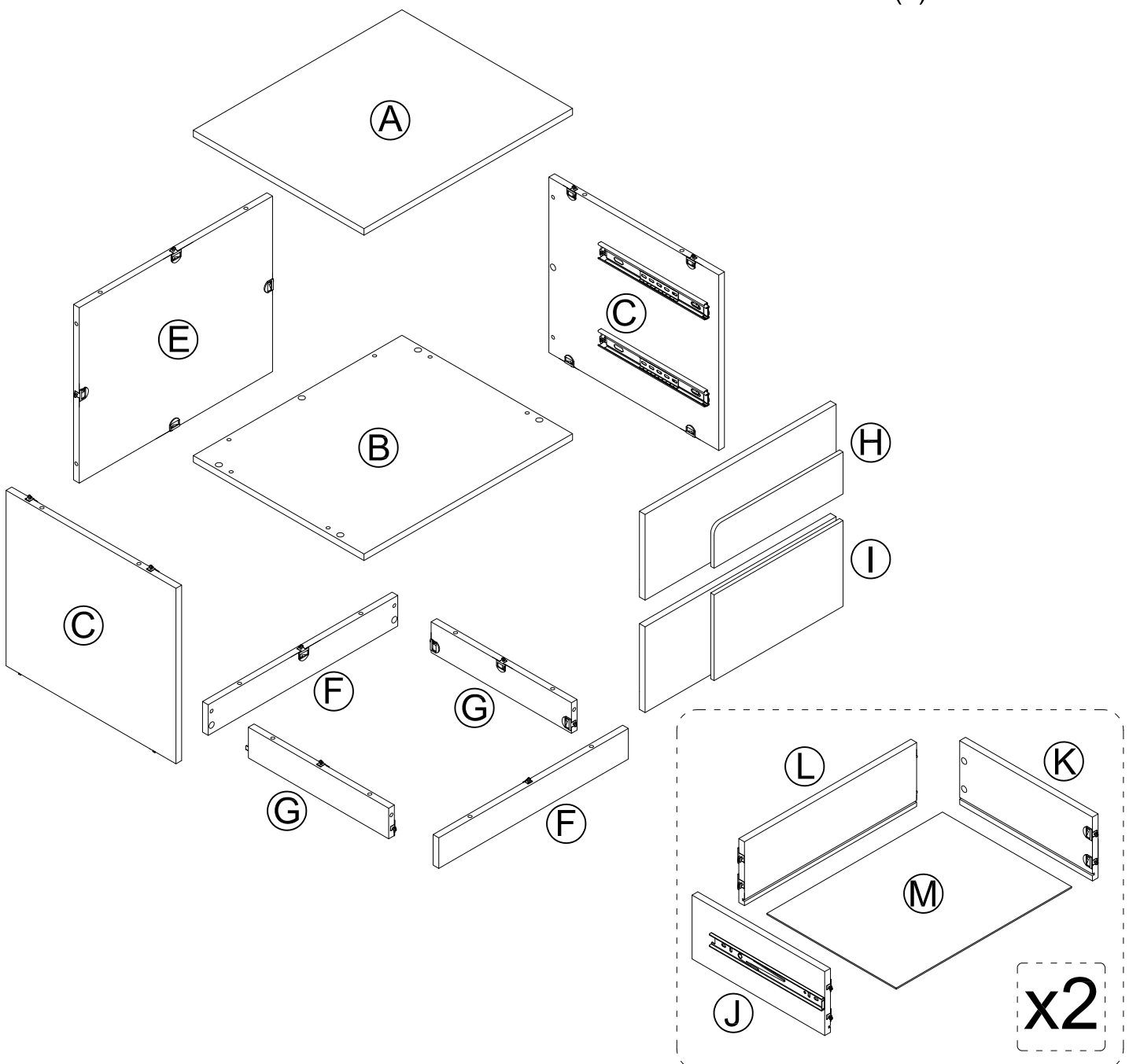

Hardware Identification

- ① WOOD DOWEL - 28pcs
Ø8*30mm

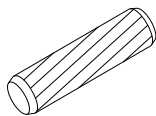

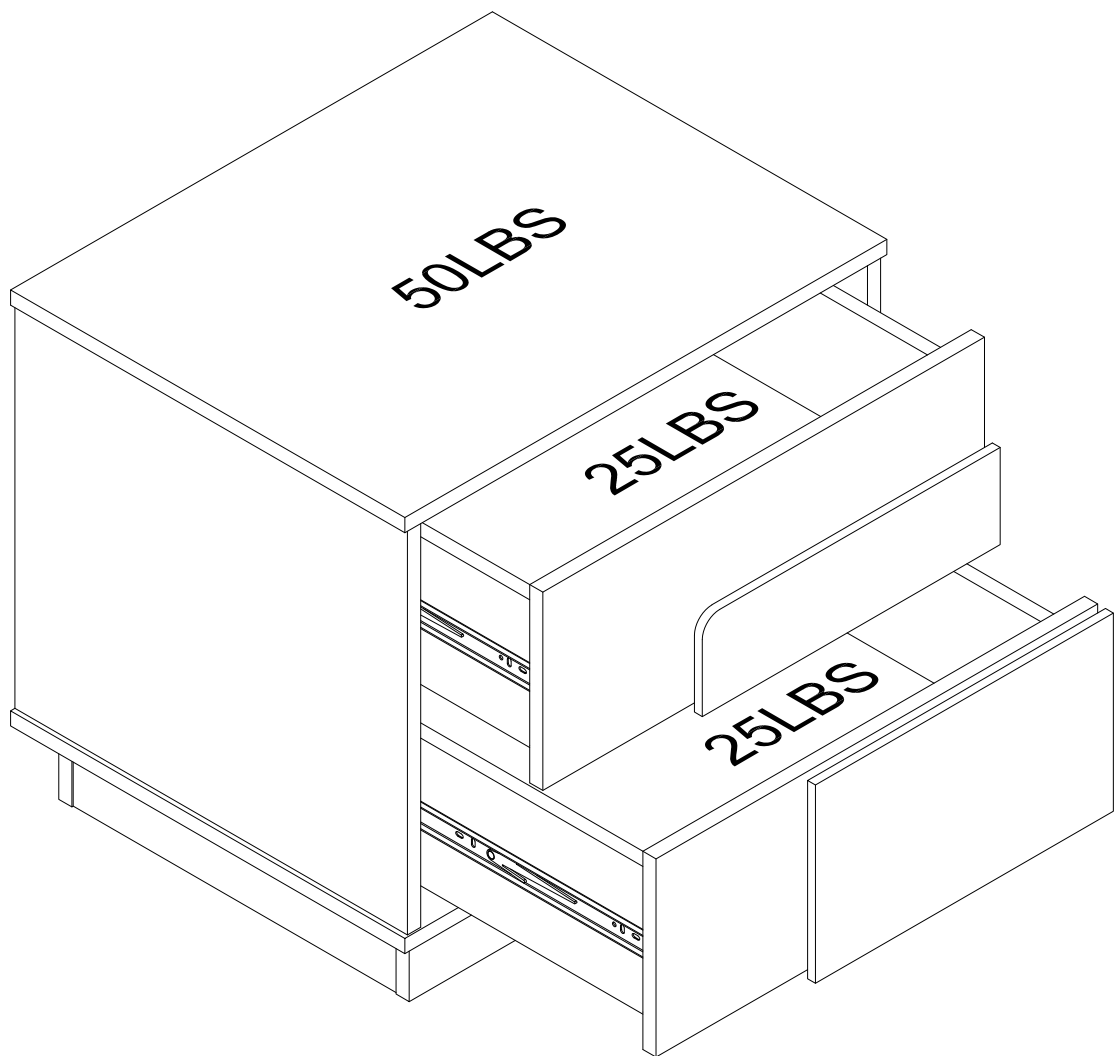

Step 1:

* Attach the FRONT/BACK LOWER HORIZONTAL PANEL(F) to the LEFT/RIGHT LOWER HORIZONTAL PANEL(G) by Four WOOD DOWEL (1) .

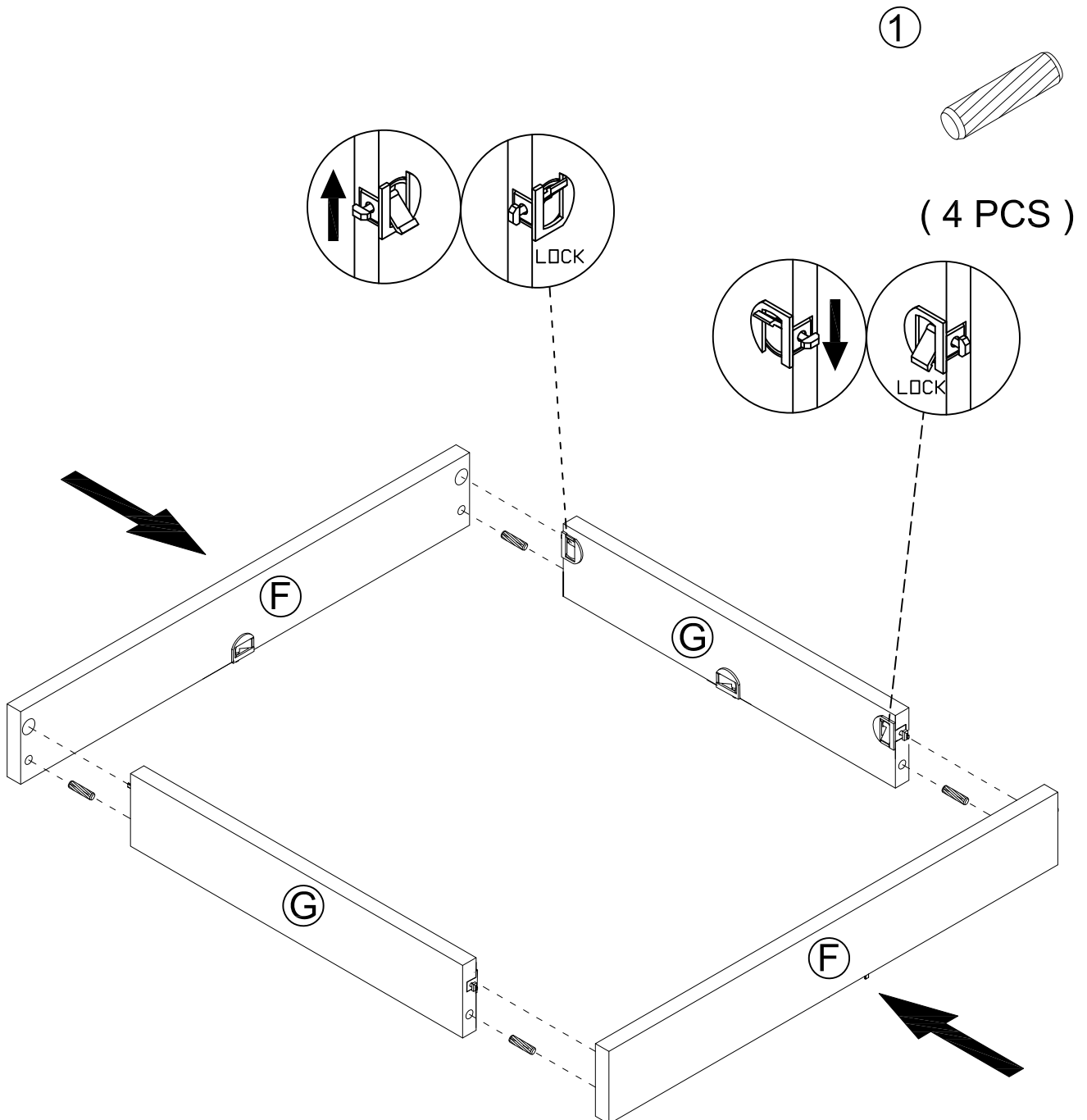

Step 2:

* Connect the left and right side panels (C) to the back panel (E) using four WOOD DOWEL (1).

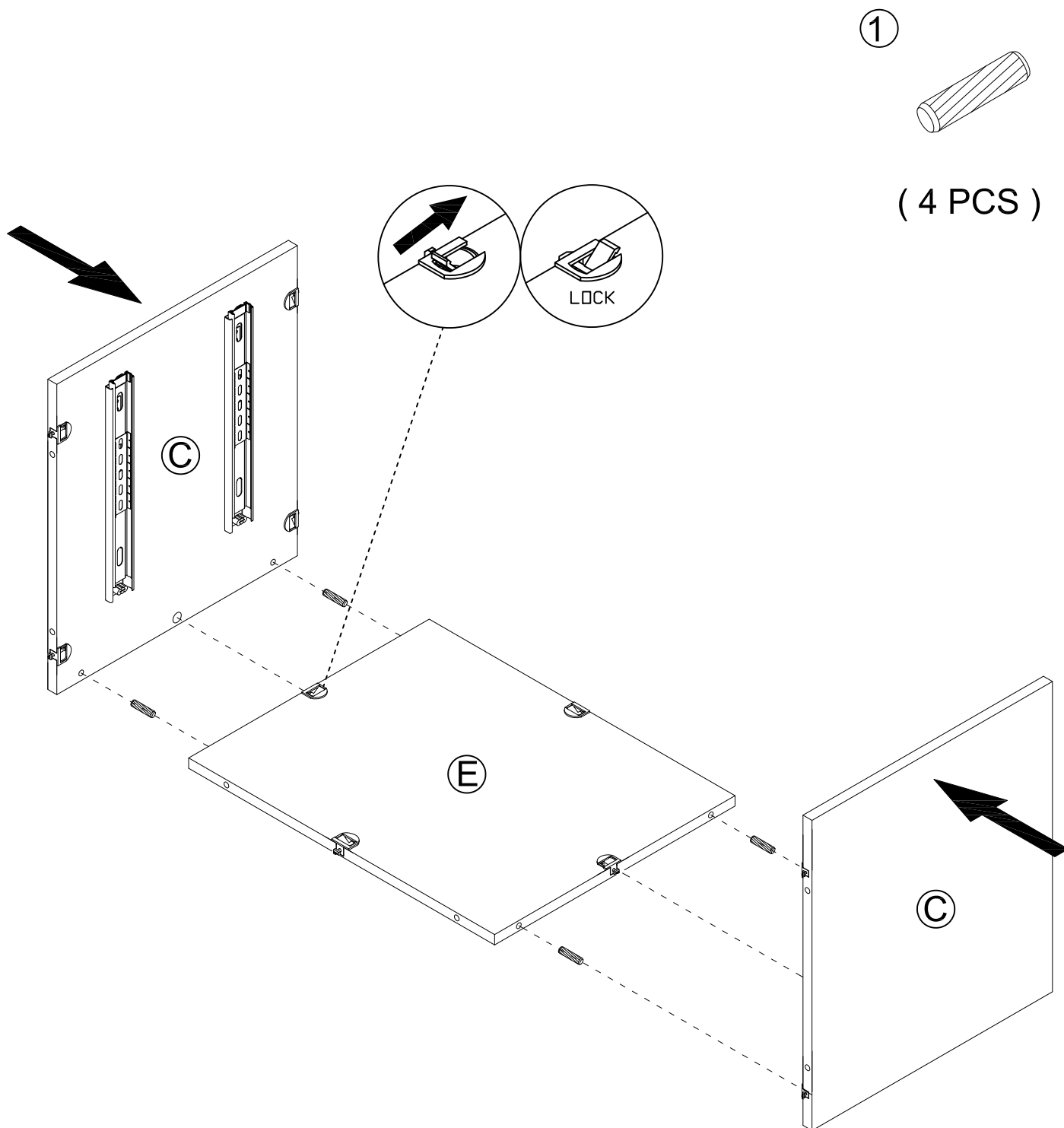

Step 3:

* Attach the BOTTOM PANEL(B) to the LEFT PANEL(C), RIGHT PANEL(D) and BACK PANEL(E) to by Six WOOD DOWEL (1) .

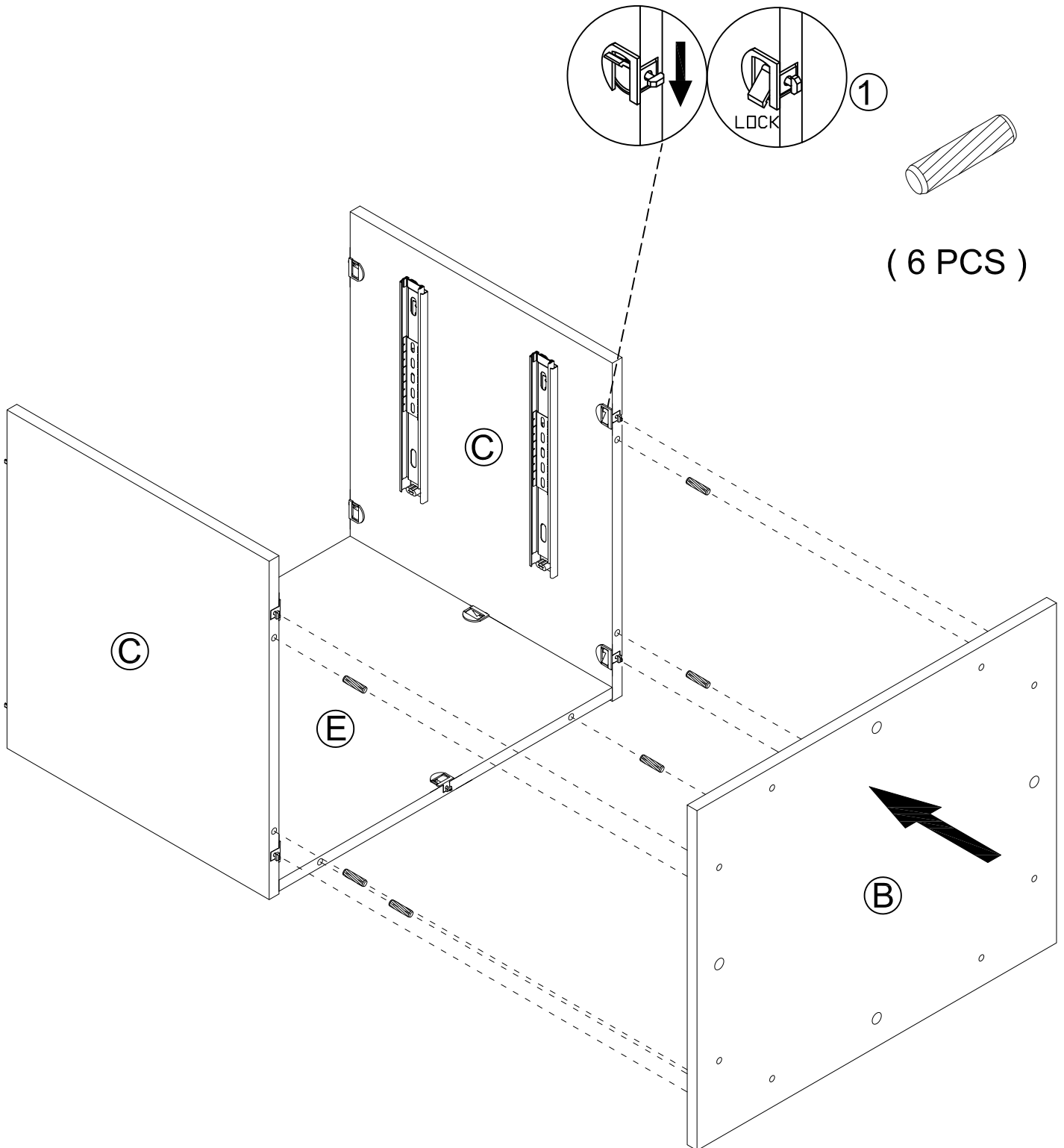

Step 4:

* Attach the FRONT/BACK LOWER HORIZONTAL PANEL(F) and LEFT/RIGHT LOWER HORIZONTAL PANEL(G) to the BOTTOM PANEL(B) by Eight WOOD DOWEL (1) .

①

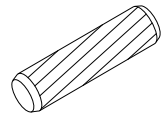

(8 PCS)

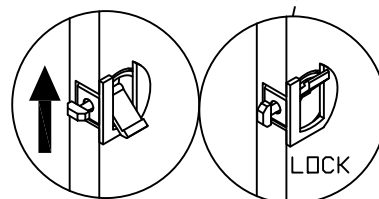
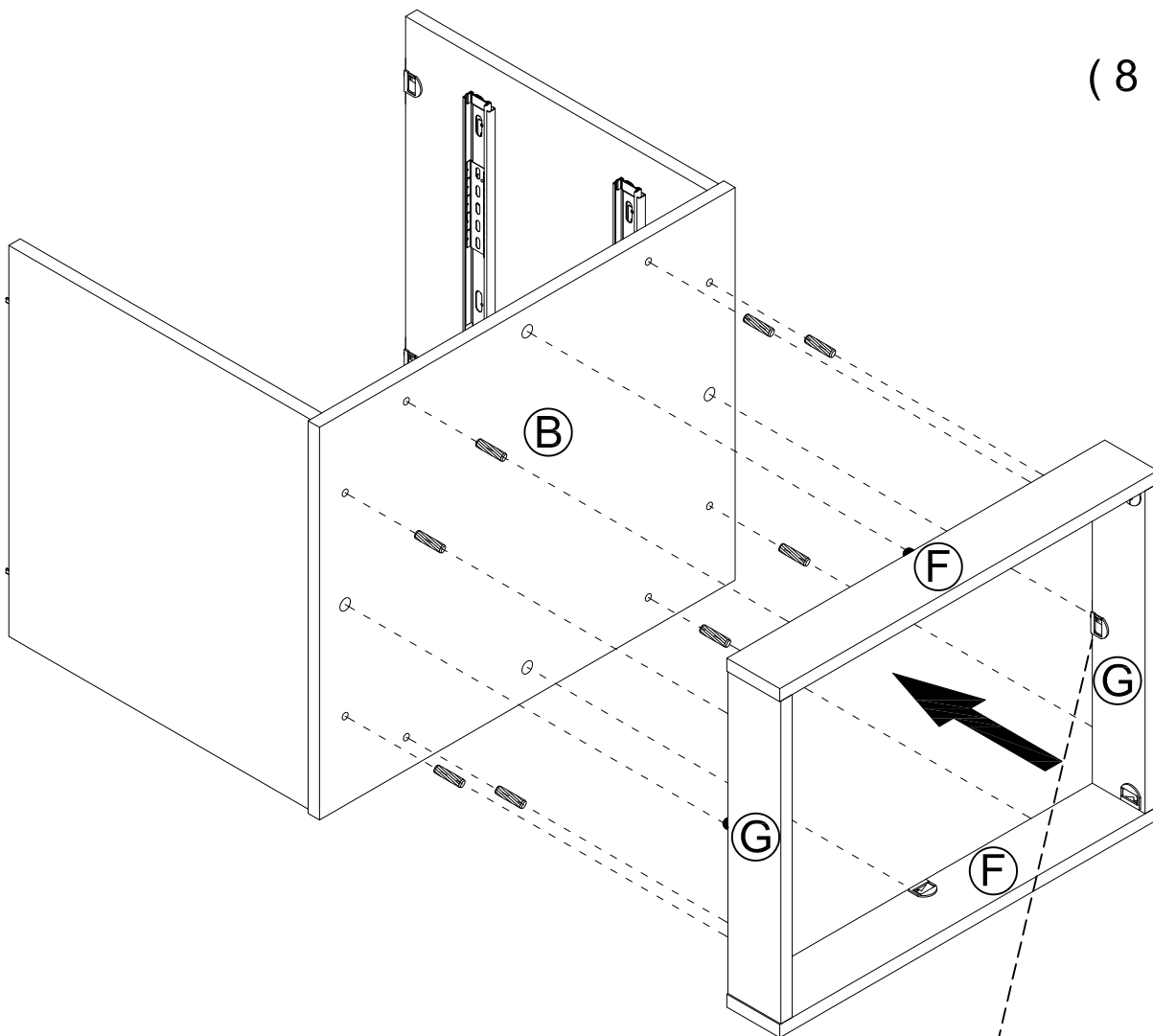

Step 5:

* Attach the TOP PANEL(A) to the LEFT PANEL(C), RIGHT PANEL(D) and BACK PANEL(E) to by Six WOOD DOWEL (1) .

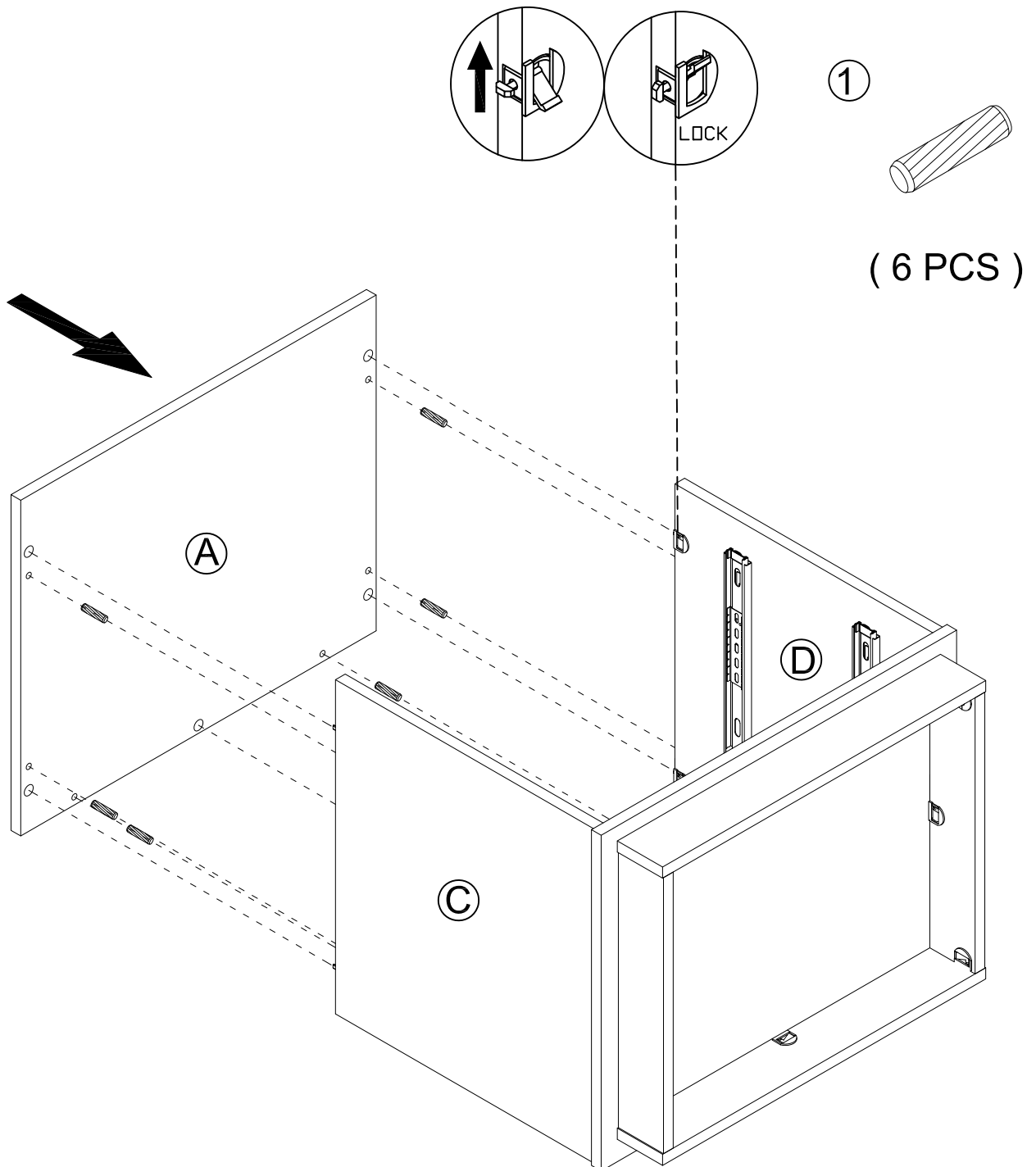

Step 6:

* Attach the DRAWER LEFT PANEL(J) and DRAWER RIGHT PANEL(K) to the DRAWER BACK PANEL(L).

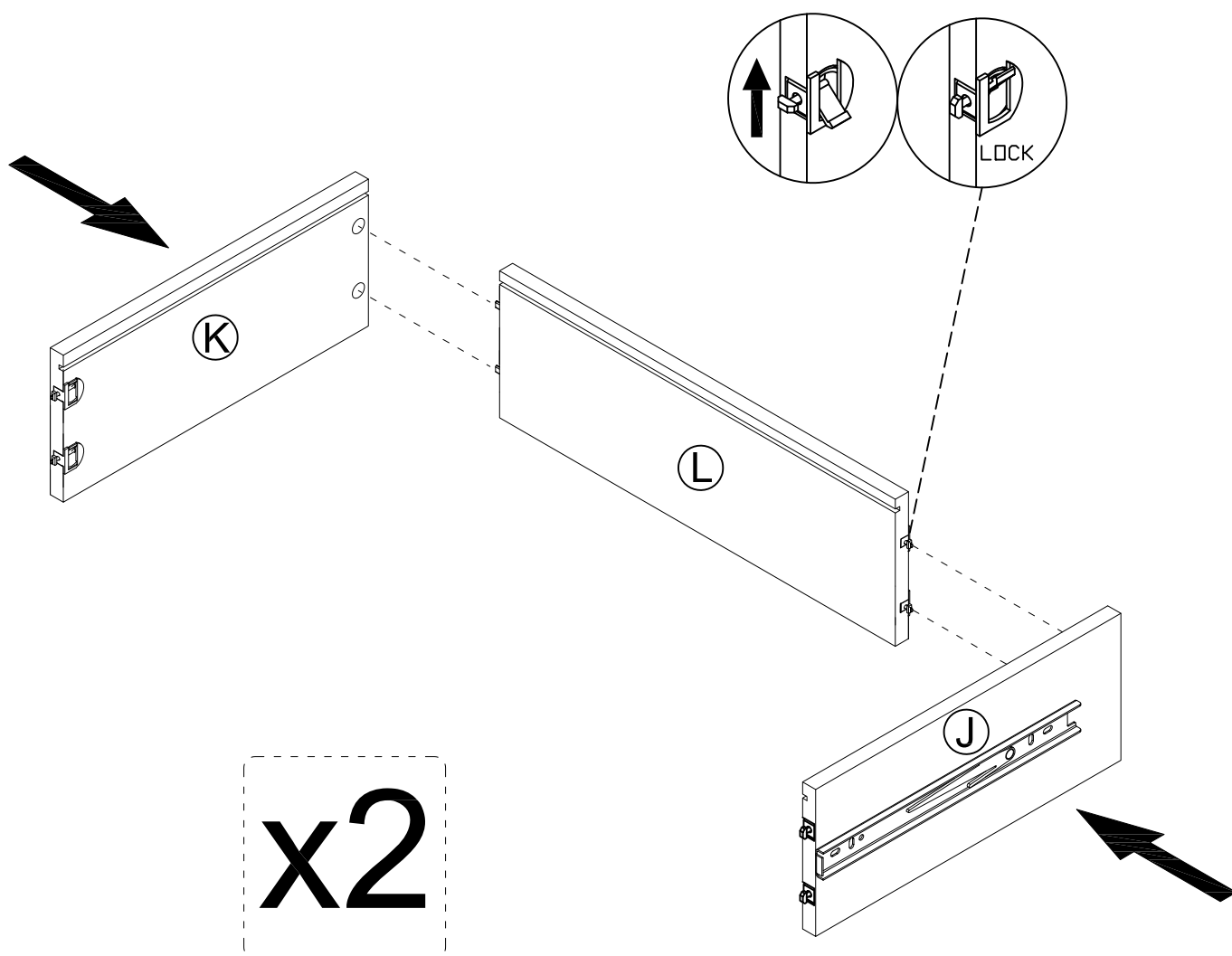

Step 7:

- * Slide in the DRAWER BOTTOM PANEL (M).

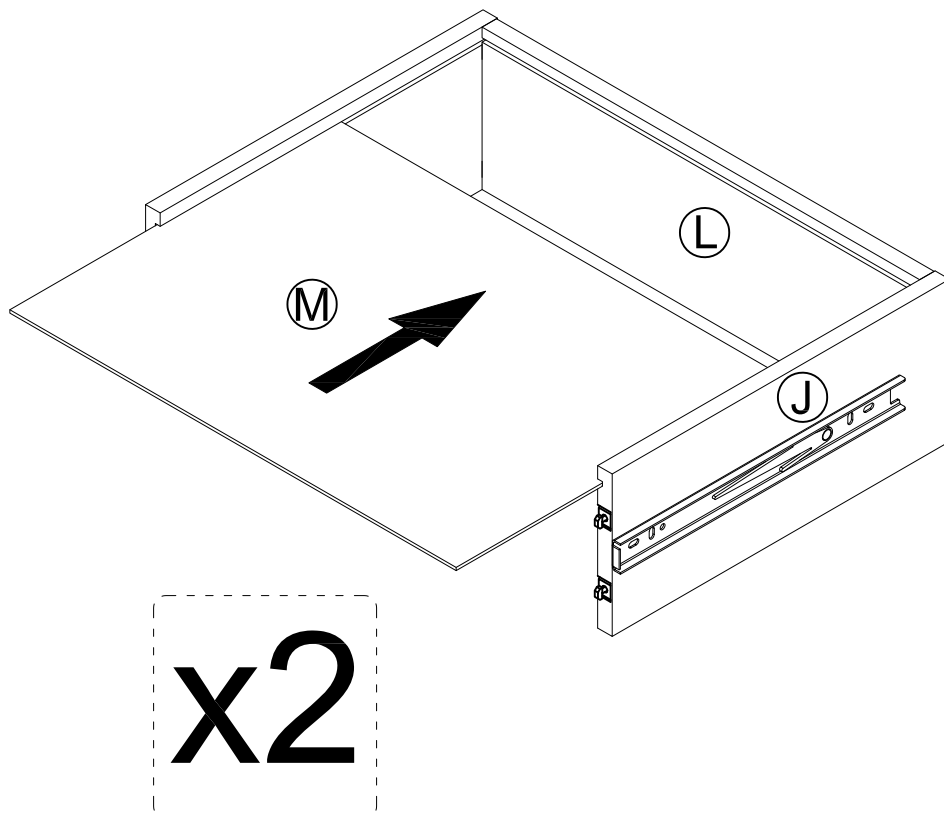

Step 8:

* Attach the DRAWER UPPER FRONT PANEL (H) to the Drawer Tray.

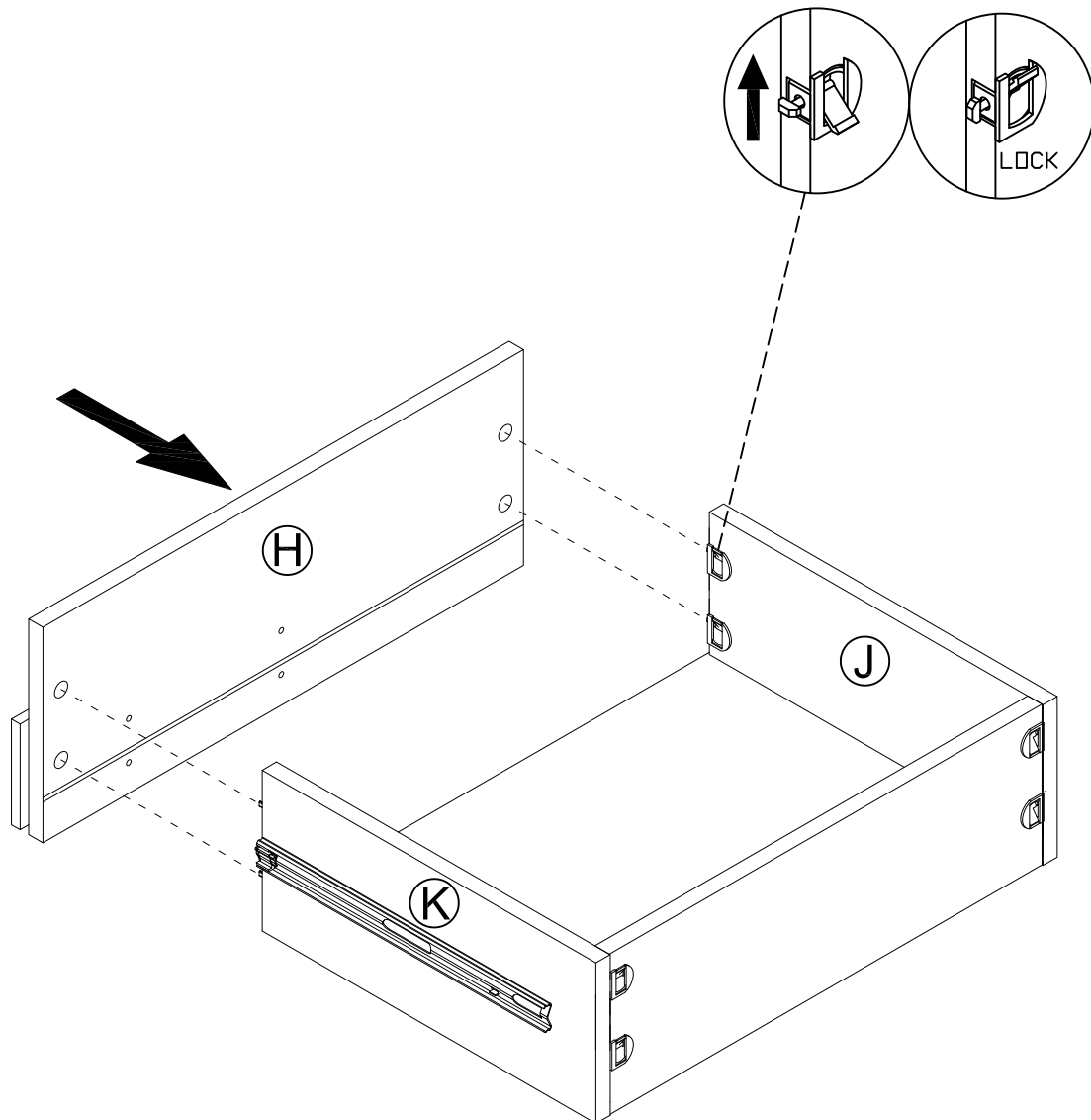

Step 9:

* Attach the DRAWER LOWER FRONT PANEL (I) to the Drawer Tray.

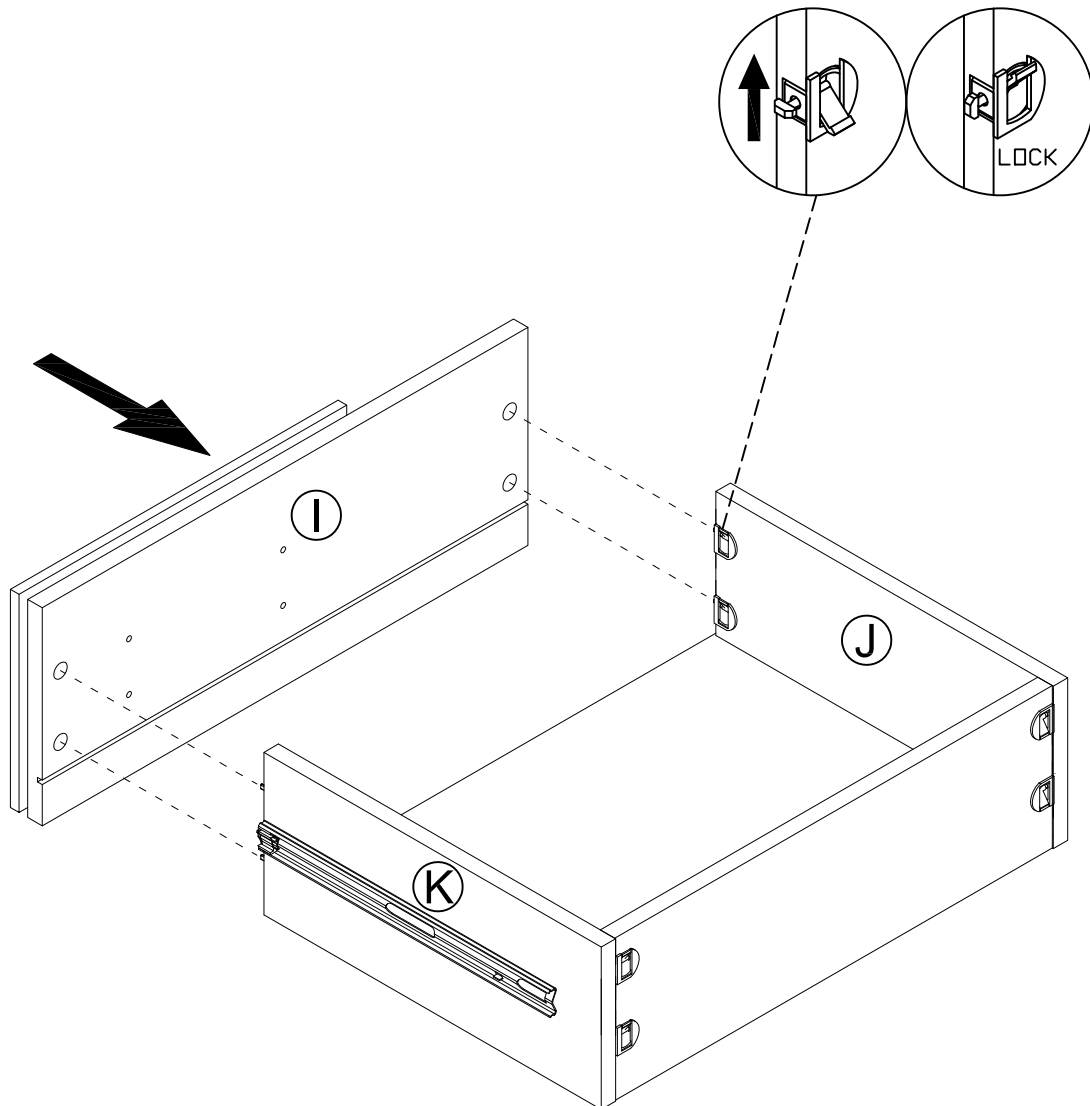

Step 10:

*Input Two Drawer tray to the stand.

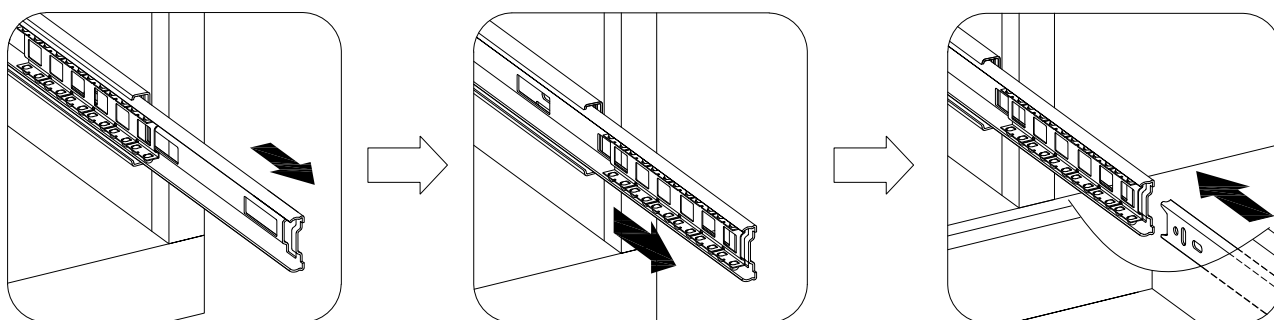
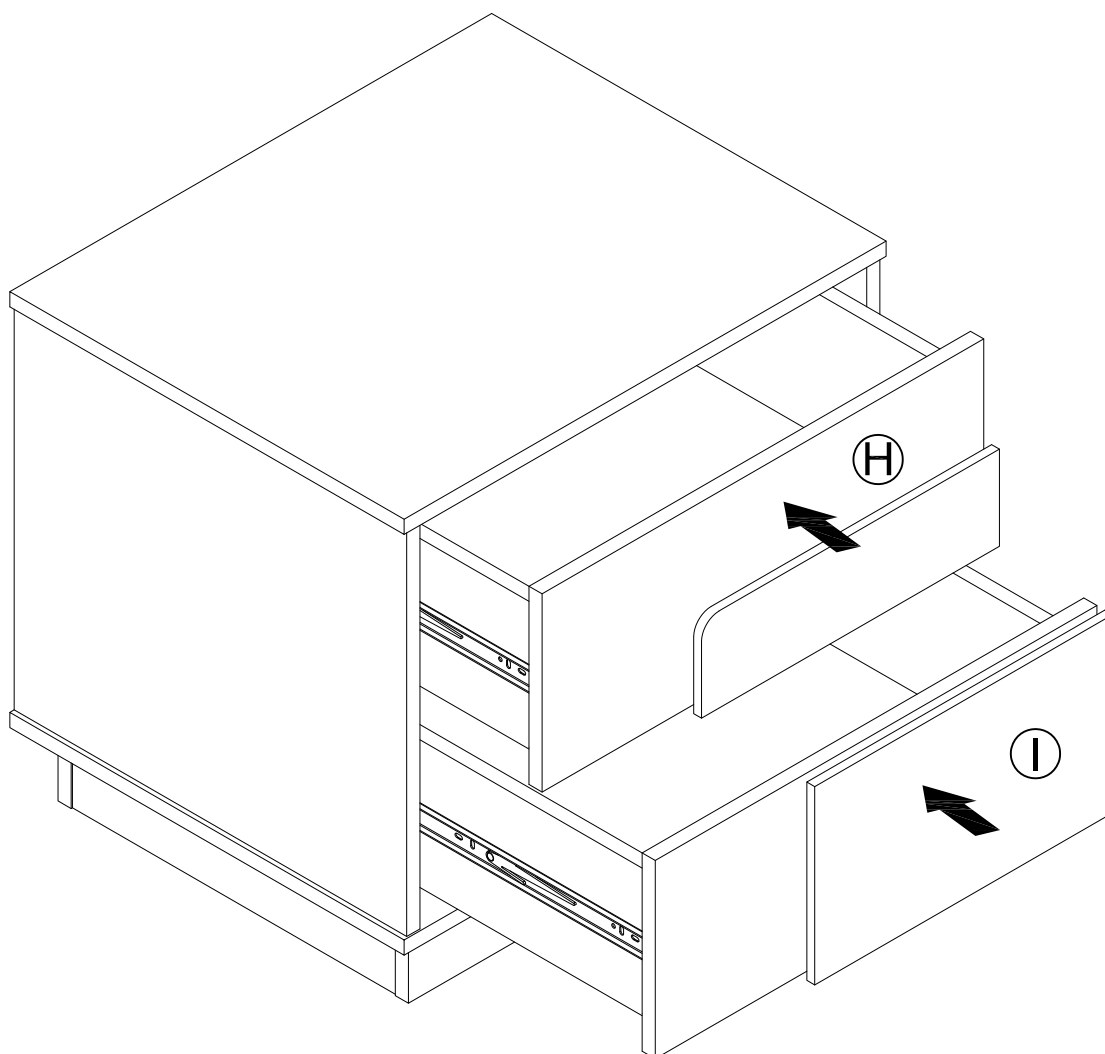



MANHATTAN COMFORT

WARRANTY POLICY

All Manhattan Comfort furniture products are warranted, to the original purchaser at the time of purchase and for a period of 30 days thereafter.

Our warranty is limited to new products purchased in factory sealed cartons. This warranty is valid in the United States of America and Canada.

In order to provide you with timely assistance, please thoroughly inspect your furniture for missing or defective parts immediately after opening the carton.

Manhattan Comfort offers a 30-day parts replacement warranty on all items.

Our furniture products are not intended for outdoor use.

THE WARRANTY DOES NOT COVER:

Defects/damages by improper assembly or disassembly.

-Defects/damages caused by inappropriate use of the furniture.



319 Ridge Rd. Dayton, NJ 08810
908-888-0818