

# YAUFEY

Home Dehumidifier

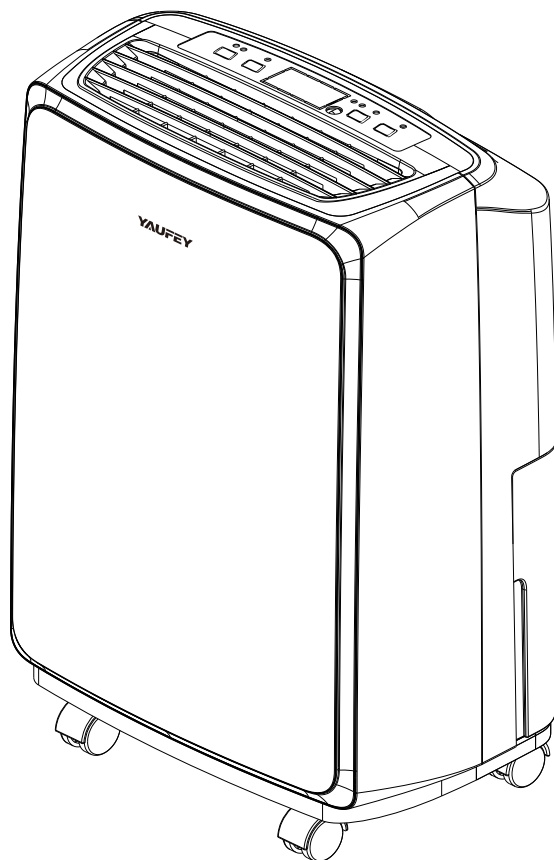

## MANUAL

HD163A

## **TABLE OF CONTENTS**

<b>1. Important Safety Instructions</b> .....	<b>1</b>
<b>2. Parts Description</b> .....	<b>3</b>
<b>3. Operation</b> .....	<b>4</b>
<b>4. Care &amp; Cleaning</b> .....	<b>9</b>
<b>5. Troubleshooting</b> .....	<b>10</b>
<b>6. Technical Specifications</b> .....	<b>11</b>
<b>7. Warranty</b> .....	<b>12</b>
<b>8. Warning</b> .....	<b>12</b>
<b>9. Contact Us</b> .....	<b>12</b>

## **BEFORE FIRST USE:**

To prevent any internal damage, it is very important to keep refrigeration units (like this one) upright throughout their journey. Please leave it standing upright and outside the box for **24 HOURS** before plugging it in.

# Important Safety Instructions

---



## **IMPORTANT NOTICE FOR FIRST USE**

**To preventing the user or other people's property damage injury, we must use the dehumidifier follow the instruction. Incorrect operation due to ignoring of instructions may cause harm or injury. This instructions is for household use only.**

1. Make sure to turn off and unplug the dehumidifier before cleaning.
2. Do not touch the plug with wet hands.
3. Do not operate or turn off the dehumidifier by plugging in or unplugging the device. Use the control panel instead.
4. Be sure to run the water hose sloping downward to let the water flow out smoothly.
5. Do not use if the power cord is broken or damaged.
6. Do not place the dehumidifier in places where it may be splashed by water.
7. Do not place the dehumidifier near a heat source.
8. Do not install the dehumidifier in a location that may be exposed to combustible gas.
9. Do not use the dehumidifier near flammable gas or combustibles, such as gasoline, benzene, thinner, etc.
10. Do not use in areas where chemicals are handled.
11. Do not climb on or place objects on the dehumidifier.
12. Do not place a heavy object on the power cord and make sure that the cord is not compressed.
13. Place the dehumidifier on a level, sturdy section of the floor, and avoid placing on uneven or tilted section. If the dehumidifier is knocked over during use, turn off the dehumidifier and unplug it from the main power supply immediately. Visually inspect the dehumidifier to ensure there is no damage.
14. Disconnect the power if strange sounds, smell, or smoke comes from the dehumidifier.
15. Do not take the water bucket out while the dehumidifier is working.
16. Do not cover the intake or exhaust openings with cloths or towels.
17. Care should be taken when using the dehumidifier in a room with the following persons: infants, children, the elderly and people not sensitive to humidity.
18. Never insert your finger or other foreign objects into grills or openings. Take special care to warn children of these dangers.
19. You should never try to take apart or repair the dehumidifier by yourself.

# Important Safety Instructions

---

- 20. Do not drink or use the water drained from the dehumidifier.
- 21. Always insert the filters securely. Make sure to clean the filter once every month.
- 22. Do not use the dehumidifier in tiny spaces.
- 23. If water enters the dehumidifier, please turn the dehumidifier off and disconnect the power, contact Yaufey Customer Service at email: [support@yaufey.com](mailto:support@yaufey.com) in order to avoid a hazard.

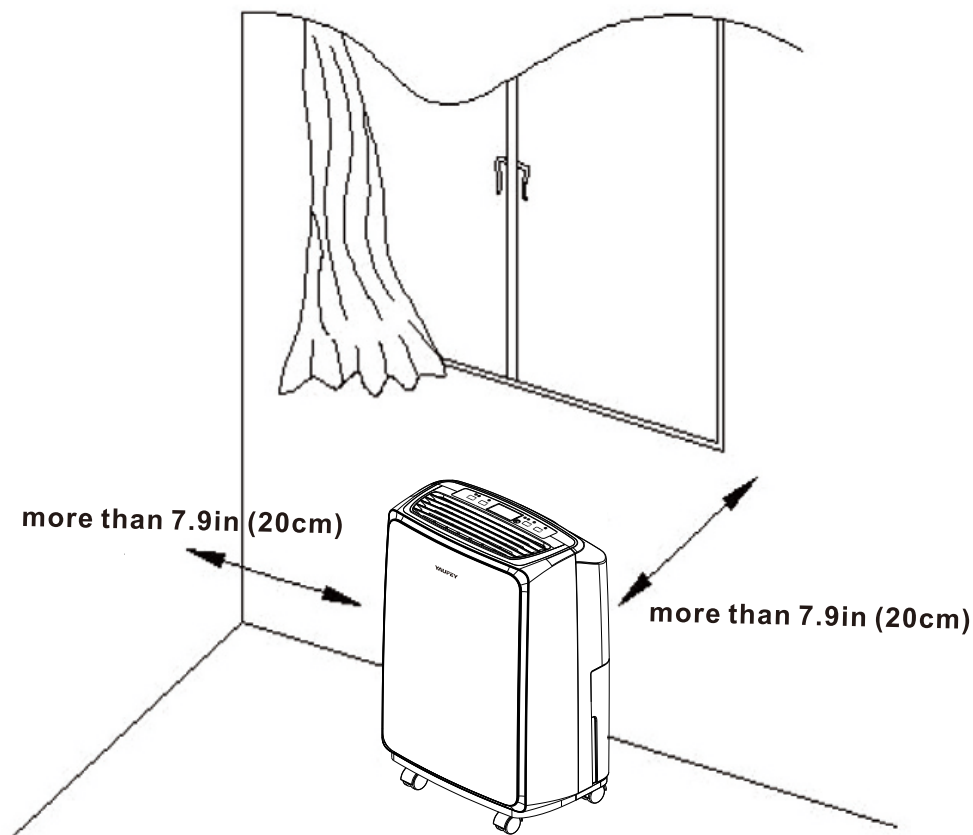

# Parts Description

## FRONT

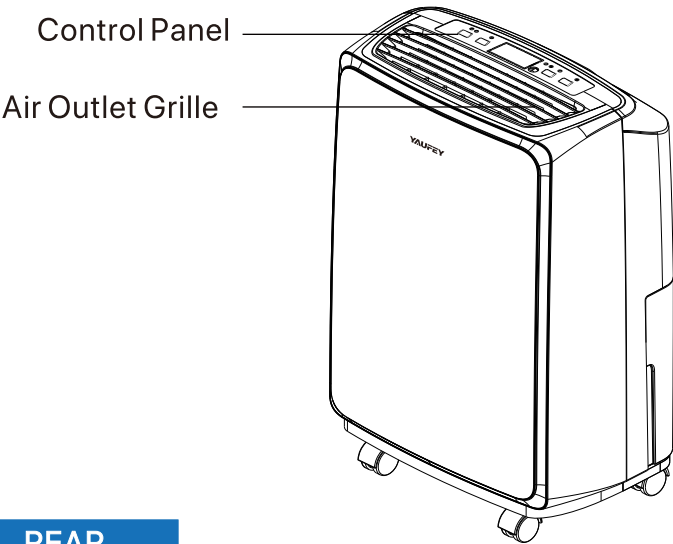

## REAR

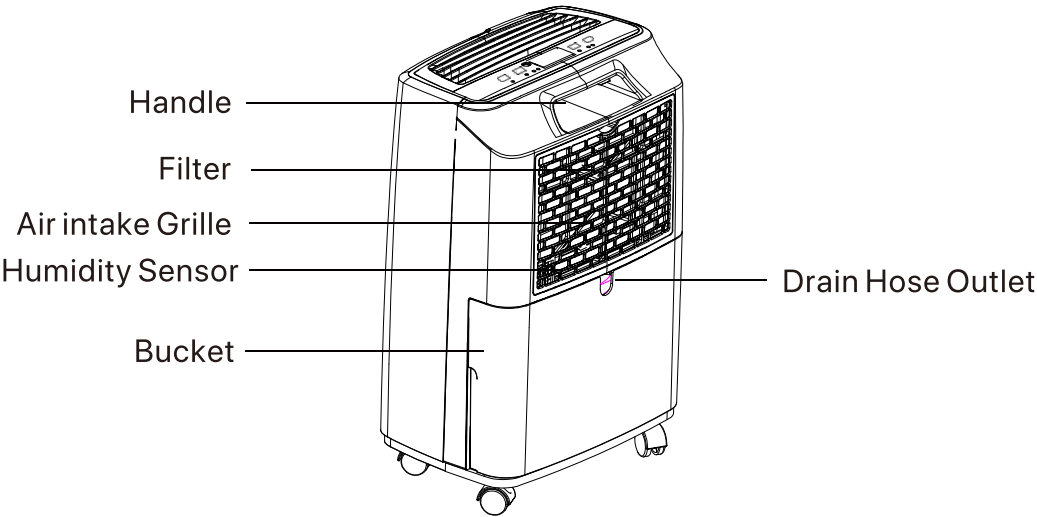

## CONTROL PANEL

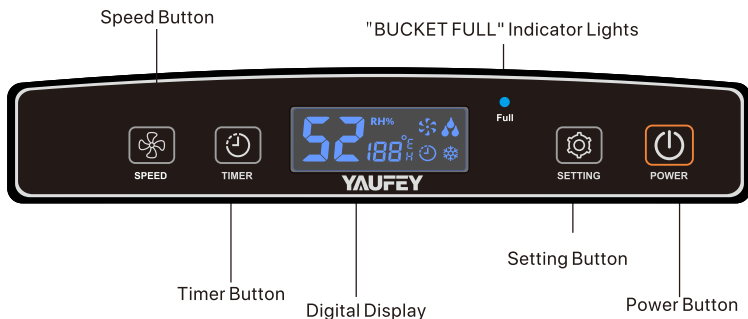

### **POWER button**

Press to turn the dehumidifier on and off.

### **SETTING button**

The humidity level can be set within a range of 30%RH to 80%RH in 5% increments.

-When it starts work, it will first automatically detect and show the room's humidity(and temperature). Press the "SETTING" button to change the humidity selection in 5% increments. It can be set circularly. (After you have set the desired humidity, the readout will display the actual room humidity.)

-When the humidity level overtakes or drops to the level you set, the dehumidifier will automatically begin working or stop.

-When the humidity level is set at 30%RH, the dehumidifier will be at CONTINUOUS dehumidifying mode.

### **TIMER Button**

The "TIMER" Button enables you to either Delay Start or Delay Stop the unit in the choice from 1 hour to 24 hours. In the shutdown state, the timer is set to the timing boot. In the boot state, the timer is set to the time shutdown.

TIMER setting:

1. Press "TIMER" button to change the delay timer at 1 hour increments, up to 24 hours. The control will count down the time remaining until start.

2. Click "TIMER" button, the control will display the room temperature like before. Click "TIMER" button again at any time will stop the TIMER function.

-Turning the dehumidifier ON or OFF at any time or adjusting the timer setting to 0.0 will cancel the Auto Start/Stop function.

## Note:

- Before entering TIMER setting, make sure power is being supplied to the unit.
- Before entering TIMER setting, make sure pressing Setting Button sets one desired room humidity first.



## SPEED Button

Control the fan speed. Press to select either High or Normal fan speed. A higher fan speed will result in quicker moisture removal. Set the fan control to High for maximum moisture removal. When the humidity has been reduced and quiet operation is preferred, set the fan control to Normal.



## "BUCKET FULL" Indicator Lights

When the bucket is full, the light will flash and the machine will automatically shut off. After the water in the bucket is emptied, put the bucket back in place, then the indicator will go out, and the machine will restart.



## Auto Defrost Feature

When the dehumidifier is running at a lower temperature, the system will automatically determine if there is frost, and if frost is present, it will automatically defrost.

## Defrost action

The fan runs at high wind speed while the compressor stops, and the LED screen display the defrosting symbol.

## Action Description

Power on: Compressor start after fan work a few seconds.

Power off: Compressor shut down at once, after a few seconds, the fan stop (when other malfunctions occurs or humidity reached the desired level, the fan will stop after tens of seconds ).

Tips: The compressor features "3 minutes delay protection" unction —— While the dehumidifier is powered, the compressor can only start again three minutes after its last shutdown.



## Fault & Protection Codes:

Number	Fault code	Name of the fault
1	E1	Humidity sensor error
2	E2	Defrost temperature sensor error
3	E4	Temperature sensor error
4	E7	Bucket is full. Empty the bucket.

## Attention :

1. If the display reads "E1", "E2" or "E4" error codes, please turn off and unplug the unit, and check for any obstructions. Plug it in again and restart the dehumidifier,
2. When one of the above malfunctions occurs, the buzzer will alarm for a few seconds. Press any key during the alarm to release the alarm sound.-If the malfunction is still present, please don't hesitate to contact Yaufey Customer Service email: [support@yaufey.com](mailto:support@yaufey.com) for help.

## Note:

Before starting the machine, please ensure that the air outlet has been opened, otherwise the machine will overheat. Do not pull out the power cord directly to stop the machine.

## REMOVING THE COLLECTED WATER

There are two ways to remove collected water:

### 1. Use the bucket

When the bucket is full, remove the bucket and empty it.

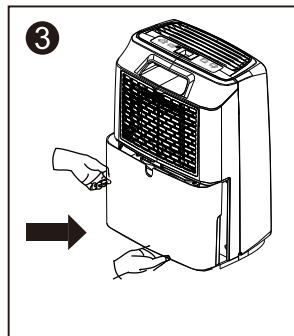
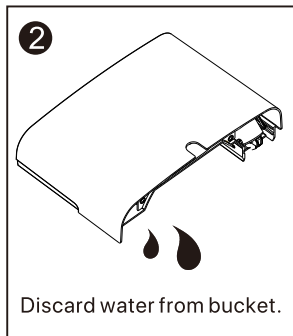
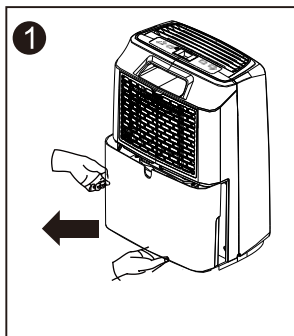

### Note:

Replace the empty bucket back into the unit and once seated correctly, the unit will start up again.

- You should hear a click when the bucket is in the correct position.
- Do not remove the float in the bucket, otherwise the sensor will not be able to sense the water level properly, so that the water will overflow from the bucket when the bucket is full.
- If the tank is dirty, only can be used in cold or warm water wash, do not use detergent, steel wool, chemical processing dust cloth, gasoline, benzene, thinner or other solvent treatment, otherwise it may cause damage to the tank Water Leakage.

## Continuous Drainage

The continuous drainage function can be realized by connecting the drainage pipe at the continuous drainage port

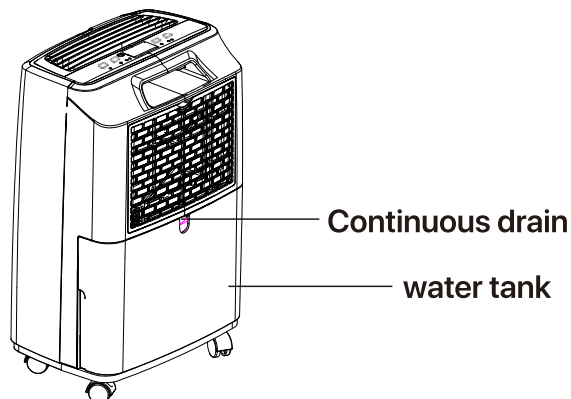

Continuous drainage Pipe installation

Picture 1: Example of error connection

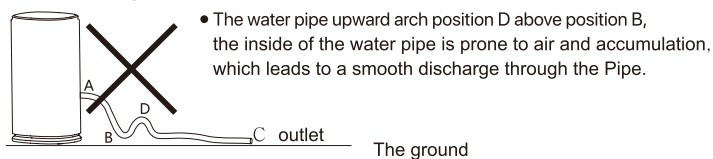

Picture 2: Example of error connection

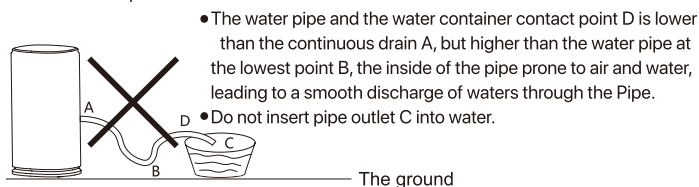

Picture 3: Example of a correct connection

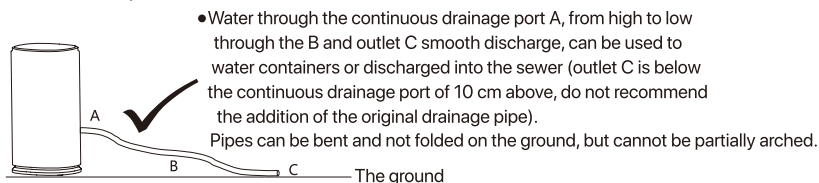

The picture is for reference only.

# Care & Cleaning

## CARE AND CLEANING OF THE DEHUMIDIFIER

### WARNING:

Turn the dehumidifier off and remove the plug from the wall outlet before cleaning.

### 1. Clean the bucket

Clean the bucket with water every two (2) weeks.

### 2. Clean the air filter

Clean the filter with clean water at least once every 30 days.

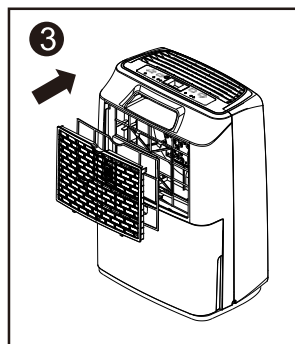
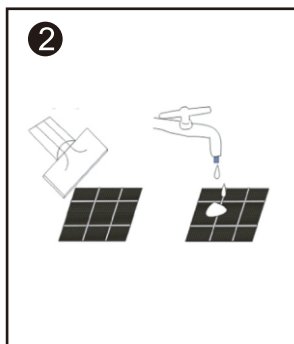
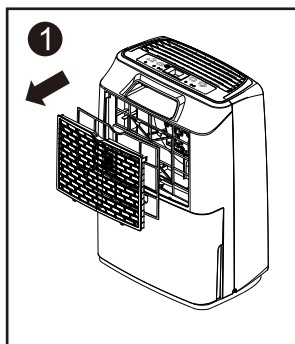

### 3. Storing the dehumidifier

When not using the dehumidifier for long periods

- After turning off the dehumidifier, wait one day before emptying the bucket.
- Clean the main dehumidifier, bucket and air filter.
- Wrap the cord and bundle it with the band.
- Cover the dehumidifier with a plastic bag.
- Store the dehumidifier upright in a dry, well-ventilated place.

### CAUTION:

Do not operate the dehumidifier without a filter. Because dirt and lint will clog it and reduce performance.

# Troubleshooting

Before calling Yaufey customer service, review this list. It may save you time and expense. This list includes the most common occurrences that are not the result of defective craft or materials in this dehumidifier.

PROBLEM	CAUSE
Dehumidifier does not start	<ul style="list-style-type: none"><li>- Make sure the dehumidifier’s plug is inserted completely into the outlet.</li><li>- Check the house fuse/circuit breaker box.</li><li>- Dehumidifier has reached its preset level or bucket is full.</li><li>- Bucket is not in the proper position.</li><li>- Room temperature is between 41°F (5°C) and 68°F (20°C). Auto-defrost is in progress. The unit can't be started temporarily.</li></ul>
Dehumidifier does not dry the air as it should	<ul style="list-style-type: none"><li>- Did not allow enough time to remove the moisture.</li><li>- Make sure there are no curtains, blinds or furniture blocking the front or back of the dehumidifier.</li><li>- The humidity selector may not be set low enough.</li><li>- Check that all doors, windows and other openings are securely closed.</li><li>- Room temperature is too high or too low, above 100°F (38°C) or below 41°F (5°C).</li><li>- There is a kerosene heater or something giving off water vapor in the room.</li></ul>
The dehumidifier makes a loud noise when operating	<ul style="list-style-type: none"><li>- The air filter is clogged.</li><li>- The dehumidifier is tilted instead of upright as it should be.</li><li>- The floor surface is not level.</li></ul>

Please contact Yaufey Customer Service at [support@yaufey.com](mailto:support@yaufey.com) if dehumidifier operates abnormally or does not operate, and the solutions above are not useful.

# Technical specifications

---

Model Name	Dehumidifier
MODEL	HD163A
POWER SOURCE	110-120V ~ 60Hz
RATED POWER	200W
RATED CURRENT	2.0A
INPUT POWER(80°F, RH60%)	160W
INPUT CURRENT(80°F, RH60%)	1.7A
MOISTURE REMOVAL(80°F, RH60%)	11.5pints/Day( 5.45L/Day)
INPUT POWER(86°F, RH80%)	180W
INPUT CURRENT(86°F, RH80%)	1.8A
MOISTURE REMOVAL(86°F, RH80%)	22.5pints/Day(10.7L/Day)
INPUT POWER(95°F, RH90%)	260W
INPUT CURRENT(95°F, RH90%)	2.6A
MOISTURE REMOVAL(95°F, RH90%)	32.7pints/Day( 15.5L/Day)
MOTOR FLA	0.19A
MOTOR COMPRESSOR	RLA:1.75A LRA:11A
REFRIGERANT	R134a/3.7ozs(105g)
HIGH PRESSURE	232PSIG(1.6MPa)
LOW PRESSURE	90PSIG(0.62MPa)

# Warranty

---

Yaufey offers a 12-month warranty on all of our products purchased new and unused from Yaufey Technologies Co.,Ltd. or an authorized reseller, with an original proof of purchase and where a defect has arisen, wholly or substantially, as a result of faulty manufacturing, parts or workmanship during the Warranty Period. The warranty does not apply where damage is caused by other factors, including without limitation:

- (a) Normal wear and tear;
- (b) Abuse, mishandling, accident or failure to follow operating instructions;
- (c) Exposure to liquid or infiltration of foreign particles;
- (d) Servicing or modification of the product other than by Yaufey.

These are our general terms for the warranty service, but we always urge our customers to reach out to us with any issue, regardless of warranty terms. If you experience an issue with a Yaufey product, please contact us at Email: **support@yaufey.com**, we will do our best to resolve it for you.

## Get That Warranty

---

Register your product within **14 days** of your purchase to receive **an extra bonus year on your warranty!**

1. Visit **www.yaufey.com/account/register**
2. Enter in your purchase information and opt into our exclusive community.
3. Receive wellness tips, style inspiration, a chance to win **free product giveaways**, and the inside scoop on Yaufey products in your inbox.

## Contact Us

---



OFFICIAL WEBSITE

[www.yaufey.com](http://www.yaufey.com)



EMAIL US

[support@yaufey.com](mailto:support@yaufey.com)

# YAUFEY

Home Dehumidifier

[support@yaufey.com](mailto:support@yaufey.com)

Contact us on Facebook:

(Scan the QR Code Get More)