

FIREPLACE TV STAND

FP4

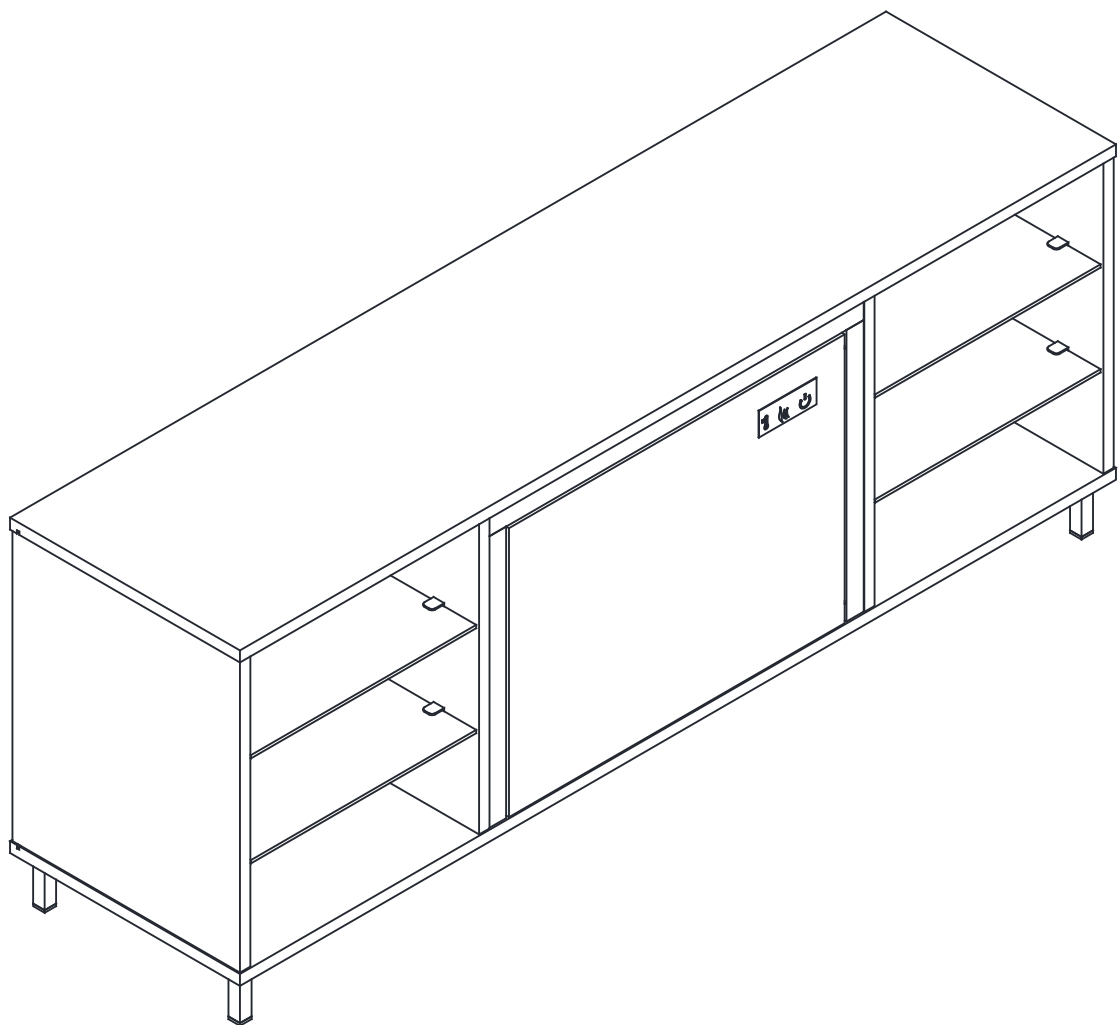
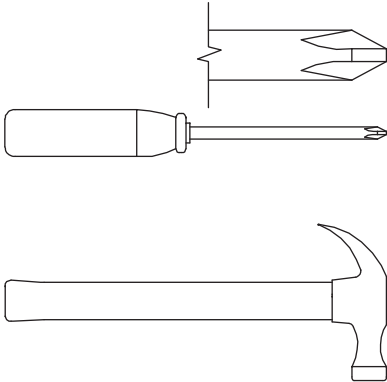

Table of Contents

Assembly Tools Required

Part Identification	3
Hardware Identification	4
Assembly Steps	5-24



No. 2 Phillips Screwdriver
Tip Shown Actual Size

Hammer
Not actual size 😊

Part Identification

Now you know
our ABCs.



- ◆ While not all parts are labeled, some of the parts will have a label or an inked letter on the edge to help distinguish similar parts from each other. Use this part identification to help identify similar parts.

A	TOP (1)
B	BOTTOM (1)
C	LEFT END (1)
D	RIGHT END (1)
E	LEFT UPRIGHT (1)
F	RIGHT UPRIGHT (1)
G	BACK (2)
H	SHELF (4)
J	TOP MOLDING (1)
K	LEFT MOLDING (1)
L	RIGHT MOLDING (1)

O	END LEG (2)
P	BOTTOM MOLDING (2)
Q	SHORT LEG (2)
R	MIDDLE SHELF (1)
W	FIREPLACE (1)
X	TOP BRACKET (1)
Y	END BRACKET (2)

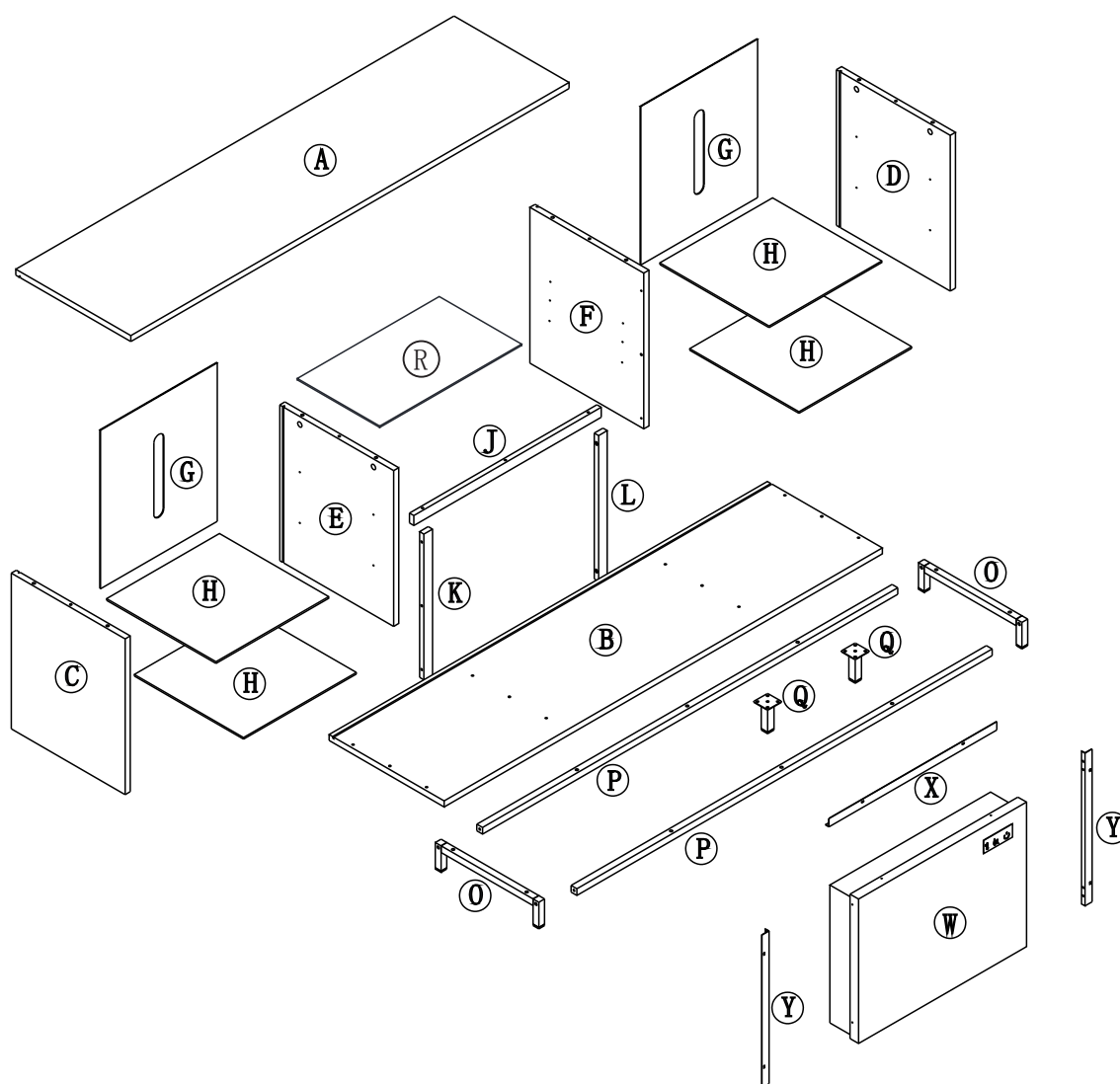

Hardware Identification

◆ Screws are shown actual size. You may receive extra hardware with your unit.

1 CAM SCREW - 8

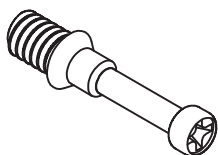

2 HIDDEN CAM - 8

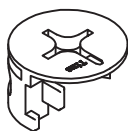

3 WOOD DOWEL - 10

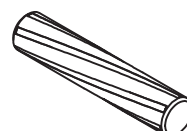

4 APPLIQUE CARD - 2

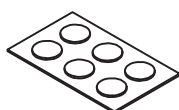

5 GLASSCLIP - 16

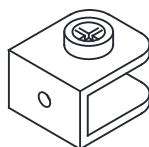

6 CLIP - 8

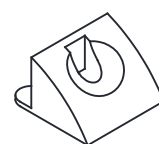

7 LWRENCH - 1



8 1-5/8" HEX HEAD SCREW - 4

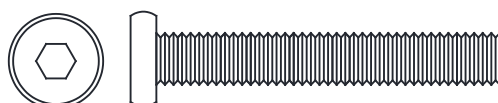

9 1-3/8" PAN HEAD SCREW - 15



10 1-3/16" HEX HEAD SCREW - 10

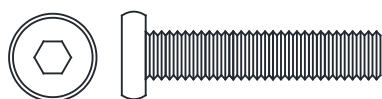

11 1/2" PAN HEAD SCREW - 8



12 1/2" FIAT HEAD SCREW - 16



13 5/8"FIAT HEAD SCREW - 8



14 METAL PIN - 4



15 WARNING LABEL - 1



(Refer to the last step for proper location and application)

ZZ 3/8" PAN HEAD SCREW-15



Hardware Usage Guide

HOW TO USE A HIDDEN CAM & CAM SCREW OR CAM DOWEL

1. NOTE: Various CAM SCREWS or a CAM DOWEL may be used.

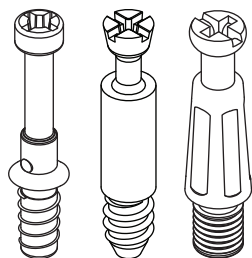

Cam Screws

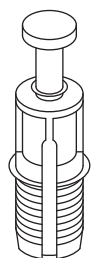

Cam Dowel

Turn the CAM SCREW or gently tap the CAM DOWEL until the shoulder is against the surface of the part.

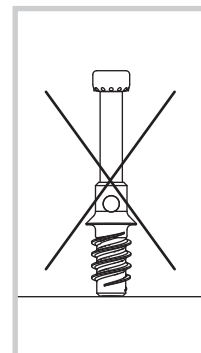
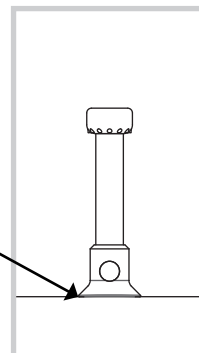

- 2.

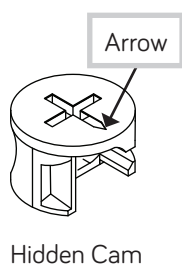

Hidden Cam

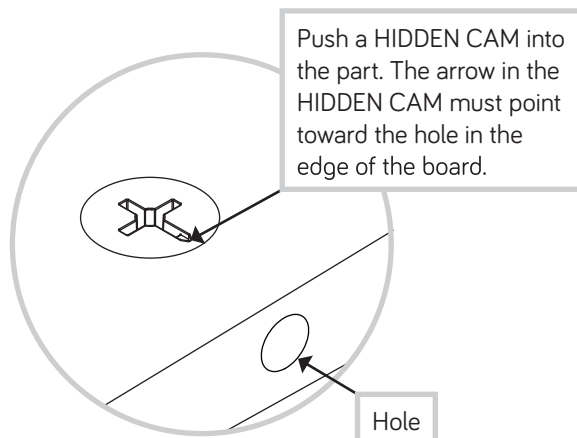

- 3.

Insert the CAM SCREW or CAM DOWEL into the HIDDEN CAM. Tighten the HIDDEN CAM.

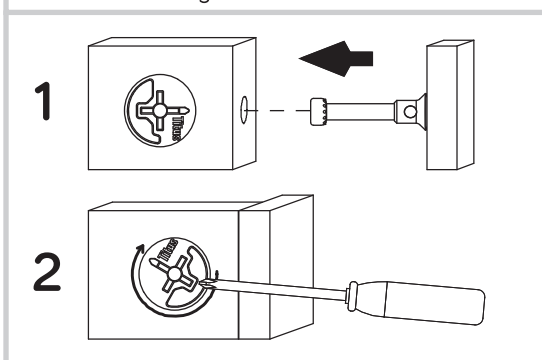

Step 1

- ◆ Assemble your unit on a carpeted floor or on the empty carton to avoid scratching your unit or the floor.
- ◆ Turn eight CAM SCREWS (1) into the TOP (A).

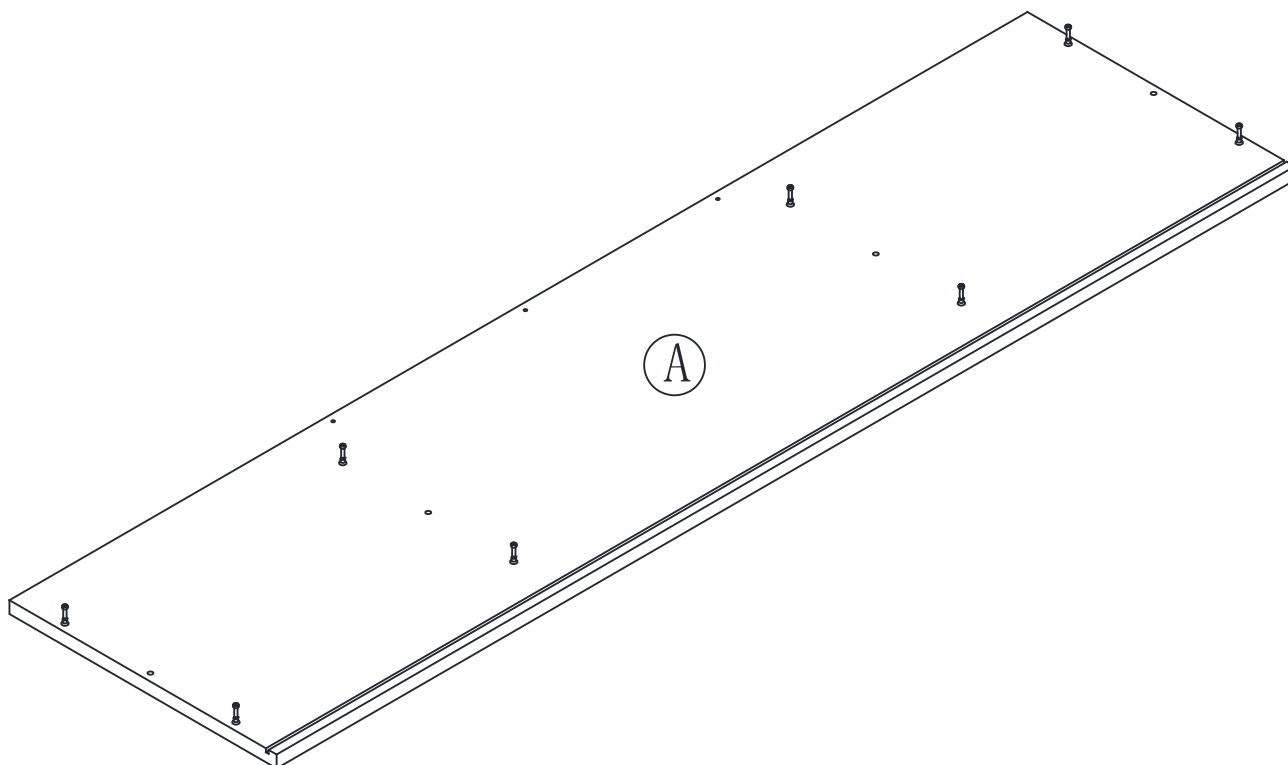
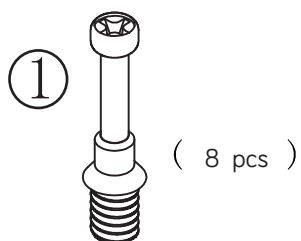
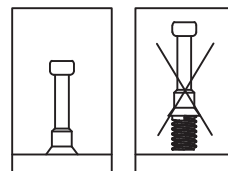

Step 2

- ◆ Push eight HIDDEN CAMS (2) into the ENDS (C and D) and the UPRIGHTS (E and F).

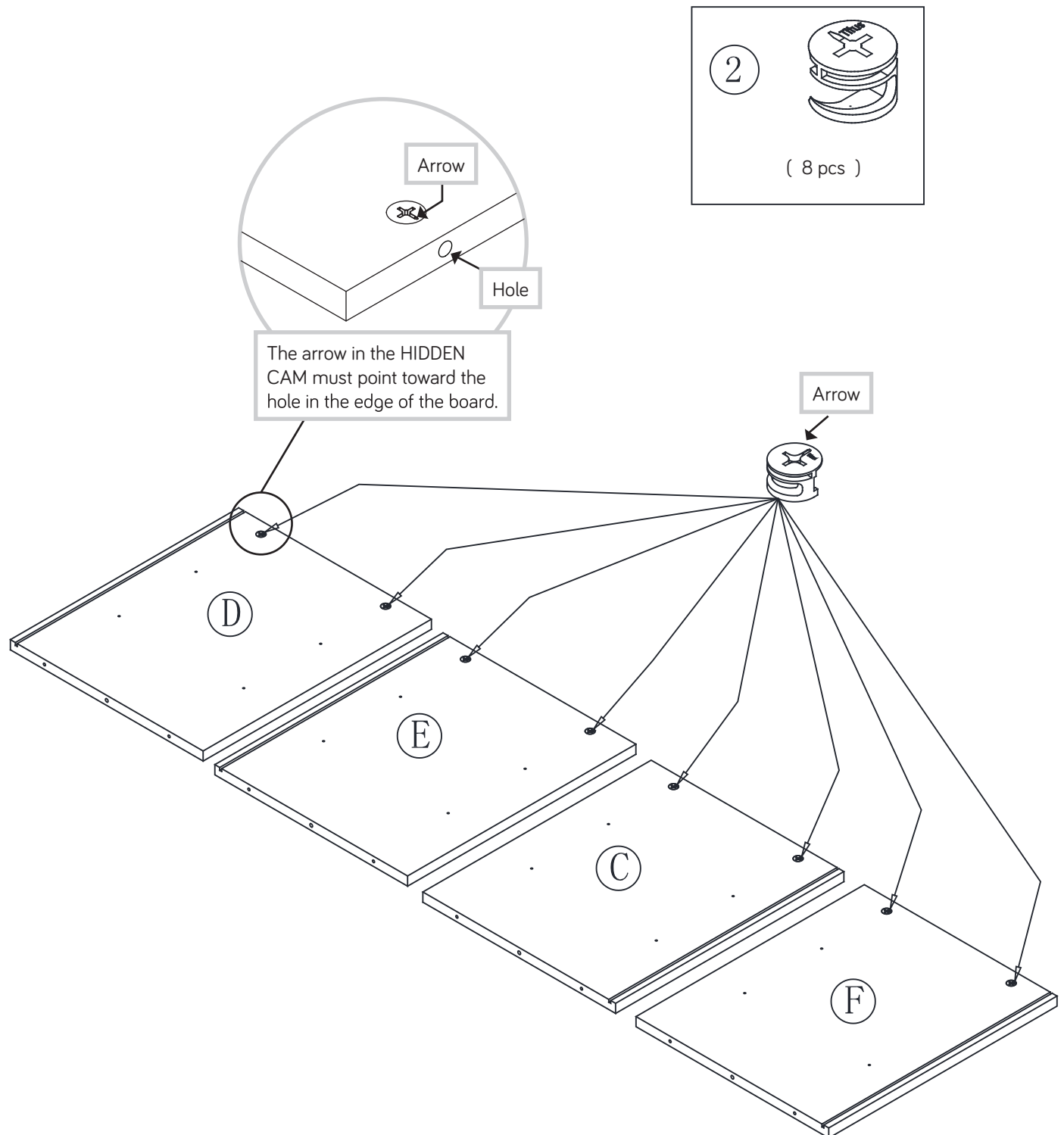

Step 3

- ◆ Push the WOOD DOWELS (3) into the exact hole shown in the UPRIGHTS (E and F).
- ◆ Fasten the LEFT MOLDING (K) to the LEFT UPRIGHT (E).
- ◆ Fasten the RIGHT MOLDING (L) to the RIGHT UPRIGHT (F).
- ◆ Use four 1-3/8"mm Pan Head Screws.
- ◆ NOTE: You should align each SCREW to the holes before completely tightening any of them.

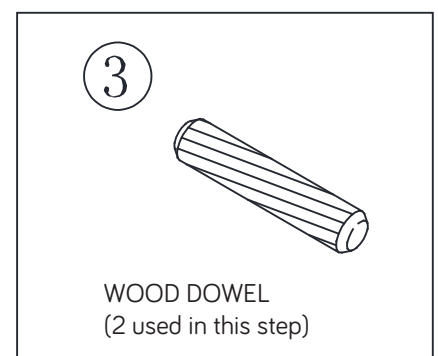
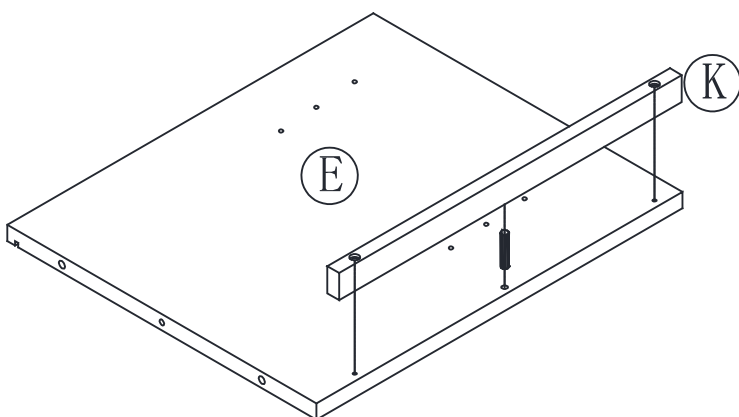
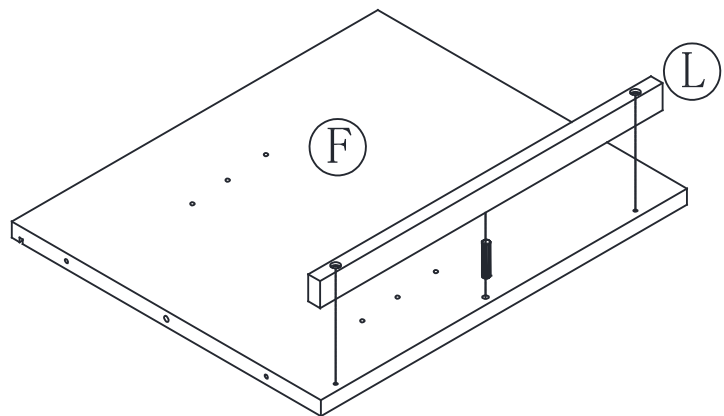
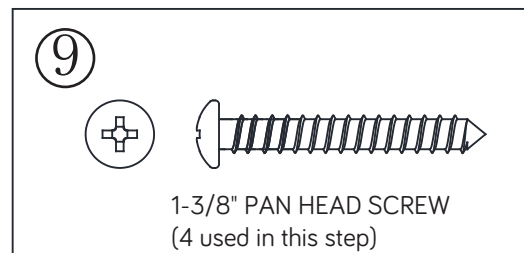

Step 4

- ◆ Fasten sixteen GLASS CLIPS (5) to the ENDS (C and D) and UPRIGHTS (E and F). Use sixteen 1/2" FLAT HEAD SCREWS

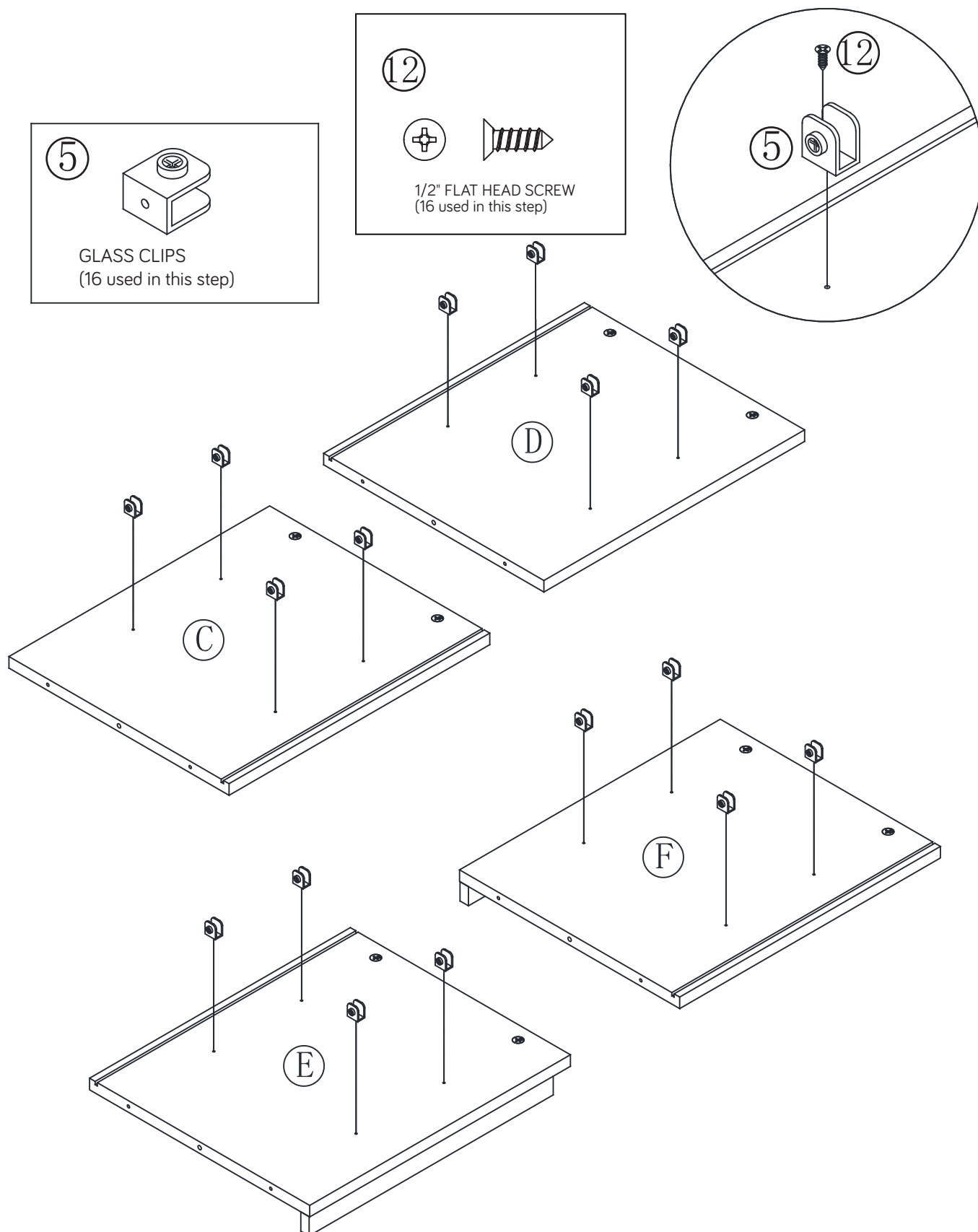

Step 5

- ◆ Fasten the TOP MOLDING (J) to the TOP (A).
Use three 1-3/8" Pan Head Screws.
- ◆ NOTE: You should align each SCREW to the holes before completely tightening any of them.

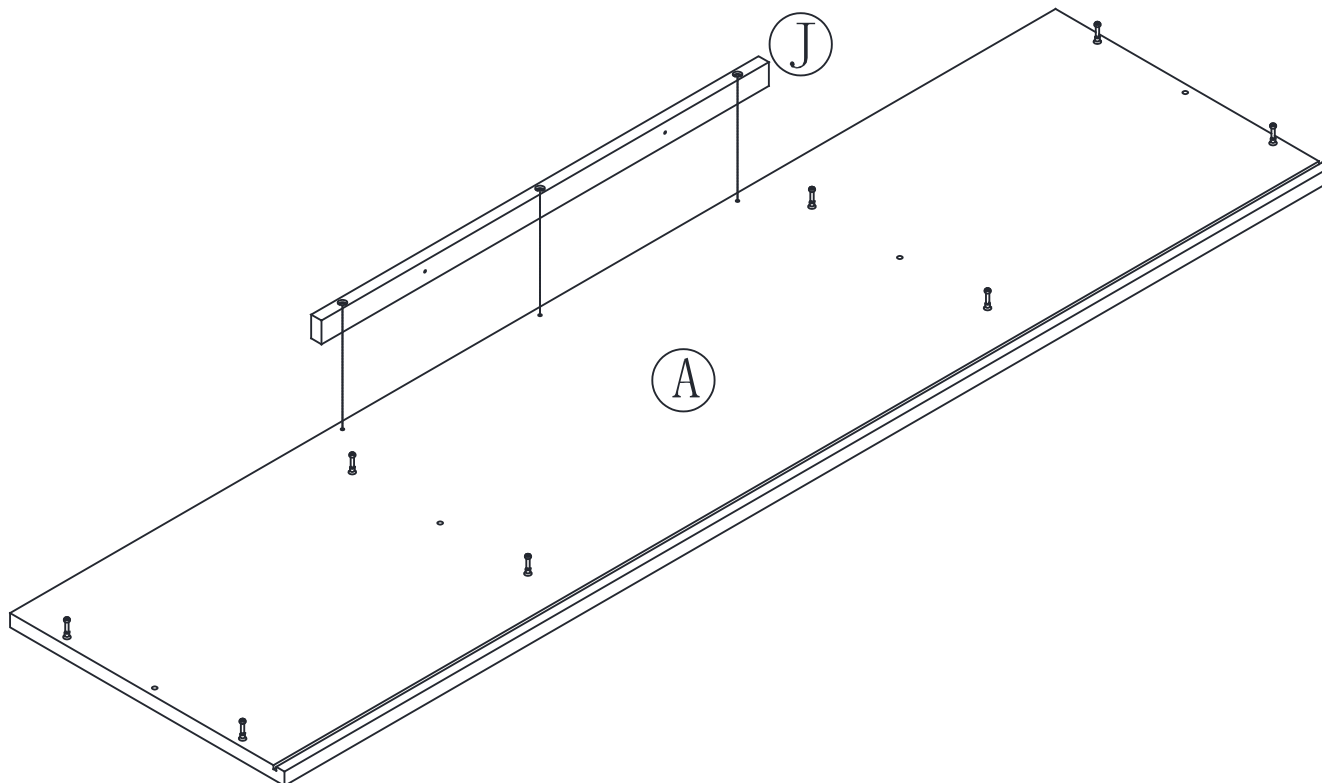
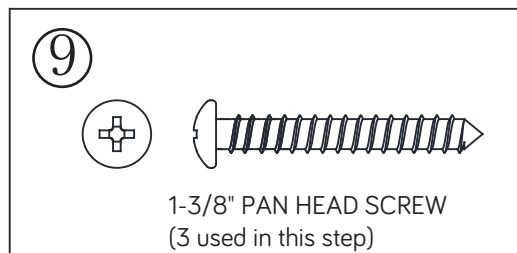

Step 6

- ◆ Push the WOOD DOWELS (3) into the exact hole shown in the TOP (A).
- ◆ Fasten the UPRIGHTS (E and F) and the ENDS (C and D) to the TOP (A).
Tighten eight HIDDEN CAMS.

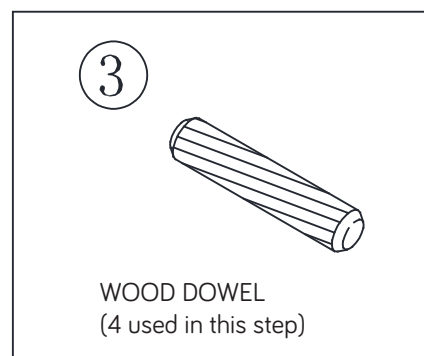
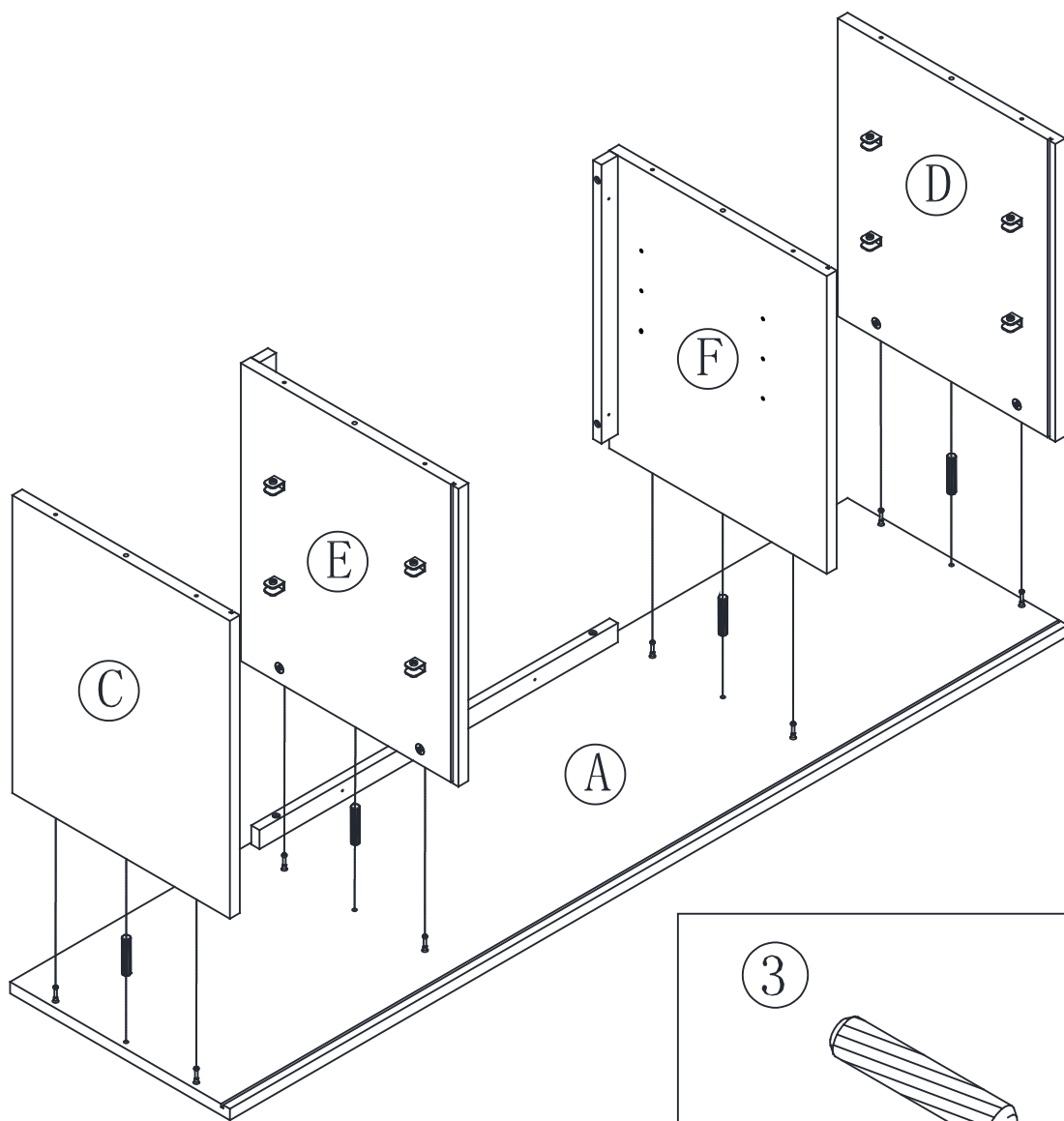
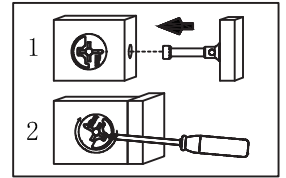
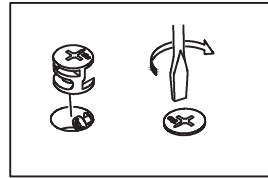
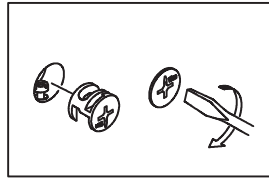

Step 7

- ◆ Slide the BACK (G) into the grooves of the LEFT UPRIGHT (E) and LEFT END (C).
- ◆ Slide the BACK (G) into the grooves of the RIGHT UPRIGHT (F) and the RIGHT END (D).

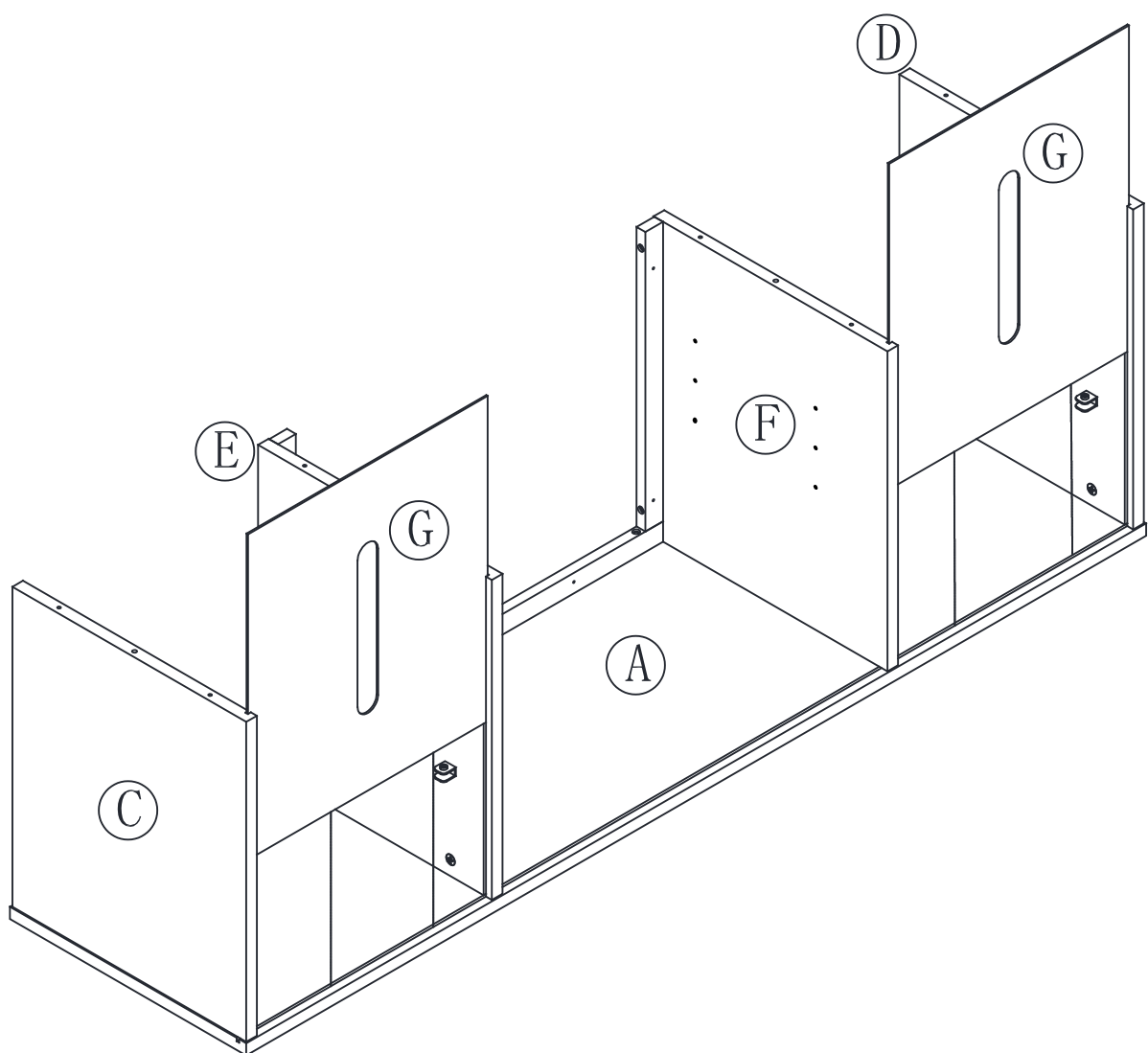

Step 8

- ◆ Push the WOOD DOWELS (3) into the exact hole shown in the UPRIGHTS (E and F) and the ENDS (C and D). Fasten (B) to the ENDS (C and D), UPRIGHTS (E and F).
- ◆ Use eight 1-3/8 " PAN HEAD SCREWS (9).
- ◆ NOTE: You should align each SCREW to the holes before completely tightening any of them.

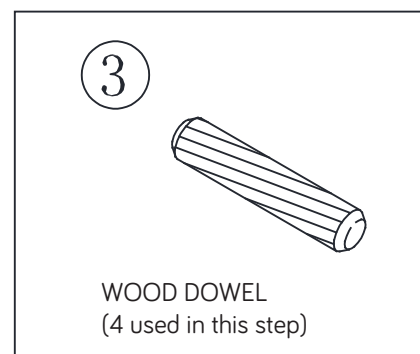
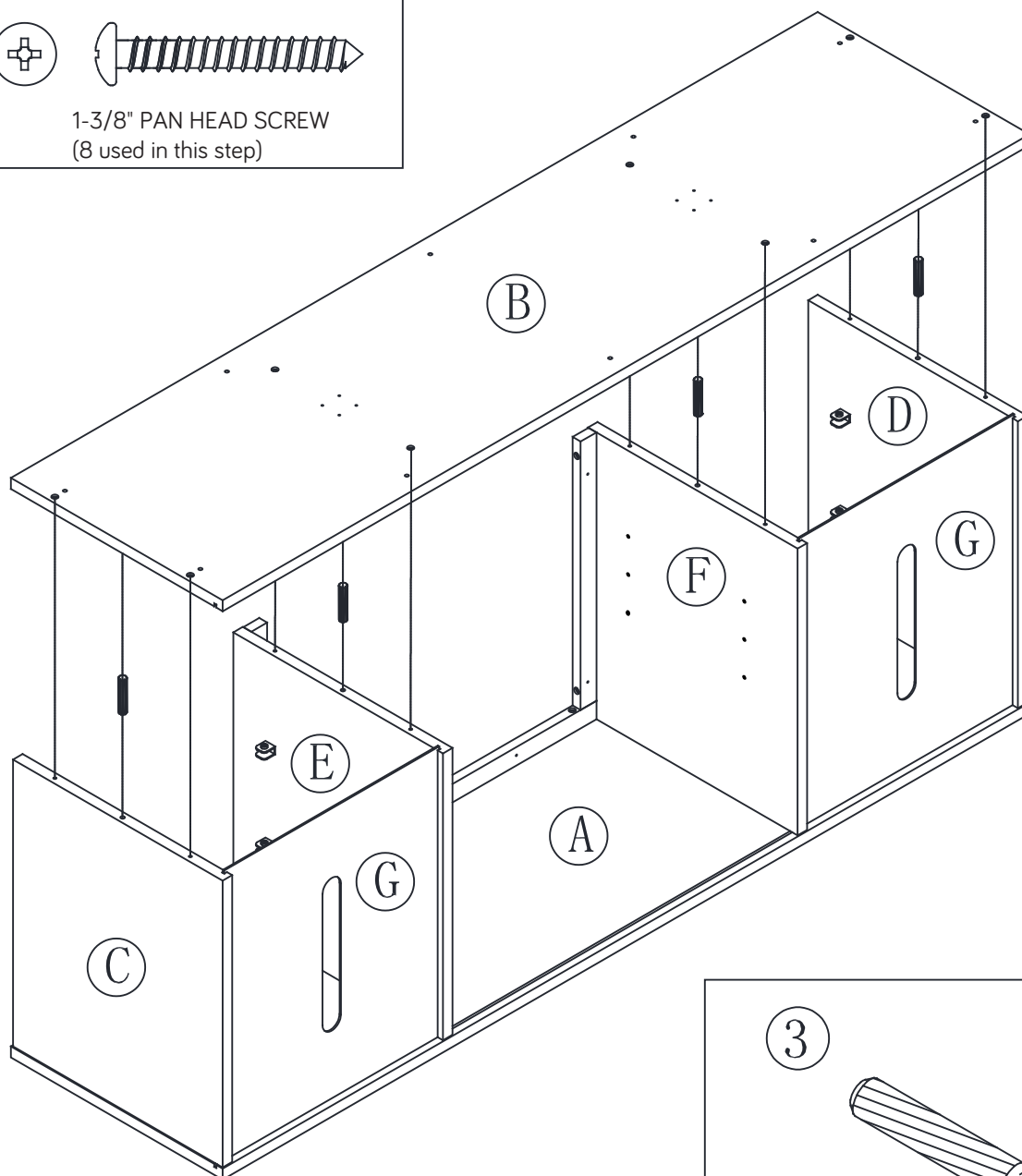
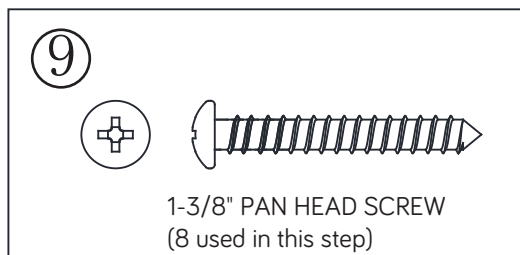

Step 9

- ◆ Fasten the END LEGS (O) to the BOTTOM MOLDINGS (P). Use four 1-5/8" HEX HEAD SCREWS (8) with the L-WRENCH.

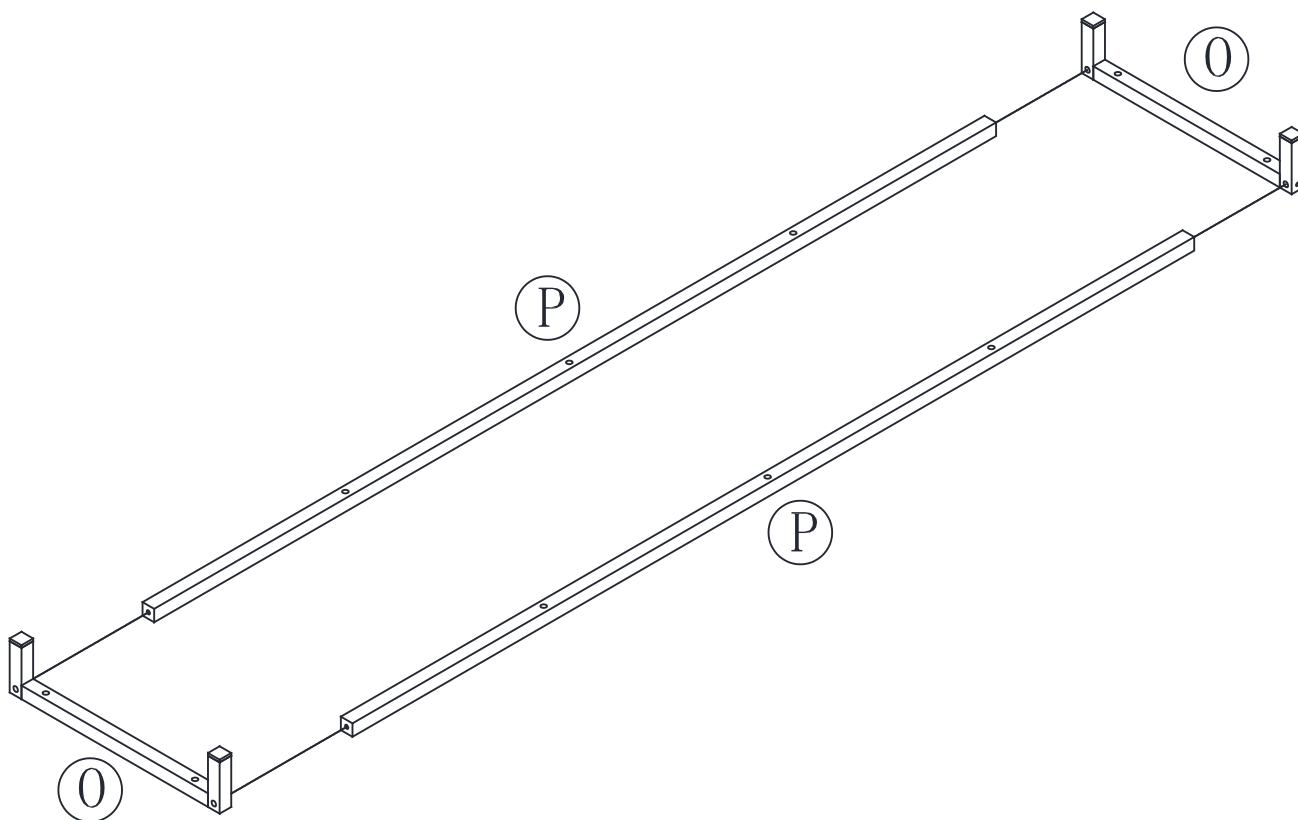
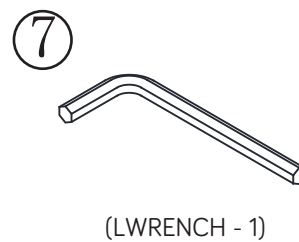
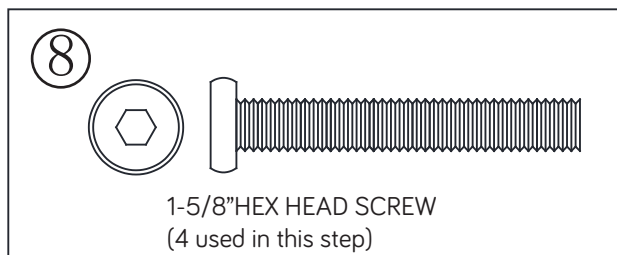

Step 10

- ◆ Fasten the LEGS to the BOTTOM (B). Use ten HEX HEAD SCREWS (10) with the L-WRENCH.

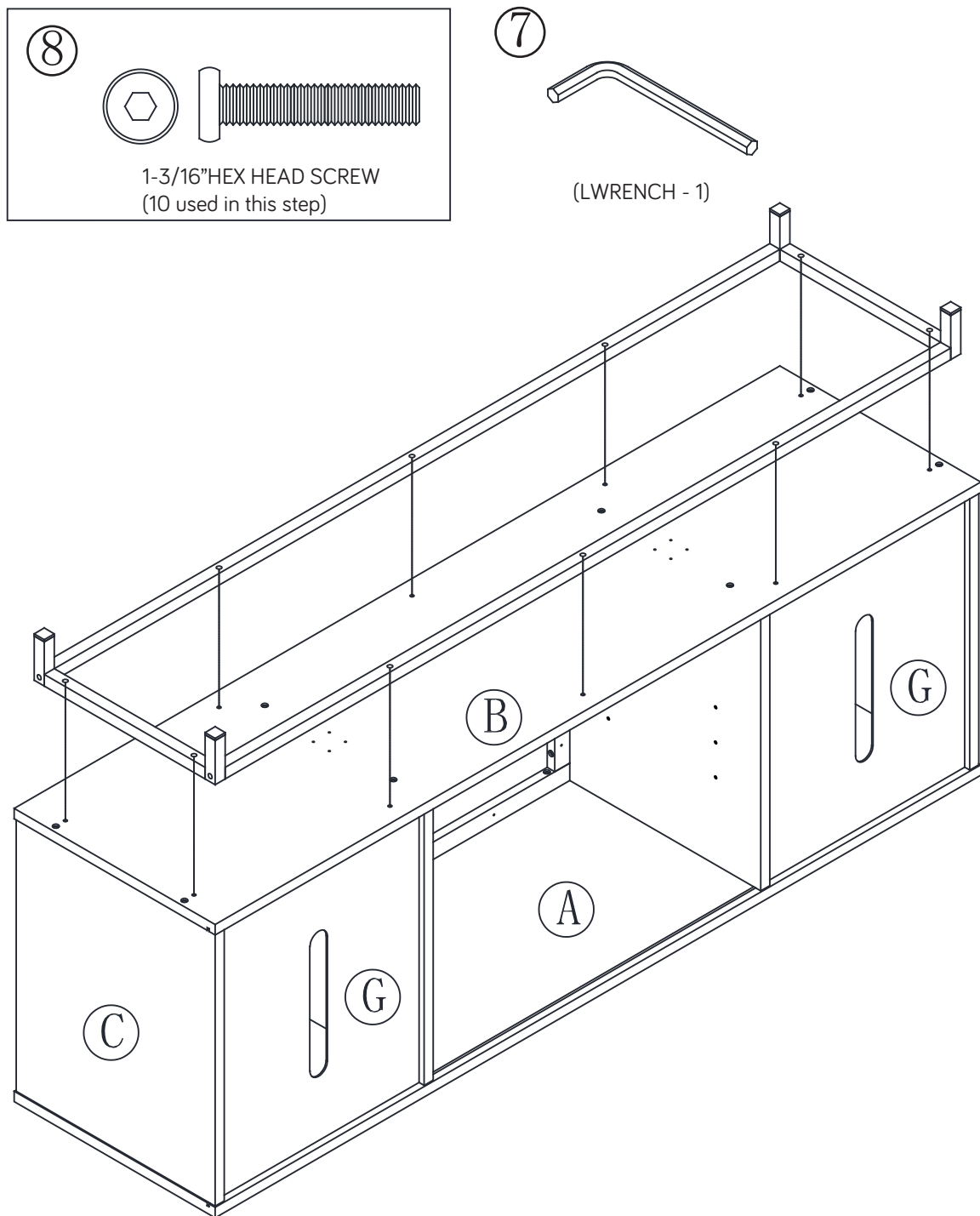

Step 11

- ◆ Fasten the SHORT LEGS (Q) to the BOTTOM (B). Use eight 1/2" PAN HEAD SCREWS.

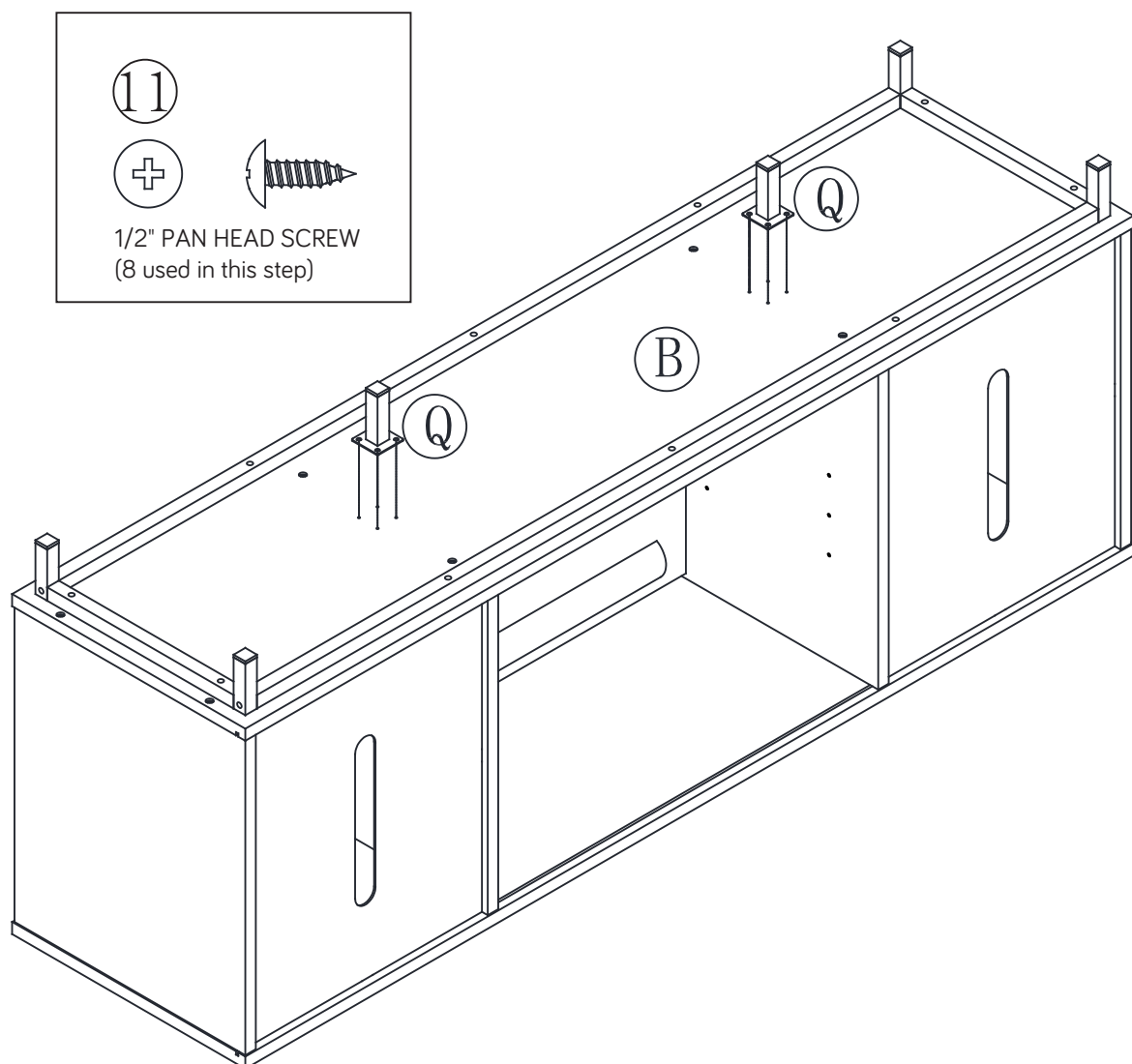

Step 12

- ◆ Push eight CLIPS (6) between the BACKS (G) and connecting BOTTOM(B), ENDS (C and D), UPRIGHTS (E and F) and TOP(A).
- ◆ Then, fasten the CLIPS (10) with eight 5/8" FLAT HEAD SCREWS (13).

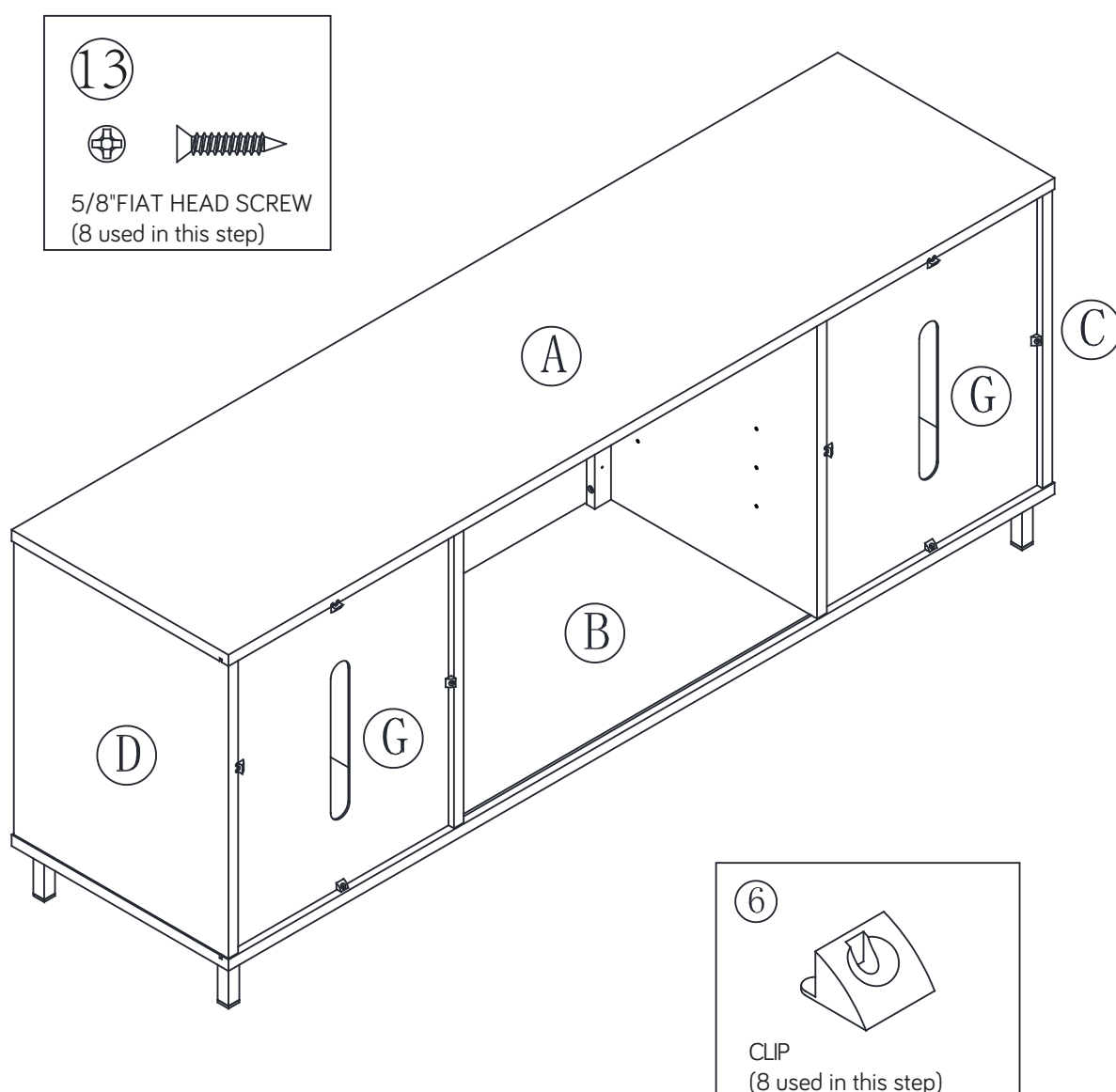

Step 13

- ◆ Set the SHELVES (H) onto the GLASS CLIP (5).
- ◆ Fasten the screw of Glass CLIP to fixed the SHELVES (H) in position.

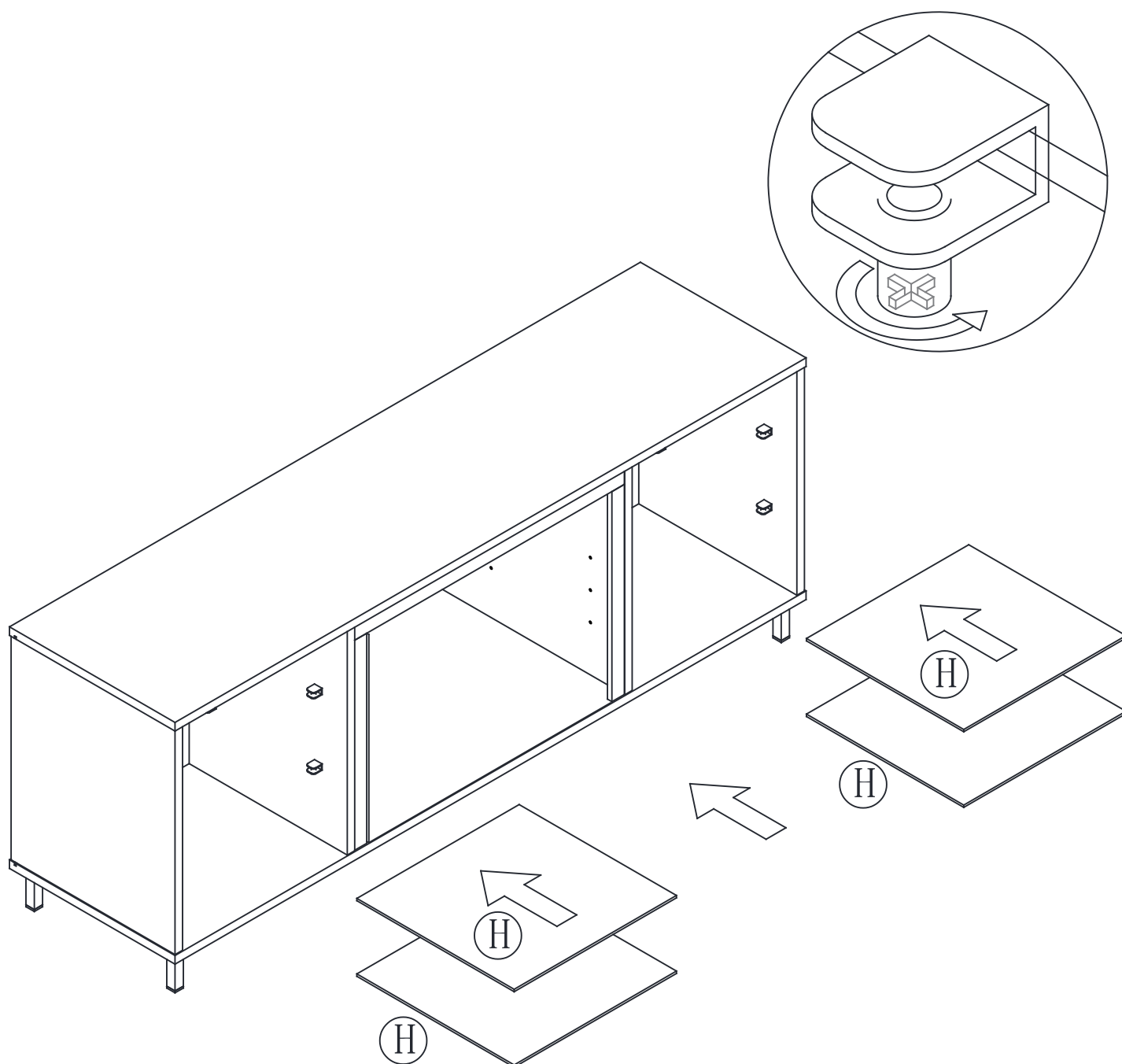

Step 14

- ◆ Please go to step 15 if you want to put the middle shelf (Z) as show in diagram #1 or go to step 20 if you want to put the insert as show in diagram #2.

Diagram #1

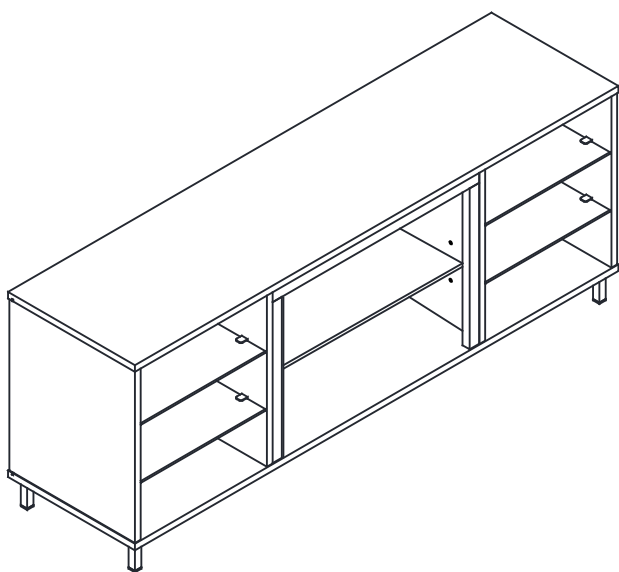
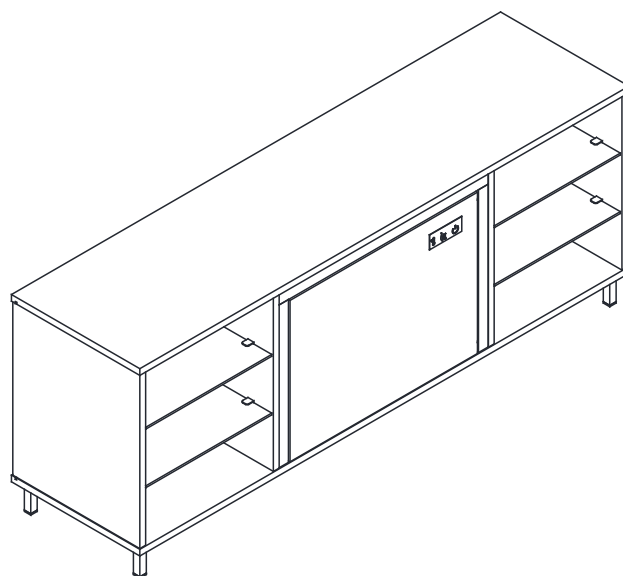
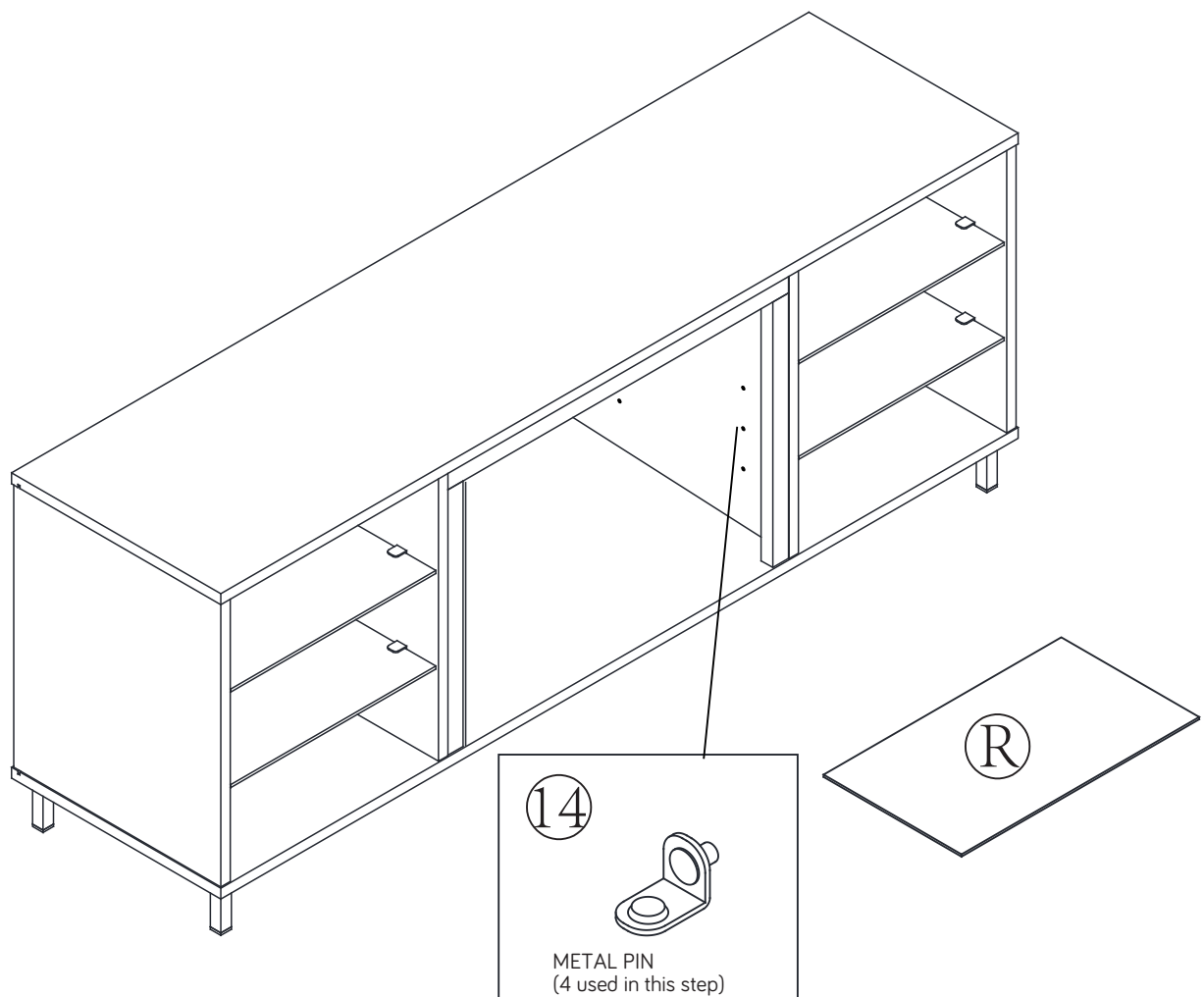

Diagram #2



Step 15

- ◆ Insert the METAL PINS (14) into the hole locations of your choice in the UPRIGHTS (E and F).
- ◆ Set the ADJUSTABLE SHELF (R) onto the METAL PINS.



Step 16

- ◆ Peel APPLIQUES from the APPLIQUE CARDS (4) and stick them onto each visible HIDDEN CAM.
- ◆ This completes assembly. Clean with a damp cloth. Wipe dry.
- ◆ Apply the WARNING LABEL (15) to the TOP (A). You should be able to read the label when the TV is removed from the unit. When the TV is in place, it should hide the label. Peel off the backing and apply the label as shown in the diagram.
- ◆ NOTE: This is a permanent label intended to last for the life of the product. Once applied, do not try to remove it.
- ◆ This completes assembly. Clean with a damp cloth. Wipe dry.

⚠ WARNING	• ADVERTENCIA	• AVERTISSEMENT ⚠
Never use this furniture with a TV that is too large or too heavy. Severe injury or death can occur. The TV and furniture will be unstable and may tip.	Nunca use este mueble con un televisor que es demasiado grande o demasiado pesado. Podría resultar en una lesión grave hasta fatal. El televisor y el mueble estarán inestables y pueden volcarse.	Ne jamais utiliser ce meuble avec un téléviseur qui soit trop large ou trop lourd. Risque de provoquer des blessures graves, voire mortelles. Le téléviseur et le meuble seront instables et risquent de se renverser.
-The TV must weigh less than 70 lbs. -The base of the TV must be able to sit completely on this shelf.	-El televisor debe pesar 31,75 kg o menos. -La base del televisor debe poder colocarse completamente sobre este estante.	-Le téléviseur doit peser 31,75 kg ou moins. -Le socle du téléviseur doit pouvoir être placé complètement sur cette tablette.
Refer to instruction book for complete safety information.	Consulte el folleto de instrucciones para información completa sobre la seguridad.	Consulter le manuel d'instructions pour information complète concernant la sécurité.
<i>Note: This is a <u>permanent</u> label. Do not try to remove. Surface will be damaged.</i>	<i>Nota: Esta etiqueta es <u>permanente</u>. No intente quitarla. Causará daño a la superficie.</i>	<i>Remarque: Cette étiquette est <u>permanente</u>. Ne pas essayer de la retirer. Causer des dommages à la surface.</i>

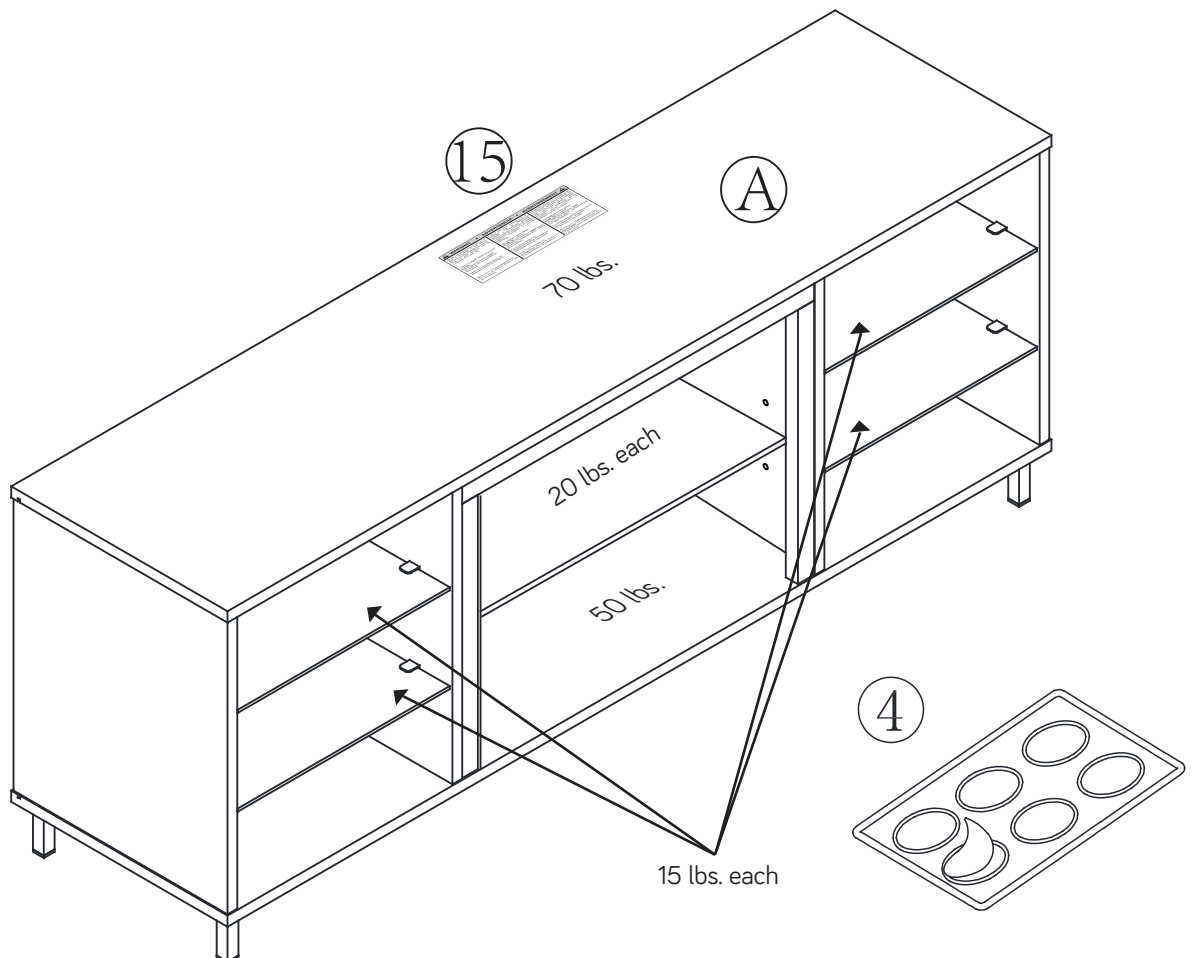

Step 17

- ◆ Fasten the BRACKETS (X and Y) to the FIREPLACE (W). Use six 3/8" FLAT HEAD SCREWS (ZZ).

WARNING

CAUTION!!

Please read all FIREPLACE instructions prior to installing or removing it from your unit.

Do not plug the FIREPLACE into the power supply until it is installed and your unit is in its final position. Do not move the FIREPLACE while it is plugged into a power supply. Unplug it before moving it.

ZZ

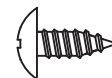

3/8" PAN HEAD SCREW
(6 used in this step)

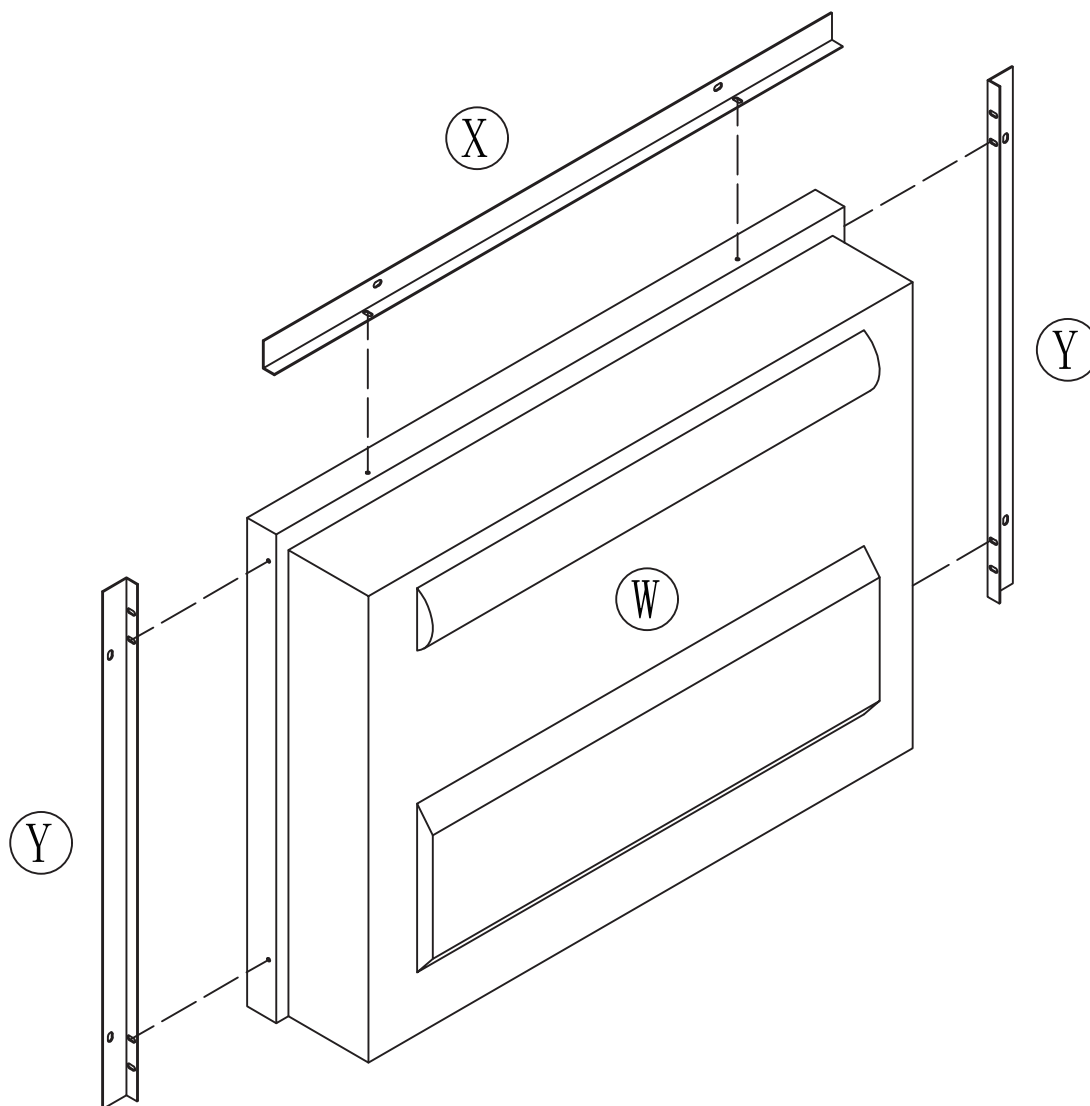

Step 18

- ◆ Insert the FIREPLACE (W) in through the opening in the back of your unit.

Fasten the FIREPLACE (W) to the MOLDINGS (, P and Q).

- ◆ Use two BLACK 3/8" PAN HEAD SCREWS (ZZ) through the BRACKETS on the FIREPLACE and into the holes in the MOLDINGS

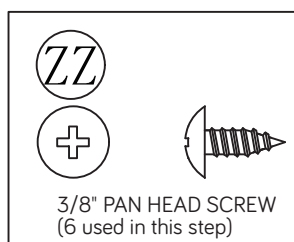
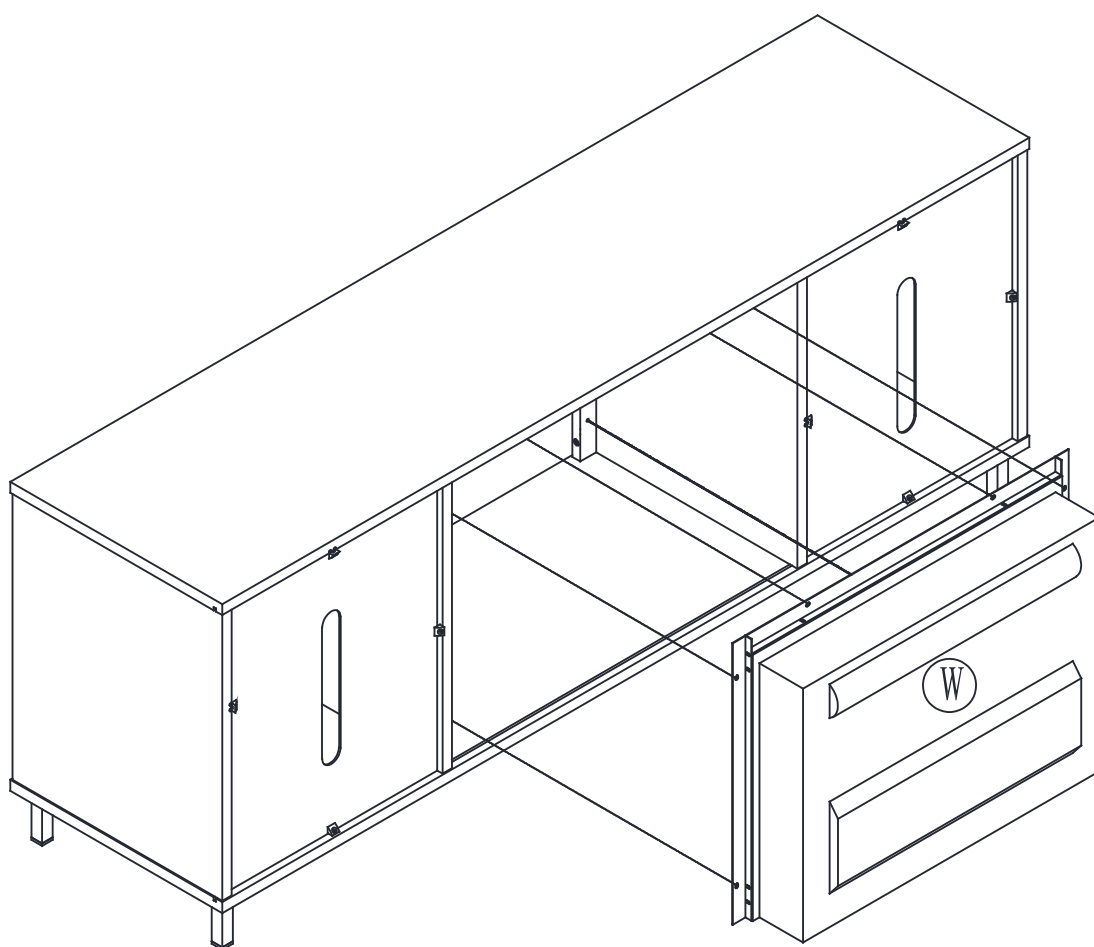

Step 19

- ◆ Peel APPLIQUES from the APPLIQUE CARDS (4) and stick them onto each visible HIDDEN CAM.
- ◆ This completes assembly. Clean with a damp cloth. Wipe dry.
- ◆ Apply the WARNING LABEL (15) to the TOP (A). You should be able to read the label when the TV is removed from the unit. When the TV is in place, it should hide the label. Peel off the backing and apply the label as shown in the diagram.
- ◆ NOTE: This is a permanent label intended to last for the life of the product. Once applied, do not try to remove it.
- ◆ This completes assembly. Clean with a damp cloth. Wipe dry.

⚠ WARNING	• ADVERTENCIA	• AVERTISSEMENT ⚠
Never use this furniture with a TV that is too large or too heavy. Severe injury or death can occur. The TV and furniture will be unstable and may tip.	Nunca use este mueble con un televisor que es demasiado grande o demasiado pesado. Podría resultar en una lesión grave hasta fatal. El televisor y el mueble estarán inestables y pueden volcarse.	Ne jamais utiliser ce meuble avec un téléviseur qui soit trop large ou trop lourd. Risque de provoquer des blessures graves, voire mortelles. Le téléviseur et le meuble seront instables et risquent de se renverser.
-The TV must weigh less than 70 lbs. -The base of the TV must be able to sit completely on this shelf.	-El televisor debe pesar 31,75 kg o menos. -La base del televisor debe poder colocarse completamente sobre este estante.	-Le téléviseur doit peser 31,75 kg ou moins. -Le socle du téléviseur doit pouvoir être placé complètement sur cette tablette.
Refer to instruction book for complete safety information.	Consulte el folleto de instrucciones para información completa sobre la seguridad.	Consulter le manuel d'instructions pour information complète concernant la sécurité.
<i>Note: This is a <u>permanent</u> label. Do not try to remove. Surface will be damaged.</i>	<i>Nota: Esta etiqueta es <u>permanente</u>. No intente quitarla. Causará daño a la superficie.</i>	<i>Remarque: Cette étiquette est <u>permanente</u>. Ne pas essayer de la retirer. Causer des dommages à la surface.</i>

