



## USER'S MANUAL

### SMOKE ALARM

AC POWERED WITH BATTERY BACKUP  
AND WIRELESS INTERCONNECT

Model SM500-AC



#### RECOMMENDED PLACEMENT:

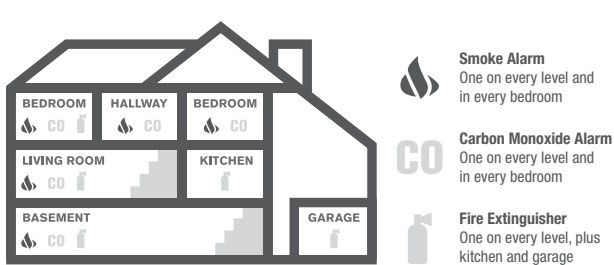

- Smoke Alarm**  
One on every level and in every bedroom
- Carbon Monoxide Alarm**  
One on every level and in every bedroom
- Fire Extinguisher**  
One on every level, plus kitchen and garage

- When installing on the wall, the top edge of Smoke Alarms should be placed between 4 inches (102 mm) and 12 inches (305 mm) from the wall/ceiling line.
- When installing on the ceiling, place the Alarm as close to the center as possible.
- In either case, install at least 4 inches (102 mm) from where the wall and ceiling meet. See "Avoiding Dead Air Spaces" for more information.

**NOTE:** For any location, make sure no door or other obstruction could keep carbon monoxide or smoke from reaching the Alarm.

#### WHERE NOT TO INSTALL THIS ALARM

**FOR BEST PERFORMANCE, IT IS RECOMMENDED YOU AVOID INSTALLING SMOKE ALARMS IN THESE AREAS:**

- In garages, furnace rooms, crawl spaces and unfinished attics. Avoid extremely dusty, dirty or greasy areas.
- Where combustion particles are produced. Combustion particles form when something burns. Areas to avoid include poorly ventilated kitchens, garages, and furnace rooms. Keep units at least 20 feet (6 meters) from the sources of combustion particles (stove, furnace, water heater, space heater) if possible. In areas where a 20-foot (6 meter) distance is not possible – in mobile, mobile, or smaller homes, for example – it is recommended the Smoke Alarm be placed as far from these fuel-burning sources as possible. The placement recommendations are intended to keep these Alarms at a reasonable distance from a fuel-burning source, and thus reduce "unwanted" Alarms. Unwanted Alarms can occur if a Smoke Alarm is placed directly next to a fuel-burning source. Ventilate these areas as much as possible.
- Within 5 feet (1.5 meters) of any smoking appliance. In air streams near kitchens. Air currents can draw cooking smoke into the smoke sensor and cause unwanted Alarms.
- In extremely humid areas. This Alarm should be at least 10 feet (3 meters) from a shower, sauna, humidifier, vaporizer, dishwasher, laundry room, utility room, or other source of high humidity.
- In direct sunlight.
- In turbulent air, like near ceiling fans or open windows. Blowing air may prevent smoke from reaching the sensors.
- In areas where temperature is colder than 40° F (4.4° C) or hotter than 100°F (37.8° C). These areas include non-air conditioned crawl spaces, unfinished attics, uninsulated or poorly insulated ceilings, porches, and garages.
- In insect infested areas. Insects can clog the openings to the sensing chamber.
- Less than 12 inches (305 mm) away from fluorescent lights. Electrical "noise" can interfere with the sensor.
- In "dead air" spaces.

#### AVOIDING DEAD AIR SPACES

"Dead air" spaces may prevent smoke from reaching the Smoke Alarm. To avoid dead air spaces, follow installation recommendations below.

**On ceilings,** install Smoke Alarms as close to the center of the ceiling as possible. If this is not possible, install Smoke Alarm at least 4 inches (102 mm) from the wall or corner.

**For wall mounting** (if allowed by building codes), the top edge of Smoke Alarms should be placed between 4 inches (102 mm) and 12 inches (305 mm) from the wall/ceiling line, below typical "dead air" spaces.

**On a peaked, gabled, or cathedral ceiling,** install first Smoke Alarm within 3 feet (0.9 meters) of the peak of the ceiling, measured horizontally. Additional Smoke Alarms may be required depending on the length, angle, etc. of the ceiling's slope. Refer to NFPA 72 for details on requirements for sloped or peaked ceilings.

#### WIRELESS OPERATION

First Alert® Wireless Interconnect Technology is the easy, cost-effective way to provide your family with whole-home safety. Compatible Wireless Interconnect Alarms communicate with each other without wires or connectors. When one Alarm sounds, they all sound. This provides your family with an earlier warning of potential danger, and gives you more time to react.

The communication distance (range) between any two compatible Wireless Interconnect Alarms is typically 100 feet (30 meters) inside of a home. Some features of a home, such as the number of levels, number/type of rooms, furniture and types of building materials may reduce the range of Alarms. Examples include: suspended ceilings, ductwork, large metallic appliances (refrigerators) and metal studs. A feature of Wireless Interconnect Alarms is that they operate as a mesh network. All Alarms will repeat any Alarm signal that is received to all other Wireless Interconnect Alarms. Interference from structural conditions can be overcome by adding additional Alarms to route the wireless signal around obstructions.

Compatible Wireless Interconnect Alarms: SM500V, SM500S500V

- IMPORTANT!**
  - The range and proper operation of any wireless device will vary depending on its surroundings. It is very important that each Alarm is tested individually before and after installation to make sure that all Alarms respond properly.
  - The Wireless Interconnect Alarms are not to be used outdoors or to transmit between buildings. The Alarms will not communicate properly under these conditions.
  - Metal objects and metallic wallpaper may interfere with signals from wireless Alarms. Alarms should be tested after changes to your home such as remodeling, moving furniture, and with metal doors opened and closed.

Your First Alert® Wireless Interconnect Smoke/CO Alarm will automatically communicate potential fires with all other compatible First Alert® Wireless Interconnect Smoke/CO Alarms.

#### HOW TO INSTALL THIS ALARM

##### IMPORTANT!

This Smoke Alarm is designed to be mounted on any standard wiring junction box up to a 4-inch (10 cm) size, on either the ceiling or wall (if allowed by local codes). Read "Where to Install This Alarm" and "Where This Alarm Should Not Be Installed" before you begin installation.

**Tools you will need:** needle-nose pliers or utility knife, standard flathead screwdriver, wire strippers.

##### ▲ DANGER!

Make sure the Alarm is not receiving excessively noisy power. Examples of noisy power could be major appliances on the same circuit, power from a generator or solar power, light dimmer on the same circuit or mounted near fluorescent lighting. Excessively noisy power may cause damage to your Alarm.

#### THE PARTS OF THIS ALARM

**The Mounting Bracket:** To remove the mounting bracket from the Alarm base, hold the Alarm base firmly and twist the mounting bracket counterclockwise. The mounting bracket installs onto the junction box. It has a variety of screw slots to fit most boxes.

**The Power Connector:** The power connector plugs into a power input block on the Alarm. It supplies the unit with AC power.

The black wire is "hot."

The white wire is neutral.

The orange wire is used for interconnect.

If you need to remove the power connector, turn

**POWER OFF** first. Insert a flat screwdriver blade

between the power connector and the security tab

inside the power input block. Gently pry back the tab

and pull the connector free.

#### THE PARTS OF THIS SMOKE ALARM

- 1 Mounting Bracket
- 2 Mounting Slots
- 3 Locking Pins (break out of bracket)
- 4 Hot (Black) AC Wire
- 5 Neutral (White) AC Wire
- 6 Interconnect (Orange) Wire
- 7 Quick-Connect Power Connector
- 8 Turn this way to remove from bracket
- 9 Turn this way to attach to bracket
- 10 Slide-Out Battery Drawer

#### FOLLOW THESE SIMPLE STEPS

The basic installation of this Alarm is similar whether you want to install one Alarm, or interconnect more than one Alarm. If you are interconnecting more than one Alarm, you **MUST** read "Special Requirements for Interconnected Alarms" below before you begin installation.

##### ▲ DANGER!

**ELECTRICAL SHOCK HAZARD. Turn off power to the area where you will install this unit at the circuit breaker or fuse box before beginning installation. Failure to turn off the power before installation may result in serious electrical shock, injury or death.**

1. Remove the mounting bracket from the base, and attach it to the junction box.
2. Using wire nuts, connect the power connector to the household wiring.

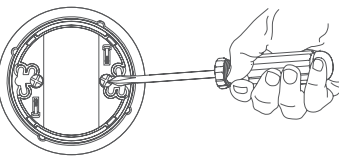

#### STAND-ALONE ALARM ONLY:

- Connect the white wire on the power connector to the neutral wire in the junction box.
- Connect the black wire on the power connector to the hot wire in the junction box.
- Turn the orange wire inside the junction box. It is used for interconnect only.

#### INTERCONNECTED UNITS ONLY:

Strip off about 1/2" (12 mm) of the plastic coating on the orange wire on the power connector.

- Connect the white wire on the power connector to the neutral wire in the junction box.
- Connect the black wire on the power connector to the hot wire in the junction box.
- Connect the orange wire on the power connector to the interconnect wire in the junction box. Repeat for each unit you are interconnecting. Never connect the hot or neutral wires in the junction box to the orange interconnect wire. Never cross hot and neutral wires between Alarms.

3. Activate the battery back-up by removing the "Pull to Activate Battery Back-Up" tab. Or, install battery back-up. Battery back-up cannot work until you install the battery in the correct position (Match "+" to "+" and "-" to "-").
4. Plug the power connector into the back of the Alarm.
5. Position the base of the Alarm over the mounting bracket, and turn the Alarm clockwise (right) until the unit is in place. If wall mounted, adjust unit so words are level.
6. Check all connections.

##### ▲ WARNING!

Improper wiring of the power connector or the wiring leading to the power connector will cause damage to the Alarm and may lead to a non-functioning Alarm.

#### STAND-ALONE ALARM ONLY:

- If you are only installing one Alarm, restore power to the junction box.

#### INTERCONNECTED UNITS ONLY:

- If you are interconnecting multiple Alarms, repeat steps 1-5 for each Alarm in the series. When you are finished, restore power to the junction box.

##### ▲ DANGER!

**ELECTRICAL SHOCK HAZARD. Do not restore power until all Alarms are completely installed. Restoring power before installation is complete may result in serious electrical shock, injury or death.**

1. Make sure the Alarm is receiving AC power. Under normal operation, the Green power indicator light will shine continuously.
2. If the Green power indicator light does not light, **TURN OFF POWER TO THE JUNCTION BOX** and recheck all connections. If all connections are correct and the Green power indicator still does not light when you restore the power, the unit should be replaced immediately.
3. Test each Smoke Alarm. Press and hold the Test/Silence button until the unit Alarms. When testing a series of interconnected units you must test each unit individually. Make sure all units Alarm when each one is tested.

**▲ DANGER!**  
If any unit in the series does not Alarm, **TURN OFF POWER** and recheck connections. If it does not Alarm when you restore power, replace it immediately.

#### SPECIAL REQUIREMENTS FOR INTERCONNECTED ALARMS

##### ▲ WARNING!

- Failure to meet any of the above requirements could damage the units and cause them to malfunction, removing your protection.
- AC and AC/DC Alarms can be interconnected. Under AC power, all units will Alarm when the senses smoke or CO. When power is interrupted, only the AC/DC units in the series will continue to send and receive signals. AC powered Alarms will not operate.**

#### COMPATIBLE INTERCONNECTED UNITS

##### IMPORTANT!

Interconnect units within a single family residence only. Otherwise all households will experience unwanted Alarms when you test any unit in the series. Interconnected units will only work if they are wired to compatible units and all requirements are met. This unit is designed to be compatible with: First Alert and BRK Smoke Alarm Models 7010, 9120, 3120B, 7010B, 7010BSL, 7020B, 7020BSL, 9120B, SA520, SC7010B, SC7010BS, SC9120B, SM100V-AC, SM500-AC, SM500S-AC, SM100-AC, SM100S-AC and SM110LED-AC; First Alert and BRK Smoke & CO Alarm Models 1039102, 7030BSL, SMCO100V-AC, SMCO100-AC, SMCO105-AC, and SMCO110LED-AC; First Alert and BRK CO Alarm Models CO5120BN and CO5120PBN; First Alert and BRK Heat Alarm Model HD6135FB; RM4 Relay and SLED177 Strobe when connected via an RM4 Relay.

#### INTERCONNECTED UNITS MUST MEET ALL OF THE FOLLOWING REQUIREMENTS:

- A maximum of 18 compatible units may be interconnected (Maximum of 12 Smoke Alarms). The Alarms will not communicate properly under these conditions.
- The total length of wire interconnecting the units should be less than 1000 feet (300 meters). This type of wire is commonly available at Hardware and Electrical Supply stores.
- All wiring must conform to all local electrical codes and NFPA 70 (NEC). Refer to NFPA 72, NFPA 101, and/or your local building code for further connection requirements.

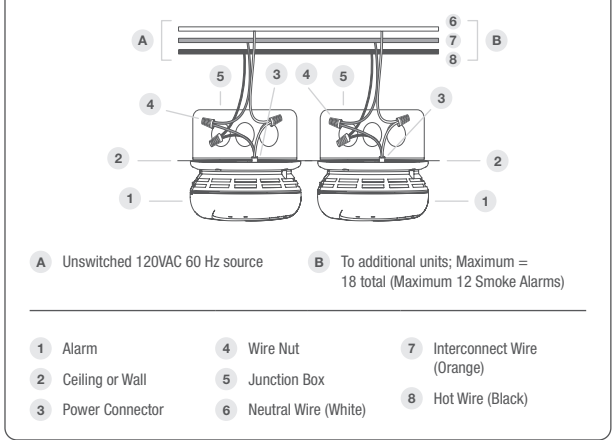

#### ADDING AND LINKING ADDITIONAL WIRELESS INTERCONNECT ALARMS

**NOTE:** Steps 1 through 3 need to be completed within two minutes. If more than two minutes pass, the Green Power LED will stop blinking. Simply open the battery drawer of the second Alarm and repeat steps 1 through 3.

1. Insert the batteries into the battery drawer of the next Alarm. **DO NOT CLOSE THE DRAWER.**
2. Press and hold the test button and then close the battery drawer.
3. Once you hear the unit chirp, release the test button. The green power LED will start to blink indicating the Wireless Interconnect Alarm is waiting for program data from the one of the other setup Wireless Interconnect Alarms.

Action	What You Will See & Hear
Under Normal AC Operations	Horn: Silent; Power LED: Steady GREEN
Alarm is Operating on Battery Backup	Horn: Silent; Power LED: Flashes GREEN every 45 seconds
When You Test the Alarm	Horn: Short chirp then 3 beeps, pause, repeats 2 more times <b>Power LED:</b> Flashes Green THEN Horn: 3 beeps, pause, 3 beeps; <b>Smoke LED:</b> Red in sync with horn
Battery Becomes Low	Horn: Chirps 1 time every 45 seconds; <b>Power LED:</b> Flashes Green in sync with horn
Low Battery Signal is Silenced (for up to 8 hours)	Horn: Silent; <b>Smoke LED:</b> Flashes RED 2 times every 45 seconds
Alarm is Not Operating Properly (MALFUNCTION SIGNAL)	Horn: 3 chirps every 45 seconds; <b>Power LED:</b> Flashes GREEN in sync with horn
Alarm has reached End of Life	Horn: 5 chirps every 45 seconds; <b>Power/Smoke LED:</b> Off
End of Life Signal is Silenced (for up to 2 days, 14 days total)	Horn: Silent; <b>Smoke LED:</b> Flashes RED 5 times every 45 seconds

Smoke is Detected	Horn: 3 beeps, pause, repeats 2 more times; <b>Power LED:</b> Flashes Green THEN Horn: 3 beeps, pause, 3 beeps, repeating; <b>Smoke LED:</b> Red in sync with horn
Smoke is Detected in another Interconnected Alarm	Horn: 3 beeps, pause, repeats 2 more times; <b>Power LED:</b> Flashes Green THEN Horn: 3 beeps, pause, repeating; <b>Smoke LED:</b> Off
Smoke Alarm is Silenced (up to 8 minutes)	Horn: Off; <b>Smoke LED:</b> Flashes RED 3 times, pause, 3 times
CO is Detected in another Interconnected Alarm	<b>Power LED:</b> Flashes Green THEN Horn: 4 beeps, pause, repeating; <b>Smoke LED:</b> Off

## 04 ALARM FEATURES

- Early Warning Interconnect:** When one Alarm sounds, all compatible\* Alarms sound.
- Quick Connect Plug:** Allows for easy installation. No need to rewire.
- End of Life Warning:** Lets you know when it's time to replace.

#### TO LOCK THE BATTERY COMPARTMENT

Do not lock the battery compartment until you have installed the battery and tested the Alarm.

##### IMPORTANT!

If the unit does not Alarm during testing, **DO NOT lock the battery compartment. Install a new battery and test again. If the Alarm still does not Alarm, replace it immediately.**

1. Using needle-nose pliers, detach one locking pin from the mounting bracket.
2. After batteries are inserted, push the locking pin through the hole near the battery door latch on the back of the Alarm.

#### TO UNLOCK THE BATTERY COMPARTMENT

1. Remove the Alarm from the mounting bracket. If the unit is locked to the bracket, see the section "To Unlock the Mounting Bracket."
2. Insert a flathead screwdriver under the head of the locking pin, and gently pry it out of the battery compartment lock. (If you plan to relock the battery compartment, save the locking pin.)
3. To relock the battery compartment, close the battery door and reinsert locking pin in lock.
4. Reattach the Alarm to the mounting bracket.

##### IMPORTANT!

When replacing the batteries, always test the Alarm before relocking the battery compartment.

#### OPTIONAL LOCKING FEATURE

The optional locking feature is designed to prevent unauthorized removal of the Alarm. It is not necessary to activate the lock in single-family households where unauthorized Alarm removal is not a concern.

**Tools you will need:** Needle-nose pliers or utility knife, standard flathead screwdriver

The feature uses a locking pin which is molded into the mounting bracket. Remove locking pin by using needle-nose pliers or a utility knife.

##### IMPORTANT!

To permanently remove the locking pin, insert a flathead screwdriver between the locking pin and the lock and pry the pin out of the lock.

#### TO LOCK THE MOUNTING BRACKET

1. Using needle-nose pliers, detach the pin from the mounting bracket.
2. Insert the locking pin through the hole on the back of the Smoke Alarm as shown in the diagram.
3. When you attach the Alarm to the mounting bracket the locking pin's head will fit into a notch on the bracket.

#### TO UNLOCK THE MOUNTING BRACKET

1. Insert a flathead screwdriver in between the mounting bracket and the locking pin.
2. Pry the Alarm away from the bracket by pushing up the screwdriver and turning the Alarm counterclockwise (left) at the same time.

## 05 TESTING & MAINTENANCE

#### WEEKLY TESTING

##### ▲ WARNING!

- NEVER** use an open flame of any kind to test this unit. You might accidentally damage or set fire to the unit or your home.
- If the Alarm ever fails to test properly, replace it immediately. Products under warranty may be returned to the manufacturer for replacement. See "Limited Warranty" for details.
- DO NOT** stand close to the Alarm when the alarm is sounding. Exposure at close range may be harmful to your hearing. When testing, step away when horn starts sounding.

##### ▲ CAUTION!

**It is important to test this unit every week to make sure it is working properly. Using the test button is the recommended way to test this Smoke Alarm.**

You can test this Smoke Alarm pressing and holding the Test/Silence button on the Alarm cover until Alarm sounds.

**Activate the Alarm test, reset or silence function by use of a finger or thumb. Use of any other instrument is strictly prohibited.**

During testing, you will see and hear the following sequence:

Horn: Short chirp then 3 beeps, pause, repeats 2 more times. **Power LED:** Flashes Green THEN Horn: 3 beeps, pause, 3 beeps. **Smoke LED:** Red in sync with horn

If the unit does not Alarm, make sure the batteries are correctly installed, and test again. If the unit still does not Alarm, replace it immediately.

#### REGULAR MAINTENANCE

This unit has been designed to be as maintenance free as possible, but there are a few simple things you must do to keep it working properly.

- Test it at least once a week.
- Clean the Smoke Alarm at least once a month; gently vacuum off any dust using your household vacuum's soft brush attachment, and test the Smoke Alarm after cleaning. Never use water, cleaners or solvents since they may damage the unit.
- If the Smoke Alarm becomes contaminated by excessive dirt, dust or ash/grime, and cannot be cleaned to avoid unwanted Alarms, replace the unit immediately.
- Relocate the unit if it sounds frequent unwanted Alarms. See "Locations to Avoid for Smoke Alarms" for details.
- Protect or cover the alarm when doing any maintenance to home i.e. sanding floors, painting, drywall patching, etc. to prevent contamination.

##### IMPORTANT!

Actual service life depends on the Smoke Alarm and the environment in which it is installed. You **MUST** replace the Smoke Alarm immediately once the unit starts "chirping" (the End of Life or Malfunction warning).

#### CHOOSING A REPLACEMENT BATTERY:

Your Smoke Alarm requires two "AA" Duracell MN150/LR6 or Energizer E91 batteries. These batteries are available at many local retail stores.

##### ▲ WARNING!

- Always use the exact batteries specified by this User's Manual. **DO NOT** use rechargeable batteries. Clean the battery contacts and also those of the device prior to battery installation. Install batteries correctly with regard to polarity (+ and -).
- Please dispose of or recycle used batteries properly, following any local regulations. Consult your local waste management authority or recycling organization to find an electronics recycling facility in your area. **DO NOT DISPOSE OF BATTERIES IN FIRE. BATTERIES MAY EXPLODE OR LEAK.**

##### ▲ WARNING!

- Keep battery out of reach of children. In the event a battery is swallowed, immediately contact your poison control center, your physician, or the National Battery Ingestion hotline at 202-625-3333 as serious injury may occur.

##### IMPORTANT!

Actual battery service life depends on the Smoke Alarm and the environment in which it is installed. All the batteries specified above are acceptable replacement batteries for this unit. Regardless of the manufacturer's suggested battery life, you **MUST** replace the battery immediately once the unit starts "chirping" (the "low battery warning").

To replace the batteries (without removing Alarm from the ceiling or wall):

1. Open the battery compartment.
2. Press tabs A and B as shown in the diagram and remove each battery.
3. Insert the new batteries, making sure they snap completely into the battery compartment. Match the terminals on the ends of the batteries with the terminals on the unit.
4. Close the battery compartment, and then test the unit by pressing the Test/Silence button.

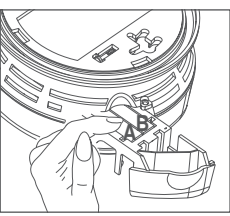

#### TROUBLESHOOTING GUIDE

##### ▲ DANGER!

**ELECTRICAL SHOCK HAZARD. Turn off the power to the area where the Alarm is installed BEFORE removing it from the mounting bracket or checking any electrical connections! Failure to turn off the power may result in electrical shock, injury or death.**

IF THE ALARM...	PROBLEM...	YOU SHOULD...
Green Power light is off. Unit will not alarm when you press the Test/Silence button	Unit may not be receiving any power.	Check the AC power supply. Make sure the power connector is securely attached to the Alarm. Make sure a fresh battery is installed to power the battery backup*.
Green Power light flashes ON every 45 seconds (horn is silent)	Alarm is not receiving AC power.	Unit is operating on battery backup. Check the AC power supply.
Horn "chirps" 1 time every 45 seconds	Unit is powered via AC, but battery is low or missing OR Alarm is not receiving AC power, but battery is low.	Replace battery*
Horn "chirps" 3 times every 45 seconds	MALFUNCTION SIGNAL. Device is not working properly, and needs to be replaced.	If unit is under warranty, contact Consumer Support to process a warranty replacement.
Horn "chirps" 5 times every minute	END OF LIFE SIGNAL. Alarm needs to be replaced.	Replace Alarm immediately
Alarm goes back into alarm after you press the Test/Silence button to silence the alarm	Smoke levels are still potentially dangerous	Refer to "If your Smoke Alarm Sounds" for details on how to respond to an alarm. EVACUATE your home immediately and call 911.
Smoke Alarm sounds when no smoke is visible.	Unwanted Alarm may be caused by nonemergency source like cooking smoke.	Silence Alarm using test/silence button. Clean the Alarm's cover with a soft, clean cloth. If frequent unwanted alarms continue, relocate your alarm. Alarm may be too close to a kitchen, cooking appliance or steamy bathroom.
*For a list of acceptable replacement batteries, see "Regular Maintenance."		
If you have questions that cannot be answered by reading this manual, call the Consumer Support Team at 1-800-323-9005.		

#### FIRE SAFETY TIPS

Follow safety rules and prevent hazardous situations: 1) Use smoke materials properly. Never smoke in bed. 2) Keep matches or lighters away from children; 3) Store flammable materials in proper containers; 4) Keep electrical appliances in good condition and don't overload electrical circuits; 5) Keep stoves, barbecue grills, fireplaces and chimneys grease- and debris-free; 6) Never leave anything cooking on the stove unattended; 7) Keep portable heaters and open flames, like candles, away from flammable materials; 8) Don't let rubbish accumulate. Keep Alarms clean, and test them weekly. Replace Alarms immediately if they are not working properly. Smoke Alarms that do not work cannot alert you to a fire. Keep at least one working fire extinguisher on every level, and an additional one in the kitchen. Have fire escape ladders or other reliable means of escape from an upper level in case stairs are blocked; 9) Have an escape plan and practice it regularly.

## 06 IF THIS SMOKE ALARM SOUNDS

#### RESPONDING TO AN ALARM

During an Alarm, you will hear: Horn: 3 beeps, pause, repeats 2 more times. **Power LED:** Flashes Green THEN Horn: 3 beeps, pause, 3 beeps, repeating. **Smoke LED:** Red in sync with horn

##### ▲ WARNING!

- If the unit Alarms get everyone out of the house immediately.
- If the unit Alarms and you are not testing the unit, it is warning you of a potentially dangerous situation that requires your immediate attention. **NEVER** ignore any Alarm. Ignoring the Alarm may result in injury or death.
- Never remove the batteries from a battery operated Smoke Alarm to stop an unwanted Alarm (caused by cooking smoke, etc.). Removing batteries disables the Alarm so it cannot sense smoke, and removes your protection. Instead open a window or fan the smoke away from the unit. The Alarm will reset automatically.

#### WHAT TO DO IN CASE OF FIRE

- Don't panic; stay calm. Follow your family escape plan.
- Get out of the house as quickly as possible. Don't stop to get dressed or collect anything.
- Feel doors with the back of your hand before opening them. If a door is cool, open it slowly. Don't open a hot door. Keep doors and windows closed, unless you must escape through them.
- Cover your nose and mouth with a cloth (preferably damp). Take short, shallow breaths.
- Meet at your planned meeting place outside your home, and do a head count to make sure everybody got out safely.
- Call the Fire Department as soon as possible from outside. Give your address, then your name.
- Never go back inside a burning building for any reason.
- Contact your Fire Department for ideas on making your home safer.

##### ▲ WARNING!

Alarms have various limitations. See "General Limitations of Smoke Alarms" for details.

## 07 USING THE SILENCE FEATURES

##### ▲ WARNING!

**Never remove the batteries to quiet an unwanted Alarm. Removing the batteries disables the Alarm and removes your protection.**

The Silence Feature is intended to temporarily silence the horn while you identify and correct the problem. Do not use the Silence Feature in emergency situations. It will not extinguish a fire. The Silence Feature can temporarily quiet an unwanted Alarm for several minutes. You can silence this Smoke Alarm by pressing the Test/Silence button on the Alarm cover for at least 3-5 seconds.

#### WHEN THE SMOKE ALARM IS SILENCED

The Smoke Alarm will remain silent for up to 8 minutes, then return to normal operation. If the smoke has not cleared—or continues to increase—the device will go back into Alarm.

#### SILENCING THE LOW BATTERY WARNING

This Silence Feature can temporarily quiet the low battery warning "chirp" for up to 8 hours if AC power is present. Press the Test/Silence button on the Alarm cover until you hear the acknowledgement "chirp".

Once the low battery warning "chirp" Silence Feature is activated, the unit continues to flash



**Smoke Alarms may not waken all individuals.** Practice the escape plan at least twice a year, making sure that everyone is involved – from kids to grandparents. Allow children to master fire escape planning and practice before holding a fire drill at night when they are sleeping. If children or others do not readily waken to the sound of the Smoke Alarm, or if there are infants or family members with mobility limitations, make sure that someone is assigned to assist them in fire drill and in the event of an emergency. It is recommended that you hold a fire drill while family members are sleeping in order to determine their response to the sound of the Smoke Alarm while sleeping and to determine whether they may need assistance in the event of an emergency.

**Smoke Alarms cannot work without power.** Battery operated units cannot work if the batteries are missing, disconnected or dead, if the wrong type of batteries are used, or if the batteries are not installed correctly. AC units cannot work if the AC power is cut off for any reason (open fuse or circuit breaker, failure along a power line or at a power station, electrical fire that burns the electrical wires, etc. ). If you are concerned about the limitations of battery or AC power, install both types of units.

**This Smoke Alarm will not sense smoke that does not reach the sensors.** It will only sense smoke at the sensor. **Smoke may be present in other areas.** Doors or other obstructions may affect the rate at which smoke reaches the sensors. If bedroom doors are usually closed at night, we recommend you install an Alarm device (Combination CO and Smoke Alarm, or separate CO Alarms and Smoke Alarms) in each bedroom and in the hallway between them.

**This Smoke Alarm may not sense smoke on another level of the home.** Example: This Alarm device, installed on the second floor, may not sense smoke in the basement. For this reason, one Alarm device may not give adequate early warning. Recommended minimum protection is one Alarm device in every sleeping area, every bedroom, and on every level of your home. Some experts recommend battery powered Smoke Alarms be used in conjunction with interconnected AC powered Smoke Alarms. For details, see "About Smoke Alarms" for details.

**Smoke Alarms may not be heard.** The Alarm horn loudness meets or exceeds current UL standards of 85 dB at 10 feet (3 meters). However, if the Smoke Alarm is installed outside the bedroom, it may not wake up a sound sleeper or one who has recently used drugs or has been drinking alcoholic beverages. This is especially true if the door is closed or only partly open. Even persons who are awake may not hear the Alarm horn if the sound is blocked by distance or closed doors. Noise from traffic, stereo, radio, television, air conditioner, or other appliances may also prevent alert persons from hearing the Alarm horn. This Smoke Alarm is not intended for people who are hearing impaired.

**The Alarm may not have time to Alarm before the fire itself causes damage, injury, or death, since smoke from some fires may not reach the unit immediately. Examples of this include persons smoking in bed, children playing with matches, when a person's clothing catches fire while cooking, fires caused by violent explosions resulting from escaping gas, or incendiary fires where the fire grows so rapidly that an occupant's egress is blocked even with properly located Smoke Alarms.**

**This Smoke Alarm is not a substitute for life insurance.** Though this Smoke Alarm warns against the presence of smoke, First Alert does not warrant or imply in any way that they will protect lives. Homeowners and renters must still insure their lives.

**This Smoke Alarm has a limited life.** Although this Smoke Alarm and all of its parts have passed many stringent tests and are designed to be as reliable as possible, any of these parts could fail at any time. Therefore, you must test this device weekly. The unit should be replaced immediately if it is not operating properly.

**This Smoke Alarm is not foolproof.** Like all other electronic devices, this Smoke Alarm has limitations. It can only detect smoke that reaches the sensors. It may not give early warning if the source of smoke is in a remote part of the home, away from the Alarm device.

## 12 LIMITED WARRANTY

First Alert® warrants that for a period of ten years from the date of purchase, this product will be free from defects in material and workmanship. First Alert, at its option, will repair or replace this product or any component of the product found to be defective during the warranty period. Replacement will be made with a new or remanufactured product or component. If the product is no longer available, replacement may be made with a similar product of equal or greater value. This is your exclusive warranty.

This warranty is valid for the original retail purchaser from the date of initial retail purchase and is not transferable. Keep the original sales receipt. Proof of purchase is required to obtain warranty performance. First Alert dealers, service centers, or retail stores selling First Alert products do not have the right to alter, modify or any way change the terms and conditions of this warranty.

This warranty does not cover normal wear of parts or damage resulting from any of the following: negligent use or misuse of the product, use on improper voltage or current, use contrary to the operating instructions, disassembly, repair or alteration by anyone other than First Alert or an authorized service center. Further, the warranty does not cover Acts of God, such as fire, flood, hurricanes and tornadoes or any batteries that are included with this unit.

First Alert shall not be liable for any incidental or consequential damages caused by the breach of any express or implied warranty. Except to the extent prohibited by applicable law, any implied warranty of merchantability or fitness for a particular purpose is limited in duration to the duration of the above warranty. Some states, provinces or jurisdictions do not allow the exclusion or limitation of incidental or consequential damages or limitations on how long an implied warranty lasts, so the above limitations or exclusion may not apply to you. This warranty gives you specific legal rights, and you may also have other rights that vary from state to state or province to province.

### HOW TO OBTAIN WARRANTY SERVICE

**Service:** If service is required, do not return the product to your retailer. In order to obtain warranty service, contact the Consumer Support Team at 1-800-323-9005. To assist us in serving you, please have the model number and date of purchase available when calling.

**Battery:** First Alert makes no warranty, express or implied, written or oral, including that of merchantability or fitness for any particular purpose with respect to battery.

**Disposal:** Please follow local guidelines regarding the disposal or recycling of batteries and/or electronics.

For your records, please record:

Date Purchased: \_\_\_\_\_

Where Purchased: \_\_\_\_\_

Date Installed: \_\_\_\_\_ / \_\_\_\_\_ Month/Year

Replace Alarm 10 years after installation.

Please write the date in the space provided: \_\_\_\_\_ / \_\_\_\_\_ Month/Year

The Alarm will also provide an audible End-of-Life Signal approximately 10 years after installation to remind you to replace the unit.

The End-of-Life Signal can be silenced for up to 2 days. Do not unplug or deactivate the Alarm until you get replacement.

Printed in Mexico | M08-170686 01/23

CONFORMS TO UL STD 217

120V AC ~ 60HZ, 0.09A

firstalert.com



© 2023 Resideo Technologies, Inc. All rights reserved. These products are manufactured by Resideo Technologies, Inc. and its affiliates. 3901 Liberty Street, Aurora, IL 60504-6122. Consumer Support Team: (800) 323-9005 | firstalert.com