

allen + roth.

ITEM #6021324
MODEL #43527

LED CRYSTAL PENDANT

ALLEN + ROTH and logo design are trademarks or registered trademarks of LF, LLC. All rights reserved.

Español p. 9

ATTACH YOUR RECEIPT HERE

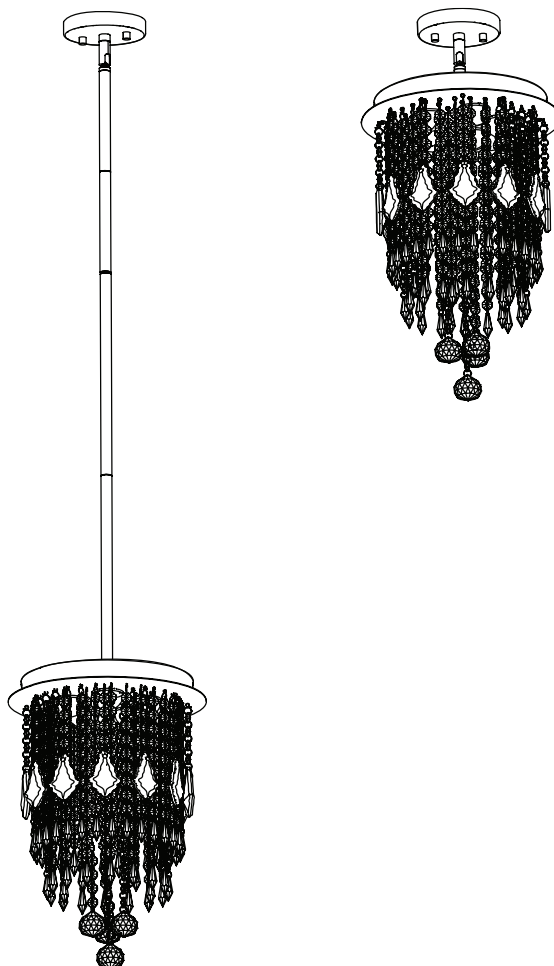

Purchase Date _____

Thank you for purchasing this ALLEN + ROTH product.
Questions, problems, missing parts?
Before returning to your retailer, contact us at:
866-439-9800, 8 a.m. - 8 p.m., EST, Monday - Sunday or **ascs@lowes.com**.

TABLE OF CONTENTS

Package Contents. 3

Hardware Contents. 3

Preparation 3

Safety Information. 4

Assembly Instructions. 5

Troubleshooting. 10

3-Year Limited Warranty. 10

PACKAGE CONTENTS

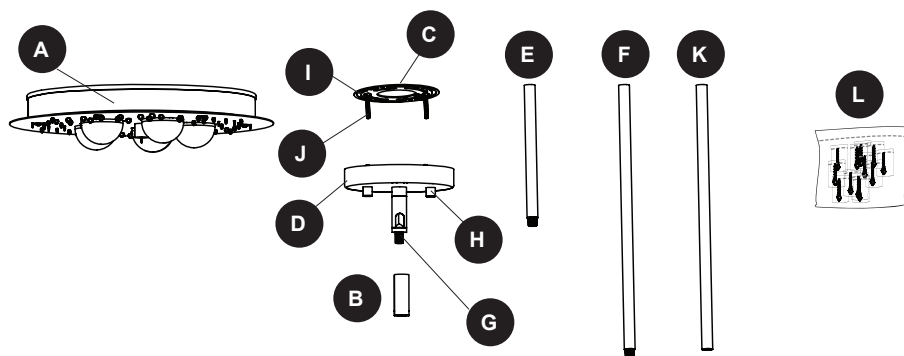

PART	DESCRIPTION	QUANTITY
A	Fixture	1
B	Spacer	1
C	Mounting Bracket	1
D	Canopy (preassembled to Mounting Bracket [C])	1
E	Short Rod	2
F	Long Rod	3
G	Connecting Rod (preassembled to the Canopy [D])	1
H	Screw Cap (preassembled to Mounting Screw [J])	2
I	Hex Nut (preassembled to the Mounting Screw [J])	2
J	Mounting Screw (preassembled to the Mounting Bracket [C])	2
K	Long Rod without threads	1
L	Crystal Bead Strands	6

HARDWARE CONTENTS

AA



Wire Connector
Qty. 3

RR



Bracket Screw
Qty. 2

PREPARATION

Estimated Assembly Time: 60 minutes

Tools Required for Assembly (not included):

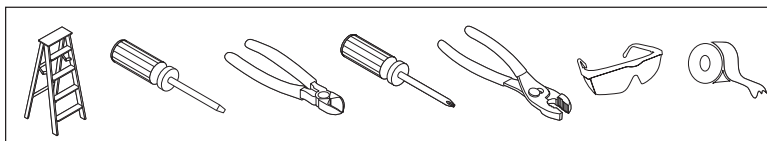

Helpful Tools (not included)

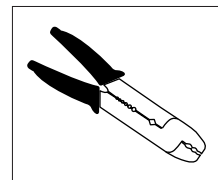

SAFETY INFORMATION

Please read and understand this entire manual before attempting to assemble, operate or install the product. Failure to do so could lead to electrical shock, fire or other injuries that could be hazardous or even fatal.

- Before you begin installing the light, disconnect the power by removing fuses or turning off the circuit breakers.
- The net weight of the light kit is 9.24 lbs.
- This fixture is intended for indoor locations. It is not suitable for outdoor or damp locations.

DANGER:

- DO NOT connect this fixture to an electrical system that does not provide a means for equipment grounding. Never use a fixture in a two-wire system that is not grounded. Installing a fixture into an electrical system not having a proper grounding means could cause metal parts of the fixture to carry electrical currents if any of the fixture wires, wire connections or splices were to become broken, cut or loose during the mounting or normal operation of the fixture. Under this condition, anyone coming in contact with the fixture would be subject to electrical shock, which could cause serious injury or death.
- DO NOT connect the bare or green insulation fixture ground wire to the black (hot) current-carrying wire or the white neutral house wire. Connection of the bare or green fixture ground wire to the black or white house wires may cause metal parts of the fixture to carry electrical currents. Under this condition anyone coming in contact with the fixture will receive electrical shock, which could cause serious injury or death.
- DO NOT damage or cut the wire insulation (covering) during installation of the fixture. DO NOT permit wires to contact any surface having a sharp edge. To do so may damage or cut the wire insulation, which could cause serious injury or death from electrical shock.

WARNING:

- All electrical connections must be in agreement with local codes and ordinances, the National Electric Code (NEC) and ANSI/NFPA 70-1999. Contact your municipal building department to learn about your local codes, permits and/or inspections. Risk of fire - most dwellings built before 1985 have supply wire rated for 140°F. Consult a qualified electrician before installation.
- To avoid personal injury, the use of gloves may be necessary while handling fixture parts with sharp edges.
- DO NOT suspend any fixture by the house wires. A fixture must always be mounted directly to a an outlet box. Wire connectors will not support the weight of a fixture. Suspending a fixture by the house wires and wire connectors will result in the fixture falling, with the possibility of personal injury and the danger of electrical shock or fire.
- To reduce the risk of fire, electrical shock, or personal injury, each wire connector used with this light kit should accept only one 18-gauge wire from the light fixture and one 18-gauge wire from the outlet box. If there are three or more wires to connect or any of the wires is larger than 18 gauges, consult an electrician for the proper size wire connectors to use.
- This device complies with part 15 of FCC Rules. Operation is subject to the following two conditions: 1) This device may cause harmful interference, and 2) this device must accept any interference received, including interference that may cause undesired operation.
- This equipment has been tested and found to comply with the limits for a Class B digital device, pursuant to Part 15 of the FCC Rules. These limits are designed to provide reasonable protection against harmful interference in a residential installation. This equipment generates, uses and can radiate radio frequency energy and, if not installed and used in accordance with the instructions, may cause harmful interference to radio communications. However, there is no guarantee that interference will not occur in a particular installation. If this equipment does cause harmful interference to radio or television reception, which can be determined by turning the equipment off and on, the user is encouraged to try to correct the interference by one or more of the following measures:--Reorient or relocate the receiving antenna. --Increase the separation between the equipment and receiver. --Connect the equipment into an outlet on a circuit different from that to which the receiver is connected. --Consult the dealer or an experienced radio/TV technician for help.

ASSEMBLY INSTRUCTIONS

1. Turn off the circuit breakers and the wall switch to the supply line leads.

⚠ DANGER: Failure to disconnect the power supply prior to installation may result in serious injury or death.

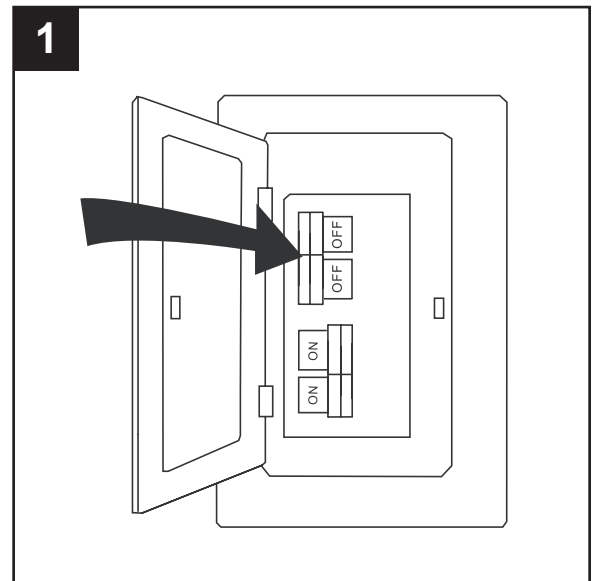

2. Remove the screw caps (H) from the mounting screws preassembled to the mounting bracket. Remove the mounting bracket (C) from the canopy (D).

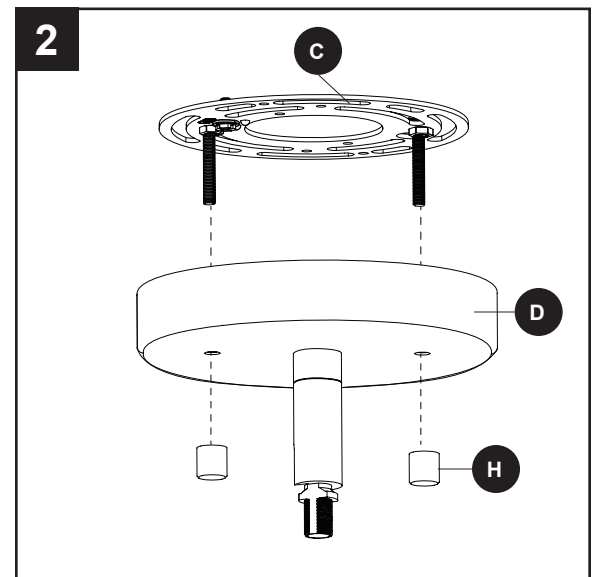

3. Use the bracket screws (RR) to attach the mounting bracket (C) securely to the outlet box (sold separately).

Hardware Used

RR Bracket Screw  x 2

For mounting on angled ceiling - Fixture may be mounted at angle up to 90 degrees. Position of mounting screws (J) will determine the direction which the fixture (A) will hang. You may want to temporarily place canopy (D) onto mounting screws (J) to determine the position of the mounting bracket (C) on the outlet box.

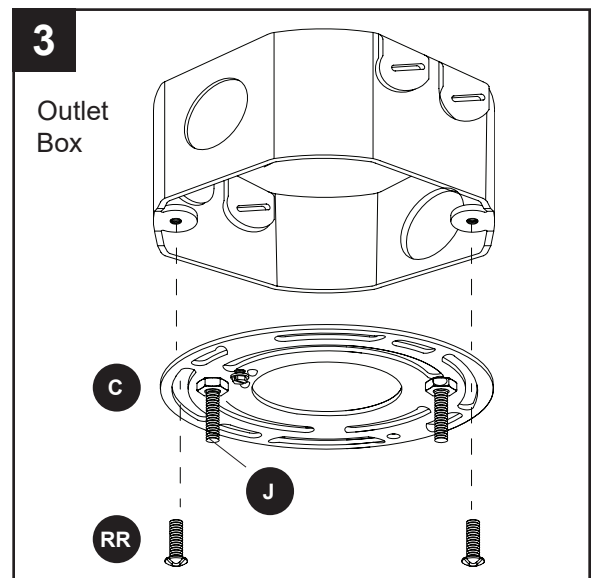

ASSEMBLY INSTRUCTIONS

4. Determine which type of installation you desire -- Pendant or Semi Flushmount. For *Pendant*, continue to Step 5. For *Semi Flushmount*, skip to Step 9, page 7.

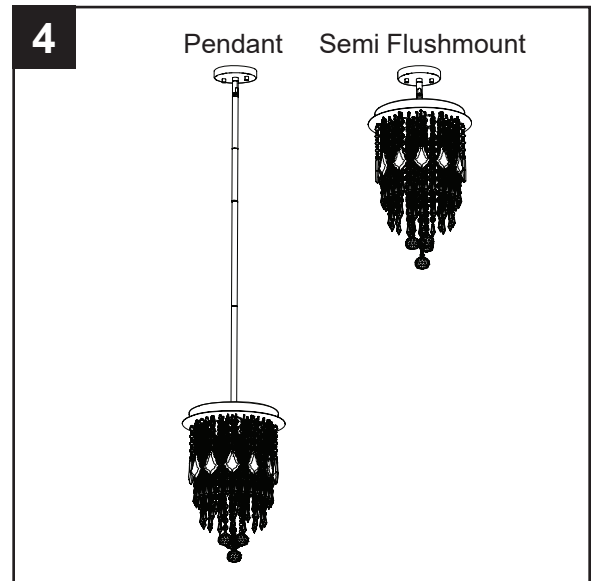

5. Determine which combination of short rods (E) and long rods (F) to use, based on the desired length of the fixture (A). Twist the wire ends coming from the fixture (A) together and feed through hole in the first rod without threads (K). Connect the first rod without threads (K) to the fixture (A) by twisting the threaded end onto the fixture in a clockwise direction until secure. Feed the wires through the remainder of the desired rods and then connect the rods by twisting them in a clockwise direction. Twist the top rod onto the thread at the bottom of the canopy (D).

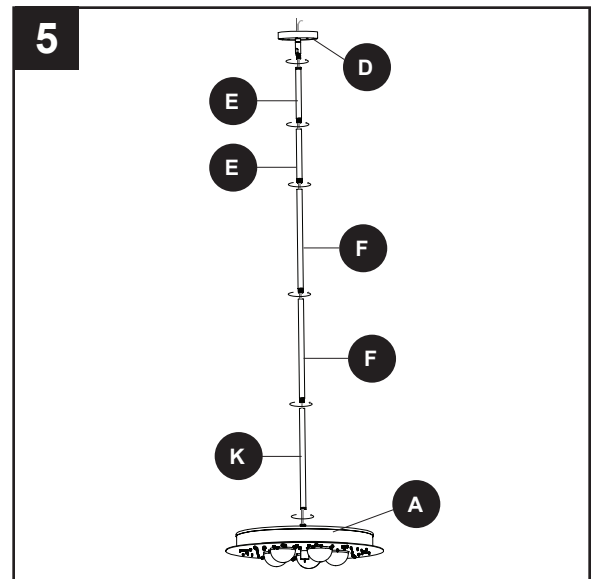

6. Loosen the ground screw on the mounting bracket (C) and wrap the bare wire from the fixture (A) around the ground screw. Tighten the ground screw to hold the bare wire in place. **Note:** Ensure there is enough of the bare wire extending from the ground screw to connect to the ground wire from the outlet box using a wire connector (AA).

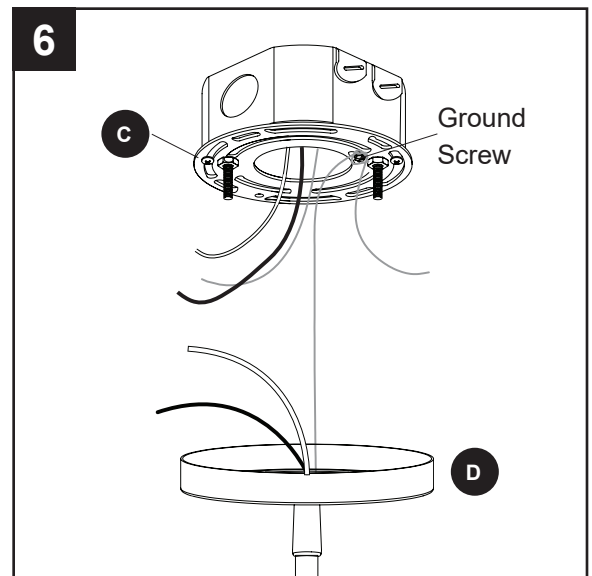

ASSEMBLY INSTRUCTIONS

7. Use wire connectors to secure the household supply wires to the fixture wires according to the image and the following instructions:
- Connect the black (hot) supply wire to the black wire from the fixture.
 - Connect the white (neutral) supply wire to the white wire from the fixture.
 - Connect the bare/green (ground) supply wire to the bare wire from the fixture.

Turn the wire connections and gently push them into the outlet box.

Hardware Used



Wire Connector



x 3

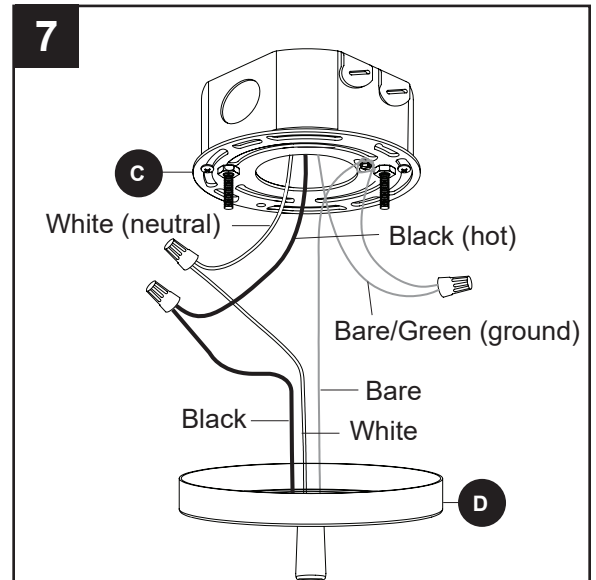

8. Align the holes in the canopy (D) with the mounting screws (J). Then lift the canopy (D) and attach the screw caps (H) to secure the canopy (D). **Note:** If the canopy (D) is not flush against the ceiling, remove the canopy (D) and loosen the hex nuts (I) to allow the mounting screws (J) length to be adjusted. Once adjusted retighten the hex nuts (I) and reinstall the canopy (D).

For crystal bead installation, skip to Page 9, Step 13.

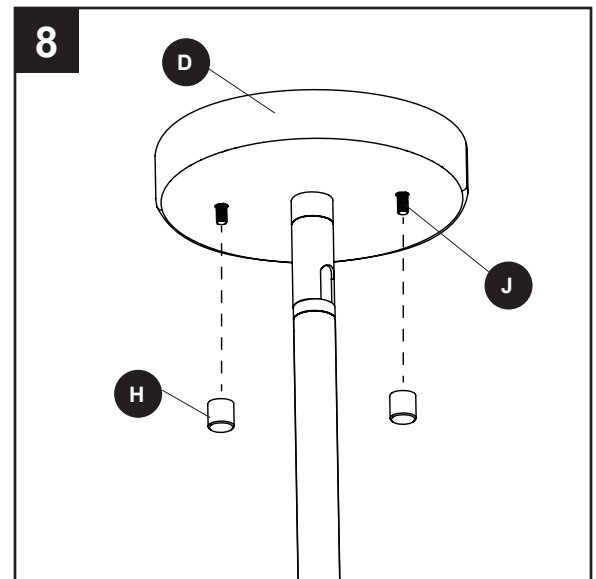

9. **For semi flush installation** - Feed the wires from the fixture (A) through the spacer (B) and canopy (D). Tighten the spacer (B) onto the threaded rod at the top of the fixture (A) and the connecting rod (G) at the bottom of canopy (D) to secure. For ease of wiring, measure 8 inches from the canopy (D) and cut off the excess wire. **Note:** Once the wires are cut, the pendant installation method is no longer an option.

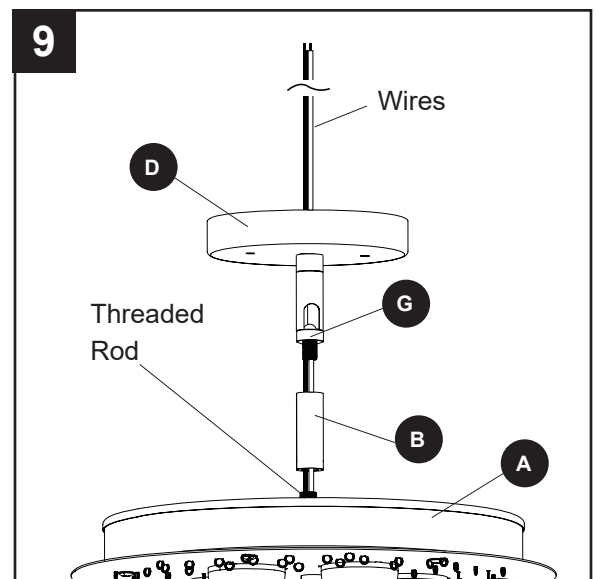

ASSEMBLY INSTRUCTIONS

10. Loosen the ground screw on the mounting bracket (C) and wrap the bare wire from the fixture around the ground screw. Tighten the ground screw to hold the bare wire in place. **Note:** Ensure there is enough of the bare wire extending from the ground screw to connect to the ground wire from the outlet box using a wire connector (AA).

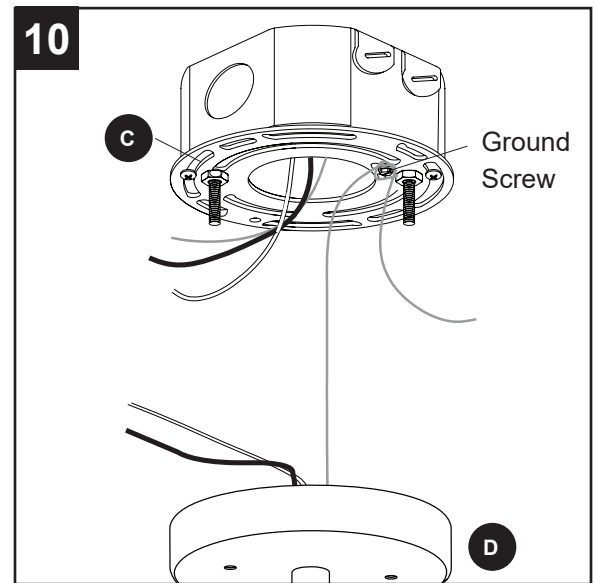

11. Use wire connectors to secure the household supply wires to the fixture wires according to the image and the following instructions:

- Connect the black (hot) supply wire to the black wire from the fixture.
- Connect the white (neutral) supply wire to the white wire from the fixture.
- Connect the bare/green (ground) supply wire to the bare wire from the fixture.

Turn the wire connections and gently push them into the outlet box.

Hardware Used

AA Wire Connector  x 3

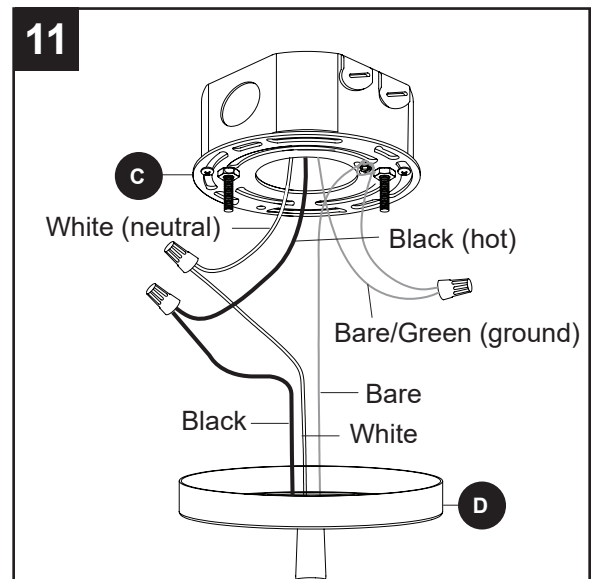

12. Align the holes in the canopy (D) with the mounting screws. Then lift the canopy (D) and attach the screw caps (H) to secure the canopy (D). **Note:** If the canopy (D) is not flush against the ceiling, remove the canopy (D) and loosen the hex nuts (I) to allow the mounting screws (J) length to be adjusted. Once adjusted retighten the hex nuts (I) and reinstall the canopy (D).

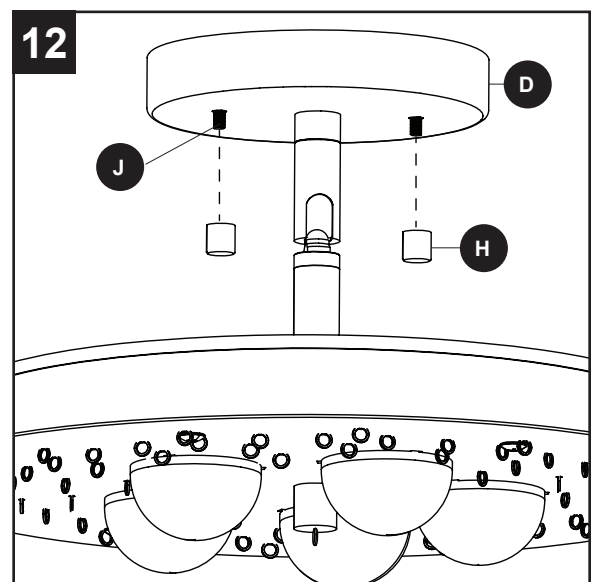

ASSEMBLY INSTRUCTIONS

13. To assemble the beads onto the fixture (A), begin by gathering your beads of varying lengths.

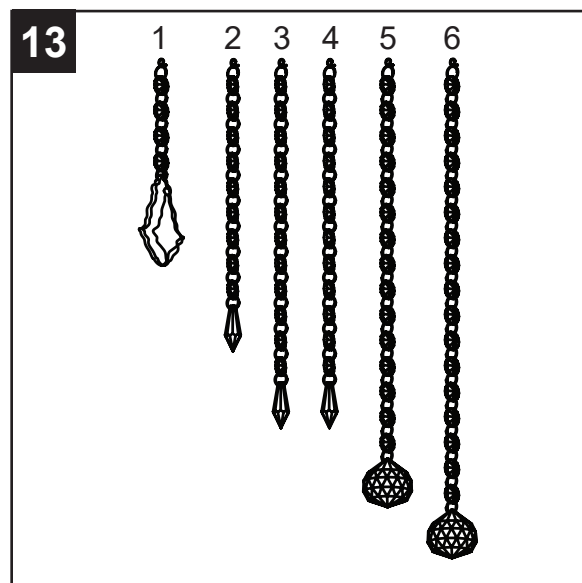

14. Start with the longest strand of beads (6) and secure to the center of the fixture (A) by hooking the open link to the metal loop on the fixture (A).

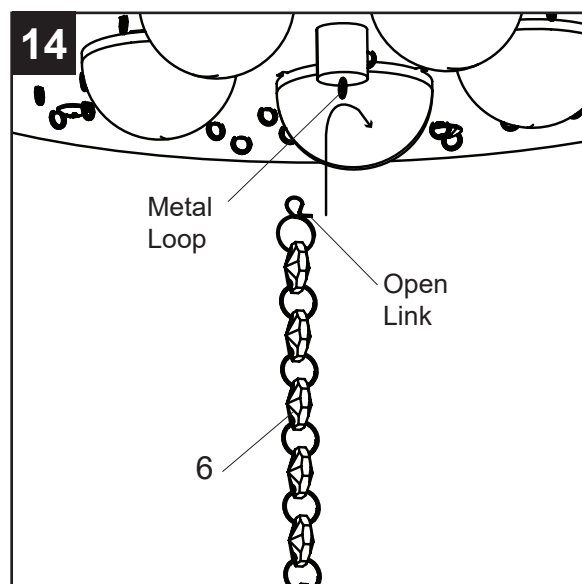

15. Continue this process, adding shorter strands (5-1) outward from the center.

Restore the power at the main fuse or circuit breaker and wall switch.

Assembly is complete.

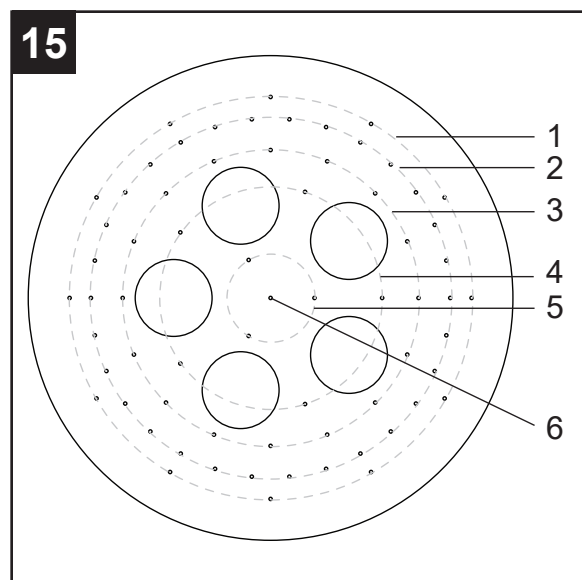

TROUBLESHOOTING

PROBLEM	POSSIBLE CAUSE	CORRECTIVE ACTION
Canopy (D) does not sit flush with ceiling.	Edge of outlet box may not be flush with ceiling.	Loosen and adjust the hex nuts on the two preassembled screws.

THREE-YEAR LIMITED WARRANTY

The manufacturer warrants all of its lighting fixtures against defects in materials and workmanship for three (3) years from the date of purchase. If within this period the product is found to be defective, take a copy of the bill of sale as a proof of purchase and the product in its original carton to the place of purchase. The manufacturer will, at its option, repair, replace or refund the purchase price to the consumer. All costs of installation and removal of the fixture is the responsibility of the consumer. This warranty does not cover fixtures becoming defective due to misuse, accidental damage or improper handling and/or installation and specifically excludes liability for direct, incidental or consequential damages. As some states do not allow exclusions of limitations on an implied warranty, the above exclusion and limitation may not apply. This warranty gives you specific rights and you may also have other rights which may vary from state to state.