

KOBALT™

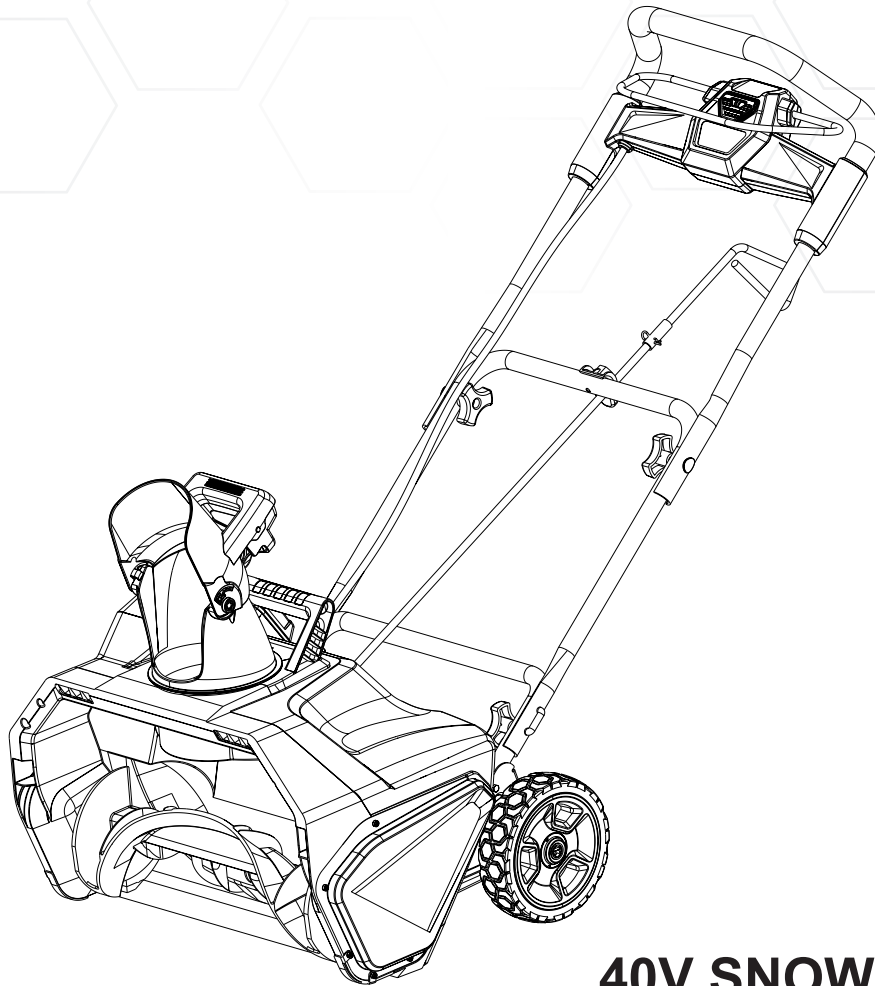

ITEM #1319247

40V SNOW THROWER

MODEL #KSB 6040-06

Español p. 22

ATTACH YOUR RECEIPT HERE

Serial Number _____ Purchase Date _____



Questions, problems, missing parts? Before returning to your retailer, call our customer service department at **1-888-3KOBALT (1-888-356-2258)**, 8 a.m. - 8 p.m., EST, Monday - Friday.

TABLE OF CONTENTS

Product Specifications	2
Package Contents	3
Hardware Contents	4
Symbols	5
Safety Information	7
Preparation	8
Assembly Instructions	9
Operating Instructions	12
Care and Maintenance	15
Troubleshooting	19
Warranty	20
Replacement Parts List	21

PRODUCT SPECIFICATIONS

SPECIFICATIONS	
Battery type	40 V Lithium-ion
No-load speed	1,900 RPM
Working width	20 in.
Cleaning depth	10 in.
Wheels	7 in.
Discharge distance	20 ft.
Weight (without battery)	33.5 lbs.

The recommended ambient temperature range:

Item	Temperature
Snow Thrower Storage Temperature Range	-4 °F (-20 °C) ~ 158 °F (70 °C)
Snow Thrower Operation Temperature Range	1.4 °F (-17 °C) ~ 104 °F (40 °C)
Battery Charging Temperature Range	39 °F (4 °C) ~ 104 °F (40 °C)
Charger Operation Temperature Range	39°F (4°C) ~ 113 °F (45 °C)
Battery Discharging temperature Range	6.8°F(-14°C) ~ 113 °F (45 °C)
Battery Storage Temperature Range	1 year: 32°F (0°C) ~ 73°F (23°C)
	3 month: 32°F (0°C) ~ 113°F (45°C)
	1 month: 32°F (0°C) ~ 140°F (60°C)

PACKAGE CONTENTS

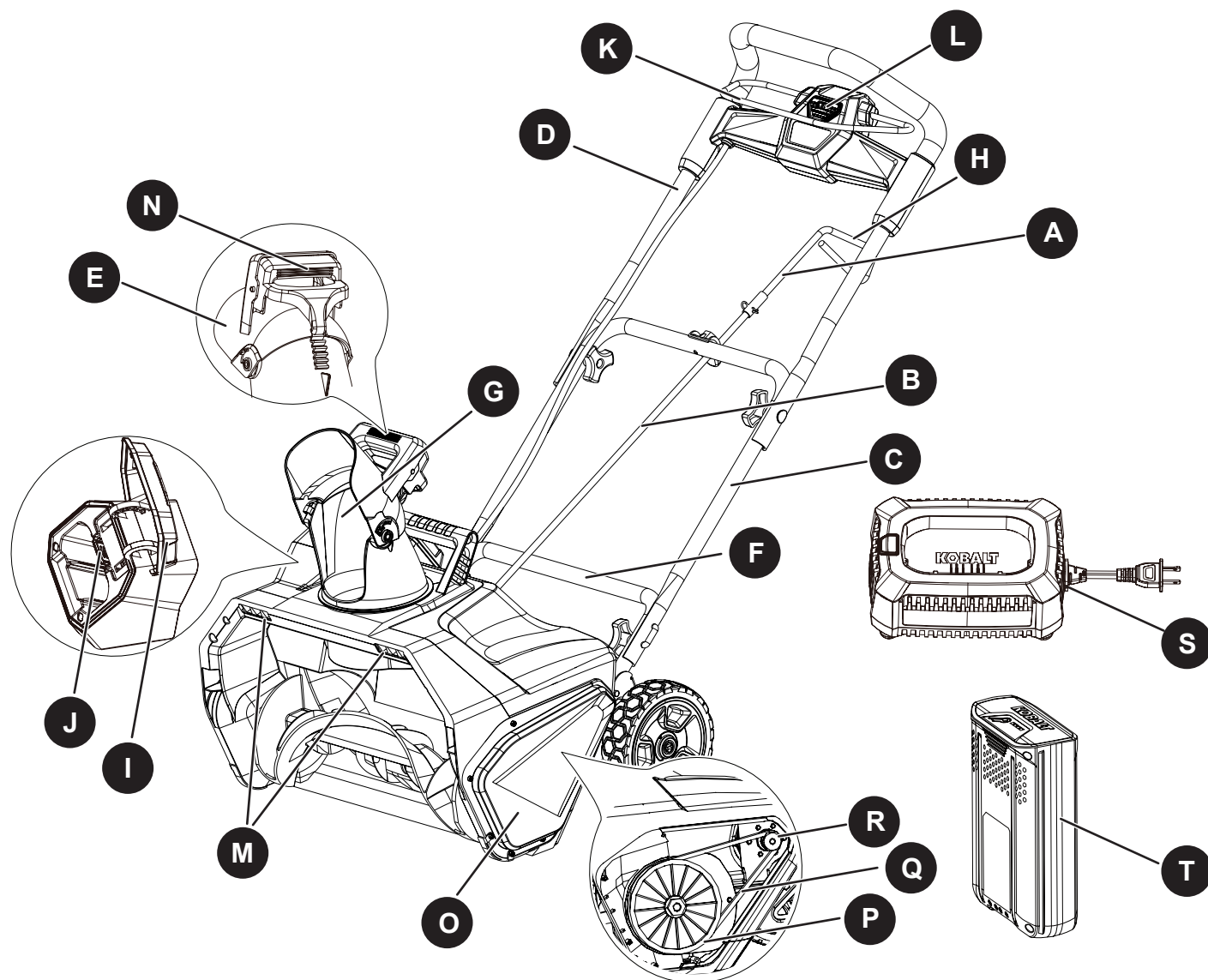

PART	DESCRIPTION	QUANTITY
A	Upper chute control rod	1
B	Lower chute control rod	1
C	Middle handle	1
D	Upper handle	1
E	Chute deflector	1
F	Lower handle	1
G	Discharge chute	1
H	Handle of the chute control rod	1
I	Battery compartment cover	1
J	Battery release button	1

PART	DESCRIPTION	QUANTITY
K	Bail lever	1
L	Safety switch button	1
M	LED lights	1
N	Trigger	1
O	Left side cover	1
P	Large pulley	1
Q	Drive Belt	1
R	Small pulley	1
S	Charger	1
T	Battery	1

HARDWARE CONTENTS (not shown actual size)

AA

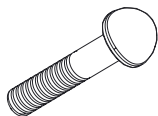

Bolts

Qty. 2

BB

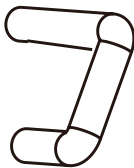

Bolts

Qty. 2

CC



Handle knobs

Qty. 4

DD













Hitch pin

Qty. 1



SYMBOLS

Some of the following symbols may be used on this product. Please study them and learn their meaning. Proper interpretation of these symbols will allow you to operate the product better and safer.

SYMBOLS	NAME	DESIGNATION/EXPLANATION
V	Volts	Voltage
A	Amperes	Current
Hz	Hertz	Frequency (cycles per second)
Wh	Watt Hour	Energy Storage Capacity
Ah	Amp Hour	Current Capacity
---	Direct Current	Type or a characteristic of current
RPM	Rotating Speed	Revolutions per minute
/min	Per Minute	Revolutions, strokes, surface speed, orbits etc., per minute
	Wet Conditions Alert	Do not expose to rain or use in damp locations.
	Read The Operator's Manual	To reduce the risk of injury user must read and understand operator's manual before using this product.
	Eye Protection	Always wear eye protection with side shields marked to comply with ANSI Z87.1 when operating this equipment.
	Safety Alert	Precautions that involve your safety.
	Hand and Feet	Keep hands and feet away.
	Safe Distance	Keep bystanders a safe distance from the machine.
	Stop the Machine	Stop the motor and remove the battery before leaving the machine.
	Moving Parts	Stay away from moving parts. Keep all guards and shields in place.
	Thrown objects	Thrown objects can ricochet and result in personal injury or property damage.
	Hand and feet	Keep hands and feet away from rotating impeller.
	Hand	Keep hands away from the discharge area.

SYMBOLS

The following signal words and meanings are intended to explain the levels of risk associated with this product.

SYMBOL	SIGNAL	MEANING
	DANGER	Indicates an imminently hazardous situation, which, if not avoided, will result in death or serious injury.
	WARNING	Indicates a potentially hazardous situation, which, if not avoided, could result in death or serious injury.
	CAUTION	Indicates a potentially hazardous situation, which, if not avoided, may result in minor or moderate injury.
	CAUTION	(Without Safety Alert Symbol) Indicates a situation that may result in property damage.

WARNING

- To avoid serious personal injury, do not attempt to use this product until you have read this Owner's Manual thoroughly and understand it completely. If you do not understand the warnings and instructions in this Owner's Manual, do not use this product.
Call 1-888-356-2258 for assistance.
-  The operation of any power tool can result in foreign objects being thrown into your eyes, which can result in severe eye damage. Before operating a power tool, always wear safety goggles, safety glasses with side shields, or a full face shield when needed. We recommend a Wide Vision Safety Mask for use over eyeglasses or standard safety glasses with side shields. Always use eye protection that is marked to comply with ANSI Z87.1.



SAFETY INFORMATION



WARNING

Read and understand all instructions before using this product. Failure to follow all instructions listed below may result in electric shock, fire, and/or serious personal injury.

The term “power tool” in all of the warnings listed below refers to your mains-operated (corded) power tool or battery-operated (cordless) power tool.

- Walk. Do not run.
- Verify that the power tool is not in contact with anything before turning it on.
- Stay away from impeller openings at all times. Keep face, hands, and feet away from concealed, moving, or rotating parts.
- Be attentive when using the power tool. Stay alert for holes in the terrain and other hidden hazards or traffic.
- Move up and down slopes when clearing snow. Do not go across a slope. Use caution when changing direction. Do not use this power tool to clear snow from steep slopes.
- Do not operate the power tool if the guards, plates, and other safety protective devices are not in place.
- Do not operate the power tool near glass enclosures, automobiles, trucks, window wells, drop-offs, etc., without properly adjusting the angle of the snow discharge. Keep children and pets away from the work area.
- Do not operate the power tool at high speeds on slippery surfaces. Look behind when backing up and exercise caution.
- Wear safety glasses or goggles that meet ANSI Z87.1 standards.
- Use the power tool in daylight or in good artificial light. Ensure lights are on if using in low light conditions.
- To avoid accidental start-ups, remain in the starting position when turning the power tool on. The operator and the power tool must be in a stable position during start-up. See the section titled Starting/Stopping Instructions.
- Use this power tool only for the purposes it was designed.
- Hold the power tool with both hands while it is in use. Keep a firm grip on the handles.
- If the impeller does not rotate freely due to ice, thaw the power tool thoroughly before attempting to use it.
- Keep the impeller clear of debris.
- Do not attempt to clear the impeller while the motor is running.
- After striking a foreign object, turn the power tool off and remove the battery pack, then inspect it for damage. Repair any damage before restarting and using the power tool.
- If the power tool starts to vibrate abnormally, stop the power tool immediately and attempt to determine the cause. Vibration is generally an indication of danger.
- Stop the motor and remove the battery pack whenever the operator is not in the operating position, before unclogging the impeller, and before making any repairs, adjustments, or inspections.
- Do not use on graveled surface unless the power tool is adjusted for such a surface in accordance with the operator’s manual.
- Keep Children Away – All visitors should be kept a safe distance from work area.
- Dress Properly – Do not wear loose clothing or jewelry. They can be caught in moving parts.
- Wear rubber boots when operating the power tool. Do not operate the equipment when barefoot or wearing open sandals. Always wear substantial footwear.



SAFETY INFORMATION

- Operation of the power tool in the hand-held position is unsafe, except in accordance with the special instructions for such use provided in the operator's manual.
- Keep guards in place and in working order.
- Don't Force Power Tool – It will perform better and safer at the rate for which it was designed.
- Don't Overreach – Keep proper footing and balance at all times.
- If the power tool strikes a foreign object, follow these steps:
 - i) Stop the power tool. Release the switch.
 - ii) Remove the battery pack.
 - iii) Inspect for damage.
 - iv) Repair any damage before restarting and operating the power tool.
- Store Idle Power Tool Indoors – When not in use, power tools should be stored indoors in a dry, locked-up place out of reach of children.
- Hand contact with the rotating impeller inside the discharge chute is the most common cause of injury associated with snow throwers. Never use your hand to clean out the discharge chute.
- To clear the chute:
 - i) Stop the unit and remove the battery.
 - ii) Wait 10 seconds to be sure the impeller blades have stopped rotating.
 - iii) Always use a clean-out tool, not your hands.
- Maintain Power Tools With Care – Follow instructions for lubricating and changing accessories.
- Allow the power tool to run for a few minutes after clearing snow in order to prevent moving parts from freezing.
- Only use identical replacement parts and accessories for this power tool. The use of nonidentical parts or accessories could lead to serious injury to the user or damage the power tool, and will void the warranty.
- Never operate the snow thrower without good visibility or light. Always be sure of your footing, and keep a firm hold on the handles. Walk; never run.
- Do not pick up the power tool while it is running. The power tool is designed to travel along the ground.
- Never allow children to operate a power tool. Never allow adults to operate the equipment without proper instruction. Keep the area of operation clear of all persons, particularly small children, and pets.
- Thoroughly inspect the area where the equipment is to be used and remove all stones, sticks, wires, bones, and other foreign objects.
- Stop the blade(s) when crossing gravel drives, walks, or roads.
- For use only with Kobalt KB 640-06 battery and KRC 40-06 charger.
- Read the operating and service instruction manual carefully. Be thoroughly familiar with the controls and the proper use of the equipment.
- Prevent unintentional starting. Ensure the switch is in the off-position before connecting to battery pack, picking up or carrying the appliance. Carrying the appliance with your finger on the switch or energizing appliance that have the switch on invites accidents.
- Disconnect the battery pack from the appliance before making any adjustments, changing accessories, or storing appliance. Such preventive safety measures reduce the risk of starting the appliance accidentally.
- Run the machine a few minutes after throwing snow to prevent freeze-up of the collector/impeller.
- Recharge only with the charger specified by the manufacturer. A charger that is suitable for one type of battery pack may create a risk of fire when used with another battery pack.



SAFETY INFORMATION

- Use appliances only with specifically designated battery packs. Use of any other battery packs may create a risk of injury and fire.
- When battery pack is not in use, keep it away from other metal objects, like paper clips, coins, keys, nails, screws or other small metal objects, that can make a connection from one terminal to another. Shorting the battery terminals together may cause burns or a fire.
- Under abusive conditions, liquid may be ejected from the battery; avoid contact. If contact accidentally occurs, flush with water. If liquid contacts eyes, additionally seek medical help. Liquid ejected from the battery may cause irritation or burns.
- Do not use a battery pack or appliance that is damaged or modified. Damaged or modified batteries may exhibit unpredictable behavior resulting in fire explosion or risk of injury.
- Do not expose a battery pack or appliance to fire or excessive temperature. Exposure to fire or temperature above 265°F may cause explosion.
- Follow all charging instructions and do not charge the battery pack or appliance outside of the temperature range specified in the instructions. Charging improperly or at temperatures outside of the specified range may damage the battery and increase the risk of fire.
- Have servicing performed by a qualified repair person using only identical replacement parts. This will ensure that the safety of the product is maintained.
- Do not modify or attempt to repair the appliance or the battery pack (as applicable) except as indicated in the instructions for use and care.

GENERAL SAFETY RULES

- Verify that the power tool is secure while transporting.
- Store the power tool in a dry area that will prevent unauthorized use or damage. Keep out of the reach of children.
- Keep handles dry, clean, and free of debris. Clean the power tool after each use. Refer to the Maintenance Section in this manual for more information.
- If the labels on the power tool become defaced or start to lift off, contact customer service at 1-888-356-2258.
- Keep these instructions in a safe place for future reference. Refer to them often and use them to instruct other users. Anyone who uses this power tool must read these instructions carefully.
- Maintain the power tool with care. Follow the instructions for lubricating and changing accessories.

PREPARATION

Before beginning assembly of product, make sure all parts are present. Compare parts with package contents list and hardware contents list. If any part is missing or damaged, do not attempt to assemble the product.

Estimated Assembly Time: 10 minutes

- Always refer to owner's guide instructions for important details if the snow thrower is to be stored for an extended period.
- Maintain or replace safety and instructions labels, as necessary.

ASSEMBLY INSTRUCTIONS

WARNING

- Do not allow familiarity with this product to make you careless. Remember that a careless fraction of a second is sufficient to inflict serious injury.
- Do not use any attachments or accessories not recommended by the manufacturer of this product. The use of attachments or accessories not recommended can result in serious personal injury.

1. ASSEMBLING THE HANDLES

- 1a. Align the holes on the middle handle (C) and the lower handle (F). Insert the bolts (BB) and use the handle knobs (CC) to tighten them.

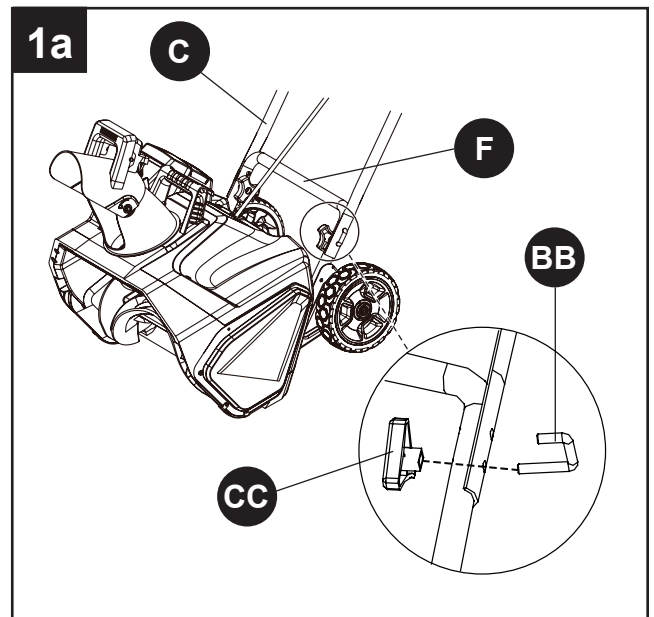

- 1b. Align the hole on the middle handle (C) and the upper handle (D). Insert the bolts (AA) and use the handle knobs (CC) to tighten them.

NOTE: If the upper handle is loose or separated from the middle handle, tighten the handle knobs by turning them clockwise. Do not overtighten the handle knobs.

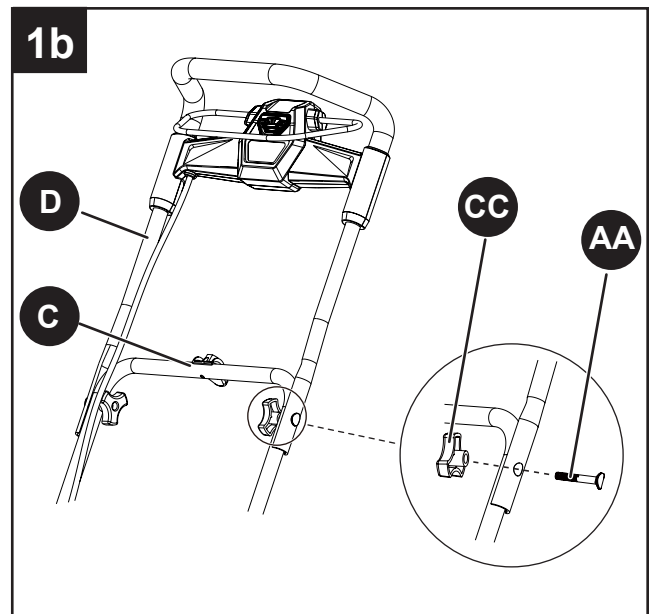

ASSEMBLY INSTRUCTIONS

2. ASSEMBLING THE DISCHARGE CHUTE

- 2a. Push the chute deflector (E) until the latching tabs on both sides click into the slots and the posts on both sides click into the keyed holes.

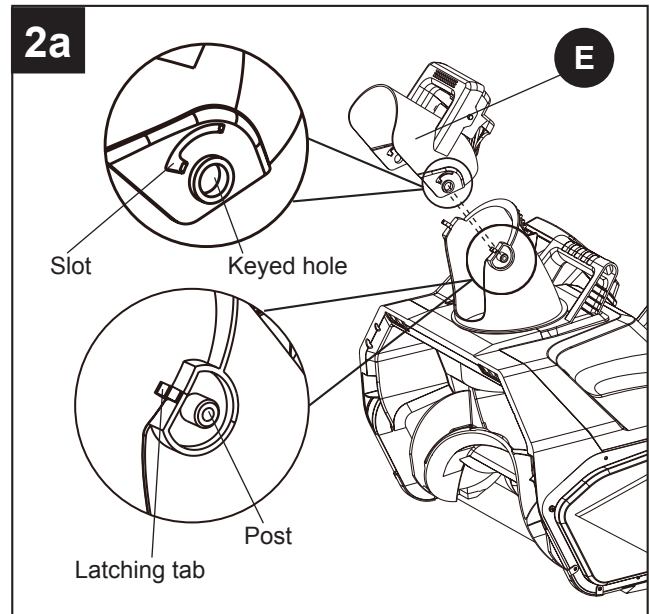

3. INSTALLING THE CHUTE CONTROL ROD

- 3a. Align the holes on the upper chute control rod (A) with the holes on the lower chute control rod (B). Insert the hitch pin (DD).

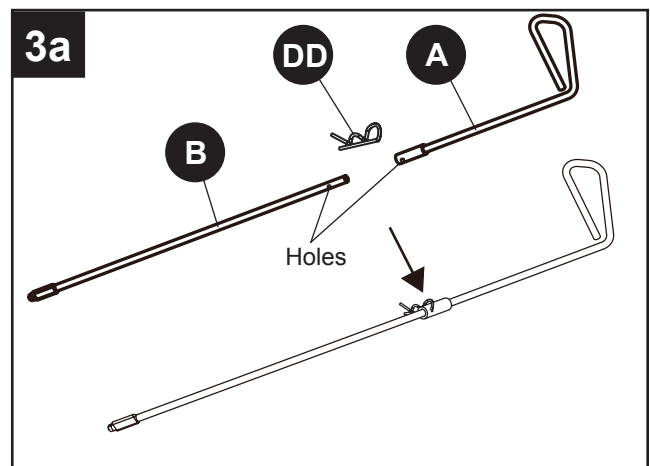

NOTE: Position the discharge chute (G) so that it faces forward.

- 3b. Insert the end of the chute control rod through the keyed hole in the bracket that is attached to the top of the middle handle (C).

Ensure that the handle (H) of the chute control rod points downward and insert the rod into the keyed hole in the back of the housing.

Firmly push the rod into the keyed hole in the back of the housing until it snaps into place.

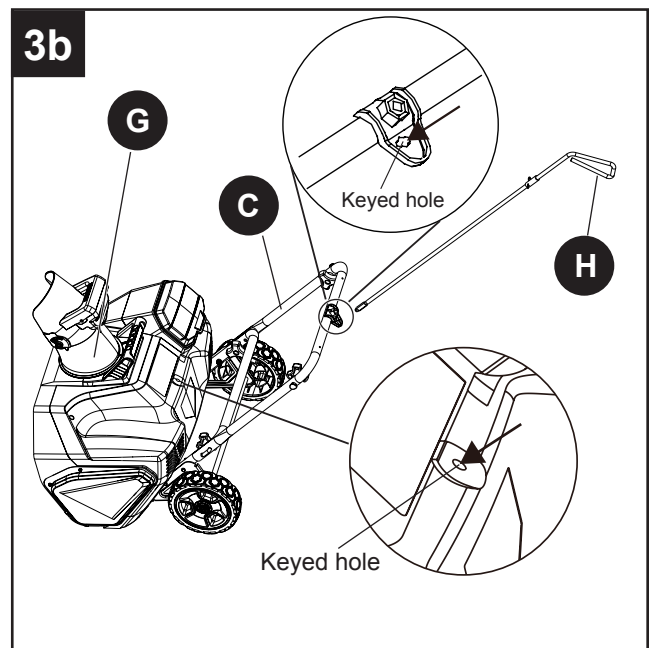

ASSEMBLY INSTRUCTIONS

- 3c. Rotate the handle (H) on the chute control rod to ensure that it moves in the opposite direction as the chute.

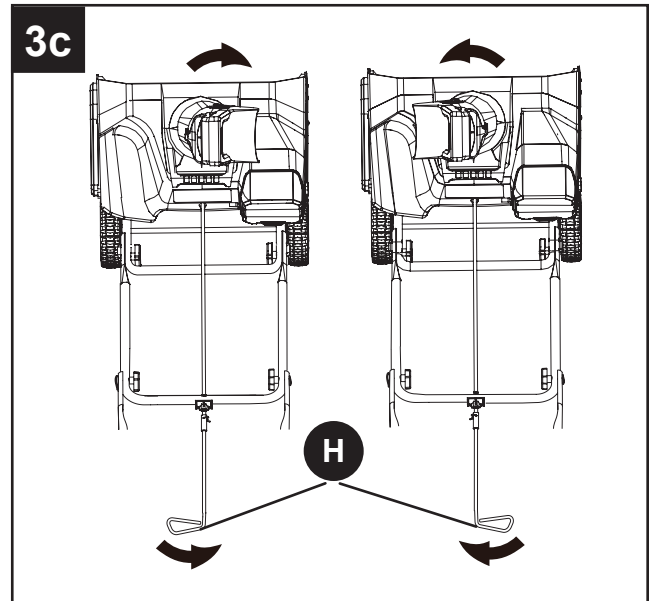

WARNING

Always remove battery from your tool when you are assembling parts, making adjustments, cleaning, or when not in use. Removing battery will prevent accidental starting that could cause serious personal injury.

4a. TO INSTALL BATTERY PACK

- Open the battery compartment cover (I).
- Align the battery with the cavity in the snow thrower housing.
- Slide the battery down to lock it into position. The battery is fully inserted into the snow thrower when you hear an audible “click”.
- Close the battery compartment cover.

4b. TO REMOVE BATTERY PACK

- Release your grip on the bail lever to stop the snow thrower.
- Press the battery release button (J) in the snow thrower housing. This will cause the battery to raise out of the tool slightly.
- Remove battery pack from the snow thrower.

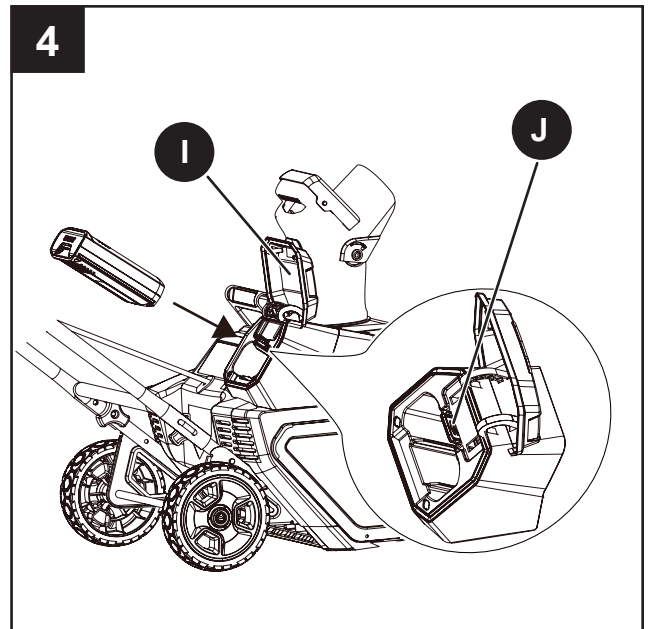

OPERATING INSTRUCTIONS

1a. POWERING ON

1. Press and hold the safety switch button (L).
2. Pull the bail lever (K) upward to the handle to start the snow thrower and then release the button(I).

1b. POWERING OFF

- Release the bail lever (K).

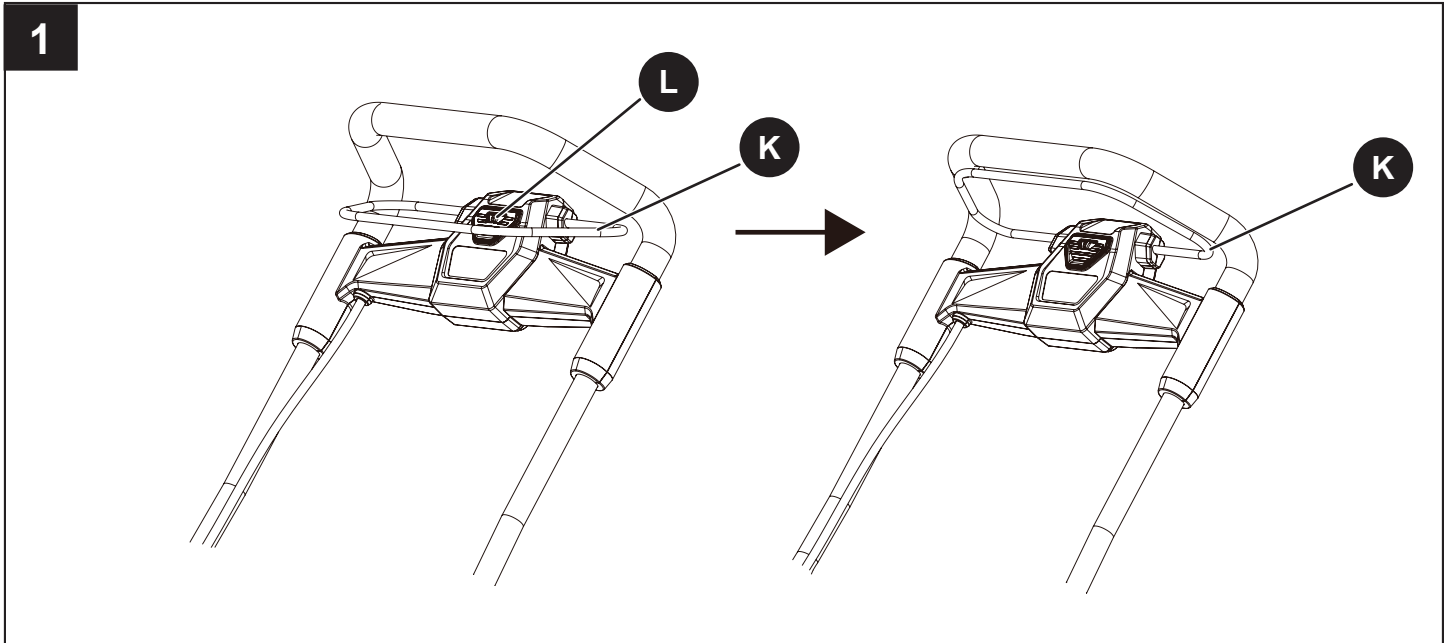

CAUTION

Do not attempt to override the operation of the safety switch button or bar lever.

WARNING

- The operation of any snow thrower can result in foreign objects being thrown into the eyes, which can cause severe eye damage. Always wear safety glasses while operating the snow thrower and while performing any adjustments or repairs.
- Keep bystanders a safe distance from the machine.
- INSPECT THE CLEARING AREA. Remove all stones, sticks, wire, bones, and other debris that might be thrown by the rotating impeller.

OPERATING INSTRUCTIONS

2. LED LIGHTS

- To turn on the LED lights (M) for night time snow removal, press the safety switch button (L) and then pull the bail lever (K) toward you.
- To turn off the LED lights, release the bail lever.

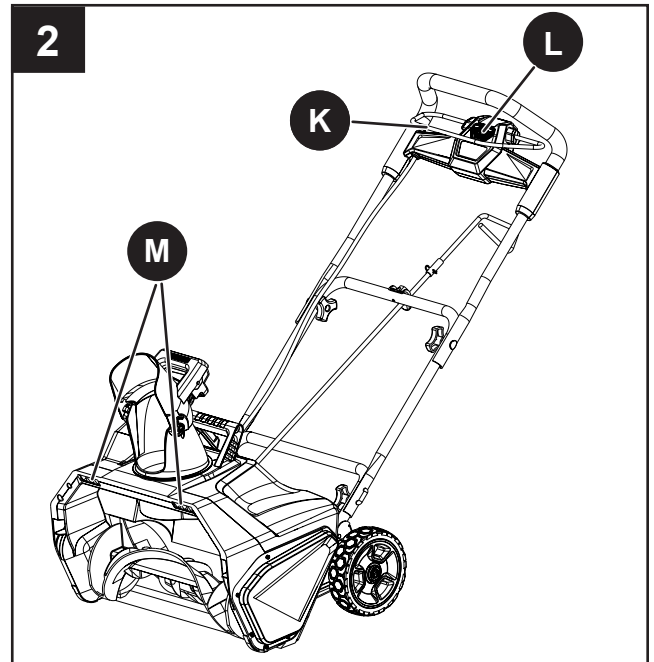

3. ADJUSTING THE DISCHARGE CHUTE AND CHUTE DEFLECTOR

- To adjust the discharge chute (G), rotate the handle (H) on the chute control rod in the direction that you wish to direct the snow stream.
- To adjust the chute deflector (E) and control the height of the snow stream, squeeze the trigger (N) to raise or lower the chute deflector.

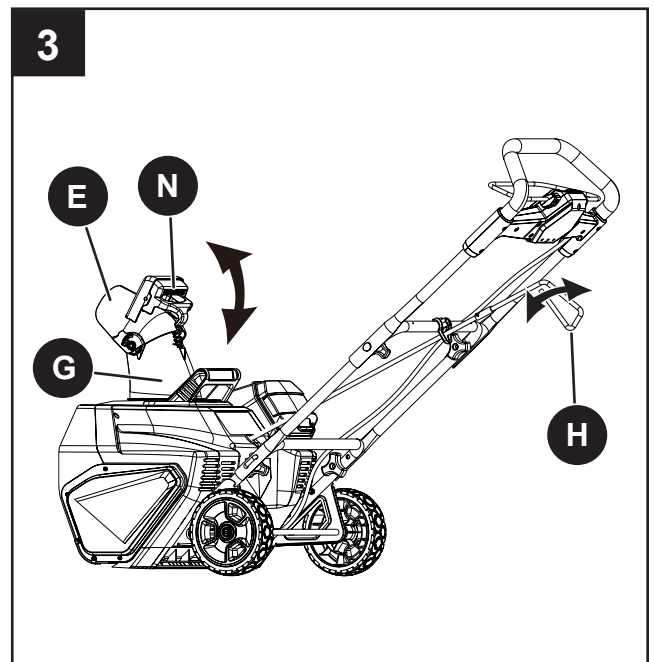

OPERATING TIPS

WARNING

If the snow thrower hits a foreign object while it is in use, the object could be thrown in the direction of the operator or a bystander. Thrown objects could cause serious personal injury. Keep the area to be cleared free of all foreign objects that may be picked up and thrown by the impeller.

- Keep the area of operation free of foreign objects that can become thrown by the impeller. Perform a thorough inspection of the area since some objects may be hidden from view by surrounding snow. If the snow thrower hits an obstruction or picks up a foreign object during use, stop the snow thrower, remove the battery, remove the obstruction, and inspect the unit for damage. Repair or replace any damaged part before restarting and operating the unit.
- Keep children, pets, and bystanders away from the area of operation. Be aware that the normal noise of the machine when turned on may make it difficult for you to hear approaching people.
- When moving the snow thrower, use the wheels on one side as the pivot point. Slightly tilt the snow thrower on this pivot point to move it forward or backward.
- Start your clearing path outward, throwing snow in a back and forth motion. To clear in the opposite direction, pivot the snow thrower on its wheels. Make sure to overlap clearing paths.
- Note the wind direction. If possible, move in the same direction as the wind so that the snow is not thrown against the wind (and thus back onto you and on the just cleared path).
- Do not push the snow thrower with excessive force. You should push the machine gently and at a consistent speed in accordance with the unit's throw rate.
- Some parts of the snow thrower may freeze under extreme temperature conditions. Do not attempt to operate the snow thrower with frozen parts. If the parts freeze while the snow thrower is in use, stop the snow thrower, remove the battery, and inspect for frozen parts. Free all parts before restarting or operating the snow thrower. Never force controls that are frozen.
- When working on pebbles, gravel, or unpaved surfaces, avoid throwing loose surface material along with the snow by pushing down on the handle to raise the scraper at the base of the unit above the pebbles or gravel.
- Cold Weather Operation: Lithium-Ion batteries can be safely used from temperatures ranging from 39°F (4°C) to 104°F (40°C).

NOTE: Do not store or charge battery outside. Battery must be charged and stored indoors prior to use of the snow thrower.

- If the snow thrower does not start, initially remove battery from snow thrower. Place battery on charger and allow to charge for 10 minutes. Remove from charger and install in snow thrower for use. The start-up issue may be caused from the battery being too cold. To avoid this issue, ensure battery is stored in a dry cool place for storage and charging and leave indoors until ready for use.

! IMPORTANT: Always remove the battery from the tool before performing any maintenance on it.

1. REPLACING THE SCRAPER

NOTE: The scraper is located at the bottom of the impeller housing. Ensure that the battery is not installed in the tool.

- Remove the screw from each side plate that holds the scraper.

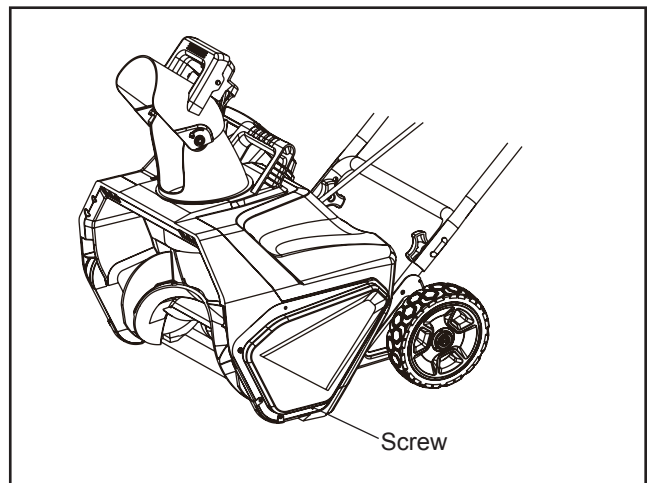
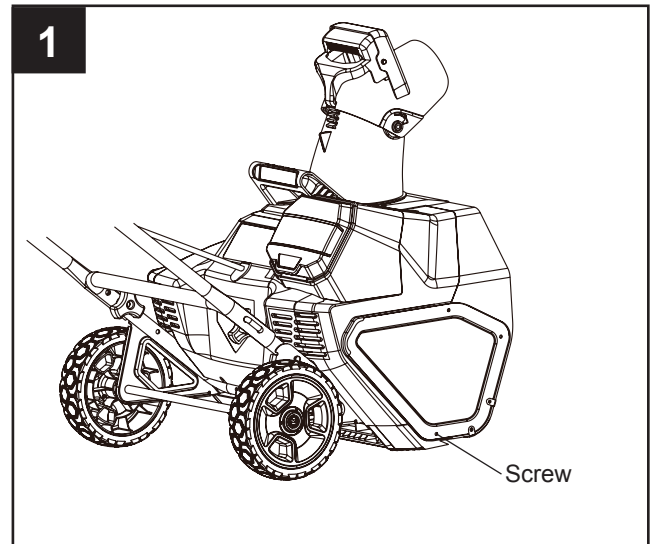

- Remove the 3 screws from under the machine that secure the scraper to the machine.
- Remove and discard the old scraper. Install the new scraper and fasten it securely with 5 screws previously removed.

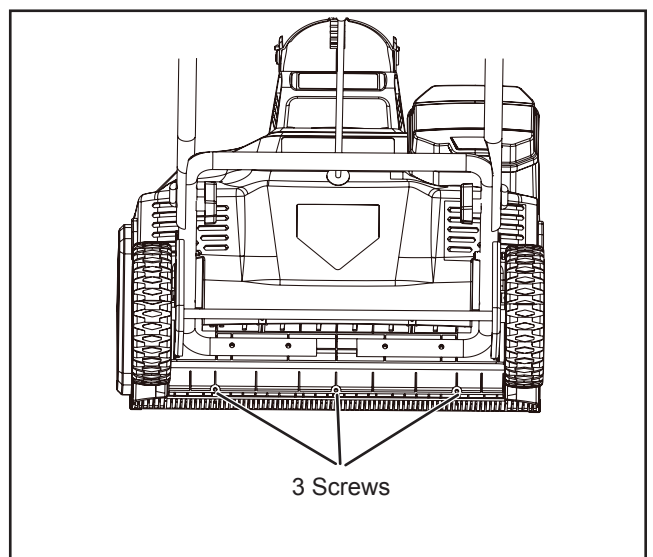

2. REPLACING THE DRIVE BELT

- Remove the 5 screws that secure the left side cover (O) to the frame of the snow thrower. Remove the side cover.

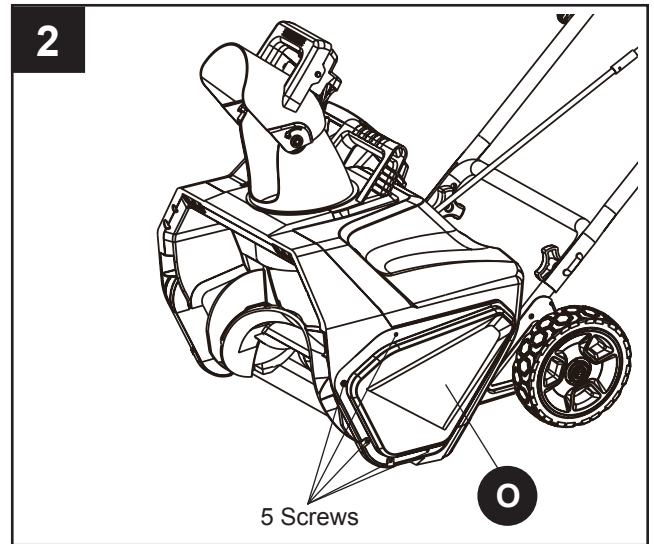

- Remove the old belt (Q) from the small pulley (R) and large pulley (P).
- Loop one end of the new belt over the small pulley.
- Rotate the impeller with the left hand while positioning the belt on the large pulley with the right hand.
- Install the left side cover and secure it using the 5 screws.

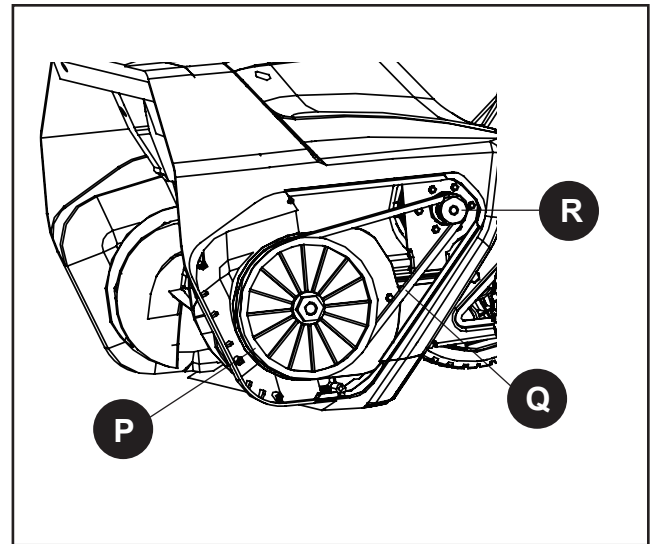

3. REPLACING THE IMPELLER

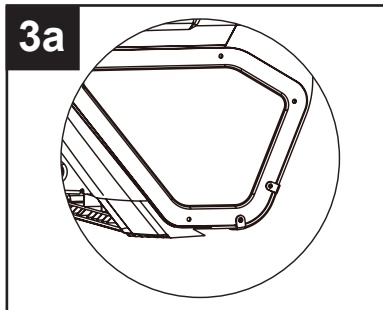

- Remove the 5 screws that secure the right side cover.

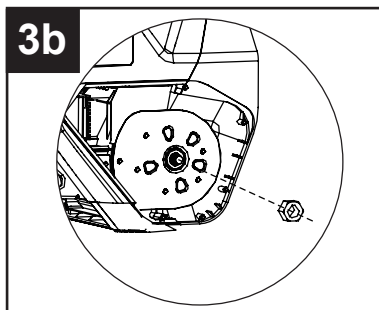

- Remove the nut from the right of the axle.

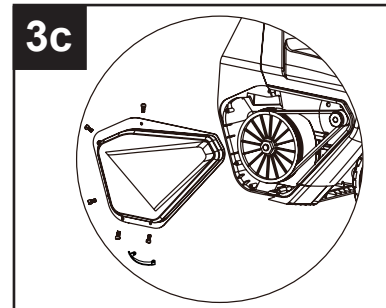

- Remove the 5 screws that secure the left side cover.

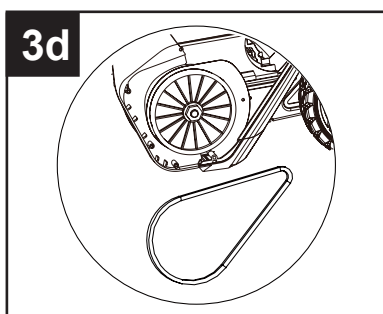

- Remove the belt.

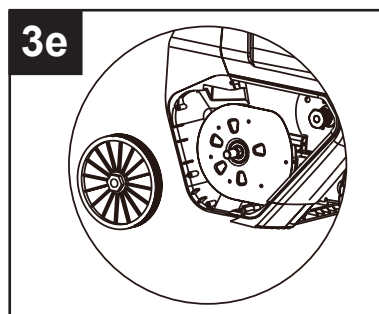

- Using a socket (not included), remove the the large pulley inside the left side cover.

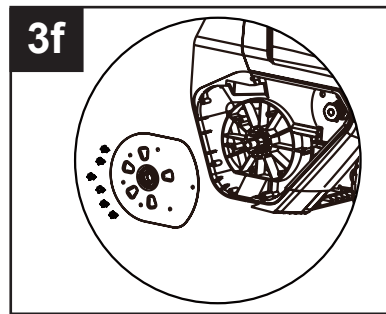

- Remove the 6 screws that secure the left side plate.

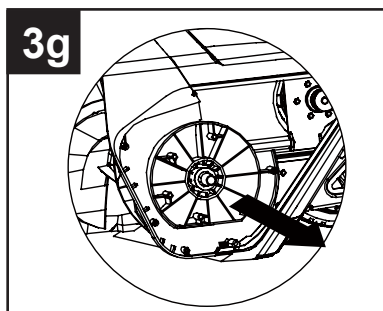

- Pull the axle and remove the old impeller. Install the new impeller and insert the axle.

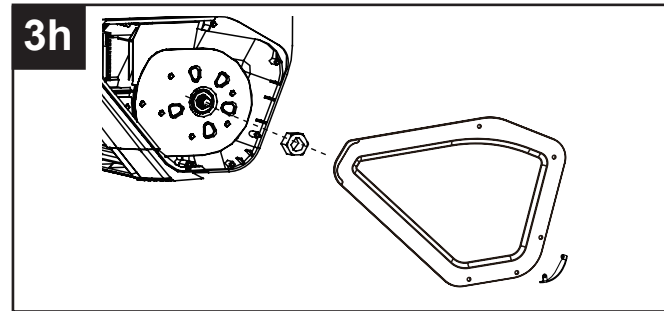

- Reinstall the nut and right side cover.

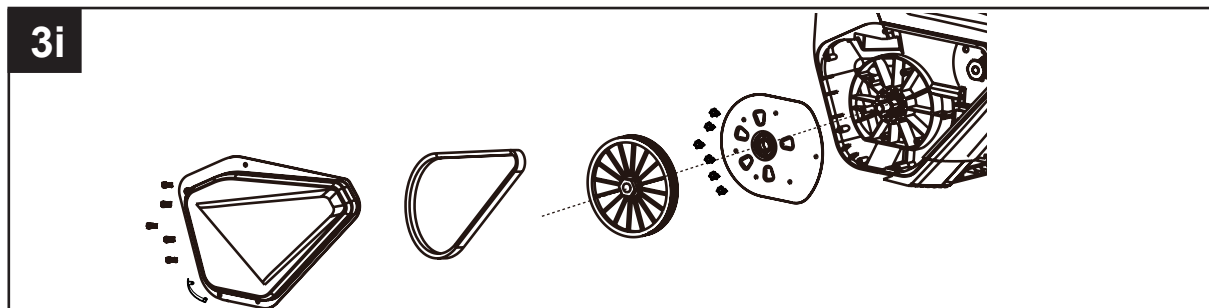

- Reinstall the left side plate, large pulley, belt and left side cover.

CARE AND MAINTENANCE

SERVICE

Servicing requires extreme care and knowledge and should be performed only by a qualified service technician. For service, it is suggested you return the product to your nearest AUTHORIZED SERVICE CENTER for repair. When servicing, use only identical replacement parts.

STORAGE

- Run the snow thrower for a few minutes in order to melt any snow that may be left on the snow thrower.
- Wipe the snow thrower off with a dry cloth before storage. This will help prevent ice building up on the unit and parts freezing.
- Remove the battery and store it in a cool dry location, if possible. Charge the battery every six months when not in use in order to increase its life.
- Inspect the snow thrower thoroughly for worn, loose, or damaged parts. If any parts must be repaired or replaced, contact 1-888-356-2258.
- Store the snow thrower in a clean, dry place. Cover it in order to provide added protection.
- Always store battery and charger indoors.

TROUBLESHOOTING

If you still have questions or an unresolved issue after going through this troubleshooting guide, or just want to speak to a Kobalt product expert, please call our Kobalt customer service department at 1-888-356-2258.

PROBLEM	POSSIBLE CAUSE	CORRECTIVE ACTION
The handle is not in position.	1. The bolts are not properly seated.	1. Make sure the bolts are correctly installed through the handle bars. Check to see if the hand knobs are tight. Refer to Assembling the Handles section in this manual.
The snow thrower doesn't start.	1. The battery is not charged. 2. The switch is defective. 3. Battery is too cold. 4. The battery is not attached to the motor. 5. Battery may require service or replacement.	1. Charge the battery by following the procedures in the battery and charger manual. 2. Have the switch replaced by an authorized service center. 3. Remove battery from snow thrower. Bring battery and charger into warm area for 15 minutes on charge. After 15 mins, remove from charger and install in snow thrower for use. 4. Check the connection between the motor connector and the battery. 5. Call customer service at 1-888-3KOBALT or replace battery.
The motor is on, but the impeller does not turn.	1. The belt is damaged.	1. Replace the belt (see the section entitled Replacing the Drive Belt).
The snow thrower leaves a thin layer of snow behind.	1. The scraper is worn.	1. Inspect the scraper for wear or damage. Replace the scraper (see the section entitled Replacing the Scraper).

WARRANTY

5-YEAR LIMITED WARRANTY

This 40V Lithium-Ion snow thrower is warranted to the original purchaser from the original purchase date for five (5) years subject to the warranty coverage described herein.

This 40V Lithium-Ion snow thrower is warranted for the original user to be free from defects in material and workmanship.

If you believe that the 40V Lithium-Ion snow thrower is defective at any time during the specified warranty period, simply return the 40V Lithium-Ion snow thrower along with proof of purchase to the place of purchase for a free replacement or refund, or call 1-888-356-2258 for warranty service.

This warranty is void if: defects in materials or workmanship or damages result from repairs or alterations which have been made or attempted by others or the unauthorized use of nonconforming parts; the damage is due to normal wear, damage is due to abuse (including overloading of the tool beyond capacity), improper maintenance, neglect or accident; or the damage is due to the use of the tool after partial failure or use with improper accessories or unauthorized repair or alteration.

This warranty gives you specific legal rights, and you may also have other rights that vary from province to province.

REPLACEMENT PARTS LIST

For replacement parts, call our customer service department at 1-888-356-2258.

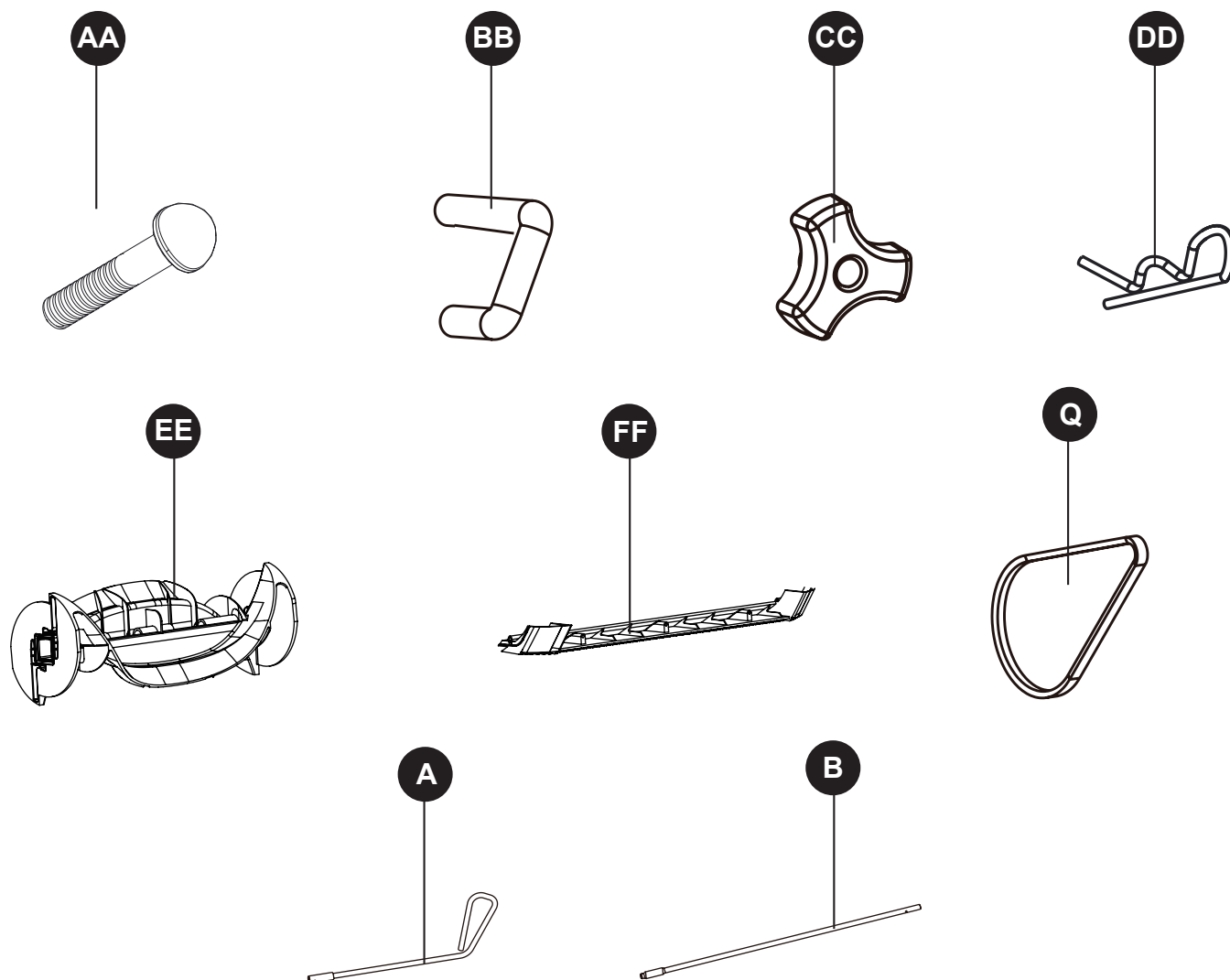

PART	DESCRIPTION	PART #
AA	Bolt	333131492
BB	Bolt	333041205
CC	Handle knob	341291179
DD	Hitch pin	322011463
EE	Impeller	341171205-1
FF	Scraper	341111205
Q	Drive Belt	329061205
A	Upper chute control rod	333032601
B	Lower chute control rod	333011483