

Assembly- Wiring of the Ceiling fan

1.Making the electrical connections



WARNING: The ceiling fan must be grounded.If the ground wire for the installation site is not present, immediately STOP installation and consult a qualified electrician.



IMPORTANT: Use the plastic wire connectors supplied with your fan. Secure the connectors with electrical tape and ensure there are no loose strands or connections.



WARNING: All wiring must be in accordance with national local electrical codes ANSI/NFPA 70. If you are unfamiliar with wiring or in doubt, consult a qualified electrician.

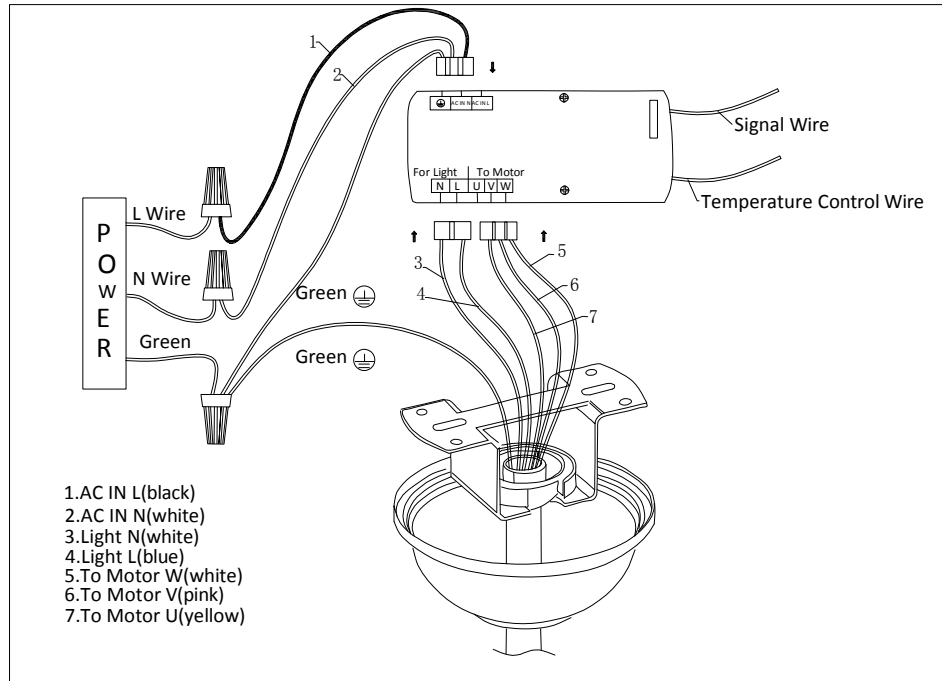

1) As shown in the figure above, install the three motor wires to the motor connector of the remote control receiver. The wire sequence cannot be mixed. The sequence is Yellow-U (left), Pink-V (middle), White-W (right).

2) As shown in the picture above, connect the LED Light wires to the light connector by plug-in - the blue wire is connected to the L terminal, and the white wire is connected to the N terminal.

3) Connect the L and N wires of the power supply to the power input connector on the remote control with the plastic wire nut; and connect the ground wire of the Power supply to the ground wire of the motor wire connection: White to N, Black to L, Green to Green .

Assembly Install the canopy

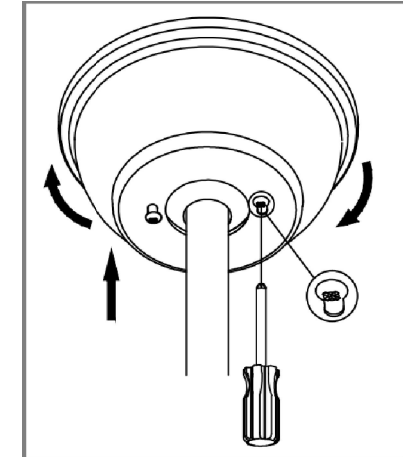
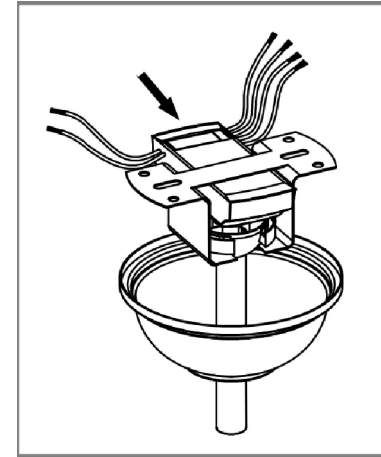

1.After wiring is done,put the remote control receiver in the mounting bracket.

2.Carefully push the canopy to the bottom of the mounting bracket, and then screw up the two screws clockwise.