

# Be Unwhite

*Every Color Sings a Unique Song*

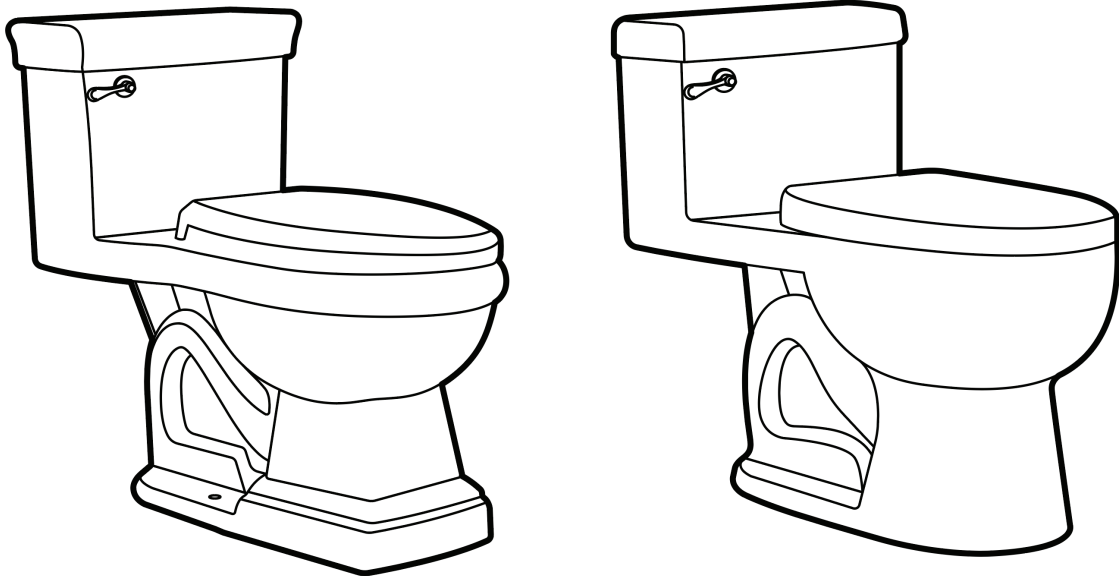

BU01T & BU02T One-Piece Toilet

## INSTALLATION & CARE GUIDE

[www.beunwhite.com](http://www.beunwhite.com)

Email: [cs@beunwhite.com](mailto:cs@beunwhite.com)

# GET READY TO ROCK YOUR TOILET INSTALLATION!

Hey there, Toilet DIY Champion!

Before you dive into this exciting adventure of installing your awesome one-piece toilet, let's make sure you're all set to conquer this task like a pro. We've got your back with some super easy-to-follow instructions. No worries, we've made it as simple as a high-five!

## Before You Jump In:

- Give these instructions a friendly read so you can strut your stuff with the right tools and materials. Trust us, this prep work is like having the ultimate cheat code.
- Take a quick peek at your toilet to ensure it's in tip-top shape after its journey to your place. We want it to look as cool as it should be!
- Be a good citizen and follow all those plumbing and building codes your neighborhood loves to talk about. We're all about keeping things legit.
- Time to say goodbye to your old toilet. Don't worry, this upgrade is going to be a game-changer!

Oh, here's a golden nugget for you: Make sure that water supply pressure hits a minimum of 35 PSI (2.5 kg/cm). That's the kind of power your toilet needs to show its magic. No pressure, no performance, right?

## Now, Let's Level Up:

- Give that mounting surface a little love – clean and level are the magic words. We want your toilet to have the comfiest seat in the house!

Alright, rockstar, you're ready to roll. Get ready to make your bathroom the envy of the block. And remember, we're just a message away if you need a helping hand. Now, go install that toilet like the champion you are!

Toilet Cheers,  
Be UnWhite Team

## TOOLS AND MATERIALS REQUIRED (not supplied)

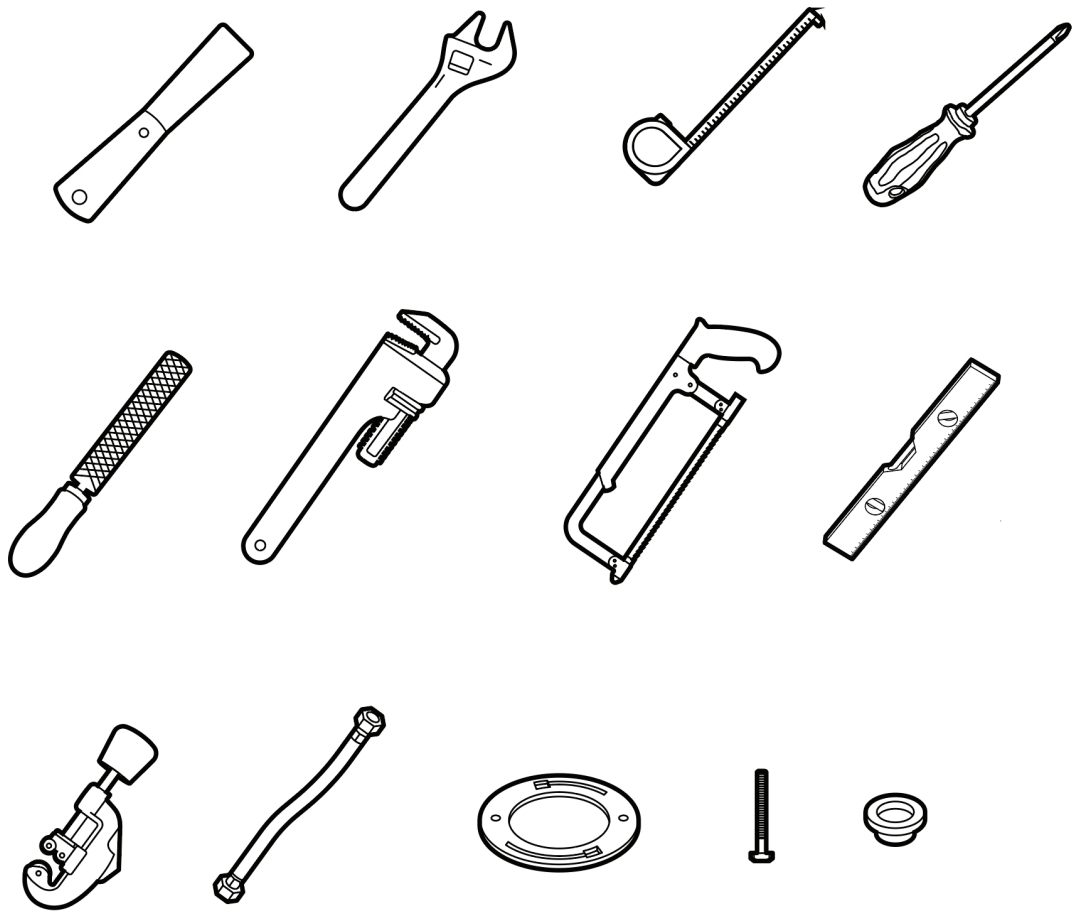

- |                                 |                                   |
|---------------------------------|-----------------------------------|
| 1 10" (254mm) adjustable wrench | 8 Tubing cutter                   |
| 2 12" (305mm) pipe wrench       | 9 Level                           |
| 3 Hacksaw                       | 10 Putty knife                    |
| 4 Screwdriver                   | 11 Toilet installation flange     |
| 5 T-Bolts                       | 12 Toilet gasket (e.g., wax seal) |
| 6 Metal file (file cut)         | 13 Water supply line              |
| 7 Tape measure                  | 14 Toilet supply shut-off valve,  |

## PRODUCT DIMENSION

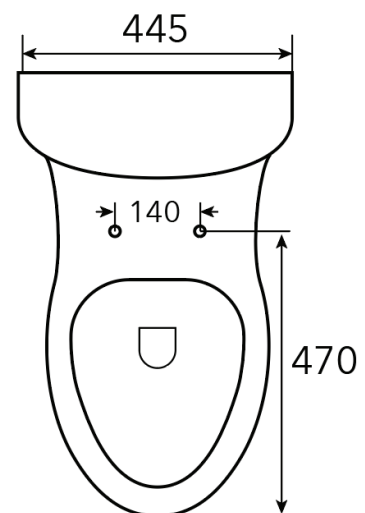
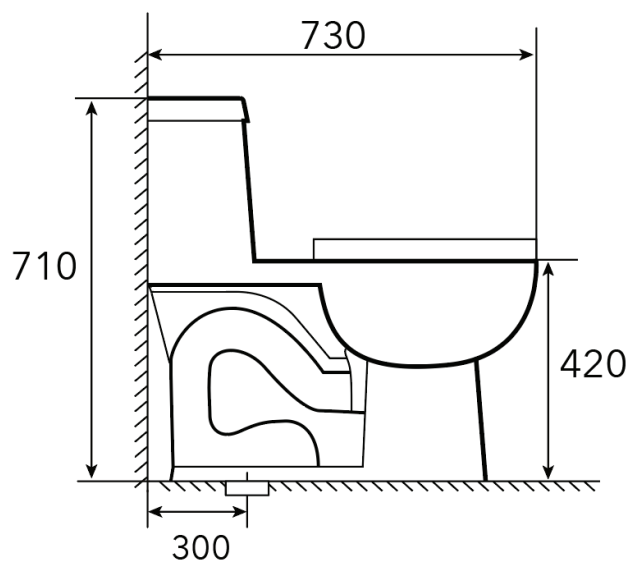
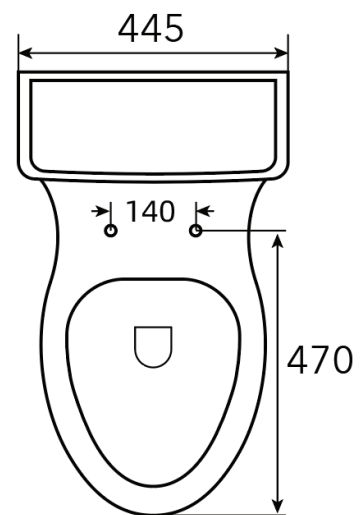
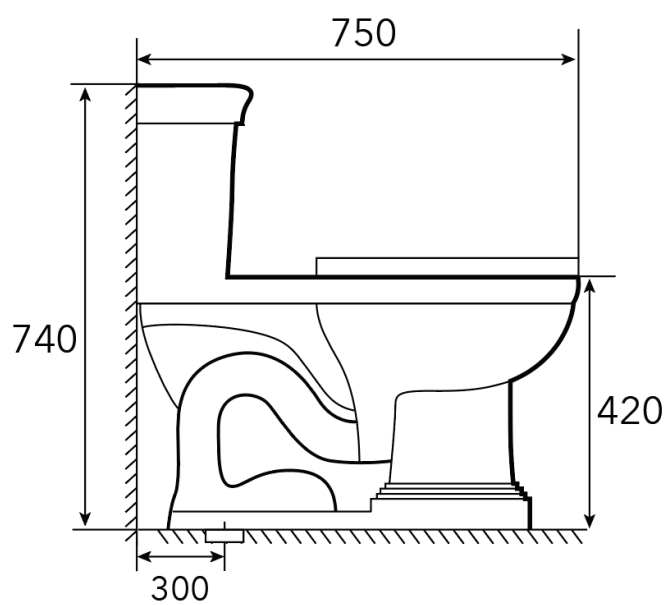

## PARTS PROVIDED

Toilet seat, Tank lever, Floor bolt covers, Seat hinge bolts and caps.

**Quick heads-up:** If your current toilet doesn't sport a supply shut-off valve beneath the tank, make sure to pop one in before you dive into setting up your shiny new throne.

## START INSTALLATION

### 1. Remove Old Toilet

- Turn off the water supply.
- Flush the toilet to empty the tank. Remove any water left in the tank or bowl.
- Disconnect the supply line from the tank.
- Remove decorative caps. Unscrew nuts that attach the toilet to the floor. Remove toilet.
- Make sure the water supply valve is shut off before installation.
- Remove old closet bolts from closet flange. Clean any old wax, putty, etc. from base area.

### 2. Install or relocate the water supply and outlet as necessary to conform to the rough-in dimensions of your new toilet. Ensure that the shut-off valve is greater than 7 1/2" from the center of the drain to the center of the shut-off valve on either side.

**NOTE:** This is a true 12" rough-in toilet from finished wall to center of the drain (no less than 12" ). Baseboard thickness may reduce rough-in dimension.

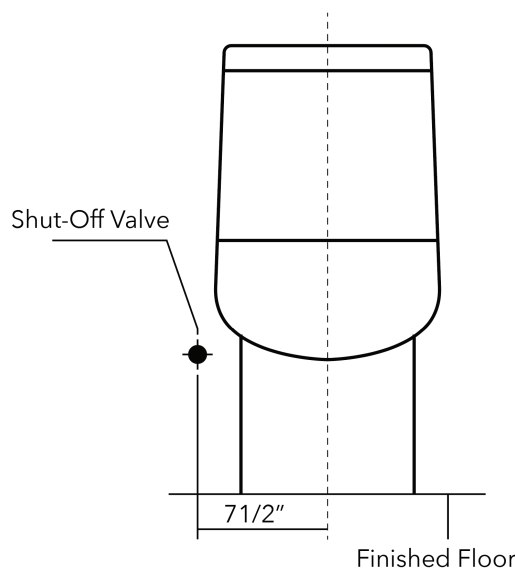

3. If replacing a toilet, scrape off and remove all wax residue with a cleaner. Toilet horn must be clean and dry.

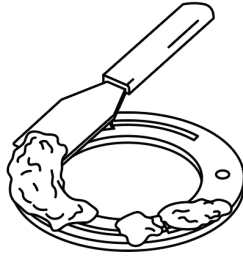

4. Insert new T-bolts.

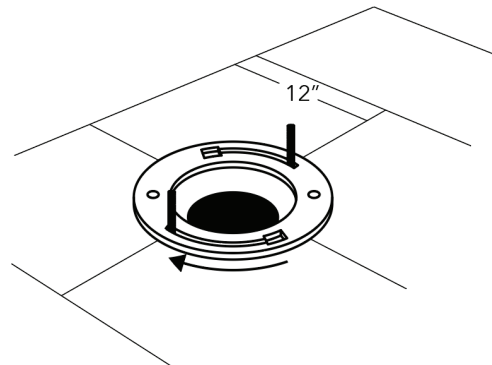
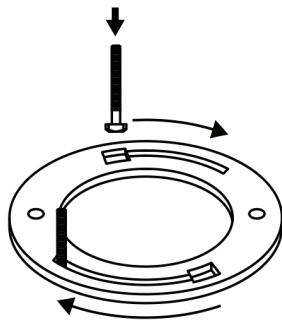

5. Place the wax seal.

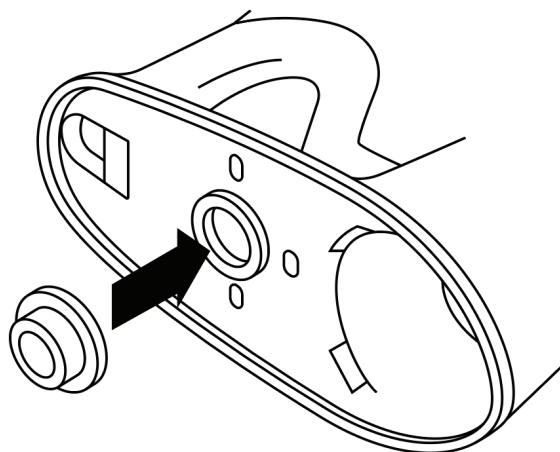

6. Apply weight evenly.

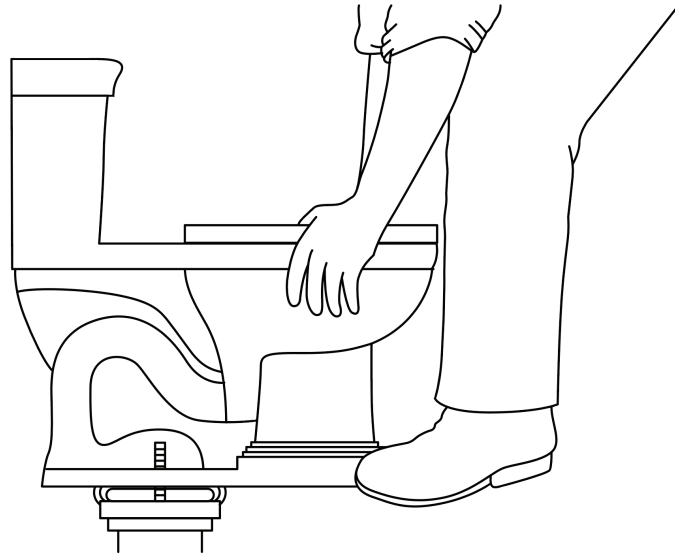

7. Install floor mounting kit as shown below. DO NOT OVERTIGHTEN!

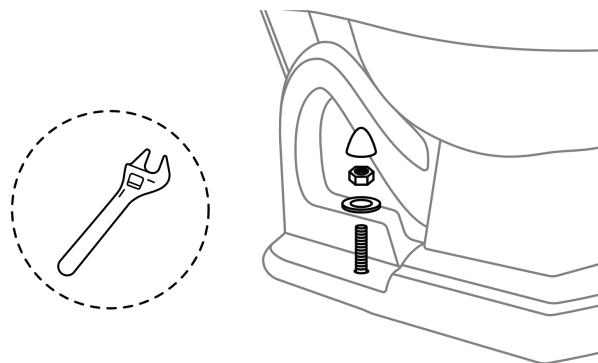

8. Cut excess from the bolt and affix bolt cap

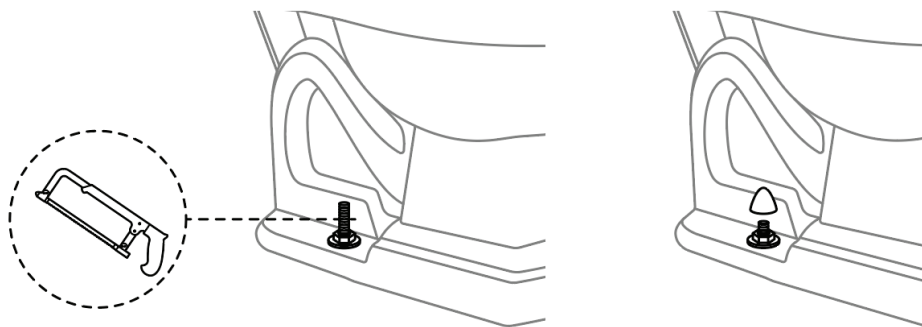

9. Connect the water supply line and turn on the water. Flush several times and check for leaks. Please Do Not Overtighten.

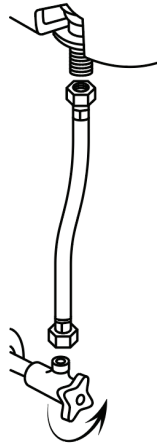

10. Check that the flapper chain is taut without any excessive slack and adjust as needed. If necessary, adjust the water level in the toilet tank.

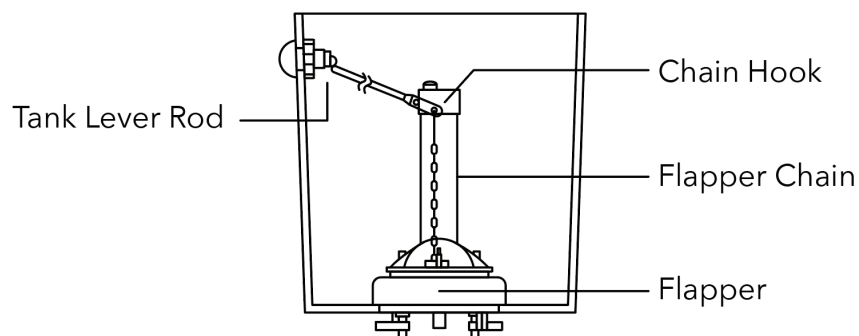

11. Install the tank lid and seat per the seat instructions provided. Use the supplied seat bolts and washers. Check for leaks over the next several days.

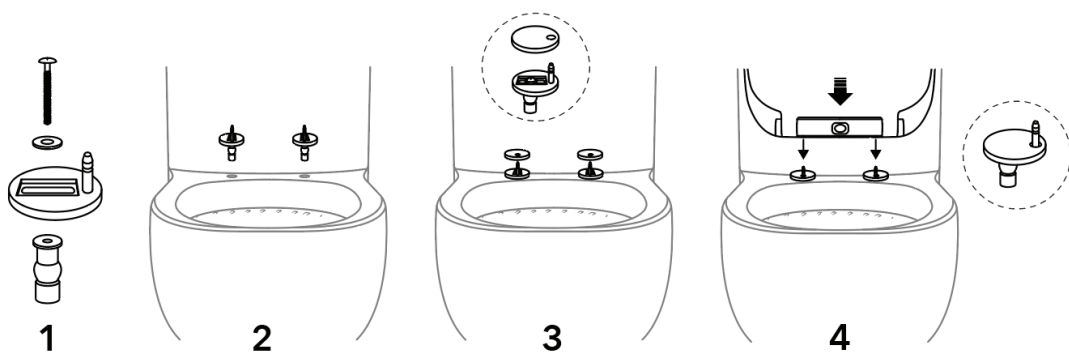



## PRODUCT CLEANING & CARE

- Do not use in-tank cleaners in your toilet. Products containing chlorine can seriously damage fittings in the tank. This can cause leakage and damage.
- Do not use cement while installing toilet.
- Wipe surfaces clean and rinse completely with water immediately after applying cleaner. Rinse and dry any overspray that lands on nearby surfaces. Do not allow cleaners to soak on surfaces.
- Use soft, dampened sponge or cloth. Never use abrasive materials such as hard-bristle brushes or scouring pads to clean surfaces. Use of any abrasive materials may damage the porcelain glaze.
- If you live in a hard water area, make certain that the rim-jet holes underneath the rim of the toilet bowl are kept clean to ensure proper flushing.

## TROUBLESHOOTING GUIDE

### PROBLEM & RECOMMENDED ACTION

#### Poor Flush

- Adjust the tank water level to match the waterline.
- Fully open the water supply shut-off valve.
- Clear obstructions from the trapway, jet or rim holes.

#### No Flush

- Reconnect the chain to the trip lever or flapper.
- Adjust the flapper chain assembly to remove excessive slack.

Fill valve turns on or off by itself without the toilet being flushed. Fill valve runs allowing water into the tank.

- Adjust the flapper chain for proper slack so flapper closes completely.
- Clean or replace the flapper if it is worn, dirty, or misaligned with the flush valve opening.
- Clean area around the flush valve opening to allow flapper to seal.
- Adjust the tank water level if it is too high.
- Replace the fill valve if the valve float sinks.

Tank takes excessive time to fill

- Fully open the water supply shut-off valve.
- Check supply line for a kink and remove if necessary.
- Clean valve inlet, valve head, or supply line. Flush lines to clear any debris.

There is excessive noise when the tank is filling

- Partially close the water supply shut-off valve if the water pressure to the toilet is too high. Check the toilet performance following any such adjustment.
- Remove dirt or obstructions from the fill valve head. Flush the lines to clear any debris.

## **IMPORTANT CONSUMER INFORMATION**

### **Consumer Responsibilities**

- If you live in a hard water area, make certain that the holes in the toilet rim are kept clean to ensure proper bowl flushing.
- Toilet bowl cleaners should be used at least once a week.
- Use a long-handled brush to clean the rim holes and to clean as far into the trap as possible to prevent mineral deposits from forming.
- Most toilet bowl cleaners are not harmful to the vitreous china surface of the toilet bowl. Please follow the bowl cleaning instructions carefully.

## **WARNING**

- DO NOT USE ABRASIVE CLEANERS OR SOLVENTS.
- DO NOT USE ANY CEMENT WHILE INSTALLING THE TOILET
- Expansion due to heat may damage the base of the toilet. Be Unwhite will not be responsible for any heat damage.
- Do not throw material into the toilet can easily clog such as newspaper, paper towels, or sanitary napkins.
- Take care not to strike vitreous china with force to prevent damage and leaks.
- Do not use the toilet with water below 0°C (32.0°F).