

## **Twin Window Fan with Two Removable Covers and Full Function Remote Control**

---

### **Features:**

- Three Fan Functions:
  - COOL - Brings fresh air in
  - EXHAUST - Removes stale air from room
  - CIRCULATE - Operates fans opposing directions creating air circulation and room ventilation
- Push Button «ON» Switch with Speed Settings: LOW, MEDIUM, HIGH
- Long Distance Full Function Remote Control  
(requires 2 AAA batteries - batteries not included)
- Adjustable Accordion Extensions Expand from 23-1/2" to 37"
- Rust Resistant Construction
- Poly Fan Blades Designed for Maximum Air Movement
- Safety Grilles
- 120V A.C. / 60Hz
- 2 Removable covers to keep out hot air, humidity, bugs:
  - FABRIC COVER (attaches to front when not in use to keep out hot and humid air)
  - BUG SCREEN (attaches to back of fan)

## INTENDED USE:

This product is intended for indoor residential and office use only, not for industrial or other commercial applications. Use only with electrical wiring that is in good working order and that meets applicable codes and ordinances. If you have any questions whether your wiring is adequate, consult a qualified electrician.

While using your fan, you should follow the IMPORTANT INSTRUCTIONS listed below. As part of those instructions, we have used the word "**WARNING**" to indicate the level of hazard: **WARNING** indicates a hazard which, if not avoided, could result in injury or death.

## IMPORTANT INSTRUCTIONS:

As with all electrical appliances, basic safety precautions should always be followed to reduce the risk of electric shock, fire, or injury to persons, including the following precautions:

- Read all the instructions before using this fan.
- Use this fan only as described in this manual. Any other use not recommended by the manufacturer may cause electrical shock, fire or injury to persons.
- Do not operate the fan with a damaged power cord or after the fan malfunctions or has been dropped in any manner.
- Use of extreme caution is necessary when any fan is used by or near children, disabled persons or pets and whenever the fan is left operating unattended.
- Do not place the fan on a small, unlevel, uneven or any surface which might allow fan to tip or fall.
- For proper operation, fan should be placed on a smooth, non-combustible, level surface.
- Always unplug fan when not in use, when moving from place to place, when assembling or disassembling parts, and before cleaning.
- The use of attachments, not recommended or sold by the manufacturer, may cause hazards.
- Do not use outdoors.
- Do not use fan in window. Rain may cause electrical hazard (for non-window models).
- Do not operate the fan with blade guards or any safety device removed.
- Avoid the use of extension cords due to risk of fire. If an extension cord must be used, the cord must be minimum 14 AWG and rated not less than 1875 watts.
- Do not run power cord under carpeting. Do not cover cord with throw rugs, runners or the like. Arrange cord away from traffic area where it will not be tripped over.
- Do not insert or allow any object to enter any openings on the fan. Doing so may cause electric shock and/or fire hazard. Avoid contact with moving parts.
- This appliance is not intended for use by persons (including children) with reduced physical, sensory or mental capabilities or lack of experience and knowledge, unless they have been given supervision or instruction concerning use of the appliance by a person responsible for their safety.
- Children should be supervised to ensure they do not play with the appliance.

## READ & SAVE THESE INSTRUCTIONS!

### **WARNING: SHOCK HAZARD**

Use your fan only in dry environments. This fan is not intended for use in a bathroom, laundry area, or similar locations, or near sinks, washing machines, swimming pools or other sources of water. Never locate fan where it may fall into a bathtub or other water receptacle. Do not use in damp environments such as flooded basements.

### **WARNING: HOT SURFACES**

Do not touch fan motor when in use. This motor is hot when in use, to avoid burns, do not let bare skin touch hot surfaces.

### **WARNING: FIRE HAZARD**

Fans have arcing or sparking parts inside. Do not use near combustible materials or flammable gases or sources of heat. Do not use in areas where gasoline, paint or flammable materials are used or stored. To prevent a possible fire, do not block air intakes or exhaust in any manner. Do not insert or allow foreign objects to enter any ventilation or exhaust opening as this may cause an electric shock, fire, or damage the fan.

### **WARNING: ELECTRICAL SHOCK HAZARD**

Do not use with damaged cord or plug. Use with adequate electrical system that is up to code.

### **CAUTION: TO PREVENT ELECTRIC SHOCK,**

this product has a polarized two prong plug (one blade is wider than the other) that must be fully inserted in to a matching properly grounded outlet. This plug is designed to fit a polarized outlet only one way. If the plug does not fit fully into the outlet, reverse the plug. If the plug still does not fit, contact a qualified electrician. Do not attempt to defeat this safety feature.

**CAUTION: TO REDUCE THE RISK OF FIRE OR ELECTRIC SHOCK,** do not use this product with any solid-state speed control device.

**DO NOT** operate any fan with a damaged cord or plug or after fan malfunctions, has been dropped or damaged in any manner. Do not operate fan with a broken blade, safety cage or any visual imperfections. Disconnect power before servicing. For repairs covered under warranty, see warranty statement. For all other repairs contact Comfort Zone® Customer Service by telephone or mail for information and assistance.

**DO NOT** run power cord under carpeting. Do not cover cord with throw rugs, runners or the like. Arrange cord away from traffic area where it will not be tripped over. Avoid the use of extension cords due to risk of fire. If an extension cord must be used, the cord must be minimum 14 AWG and rated not less than 1875 watts. Do not use an extension cord unless the plug can be completely inserted into its receptacle. Unplug the fan when not in use. Do not operate fan with its ventilation obstructed.

**CAUTION: TO REDUCE THE RISK OF FIRE AND TO PROPERLY EXHAUST AIR, be sure to duct air outside. Do not vent exhaust air into spaces within walls or ceilings or into attics, crawl spaces, or garages.**

## ASSEMBLY INSTRUCTIONS

**Simple assembly is required to use this fan on a table or floor.**

Locate slot on the base of fan. Align screw holes of base leg and fan and attach base leg, be sure base leg is snapped in and secured in slot (See Fig. 1). Use supplied screw to secure the base leg to the fan (See Fig. 2). Repeat for the opposite side.

**Note:** Base legs should not be installed when secured inside a window as described below.

**Fig 1**

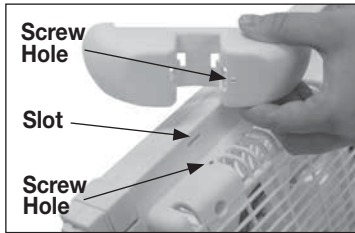

**Fig 2**

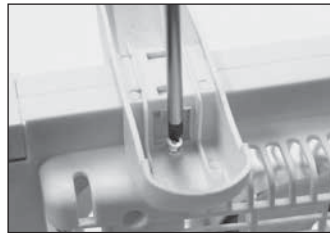

### Installation for Double Hung Window:

It is recommended that window screens be left in place. Legs should not be installed when mounting in window.

1. Locate **Slot** behind Control Panel, remember it for future use.
2. With fan centered in window unlock Clips to Accordion Panels and spread out to fit securely in window track. Lock Accordion Panels in place by closing the Clips on the top and bottom of Accordion Panels (See Fig. 3).
3. Lower window into **Slot** behind Control Panel mentioned.

**Fig 3**

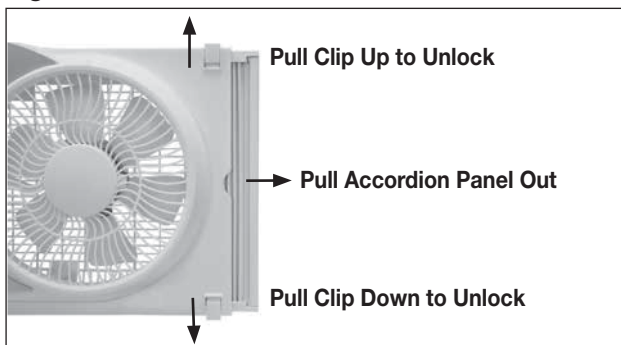

## TWO REMOVABLE COVERS

**Removable Fabric Cover:** This fan has a unique fabric cover included that helps keep out hot air, humidity and bugs when the fan is not in use. Simply attach loops of cover to the hooks around the fan openings (See Fig. 4). This cover can be used on the inside surface while the fan is installed in your window for intake or exhaust. Please be sure to remove cover before you use the fan. Do not run the fan with cover on, damage can result.

**Fig. 4**



**Bug Screen attaches to back of fan:** Simply attach loops of cover to the hooks around the fan openings (See Fig. 5).

**Fig. 5**

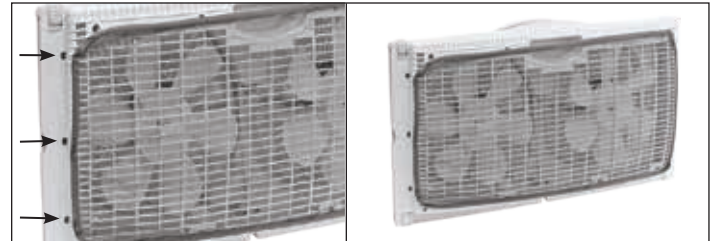

## USAGE

**Fan Operation:** Always operate the fan in the upright position following all instructions and recommendations listed in this manual.

**Fan Location:** Place the fan in the area of the room that will provide proper fan cooling. This fan can be placed in a window to provide additional FRESH air from outside. In this location, the fan can also be used to push inside air to the outside using the EXHAUST position.

**Fan Connection:** Plug fan directly into 120 volt A.C., 60 Hz wall outlet. Be sure plug fits tightly in outlet. A loose connection may cause overheating and damage to the plug or fan.

**Note:** To prevent overloading a circuit, do not plug the fan into a circuit that is servicing other electrical needs.

## FAN OPERATION CONTROLS

This fan comes with the commands of the control/functions panels and remote control expressed in two ways: WORDS (Fig. 6) or SYMBOLS (Fig. 7).

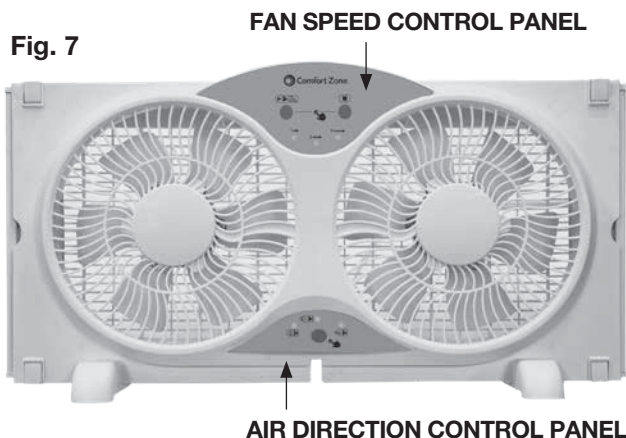

### Turning Fan On and Off: (See Fig. 8)

To start the fan, press  the «ON/SPEED» button repeatedly for the speed settings: 1 – LOW, 2 – MEDIUM, 3 – HIGH.

To stop the fan, press  the «OFF» button.

**Fig. 8 FAN SPEED CONTROL PANEL**

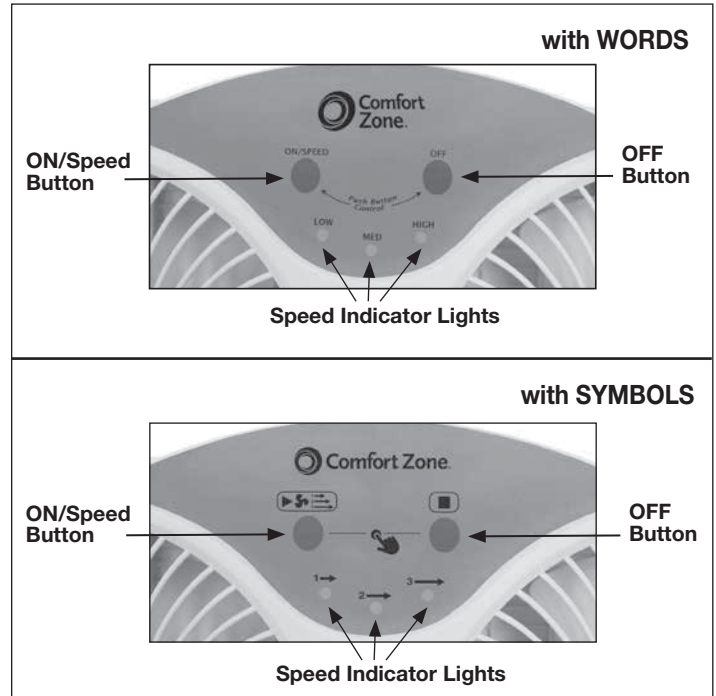

**Fan Functions:** (See Fig. 9). This fan has three functions for maximum comfort. To switch between functions, press function control button repeatedly.

 **COOL** - Brings fresh air in.

 **EXHAUST** - Removes stale air from room.

 **CIRCULATE** - Operates fans in opposing directions creating air circulation and room ventilation.

**Fig. 9 AIR DIRECTION CONTROL PANEL**

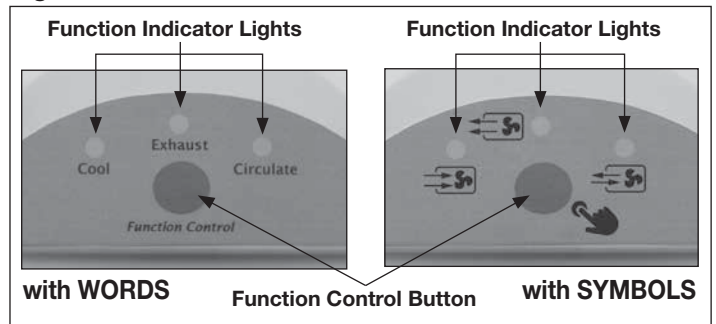



## Fan Push Buttons and Indicator Lights

If you have the fan with comands in words, see the column «**Word**» in the table below. If you have the fan with comands in symbols, see the column «**Symbol**».

Symbol	Word	Description of Function
	<b>ON/SPEED</b> button	ON switch with speed settings: 1-Low, 2-Med, 3-High
	<b>OFF</b> button	Shuts fan off
<b>1</b> →	<b>LOW</b> indicator light	Fan speed is on LOW
<b>2</b> →	<b>MEDIUM</b> indicator light	Fan speed is on MEDIUM
<b>3</b> →	<b>HIGH</b> indicator light	Fan speed is on HIGH
	<b>COOL</b> indicator light	Brings fresh air in
	<b>EXHAUST</b> indicator light	Removes stale air from the room
	<b>CIRCULATE</b> indicator light	Operates fans in opposing directions for air circulation and room ventilation

## FULL FUNCTION REMOTE CONTROL

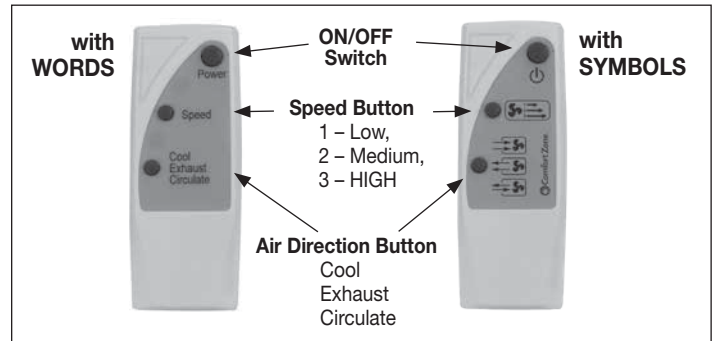

Place 2 «AAA» size batteries in the remote control (Batteries are not included). Point the remote control towards the control panel for the sensor to receive a signal. Use the buttons on the remote as you would with the control panel.

**WARNING:** Do not mix old and new batteries. Do not mix standard (Carbon-Zinc), alkaline, or rechargeable (Ni-Cd, Ni-MH, etc.) batteries. Used batteries should be disposed through local recycling centers.

If you have the fan with comands in words, see the column «**Word**» in the table below. If you have the fan with comands in symbols, see the column «**Symbol**».

## Remote Control Push Buttons

Symbol	Word	Description of Function
	<b>POWER</b> button	Turns fan ON/OFF
	<b>SPEED</b> button	Speed settings: 1-Low, 2-Med, 3-High Works in the same way as a push button on the fan. Pushing the button repeatedly changes the fan speed.
	<b>COOL</b>	Works in the same way as a push button on the fan. Pushing the button repeatedly changes the air direction.
	<b>EXHAUST</b>	
	<b>CIRCULATE</b>	

## CARE AND MAINTENANCE:

**Cleaning:** CAUTION-Before cleaning the fan be sure to disconnect power cord from the plug. Clean the grille surface with a clean damp cloth. Do not use harsh chemical or abrasive cleaners. DO NOT IMMERSE THE FAN OR ANY WIRES IN WATER. Allow fan to dry completely before use. Periodic grille cleaning with a vacuum will prevent dust build up. The motor is sealed and does not require any interior maintenance, cleaning or lubrication.

**Maintenance:** The Internal motor bearings are permanently lubricated at the factory and do not require any additional lubrication.

**Repair:** DO NOT OPERATE THE FAN WITHOUT THE GRILLE IN PLACE. DO NOT USE THE FAN IF IT HAS MALFUNCTIONED OR BECOME DAMAGED IN ANY WAY.

**Storage:** Keep original carton for storage of the fan. Coil and tie the power cord to avoid damage during storage.

**Note:** Some models come with a plug where you can replace a fuse. If your model has this, please read and follow the below instructions to replace the fuse.

This product employs overload protection (fuse). A blown fuse indicates an overload or short-circuit situation. If the fuse blows, unplug the product from the outlet. Replace the fuse as per the user servicing instructions (follow product marking for proper fuse rating) and check the product. If the replacement fuse blows, a short-circuit may be present and the product should be discarded or returned to an authorized service facility for examination and/or repair.

### Fuse Replacement:

1. Grasp plug and remove from the receptacle or other outlet device. Do not unplug by pulling on cord.
2. Open fuse cover by sliding open fuse access cover on top of attachment plug towards blades. See Fig. 2
3. Remove fuse carefully. Use a small tool to pry the end of the fuse from holder cavity. Be careful not to break glass window.
4. Replace fuse.  
**WARNING:** Risk of fire. Replace fuse only with identical 2.5 or 5.0 Amp, 125 Volt fuse (3.6mm x 10mm). Be sure fuse is properly seated within its cavity.
5. Close fuse cover by sliding it back to its original closed position.

Fig 1



Fig 2



Fig 3



## LIMITED WARRANTY

This unit is guaranteed to the original retail purchaser against defects in quality or workmanship for a period of one year from the date of original purchase. If this unit fails because of a manufacturing defect within 30 days of purchase, return the unit, with your receipt, to the retailer. After 30 days, but within the warranty period, if the unit was purchased within the continental United States, return it, freight prepaid, to World and Main for repair or replacement. If the unit was purchased outside the continental United States, return the unit to the place of purchase. This warranty does not cover damage caused by misuse, abuse, overheating or alteration. Repairs made by anyone other than World and Main are not covered in this warranty. World and Main will not be held liable for any losses due to neglectful operation. All implied warranties, including the warranties of merchantability and of fitness of purpose, if applicable, are hereby limited in duration to the period of one year from the date of original retail purchase. Some states do not allow limitations on how long an implied warranty lasts, so the above limitations may not apply to you. Incidental or consequential damages arising from a breach of either express or implied warranties are hereby disclaimed and excluded. Some states do not allow the exclusion of limitation of incidental or consequential damages, so this limitation or exclusion may not apply to you. Upon the expiration of this warranty all such liability will terminate. No other warranties are expressed or implied.

This warranty gives you specific legal rights, and you may also have other rights which vary from state to state. No informal dispute settlement mechanisms are available. This limited warranty is given in lieu of all other warranties.

Manufactured for:  
World and Main (Cranbury), LLC  
324A Half Acre Rd.  
Cranbury, NJ 08512 USA  
800-221-6895  
www.comfortzoneproducts.com

Rev. 10/05/21