

ITEM #2742219  
2742222  
2742220  
2742221

# SD44 LED CEILING FAN

MODEL #SD44BNK5LS  
SD44LW5LS  
SD44MBK5LS  
SD44NWZ5LS

**Español p. 20**

**ATTACH YOUR RECEIPT HERE  
ADJUNTE SU RECIBO AQUÍ**

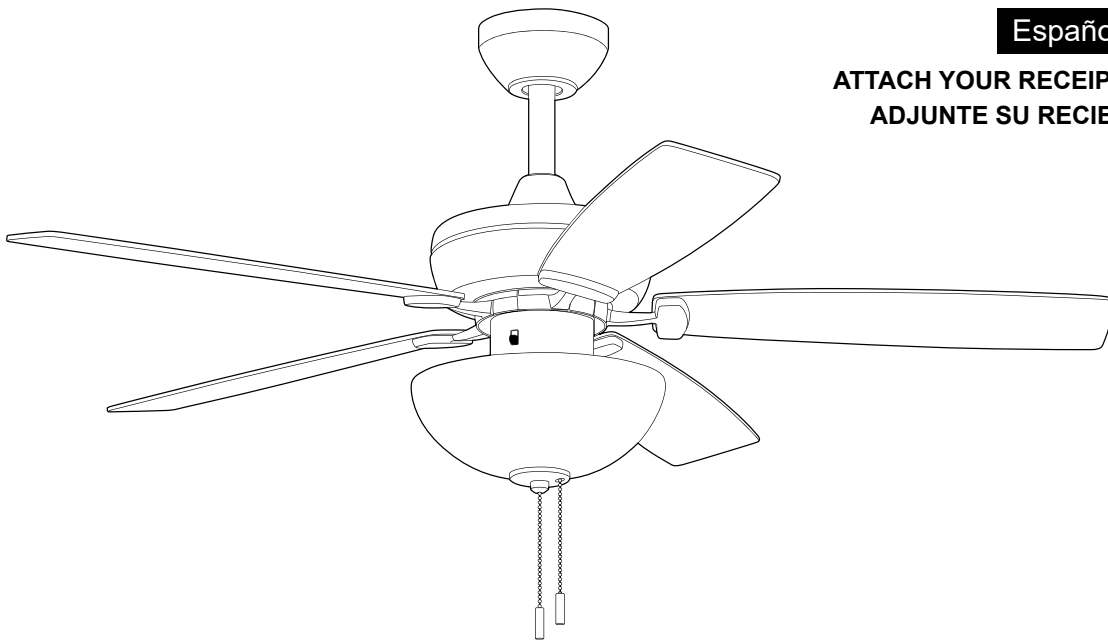

Purchase Date \_\_\_\_\_



**Questions, problems, missing parts?** Before returning to your retailer, call our customer service department at **1-800-527-1292**, 8:30 a.m. - 5 p.m., CST, Monday - Friday.

## TABLE OF CONTENTS

---

Safety Information .....	2
Package Contents .....	5
Hardware Contents .....	6
Preparation .....	6
Initial Installation .....	6
Downrod-Style Fan Mounting .....	8
Closemount-Style Fan Mounting .....	10
Wiring .....	11
Final Installation .....	13
Operating Instructions .....	16
Care and Maintenance .....	18
Troubleshooting .....	18
Limited Lifetime Warranty .....	19
Replacement Parts List .....	19



## SAFETY INFORMATION

---

Modifications not approved by the party responsible for compliance could void the user's authority to operate the equipment.

\*NOTE: This equipment has been tested and found to comply with the limits for a Class B digital device, pursuant to Part 15 of the FCC Rules. These limits are designed to provide reasonable protection against harmful interference in a residential installation. This equipment generates, uses and can radiate radio frequency energy and, if not installed and used in accordance with the instructions, may cause harmful interference to radio communications. However, there is no guarantee that interference will not occur in a particular installation. If this equipment does cause harmful interference to radio or television reception, which can be determined by turning the equipment off and on, the user is encouraged to try to correct the interference by one or more of the following measures:

- \* Reorient or relocate the receiving antenna.
- \* Increase the separation between the equipment and receiver.
- \* Connect the equipment into an outlet on a circuit different from that to which the receiver is connected.

Consult the dealer or an experienced radio/TV technician for help.

Distributed by: Litex Industries Inc., P.O. Box 535639, Grand Prairie, TX, 75053; 1-800-527-1292

The device complies with Part 15 of the FCC Rules. Operation is subject to the following two conditions: (1) this device may not cause harmful interference, (2) this device must accept any interference received, including interference that may cause undesired operation.

**NOTE:** Dimmable to 10%.

## SAFETY INFORMATION

### READ AND SAVE THESE INSTRUCTIONS

Please read and understand this entire manual before attempting to assemble, install or operate the product.

- Do not discard fan carton or foam inserts. Should this fan need to be returned to the factory for repairs, it must be shipped in its original packaging to ensure proper protection against damage that might exceed the initial cause for return.
- Make sure all electrical connections comply with local codes, ordinances, the National Electrical Code and ANSI/NFPA 70-1999. Hire a qualified electrician or consult a do-it-yourself wiring handbook if you are unfamiliar with installing electrical wiring.
- Make sure the installation site you choose allows a minimum clearance of 7 ft. from the blades to the floor and at least 30 in. from the end of the blades to any obstruction.
- After you install the fan, make sure all connections are secure to prevent the fan from falling.
- The net weight of this fan including the light kit is: 16.28 lbs.

## DANGER

When using an existing outlet box, make sure the outlet box is securely attached to the building structure and can support the full weight of the fan. Failure to do this can result in serious injury or death. The stability of the outlet box is essential in minimizing wobble and noise in the fan after installation is complete.

To reduce the risk of serious bodily injury, DO NOT use power tools to assemble any part of the fan, including the blades.

## WARNING



To reduce the risk of fire, electrical shock or personal injury, mount fan to outlet box marked "ACCEPTABLE FOR FAN SUPPORT OF 35 LBS. OR LESS" and use mounting screws provided with the outlet box. Most outlet boxes commonly used for the support of lighting fixtures are not acceptable for fan support and may need to be replaced. Consult a qualified electrician if in doubt.

When mounting fan to a ceiling outlet box, use a METAL octagonal outlet box; do NOT use a plastic outlet box. Secure the outlet box directly to the building structure. The outlet box and its support must be able to support the moving weight of the fan (at least 35 lbs.).

To avoid personal injury, the use of gloves may be necessary while handling fan parts with sharp edges.

To reduce the risk of fire, electrical shock or personal injury, wire connectors provided with this fan are designed to accept only one 12-gauge house wire and two lead wires from the fan. If your house wire is larger than 12-gauge or there is more than one house wire to connect to the corresponding fan lead wires, consult an electrician for the proper size wire connectors to use.



## SAFETY INFORMATION

### WARNING

To reduce the risk of fire or electrical shock, do not use the fan with any solid state speed control device or control fan speed with a full range dimmer switch.

To reduce the risk of fire, electrical shock or personal injury, do not bend the blade arms when installing them, balancing the blades or cleaning the fan. Do not insert objects between the rotating fan blades.

To reduce the risk of personal injury, use *only* parts provided with this fan. The use of parts *OTHER* than those provided with this fan will void the warranty.

Before proceeding, be sure to shut off electricity at main switch or circuit breaker in order to avoid electrical shock.

**The DC Motor will not operate until blades are installed.**

### CAUTION

Read all instructions and safety information before installing your new fan. Review the accompanying assembly diagrams.

Be sure outlet box is properly grounded and that a ground wire (green or bare) is present.

Once installation is complete, carefully check all screws, bolts and nuts on fan motor assembly to ensure that they are secured.

Do NOT tamper with or attempt to repair LED component. The light source is designed for this specific application and should not be serviced by untrained personnel. If any servicing is required, call our customer service department.

## PACKAGE CONTENTS

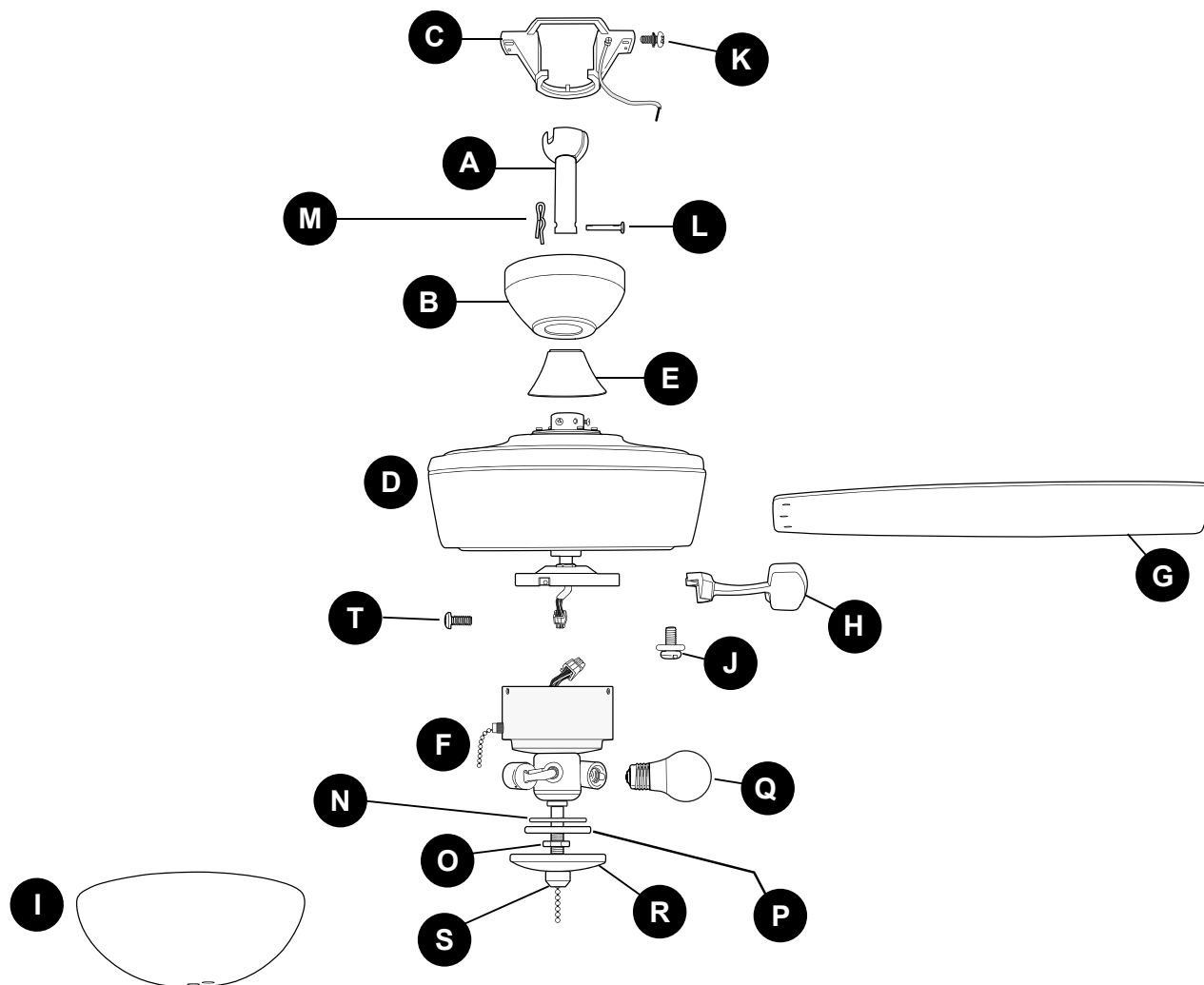

PART	DESCRIPTION	QUANTITY
A	Downrod	1
B	Canopy	1
C	Mounting Bracket	1
D	Motor Housing	1
E	Yoke Cover	1
F	Light Kit Fitter	1
G	Blade	5
H	Blade Arm	5
I	Shade	1
J	Motor Screw/Lock Washer (preassembled)	10 + 1 extra

PART	DESCRIPTION	QUANTITY
K	Canopy Mounting Screw /Lock Washer (preassembled)	4
L	Pin (preassembled)	1
M	Clip (preassembled)	1
N	Rubber Washer (preassembled)	1
O	Hex Nut (preassembled)	1
P	Flat Washer (preassembled)	1
Q	Bulb	2
R	Finial Plate (preassembled)	1
S	Finial (preassembled)	1
T	Switch Housing Screw (preassembled)	3

**⚠ IMPORTANT REMINDER:** You must use the parts provided with this fan for proper installation and safety.

## HARDWARE CONTENTS (shown actual size)

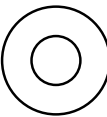
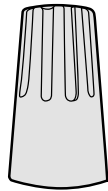
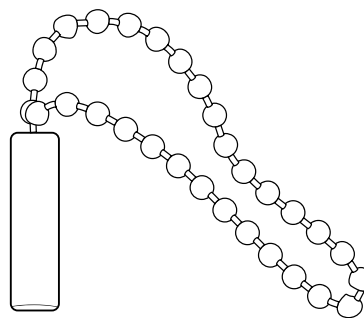
AA	BB	CC	DD
			
Blade Screw	Fiber Blade Washer	Wire Connector	Pull Chain Extension
Qty. 15 + 1 extra	Qty. 15 + 1 extra	Qty. 4	Qty. 2

## PREPARATION

Before beginning assembly of product, make sure all parts are present. Place motor on carpet or on foam to avoid damage to finish. Compare parts with package contents list and hardware contents list. If any part is missing or damaged, do not attempt to assemble the product.

### Estimated Assembly Time: 120 minutes

Tools Required for Assembly (not included): Electrical Tape, Phillips Screwdriver, Pliers, Safety Glasses, Stepladder and Wire Strippers

Helpful Tools (not included): AC Tester Light, Tape Measure, Do-It-Yourself Wiring Handbook and Wire Cutters

## INITIAL INSTALLATION

1. Turn off circuit breakers and wall switch to the fan supply line leads.

**⚠ DANGER:** Failure to disconnect power supply prior to installation may result in serious injury or death.

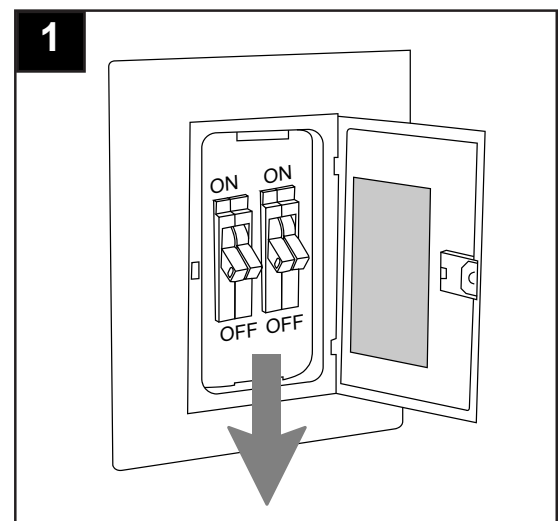

## INITIAL INSTALLATION

- Determine mounting method to use.
  - Downrod mount (standard or angled ceiling)
  - Closemount (standard ceiling only)**IMPORTANT:** If using the angle mount, check to make sure the ceiling angle is not steeper than 19°.

**\*Helpful Hint:** Downrod-style mounting is best suited for ceilings 8 ft. or higher. For taller ceilings you may want to use a longer downrod (not included). Angle-style mounting is best suited for angled or vaulted ceilings. A longer downrod is sometimes necessary to ensure proper blade clearance. Closemount mounting is more suitable for ceilings lower than 8 ft. high.

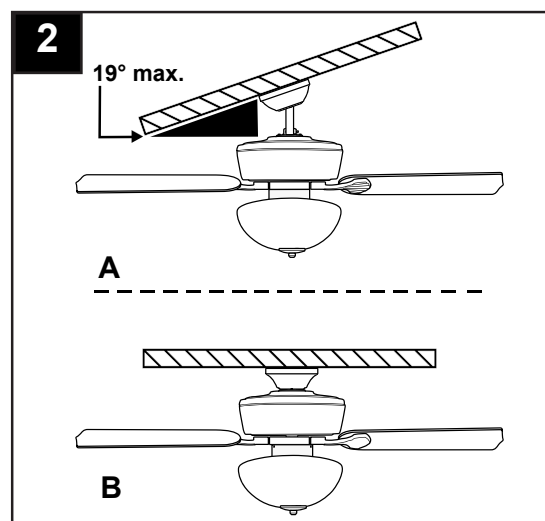

- Check to make sure blades (G) will be at least 30 in. from any obstruction and at least 7 ft. above the floor.

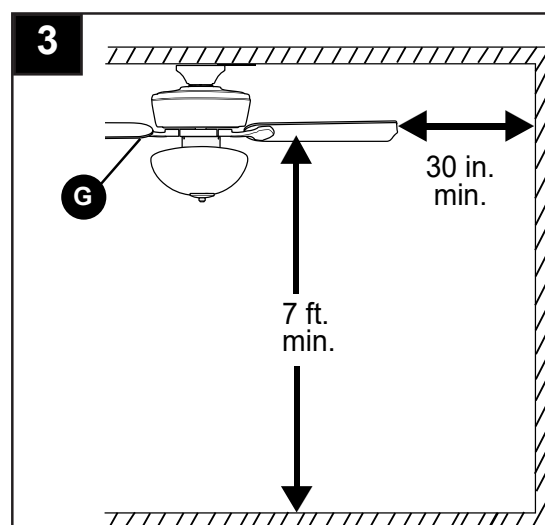

- Secure mounting bracket (C) to outlet box (not included) using screws, spring washers and flat washers provided with the outlet box.

**\*NOTE:** It is very important you use the proper hardware when installing the mounting bracket (C) as this will support the fan.

**IMPORTANT:** If using the angle mount, make sure open end of mounting bracket (C) is installed facing the higher point of the ceiling, and ensure the ceiling angle is not steeper than 19°.

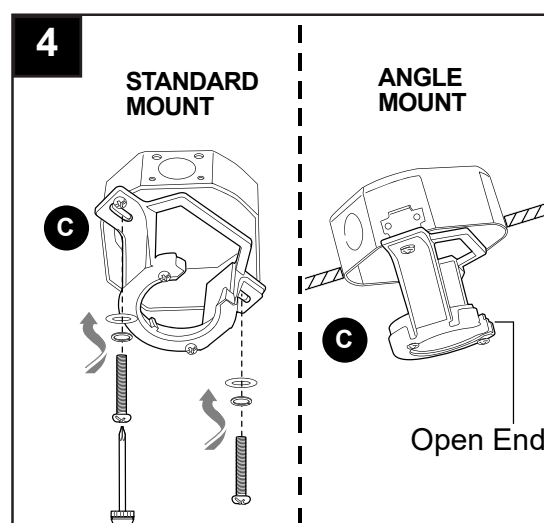

## INITIAL INSTALLATION

5. Remove motor screws/lock washers (J) and from underside of motor housing (D). [If there are plastic motor blocks installed with the motor screws/lock washers (J), discard the plastic motor blocks.]

For **DOWNROD-STYLE FAN MOUNTING**, proceed to step 1 below.

For **CLOSEMOUNT-STYLE FAN MOUNTING**, skip to page 10.

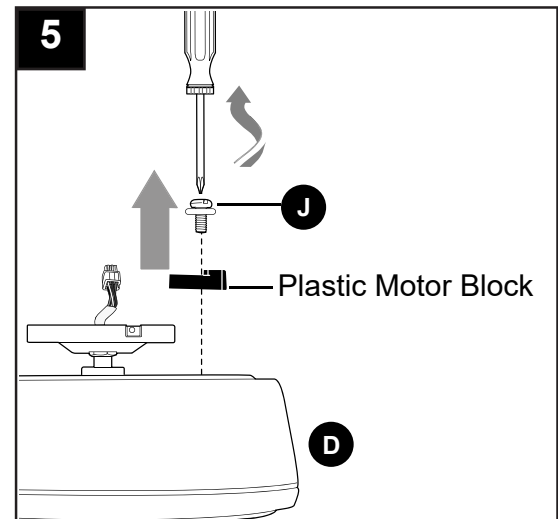

## DOWNROD-STYLE FAN MOUNTING

- 1a. Remove pin (L) and clip (M) from downrod (A).
- 1b. Partially loosen preassembled set screws and nuts in yoke at top of motor housing (D).

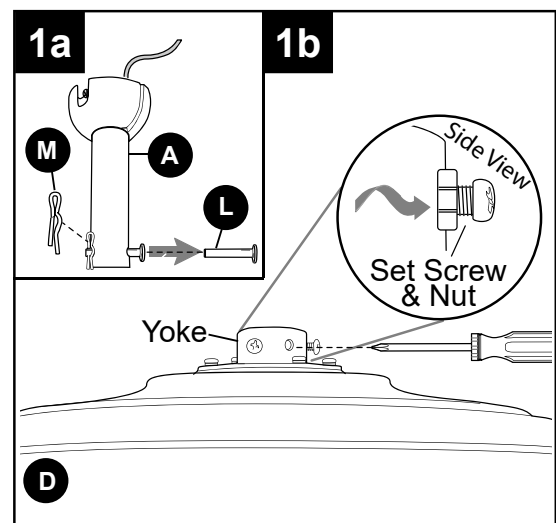

2. Insert downrod (A) through canopy (B) and yoke cover (E). Thread wires from motor housing (D) up through downrod (A).

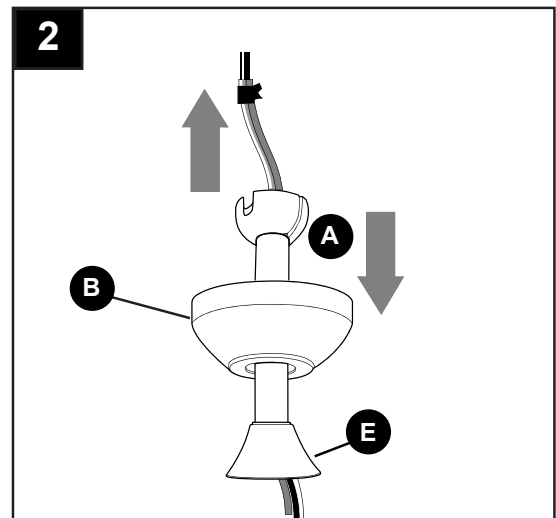



## DOWNROD-STYLE FAN MOUNTING

3. Slip downrod (A) into yoke, align holes and re-install pin (L) and clip (M). Tighten downrod (A) set screws and then tighten nuts. Slide yoke cover (E) down until it rests on top of motor housing (D).

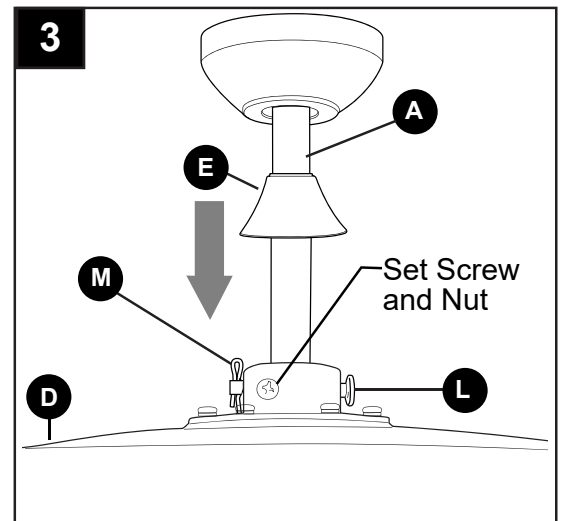

4. Depending on the length of downrod you use, you may need to cut the lead wires back to simplify the wiring. If you decide to cut back the lead wires, it is suggested you do so in the following manner:

Take the lead wires and make sure you have pulled them all the way through the top of the downrod. Start at the TOP of the hanging ball on the downrod and measure 8 in. of lead wire, and then cut the excess wire off with wire cutters (not included).

**NOTE:** If you do *not* cut back the lead wires, **Steps 4 and 5 are not necessary and you may proceed to Step 6 instead.**

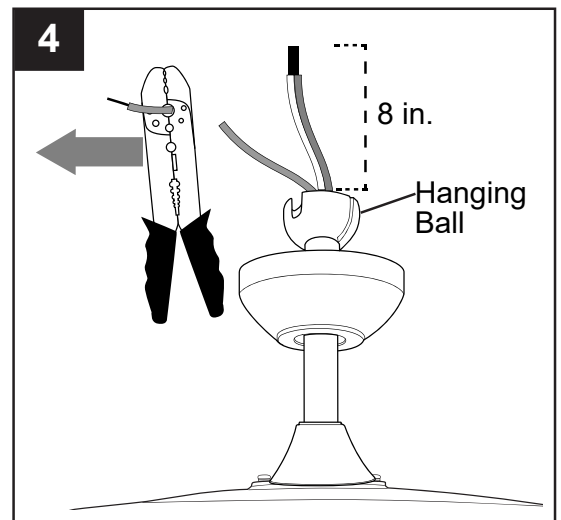

5. If you cut back the lead wires in Step 4, strip 3/4 in. of insulation from end of each wire -- white, black, green and blue (if applicable). Twist stripped ends of each strand of wire within the insulation with pliers (not included).

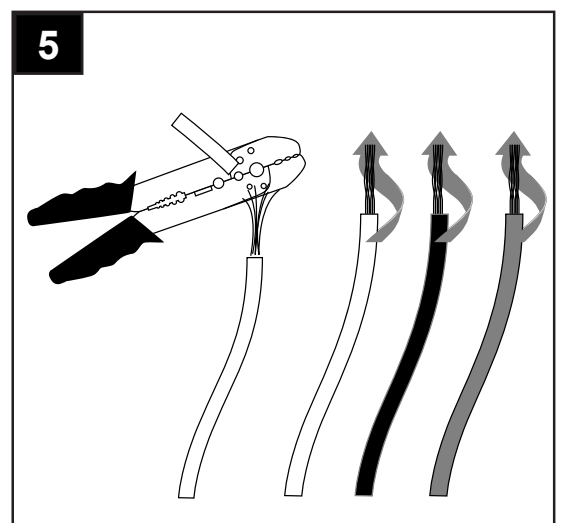

## DOWNROD-STYLE FAN MOUNTING

6. Install hanging ball of downrod (A) into opening of mounting bracket (C). Align the slot in hanging ball with the tab in mounting bracket (C).

**⚠ DANGER:** Failure to align slot in hanging ball with the tab in mounting bracket (C) may result in serious injury or death.

Continue to **WIRING** on page 11.

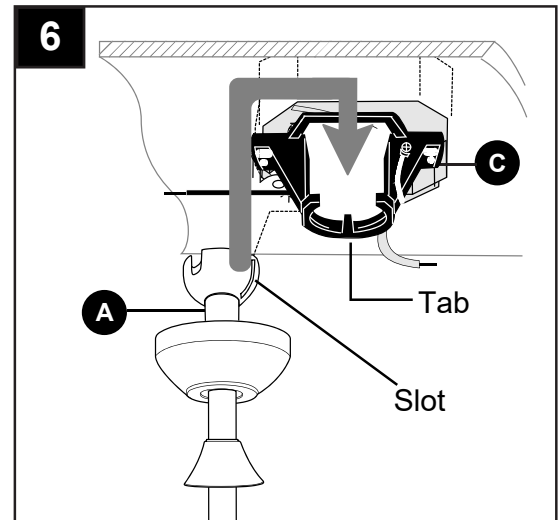

## CLOSEMOUNT-STYLE FAN MOUNTING

1. Remove preassembled canopy cover from bottom of canopy (B). **NOTE:** To remove canopy cover from canopy (B), twist canopy cover until the two small protrusions on the inner lip of the canopy cover align with the two notches on the bottom of the canopy (B). Pull on canopy cover to remove.

**NOTE:** The downrod (A), yoke cover (E) and canopy cover are not used in this type of installation.

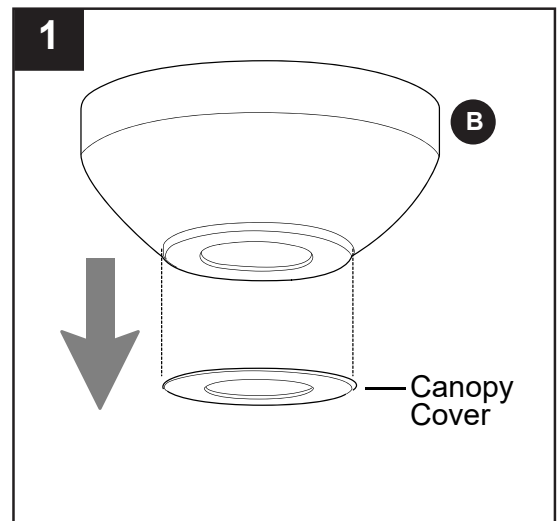

2. Remove every other preassembled screw and lock washer from top of motor housing (D).

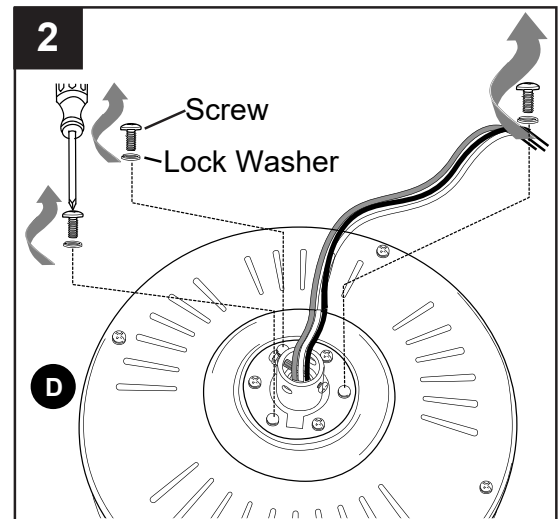

## CLOSEMOUNT-STYLE FAN MOUNTING

3. Pull wires up through hole in the middle of the canopy (B) and attach canopy (B) to motor housing (D) using the three previously removed screws and lock washers.

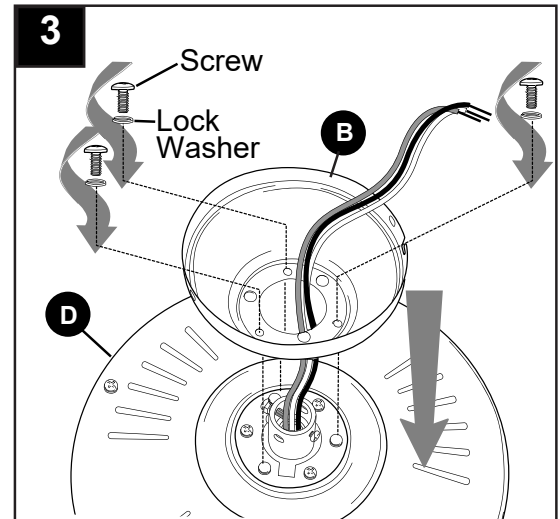

4. Temporarily hang fan on the tab on the mounting bracket (C) using one of the *non-slotted* holes in the canopy (B).

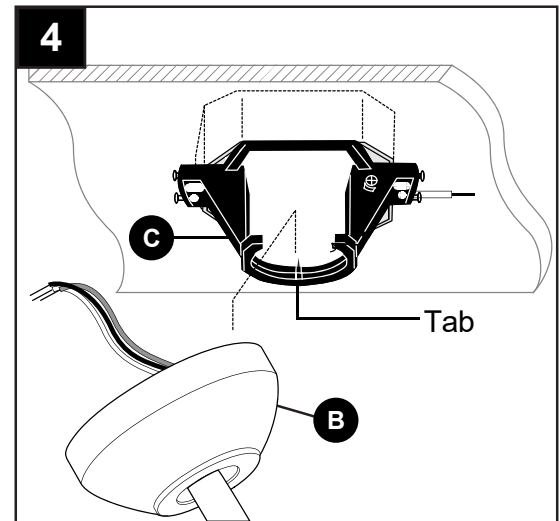

## WIRING

**⚠ WARNING:** To reduce the risk of fire, electrical shock or personal injury, wire connectors provided with this fan are designed to accept only one 12-gauge house wire and two lead wires from the fan. If your house wire is larger than 12-gauge or there is more than one house wire to connect to the corresponding fan lead wires, consult an electrician for the proper size wire connectors to use.

**⚠ CAUTION:** Be sure outlet box is properly grounded and that a ground (green or bare) wire is present.

**⚠ WARNING:** If house wires are different colors than referred to in the following steps, stop immediately. A professional electrician is recommended to determine wiring.

**⚠ WARNING:** Using a full range dimmer switch (not included) to control fan speed will cause a loud humming noise from fan. To reduce the risk of fire or electrical shock, do NOT use a full range dimmer switch to control fan speed.

**NOTE:** This fan is remote control adaptable with DC remote control ONLY (remote control not included). Please refer to instructions provided with the remote control before proceeding with these wiring instructions.

## WIRING

1. Choose wiring diagram (Fig. 1a, Fig. 1b or Fig. 1c) that fits your situation and make appropriate wiring connections as follows: [**IMPORTANT:** Use one of the wire connectors (CC) to make each wire connection, making sure to screw wire connector (CC) on in a clockwise direction.]

**1a. FAN AND LIGHT CONTROLLED BY PULL CHAINS:** Connect BLACK and BLUE wire from fan to BLACK wire from ceiling. Connect WHITE wire from fan to WHITE wire from ceiling. Connect GREEN wire from fan (on downrod (A) and mounting bracket (C)) to BARE/GREEN wire from ceiling.

**1b. FAN CONTROLLED BY PULL CHAIN, LIGHT BY WALL SWITCH:** Connect BLACK wire from fan to BLACK wire from ceiling. Connect BLUE wire from fan to the BLACK wire from the independent wall switch for the light. Connect WHITE wire from fan to WHITE wire from ceiling. Connect GROUND (GREEN) wires from fan (on downrod (A), if applicable, and mounting bracket (C)) to BARE/GREEN wire from ceiling.

**1c. FAN AND LIGHT CONTROLLED BY TWO WALL SWITCHES:** Connect BLACK wire from fan to BLACK wire from the independent wall switch for the fan. Connect BLUE wire from fan to the BLACK wire from the other independent wall switch for the light. Connect WHITE wire from fan to WHITE wire from ceiling. Connect GROUND (GREEN) wires from fan (on downrod (A), if applicable, and mounting bracket (C)) to BARE/GREEN wire from ceiling.

**NOTE:** BLACK wire is hot power for fan. BLUE wire is hot power for light kit. WHITE wire is common for fan and light kit. GREEN or BARE wire is ground.

FAN AND LIGHT CONTROLLED BY PULL CHAINS

**1a**

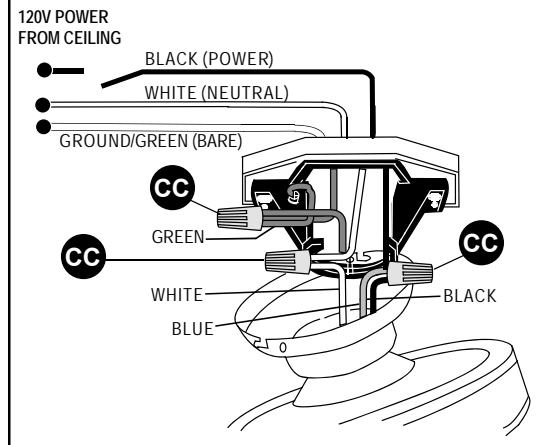

FAN CONTROLLED BY PULL CHAIN, LIGHT BY WALL SWITCH

**1b**

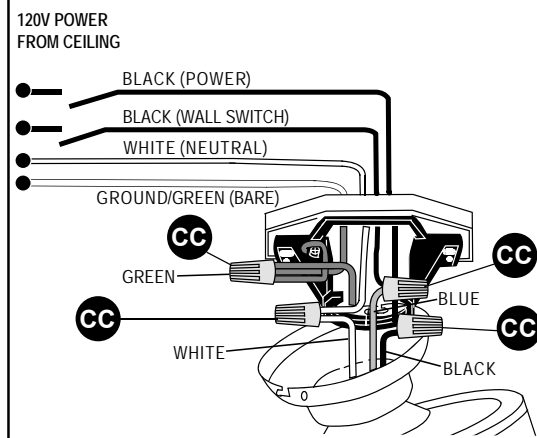

FAN AND LIGHT CONTROLLED BY TWO WALL SWITCHES

**1c**

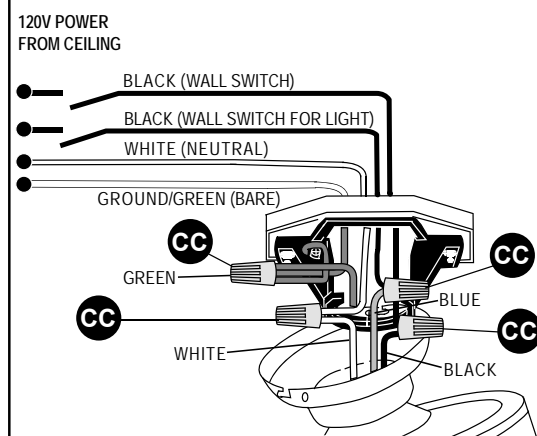

## WIRING

2. Wrap electrical tape (not included) around each individual wire connector (CC) down to the wire.

**⚠ WARNING:** Make sure no bare wire or wire strands are visible after making connections. Place GREEN and WHITE wire connections on the opposite side of the outlet box from the BLACK and BLUE wire connections.

Turn spliced/taped wires upward and gently push wires and wire connectors (CC) into outlet box.

### Hardware Used



Wire Connector

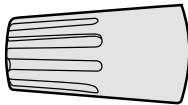

x 4

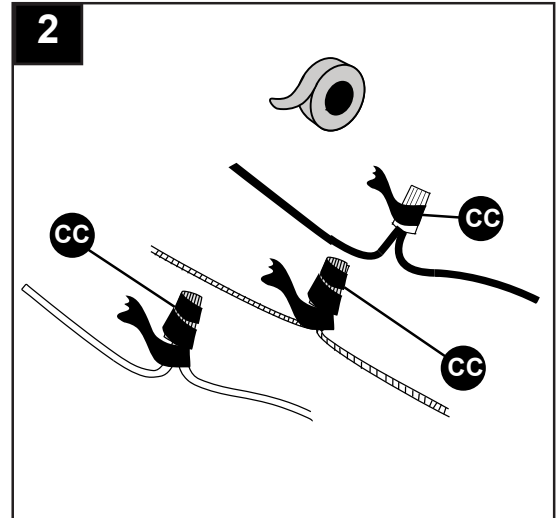

## FINAL INSTALLATION

1. Temporarily lift canopy (B) to mounting bracket (C) to determine which two canopy mounting screws/lock washers (K) in mounting bracket (C) align with slotted holes in canopy (B) and partially loosen these two canopy mounting screws/lock washers (K). Remove the other two canopy mounting screws/lock washers (K). Now, lift canopy (B) to mounting bracket (C) again, aligning slotted holes in canopy (B) with loosened canopy mounting screws/lock washers (K) in mounting bracket (C). Twist canopy (B) clockwise to lock. Re-insert the two canopy mounting screws/lock washers (K) that were just removed and tighten all canopy mounting screws/lock washers (K) securely.

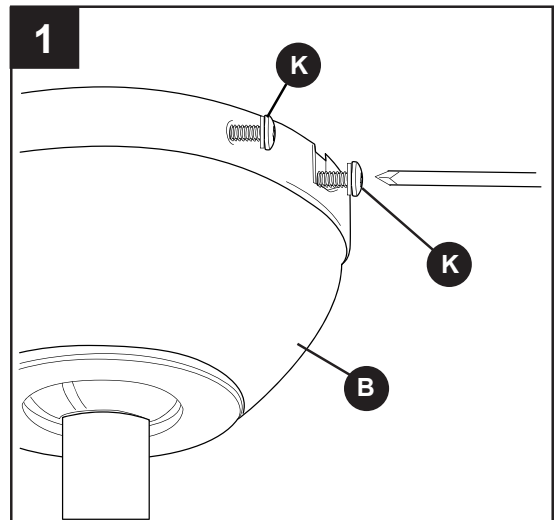

## FINAL INSTALLATION

2. **⚠ DANGER:** To reduce the risk of serious bodily injury, DO NOT use power tools to assemble the blades (G). If overtightened, blades (G) may crack and break.

Partially insert three blade screws (AA) along with three fiber blade washers (BB) into holes in blade (G) to attach blade arm (H) to blade (G). Then, tighten each blade screw (AA) starting with the one in the middle.

Repeat Step 2 for remaining blades (G) and blade arms (H).

### Hardware Used

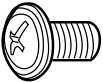
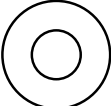
<b>AA</b>	Blade Screw		x 15
<b>BB</b>	Fiber Blade Washer		x 15

3. Attach blade arms (H) to the bottom of motor housing (D) with motor screws/lock washers (J) previously removed (Step 5, page 8). Tighten motor screws/lock washers (J) securely.

**NOTE:** Make sure to completely secure each blade arm (H) before proceeding to the next.

4. Remove the three switch housing screws (T) from preassembled switch housing plate on motor housing (D). Connect female plug from switch housing at top of light kit fitter (F) to male plug from motor housing (D), matching up the colors on the female plug with the colors on the male plug for correct fit. Make sure plugs are connected completely.

Align holes in switch housing with holes in switch housing plate and secure light kit fitter (F) with three switch housing screws (T) previously removed. Tighten all three switch housing screws (T) securely.

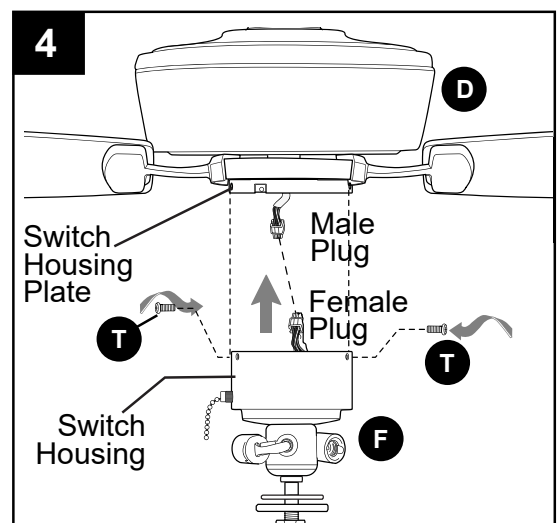
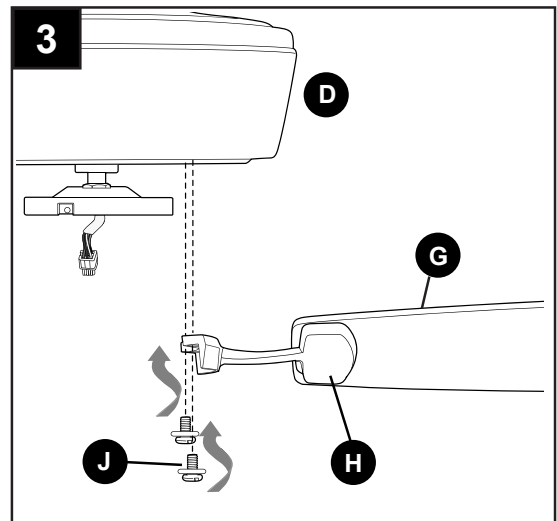
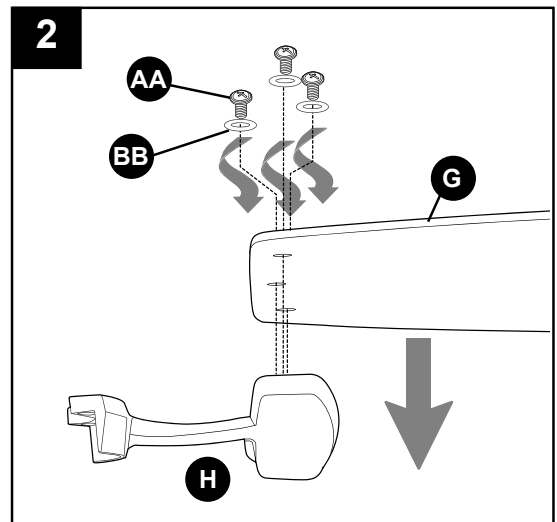

## FINAL INSTALLATION

5. Remove finial (S), finial plate (R), hex nut (O), flat washer (P) and rubber washer (N) from the threaded rod at the bottom of the light kit fitter (F). Save for later use.

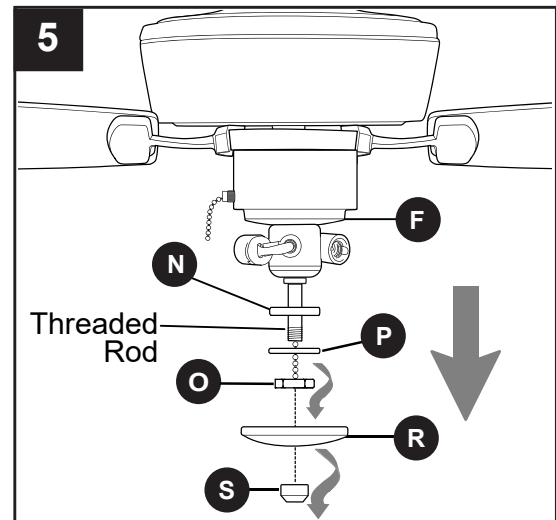

6. Install bulbs (Q).

**⚠ CAUTION:** When replacing bulb(s), allow bulb(s) and shade (I) to cool down before touching.

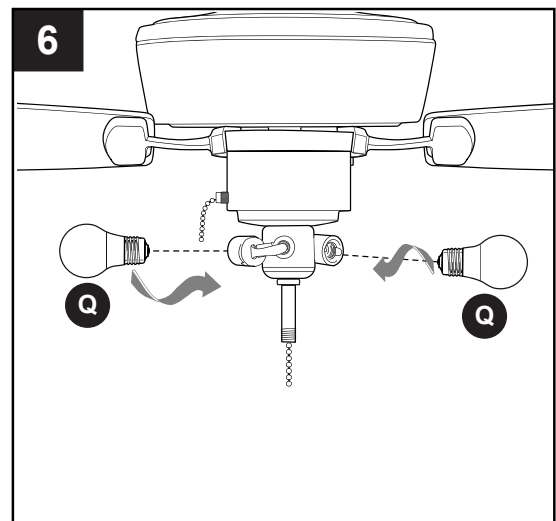

7. Place rubber washer (N) that was previously removed inside shade (I) over center hole. Align hole in center of shade (I) with threaded rod on light kit fitter (F), allowing pull chains to come through corresponding holes in shade (I). Push up gently on shade (I) until threaded rod comes through hole. (Be sure fan pull chain does not rub against bulbs during fan operation.)

Re-install flat washer (P) and secure shade (I) with hex nut (O). Align pull chains with holes in finial plate (R) and then re-attach finial (S).

**⚠ CAUTION:** Do NOT overtighten hex nut (O) or finial (S) as shade (I) may crack or break.

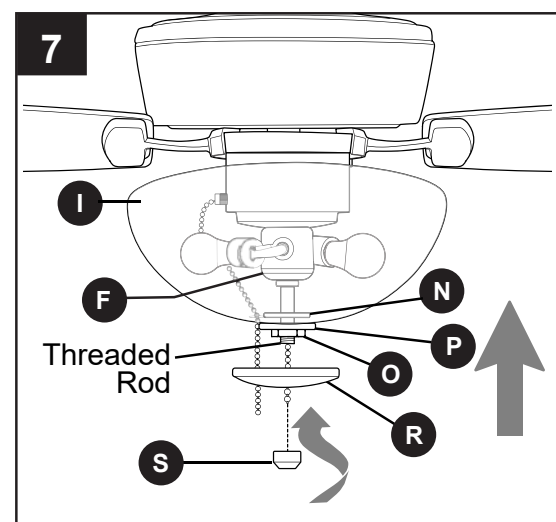

## FINAL INSTALLATION

8. Attach applicable pull chain extensions (DD) or custom pull chain extensions (not included) to the fan and light pull chains.

Assembly is now complete.

### Hardware Used

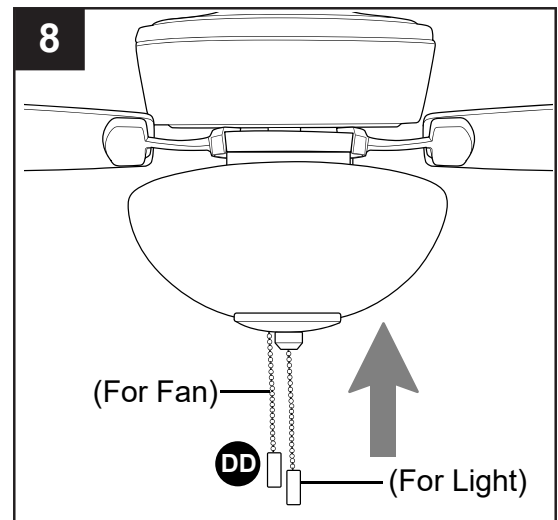
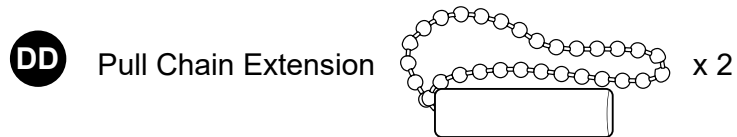

## OPERATING INSTRUCTIONS

1. The pull chain located on the switch housing at the top of the light kit fitter (F) has four positions to control fan speed. One pull is HIGH, two is MEDIUM, three is LOW and four turns the fan OFF.

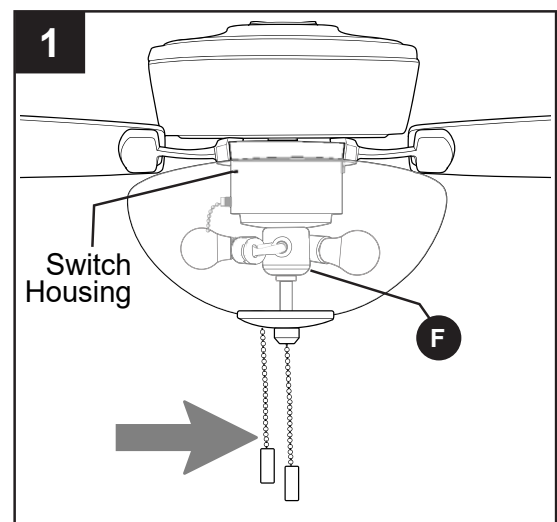

2. The pull chain located in the middle is used to turn the light ON or OFF.

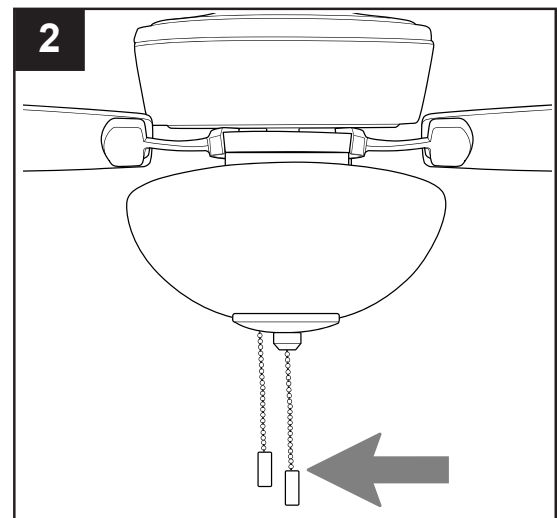



## OPERATING INSTRUCTIONS

3. Use the fan reverse switch, located on the switch housing, to optimize your fan for seasonal performance. A ceiling fan will allow you to raise your thermostat setting in summer and lower your thermostat setting in winter without feeling a difference in your comfort.

**NOTE:** Wait for fan to stop before moving the reverse switch.

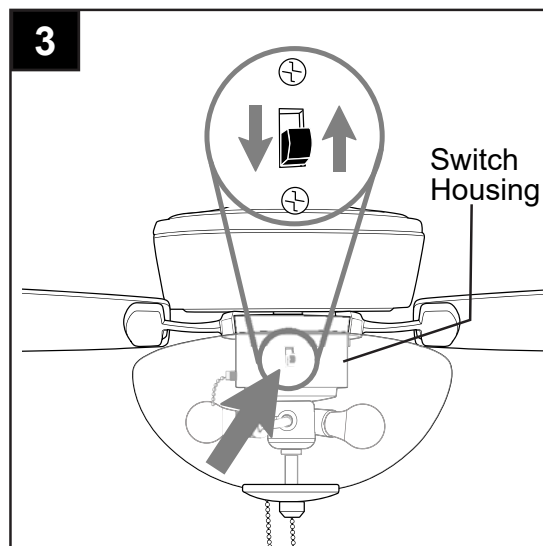

3a. In **warmer** weather, setting the reverse switch in the DOWN position will result in downward airflow creating a wind chill effect.

3b. In **cooler** weather, setting the reverse switch in the UP position will result in upward airflow that can help move stagnant, hot air off the ceiling area.

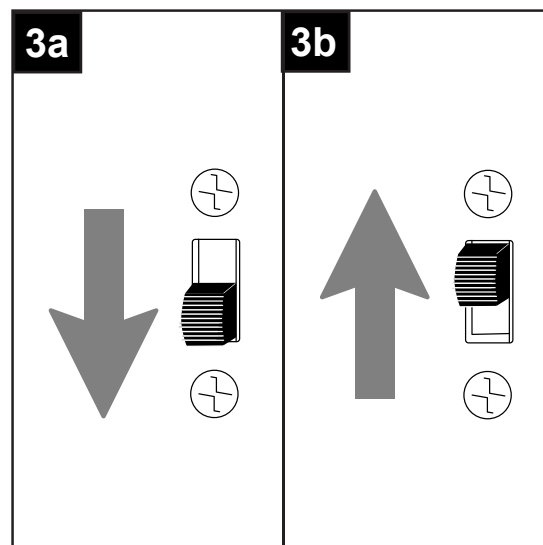

3c. **IMPORTANT:** Reverse switch must be set either **completely** UP or **completely** DOWN for fan to function. If the reverse switch is set in the middle position, fan will not operate.

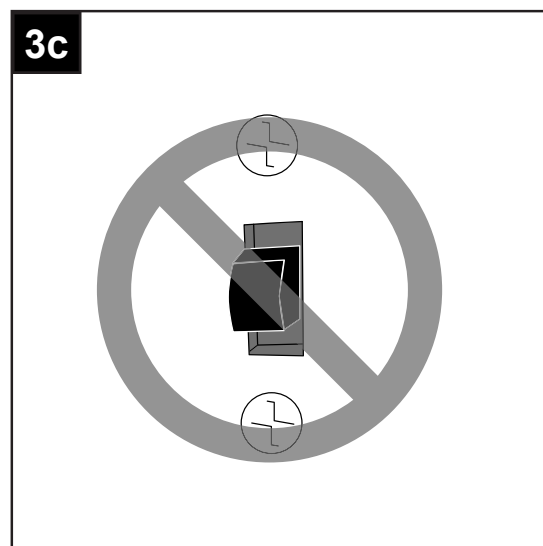

## CARE AND MAINTENANCE

At least twice each year, lower canopy (B) to check downrod (A) assembly, and then tighten all screws on fan. Clean motor housing (D) with only a soft brush or lint-free cloth to avoid scratching the finish. Clean blades (G) with a lint-free cloth. You may occasionally apply a light coat of furniture polish to wood blades for added protection.

**IMPORTANT:** Shut off main power supply before beginning any maintenance. Do not use water or a damp cloth to clean the ceiling fan.

**Bulb Replacement:** Use standard-base 8.5-watt LED bulbs or incandescent/CFL equivalent bulbs.

## TROUBLESHOOTING

**⚠ WARNING:** Before beginning work, shut off the power supply to avoid electrical shock.

PROBLEM	POSSIBLE CAUSE	CORRECTIVE ACTION
Fan does not move.	<ol style="list-style-type: none"><li>1. Reverse switch not engaged.</li><li>2. Power is off or fuse is blown.</li><li>3. Faulty wire connection.</li><li>4. Plugs not connected properly.</li></ol>	<ol style="list-style-type: none"><li>1. Push switch firmly either up or down.</li><li>2. Turn power on or check fuse.</li><li>3. Turn power off. Loosen canopy and check all connections.</li><li>4. Check that male and female plugs in light kit fitter are connected properly according to instructions on page 14.</li></ol>
Noisy operation.	<ol style="list-style-type: none"><li>1. Blades are loose.</li><li>2. Cracked blade.</li><li>3. Full range dimmer switch.</li><li>4. Fan is new.</li></ol>	<ol style="list-style-type: none"><li>1. Tighten all blade screws.</li><li>2. Replace blade.</li><li>3. Replace with an approved speed control device.</li><li>4. Allow fan a “break in” period of a few days, especially when running the fan at Medium and High speeds.</li></ol>
Excessive wobbling.	<ol style="list-style-type: none"><li>1. Blades are loose.</li><li>2. Blade arms incorrectly attached.</li><li>3. Unbalanced blades.</li><li>4. Fan not securely mounted.</li><li>5. Fan too close to vaulted ceiling.</li><li>6. Set screw(s) on motor housing yoke is (are) not tightened properly.</li><li>7. Set screw on hanging ball is not tightened properly.</li></ol>	<ol style="list-style-type: none"><li>1. Tighten all blade screws.</li><li>2. Re-install blade arms.</li><li>3. Switch one blade with a blade from the opposite side.</li><li>4. Turn power off. Carefully loosen canopy and verify that mounting bracket is secure.</li><li>5. Use a longer downrod or move fan to another location.</li><li>6. Tighten yoke set screw(s) securely.</li><li>7. Carefully loosen and lower canopy and verify that set screw on hanging ball is tightened securely.</li></ol>
Fan operates but light fails (if applicable).	<ol style="list-style-type: none"><li>1. Bulb(s) not installed correctly.</li><li>2. Wires in canopy not wired properly.</li><li>3. Wall switch to fan is off.</li></ol>	<ol style="list-style-type: none"><li>1. Re-install bulb(s).</li><li>2. Check wires in canopy and, if necessary, re-wire according to instructions on pages 11 - 13.</li><li>3. Make sure that wall switch to fan is on.</li></ol>

## TROUBLESHOOTING

PROBLEM (cont.)	POSSIBLE CAUSE	CORRECTIVE ACTION
[Fan operates but light fails.]	4. Wires in light kit fitter not wired correctly.	4. Check that male and female plugs in light kit fitter are connected properly according to instructions on page 14.

**NOTE:** A small amount of "wobble" is normal and should not be considered a defect.

## LIMITED LIFETIME WARRANTY

The distributor warrants this fan to be free from defects in workmanship and materials present at time of shipment from the factory for Lifetime limited from the date of purchase. This warranty applies only to the original purchaser. The distributor agrees to correct any defect at no charge or, at our option, replace the ceiling fan with a comparable or superior model.

To obtain warranty service, present a copy of your sales receipt as proof of purchase. All cost of removal and reinstallation are the express responsibility of the purchaser. Any damage to the ceiling fan by accident, misuse or improper installation, or by using parts not produced by the manufacturer of this fan or affixing accessories not produced by the manufacturer of this fan, are the purchaser's own responsibility. The distributor assumes no responsibility whatsoever for fan installation during the limited lifetime warranty. Any service performed by an unauthorized person will render the warranty invalid.

Due to varying climatic conditions, this warranty does not cover changes in brass finish, rusting, pitting, tarnishing, corroding or peeling. Brass finish fans maintain their beauty when protected from varying weather conditions. Any glass provided with this fan is not covered by the warranty.

Any replacement of defective parts for the ceiling fan must be reported within the first year from the date of purchase. For the balance of the warranty, call our customer service department (at **1-800-527-1292**) for return authorization and shipping instructions so that we may repair or replace the ceiling fan. Any fan or parts returned improperly packaged is/are the sole responsibility of the purchaser. There is no further express warranty. The distributor disclaims any and all implied warranties. The duration of any implied warranty which cannot be disclaimed is limited to the limited lifetime period as specified in our warranty. The distributor shall not be liable for incidental, consequential or special damages arising at or in connection with product use or performance except as may otherwise be accorded by law. This warranty gives you specific legal rights and you may also have other rights which vary from state to state. This warranty supersedes all prior warranties.

## REPLACEMENT PARTS LIST

For replacement parts, call our customer service department at **1-800-527-1292**, 8:30 a.m. - 5 p.m., CST, Monday - Friday.

		#2742219	#2742222	#2742220	#2742221
PART	DESCRIPTION	PART #	PART #	PART #	PART #
A	Downrod	2742219-A	2742222-A	2742220-A	2742221-A
B	Canopy	2742219-B	2742222-B	2742220-B	2742221-B
C	Mounting Bracket	2742219-C	2742222-C	2742220-C	2742221-C
G	Blade	2742219-G	2742222-G	2742220-G	2742221-G
H	Blade Arm	2742219-H	2742222-H	2742220-H	2742221-H
I	Shade	2742219-I	2742222-I	2742220-I	2742221-I



A

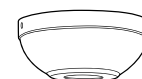

B



C



G



H



I