

# Instruction Manual

## Floor Lamp

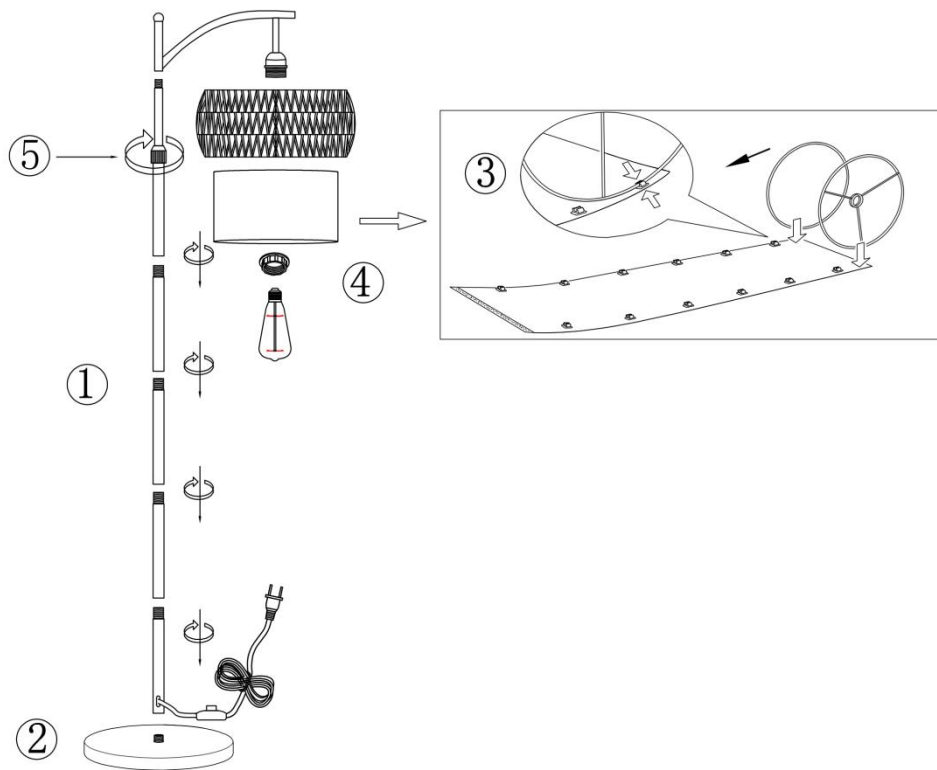

### INFORMATION AND PACKAGE

Specification	
Voltage	110- 120V
Bulb Socket	E26
Wattage	9W
Bulb Type	Smart Light Bulb
Certification	Wire, Plug, Socket, Switch are UL Listed
Warranty	2 Years

Package List	
Lamp Pole	1
Fabric Lampshade	1
Rattan Lampshade	1
Round Rings	2
Metal Base	1
Smart Light Bulb & Remote	1
Manual & Retaining Ring	1

### A LETTER TO MY PRECIOUS CUSTOMER

Dear Customer,

Thanks for choosing us! If you have any issue when you receive it, please contact us directly through "Amazon Message". We will offer a proper solution once we receive your message. Basically, we provide online customer service during PDT 6:00pm~9:00pm (EDT 9:00pm~00:00am) from Monday to Friday. So, do not hesitate to contact us during this time frame, we will reply to you in 24 Hours!

- **Customer Support Team**

### INSTALLATION STEPS

1. Connect all tubes securely and rotate to tighten.
2. Insert the assembled lamp pole firmly into the metal base.
3. Fix the round rings to the top and bottom snaps of the fabric shade and stick the fabric shade seal in place.
4. Install the rattan lampshade and fabric lampshade on the bulb socket with the retaining ring, and then install the matching smart light bulb.
5. Adjust the height of the floor lamp by adjusting the knob on the top of the light pole to get the height you want.

### QUESTION & ANSWER

Q: After powering on, my lamp doesn't work. What should I do?

1. Please check whether the lamp is really powered on and the switch is on.
2. Please make sure the light bulb you are using is the good one.
3. Please check whether the copper pieces inside the bulb socket contact well with the bulb.

None of these 3 steps? Just feel free to contact us for a replacement.