

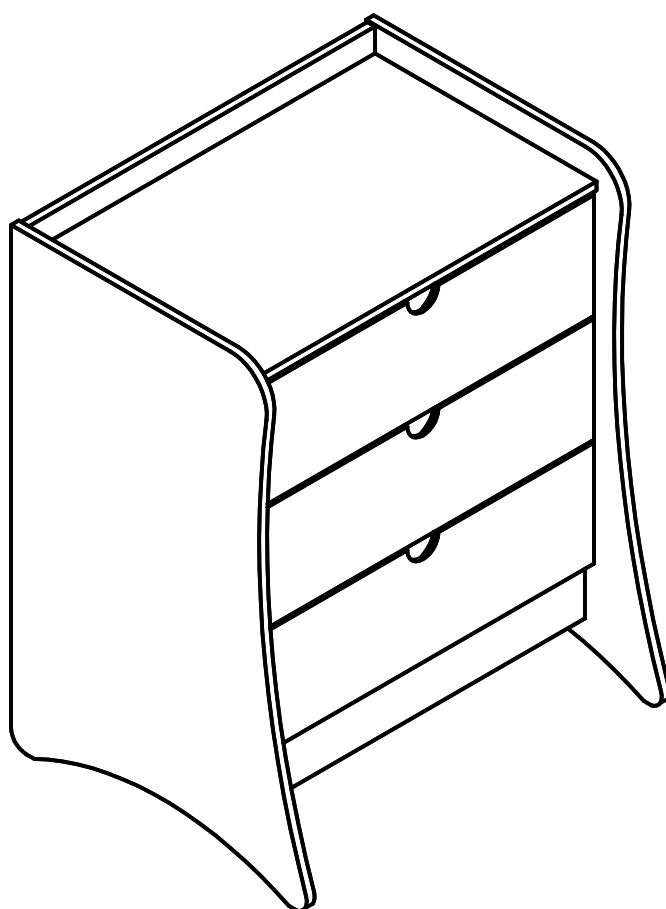

**MANHATTAN  
COMFORT**

---

**182GMC**



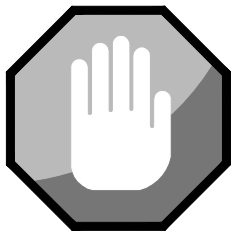

# STOP!

Before beginning the assembly process, ensure all boxes and parts have been delivered.

**ATTENTION: BEFORE START ASSEMBLING TAKE A PICTURE OF THE LABELS ON THE PACKAGES, THIS WILL BE REQUIRED IN CASE THE PRODUCT HAS ANY ASSISTANCE DEMAND.**

## FOR BEST RESULTS:

- Do not throw away packaging materials until assembly is complete.
- Assemble item on a soft surface, such as cardboard or carpet, to protect finish.
- Proper assembly requires two people.

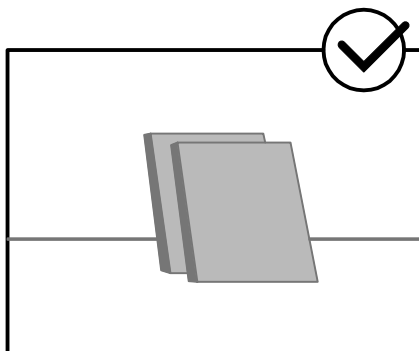
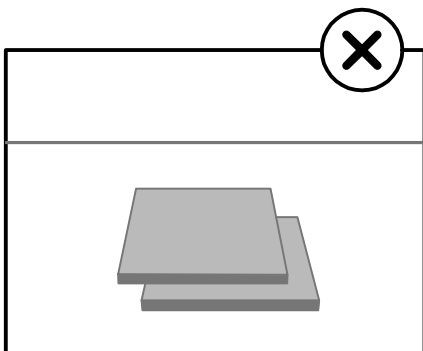
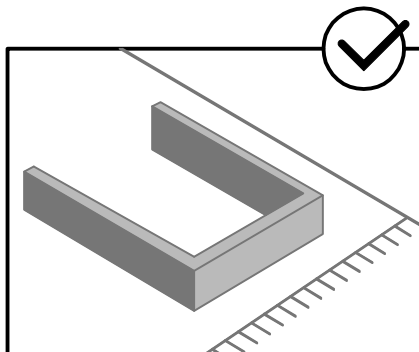
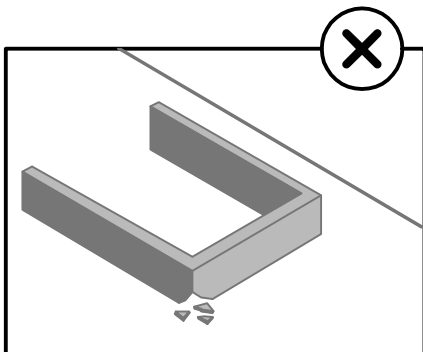

## TOOLS REQUIRED

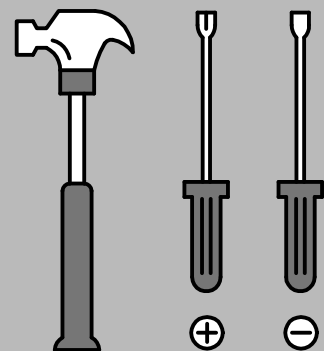

## SUPPORT SITE



View our assembly video online  
**WWW.MANHATTANCOMFORT.COM**



Stuck? Question? We are here to help.  
tel: **908-888-0818**  
e-mail: **help@manhattancomfort.com**



## Included in this package:

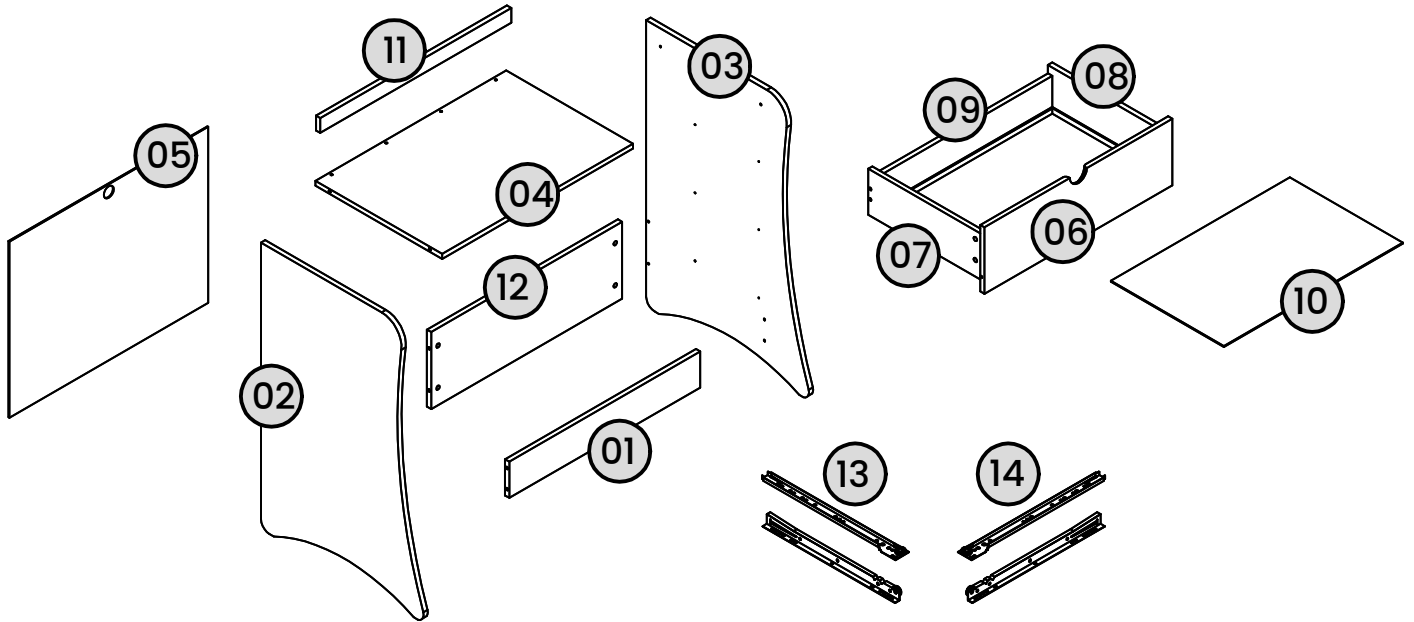

01. Front crossbar	01	08. Right side panel of the drawer	03
02. Left side panel	01	09. Rear panel of the drawer	03
03. Right side panel	01	10. Base of the drawer	03
04. Top panel	01	11. Upper crossbar	01
05. Back panel	01	12. Rear crossbar	01
06. Front of the drawer	03	13. Left slides	03
07. Left side panel of the drawer	03	14. Right slides	03

A - x36



B - x16



C - x24



D - x24



E - x04



F - x32

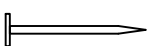

G - x24



H - x01

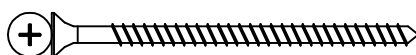

I - x01

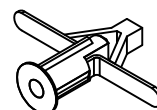

J - x01

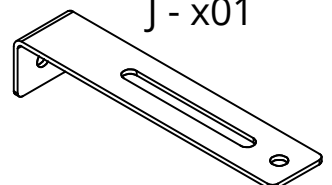

# Weight capacity:

---

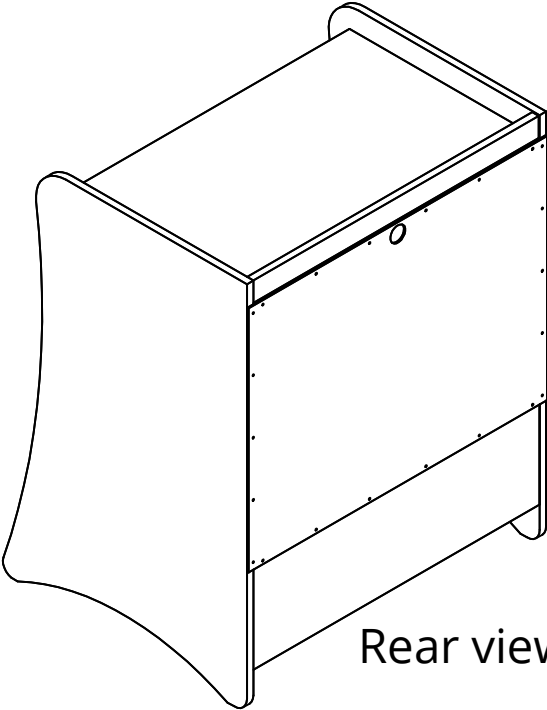
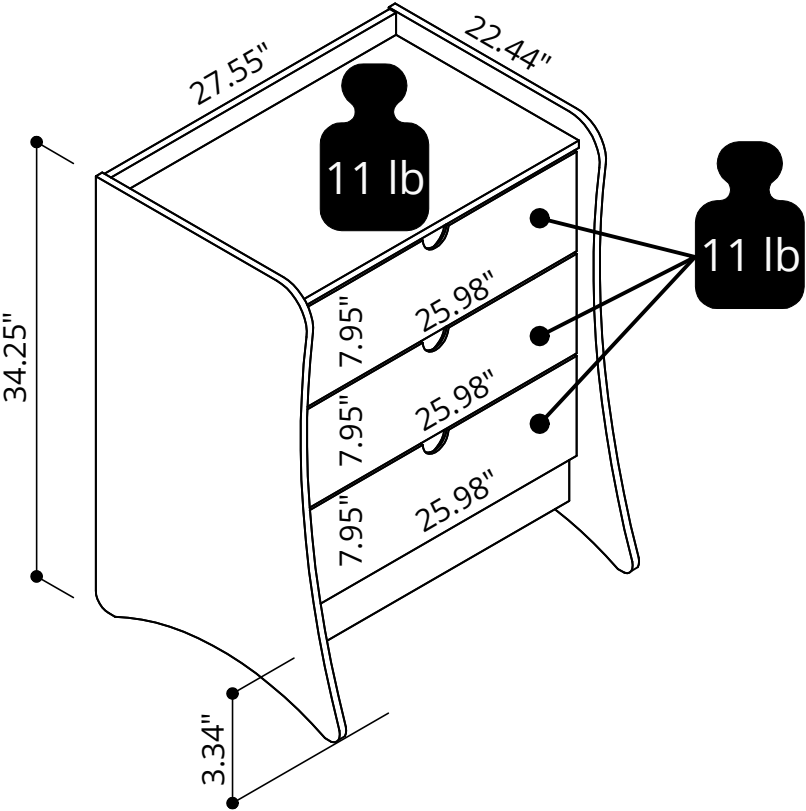

Rear view

## HOW TO IDENTIFY THE SLIDES?

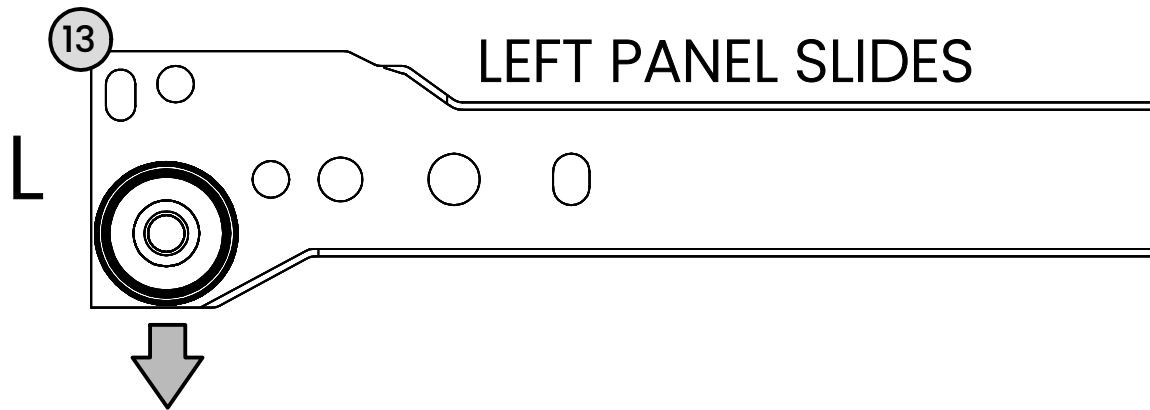

\*plastic wheel always pointed to the ground.

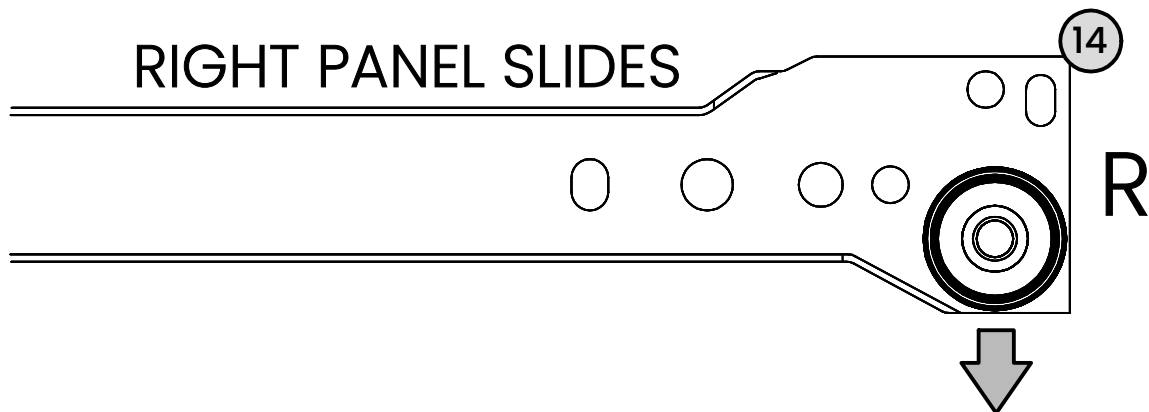

\*plastic wheel always pointed to the ground.

## WICH HOLES USE TO ATTACH THE SCREWS?



**Attention, all the assemblage must be done on the cardboard box or the Styrofoam boards to avoid damage to the parts.**

## Step 01



A = 22x



E = 04x

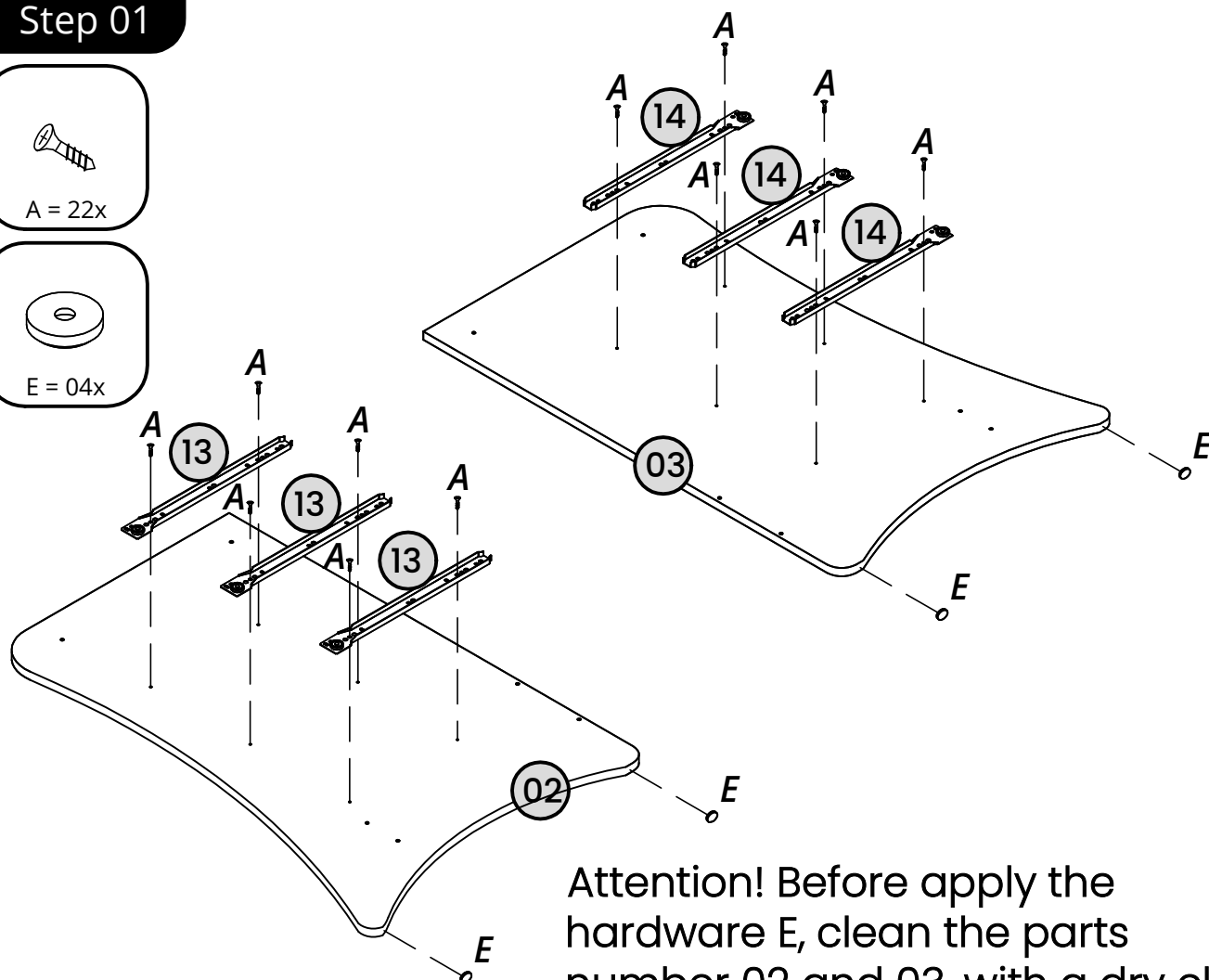

Attention! Before apply the hardware E, clean the parts number 02 and 03, with a dry cloth.

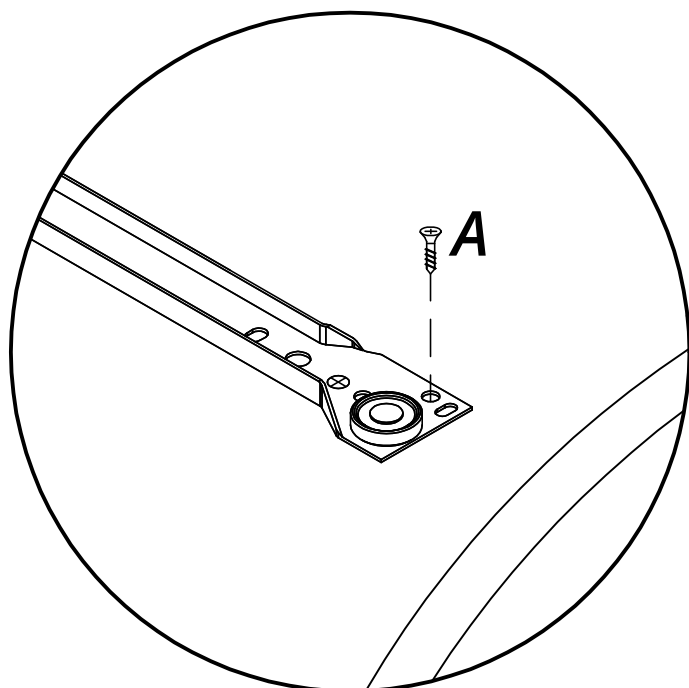

## ATTENTION!

It is mandatory to apply an additional screw (A) at the position informed, please observe there is no pre hole in the parts number 02 and 03.

**Step 02**

C = 12x

Apply the hardware (C) into the parts 02 and 03.

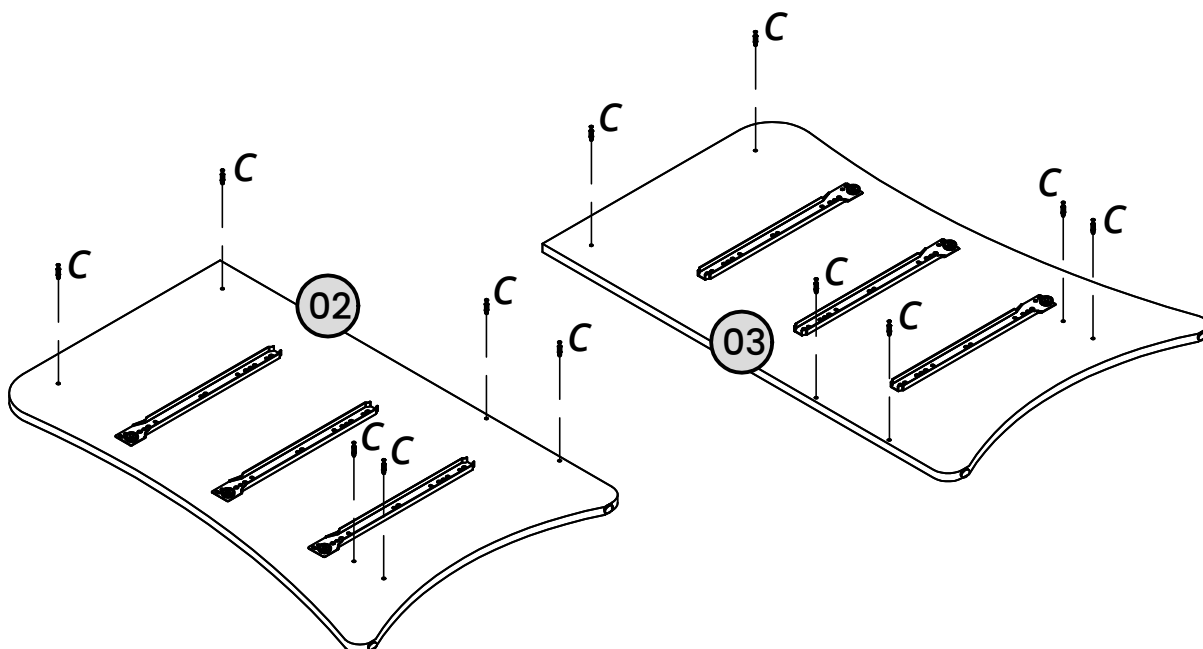
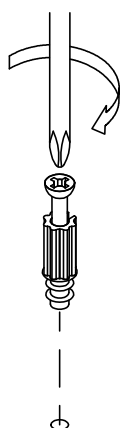
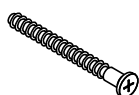
**Step 03**

B = 04x

Connect the part 11 onto the part 04 with the hardware (B).

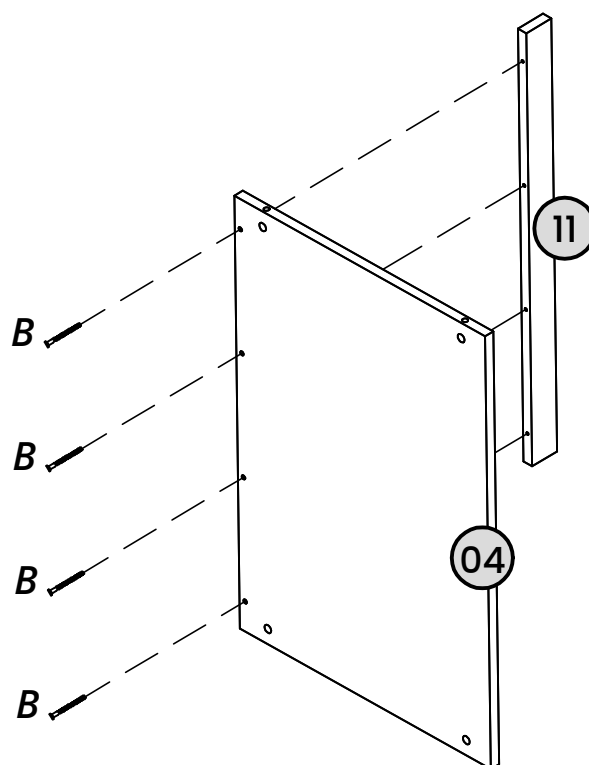

## Step 04

Connect the part 04 onto the part 03 with the hardware D.



D = 02x



G = 02x

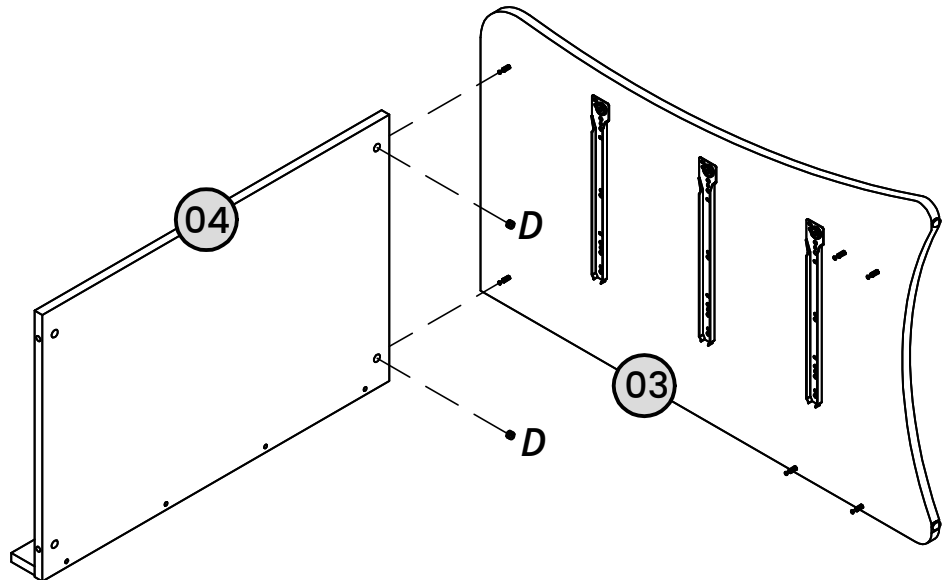
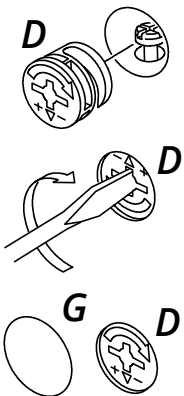

Apply the hardware (G) onto the hardware (D).

## Step 05

Connect the part 12 onto the part 03 with the hardware D.



D = 02x



G = 02x

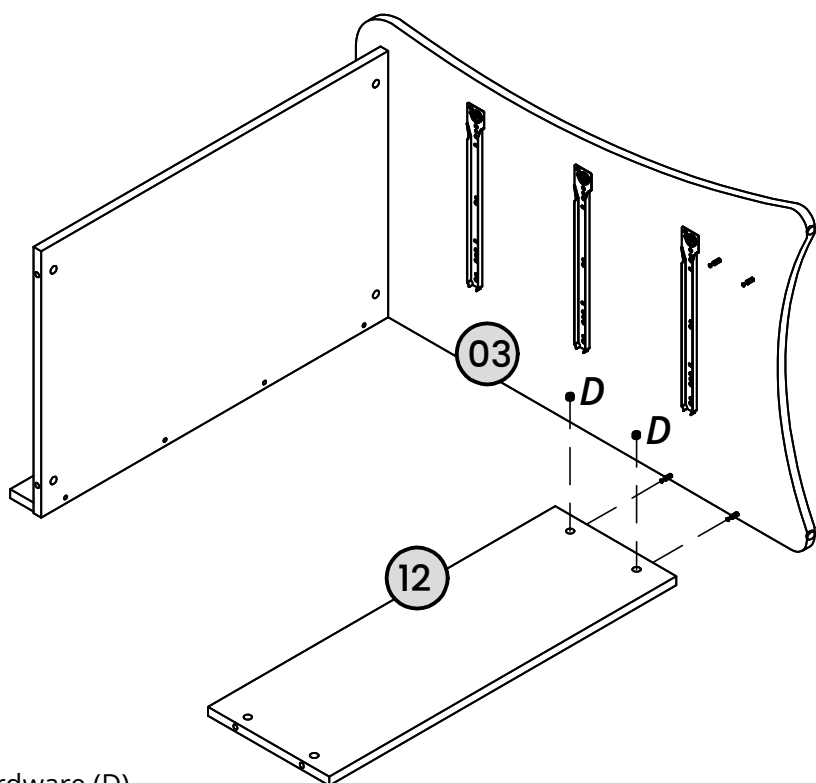
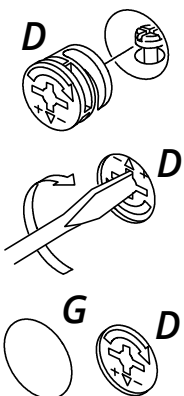

Apply the hardware (G) onto the hardware (D).



## Step 06



D = 02x



G = 02x

Connect the part 01 onto the part 03 with the hardware D.

Take care, 02 people needed.

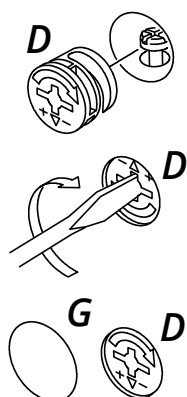
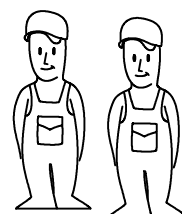

Apply the hardware (G) onto the hardware (D).

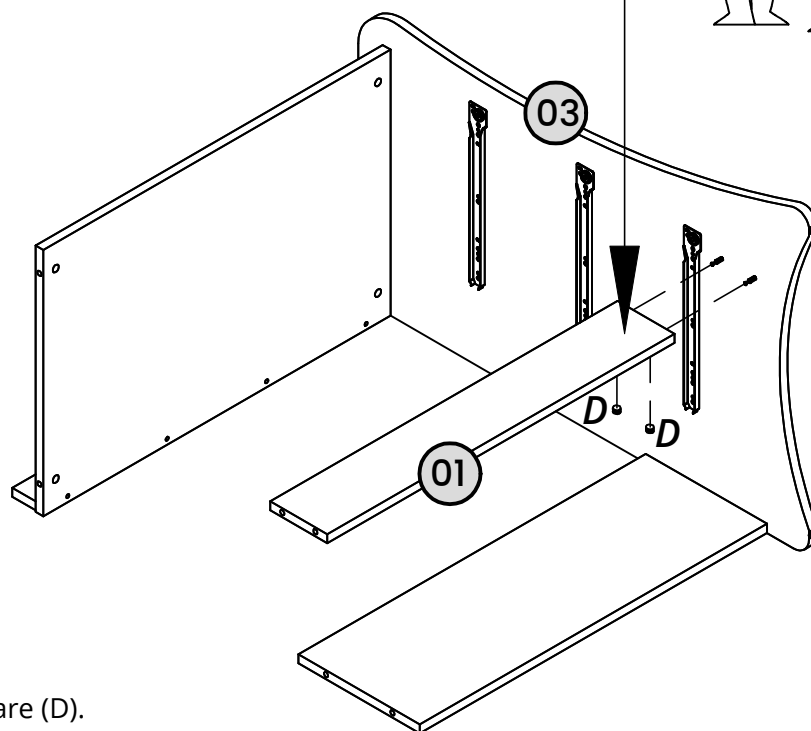

## Step 07



D = 06x



G = 06x

Connect the part 02 onto the parts 01, 04 and 12 with the hardware D.

Take care, 02 people needed.

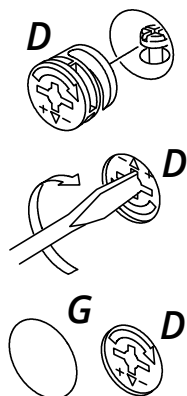
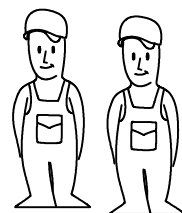

Apply the hardware (G) onto the hardware (D).

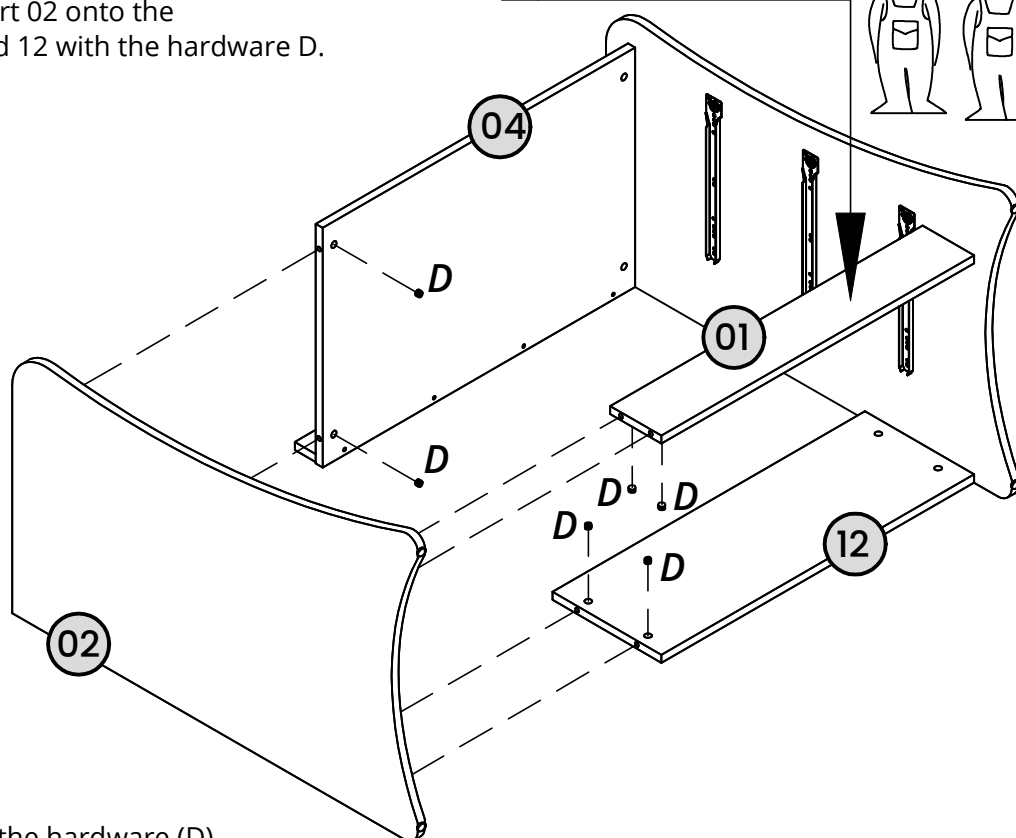

## Step 08

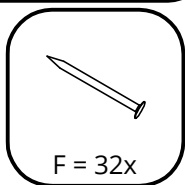

Connect the part 05 with the hardware F.

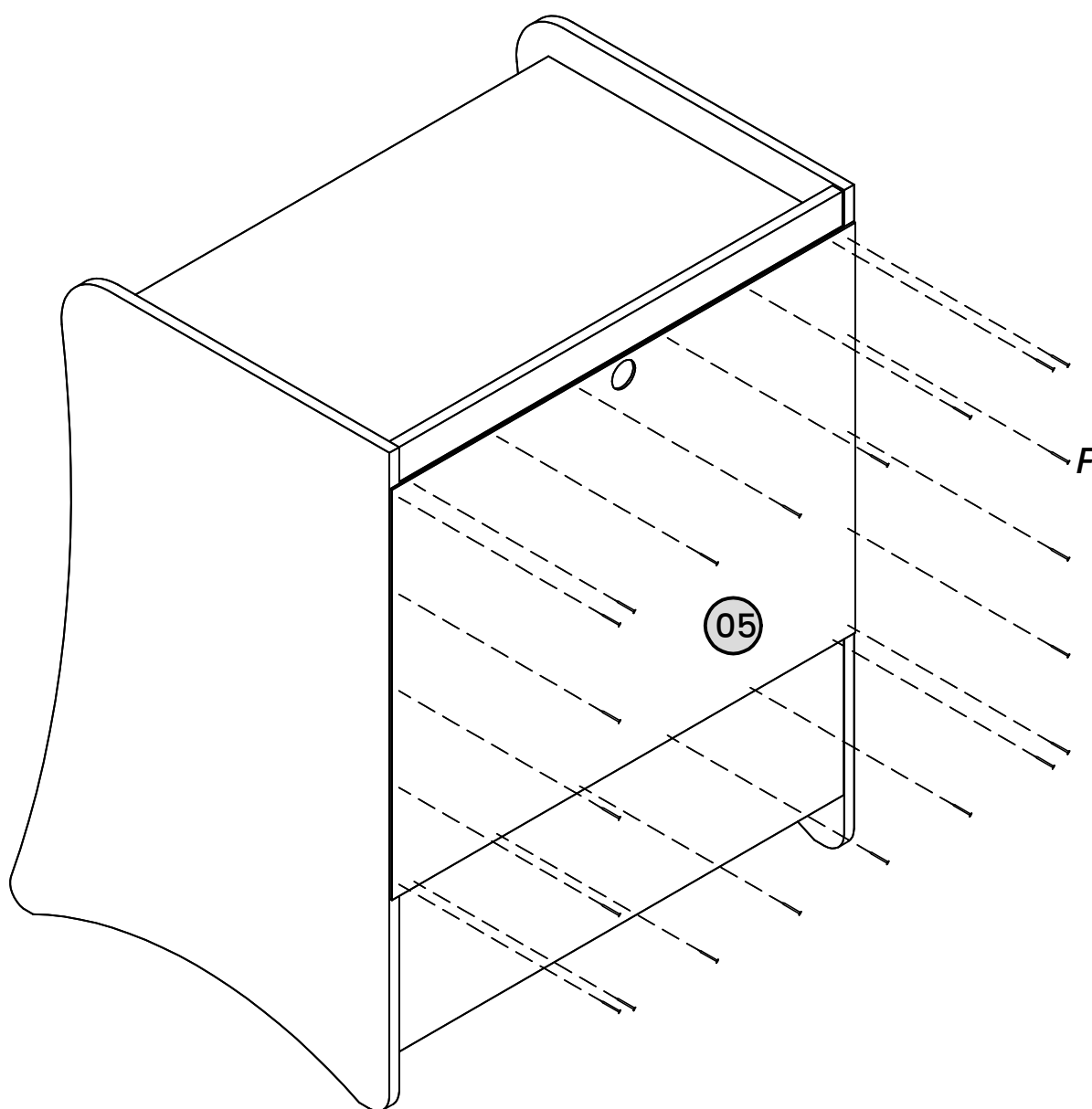

## ***Assembling the drawers***

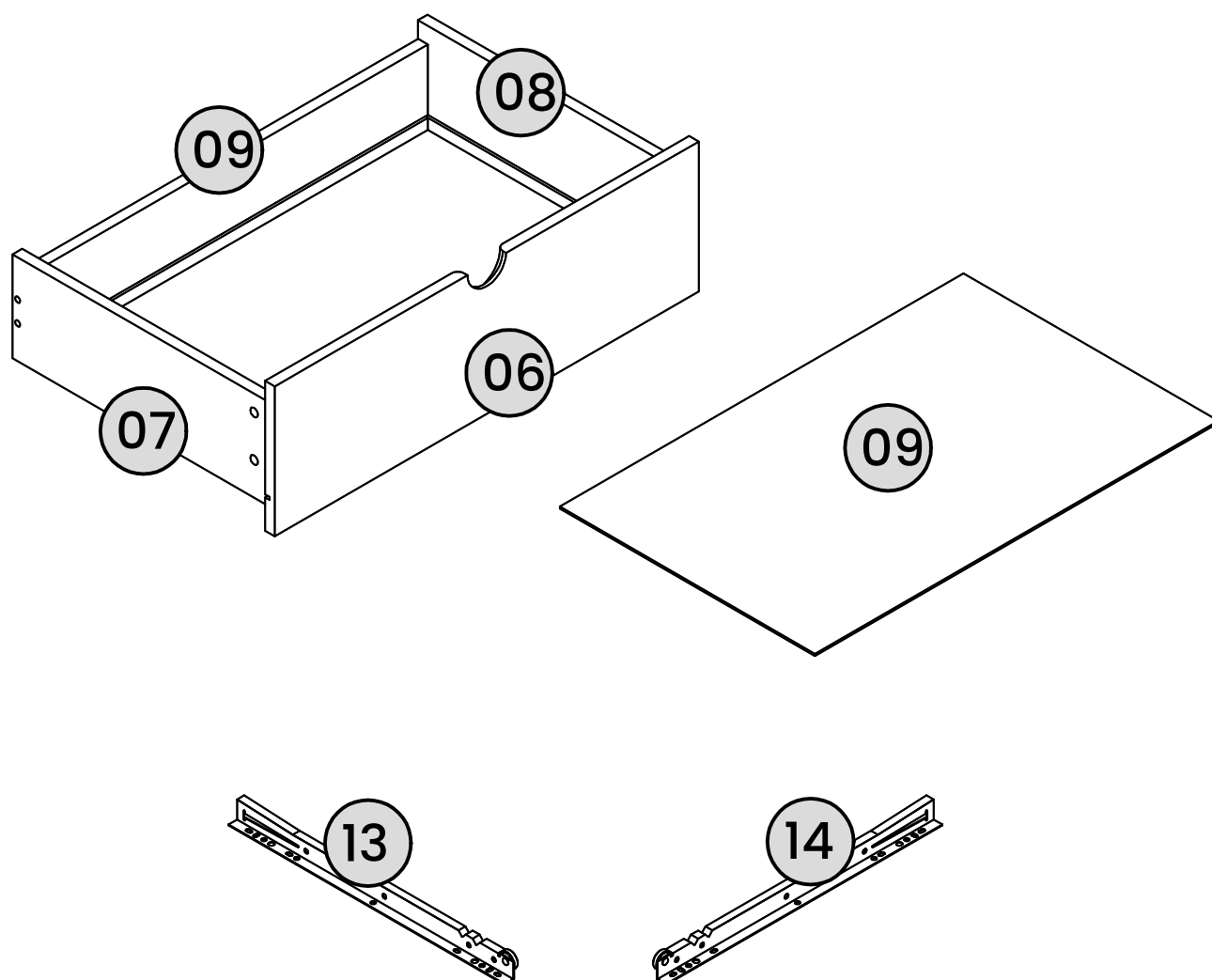

***Attention, all the assemblage must be done on the cardboard box or the Styrofoam boards to avoid damage to the parts.***

## Step 09

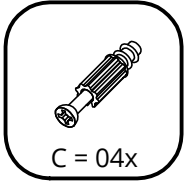

Apply the hardware (C) into the part 06.

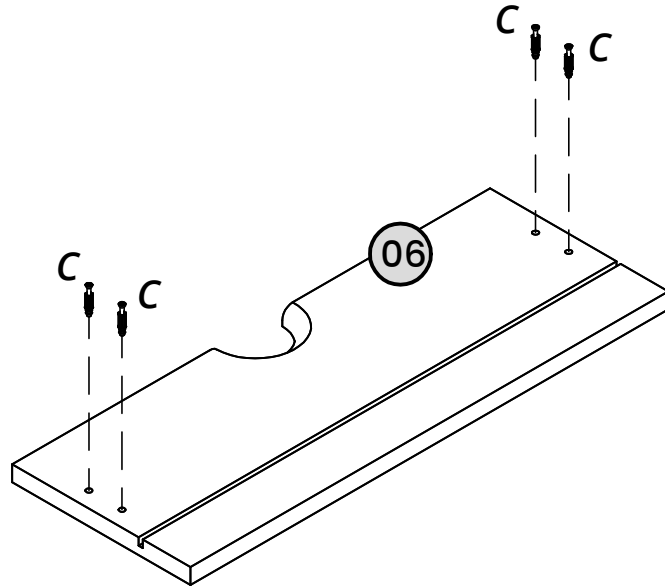
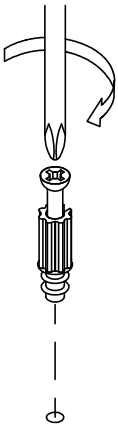

Repeat the same procedure to assemble all the drawers.

## Step 10

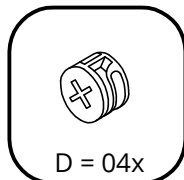

Connect the part 07 and 08 onto the part 06 with the hardware D.

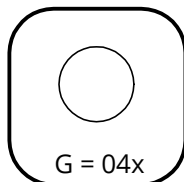

Repeat the same procedure to assemble all the drawers.

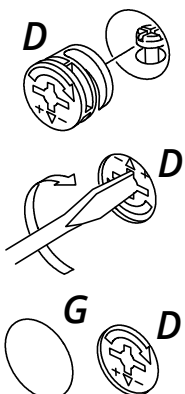

Apply the hardware (G) onto the hardware (D).

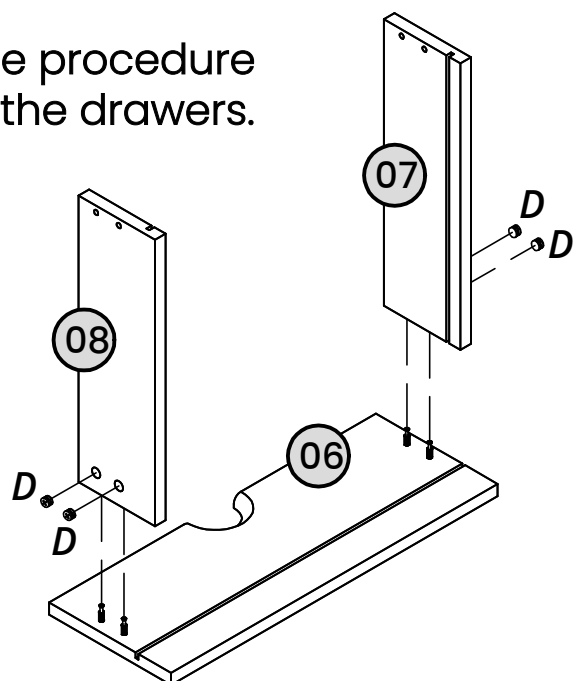

**Step 11**

Apply the part 10 in the groove of the parts 07, 08 until the groove of the part 06.

Repeat the same procedure to assemble all the drawers.

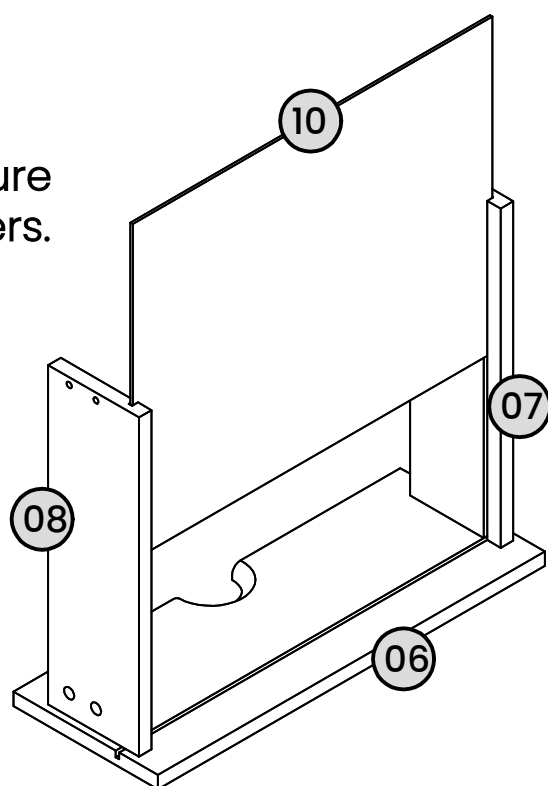
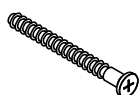
**Step 12**

B = 04x

Connect the part 09 onto the parts 07 and 08 with the hardware (B).

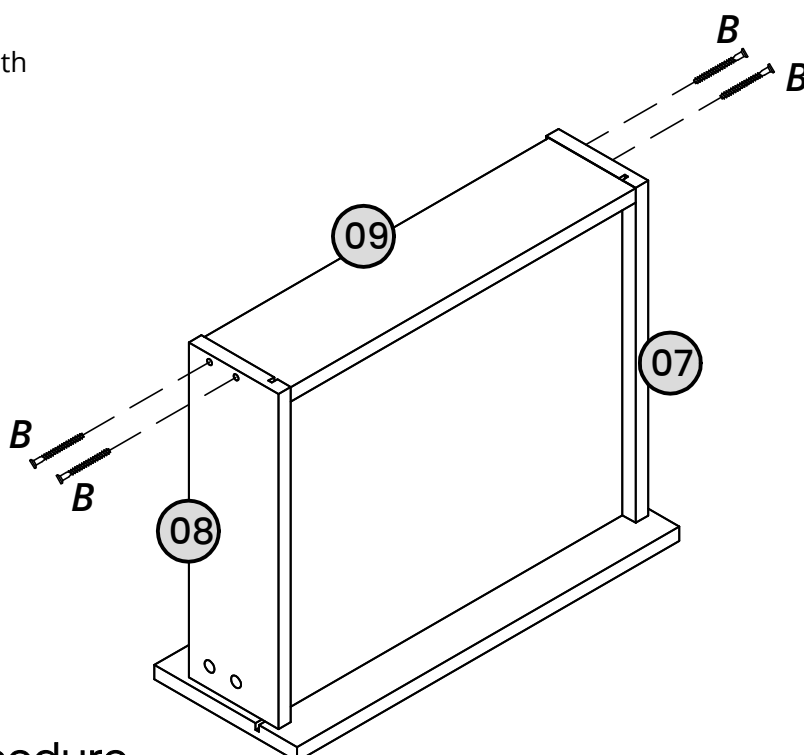

Repeat the same procedure to assemble all the drawers.

## Step 13

You must apply the screws  
on the holes  
indicated by the arrows.

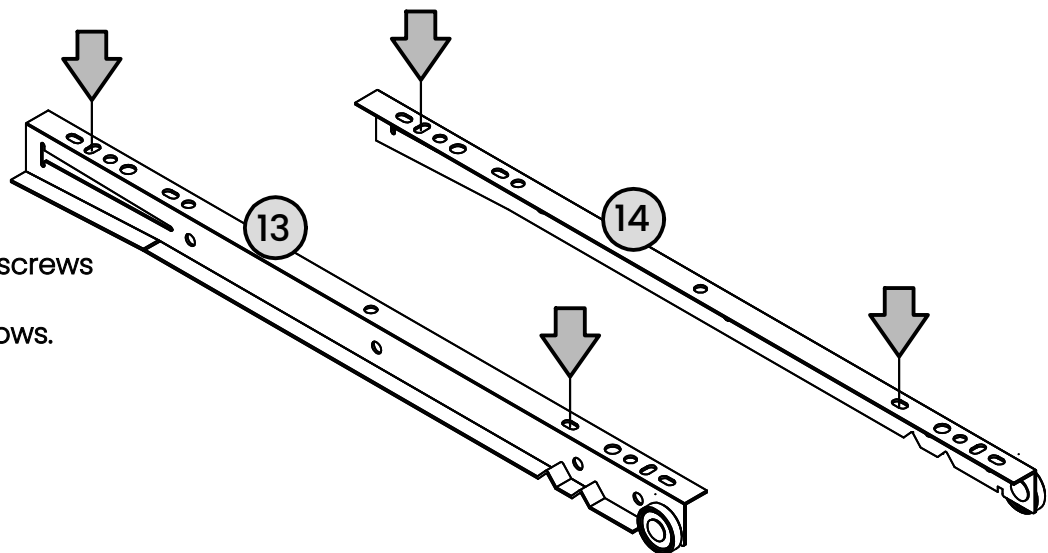

\*plastic wheel always pointed  
to the rear panel of the drawer  
part 09.

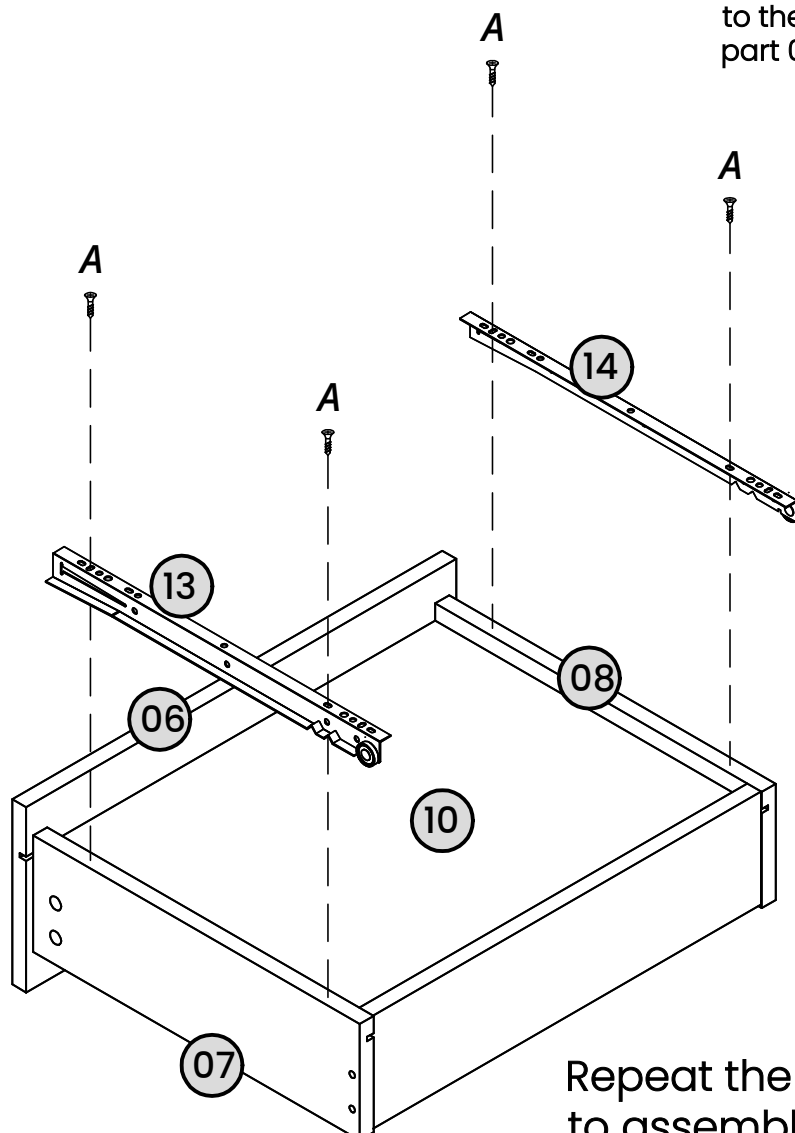
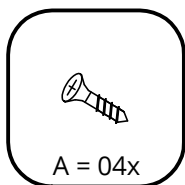

Repeat the same procedure  
to assemble all the drawers.

## Step 14

***Attention! Tipover system.***

First, approach the furniture as close as possible to the wall.

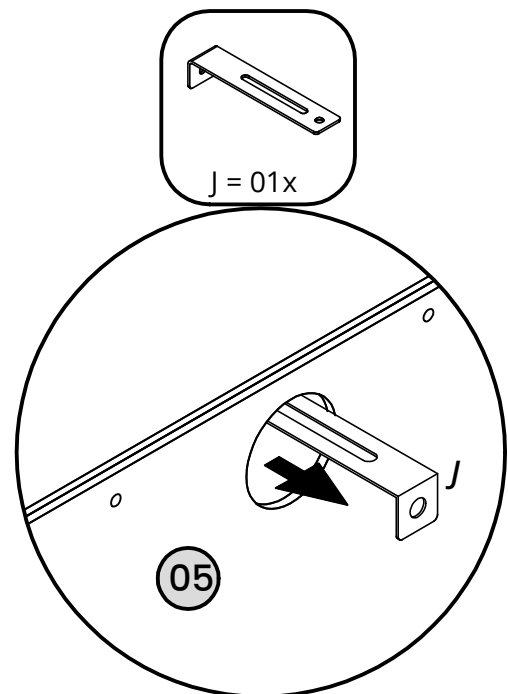
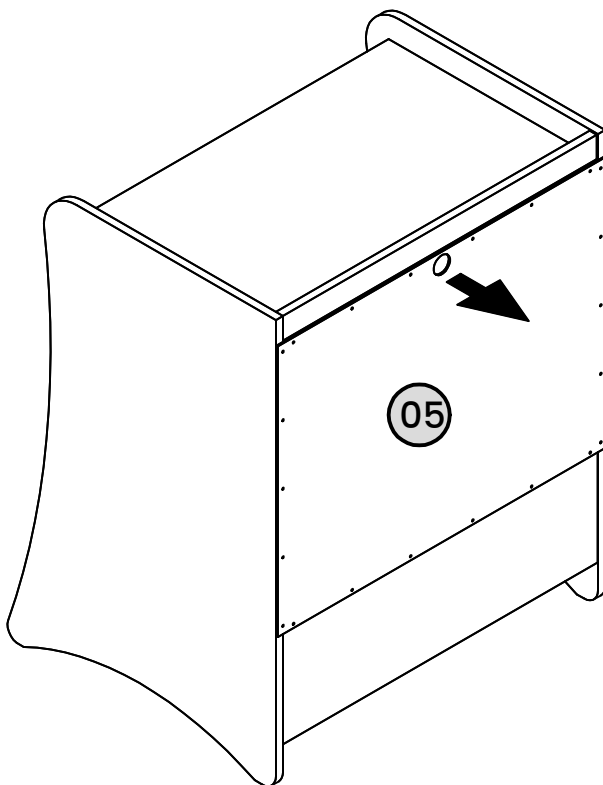
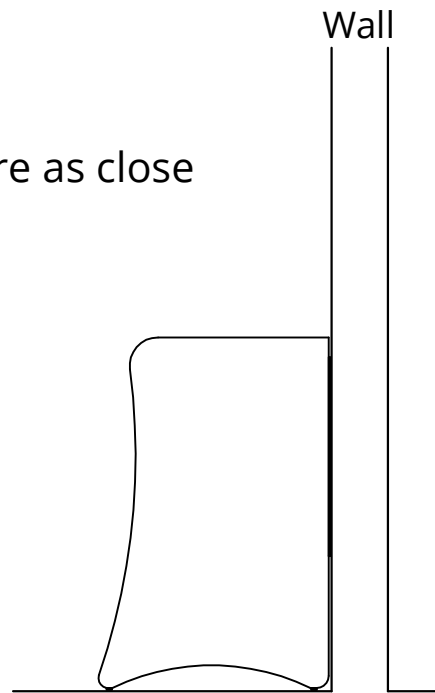

Then, pass the hardware ( J ) through the hole of the part (05) from inside to the outside as shown in the figure above until it reaches the wall.

## Step 15

***Attention! Tipover system.***

You will need a pencil to mark where you should drill the wall with a 3/8" drill bit to put in the hardware (1).

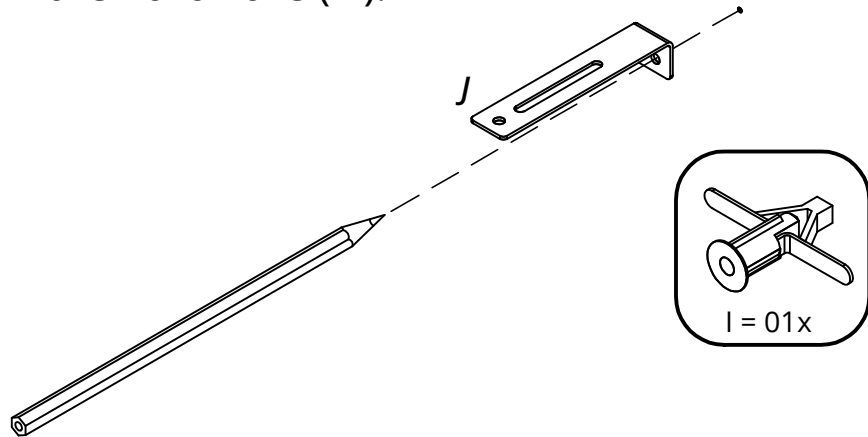

Use the 3/8" drill bit to drill the wall.

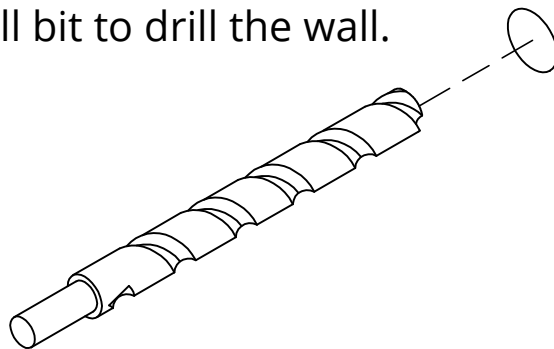

Press the wings of the hardware (1) and put it in to the hole that you drilled on the wall.

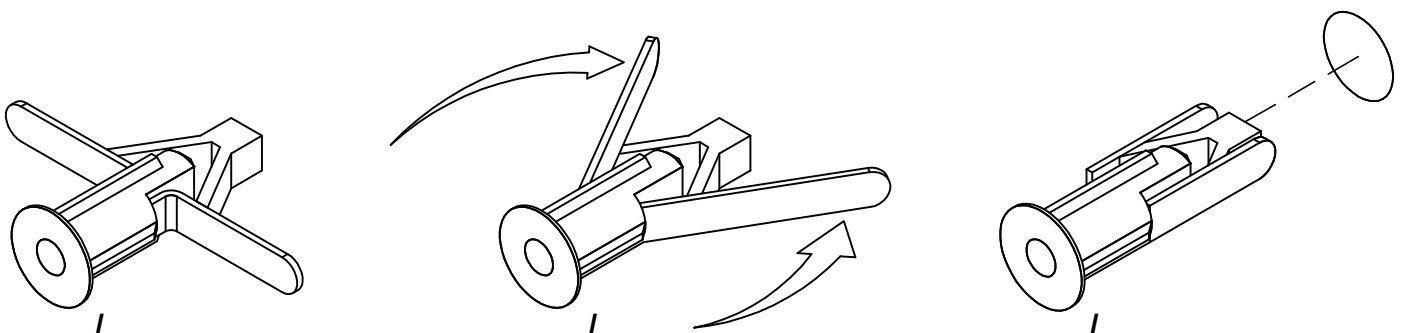

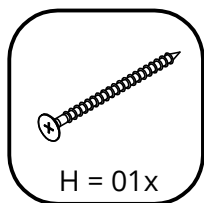

## Step 16

**Attention! Tipover system.**

Connect the hardware ( J ) on the wall, using the hardware (H).

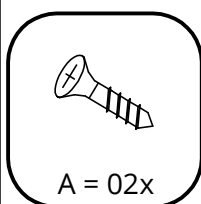
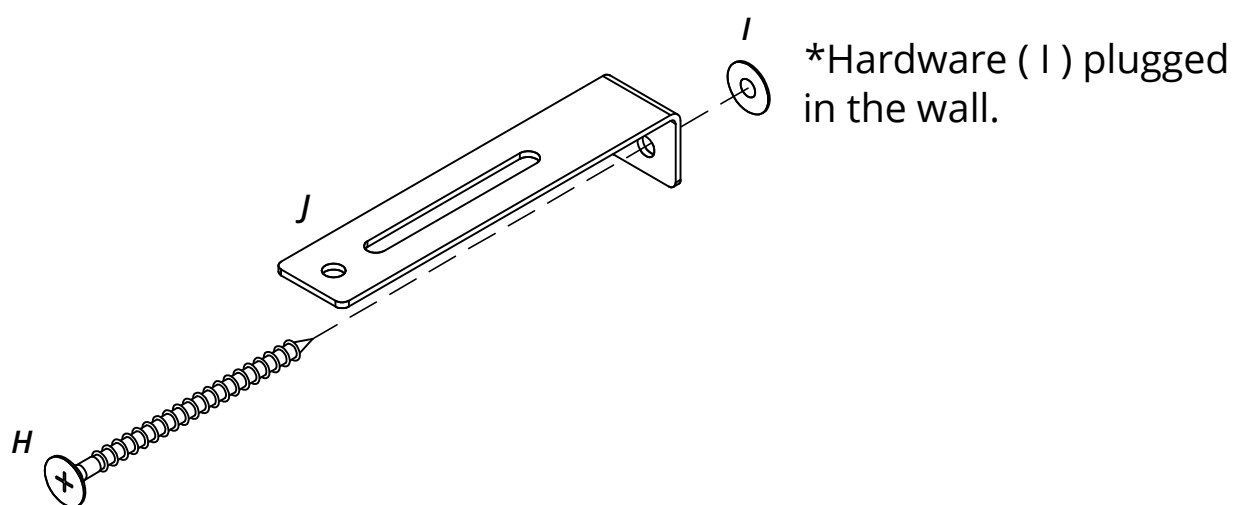

Put the furniture in the right position and connect the hardware ( J ), under the part 04 with the hardware (A).

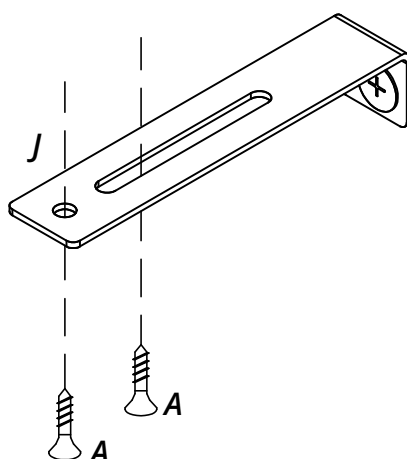

**Step 17**

Install the drawers fitting them into the slides fixed on the parts 02 and 03.

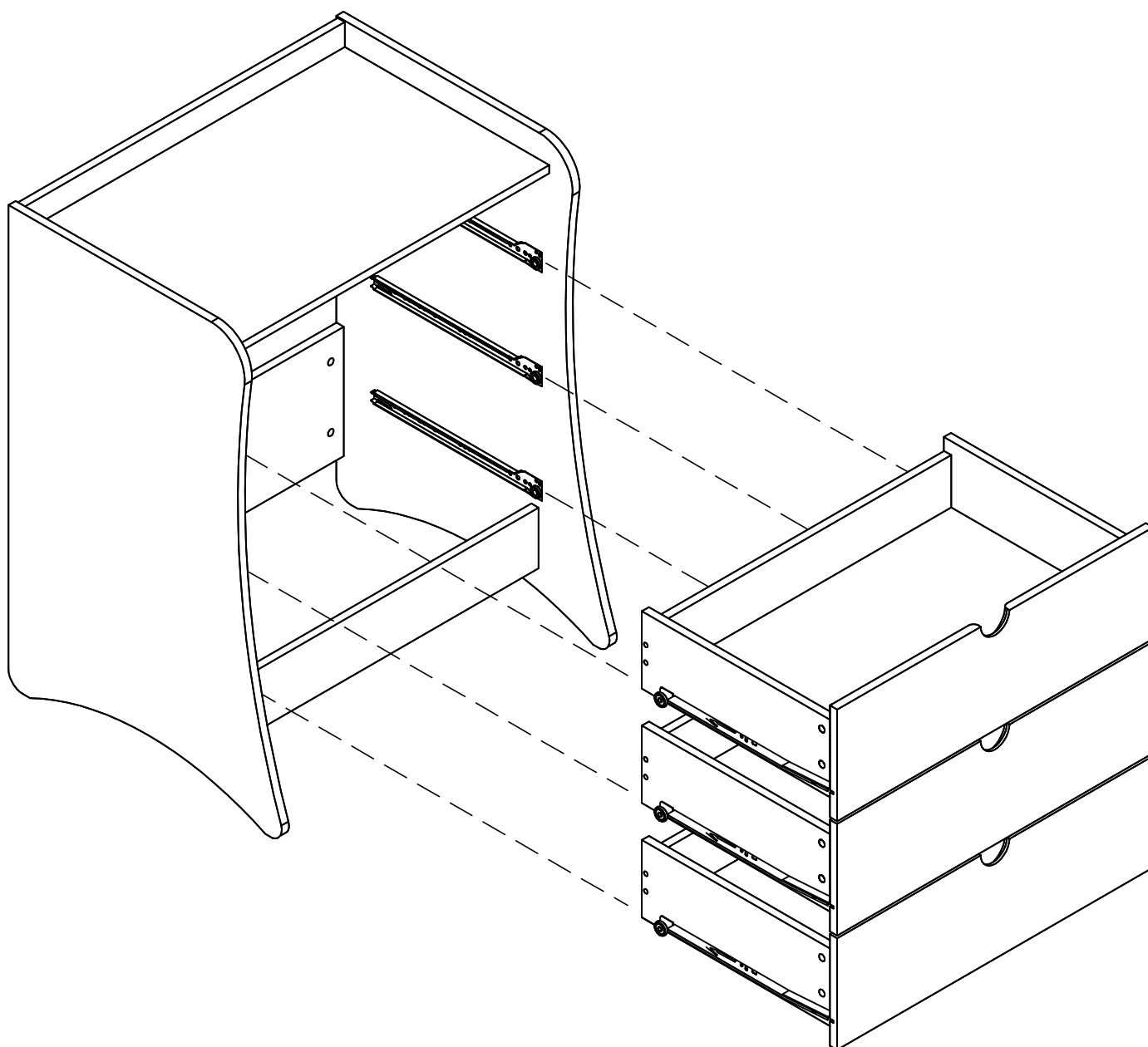



## **WARRANTY POLICY**

All Manhattan Comfort furniture products are warranted, to the original purchaser at the time of purchase and for a period of 30 days thereafter.

Our warranty is limited to new products purchased in factory sealed cartons. This warranty is valid in the United States of America and Canada.

In order to provide you with timely assistance, please thoroughly inspect your furniture for missing or defective parts immediately after opening the carton.

Manhattan Comfort offers a 30-day parts replacement warranty on all items.

Our furniture products are not intended for outdoor use.

## **THE WARRANTY DOES NOT COVER:**

- Defects/damages by improper assembly or disassembly.
- Defects/damages caused by shipping. Claims for damage during transit should be placed immediately to the transportation company.
- Defects/damages caused by inappropriate use of the furniture.



319 Ridge Rd. Dayton, NJ 08810

908-888-0818