

PRODUCT INSTRUCTION

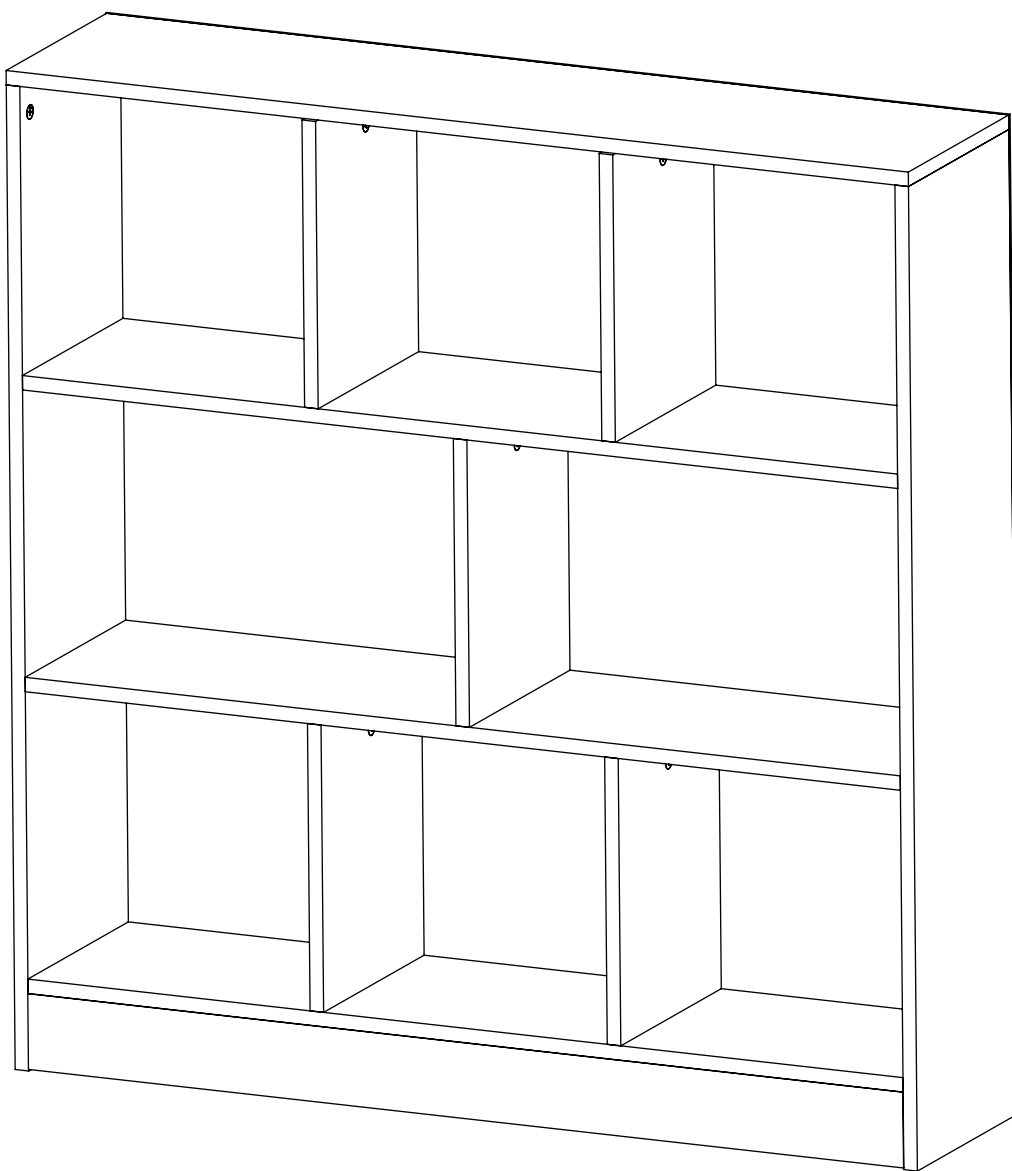

Bookshelf

WARNING

Serious or fatal crushing injuries can occur from furniture tip-over. To help prevent tip-over.

- Place heaviest items in the lowest drawers.
- Do not set TVs or other heavy objects on the top of this product.
- Never allow children to climb or hang on drawer, door, or shelves.
- Never open more than one drawer at a time.
- Use of tip-over restraints, only reduces, but does not eliminate, the risk of tip-over.
- Never open more than one drawer at a time.
- Use of tip-over restraints, only reduces, but does not eliminate, the risk of tip-over.

MAINTENANCE TIPS



Never let liquids or damp cloths sit on this furniture.



Never use chemical cleaning products. They can damage the finish. For cleaning, use only a slightly damp cloth and wipe dry.

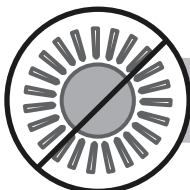

To avoid dulling of finish, do not place furniture in direct sunlight

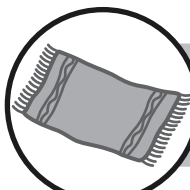

Do not put plastic or rubber rings under appliances. Use cloth or felt protectors.



To clean, use a soft or slightly damp cloth, then wipe with a clean, dry cloth.

Tools Required For Assembly

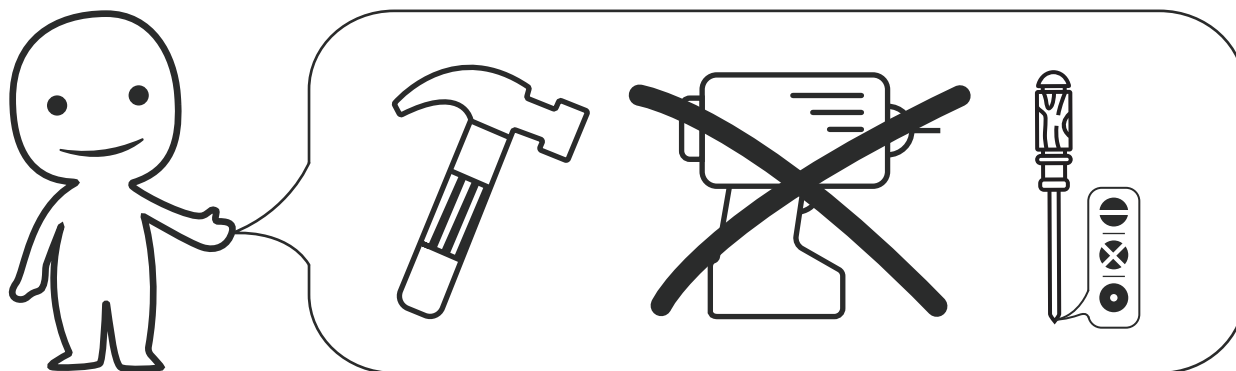

Need Two or More People To Complete

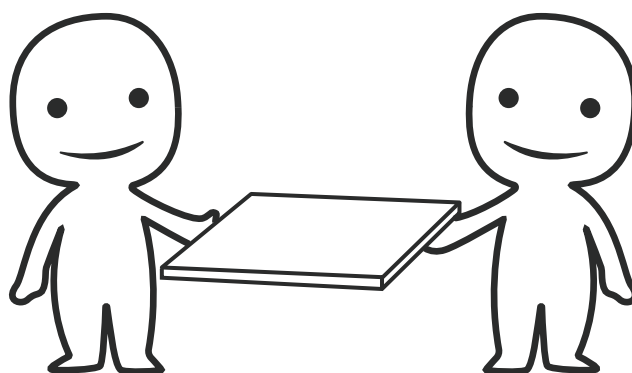

Assemble Item On a Clean Flat Surface

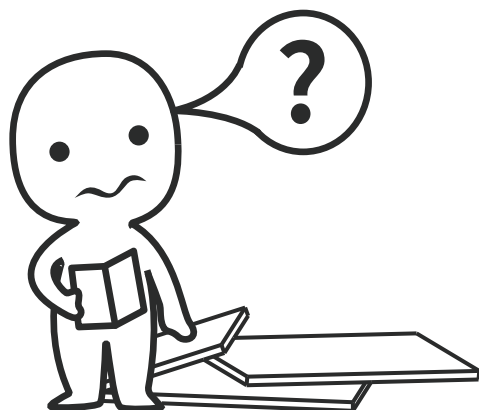
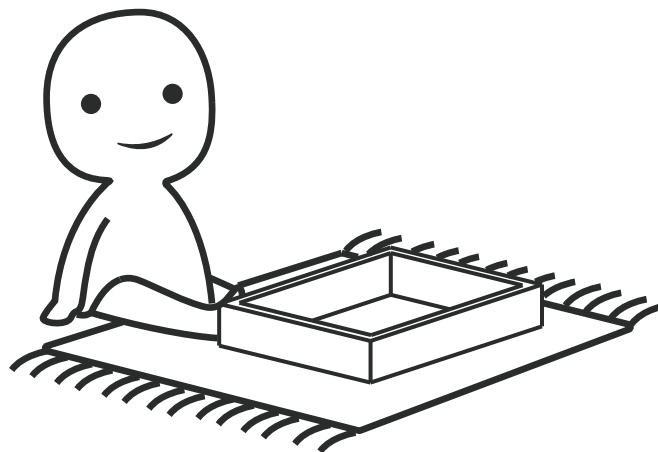
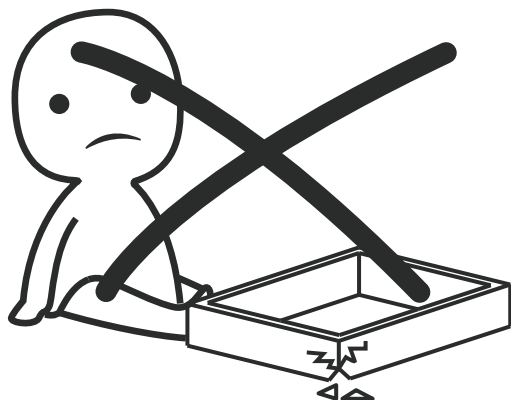

- Please check you have all hardware before assembling.
- Please ensure you have the name of the item and hardware part required and quantity.
- Please contact us by mail, if you have any questions, and we will reply you asap.
- Enjoy your new purchase!

Tips Before You Start

QUICKFIT

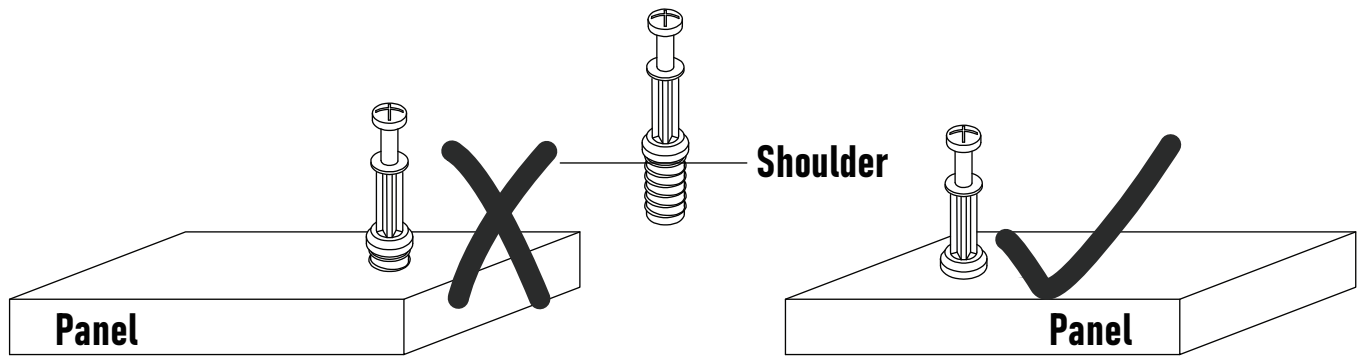

Tighten quickfit until shoulder is flush with panel. Do not overtighten or undertighten.

CAM LOCK

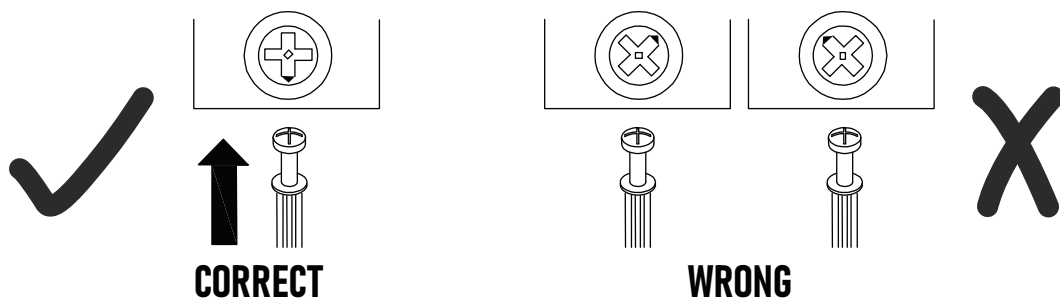

When fitting cam lock, ensure starting position is correct before you insert connecting quickfit.

Quickfit head should be in the centre of the cam lock when the two panels are joined.
Cam lock should be inserted before quickfit.

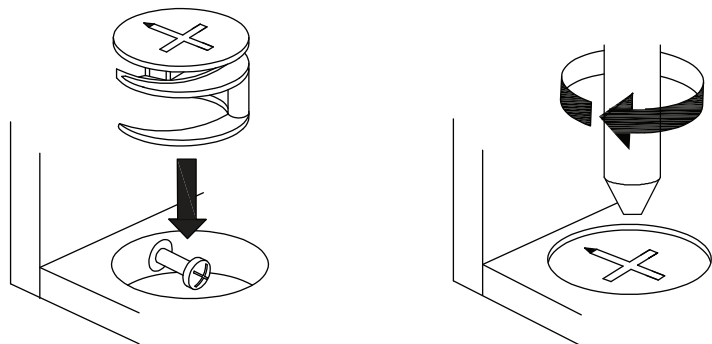

Turn cam lock clockwise to tighten.

Hardware List

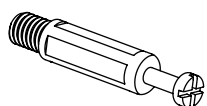

23 x A
Quickfit Screw



23 x B
Camlock

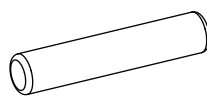

31 x C
Wooden Dowel

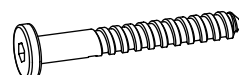

10 x D
Screw



17 x E
Nail



1 x F
Tool

G

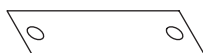

1pc
Wall Strap



1pc
Nail

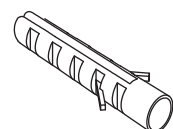

1pc
Wall Plug

Parts List

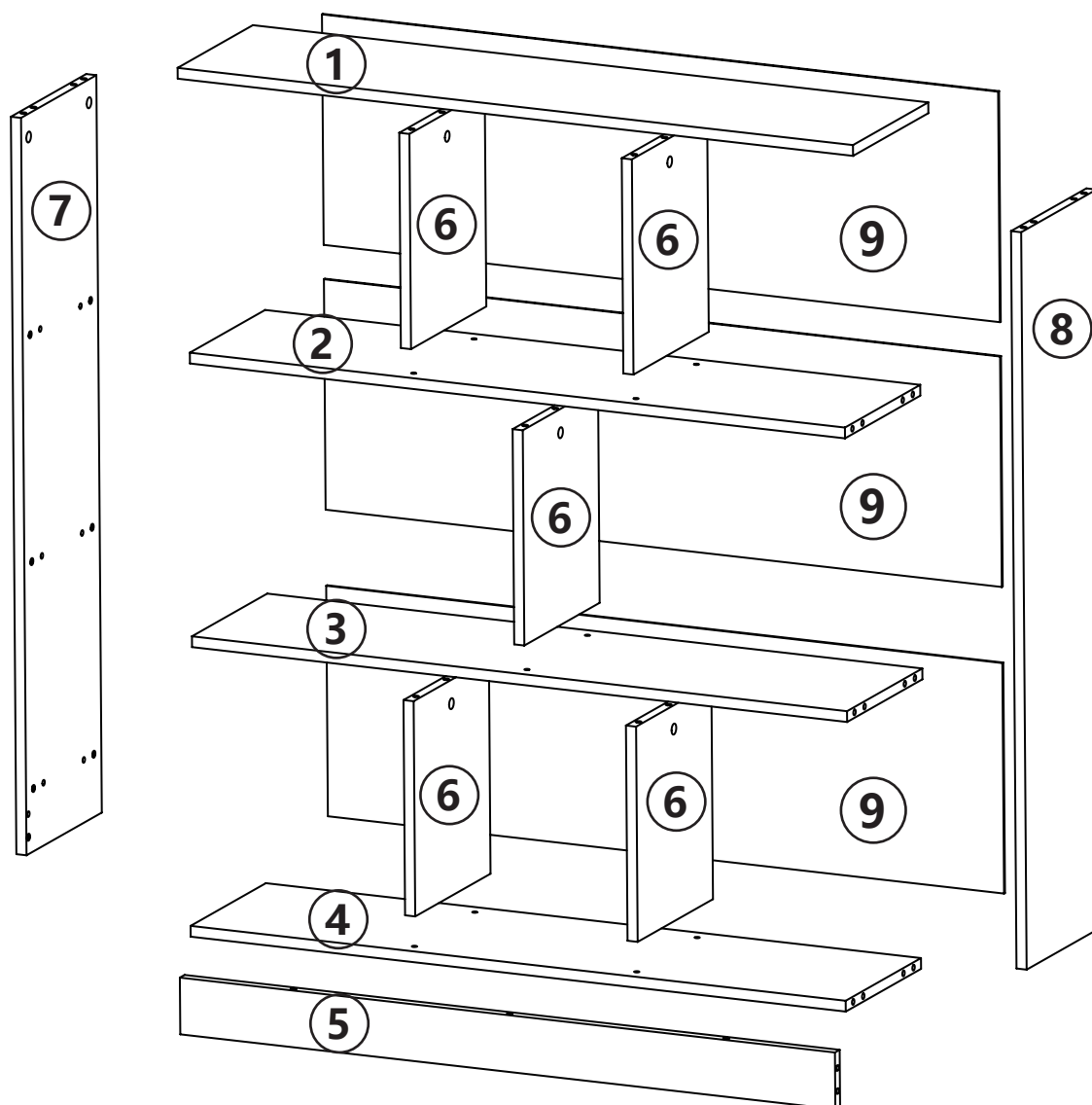

STEP 1

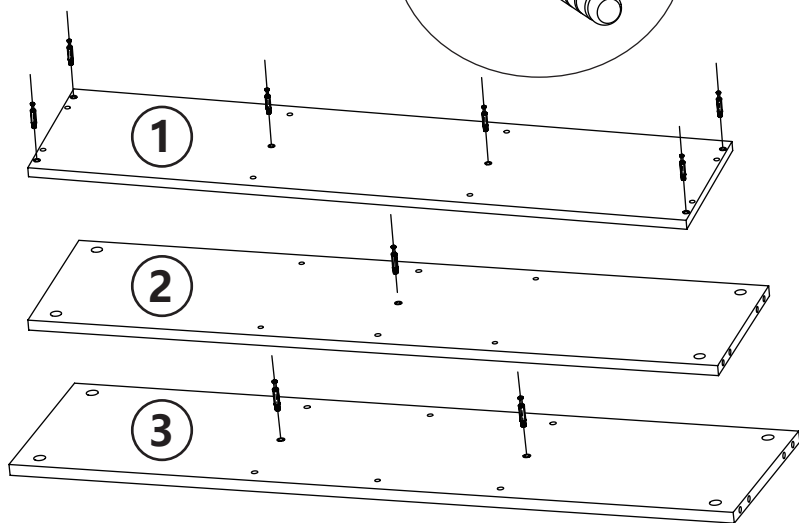
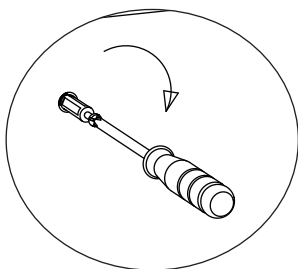

STEP 2

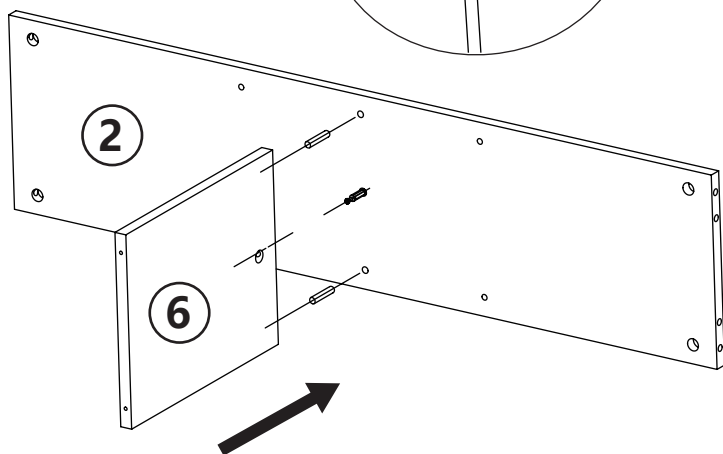
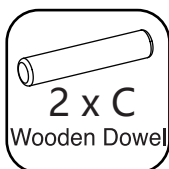
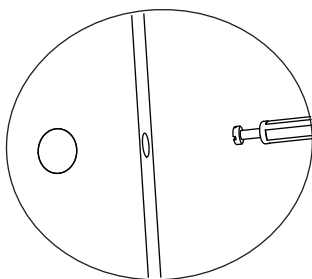

STEP 3

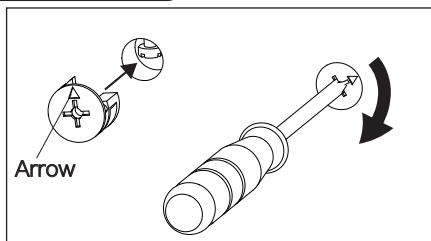

1 x B
Camlock

Identify arrow on head and put the cam locks into the holes. Arrow must point toward hole in the edge of panel. Then turn the cam locks in a clockwise direction to lock the cam bolts.

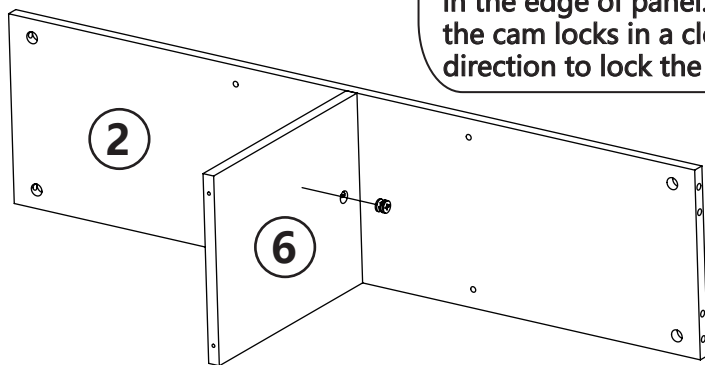

STEP 4



4 x D
Screw

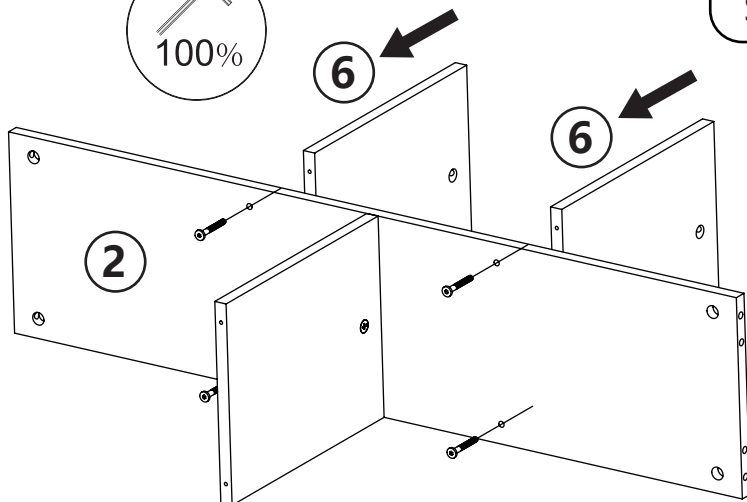

STEP 5

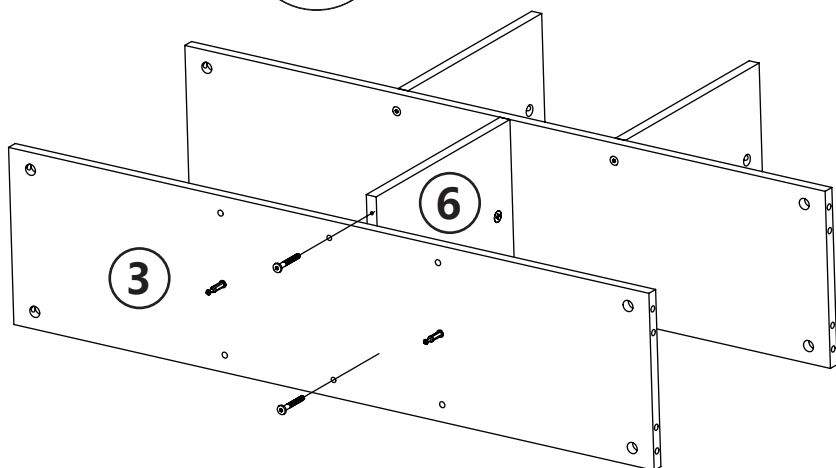
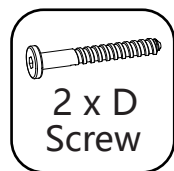

STEP 6

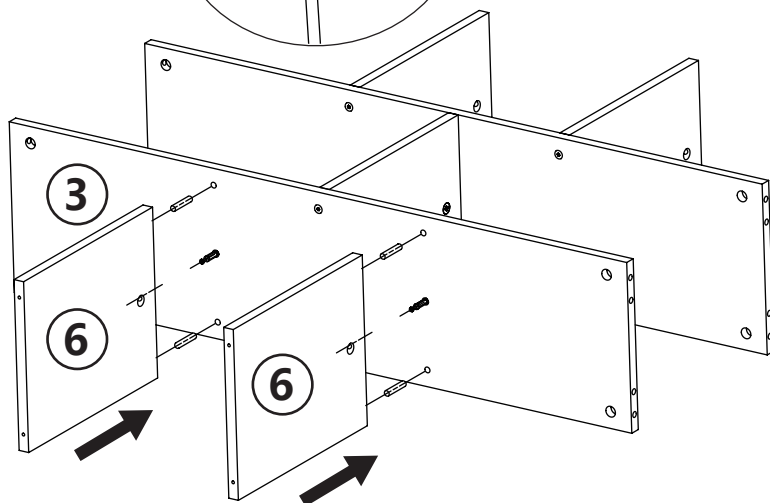
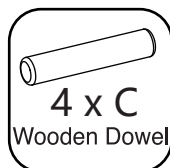
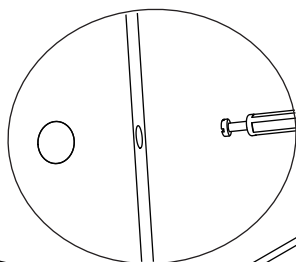

STEP 7

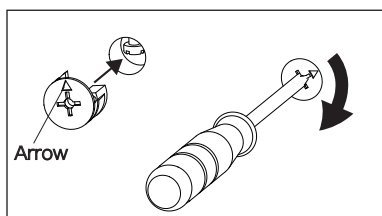

2 x B
Camlock

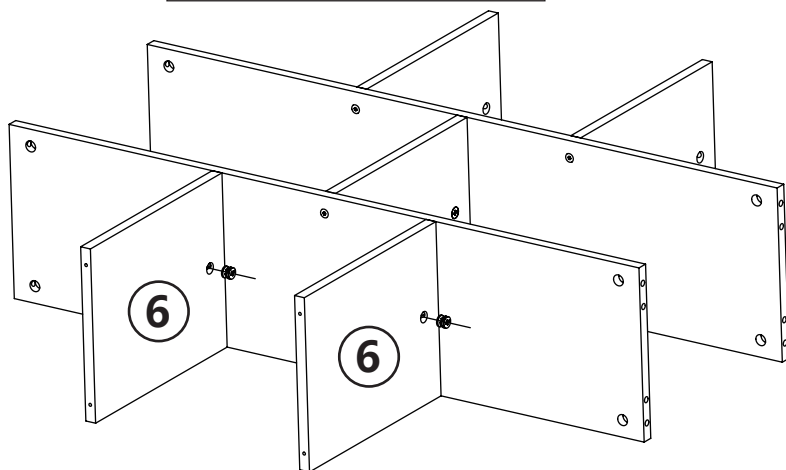

STEP 8



4 x D
Screw

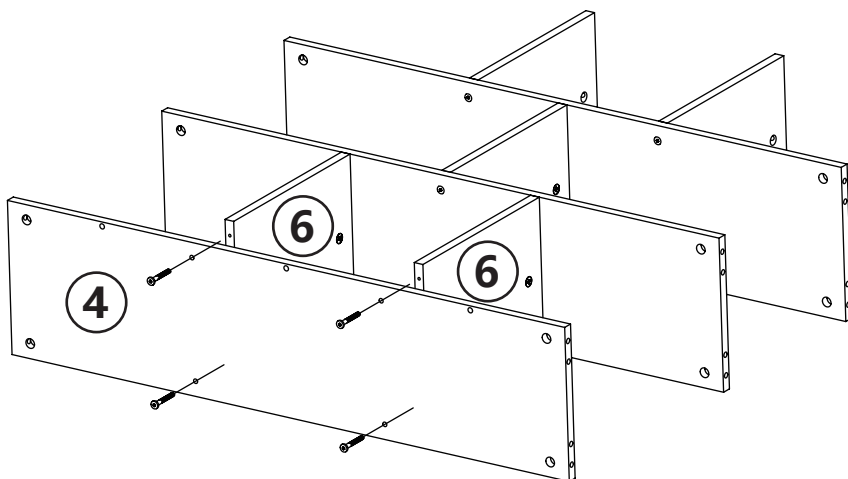

STEP 9

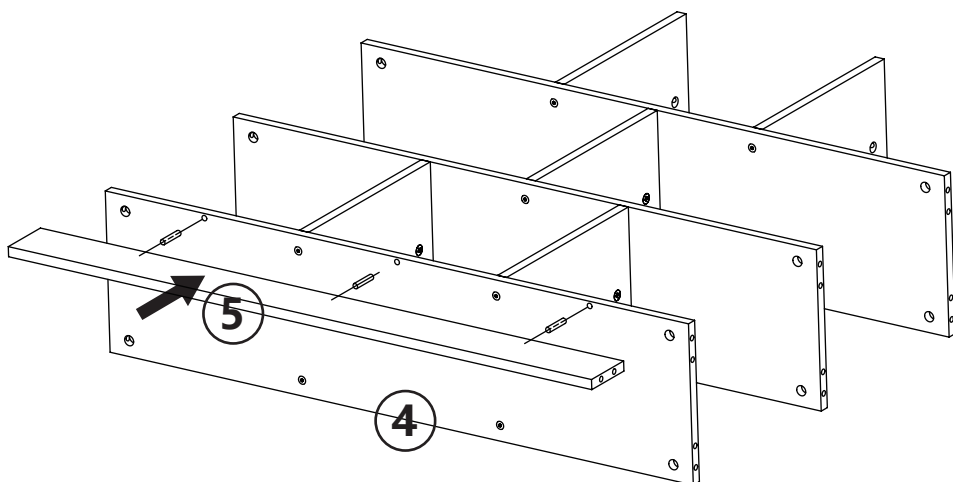
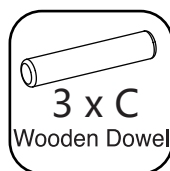

STEP 10

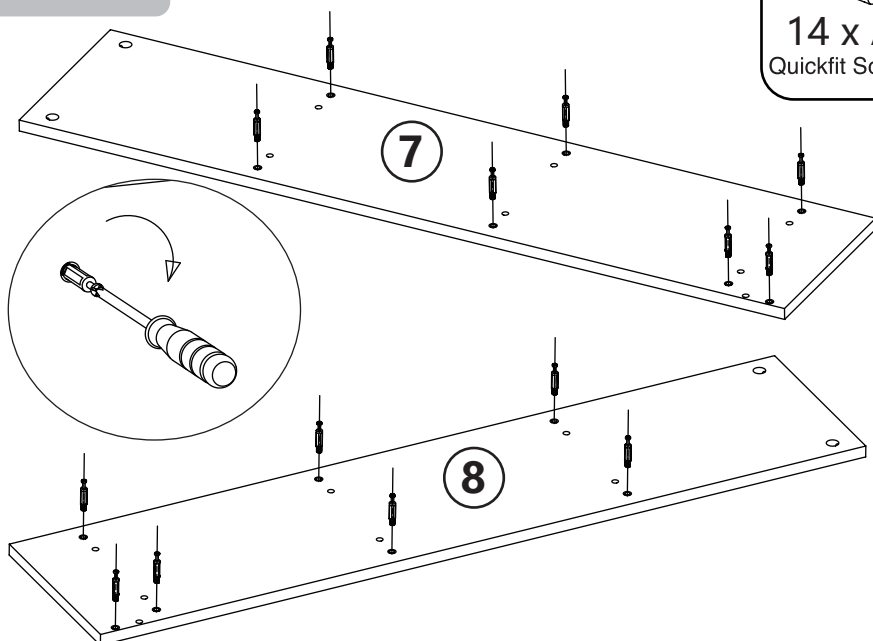

STEP 11

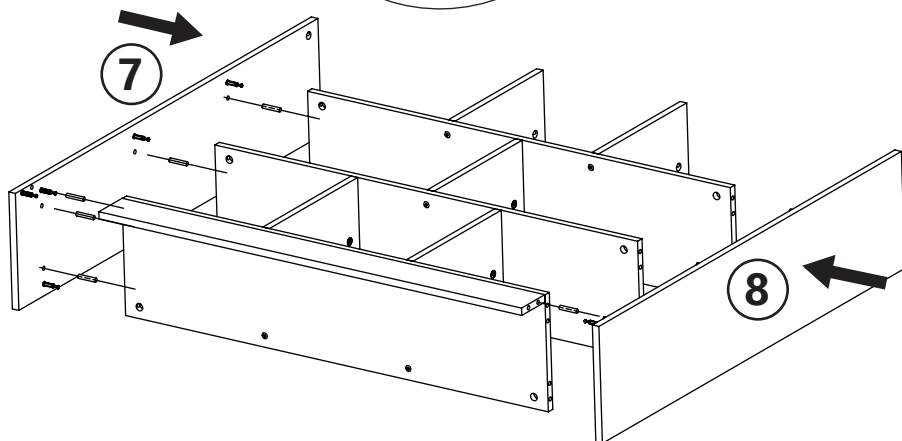
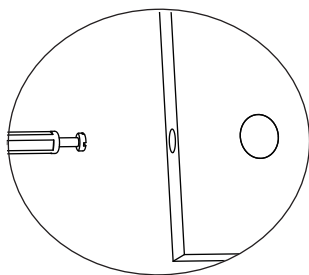

STEP 12

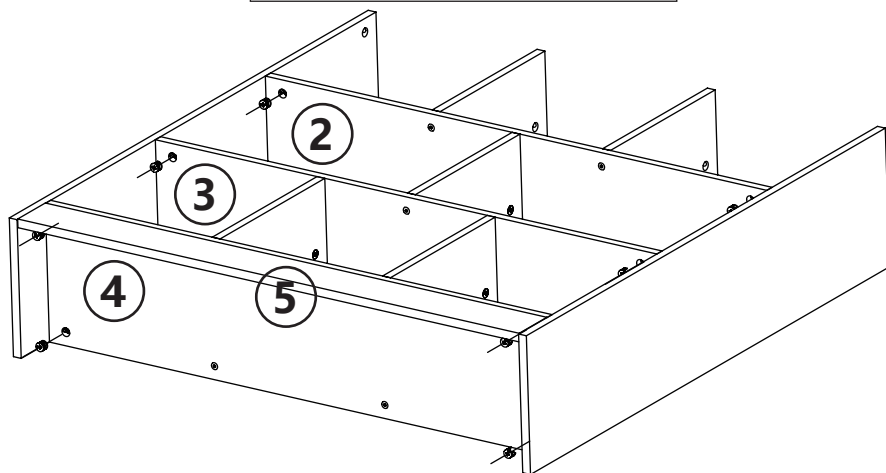
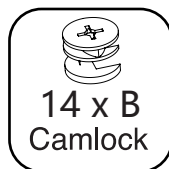
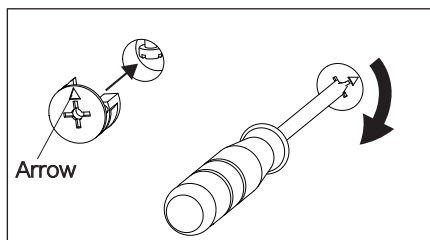

STEP 13

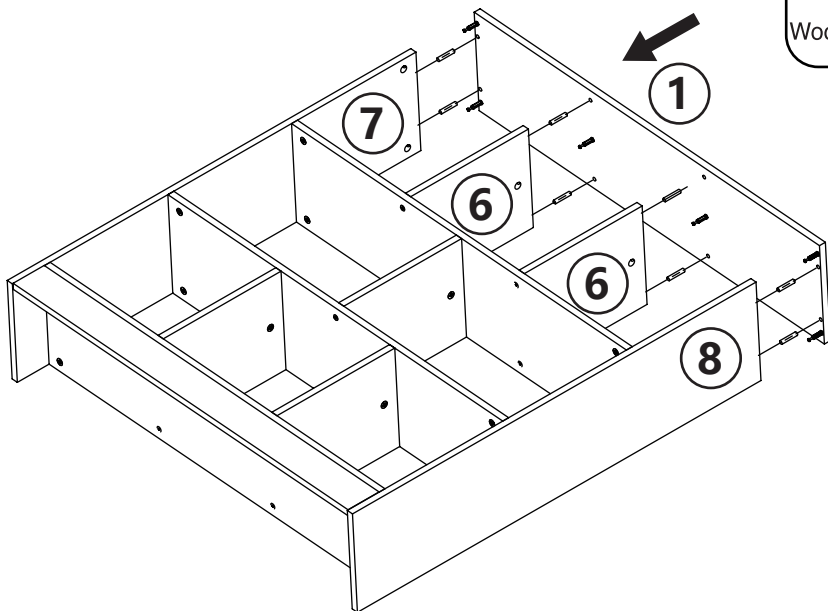
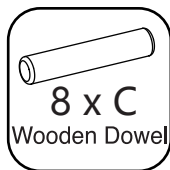

STEP 14

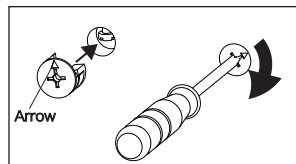
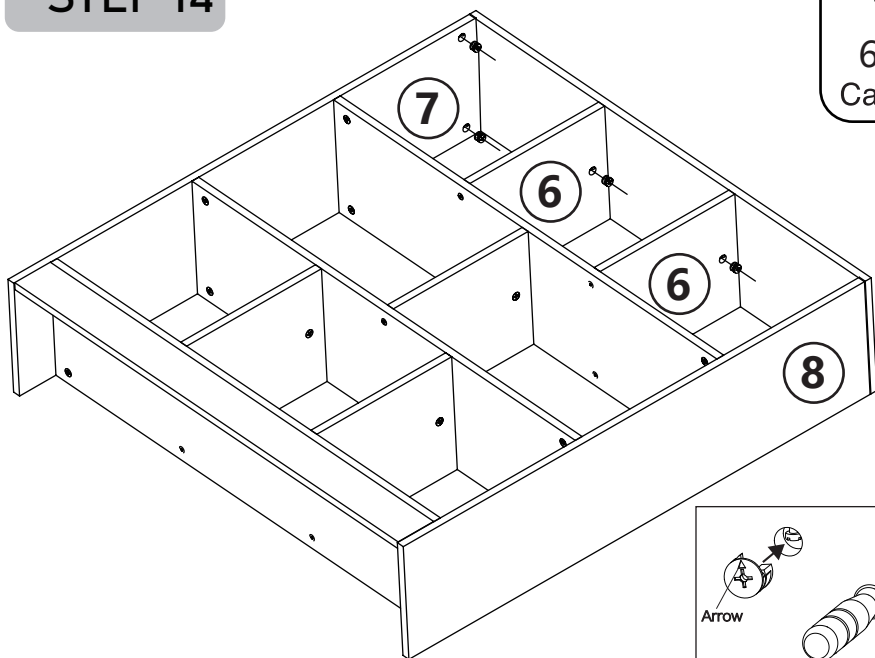
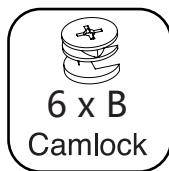

STEP 15

You can use a pencil to outline the nail to prevent it from SKEWING.

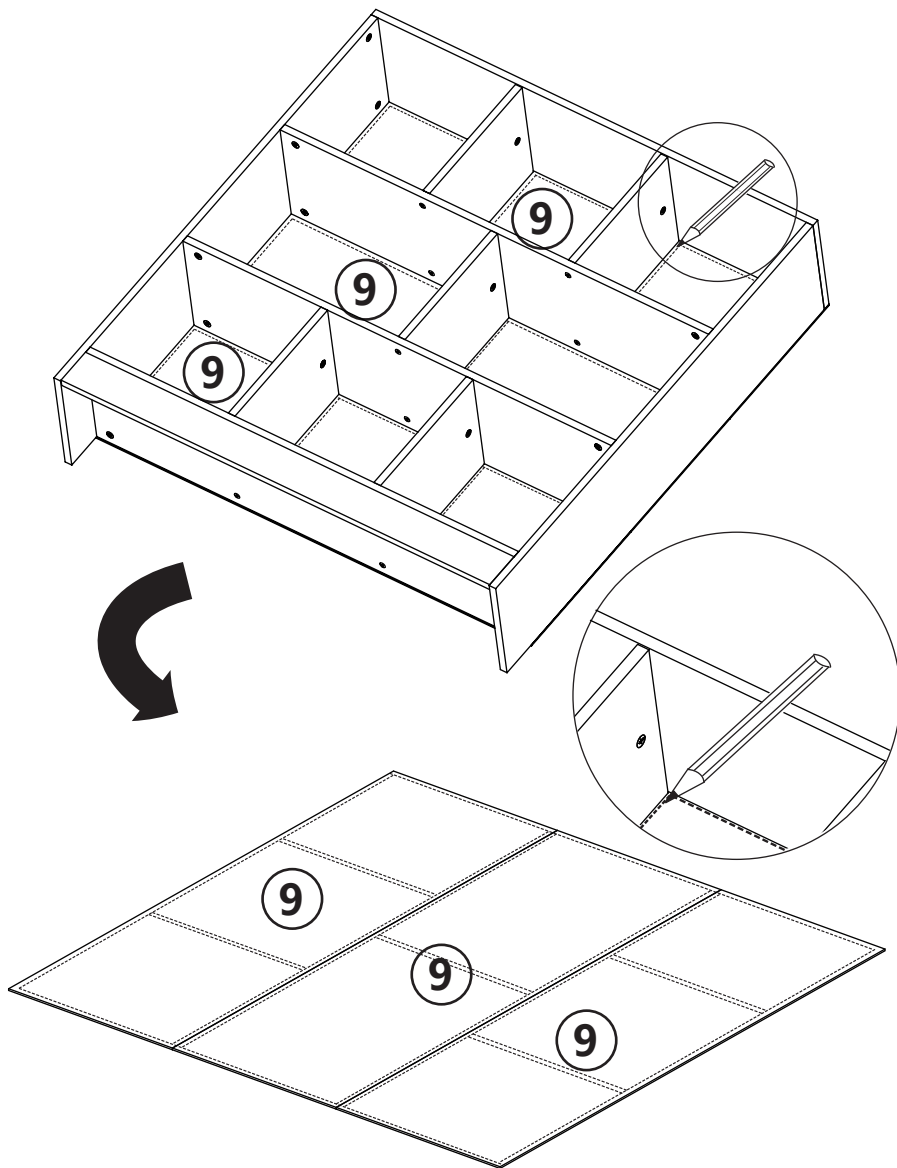

Draw lines on the back of ⑨.
Place the underlined side facing back
as the standard line for the nails.

STEP 16

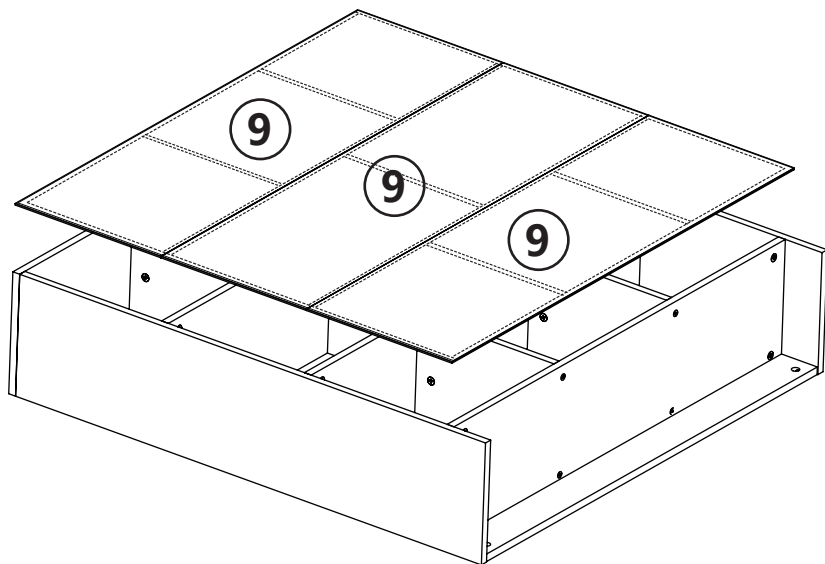

STEP 17

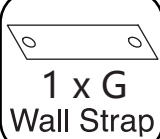
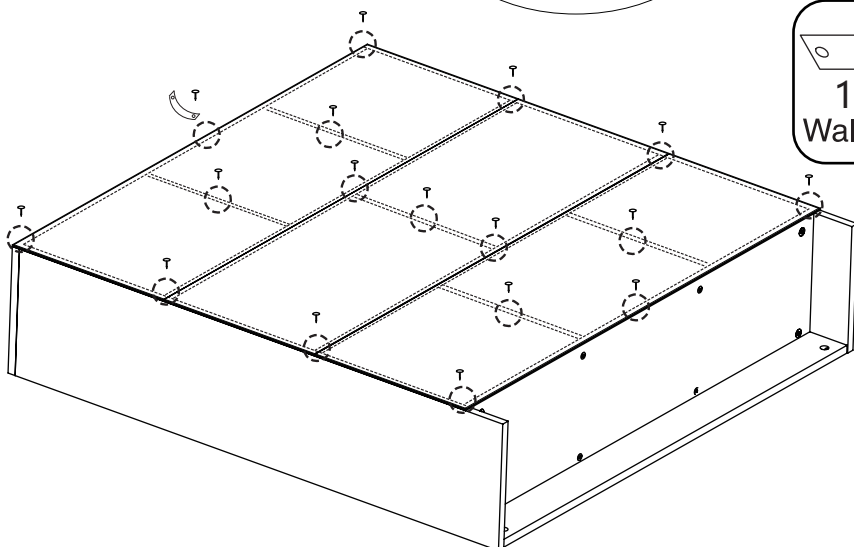
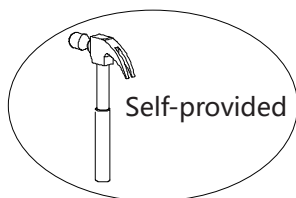

ASSEMBLE ACCOMPLISHED

If you want to fix the bookshelf to your wall, here are the steps for your reference as following. Self-provided tools are also required.

