



ITEM #5466081

12X10 Soft Top Gazebo

MODEL#GFS60055B

STYLE SELECTIONS and logo design
are trademarks or registered trademarks
of LF, LLC. All rights reserved.

ATTACH YOUR RECEIPT HERE

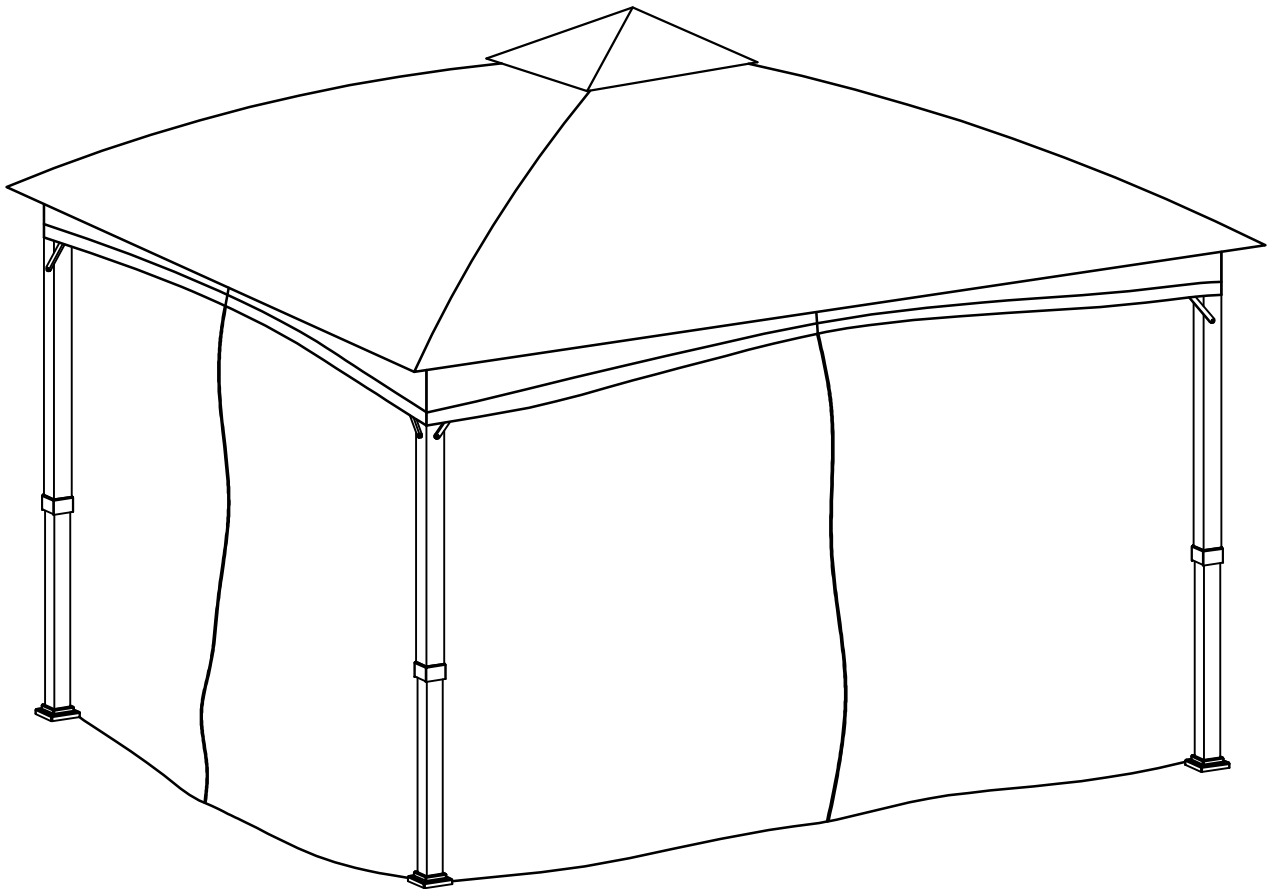

Serial Number _____ Purchase Date _____



Questions, problems, missing parts? Before returning to your retailer, call our customer service department at 877-888-8225 , 8 a.m. - 8 p.m., EST, Monday - Sunday. You may also contact us anytime at ascs@lowes.com.

SS23656

TABLE OF CONTENTS

Package Contents.....3

Hardware Contents.....4

Safety Information.....4

Preparation.....6

Assembly or Installation Instructions.....6

Care and Maintenance.....11

Warranty.....11

PRODUCT SPECIFICATIONS

SPECIFICATIONS
181.11 in W x 141.73 in D x 113.39 in H
Black Finish Frame
For outdoor use only.

PACKAGE CONTENTS

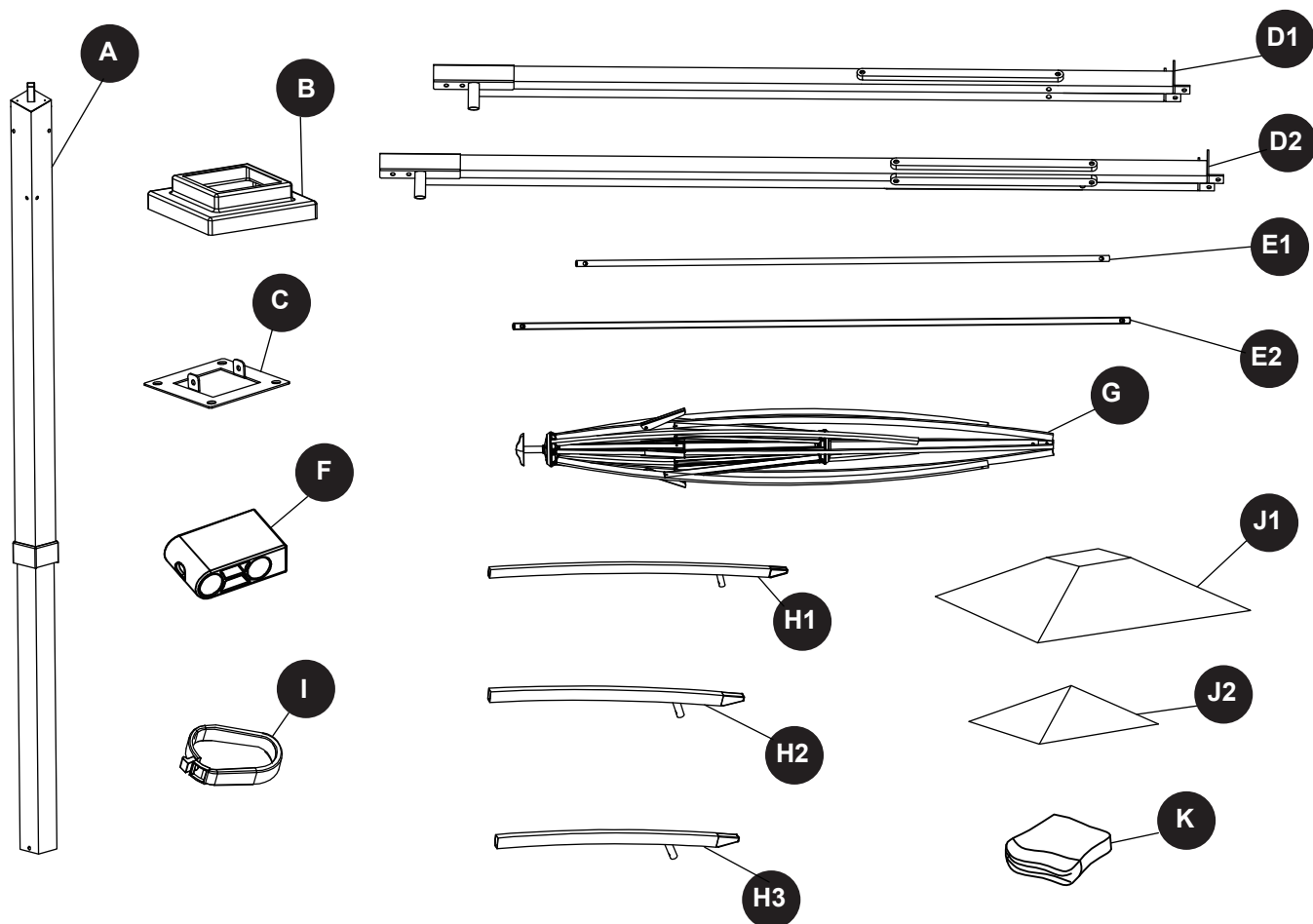

PART	DESCRIPTION	QUANTITY
A	Post	4
B	Foot Plate Cover	4
C	Foot Plate	4
D1	Fold Beam 1	2
D2	Fold Beam 2	2
E1	Short Cloth Pipe	8
E2	Long Cloth Pipe	8
F	Clothing Card	16
G	Umbrella Frame	1
H1	Corner Rafter	4
H2	Middle Rafter 1	2
H3	Middle Rafter 2	2
I	Hanging Hook	48+8
J1	Canopy	1
J2	Second Tier Canopy	1
K	Netting	1

HARDWARE CONTENTS (shown actual size)

AA

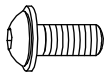

M6x15mm
Bolts
Qty. 32+2

BB

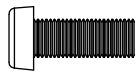

M6x15mm
Bolts
Qty. 12+1

CC

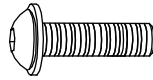

M6x25mm
Bolts
Qty. 12+1

DD

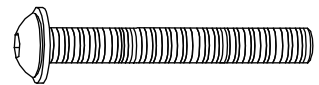

M6x65mm
Bolts
Qty. 16+1

EE

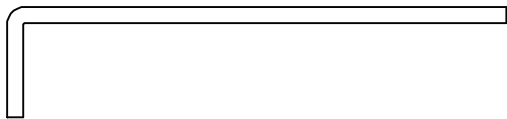

Stake
Qty. 8+1

FF

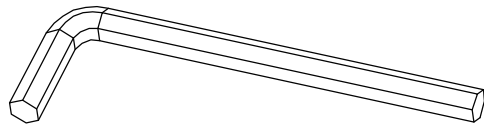

Hex key
Qty. 2



SAFETY INFORMATION

WARNING

To reduce the risk of serious injury, read the following safety instructions before assembling and using the gazebo.

Keep all flame and heat sources away from this gazebo fabric. This gazebo is made with fabric that meets CPAI-84 specifications for flame resistance. It is not fire proof, The fabric will burn if left in contact with any flame source. The application of any foreign substance to the gazebo fabric may render the flame-resistant properties ineffective.



SAFETY INFORMATION

DANGER

This unit is heavy! Do not assemble this item alone.

CAUTION

Always keep children under close supervision while they are using or around this product. Never leave children unattended.

Do not climb on top of the gazebo. Falling off the gazebo can result in serious injury, possibly even death.

- Two people are required for this assembly.
- Some parts may contain sharp edges. Wear protective gloves if necessary.
- When assembling and using this product, basic safety precautions should always be followed to reduce the risk of personal injury and damage to equipment. Please read all instructions before assembly and usage.
- This product is intended for domestic, outdoor use only.
- The product should be placed on flat, horizontal ground.
- Ensure enough clearance around the product. Before assembling the product, find level ground not less than 6' (18 m) away from any structures or obstructions such as fences, garages, houses, overhanging branches, laundry lines, or electrical wires.
- The gazebo must be anchored with stakes onto the ground for added safety. It cannot be permanently attached to a concrete floor or platform. Do not assemble the gazebo on sandy, muddy or loose soil as stakes do not have enough anchorage in these types of soil.
- In case you set up more than one gazebo, keep a minimum distance of 10' (3 m) between the gazebos.
- Any assembly or maintenance of the product must be carried out by adults only.
- Arrange necessary manpower when assembling or moving the product.
- Keep children and pets away while setting up the gazebo.
- Check all nuts and bolts periodically for tightness. When required, tighten them again.
- Repairing and replacing parts should be done by a qualified technician.
- This gazebo is intended for decorative and sunshade purposes only, and it is not designed to withstand harsh weather, including high winds, rain, and snow.
- Always remove the canopy in heavy wind conditions; otherwise, might tip over and cause damage to the product or injuries to passersby.
- Always ensure that the roof canvas is tensioned to avoid water accumulation on the roof.
- Remove accumulated water on the roof immediately, or disassemble the gazebo in order to avoid damages.
- If the product will not be used for a longer period (e.g., winter time), it should be stored in a clean, dry environment.
- Do not light any fires inside or near the product!
- Stay calm if fire breaks out. Search for the nearest exit. Do not return to the gazebo before firemen allow you to do so.
- Do not hang any weights on the roof frame.
- Do not climb onto the roof of the gazebo. Falling off the gazebo can result in serious injury.
- Retain the original packaging to store the gazebo.

PREPARATION

Before beginning assembly of product, make sure all parts are present. Compare parts with package contents list and hardware contents list. If any part is missing or damaged, do not attempt to assemble the product.

Estimated Assembly Time: 1 Hour

Additional time to install hangers on porch or structure modifications.

Tools Required for Assembly : Hex key

ASSEMBLY INSTRUCTIONS

1. Insert foot plate cover (B) and foot plate (C) into post (A) and use a hex key (FF) to tighten M6 x 15 mm bolts (AA) to fix foot plate (C) to post (A). Repeat this step for the remaining post.

Hardware Used

AA M6 x 15 mm Bolts  x 8

FF Hex key 

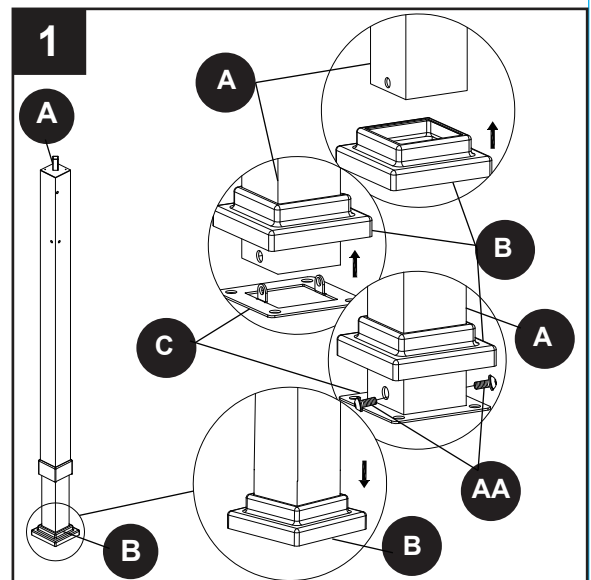

2. Expand fold beam (D1) and fold beam (D2), and then secure them with M6 x 15 mm bolts (AA). Repeat this step for the remaining fold beam.

Hardware Used

AA M6 x 15 mm Bolts  x 8

FF Hex key 

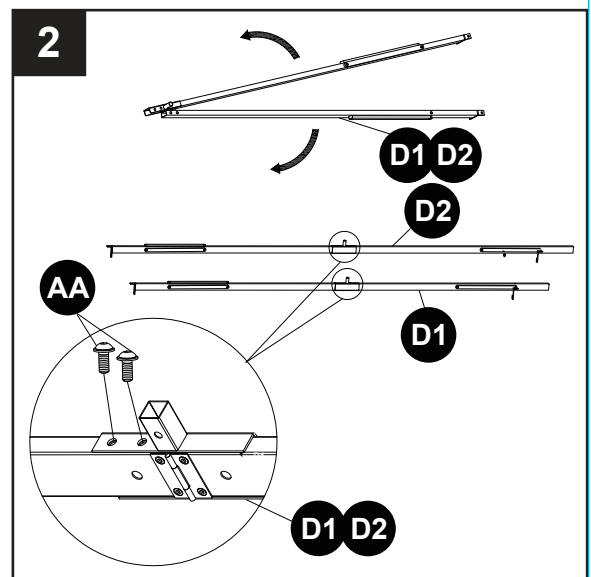

ASSEMBLY INSTRUCTIONS

3. First, use M6 x 15 mm bolts (AA) to fix fold beam 1 (D1) on post (A), then expand the support on fold beam 1 (D1), and use M6 x 25 mm bolts (CC) to fix post (A).

Hardware Used

AA M6 x 15 mm Bolts  x 8

CC M6 x 25 mm Bolts  x 4

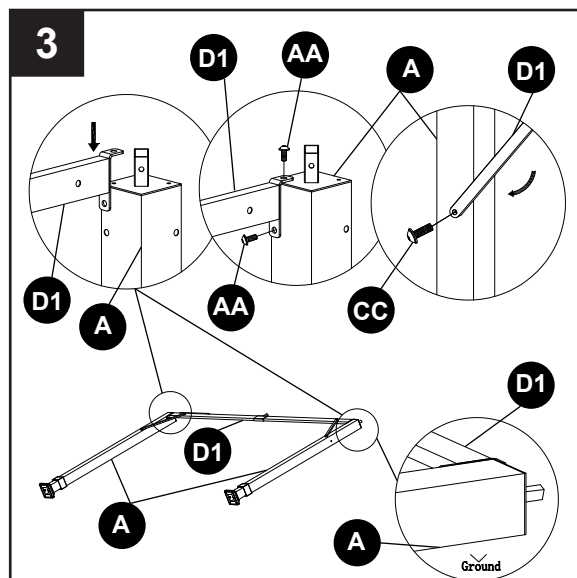

4. Use M6 x 15 mm bolts (AA) to fix fold beam 2 (D2) on post (A), then expand the support on fold beam 2 (D2) use M6 x 25 mm bolts (CC) to fix it on post (A) loosen the support above fold beam 2 (D2) and use M6 x 25 mm bolts (CC) to fix it on fold beam 1 (D1).

Hardware Used

AA M6 x 15 mm Bolts  x 8

CC M6 x 25 mm Bolts  x 8

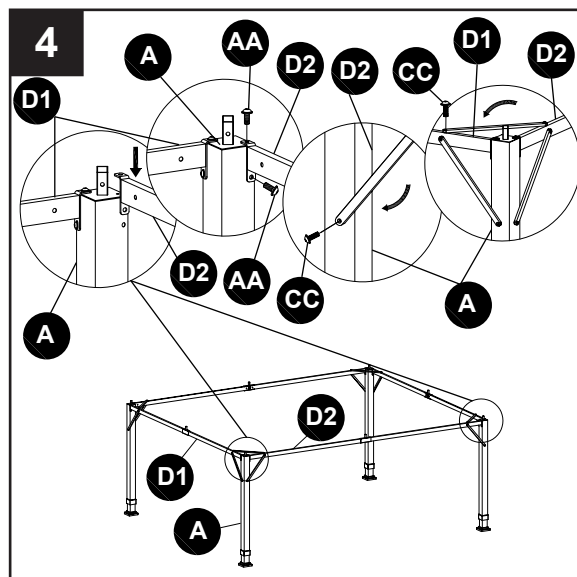

5. Insert two ends of short cloth pipe (E1) into clothing card (F) and fix them on fold beam 1 (D1) with M6 x 65 mm bolts (DD). Then insert two ends of long cloth pipe (E2) into clothing card (F) and fix them on fold beam 2 (D2) with M6 x 65 mm bolts (DD).

Hardware Used

DD M6 x 65 mm Bolts  x 16

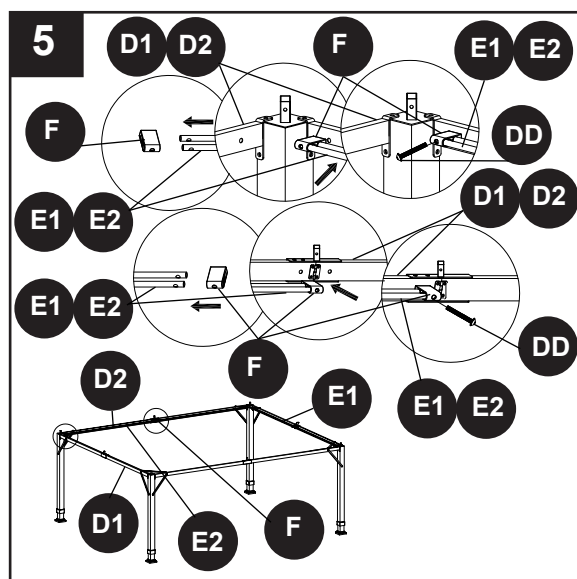

ASSEMBLY INSTRUCTIONS

6. The umbrella frame (G) is first propped open and then secured with a latch.

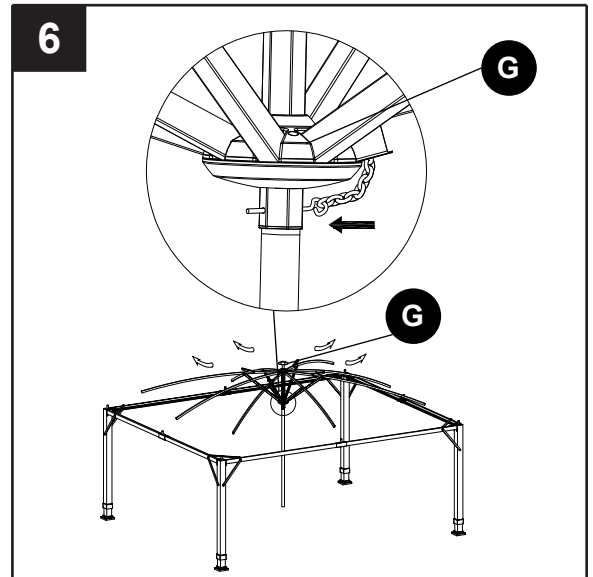

7. First insert the ends of corner rafter (H1) or middle rafter 1 (H2) or middle rafter 2 (H3) into the umbrella frame (G) as shown. The silver push buttons on parts (H1 or H2 or H3) should make an audible click and protrude from the holes of the umbrella frame (G) when securely connected. Then insert the ends of corner rafter (H1) into the post (A), middle rafter 1 (H2) into fold beam 2 (D2) and middle rafter 2 (H3) into fold beam 1 (D1) as shown. The silver push buttons on parts (H1 or H2 or H3) should make an audible click and protrude from the holes of the post (A) or fold beam 2 (D2) or fold beam 1 (D1) when securely connected.

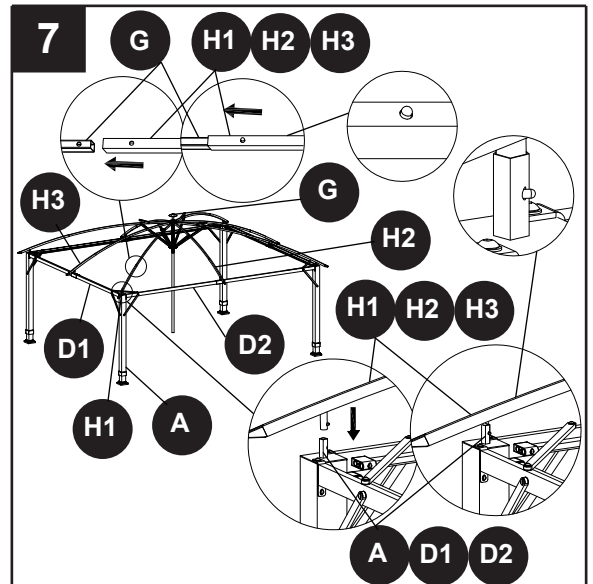

8. Insert the canopy (J1) into the umbrella frame (G).

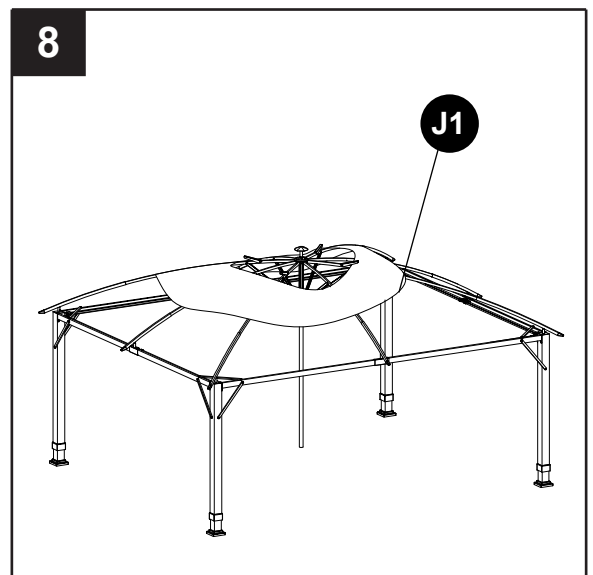

ASSEMBLY INSTRUCTIONS

9. Fix the four corners of second tier canopy (J2) to the top piece of the second floor

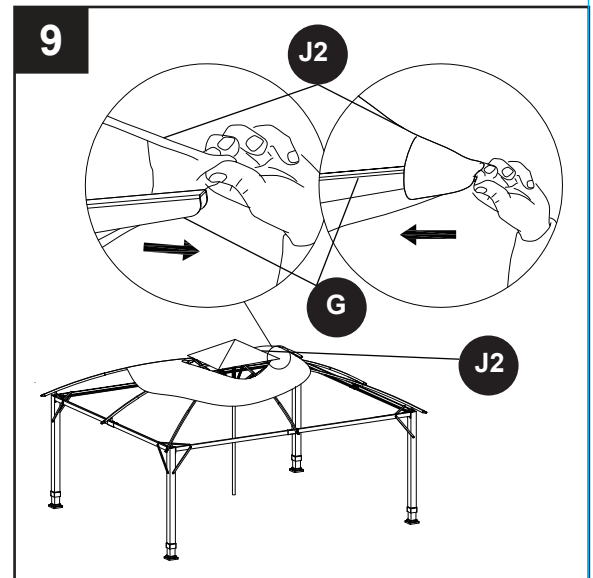

10. Fix canopy (J1) on corner rafter (H1), middle rafter 1 (H2) and middle rafter 2 (H3), and then fix the middle and four corners of the hanging edge with an adhesive.

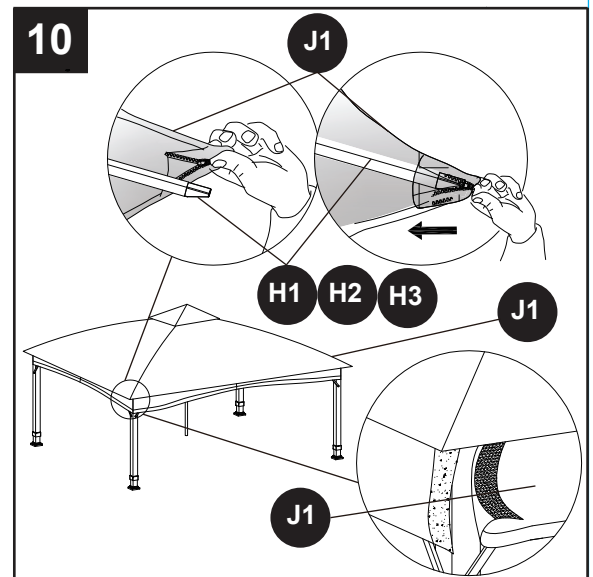

11. Raise post (A) and fix it with M6 x 15 mm bolts (BB) (preferably with all 4 feet). Unscrew the tube on umbrella frame (G).

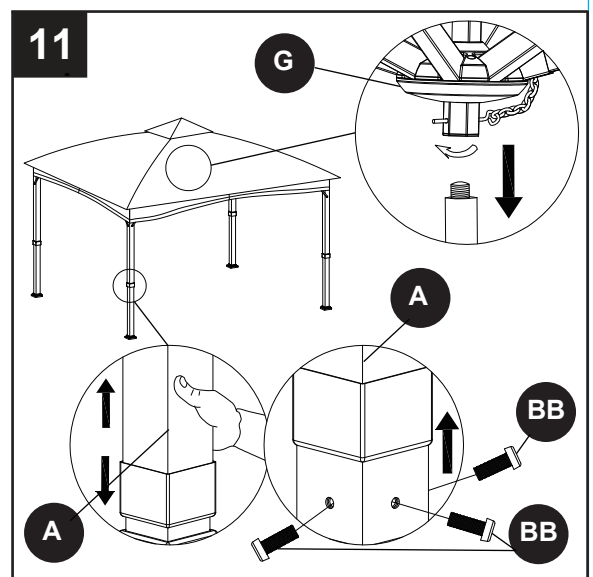

Hardware Used

BB M6 x 15 mm Bolts x 12



ASSEMBLY INSTRUCTIONS

12. First load hanging hook (I) into netting (K), and then buckle the loaded hanging hook (I) into short cloth pipe (E1) and long cloth pipe (E2). Finally, lift foot plate cover (B) and fix stake (EE) to the ground. (Note: stake (EE) can only be used with grass or soft soil.)

Hardware Used

EE Stake  x 8

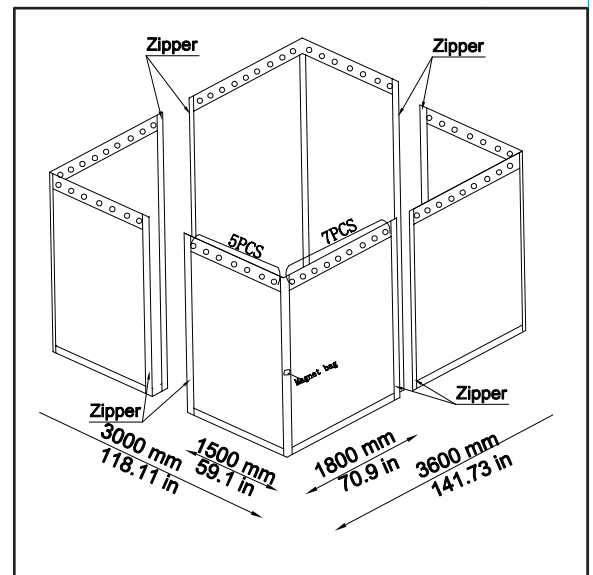
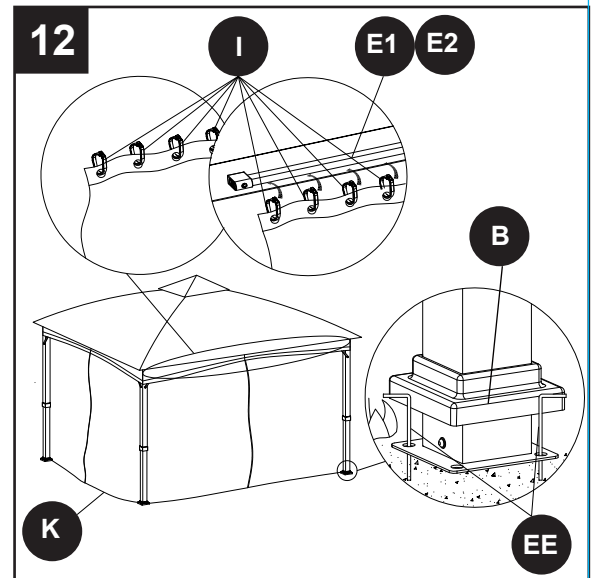

CARE AND MAINTENANCE

- Be careful to never allow water to build up in frames as this will cause corrosion and freeze damage in cold climates. Wash all frames with a solution of mild soap and water, Rinse with clean water and dry with a soft absorbent cloth towel. Frames can be treated with a liquid wax for maximum protection against UV rays and/or salty, damp air. Canopy may be cleaned by hand with a solution of soap and water with a clean water rinse. Never machine wash the canopy as this will result in shrinkage or damage. Never use a commercial or home dryer to tumble dry fabric goods. Do not use bleach or solvents to clean any product! This will void the warranty.

WARRANTY

3-Year Limited Warranty

For a period of three (3) year after date of purchase, the Manufacturer will either repair or replace defective components in accordance with this Limited Warranty. This warranty is between the Manufacturer and the original purchaser and is valid only when accompanied by the original purchaser's sales receipt showing original date of purchase and location of purchase. Replacements under this warranty revert back to the date of original purchase for future warranty.

The Manufacturer or its authorized dealer can accept or reject warranty claims based on its findings. This warranty applies in normal residential use only and is not intended for commercial use, The Manufacturer can make substitutions as required of materials, components, and sub-components of comparable value and utility. This warranty is limited to product repair or replacement (to be determined solely by the Manufacturer). Warranty return is limited to only the single affected component.

This limited warranty covers only manufacturing defects and does not cover normal wear and tear, damage due to acts of nature (such as, but not limited to freezing or high winds), abuse or misuse, including chemical damage from suntan oil or other chemicals, exposure to extreme heat or cold, abrasion or excessive weight.

This product is intended to be used in standard installations only. This warranty is void if the product is not used for its intended purpose, The Manufacturer disclaims liability for any aspect of installation and any inconvenience caused by a defective part of a component.

Certain items are not covered by this warranty, These include, but are not limited to the following:

1. Components subjected to abuse, including abuse intended to simulate failure.
2. Damages caused by retailer, shipper or installation crew (such as scratches, dents, tears, chips, etc).
3. Any part which merely exhibits normal wear yet functions essentially as new, including chips, scratches or stretching of materials and stitching.
4. Tears, punctures, scratches or any damage caused by improper installation or use.
5. Damage to frames/welds resulting from improper assembly or exposure to water and/or sub-freezing temperatures is not covered. General frame rusting is not covered.
6. Fading and/or discoloration of fabrics/cushions/straps/wicker resulting from exposure to the elements chemicals, oils, fluids or any other cause are not covered.
7. Umbrella bases are not covered under any circumstances.
8. Items sold "as is" or floor models.

To make a claim, call the toll-free number below. Please have available a copy of the original sales receipt along with a brief description of the problem. Please also provide your email address and daytime telephone or cell phone number. All items may be charged actual freight costs plus \$15 for handling. Repairs or replacement will be made at the Manufacturer's option. Sales and use taxes, plus shipping and handling charges are the responsibility of the consumer.

THIS IS THE ENTIRE EXCLUSIVE EXPRESS LIMITED LIABILITY. THE MANUFACTURER NEITHER MAKES NOR IS RESPONSIBLE FOR ANY OTHER WARRANTIES, EITHER EXPRESS

WARRANTY

OR IMPLIED INCLUDING THOSE OF RETAILING DEALERS. THIS EXCLUSIVE REMEDY IS LIMITED TO RECEIPT OF A CREDIT IN CONNECTION WITH THE REPAIR OR REPLACEMENT OF ANY PRODUCT OR COMPONENT DEEMED TO BE DEFECTIVE UNDER THE TERMS AND CONDITIONS AS STATED IN THIS WARRANTY. NEITHER THE PRODUCT MANUFACTURER NOR ITS AGENTS SHALL BE LIABLE IN ANY CASE FOR INCIDENTAL, INDIRECT, SPECIAL OR CONSEQUENTIAL DAMAGES RESULTING FROM THE USE OF THIS PRODUCT OR ARISING OUT OF ANY BREACH OF THIS WARRANTY OR NEGLIGENCE EVEN IF IT HAS BEEN ADVISED OF THE POSSIBILITY OF SUCH DAMAGES, EXCEPT AS OTHERWISE MAY BE REQUIRED BY LAW, THERE ARE NO OTHER EXPRESS OR IMPLIED WARRANTIES OTHER THAN THE WARRANTY DESCRIBED HEREIN, AND ALL OTHER WARRANTIES, INCLUDING IMPLIED WARRANTY OF MERCHANTABILITY OR FITNESS FOR A PARTICULAR PURPOSE ARE EXPRESSLY DISCLAIMED.