

# 10-INCH SEMI-FLUSHMOUNT LIGHT

Español p. 12

ATTACH YOUR RECEIPT HERE

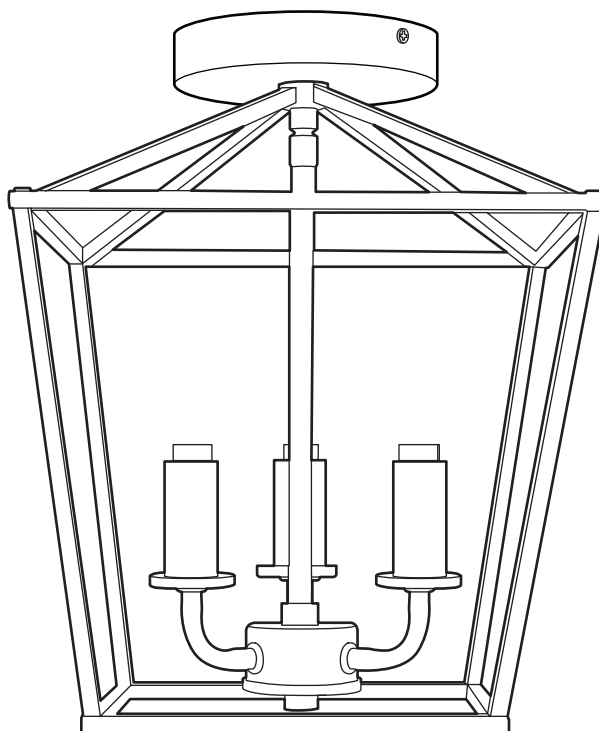

APPROVED FOR USE  
IN DAMP LOCATIONS

Purchase Date \_\_\_\_\_



**Questions, problems, missing parts?** Before returning to your retailer, contact us on:  
**800-527-1292**, 8:30 a.m. - 5 p.m., CST, Monday - Friday.

**TABLE OF CONTENTS**

Package Contents ..... 2

Hardware Contents ..... 3

Safety Information ..... 3

Preparation ..... 4

Assembly Instructions ..... 5

Care and Maintenance ..... 11

Troubleshooting ..... 11

Warranty ..... 11

**PACKAGE CONTENTS**

| PART | DESCRIPTION   | QUANTITY       |
|------|---|----------------|
| A    | Mounting Strap  | 1              |
| B    | Fixture   | 1              |
| C    | Hex Nut<br>(preassembled to fixture (B))                  | 1              |
| D    | Star Washer<br>(preassembled to fixture (B))              | 1              |
| E    | Canopy  | 1              |
| F    | Mounting Strap Screw<br>(preassembled mounting strap (A)) | 2              |
| G    | Support Rod   | 4              |
| H    | Screw<br>(preassembled to support rod (G))                | 4<br>+ 2 extra |
| I    | Rod   | 4              |
| J    | Frame   | 1              |
| K    | Base  | 1              |
| L    | Post<br>(preassembled to base (K))                        | 4              |

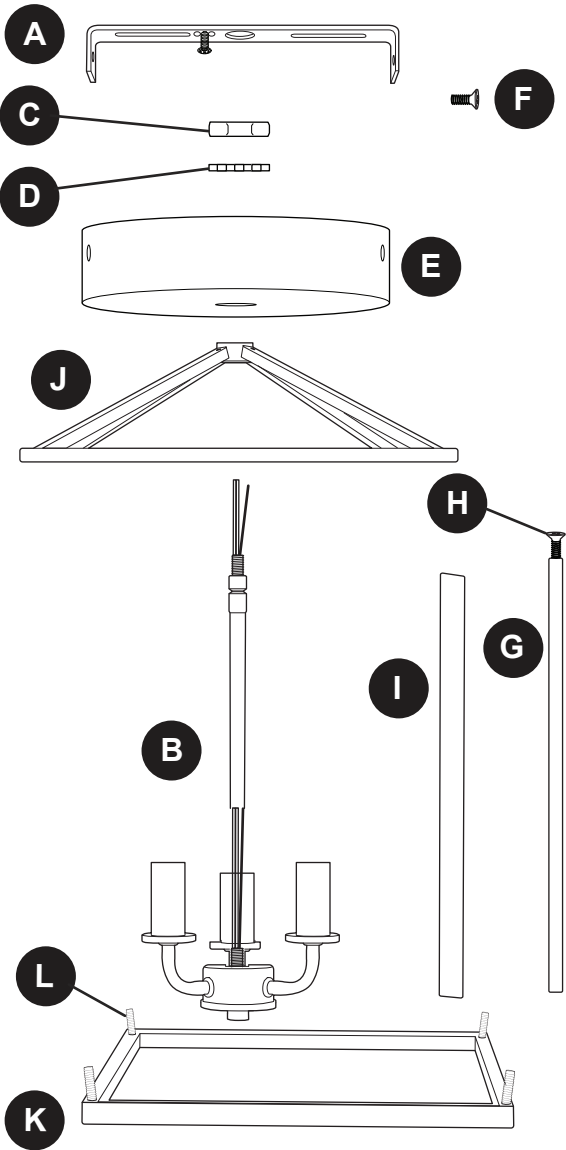

## HARDWARE CONTENTS (shown actual size)

---

AA

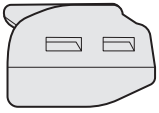

Lever Wire  
Connector

Qty. 3

BB

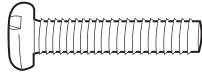

Machine  
Screw

Qty. 2

CC

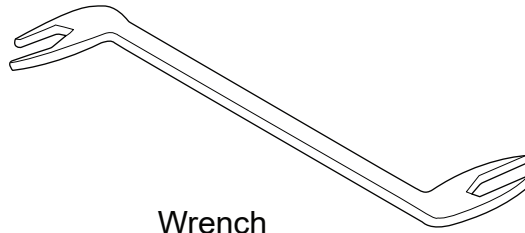

Wrench

Qty. 1

## SAFETY INFORMATION

---

**READ AND SAVE THESE INSTRUCTIONS.**

### DANGER

- For your protection and safety, carefully read and understand the information provided in this manual completely before attempting to assemble, install or operate this product. Failure to do so could lead to electrical shock, fire or other injuries that could be hazardous or even fatal.
- **TURN OFF ELECTRICITY** at main fuse box (or circuit breaker box) before beginning installation by removing the fuse (or switching the circuit breaker off).
- **DO NOT** connect this fixture to an electrical system that does not provide a means for equipment grounding. Never use a fixture in a two-wire system that is not grounded. Installing a fixture into an electrical system not having a proper grounding means could cause metal parts of the fixture to carry electrical currents if any of the fixture wires, wire connections or splices were to become broken, cut or loose during the mounting or normal operation of the fixture. Under this condition, anyone coming in contact with the fixture would be subject to electrical shock, which could cause serious injury or death.
- **DO NOT** connect the BARE or GREEN insulation fixture ground wire to the BLACK (HOT) current-carrying wire or the WHITE (NEUTRAL) house wire. Connection of the BARE or GREEN fixture ground wire to the BLACK or WHITE house wires may cause metal parts of the fixture to carry electrical currents. Under this condition anyone coming in contact with the fixture will receive electrical shock, which could cause serious injury or death.
- **DO NOT** damage or cut the wire insulation (covering) during installation of fixture. **DO NOT** permit wires to contact any surface having a sharp edge. To do so may damage or cut the wire insulation, which could cause serious injury or death from electrical shock.

### WARNING

- All electrical connections must be in agreement with local codes and ordinances, the National Electric Code (NEC) and ANSI/NFPA 70-1999. Contact your municipal building department to learn about your local codes, permits and/or inspections. Risk of fire – most dwellings built before 1985 have supply wire rated for 140 ° F. Consult a qualified electrician before installation.
- To avoid personal injury, the use of gloves may be necessary while handling fixture parts with sharp edges.

## SAFETY INFORMATION

---

### WARNING

- DO NOT suspend any fixture by the house wires. A fixture must always be mounted directly to a mounting strap which is first attached to the outlet box. Wire connectors will not support the weight of a fixture. Suspending a fixture by the house wires and wire connectors will result in the fixture falling, with the possibility of personal injury and the danger of electrical shock or fire.
- To reduce the risk of fire, electrical shock, or personal injury, wire connectors provided with this light fixture are designed to accept only one 12-gauge house wire and two lead wires from the light fixture. If your house wire is larger than 12-gauge or there is more than one house wire to connect to the corresponding fixture lead wires, consult an electrician for the proper size wire connectors to use.
- To reduce the risk of damage to the fixture, DO NOT use power tools to assemble any part of the fixture.

### CAUTION

- If you are not sure the lighting system has a grounding means, DO NOT attempt to install this fixture. Contact a qualified, licensed electrician for information regarding the proper grounding methods as required by the local electrical code in your area.
- All fixtures must be mounted to an outlet box that is supported by the building structure.
- DO NOT use bulb having a wattage greater than the maximum value stated on the fixture. The use of a bulb with higher wattage than specified will increase temperatures and risk of fire.
- If a dimmer control switch is used with this fixture, obtain professional advice to determine the correct type to use as well as the electrical rating required.

## PREPARATION

---

Before beginning assembly of product, make sure all parts are present. Compare parts with package contents list and hardware contents list. If any part is missing or damaged, do not attempt to assemble the product.

### **Estimated Assembly Time: 30 minutes**

Tools Required for Assembly (not included): Flathead Screwdriver, Phillips Screwdriver, Wire Strippers, Pliers, Wire Cutters, Safety Glasses, Stepladder, Electrical Tape

Helpful Tools (not included): A/C Tester Light, Do-It-Yourself Wiring Handbook, Soft Cloth

## ASSEMBLY INSTRUCTIONS

1. Turn off circuit breakers and wall switch to the fixture supply line leads.

**⚠ DANGER:** Failure to disconnect power supply prior to installation may result in serious injury or death.

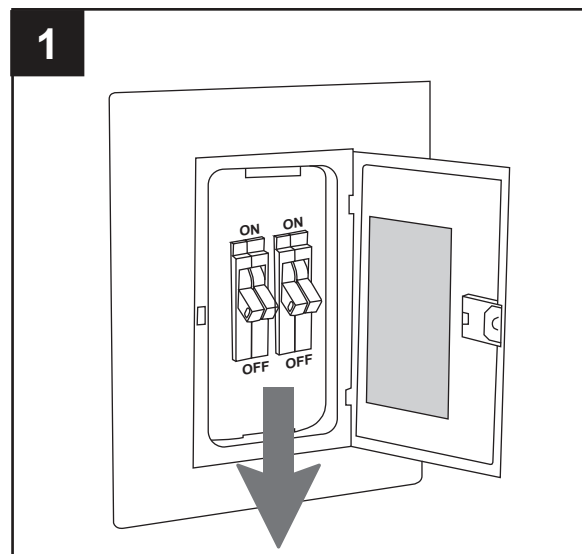

2. Remove existing fixture and disconnect all electrical wiring.

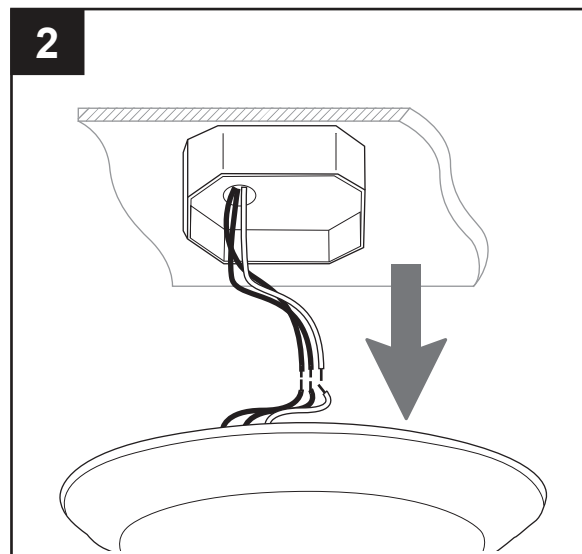

3. Remove mounting strap screws (F) from mounting strap (A).

Save mounting strap screws (F) for later use.

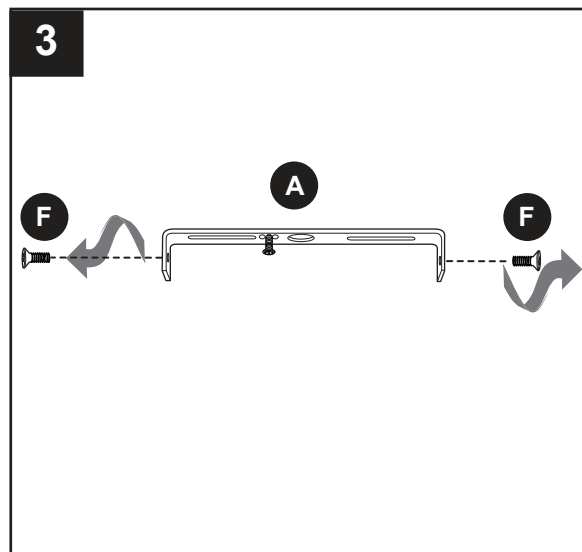

## ASSEMBLY INSTRUCTIONS

4. Attach mounting strap (A) to outlet box (not included) using existing washers and outlet box screws or the machine screws (BB). Tighten machine screws (BB) to secure mounting strap (A).

**NOTE:** If the outlet box screws required for your outlet box are of a different size than the machine screws (BB), consult a licensed electrician before proceeding.

**! CAUTION:** Make sure the outlet box can support 35 lbs. hanging weight. Use *metal* outlet box; plastic outlet boxes are not recommended.

### Hardware Used

**BB** Machine Screw  x 2

5. Remove screws (H) from support rods (G).

Save screws (H) for later use.

6. Place base (K) on a flat surface. Thread one support rod (G) into a post (L). Repeat with remaining support rods (G) and posts (L).

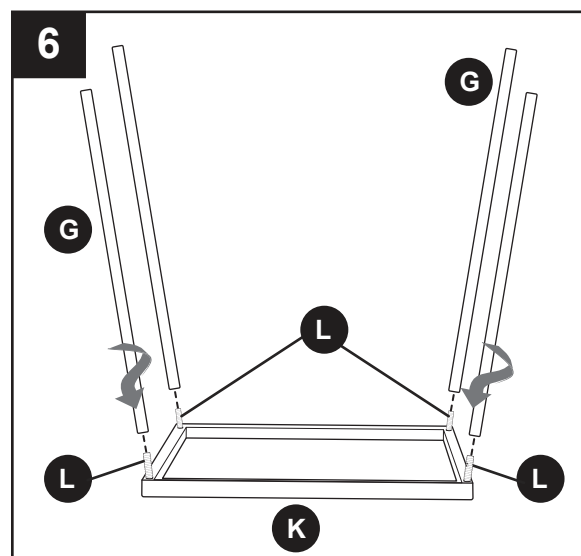
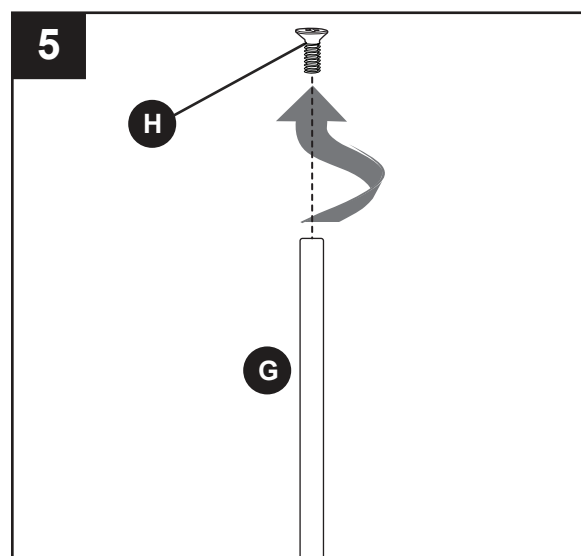
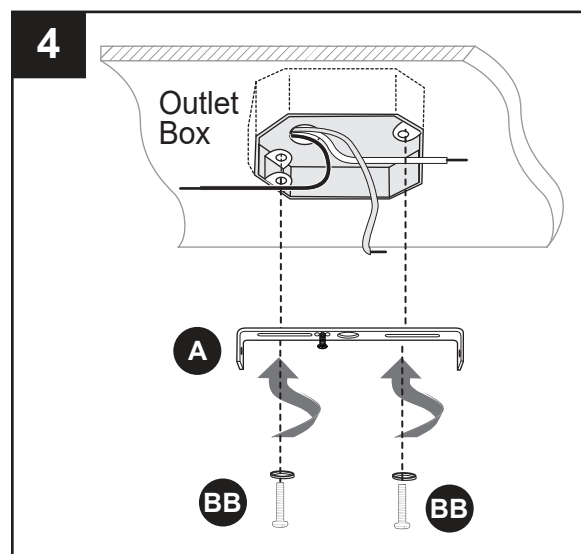

## ASSEMBLY INSTRUCTIONS

7. Slide one rod (I) over each support rod (G).

**NOTE:** Make sure to turn each rod (I) so that rods (I) and base (K) are flush against each other.

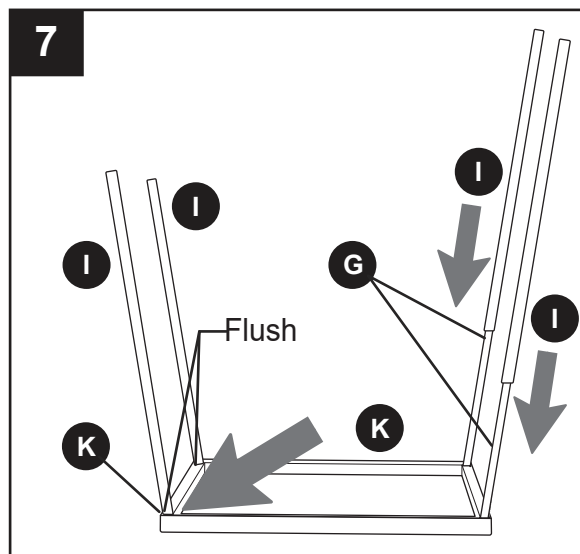

8. Place frame (J) on top of rods (I), aligning holes on frame (J) with holes in support rods (G). Re-insert screws (H) previously removed (Step 5, page 6) and partially tighten screws (H).

**NOTE:** Do not completely tighten screws (H) until frame (J) has all screws (H) partially attached.

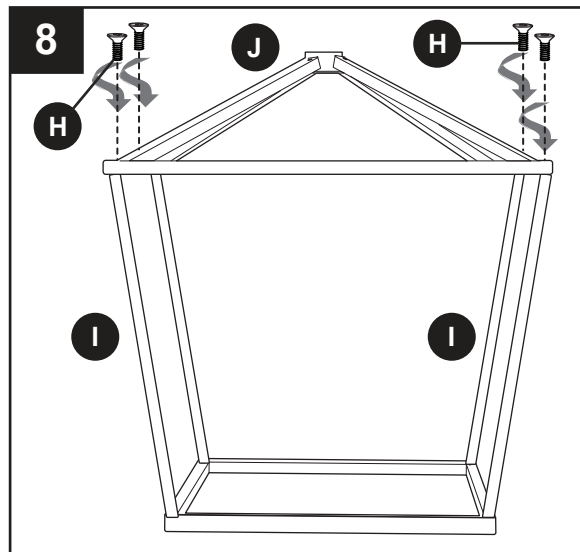

9. Attach fixture rod to fixture (B).

Remove hex nut (C) and star washer (D) from threaded rod on top of fixture rod.

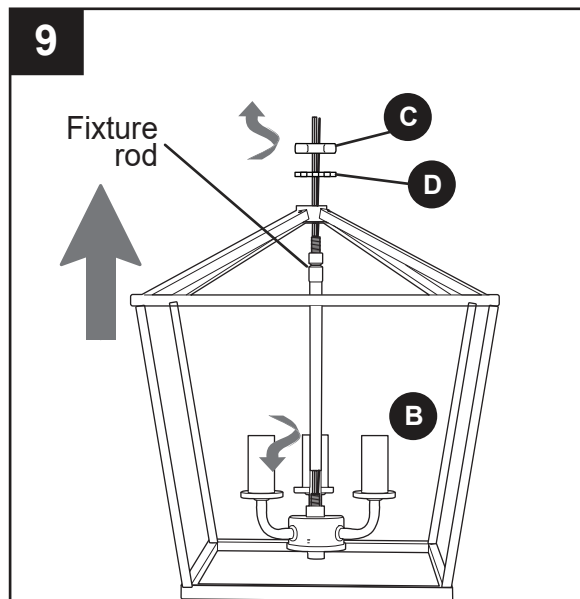

## ASSEMBLY INSTRUCTIONS

10. Unwrap BARE fixture wire from BLACK and WHITE fixture wires. Thread wiring and threaded rod from top of fixture (B) through the hole on the upper part of frame (J) and the bottom of canopy (E).

Attach fixture (B) to canopy (E) by replacing star washer (D) and hex nut (C) on threaded rod on top of fixture (B). Tighten hex nut using wrench (CC).

**NOTE:** Fixture (B) may spin as you are attaching canopy (E). Simply hold fixture (B) by the rod to tighten hex nut (C).

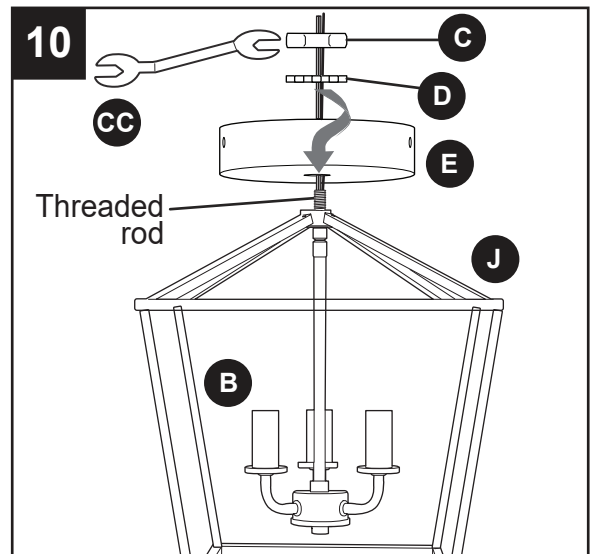

### Hardware Used

- CC** Wrench  x 1

11. Prepare wires by stripping 3/8 in. of insulation from wire ends using wire strippers (not included).

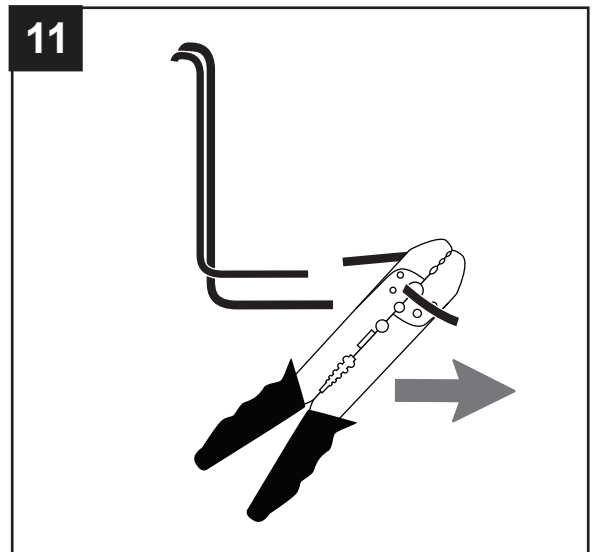



## ASSEMBLY INSTRUCTIONS

12. **IMPORTANT:** Each wire connection is made by firmly raising the levers on each lever wire connector (AA). Then, ONE wire is inserted into each opening.
- Insert BARE/GREEN ground wire from outlet box and BARE ground wire from fixture (B) into openings in lever wire connector (AA).
- Insert WHITE wire from fixture (B) and WHITE wire from outlet box into openings in lever wire connector (AA).
- Insert BLACK wire from fixture (B) and BLACK wire from outlet box into openings in lever wire connector (AA).

**! WARNING:** NEVER connect ground wire to WHITE or BLACK power supply wires.

**! WARNING:** In order for wire connections to be secure, all levers on the lever wire connectors (AA) must be completely returned to their original position. GENTLY pull on wires in each lever wire connector (AA) to confirm the lock is engaged and that wires are secure.

**! WARNING:** To reduce the risk of fire, electrical shock or personal injury, lever wire connectors (AA) are designed to accept only one 12-gauge house wire and one lead wire from the light fixture. If your house wire is larger than 12-gauge or there is more than one house wire to connect to the corresponding fixture lead wires, consult an electrician for the proper size lever wire connectors to use.

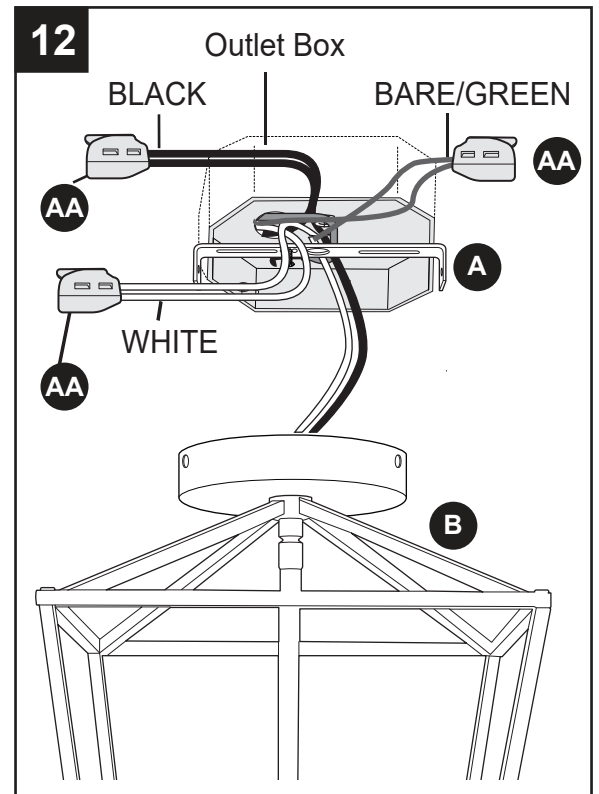

### Hardware Used

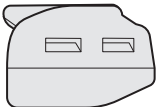
- AA** Lever Wire Connector  x 3

## ASSEMBLY INSTRUCTIONS

13. Wrap electrical tape (not included) around each individual lever wire connector (AA) down to the wire. Push lever wire connectors (AA) gently back into outlet box. Carefully push excess wiring into outlet box.

**⚠ WARNING:** Make sure no bare wire or wire strands are visible after making connections.

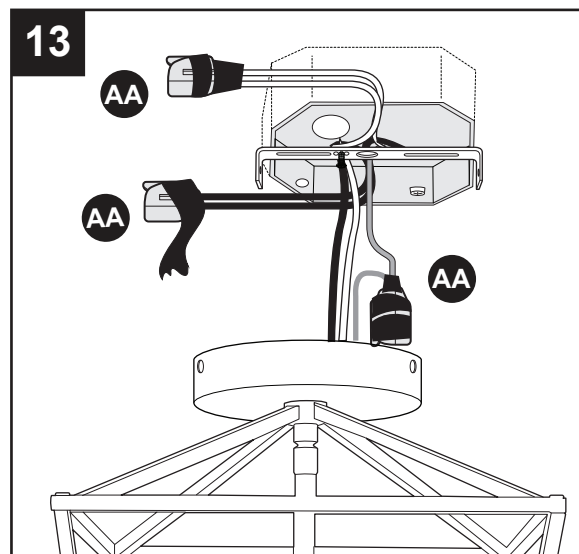

14. Attach canopy (E) to mounting strap (A) using the mounting strap screws (F) previously removed (Step 3, page 5).

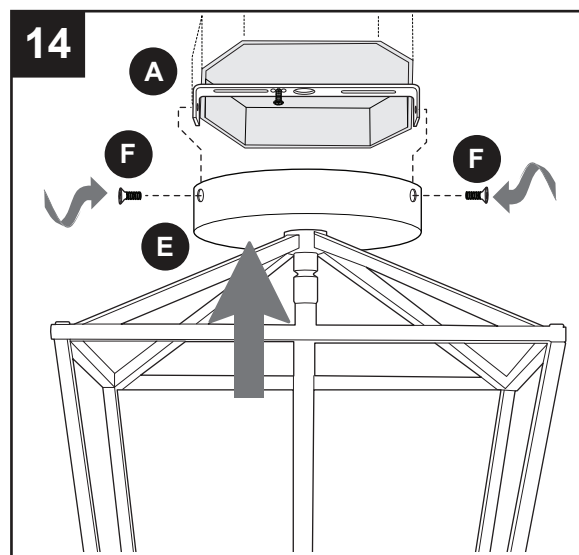

15. Install 3 candelabra-base 60-watt max. incandescent bulbs (not included) or CFL/LED equivalent.

**IMPORTANT:** When replacing bulb(s), please allow bulb(s) to cool down before touching.

Restore power and test fixture (B).

If lights do not function, please refer to TROUBLESHOOTING on the following page.

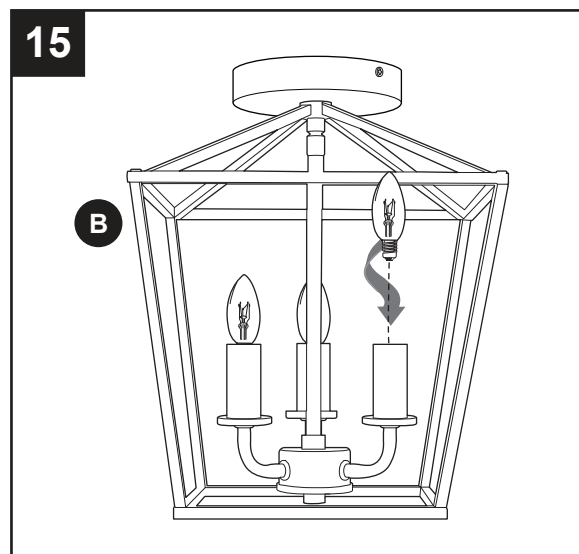

## CARE AND MAINTENANCE

---

- Shut off main power supply. Wipe with soft cloth. Do not use an abrasive cleaner.

## TROUBLESHOOTING

---

**⚠ WARNING:** Before beginning work, shut off the power supply to avoid electrical shock.

| PROBLEM                                  | POSSIBLE CAUSE   | CORRECTIVE ACTION   |
|--|--|---|
| Bulb(s) will not light.                  | 1. Bulb(s) is/are burned out.<br>2. Power is OFF.<br>3. Faulty connection. | 1. Replace light bulb(s).<br>2. Make sure power supply is ON.<br>3. Check wiring and all connections. |
| Fuse blows out or circuit breaker trips. | 1. Crossed wires.<br>2. Power wire is grounding out.                       | 1. Check wiring.<br>2. Check all connections.   |

## WARRANTY

---

The distributor warrants all of its lighting fixtures against defects in materials and workmanship for one (1) year from the date of purchase. If within this period the product is found to be defective, take a copy of the bill of sale as a proof of purchase and the product in its original carton to the place of purchase. The distributor will, at its option, repair, replace or refund the purchase price to the consumer. All costs of installation and removal of the fixture is the responsibility of the consumer. This warranty does not cover fixtures becoming defective due to misuse, accidental damage or improper handling and/or installation and specifically excludes liability for direct, incidental or consequential damages. As some states do not allow exclusions of limitations on an implied warranty, the above exclusion and limitation may not apply. This warranty gives you specific rights and you may also have other rights which may vary from state to state.