

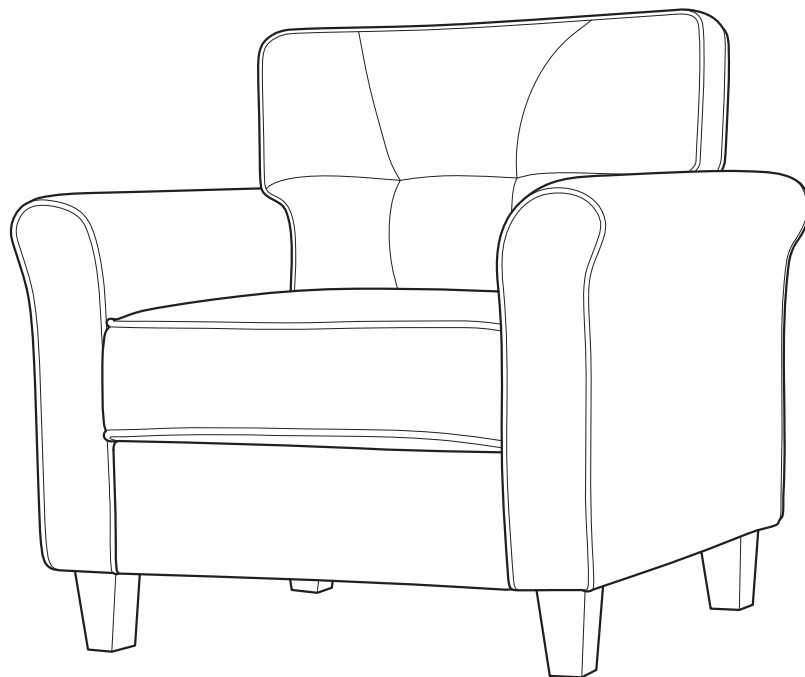

LIFESTYLE
S O L U T I O N S

CHAIR ASSEMBLY INSTRUCTIONS



WARNING

- This product has been designed for seating one (1) average adult. To prevent injury and damage to this unit, PROHIBIT jumping on it.
- This product is designed for home use and not intended for commercial use.
- Children under the age of 5, small infants and babies should not sleep alone on this product for safety reasons.
- Recommended # of people needed for handling: 2 (however it is always better to have an extra hand.)
- THIS INSTRUCTION BOOKLET CONTAINS **IMPORTANT** SAFETY INFORMATION. PLEASE READ AND KEEP FOR FUTURE REFERENCE.

PARTS

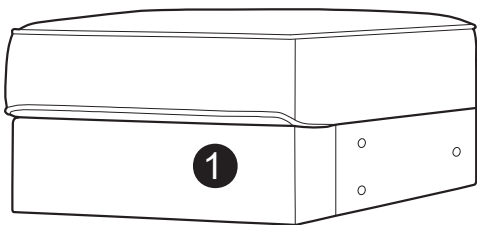

Seat Body
QTY:1

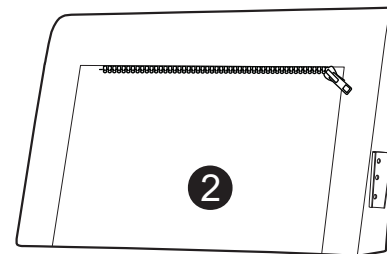

Backrest
QTY:1

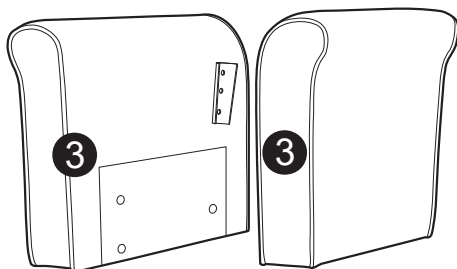

Arm
QTY:1 Pair
(In the storage underneath of seat body)

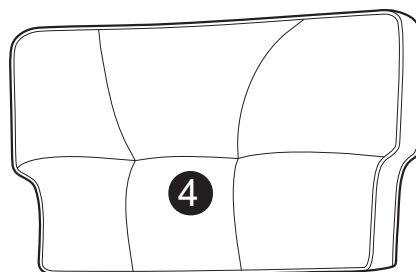

Back Cushion
QTY:1



Leg
QTY:4



M10 Washer
(Outer Dim. 45mm)
QTY:4

HARDWARE

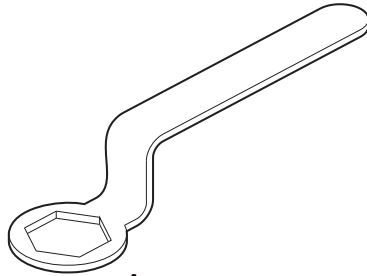

A
Spanner
14mm
QTY : 1 PC



B
Threaded Rod
M8 x 70mm
QTY : 6 PCS

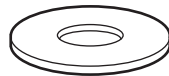

C
Washer
M8 x 22mm
QTY : 6 PCS



D
Spring Washer
M8
QTY : 6 PCS

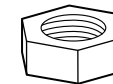

E
Nut
M8
QTY : 6 PCS

Step 1 : Carefully unpack parts/hardware from box and storage of seat body, place on a clean flat surface.

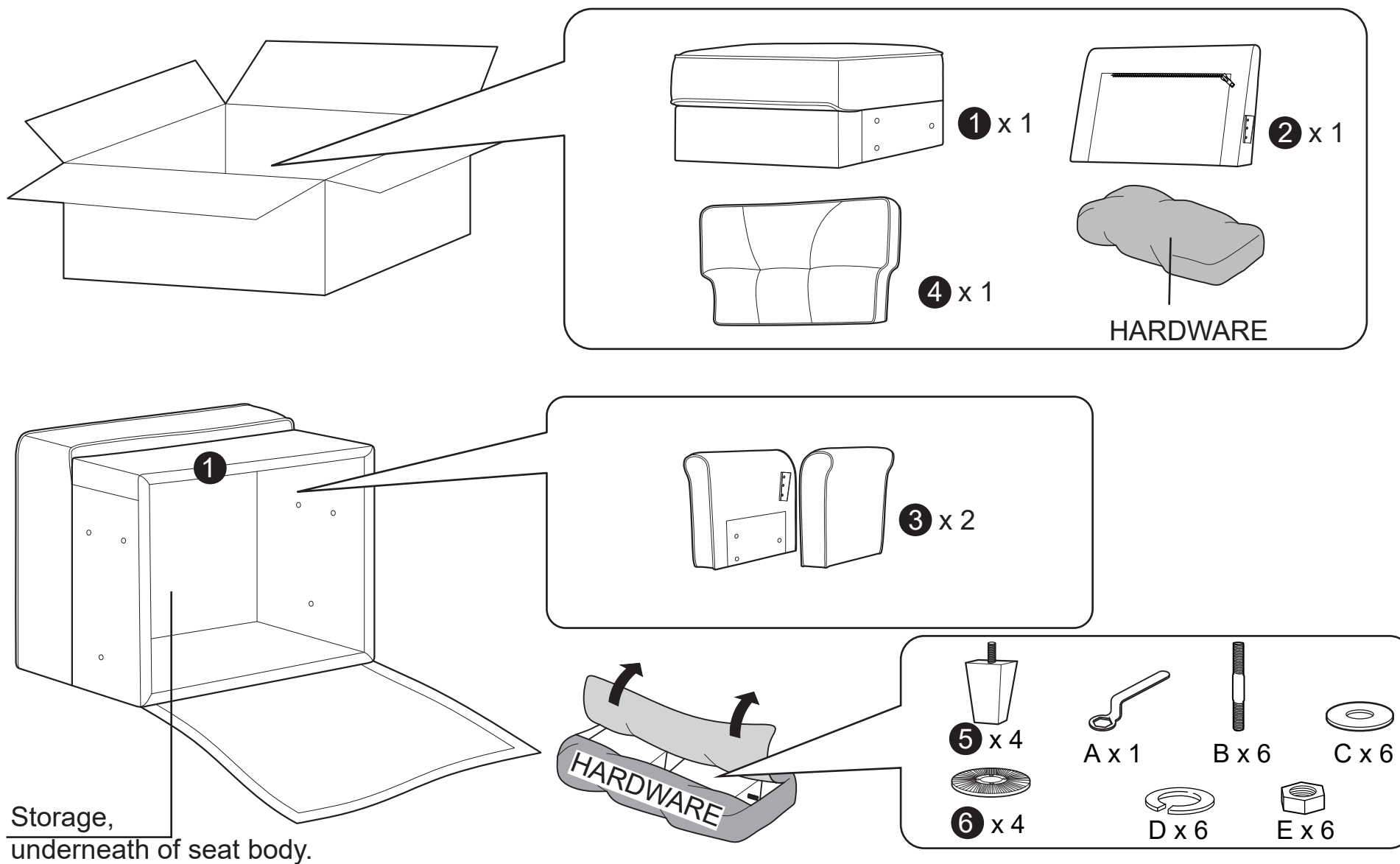

Step 2 : Screw in three threaded rods into pre-drilled holes of armrest by hand until about half of the thread is exposed. Repeat steps for other armrest.

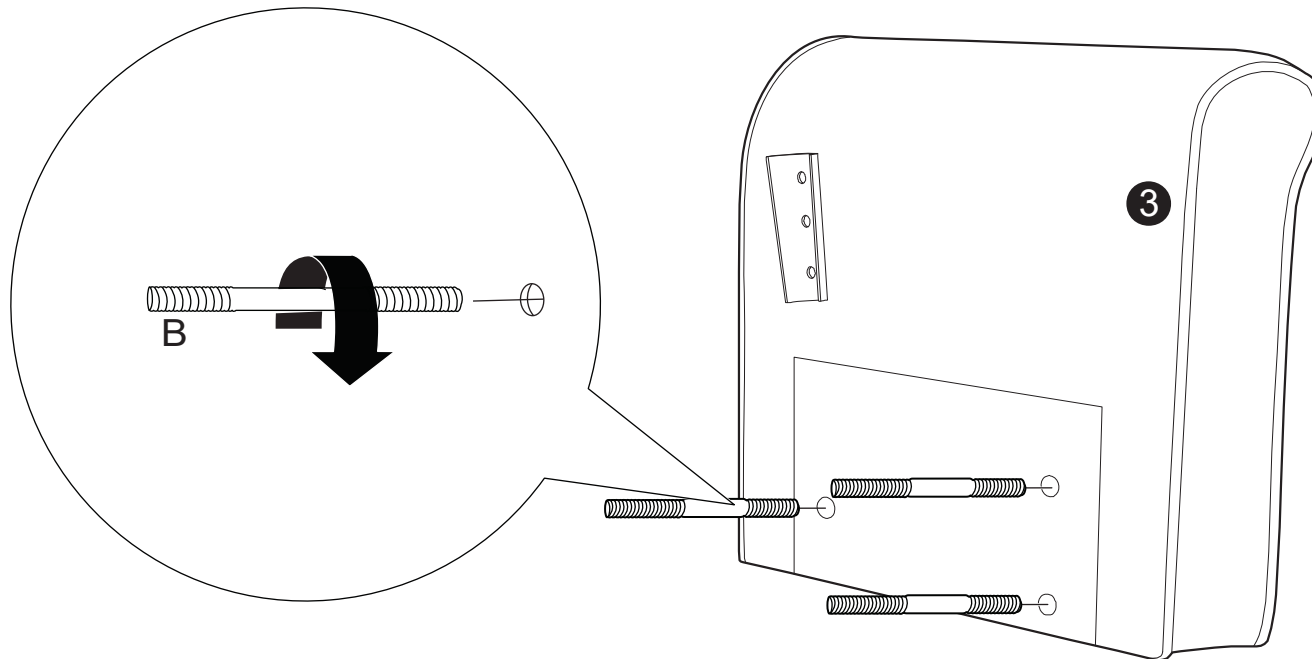
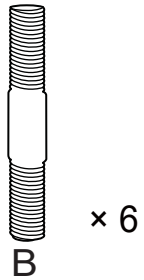

Step 3 : Locate pre-drilled holes on the side of sofa body and match the orientation with the correct armrest.

Now, carefully join armrest (with the three threaded rods exposed) with sofa body by aligning and going through the three pre-drilled holes at the side of sofa body.

Open compartment cover underneath the sofa base and secure all three threaded rods with flat washers, spring washers and nuts from inside with spanner, making sure there is no movement.

Repeat step for other armrest.

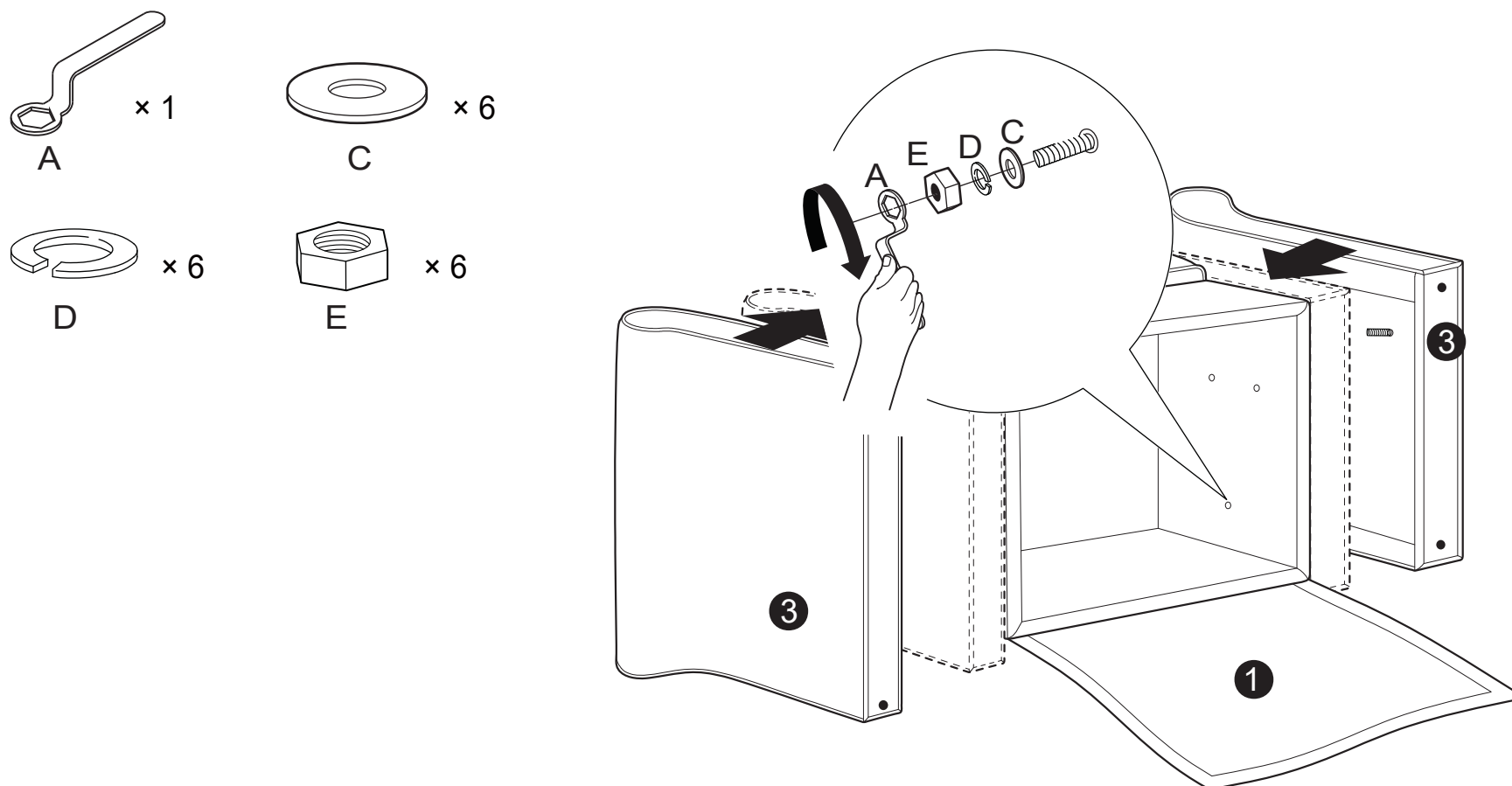

Step 4: Align all four legs onto pre-drilled holes and secure by hand.
Please avoid overtightening.



5 x 4

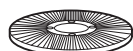

6 x 4

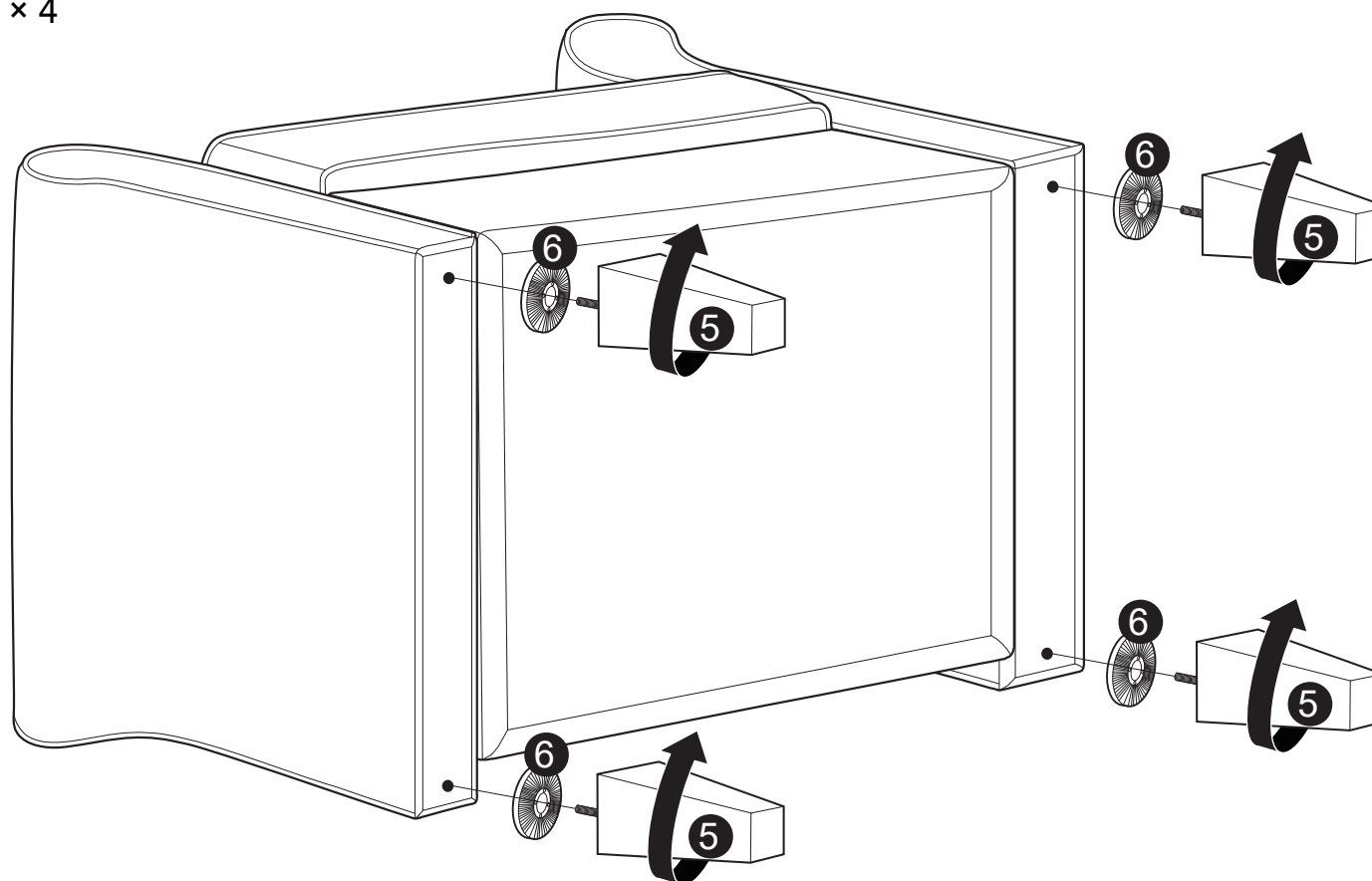

Setp 5 : Insert backrest metal plates to both arms as shown below.
Ensuring it is correctly in place.

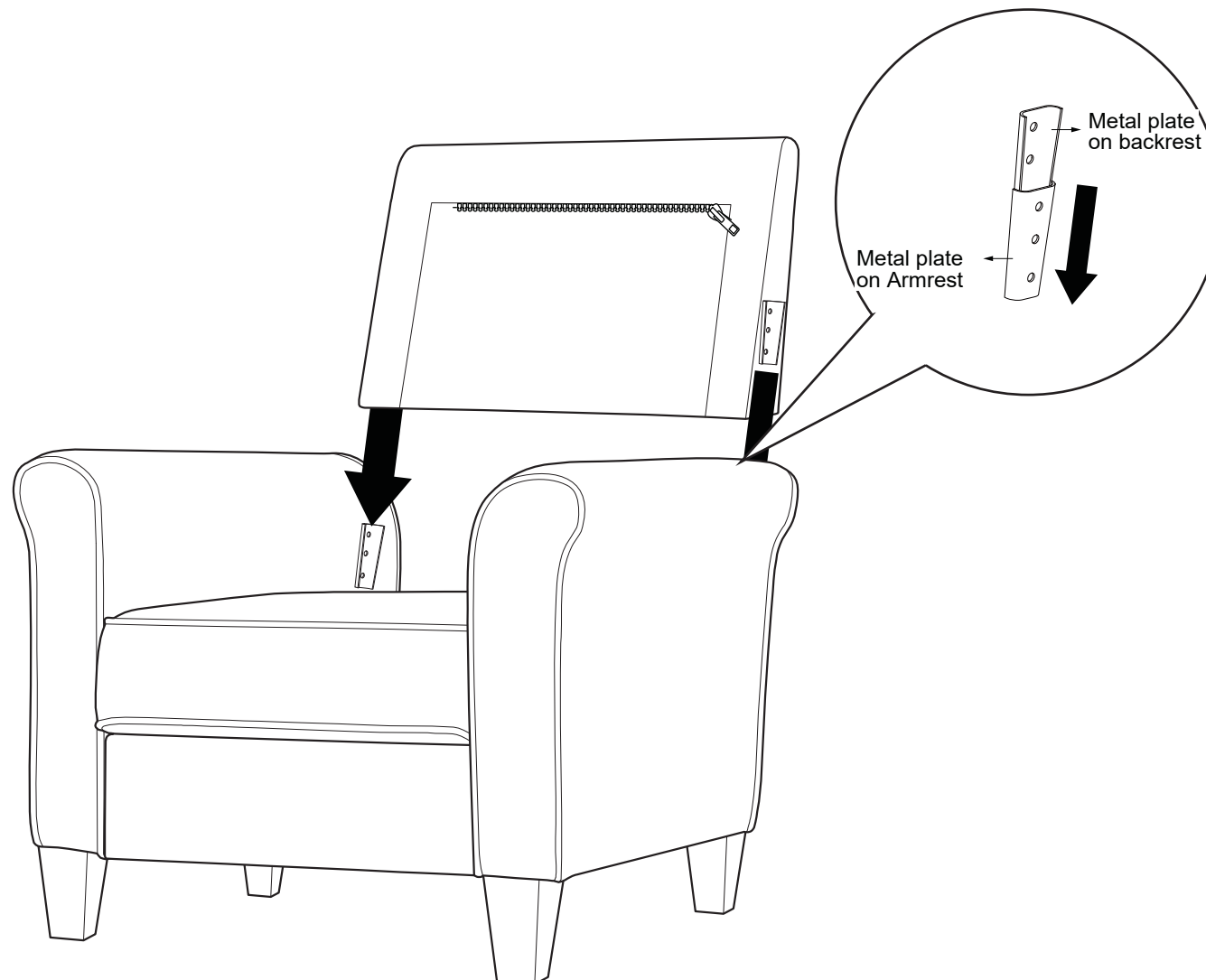

Setp 6 : Secure both back cushions by locating the zipper end. Fasten both sides and continue all the way to the end. Flip the pillow into position when finished.

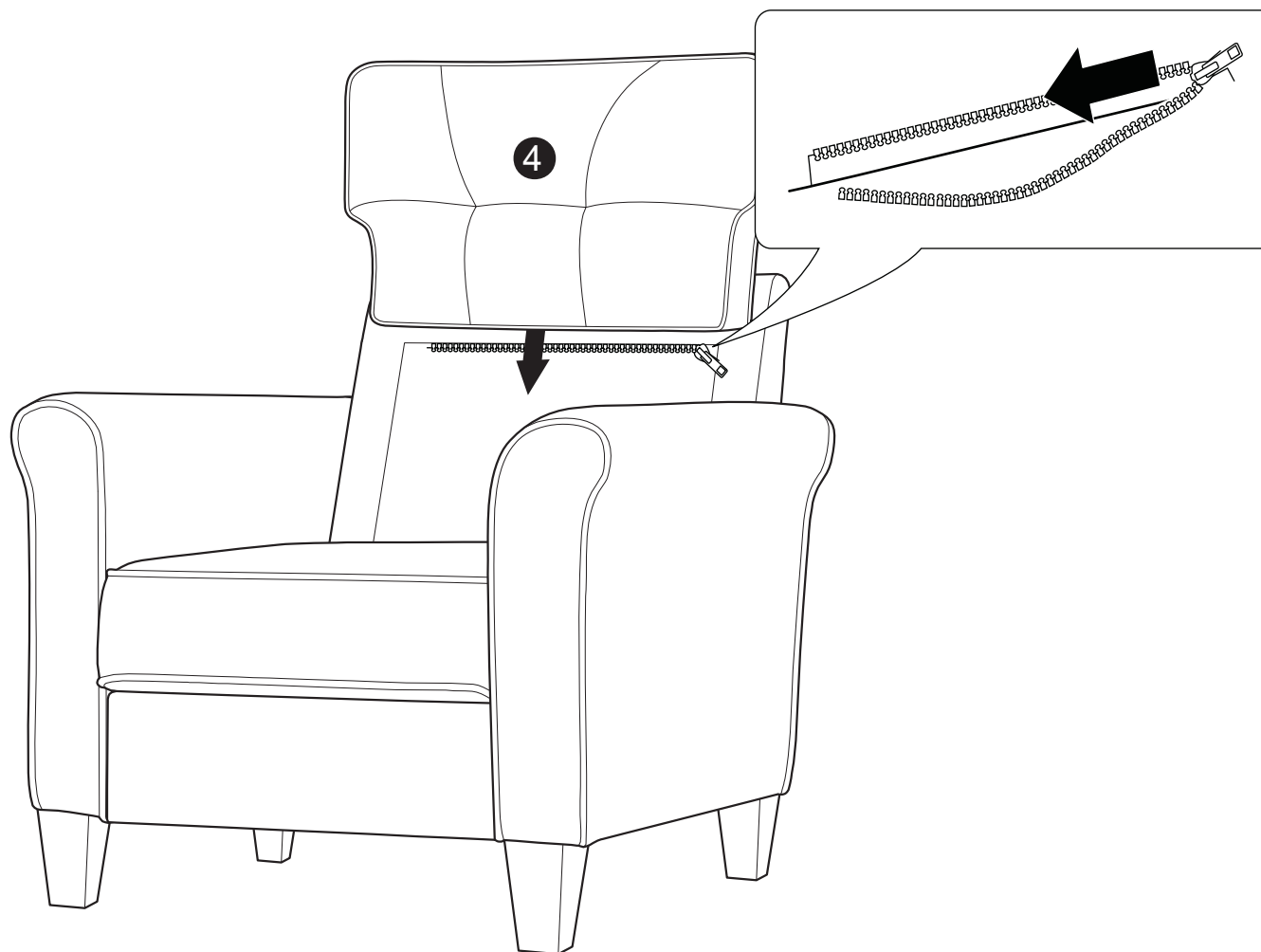

INSTALLATION COMPLETE :

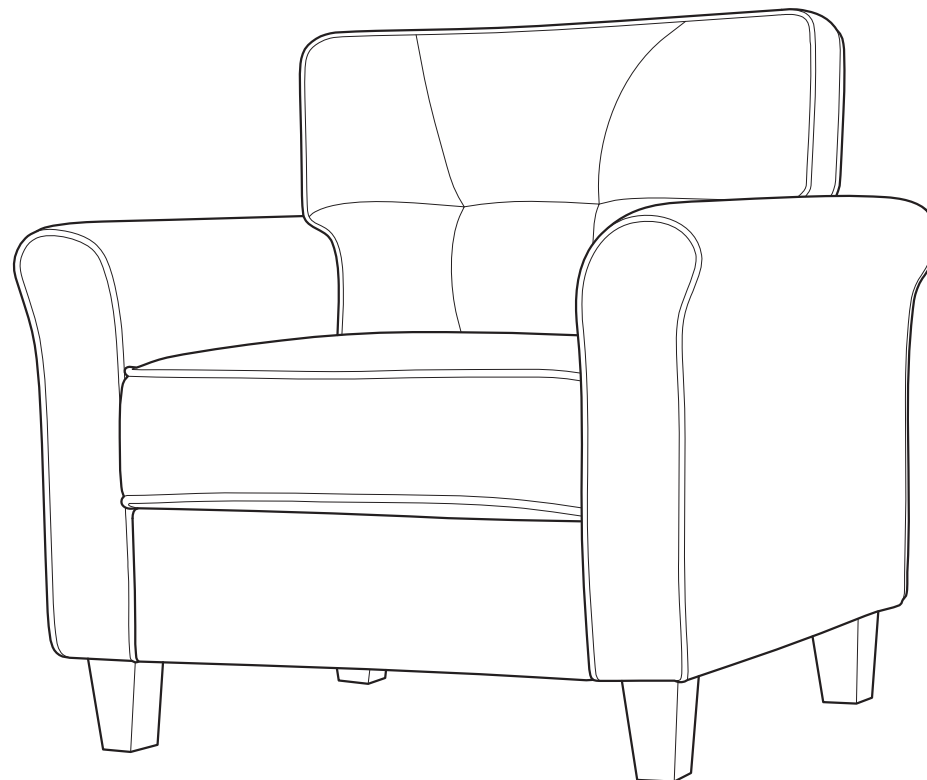

Need assistance?

Please call :

866-626-7826

For prompt, reliable service; please have your assembly manual ready.