

## 2 General Information

### 2.1 Product Specification

Model	EWP600
Part No.	EWP600B0W
Daily Production Capacity	600 GPD
Operating Water Temperatures	40-100 °F (5-38 °C)
Operating Water Pressure	15-100 psi (0.1-0.7 MPa)
Power Specifications	Input:100-240V AC    Output:24V DC
Feed Water Requirement	Municipal Tap Water
pH Parameters	2-11
TDS (Total Dissolved Solids)	< 1800 ppm
Iron	< 0.2 ppm
Turbidity	< 5 NTU
Hardness	< 10 gpg (170 mg/L)

**Hardness:** Recommended hardness not to exceed 10 grains per gallon, or 170 parts per million.

**Note:** System will operate with hardness over 10 grains but the membrane life may be shortened. The addition of a water softener may lengthen the membrane life.

**Water Pressure:** The operating water pressure in your home should be tested over a 24 hour period to attain the maximum pressure. If the incoming water pressure is above 80 psi then a water pressure regulator is required.

## 2.2 Product Overview and Installation Illustration

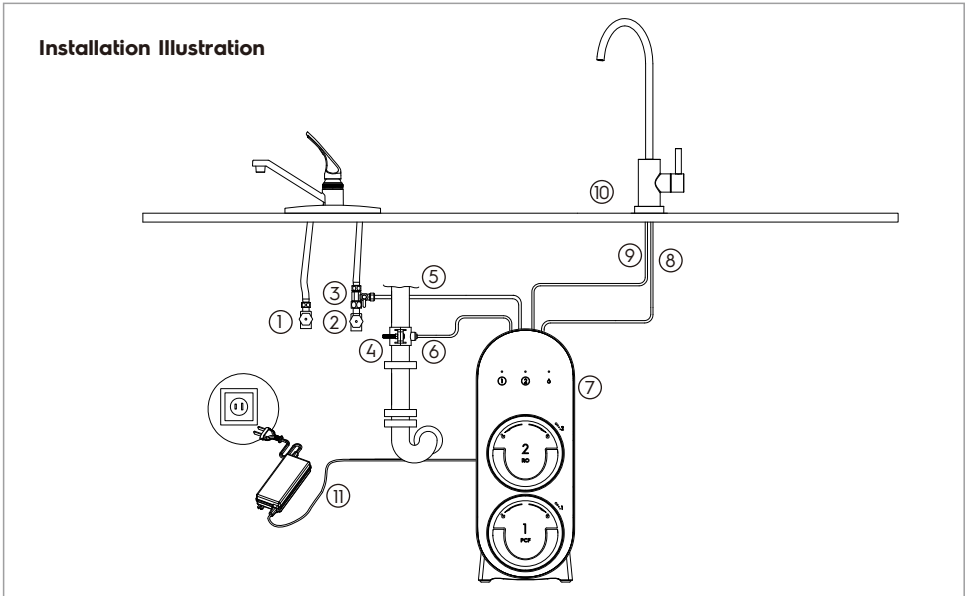
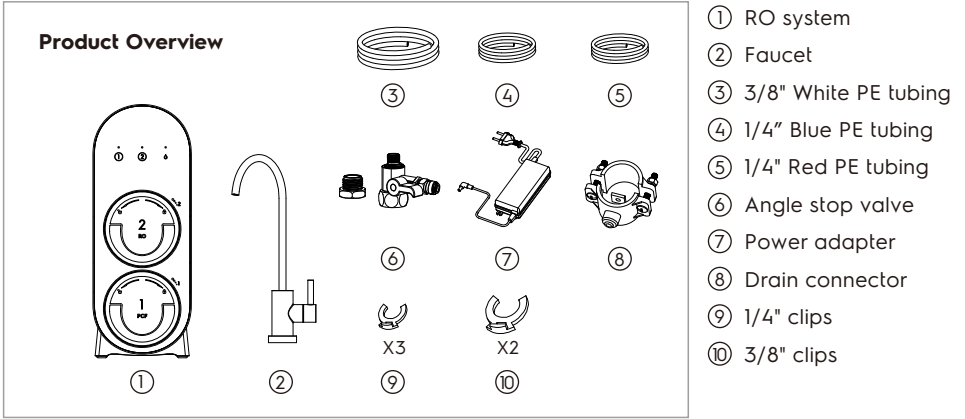

- ① Hot water valve
- ② Cold water valve
- ③ Angle stop valve
- ④ Drain connector
- ⑤ Water inlet tubing
- ⑥ Drain outlet tubing
- ⑦ Reverse osmosis system
- ⑧ Faucet power cord
- ⑨ Filtered water outlet tubing
- ⑩ Faucet
- ⑪ Power adapter