

# Weed Wacker

Product ID. 7AALQ

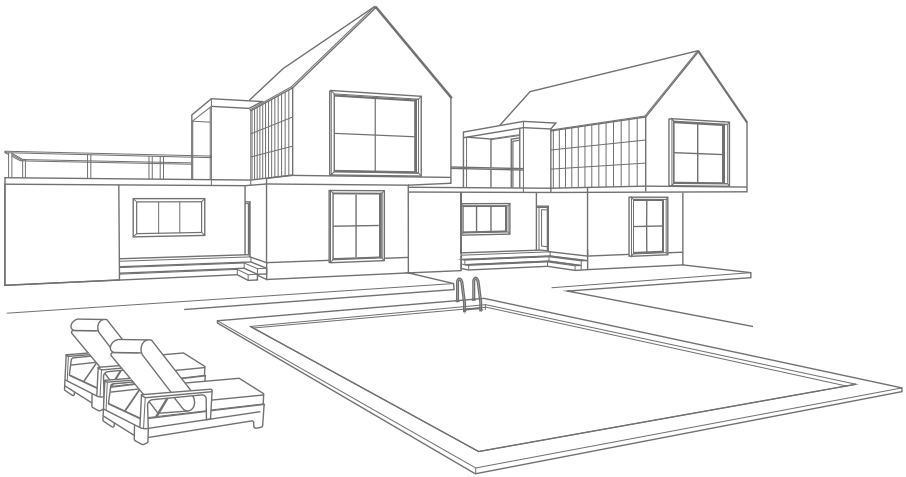

Scan for Support  
[support@garvee.com](mailto:support@garvee.com)



Distributed by  
**GARVEE**.com

V260316L8SH

# MULTI-PURPOSE TOOLS

## BRUSH CUTTER

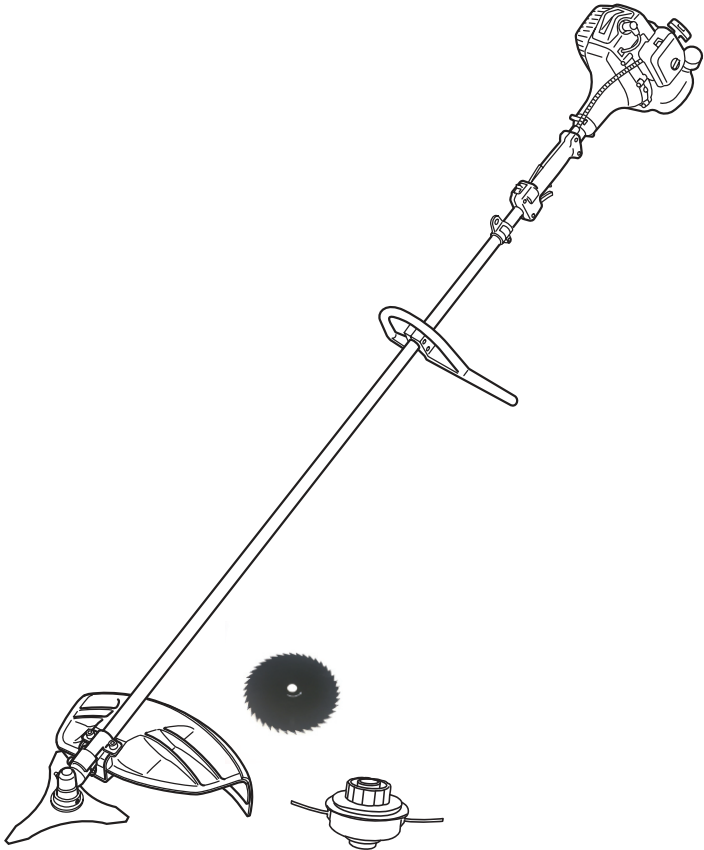

▲ **Caution**

Before using our machines  
please read this manual  
carefully to understand the  
proper use of your unit.

Distributed by Garvee  
[www.garvee.com](http://www.garvee.com)

## ▲ SAFETY FIRST

Instructions contained in warnings within this manual marked with a ▲ symbol concern critical points which must be taken into consideration to prevent possible serious bodily injury, and for this reason you are requested to read all such instructions carefully and follow them without fail.

### WARNINGS IN THE MANUAL

#### ▲ WARNING

This mark indicates instructions, which must be followed in order to prevent accidents, which could lead to serious bodily injury or death.

#### ❗ IMPORTANT

This mark indicates instructions, which must be followed, or it leads to mechanical failure, breakdown, or damage.

#### 📖 NOTE

This mark indicates hints or directions useful in the use of the product.

## Contents

1. Parts locati .....	1
2. For safe operation .....	2
3. Installation steps .....	5
4. Mixing Fuel .....	8
5. Filling the Fuel Tank .....	8
6. Startup steps .....	9
7. Operation .....	10
8. Maintenance .....	12
9. Storage .....	14
10. Troubleshooting guide .....	15
11. Packing list .....	16

## 1. Parts location

- (1) Primer pump
- (2) Air cleaner cover
- (3) Choke lever
- (4) Fuel tank
- (5) Starter knob
- (6) Blade
- (7) Gear case
- (8) Grass guard
- (9) Loop handle
- (10) Drive shaft housing
- (11) Sholder strap hanger
- (12) Throttle lever
- (13) Ignition switch
- (14) Throttle cable

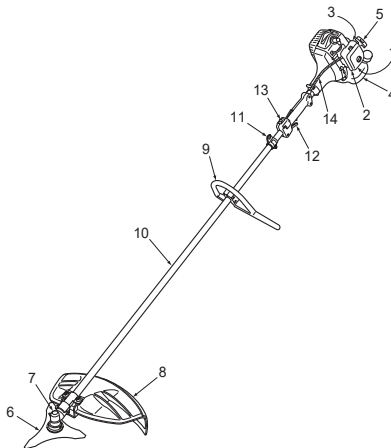

## ▲ 2. For safe operation



1. Read this manual carefully until you completely understand and follow all safety and operating instructions.
2. Keep this manual handy so that you may refer to it later whenever any questions arise. Also note, if you have any questions which cannot be answered herein, contact the dealer from whom you purchased the product.
3. Always be sure to include this manual when selling, lending, or otherwise transferring the ownership of this product.
4. Never allow children or anyone unable to fully understand the directions given in the manual to use the machine.



### WORKING CONDITION

1. When using the product, you should wear proper clothing and protective equipment.

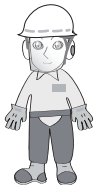

- (1) Helmet
- (2) Ear protectors
- (3) Protection goggles or face protector
- (4) Thick work gloves
- (5) Non-slip-sole work boots

2. And you should carry with you.
  - (1) Attached tools
  - (2) Properly reserved fuel
  - (3) Spare blade
  - (4) Things to notify your working area (rope, warning signs)
  - (5) Whistle (for collaboration or emergency)
  - (6) Hatchet or saw (for removal of obstacles)
3. Do not wear loose clothing, jewelry, short trousers, sandals, or go barefoot. Do not wear anything which might be caught by a moving part of the unit. Secure hair so it is above shoulder length.



### WORKING CIRCUMSTANCE

1. Never start the engine inside a closed room or building. Exhaust gases contain dangerous carbon monoxide.
2. Never use the product,
  - a. when the ground is slippery or when you can't maintain a steady posture.



- b. At night, at times of heavy fog, or at any other times when your field of vision might be limited and it would be difficult to gain a clear view of the working area.
- c. During rain storms, during lightning storms, at times of strong or gale-force winds, or at any other times when weather conditions might make it unsafe to use the product.



### WORKING PLAN

1. You should never use the product when under the influence of alcohol, when suffering from exhaustion or lack of sleep, when suffering from drowsiness as a result of having taken cold medicine or at any other time when a possibility exists that your judgment might be impaired or that you might not be able to operate the product properly and in a safe manner.
2. When planning your work schedule, allow plenty of time to rest. Limit the amount of time over which the product is to be used continuously to somewhere around 30 ~ 40 minutes per session, and take 10 ~ 20 minutes of rest between work sessions. Also try to keep the total amount of work performed in a single day under 2 hours or less.



### ▲ WARNING

1. If you don't observe the working time, or working manner (See "USING THE PRODUCT" ), Repetitive Stress Injury (RSI) could occur.  
If you feel discomfort, redness and swelling of your fingers or any other part of your body, see a doctor before getting worse.
2. To avoid noise complaints, in general, operate product between 8 a.m. and 5 p.m. on weekdays and 9 a.m. to 5 p.m. on weekends.



### 📖 NOTE

Check and follow the local regulations as to sound level and hours of operations for the product.

## ▲ 2. For safe operation



### BEFORE STARTING THE ENGINE

1. The area within a perimeter of 15 m (50 ft) of the person using the product should be considered a hazardous area into which no one should enter. If necessary, yellow warning rope, warning signs should be placed around the perimeter of the area. When work is to be performed simultaneously by two or more persons, care should also be taken to constantly look around or otherwise check for the presence and locations of other people working so as to maintain a distance between each person sufficient to ensure safety.
2. Check the condition of working area to avoid any accident by hitting hidden obstacles such as stumps, stones, cans, or broken glass.

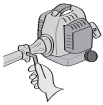

### ⓘ IMPOR TANT

Remove any obstacle before beginning work.



3. Inspect the entire unit for loose fasteners and fuel leakage. Make sure that the cutting attachment is properly installed and securely fastened.
4. Be sure the debris guard is firmly attached in place.
5. Always use the shoulder strap. Adjust the strap for comfort before starting the engine. The strap should be adjusted so the left hand can comfortably hold the handlebar grip approximately waist high.

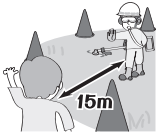

### STARTING THE ENGINE

1. Keep bystanders and animals at least 15 m (50 ft) away from the operating point. If you are approached, immediately stop the engine.
2. The product is equipped with a centrifugal clutch mechanism, so the cutting attachment begins to rotate as soon as the engine is started by putting the throttle into the start position. When starting the engine, place the product onto the ground in a flat clear area and hold it firmly in place so as to



ensure that neither the cutting part nor the throttle come into contact with any obstacle when the engine starts.

### ▲ WARNING

Never place the throttle into the high-speed position when starting the engine.

3. After starting the engine, check to make sure that the cutting attachment stops rotating when the throttle is moved fully back to its original position. If it continues to rotate even after the throttle has been moved fully back, turn off the engine and take the unit to your dealer for repair.

### USING THE PRODUCT

### ⓘ IMPOR TANT

Cut only materials recommended by the manufacturer. And use only for tasks explained in the manual.



1. Grip the handles firmly with both hands using your whole hand. Place your feet slightly apart (slightly further apart than the width of your shoulders) so that your weight is distributed evenly across both legs, and always be sure to maintain a steady, even posture while working.
2. Keep cutting attachment below waist level.
3. Maintain the speed of the engine at the level required to perform cutting work, and never raise the speed of the engine above the level necessary.
4. If the unit starts to shake or vibrate, turn off the engine and check the whole unit. Do not use it until the trouble has been properly corrected.
5. Keep all parts of your body away from rotating cutting attachment and hot surfaces.
6. Never touch the muffler, spark plug, or other metallic parts of the engine while the engine is in operation or immediately after shutting down the engine. Doing so



## ▲ 2. For safe operation

could result in serious burns or electrical shock.

### • IF SOMEONE COMES

1. Guard against hazardous situations at all times. Warn adults to keep pets and children away from the area. Be careful if you are approached. Injury may result from flying debris.
2. If someone calls out or otherwise interrupts you while working, always be sure to turn off the engine before turning around.



### MAINTENANCE

1. In order to maintain your product in proper working order, perform the maintenance and checking operations described in the manual at regular intervals.
2. Always be sure to turn off the engine before performing any maintenance or checking procedures.

### ▲ WARNING

The metallic parts react in high temperatures immediately after stopping the engine.



3. When replacing the cutting attachment or any other part, or when replacing the oil or any lubricant, always be sure to use only qualified products.
4. In the event that any part must be replaced or any maintenance or repair work not described in this manual must be performed, please contact your dealer for assistance.
5. Do not use any accessory or attachment other than those recommended for the unit.
6. Under no circumstances should you ever take apart the product or alter it in any way. Doing so might result in the product becoming damaged during operation or the product becoming unable to operate properly.



### HANDLING FUEL

1. The engine of the product is designed to run on a mixed fuel, which contains highly flammable gasoline. Never store cans of fuel or refill the tank of the unit in any place where there is a boiler, stove, wood fire, electrical sparks, welding sparks, or any other source of heat or fire which might ignite the fuel.
2. Never smoke while operating the unit or refilling its fuel tank.
3. When refilling the tank, always turn off the engine and allow it to cool down. Take a careful look around to make sure that there are no sparks or open flames anywhere nearby before refueling.
4. Wipe spilled fuel completely using a dry rag if any fuel spillage occurs during refueling.
5. After refueling, screw the fuel cap back tightly onto the fuel tank and then carry the unit to a spot 3 m or more away from where it was refueled before turning on the engine.

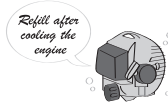

### TRANSPORTATION

1. When hand-carrying the product, cover over the cutting part if necessary, lift up the product and carry it paying attention to the blade.
2. Never transport the product over rough roads over long distances by vehicle without removing all fuel from the fuel tank. If doing so, fuel might leak from the tank during transport.



9. Install the air filter cover.



- Cable Ties (x2, for throttle cable routing)

10. Connect the corresponding power cord.



11. Tighten the fixing screws of the switch handle to prevent it from sliding.



12. Install the front rod and clamp it inside.



13. Hold down the pressure plate and tighten the fixed switch.



14. Unscrew the screw on the gear head.



15. Put the backing plate on corresponding hole position.



16. Install the grass shield as shown in the picture and tighten the fixing screws.



- Three-Point Mounting Bracket (for debris shield attachment)  
- M6x25mm Tri-Lobular (Torx) Screws (x3; 2 for debris shield)

17. Install the small blade onto the grass shield.



- L-Shaped Blade (for debris shield)
- 4x8mm Self-Tapping Screws ( x3, for L-shaped blade)

18. Install the handle.



19. Tighten the fixing screws.



- P-Handle Soft Grip (for P-handle installation)
- M5x35mm Screws (x4) & M5 Nuts (x4, for P-handle mounting)

20. Fasten the harness to the corresponding holes.



21. Block the shaft with a stop pin.

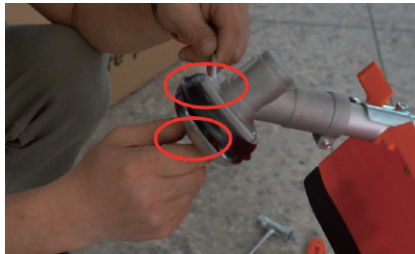

22. Install the trimmer head while the shaft is still blocked.



23. Install the blade, aligning the blade edge with the position of the small blade.



24. Install the pressure plate back and fix the blade.

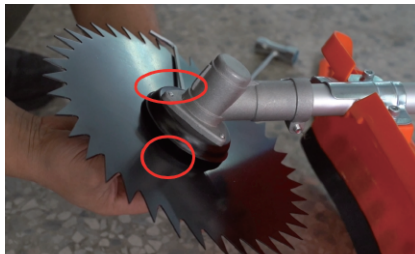

## 4. Mixing Fuel

### Mixing Fuel

#### **CAUTION!**

This engine is to be operated on a 25:1 mixture consisting of unleaded gasoline and 2-cycle mixing oil only.

Some gasolines contain alcohol as an oxygenate! Oxygenated fuels may cause increased operating temperatures. Under certain conditions, alcohol-based fuels may also reduce the lubricating qualities of some mixing oils. Never use any fuel containing more than 10% alcohol by volume! When an oxygenated fuel must be used, fuel containing an oxygenate such as MTBE is to preferred over an alcohol based fuel.

Generic oils and some outboard motor oils may not be intended for use in high-performance air cooled 2-cycle engines, and should never be used in a this engine!

- Use only fresh, clean unleaded gasoline with an octane rating of 87 or above.
- Mix all fuel with 2-cycle Engine Oil at a gasoline/oil ratio of 25:1.

#### **IMPORTANT**

Mix only enough fuel for your immediate needs! If fuel must be stored longer than 30 days, it should first be treated with a stabilizer such as StaBil™.

## 5. Filling the Fuel Tank

### Filling the Fuel Tank



#### **WARNING!**

Always minimize the risk of fire when handling fuel!

- Always allow the brush cutter to cool before refueling!
- Wipe all spilled fuel and move the brush cutter at least 3 meters (10 feet) from the fueling point before restarting!
- Never smoke or light any fires near the brush cutter or fuels!
- Never place any flammable material near the engine muffler!
- Never operate the engine without the muffler and spark arrestor in place and properly functioning!
- Never operate this machine if fuel system components are damaged or are leaking.

1. Place the brush cutter on a flat, level surface.
2. Clear any dirt or other debris from around the fuel filler cap.
3. Remove the fuel cap, and fill the fuel tank with clean, fresh fuel mixture.
4. Install and firmly tighten the fuel cap.
5. Wipe up any spilled fuel from the powerhead before restarting.

## 6. Startup steps

1. Complete with 2-stroke oil 25:1



2. Mix the engine oil and gasoline well.



3. Open the oil can and add the mixed oil.

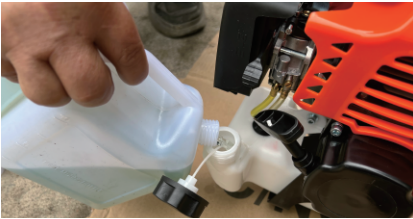

4. Press the oil bubble several times to push the oil through the pipe.



5. Close the air cleaner cover upwards

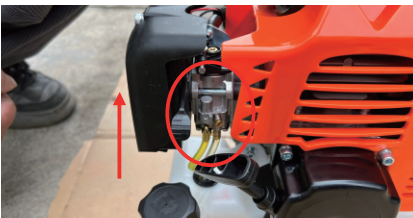

6. Push back to turn on the switch. (If you want to turn off the machine, push forward to close the switch)



7. Pull the starter firmly until the machine starts.



8. Open the air cleaner cover downwards at once after the machine starts.



9. Press and hold the latch and switch.



# 7. Operation

## ADJUSTING THROTTLE CABLE

- The normal play is 1 or 2 mm when measured at the carburetor side end. Readjust with the cable adjuster as required.

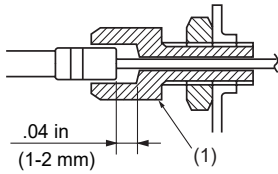

(1) Cable adjuster

## ADJUSTING IDLING SPEED

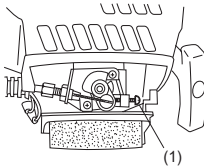

(1) Idle adjusting screw

- When the engine tends to stop frequently at idling mode, turn the adjusting screw clockwise.
- When the cutting head keeps rotating after releasing the trigger, turn the adjusting screw counter-clockwise.

### NOTE

- Warm up the engine before adjusting the idling speed.

## CUTTER APPLICATION CHART

- Replace by a suitable recommended cutting attachment according to the object to be cut.
- When replacing blade always be sure to use products which have been recommended by your dealer.

### WARNING

- When sharpening, removing, or reattaching the blade, be sure to wear thick, sturdy gloves and use only proper tools and equipment to prevent injury.



## METAL BLADE USAGE

- Check the nut to fasten the blade and be sure the nut has no fault, and no abrasion.
- Be sure that the blade and the holder have been fastened according to instruction and the blade turns smoothly without abnormal noise.



### WARNING

- The rotating parts fastened incorrectly may cause a serious accident to the operator.
- Make sure that the blade is not bent, warped, cracked, broken or damaged.
- If you find any error with the blade, discard it and change new one which is recommended by your dealer.
- By using the shoulder strap, hang the unit on your right side. Adjust the strap length so that the cutting head may become parallel to the ground.

### WARNING

- Make sure to use shoulder strap and debris guard. If not, it is very dangerous when you slip or lose your balance.



# 7. Operation

## CUTTING METHOD

- (a) Use the front left side cutting.
- (b) Guide the blade from your right to left with it tilted slightly to your left.
- (c) When mowing a wide area, start working from your left end to avoid interference of cut grass.
- (d) The blade may be seized by weeds if the engine speed is too low, or the blade cuts too deep into weeds. Adjust the engine speed and cutting depth according to the condition of object.

### **▲ WARNING**

- If the grass or other object gets caught in the blade, or if the unit starts to shake or vibrate, turn off the engine and check the whole unit. Change the blade if it has been damaged.
- Turn off the engine and make sure the blade has completely stop before checking the blade, and removing any object got caught in.

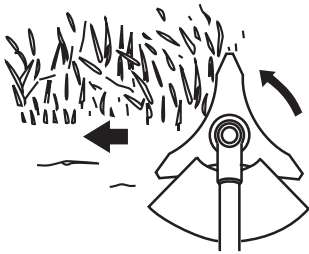

### **▲ WARNING**

## CONTROLLING BLADE BOUNCE

- A kick-out can cause serious personal injury. Carefully study this section. It is important that you understand what causes kick out, how you can reduce the chance of kick out and how you can remain in control of the unit if kick out does occur.

### 1. What causes kick out:

- Kick out can occur when the moving blade contacts an object that it cannot cut. This contact causes the blade to stop for an instant and then suddenly move or "bounce" away from the object that was hit. The operator can lose control of the unit and the blade can cause serious personal injury to the operator or any person nearby if the blade contacts any part of the body.

### 2. How you can reduce the chance of kick out:

- a. Recognize that kick out can happen. By understanding and knowing about bounce, you can help eliminate the element of surprise.
- b. Cut fibrous weeds and grass only. Do not let the blade contact materials it cannot cut such as hard, woody vines and brush or rocks, fences, metal, etc

- c. Be extra prepared for bounce if you must cut where you cannot see the blade making contact such as in areas of dense growth.
- d. Keep the blade sharp. A dull blade increases the chance of bounce.
- e. Avoid feeding the blade too rapidly. The blade can bounce away from material being cut if the blade is fed faster than its cutting capability.
- f. Cut only from your right to your left.
- g. Keep your path of advance clear of material that has been cut and other debris.

### 3. How you can maintain the best control:

- a. Keep a good, firm grip on the unit with both hands. A firm grip can help neutralize bounce. Keep your right and left hands completely around the respective handles.
- b. Keep both feet spread apart in a comfortable stance and yet braced for the possibility that the unit could bounce. Do not overreach. Keep firm footing and balance.

## CUTTING WORK (LINE HEAD USAGE)

### **▲ WARNING**

1. Always wear eye protection such as safety goggles. Never lean over the rotating cutting head. Rocks or other debris could be thrown into eyes and face and cause serious personal injury.
2. Keep the debris guard in place at all times when the unit is operated. Remember to remove the cover from the line cutter (knife) which locates on the debris guard. You can adjust the line to the right length at any time by lightly tapping the trimmer head against the ground. The line cutter cuts off the excessive line automatically.

## TRIMMING GRASS AND WEEDS

- Always remember that the TIP of the line does cutting. You will achieve better results by not crowding the line into the cutting area. Allow the unit to trim at its own pace.

1. Hold the unit so the head is off the ground and is tilted about 20 degrees toward the sweep direction.

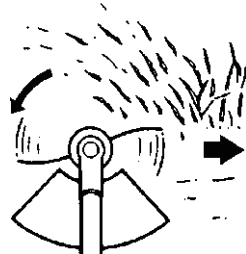

2. You can avoid thrown debris by sweeping from your left to the right.

# 7. Operation

3. Use a slow, deliberate action to cut heavy growth. The rate of cutting motion will depend on the material being cut. Heavy growth will require slower action than will light growth.
4. Never swing the unit so hard as you are in danger of losing your balance or control of the unit.
5. Try to control the cutting motion with the hip rather than placing the full workload on the arm and hands.
6. Take precautions to avoid wire, grass and dead, dry, long-stem weeds from wrapping around the head shaft. Such materials can stall the head and cause the clutch to slip, resulting in damage to the clutch system if repeated frequently.

## ADJUSTING THE LINE LENGTH

- Your brush cutter is equipped with a semi- auto type nylon line head that allows the operator to advance the line without stopping the engine. When the line becomes short, lightly tap the head on the ground while running the engine at full throttle.
- Each time the head is bumped, the line advances about 25 mm. For better effect, tap the head on bear ground or hard soil. Avoid bumping in thick, tall grass as the engine may stall by overload.

# 8. Maintenance

System/components	Procedure	Before use	Every 25 hours after	Every 50 hours after	Every 100 hours after	Note
fuel leaks, fuel spillage	wipe out	<input checked="" type="checkbox"/>				
fuel tank, air filter, fuel filter	inspect/clean	<input checked="" type="checkbox"/>	<input checked="" type="checkbox"/>			replace, if necessary
idle adjusting screw	see adjusting idling speed	<input checked="" type="checkbox"/>				replace carburetor if necessary
spark plug	clean and readjust plug gap			<input checked="" type="checkbox"/>		GAP: .025 in (0.6-0.7 mm) replace, if necessary
cylinder fins, intake air cooling vent	clean		<input checked="" type="checkbox"/>			
muffler, spark arrester, cylinder exhaust port	clean			<input checked="" type="checkbox"/>		
throttle lever, ignition switch	check operation	<input checked="" type="checkbox"/>				
cutting parts	replace if something's wrong	<input checked="" type="checkbox"/>				
gear case	grease		<input checked="" type="checkbox"/>			
screws/nuts/bolts	tighten/replace	<input checked="" type="checkbox"/>			<input checked="" type="checkbox"/>	not adjusting screws
debris guard	make sure to attach	<input checked="" type="checkbox"/>				

## BLADE

- Check the blade and the fasteners for looseness, cracking, or bending.
- Check the cutting edges and reform with a flat file.

- (A) 8-teeth blade  
(B) 3-teeth blade

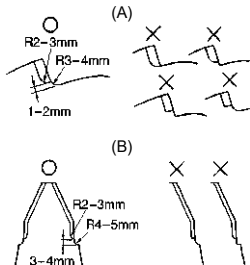

## Point :

1. Keep the end corner sharp.
2. Round the root of the edge, using round file.
3. Do not use water when using a grinder.

- It is recommended that filing should be done by professionals.
- Especially regarding filing the saw blade, Leave it to the professionals.

# 8. Maintenance

## REFILLING TRIMMING LINE

1. For replacement line, use a diameter of 2.4mm (.095in). The spool is capable of a line upto 6m(20ft) on the 10cm(4") head. Avoid using a larger line as it may cut down the trimming performance.

### ▲ WARNING

- For safety reasons, do not use metalreinforced line.
2. Pinch the slotted area on the both sides of the spool housing to unhook the bottom cap.
  3. Take out the spool and pull off the old line. Put one end of new line through the spool holes and pull it until the length is equal between each part of the line.
  4. Wind up the line in the correct direction as indicated on the spool.
  5. Hook each end of the line in the slot on the edge of the spool, and then put the ends through the eyelets on the housing. Make sure that the spring and the washers are in place.
  6. While holding the spool against the housing, pull the line ends to release them from the slot.
  7. Line up the slot on the bottom cap with the hook on the housing, press the cap against the housing until it clicks.

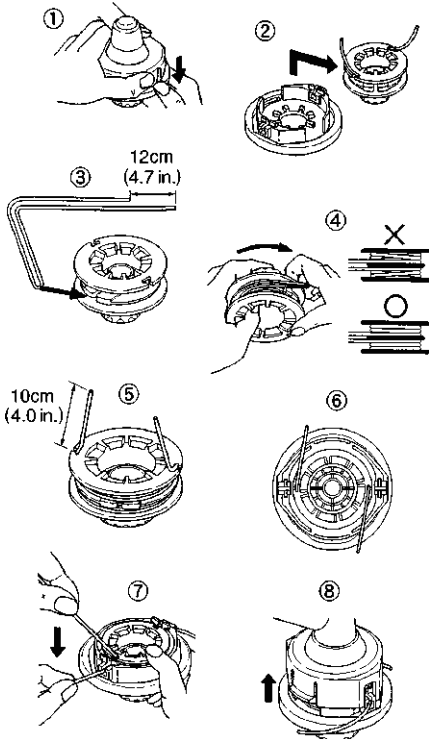

### ▲ WARNING

- Make sure that the engine has stopped and is cool before performing any service to the machine. Contact with moving cutting head or hot muffler may result in a personal injury.

## AIR FILTER

- The air filter, if clogged, will reduce the engine performance. Check and clean the filter element in warm, soapy water as required. Dry completely before installing. If the element is broken or shrunk, replace with a new one.

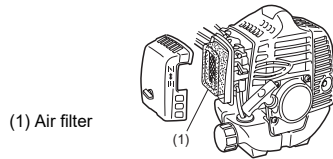

(1) Air filter

## FUEL FILTER

- When the engine runs short of fuel supply, check the fuel cap and the fuel filter for blockage.

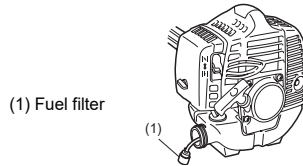

(1) Fuel filter

## SPARK PLUG

- Starting failure and misfiring are often caused by a fouled spark plug. Clean the spark plug and check that the plug gap is in the correct range. For a replacement plug, use the correct type specified by YOUR DEALER.

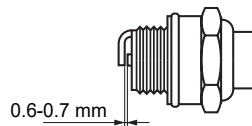

# 8. Maintenance

## ⓘ IMPORT ANT

- Note that using any spark plug other than those designated may result in the engine failing to operate properly or in the engine becoming overheated and damaged.
- To install the spark plug, first turn the plug until it is finger tight, then tighten it a quarter turn more with a socket wrench.

TIGHTENING TORQUE:  $\frac{87-104 \text{ in-lbs}}{(9.8-11.8 \text{ N.m.)}}$

## MUFFLER

### ⚠ WARNING

- Inspect periodically, the muffler for loose fasteners, any damage or corrosion. If any sign of exhaust leakage is found, stop using the machine and have it repaired immediately.
- Note that failing to do so may result in the engine catching on fire.

## SPARK ARRESTER

- The muffler is equipped with a spark arrester to prevent red hot carbon from flying out of the exhaust outlet. Periodically inspect and clean as necessary with a wire brush.

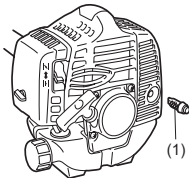

(1) Spark arrester

## GEAR CASE

- The reduction gears are lubricated by multipurpose, lithium-based grease in the gear case. Supply new grease every 25 hours of use or more often depending on the job condition.
- Remove the bolt opposite to the grease nipple before installing new grease to arrange for old grease to exit.

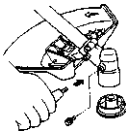

## INTAKE AIR COOLING VENT

### ⚠ WARNING

- Never touch the cylinder, muffler, or spark plugs with your bare hands immediately after stopping the engine. The engine can become very hot when in operation, and doing so could result in severe burns.

- When checking the machine to make sure that it is okay before using it, check the area around the muffler and remove any wood chips or leaves which have attached themselves to the brushcutter. Failing to do so could cause the muffler to become overheated and that in turn could cause the engine to catch on fire. Always make sure that the muffler is clean and free of wood chips, leaves, and other waste before use.
- Check the intake air cooling vent and the area around the cylinder cooling fins after every 25 hours of use for blockage, and remove any waste which has attached itself to the brushcutter. Note that it is necessary to remove the engine cover shown in in order to be able to view the upper part of the cylinder.

## ⓘ IMPORT ANT

- If waste gets stuck and causes blockage around the intake air cooling vent or between the cylinder fins, it may cause the engine to overheat, and that in turn may cause mechanical failure on the part of the brushcutter.

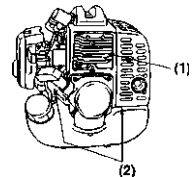

(1) Cylinder  
(2) Intake air cooling vent

## PROCEDURES TO BE PERFORMED AFTER EVERY 100 HOURS OF USE

1. Remove the muffler, insert a screwdriver into the vent, and wipe away any carbon buildup. Wipe away any carbon buildup on the muffler exhaust vent and cylinder exhaust port at the same time.
2. Tighten all screws, bolts, and fittings.
3. Check to see if any oil or grease has worked its way in between the clutch lining and drum, and if it has, wipe it away using oil-free, lead-free gasoline.



# 9. Storage

Aged fuel is one of major causes of engine starting failure. Before storing the unit, empty the fuel tank and run the engine until it uses all the fuel left in the fuel line and the carburetor. Store the unit indoor taking necessary measures for rust prevention.

# 10. Troubleshooting Guide

ENGINE DOES NOT START		
What to check	Possible cause	Remedy
Does the engine crank?	NO Faulty recoil starter. Fluid in the crankcase. Internal damage.	Return the unit to the dealer
YES ↓ Good compression?	NO Loose spark plug. Excess wear on cylinder, piston, rings	Tighten and re-test Return unit to the dealer.
YES ↓ Does the tank contain fresh fuel of the proper grade?	NO Fuel incorrect, stale, or contaminated. Fuel mixture incorret	Refill with fresh fuel of the correct mixture(gasoline and 2-cycle Engine Oil, 25:1 ratio).
YES ↓ Is fuel visible and moving in the return line when priming?	NO Check for clogged fuel filter and/or vent.	Clean as required; restart. Move switch to "I"(Start) position and restart.
YES ↓ Is there spark at the spark plug wire terminal?	NO The ignition switch is on "0"(Stop) position. Faulty ignition ground. Faulty transistor unit.	Return unit to the dealer.
YES ↓ Check the spark plug?	NO If the plug is wet, excess fuel may be in the cylinder.	Crank the engine with the plug removed, replace the plug, and restart.
	The plug is fouled or improperly gapped.	Clean and re-gap the plug to 0.6~0.7mm. restart.
	The plug is damaged internally or of the wrong size.	Replace the plug and restart.

# 10. Troubleshooting guide

## Case 1. Starting failure

CHECK	PROBABLE CAUSES	ACTION
fuel tank	→ incorrect fuel	→ drain it and use correct fuel
fuel filter	→ fuel filter is clogged	→ clean
carburetor adjustment screw	→ out of normal range	→ adjust to normal range
sparkling (no spark)	→ spark plug is fouled/wet	→ clean/dry
	→ plug gap is incorrect	→ correct (GAP: 0.6-0.7 mm)
spark plug	→ disconnected	→ retighten

## Case 2. Engine starts but does not keep running/hard re-starting

CHECK	PROBABLE CAUSES	ACTION
fuel tank	→ incorrect fuel or stale fuel	→ drain it and use correct fuel
carburetor adjustment screw	→ out of normal range	→ adjust to normal range
muffler, cylinder (exhaust port)	→ carbon is built-up	→ wipe away
air cleaner	→ clogged with dust	→ wash
cylinder fin, fan cover	→ clogged with dust	→ clean

# 11. Bill of Materials

1. Instruction Manual
2. Extended Warranty Card
3. Debris Shield
4. Orange TH102 Nylon Trimmer Head
5. Carry Bag
6. P-Handle
7. 0.5-Liter Fuel-Oil Ratio Bottle
8. Funnel
9. Black Single-Hook Harness
10. 3-Tooth Blade
11. 40-Tooth Blade
12. Black Fabric Tool Pouch
  - 8&10 mm Combination Wrench
  - M5 Hex Key (Allen Wrench)
  - M6 Hex Key (Allen Wrench)
  - 17-19mm Spark Plug Socket Wrench (Cross-type / 4-way)
  - Quick-Change Screwdriver Shank
  - Three-Point Mounting Bracket (for debris shield attachment)
  - P-Handle Soft Grip (for P-handle installation)
  - 5x12mm Tri-Lobular (Torx) Screw (x1, for drive disc)
  - L-Shaped Blade (for debris shield)
  - 4x8mm Self-Tapping Screws ( x3, for L-shaped blade)
  - M6x25mm Tri-Lobular (Torx) Screws (x3; 2 for debris shield, 1 for drive disc)
  - Cable Ties (x2, for throttle cable routing)
  - M5x35mm Screws (x4) & M5 Nuts (x4, for P-handle mounting)

**GARVEE**  
support@garvee.com