

USER MANUAL

SB-100C

TABLE OF CONTENTS

Important Safeguards	2
Grounding Instructions	4
Name of Parts	5
Installation method	6
How to use	9
Maintenance	10
Troubleshooting	11
Specifications	13
Warranty	14

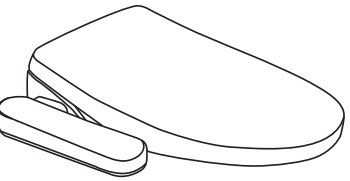

- This product was manufactured for household use only.
- Read all operating instructions before installation and use.
- Please save this operating instruction manual and place in an easily accessible location.
- External appearance and specifications are subject of change for improvement of product without notice

Important Safeguards

READ ALL INSTRUCTIONS BEFORE USING.

DANGER To reduce the risk of electrocution.

- Do not use while bathing.
- Do not place or store product where it can fall or be pulled into a tub or sink.
- Do not place in or drop into water or other liquid.
- Do not reach for a product that has fallen into water. Unplug immediately.

WARNING To reduce the risk of burns, electrocution, fire or injury to persons.

- If the supply cord is damaged, it must be replaced by the manufacturer, its service agent or similarly qualified persons in order to avoid a hazard.
- Connect this product to a properly grounded outlet only.
- Unplug the appliance during filling and cleaning.
- Do not touch the power plug with wet hands.
- Properly connect the power cord to the electrical outlet corresponding to the rated voltage of the unit.
- Keep the cord away from heated surfaces.
- Do not use damaged or loose power cord.
- Before removing the unit from the toilet bowl, disconnect the power plug first.
- Do not connect other electrical appliances to the same power socket connected to the unit.
- Children should be supervised to ensure that they do not play with the appliance.
- This appliance is not intended for use by persons (including children) with reduced physical, sensory or mental capabilities, or lack of experience and knowledge, unless they have been given supervision or instruction concerning use of the appliance by a person responsible for their safety.
- Never operate this product if it has a damaged cord or plug, if it is not working properly, if it has been dropped or damaged, or dropped into water. Return the product to a service center for examination and repair.
- Never block the air openings of the product or place it on a soft surface, such as a bed or couch, where the air openings may be blocked.
- Keep the air openings free of lint, hair, and the like.
- Any other servicing should be performed by an authorized service representative.
- Close supervision is necessary when this product is used by, on, or near children or invalids.
- Do not dismantle, repair, or alter the unit.

Important Safeguards

WARNING To reduce the risk of burns, electrocution, fire or injury to persons.

- Never use while sleeping or drowsy.
- Never drop or insert any object into any opening or hose.
- Do not use outdoors, or operate where aerosol(spray) products are being used or where oxygen is being administered.
- Do not pour or spray water on to the unit.
- Do not use steam cleaner.
- Keep the unit away from fires or inflammable substance.
- Do not connect to the industrial water supplies.
- Caution against low temperature burns.
- New hose-sets supplied with the appliance are to be used and that old hose-sets should not be reused.

CAUTION To reduce the risk of injury to persons or damage to the product or the property.

- Do not place heavy objects or step on the unit. It may cause product damage or injury.
- When cleaning the unit, do not use any chemicals. Clean the unit with moist, well-wrung soft cloth. For excessive stains, use soft cloth moistened with mild dish-wash detergent and wipe out with dry cloth. It may cause product damage.
- Do not slam down the lid. It may cause product defect.
- Do not lean against the lid. It may cause product defect.
- When not in use for a long period of time, disconnect the power plug and drain the water tank. Tank water may be contaminated and cause skin troubles.
- Do not twist or pull the connection hoses. It may affect water supply or cause water leakage.
- Do not cover up the warm air outlet or insert hands or other objects. It may cause burn or electric shock.
- Do not operate the unit during product malfunction. Disconnect the power plug and call the authorized service center. It may cause fire or electric shock if the unit is operated while it is out of order.

Grounding Instructions

WARNING Improper use of the grounding plug can result in risk of electric shock.

This product is for use a nominal 120v circuit and a GFCI (ground fault circuit interrupter) receptacle is required for use with this product. Do not use this product with an ungrounded outlet. Do not use an extension cord with this product.

If you do not have a GFCI receptacle, contact a qualified electrician to have installed.

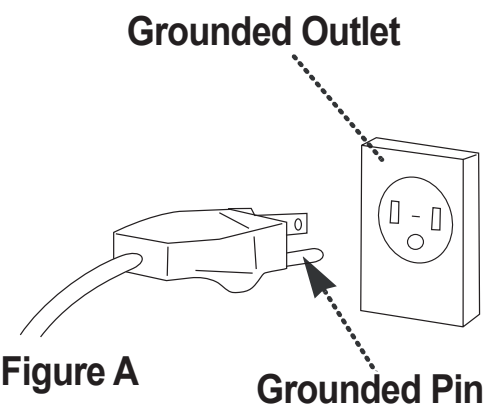

Name of parts

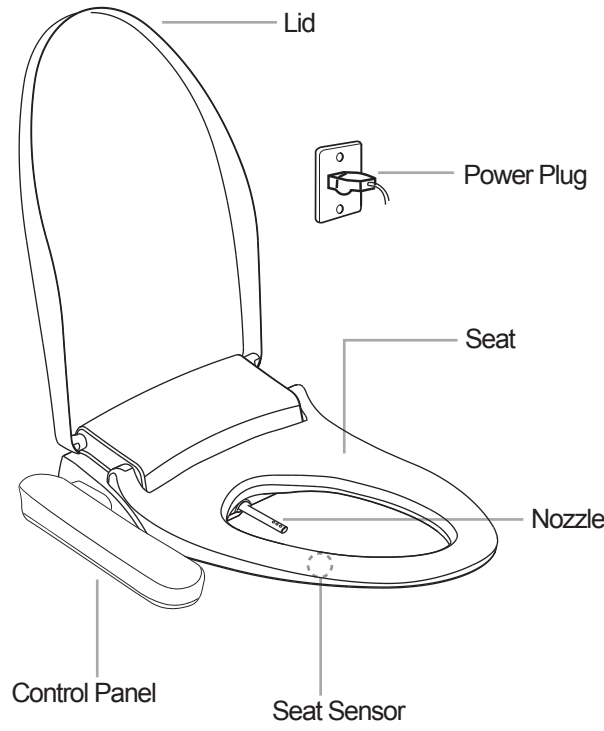

Installation

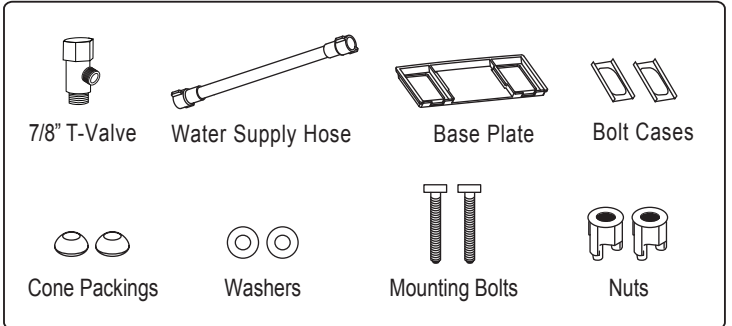

Before installation

- Read the instructions carefully before installing.
- Plug in only after complete installation then supply water.

Installation guide

1 Separate water supply hose

- Turn the shut off valve clockwise to turn the water off. Flush your toilet's water tank completely to empty. Disconnect the top of the water supply hose by using a wrench.

2 Remove the existing toilet seat

- Unfasten the nuts and remove the toilet seat.
- Save your toilet's seat, lid, and nuts for reinstallation later.

3 Connect T-valve

- Install T-valve as shown

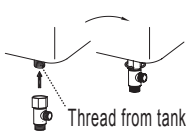

4 Insert the base plate.

- Align the base plate's grooves with the toilet seat holes.
- Insert the mounting bolt into the base plate and toilet seat holes.

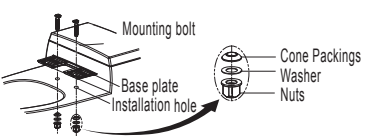

5 Insert the bidet body

- Mount the main bidet into the fixing holes.
- Align the front of the bidet body and the front of the toilet before fastening the nuts.

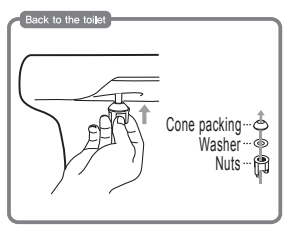

6 Connect the water supply hose

- Connect the water supply hose to the T-valve and the main body.
- Turn the water supply valve counterclockwise to allow water flow.

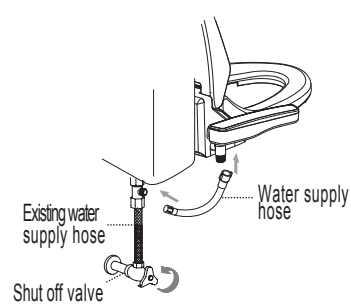

Operation check

1. Turn the shut off valve counterclockwise to check for water leakage.
2. Connect the power plug into electrical outlet.
3. Check the function for each type of use.

Memo

How to use

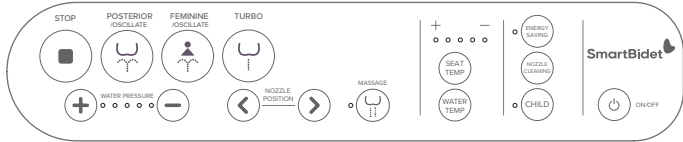

- STOP**

 - Press the Stop button when you want to stop the function.
- POSTERIOR / OSCILLATE**

 - Press the Posterior/Oscillate button to wash.
 - Press the button again during using the operation and it will oscillate.
 - Press the button again and Oscillation will stop.
- FEMININE / OSCILLATE**

 - Press the Feminine/Oscillate button to wash.
 - Press the button again during using this opeation and it will oscillate
 - Press the button again and Oscillation will stop.
- TURBO**

 - Press the Turbo button to wash
 - It starts from the highest water pressure.
- MESSAGE**

 - Press the Massage button during Posterior or Feminine wash. The water pressure will pulsate from strong to soft.
 - Press the button again then the Massage function will stops.
- WATER PRESSURE**

 - 5 levels of water pressure
- NOZZLE POSITION**

 - Control the nozzle position forward or backward.
- SEAT TEMPERATURE**

WATER TEMPERATURE

 - 5 levels of Water Temperature and Seat Temperature.
- ENERGY SAVING**

 - It cuts off the power of heated water and heated seat.
 - It minimizes the use of power.
- NOZZLE CLEANING**

 - Press the button then the nozzle extends out for cleaning.
 - Press the button again then the nozzle will return to original position.
- CHILD mode**

 - LED displays the setting condition.
 - User can use Posterior, Feminine, Dry without seat occupied.
- ON / OFF**

 - Press the button to power ON or OFF
 - ON (instantly)
 - OFF (will take more than 3 seconds)

Specifications

Item		Description
Model		SB-100C
Power rating		AC120V 60Hz 864W
Ambient temperature		32~104°F
Water supply		Direct water connection
Water pressure		14.2~106.6 Psi
Wash	Posterior wash	Max 0.18 gal
	Feminine wash	Max 0.21 gal
	Turbo wash	Max 0.19 gal
	Heater capacity	800W
	Tank capacity	0.15 gal
	Water temperature	Room temp - 104 °F
	Safety device	Thermal Fuse, Thermostat,Water Level Sensor
Heated seat	Heater capacity	55W
	Seat temperature	Room temp - 104°F
	Safety device	Thermal Fuse
Power cord length		3.9 ft
Product dimension		18.7 in x 20.9 in x 5.4 in
Product weight		9.9 lbs

Maintenance

Use ENERGY SAVING

- Press the Energy Saving button to save energy while it's not in use.
- Press the button once(general saving mode) then the LED (green) light will turn ON. It will maintain the preset temperature for 30 minutes. After standing up, the water heater will turn OFF, the seat temperature will be at 86°F. (Heated water & Heated seat will be OFF in 24 hours)
- Press the button twice(strong saving mode) then LED (red) light will turn ON and the heated water & heated seat will be OFF.
- To stop the Energy Saving function, press the button to turn the LED off.
- When the user sits down in this mode, the seat sensor will turn ON, the water heater and seat heater will start working automatically up to the preset temperature. (It will takes 5 minutes to reach the preset temperature.)
- When the user stands up, the seat sensor will turn OFF, the water heater and seat heater will automatically return to Energy Saving mode.
- Washing functions will work while in Energy Saving mode.

Nozzle Cleaning

- Use a soft cloth or toothbrush to clean the nozzle.
- Do not use Abrasives, Volatile detergent, or Acid/Alkaline containing detergent. It may cause breakage or the plastic to deteriorate.

Nozzle Cleaning (Automatic)

When the seat sensor is not activated, press the Nozzle Cleaning button on the control panel then the nozzle will extend and self-clean for 2 minutes.

Nozzle Cleaning (Manual)

- Press the Nozzle Cleaning button for 3 seconds.
- Nozzle extends out for 2 minutes.
- Clean the nozzle using toothbrush.
- Wipe the nozzle with soft cloth or brush.

- ※ Do not pull out or push the nozzle forcibly.
- ※ Nozzle cleaning function does not work when seat is occupied.
- ※ Nozzle cleaning function does not work in Child mode.



Hitrons Solutions Inc.
Limited Warranty

General Limited Warranty Covered **Hitrons Solutions Inc** will warrant to the original retail byuer only, whic falls in normal user and within the applicable periods specified below. **Hitrons Solutions Inc** replacements will be warranted to the original purchaser of the products only.

The Parts Warranty If the parts fail within Twelve(12)months after original purchase from authorized retaile following the installation manual and normal operation, **Hitrons Solutions Inc** will furnish replacement part(s) after warranty registration.

This Warranty does not cover the following

1. Defects and/or malfunctions from failure to properly install, operate and/or maintain the unit in accordance with the installation manual.
2. Damage from abuse, fire, flood, freeze, and any other acts of nature.
3. Damage resulting from unauthorized alterations, attachments and/or repairs.
4. If the product was not installed properly.
5. Damage to the unit by animals, mice or insects.
6. Damage caused by excess moisture or from water clogging the bathroom or restroom.
7. Damage from not being installed in accordance with all applicable local codes, ordinances and good trade practices.
8. Color fading due to use in wrong environment.
9. Damage from chemicals.
10. The warranty will not be covered without providing the date of purchase with original receipt.

Troubleshooting

When you think the product is having an issue, please refer to the following for these solutions.

Power supply

Issue	Possible Causes	Solution
The unit is not working	The power is out or the circuit breaker is off.	Wait until the power is restored or turn on the circuit breaker.
	The operation lights on the simple panel on the main body is off.	Plug the power plug into the outlet.

Posterior wash, Feminine wash, Turbo wash functions

Issue	Possible Causes	Solution
Water pressure is weak	The water pressure is set to a low level.	Adjust the water pressure to a higher level.
	The strainer is clogged.	Clean the strainer.
Water is cold	The temperature is set to a low level or it is turned off.	Adjust the water temperature to a higher level.
	It's in Energy Saving mode.	The water tempreture is set lower. Press the Energy Saving button again.
Water spray stops during use.	The washing stops 90 seconds after pressing the Posterior, Feminine and Turbo buttons.	Press the Posterior, Feminine, or Turbo button one more time.
	Seat sensor is not activated.	Check the position of the seat sensor on page 5.

Memo

Heated seat

Issue	Possible Causes	Solution
The seat does not warm up.	The seat temperature is set to OFF or set to a low level.	Adjust the seat temperature to a higher level.
	The bidet seat is in energy saving mode.	The seat temperature is set lower. Press the Energy Saving again.

Seat sensor

Issue	Possible Causes	Solution
The posterior wash works without sitting on the seat.	Isn't the seat wet or occupied by wet towel?	Wipe water out. Remove the wet towel.

Energy Saving

Issue	Possible Causes	Solution
Energy Saving is not working.	The unit is unplugged. The power is out.	Reset the setting by pressing the energy saving button.

Self diagnosis

Issue	Indication (LED light on Temperature control)	Symptom
Water supply stops or water level sensor faulty	••✖•• 3rd level LED blinks	Water doesn't spray, warm water not spray
Water temperature sensor disconnected	✖•••• 5th level LED blinks	Warm water doesn't spray
Water temperature sensor short circuit	•✖••• 4th level LED blinks	All wash functions don't work
Seat temperature sensor disconnected	•••✖• 2nd level LED blinks	Seat not heated
Seat temperature sensor short circuit	••••✖ 1st level LED blinks	Seat not heated

Memo