

allen + roth[®]

welcoming • sophisticated • inspiring



**RATED FOR
WET
LOCATIONS**

ALLEN + ROTH and logo design are trademarks or registered trademarks of LF, LLC. All rights reserved.

ITEM #5644941, 5644942
MODEL #43037, 43038

1-LIGHT PENDANT

ATTACH YOUR RECEIPT HERE

Español p. 17

Purchase Date _____



SS23737

Thank you for purchasing this ALLEN + ROTH product.
Questions, problems, or missing parts?
Before returning, contact at:
866-439-9800, 8 a.m. - 8 p.m., EST, Monday - Sunday or ascs@lowes.com.

TABLE OF CONTENTS

Package Contents. 3

Hardware Contents. 4

Safety Information. 5

Assembly Instructions for Plug-In Installation.. . . . 6

Assembly Instructions for Hardwire Installation.. . . . 11

Operating Instructions 15

Troubleshooting. 16

3-Year Warranty. 16

PACKAGE CONTENTS (not drawn to scale)

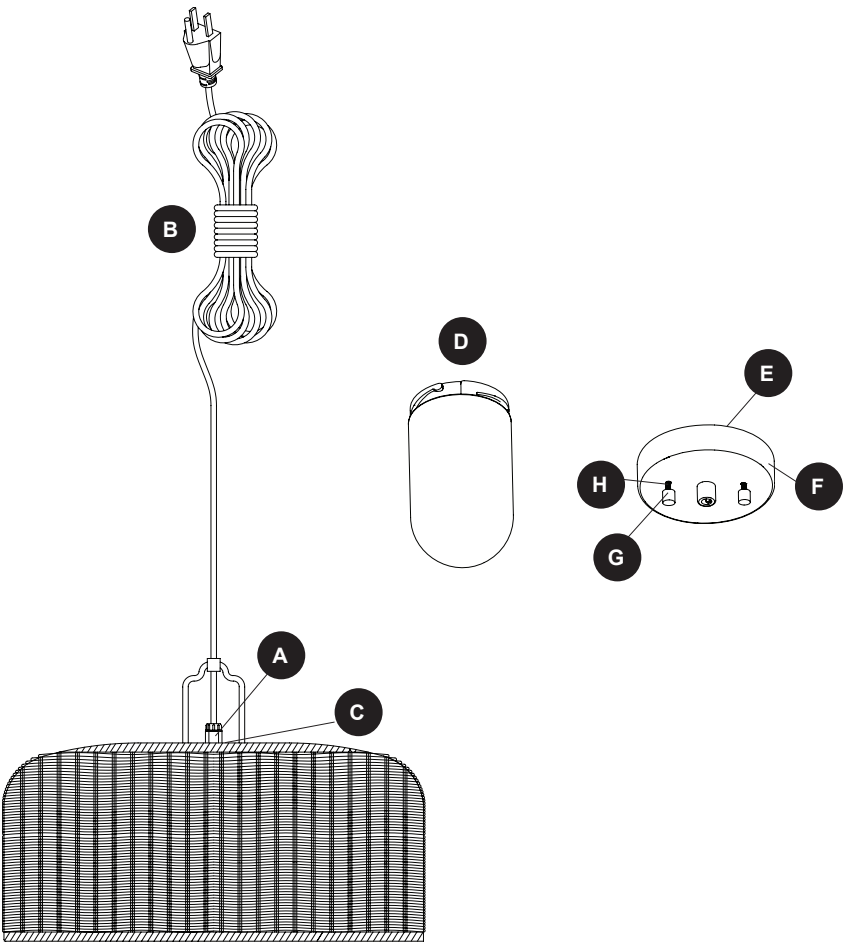

PART	DESCRIPTION	QUANTITY
A	Fixture	1
B	Fixture Wire (preassembled to Fixture [A])	1
C	Switch (preassembled to Fixture [A])	1
D	Glass Shade	1
E	Mounting Bracket	1
F	Canopy (preassembled to Mounting Bracket [G])	1
G	Screw Cap (preassembled to Mounting Bracket [G])	2
H	Mounting Screw (preassembled to Mounting Bracket [E])	2

Note: Not all parts will be used for both installations. Only use parts you are instructed to use.

HARDWARE CONTENTS

AA



Wire Connector
Qty. 3

AJ

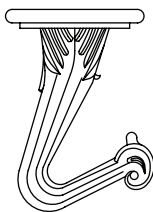

Swag Hook
Qty. 2

AK



Toggle Bolt
Qty. 2

AL



Wing Nut
Qty. 2

AM

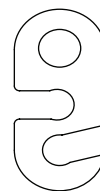

Wire Clip
Qty. 2

AN



Swag Screw
Qty. 2

AO



Concrete
Anchor
Qty. 2

AP



Wire Stay
Qty. 1

RR

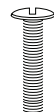

Bracket Screw
Qty. 2

Note: Not all hardware will be used for every installation. Only use hardware instructed.

PREPARATION

Estimated Assembly Time: 60 minutes

Tools Required for Assembly (not included):

Hammer, Wire Cutters, Safety Glasses, Electrical Tape, Pliers, Drill Bits, Drill and Ladder

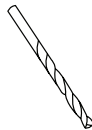
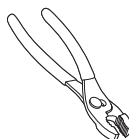
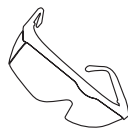
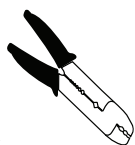
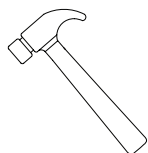

1/8"

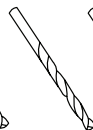

19/64"



5/8"



SAFETY INFORMATION

Please read and understand this entire manual before attempting to assemble, operate or install the product. Failure to do so could lead to electrical shock, fire or other injuries that could be hazardous or even fatal.

- Before you begin installing the light kit, disconnect the power by removing fuses or turning off the circuit breakers.
- The net weight of the light kit is 5.17 lb.
- RATED FOR WET LOCATIONS. This fan is intended for indoor, damp, or outdoor use.

DANGER:

- DO NOT connect this fixture to an electrical system that does not provide a means for equipment grounding. Never use a fixture in a two-wire system that is not grounded. Installing a fixture into an electrical system not having a proper grounding means could cause metal parts of the fixture to carry electrical currents if any of the fixture wires, wire connections or splices were to become broken, cut or loose during the mounting or normal operation of the fixture. Under this condition, anyone coming in contact with the fixture would be subject to electrical shock, which could cause serious injury or death.
- DO NOT connect the bare or green insulation fixture ground wire to the black (hot) current-carrying wire or the white neutral house wire. Connection of the bare or green fixture ground wire to the black or white house wires may cause metal parts of the fixture to carry electrical currents. Under this condition anyone coming in contact with the fixture will receive electrical shock, which could cause serious injury or death.
- DO NOT damage or cut the wire insulation (covering) during installation of the fixture. DO NOT permit wires to contact any surface having a sharp edge. To do so may damage or cut the wire insulation, which could cause serious injury or death from electrical shock.

WARNING:

- All electrical connections must be in agreement with local codes and ordinances, the National Electric Code (NEC) and ANSI/NFPA 70-1999. Contact your municipal building department to learn about your local codes, permits and/or inspections. Risk of fire - most dwellings built before 1985 have supply wire rated for 140°F. Consult a qualified electrician before installation.
- To avoid personal injury, the use of gloves may be necessary while handling fixture parts with sharp edges.
- DO NOT suspend any fixture by the house wires. A fixture must always be mounted directly to an outlet box. Wire connectors will not support the weight of a fixture. Suspending a fixture by the house wires and wire connectors will result in the fixture falling, with the possibility of personal injury and the danger of electrical shock or fire.
- To reduce the risk of fire, electrical shock, or personal injury, each wire connector used with this light kit should accept only one 18-gauge wire from the light fixture and one 18-gauge wire from the outlet box. If there are three or more wires to connect or any of the wires is larger than 18 gauges, consult an electrician for the proper size wire connectors to use.
- If using the fixture in a wet location, the outlet must be connected to a supply circuit that is protected by a Ground Fault Circuit Interrupter (GFCI) to reduce the risk of personal injury, electrical shock or death.
- For use outdoors: ONLY connect the power cord to a covered 120-volt Class A Type GFCI (ground fault circuit interrupter) protected hooded flush type cover plate outlet that is marked "WET LOCATION".

ASSEMBLY INSTRUCTIONS FOR PLUG-IN INSTALLATION

1. Turn off the circuit breakers and the wall switch to the supply line leads.



DANGER: Failure to disconnect the power supply prior to installation may result in serious injury or death.

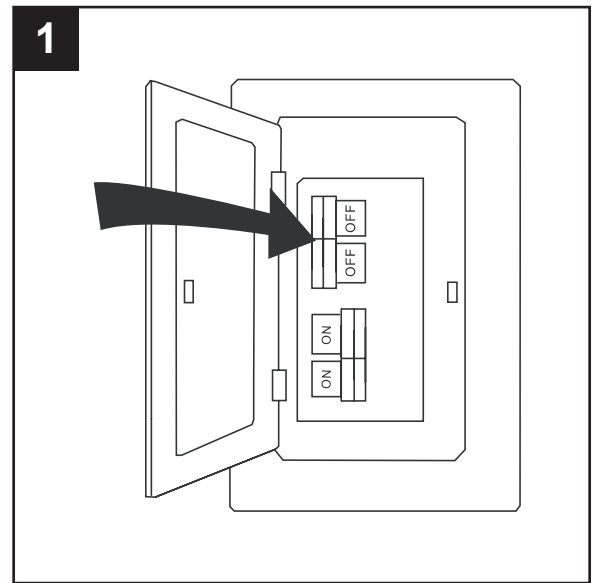

2. This fixture has two options for installation. To install the fixture using the plug-in method, continue to the next step.

To install the fixture without the plug, skip to **ASSEMBLY INSTRUCTIONS FOR HARDWIRE INSTALLATION**, page 11. Note: Hardwire installation requires an outlet box at the installation location.

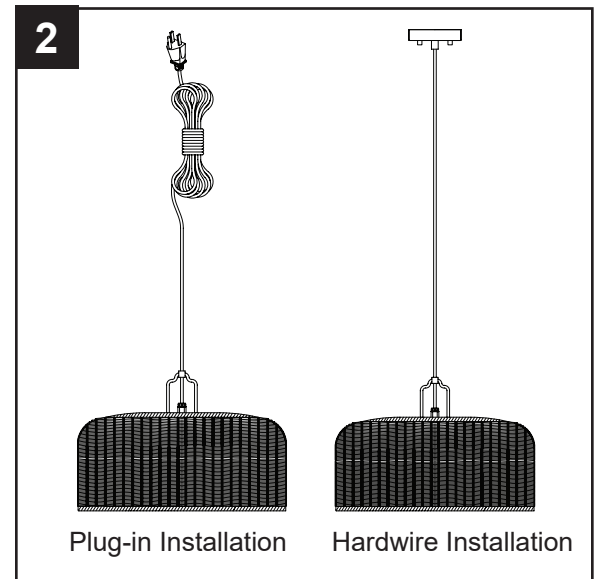

3. The chandelier can be installed in a ceiling or structure made from drywall, wood, or concrete.
For drywall installation, proceed to Step 5-7.
For wood installation, proceed to Step 8-10.
For concrete installation, proceed to Step 11-13.

ASSEMBLY INSTRUCTIONS FOR PLUG-IN INSTALLATION

4. **For drywall installation** - Determine the desired location of the fixture assembly (A) making sure you have access to an electrical outlet and there are no electrical lines or plumbing where you intend to install the first swag hook. The second swag hook should be near the wall where the electrical outlet is located. Mark the swag hook (AJ) locations on ceiling and drill each hole 5/8" in diameter.

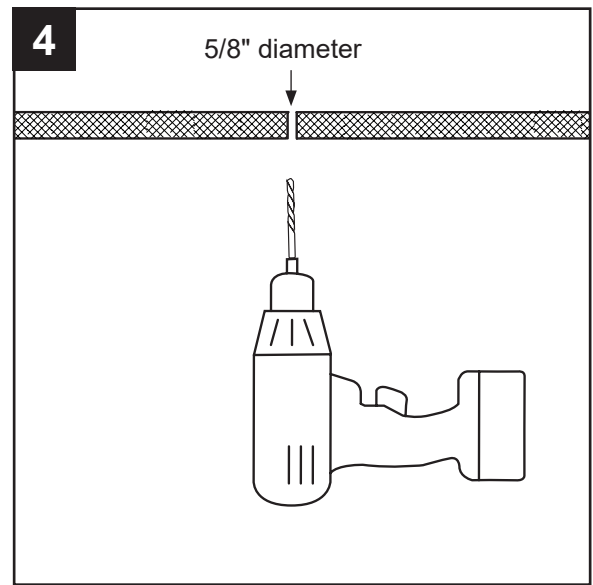

5. Twist toggle bolt (AK) clockwise into swag hook (AJ) until hand tightened. Then twist wing nut (AL) onto toggle bolt (AK). Insert the wing nut (AL) into the hole and turn clockwise until secure.

Hardware Used

AK	Toggle Bolt		x 2
AL	Wing Nut		x 2
AJ	Swag Hook		x 2

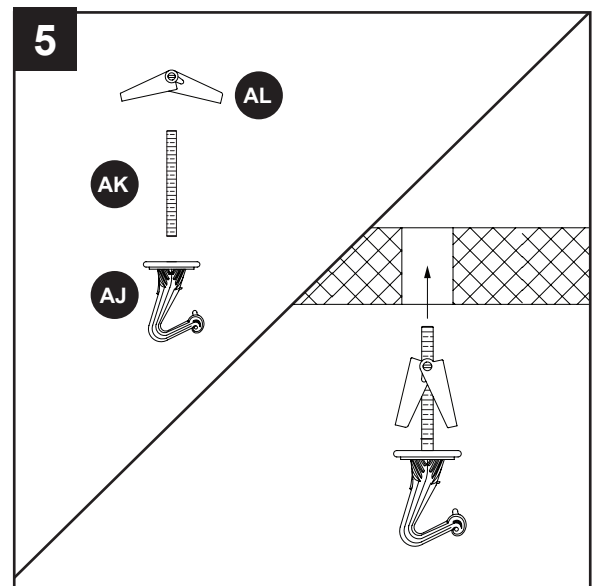

6. Use the wire clips (AM) to hang the fixture wire on swag hooks (AJ), as shown in illustration.

Hardware Used

AM	Wire Clip		x 2
-----------	-----------	--	-----

Skip to Step 13, page 10.

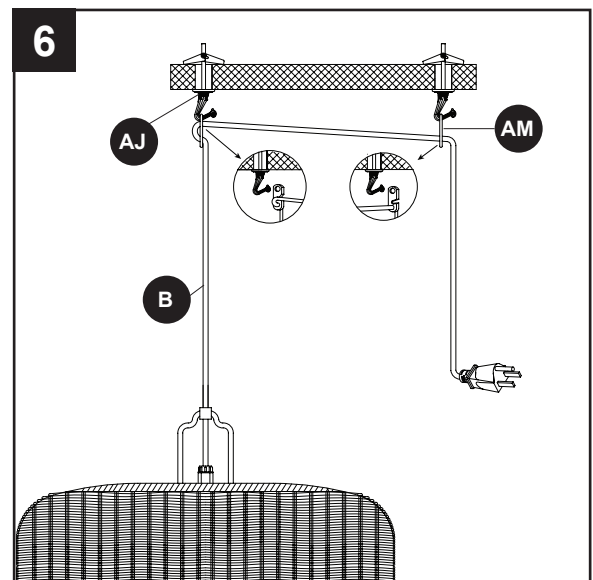

ASSEMBLY INSTRUCTIONS FOR PLUG-IN INSTALLATION

7. **For wood installation** - Determine the desired location of the fixture assembly (A) making sure you have access to an electrical outlet and there are no electrical lines or plumbing where you intend to install the first swag hook. The second swag hook should be near the wall where the electrical outlet is located. Mark the swag screw (AN) locations on ceiling and drill each hole 1/8" in diameter.

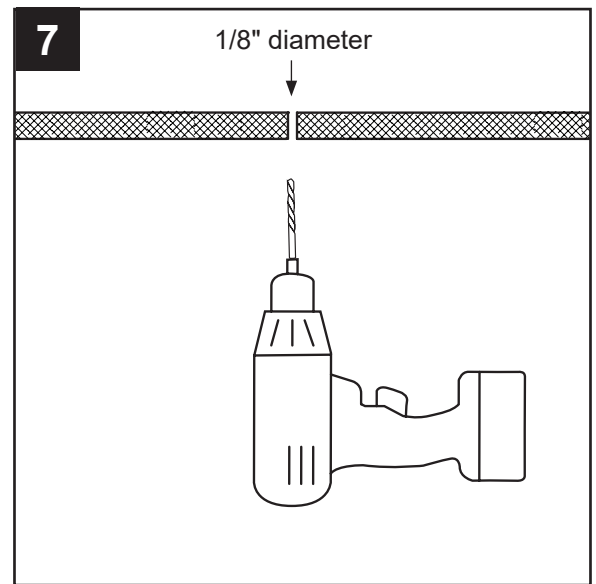

8. Twist swag screw (AN) clockwise into swag hook (AJ) until hand tightened. Insert the swag screw (AJ) into the hole and turn clockwise until secure.

Hardware Used

AN	Swag Screw		x 2
AJ	Swag Hook		x 2

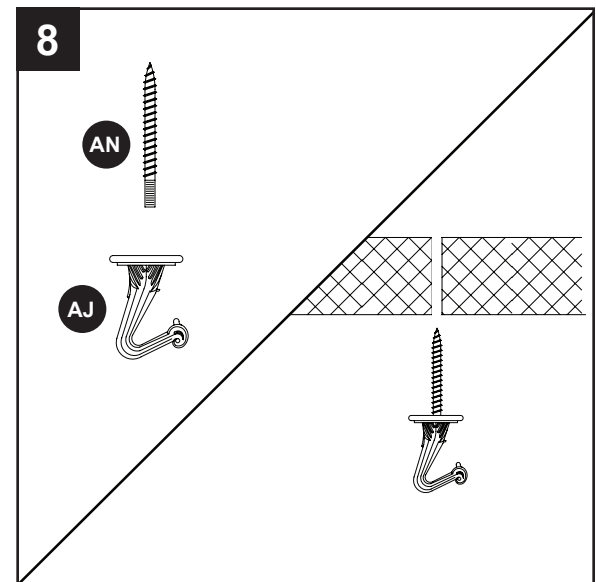

9. Use the wire clips (AM) to hang the fixture wire on swag hooks (AJ), as shown in illustration.

Hardware Used

AM	Wire Clip		x 2
-----------	-----------	--	-----

Skip to Step 13, page 10.

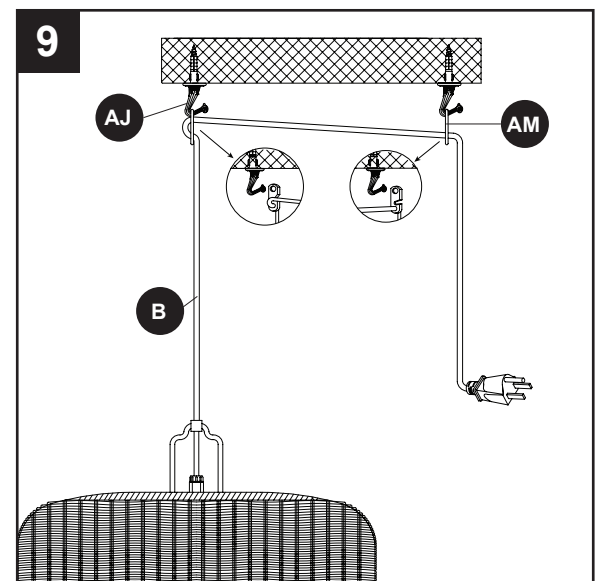

ASSEMBLY INSTRUCTIONS FOR PLUG-IN INSTALLATION

10. **For concrete installation** - Determine the desired location of the fixture assembly (A) making sure you have access to an electrical outlet and there are no electrical lines or plumbing where you intend to install the first swag hook. The second swag hook should be near the wall where the electrical outlet is located. Mark the concrete anchor (AO) locations on ceiling and drill each hole $19/64$ " in diameter.

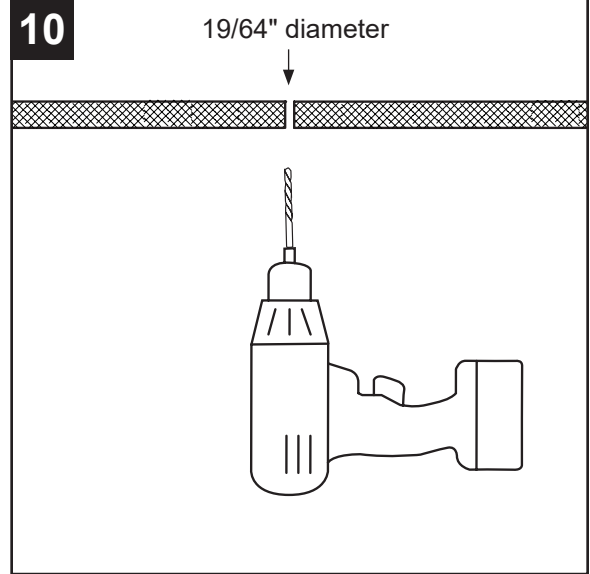

CAUTION: The concrete anchors will support the weight of the fixture. If the fixture falls, it could cause harm or injury. If you are inexperienced or uncertain how to install anchors into concrete, contact a licensed contractor.

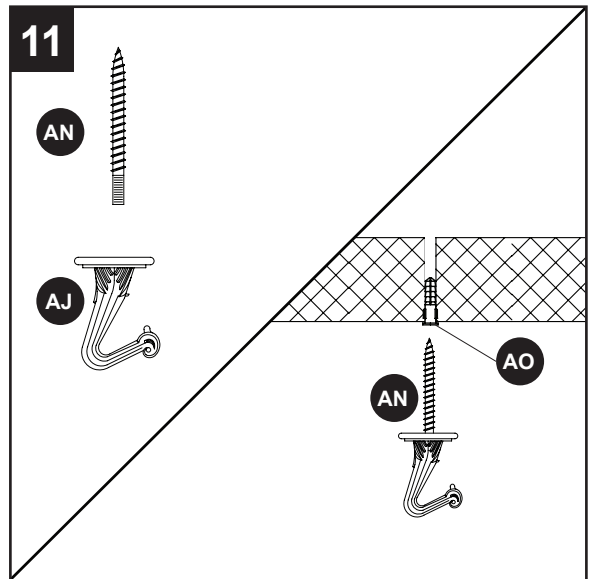

11. Twist swag screw (AN) clockwise into swag hook (AJ) until hand tightened. Then use hammer (not included) to tap the concrete anchor (AO) into the hole in the concrete. Insert the swag screw (AJ) into concrete anchor (AO) and turn clockwise until secure.

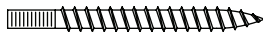
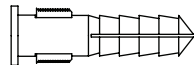

Hardware Used

AN	Swag Screw		x 2
AO	Concrete Anchor		x 2
AJ	Swag Hook		x 2

12. Use the wire clips (AM) to hang the fixture wire on swag hooks (AJ), as shown in illustration.

Hardware Used

AM	Wire Clip		x 2
-----------	-----------	---	-----

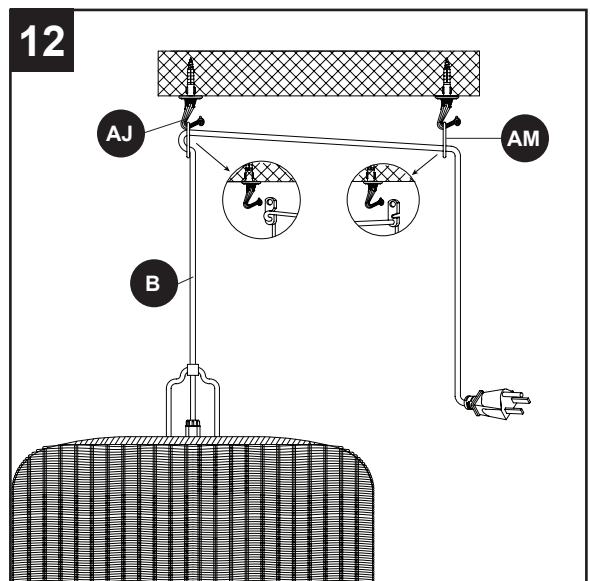

ASSEMBLY INSTRUCTIONS FOR PLUG-IN INSTALLATION

13. Install the E26-base bulb (sold separately) into the socket of the fixture. Note: Fixture is compatible with any E26-base LED bulb (60 watt max.).

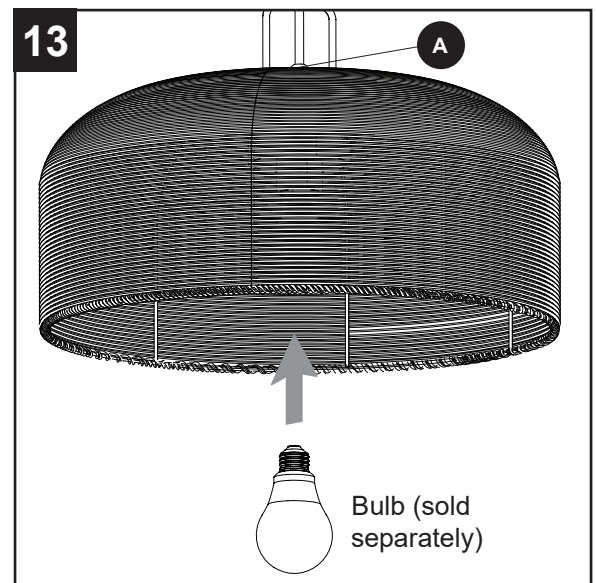

14. Lift the glass shade (D) over the bulb and turn in a clockwise direction to secure. **CAUTION:** Avoid cross-threading the glass shade (D) during installation. Improper installation could cause the glass shade (D) to be difficult to remove or fall, which could cause serious injury.

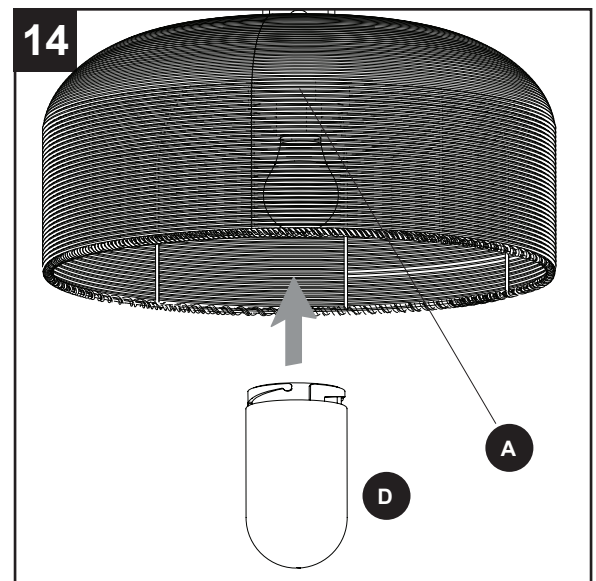

15. Plug fixture into 120V electrical outlet.

WARNING: If using the fixture in a wet location, the outlet must be connected to a supply circuit that is protected by a Ground Fault Circuit Interrupter (GFCI) to reduce the risk of personal injury, electrical shock or death.

For use outdoors: **ONLY** connect the power cord to a covered 120-volt Class A Type GFCI (ground fault circuit interrupter) protected hooded flush type cover plate outlet that is marked "WET LOCATION".

Restore the power to the circuit breakers and the wall switch to the supply line leads.

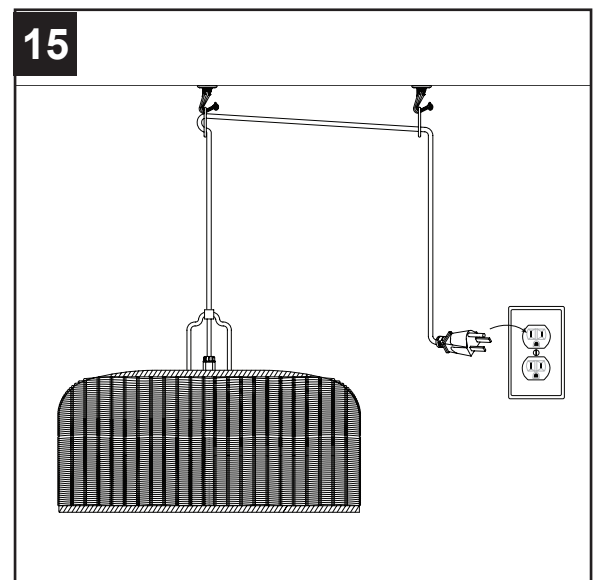

Assembly is complete.

ASSEMBLY INSTRUCTIONS FOR HARDWIRE INSTALLATION

1. For hardwire installation - Determine the distance you want the pendant to hang from the ceiling/structure and add 8 inches to the measurement. Then use wire cutters (not included) to cut off the excess fixture wire.

Important: Once plug and excess fixture wire are removed, the plug-in installation method will no longer be available.

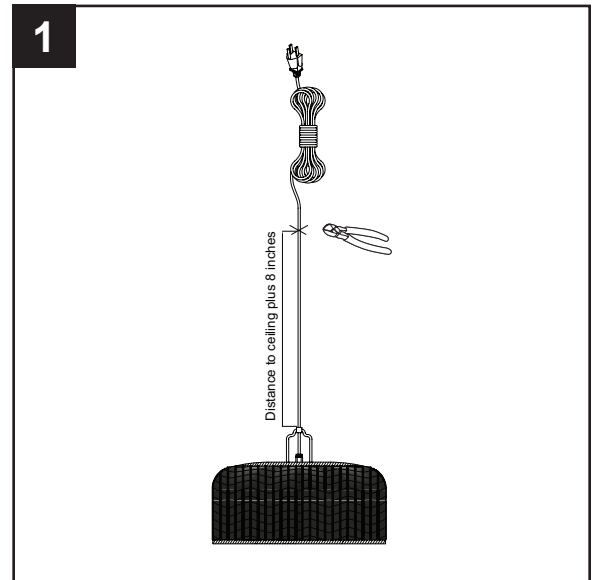

2. Remove the screw caps (G) from the mounting screws (H) preassembled to the mounting bracket (E). Remove the mounting bracket (E) from the canopy (F).

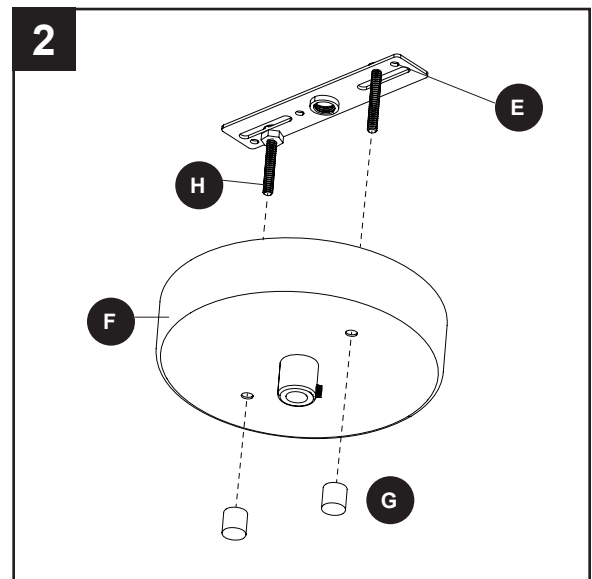

3. Loosen set screw on canopy (F). Feed the fixture wire through the center hole of canopy (F) and mounting bracket (E). Tighten set screw on canopy (F) to secure fixture wire (B).

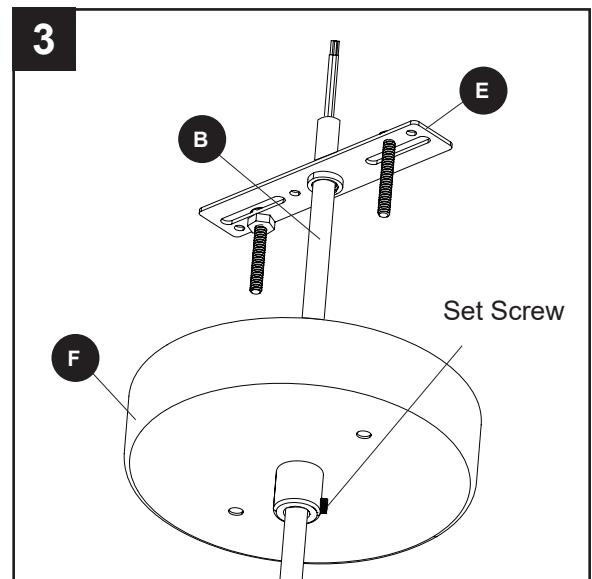

ASSEMBLY INSTRUCTIONS FOR HARDWIRE INSTALLATION

4. Strip 1/2 in. of insulation from the end of the wires. Twist the stripped ends of each strand of wire within the insulation with pliers (not included). Repeat this step for black and green wires.

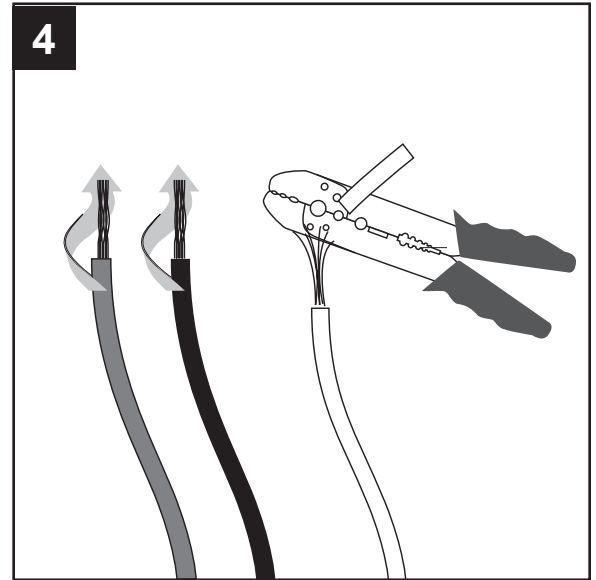

6. Use the bracket screws (RR) to attach the mounting bracket (E) securely to the outlet box (sold separately).

Hardware Used

RR Bracket Screw  x 2

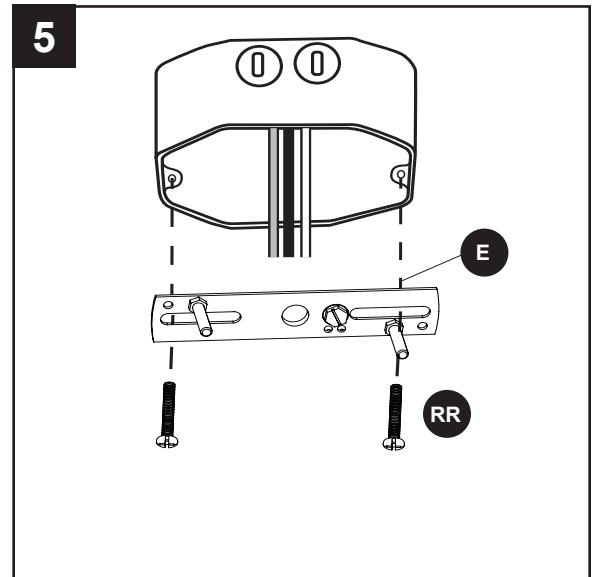

6. Loosen the ground screw on the mounting bracket (E) and wrap the bare wire from the fixture (A) around the ground screw. Tighten the ground screw to hold the bare wire in place. **Note:** Ensure there is enough of the bare wire extending from the ground screw to connect to the ground wire from the outlet box using a wire connector (AA).

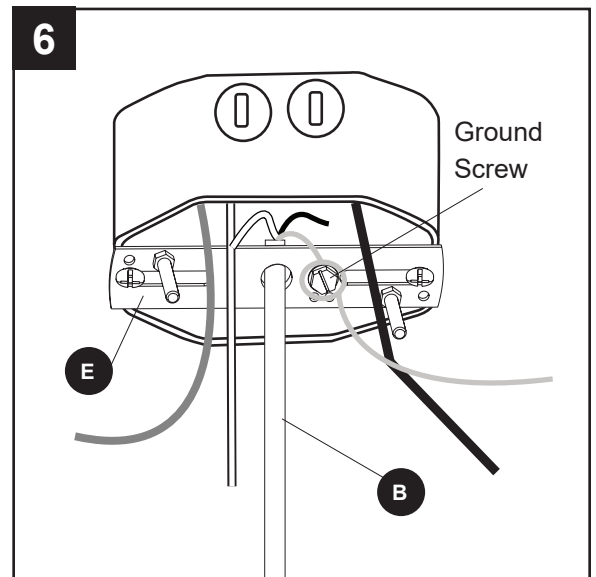

ASSEMBLY INSTRUCTIONS FOR HARDWIRE INSTALLATION

8. Use wire connectors to secure the household supply wires to the fixture wires according to the image and the following instructions:

- Connect the black (hot) supply wire to the black wire from the fixture.
- Connect the white (neutral) supply wire to the white wire from the fixture.
- Connect the bare/green (ground) supply wire to the bare wire from the fixture.

Turn the wire connections and gently push them into the outlet box.

Hardware Used



Wire Connector



x 3

8. Wrap electrical tape (not included) around each individual wire connectors (AA) down to the wire. Turn the spliced/taped wires upward and gently push the wires and wire connectors (AA) into the outlet box.

WARNING: Ensure no bare wire strands are visible after making connections. Place the ground and neutral supply wire connections on opposite sides of outlet box from the hot wire connection.

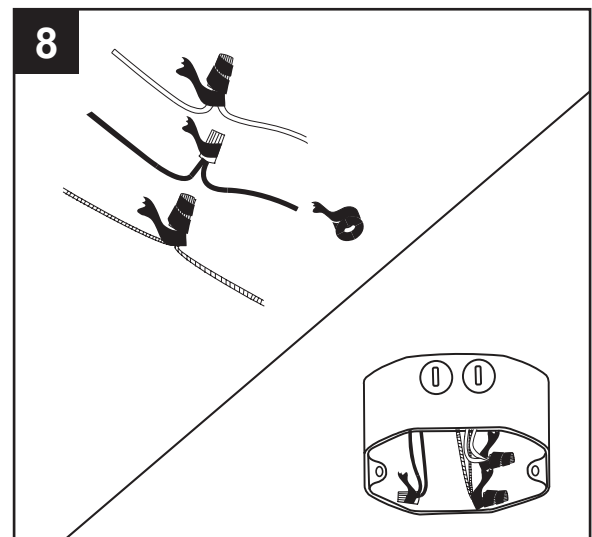
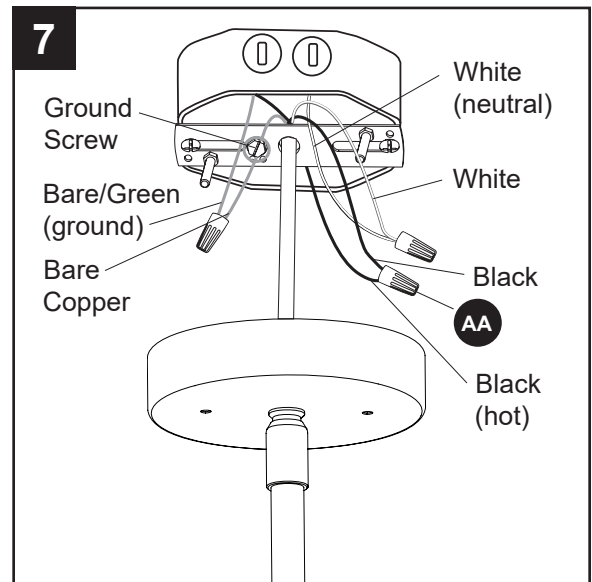

9. Align the holes in the canopy (F) with the mounting screws. Then lift the canopy (F) and attach the screw caps (G) to secure the canopy (F). **Note:** If the canopy (F) is not flush against the ceiling, remove the fixture and loosen the hex nuts to allow the mounting screw (H) length to be adjusted. Once adjusted retighten the hex nuts and reinstall the canopy (F).

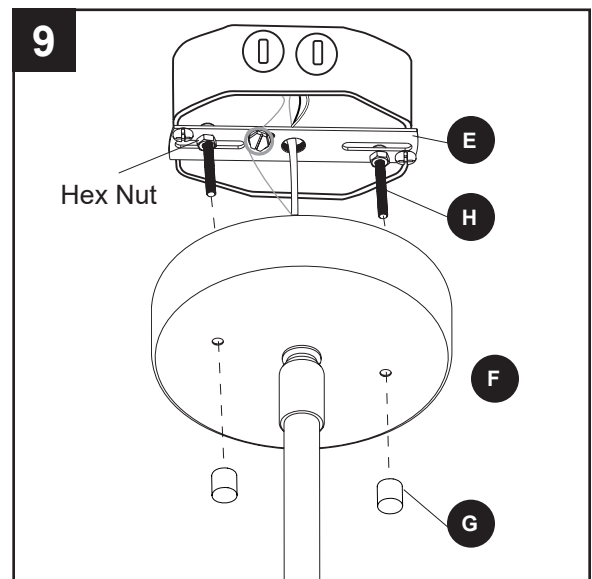

ASSEMBLY INSTRUCTIONS FOR HARDWIRE INSTALLATION

10. Install the E26-base bulb (sold separately) into the socket of the fixture. **Note:** Fixture is compatible with any E26-base LED bulb (60 watt max.).

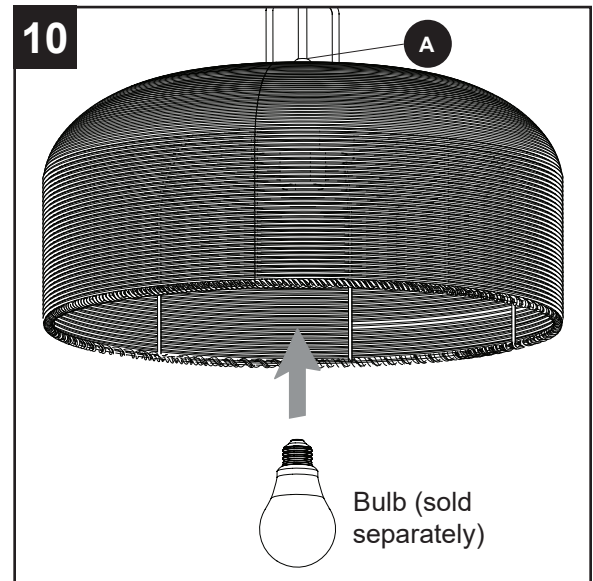

11. Lift the glass shade (D) over the bulb and turn in a clockwise direction to secure. **CAUTION:** Avoid cross-threading the glass shade (D) during installation. Improper installation could cause the glass shade (D) to be difficult to remove or fall, which could cause serious injury.

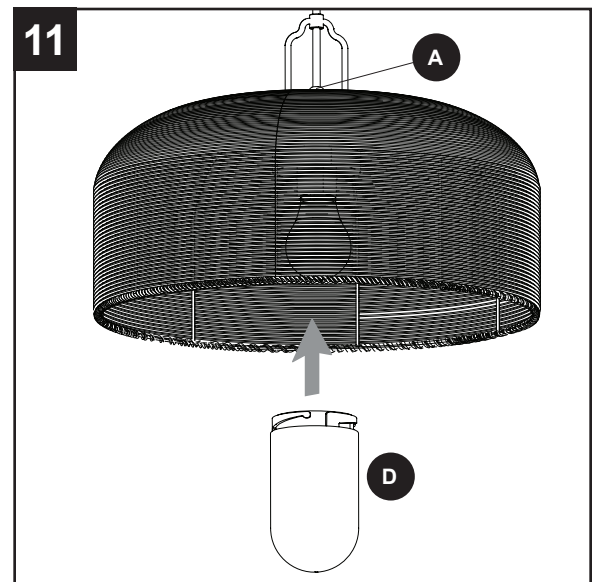

12. Restore the power at the main fuse or circuit breaker and wall switch.

Assembly is complete.

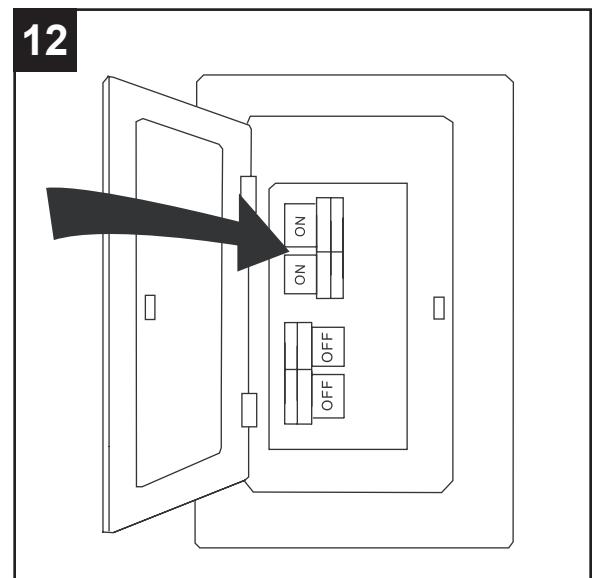

OPERATING INSTRUCTIONS

1. Use switch (C) located at bottom of fixture to turn on/off.

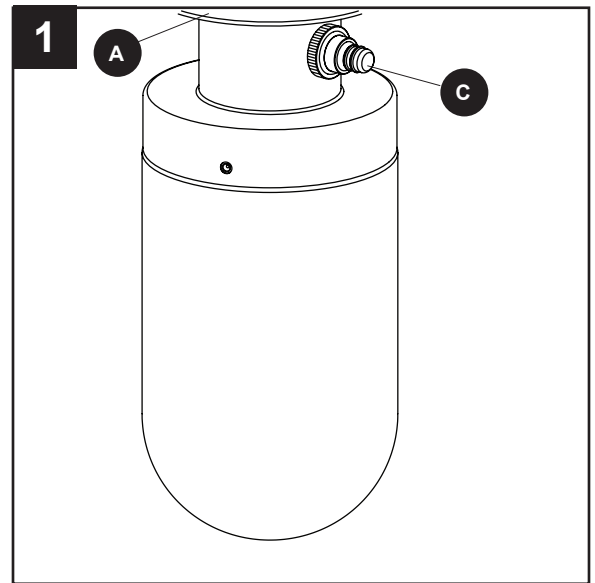

TROUBLESHOOTING

PROBLEM	POSSIBLE CAUSE	CORRECTIVE ACTION
Bulbs will not light.	1. Fixture may be wired incorrectly. 2. Worn or broken bulbs.	1. Check wiring. 2. Replace bulbs.
Canopy (H) does not sit flush with ceiling.	Edge of outlet box may not be flush with ceiling.	If the canopy (F) is not flush against the ceiling, remove the canopy (F) and loosen the hex nuts to allow the mounting screw (H) length to be adjusted. Once adjusted retighten the hex nuts and reinstall the canopy (F).

THREE-YEAR LIMITED WARRANTY

The manufacturer warrants all of its lighting fixtures against defects in materials and workmanship for three (3) years from the date of purchase. If within this period the product is found to be defective, take a copy of the bill of sale as a proof of purchase and the product in its original carton to the place of purchase. The manufacturer will, at its option, repair, replace or refund the purchase price to the consumer. All costs of installation and removal of the fixture is the responsibility of the consumer. This warranty does not cover fixtures becoming defective due to misuse, accidental damage or improper handling and/or installation and specifically excludes liability for direct, incidental or consequential damages. As some states do not allow exclusions of limitations on an implied warranty, the above exclusion and limitation may not apply. This warranty gives you specific rights and you may also have other rights which may vary from state to state.