



Harbor Breeze® is a registered trademark of LF, LLC. All rights reserved.

ITEM #0805608, 0829276, 0829277

# ANGLED CEILING ADAPTER

MODEL #40030, 40295, 40294

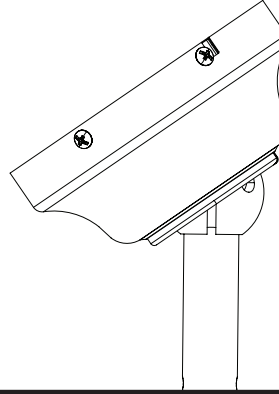

## ATTACH YOUR RECEIPT HERE

Purchase Date \_\_\_\_\_

## PACKAGE CONTENTS

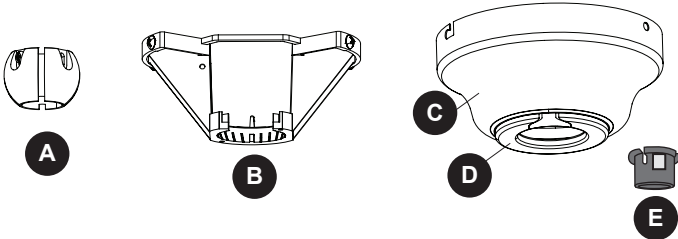

PART	DESCRIPTION	QUANTITY
A	Ball	1
B	Mounting Bracket	1
C	Canopy	1
D	Canopy Cover (preassembled to Canopy [C])	1
E	Ball Adapter	1

## HARDWARE CONTENTS (shown actual size)

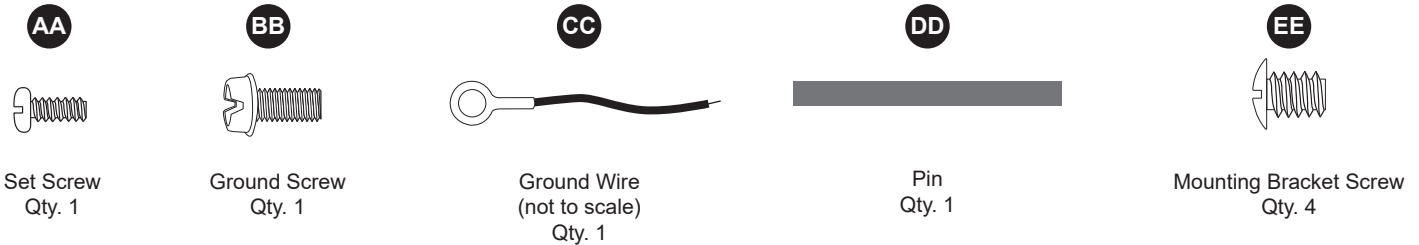

## SAFETY INFORMATION

Please read and understand this entire manual before attempting to assemble, operate or install the product.

### WARNING

- ELECTRICAL SHOCK HAZARD/FIRE HAZARD: Disconnect power before removing or installing parts in fixture. Failure to do so can result in death or electrical shock.
- To prevent fire, install in accordance with appropriate electrical codes and regulations.
- It is extremely important the outlet box is securely attached to the building structure and can support the full weight of the fan. Do NOT use a plastic outlet box. Ensure the outlet box is clearly marked "Suitable for Fan Support." If not, it must be replaced with an approved outlet box. Failure to do so can result in serious injury.
- Failure to align slot in ball with tab may cause fan to wobble or fall, which could result in serious injury or death.

### CAUTION

- Ceiling angle is not to exceed 45° for 1/2-in. or 3/4-in. downrods.
- It is imperative you use the hanging bracket and canopy provided with this angled ceiling adapter as the screw holes in the hanging bracket are aligned to fit specifically with the screw holes in the canopy provided.

## PREPARATION

Before beginning assembly of product, make sure all parts are present. Compare parts with package contents list and hardware contents list. If any part is missing or damaged, do not attempt to assemble the product.

**Estimated Assembly Time:** 30 minutes

**Tools Required for Assembly (not included):** Phillips Screwdriver and Step Ladder

## ASSEMBLY INSTRUCTIONS

**Note:** This item was designed for use with an existing ceiling fan. It will be necessary to purchase a longer downrod in order to install the fan to a vaulted ceiling. The parts included with this item will be used instead of similar parts included with your fan.

1. Turn off circuit breakers and wall switch to the fan supply line leads.

**⚠ DANGER:** Failure to disconnect the power supply prior to installation may result in serious injury or death.

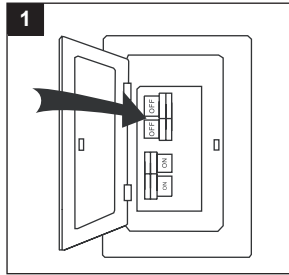

2. With the mounting bracket (B) resting inside the canopy (C), partially install two mounting bracket screws (EE) into the two holes surrounded by the J-slots in the canopy (C). Then, remove the mounting bracket (B) from the canopy (C).

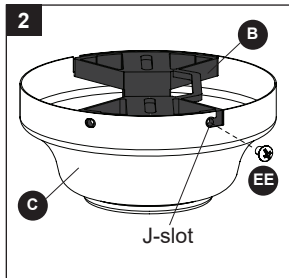

3. Using the screws and washers provided with the outlet box (not included), secure the mounting bracket (B) to a "Ceiling Fan Rated" outlet box. The opening of mounting bracket (B) should open toward the floor.

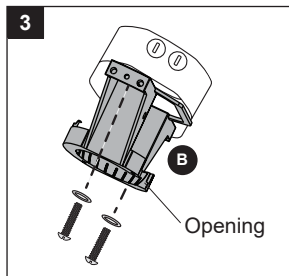

4. Slide the accessory downrod (sold separately) into the yoke of the ceiling fan. Install the accessory downrod according to the instruction manual included with the ceiling fan.

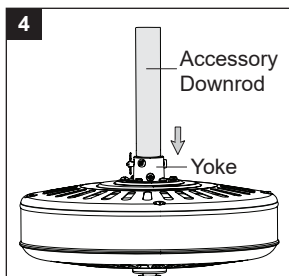

5. If using this item on an angled ceiling, snap out the perforated section of the canopy cover (D).

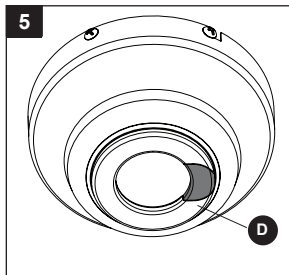

6. Slide the canopy (C) of your choice and the ball (A) onto the accessory downrod. **Note:** Ball (A) must be positioned with the holes near the top of the downrod.

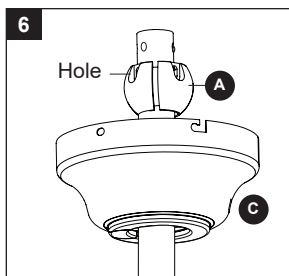

- 7a. If using a 3/4-inch diameter accessory downrod, attach the ground wire (CC) to the smaller hole in the accessory downrod using the ground screw (BB). Then slide the pin (DD) into the two large holes at the top of the downrod.

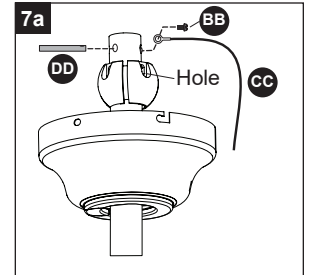

- 7b. If using a 1/2-in. diameter downrod, slide the ball adapter (E) onto the accessory downrod and down into the center of the ball (A). Then, attach the ground wire (CC) to the small hole in the top of the accessory downrod with the ground screw (BB). Align the large holes in the ball adapter (E) with the large holes in the top of the accessory downrod, then slide pin (DD) through larger holes in the ball adapter (E) and downrod.

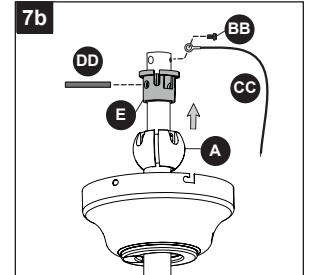

8. Raise the ball (A) to the top of accessory downrod, aligning hole in the ball (A) with set screw hole at top of downrod. This will allow the pin (DD) to fall into the proper slot in the top of the ball (A). Then, secure the ball (A) to the top of the accessory downrod using the set screw (AA).

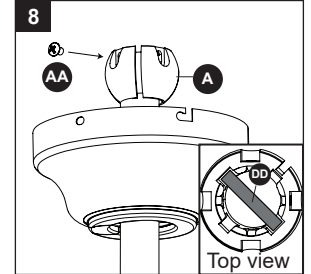

9. Lift the ball (A) along with the fan into the opening in the mounting bracket (B). Align one of the slots in the ball (A) with the tab in the mounting bracket (B).

**⚠ DANGER:** Failure to align a slot in the ball (A) with the tab in the mounting bracket (B) may cause fan to wobble or fall, which could result in serious injury or death.

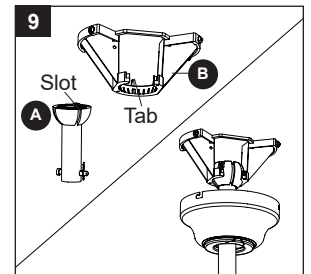

10. Align the canopy (C) over the loose mounting bracket screws (EE) preassembled on the mounting bracket (B) in Step 2. Then, twist canopy (C) to lock. Insert two more mounting bracket screws (EE) into the round holes of the canopy (C). Tighten all four mounting bracket screws (EE).

