

MOUNTING & WIRING

DIMENSION

WARNING:

Improper installation may cause electrical shock, fire, or equipment damage. The person performing the installation must be familiar with the construction and operation of the product and associated hazards.

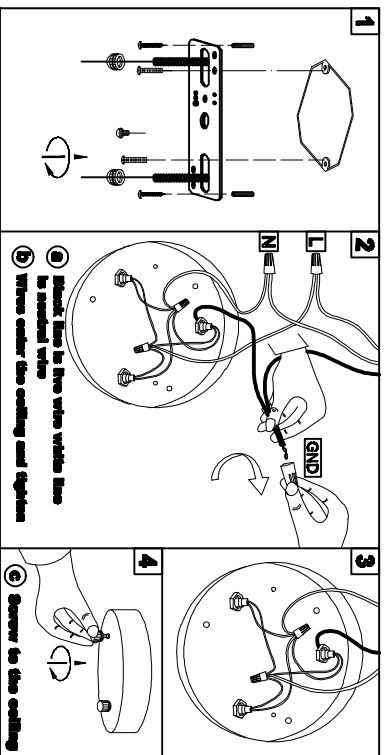

Wire Connection Diagram:

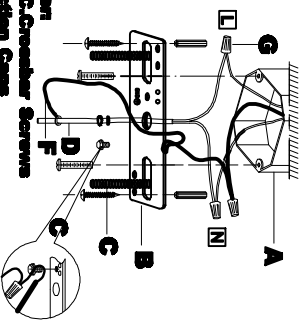
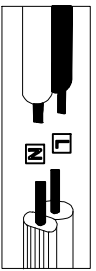

Please proceed in an alphabetical order:
A.Drilling Electrical BOX **B**.Screwdriver **C**.Screwdriver Screws
D.Drilling Wire **E**.Canopy **F**.Wire **G**.Junction Caps
 Attach the canopy(**E**) to the existing electrical box(**A**) using the two screwdriver screws(**C**) which are not supplied and should already be in your box. Pass the main wire(**F**) and ground wire(**D**) through the canopy(**E**) and the screwdriver(**C**) until the end of the main wire(**F**) reaches the electrical box.
 (A)where you can wire use electrician connections. Be sure when connecting the wire use electrician approved junction caps(**D**). After the excess wire in the electrical box(**A**) make the canopy(**E**), attach canopy(**E**) to ceiling and hold the canopy(**E**).

