

CARE AND MAINTENANCE

Never use abrasive or acid-based cleaners on the shelf rack.
Clean shelves and rods with a solution of mild detergent and water. Use a soft cloth or sponge to wipe parts. Rinse and dry thoroughly. Keep surfaces dry and clean for a longer lasting finish.

NOTICE

- Please read and understand these instructions before attempting to assemble, operate or install the product.
- Two adults required for a assembly.
 - Do not allow children to climb or play in or around the shelves.
 - Each shelf holds up to 600 lbs. when items are evenly distributed with levelers.
 - Assemble on a soft surface, such as carpeting to avoid scratching the finish.

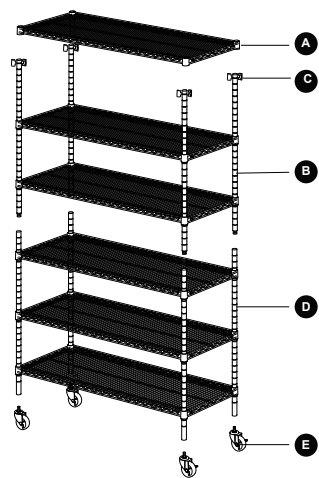

Part	Description	Picture	Quantity
A	Shelves		6
B	Upper Pole (with Joiner)		4
C	Spacers		26
D	Lower Pole (with leveler)		4
E	Caster		4

PREPARATION

- 1.Before beginning assembly of product, make sure all parts are present. Compare parts with package contents list and hardware contents . If any part is missing or damaged, do not attempt to assemble the product.
- 2.Estimated Assembly Time: Approximately 15 - 20 minutes.
- 3.Helpful Tools (not included):Rubber Mallet.
- 4.No Tools Required for Assembly.

SAFAVIEH
FURNITURE

Model# HAC2005A , HAC2005B

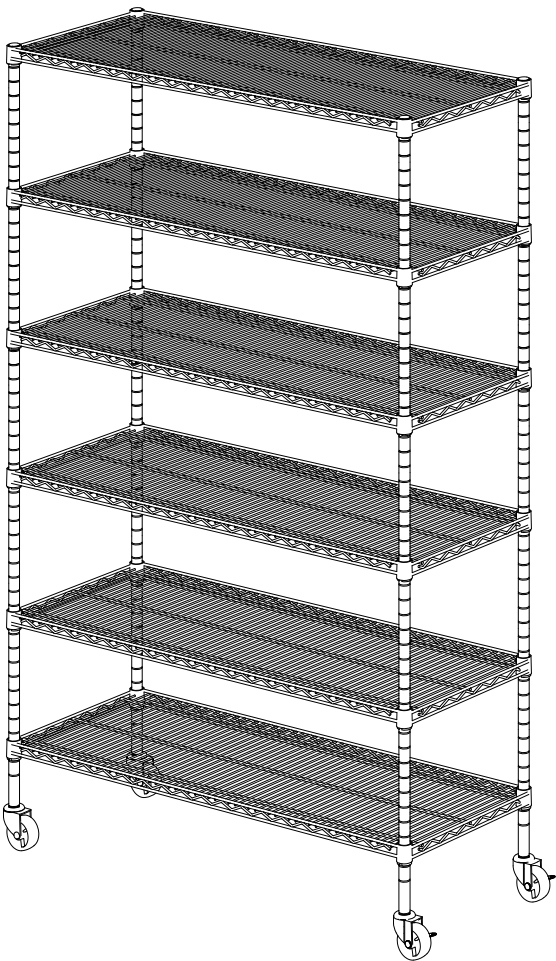

48 in W x 18 in D x 72 in H

Assembly Instructions

1

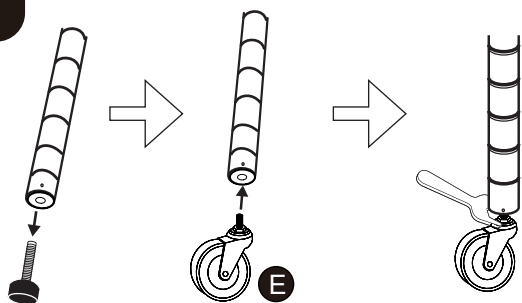

Turn the levelers out and replace them with the casters. Screw the Casters (E) onto the threaded end of the Lower poles (D). Tighten securely with the wrench.

2

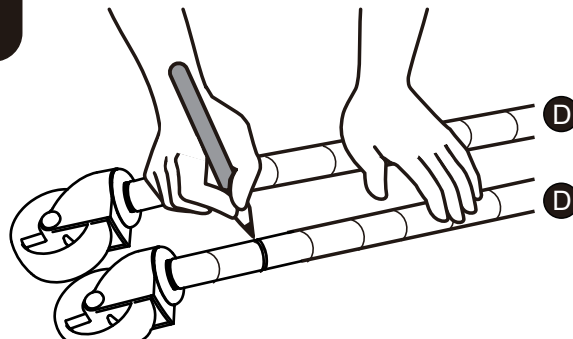

Use a pen to mark the height on the 4 Lower Poles (D). Be sure all poles are marked in the same location.

3

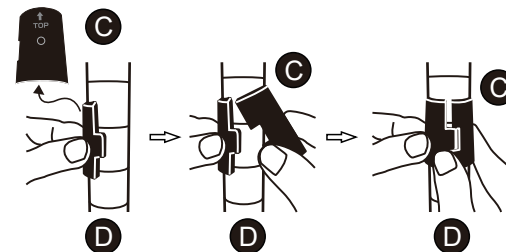

Attach 2 Spacers (C) at the pen marks on the 4 Lower Poles (D). Keep the arrows on the spacers (C) pointed upwards.

4

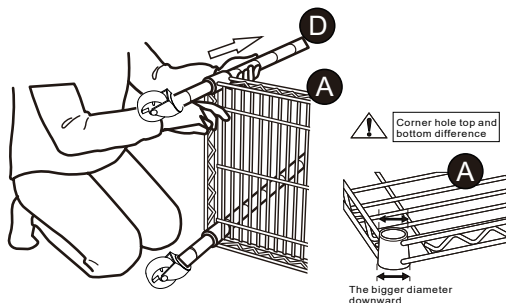

Place the Lower Poles (D) through the corner holes of 1 Shelf (A). Fit the shelf carefully and securely over the Spacers (C).

5

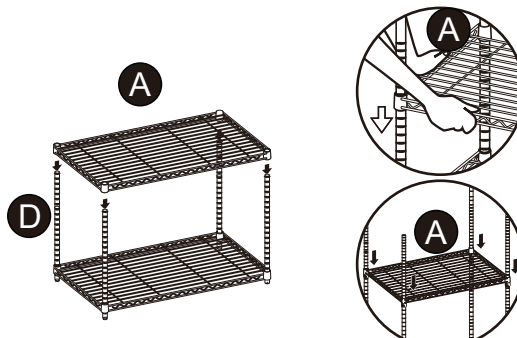

Install the second Shelf (A) following steps 2-3.

6

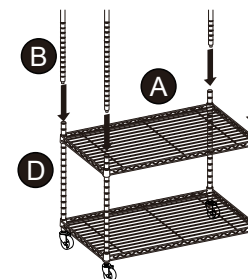

Screw the Upper Poles (B) onto the threaded ends of the Lower Poles (D). Be sure the connection is secure & tight.

7

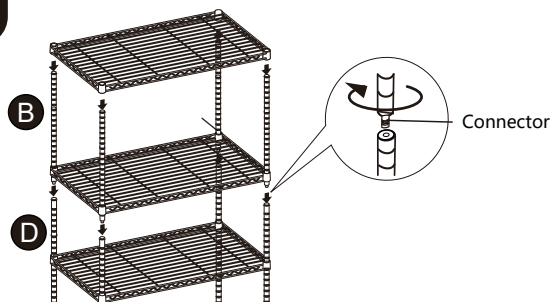

Install remaining Shelves (A) following steps 2-3.

8

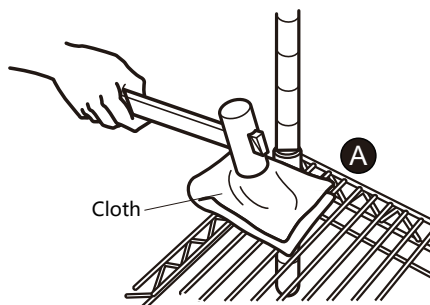

Use the rubber mallet to tap the shelves into place for a secure fit. Use a soft cloth between the shelf & mallet to prevent damage to the shelf.

9

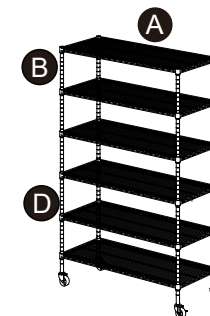

Assembly is Complete.