

# ASSEMBLY INSTRUCTIONS

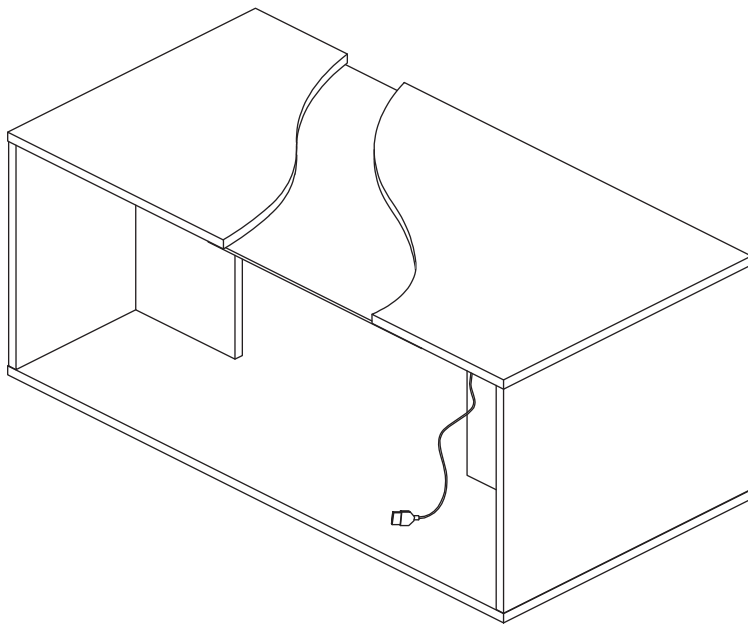

## TOOLS REQUIRED



### Hammer

(Not Included)



### Philips Screwdriver

(Not Included)



**2 - People  
Recommended**

## ASSEMBLY RATING



EASY —————> DIFFICULT

The Assembly Rating is a 5-point system showing the level of effort needed to assemble a specific product.



**Thank you for your purchase!**

We hope you enjoy this new addition to your home for many years to come.

Our commitment to providing quality products does not simply end when you purchase our product. We fully stand behind our products from start to finish. Our customer service department is available Monday – Friday 8:30 AM – 5:30 PM Pacific and can help with assembly questions as well as, if necessary, replacing damaged or missing parts. To help expedite our service, please have these assembly instructions readily available, along with your order receipt.



**Consumer Hotline**  
Toll-Free 1-888-980-5122



**Monday to Friday**  
8:30AM- 5:30PM (PST)



**WEBSITE**  
[www.foagroup.com](http://www.foagroup.com)



**E-MAIL**  
[cs.ec@foagroup.com](mailto:cs.ec@foagroup.com)



foagroup



FurnitureOfAmerica



## **CHECK BEFORE STARTING**

☐

### **Are you missing anything?**

Double-check all parts, hardware and accessories listed are all accounted for.

☐

### **Check out our Quick Tips!**

We recommend reviewing the pre-assembly handouts. Even experts need a refresher now and then!

☐

### **Should we send any replacements?**

Are there any irregularities or flaws in the parts? We can send replacements!

☐

### **Prep Time!**

Please review the assembly instructions and all diagrams prior to assembling. Arrange parts as recommended on Page 7 and group identical hardware together to make assembling easier.

# PRE ASSEMBLY INTRODUCTION

We understand building ready-to-assemble furniture can be a challenging experience for some. To help avoid confusion, we have provided some helpful tips that may speed up the process.

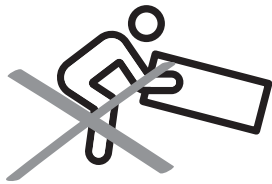

## Teamwork

ALWAYS have at least two people to help with transporting and assembling the product to avoid potential injury and/or damage.

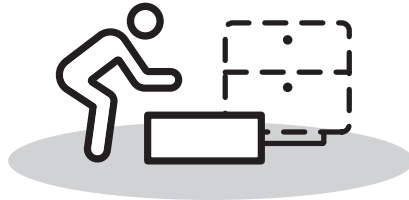
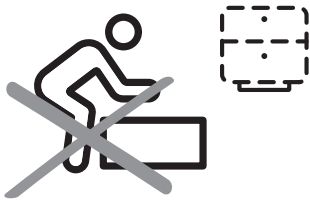

## Suitable Location

Assembling near the area of the intended location is highly recommended.



## Sufficient Space

Make sure you have enough space to move around during the assembly.

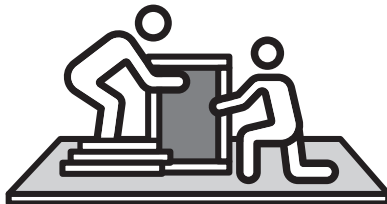

## Avoid Scratches

Use cardboard, blankets or a carpeted area while assembling furniture to prevent scratches.

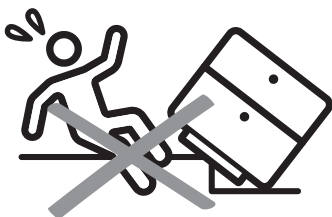

## Flat Surface

Make sure the furniture rests on a flat and level surface with each leg evenly touching the floor.

# ASSEMBLY AND CARE ADVICE



**FAILURE TO FOLLOW THE GUIDELINES BELOW MAY  
RESULT IN INJURY AND/OR PROPERTY DAMAGE.**



Position each part correctly  
and insert screws or bolts into  
their respective holes.

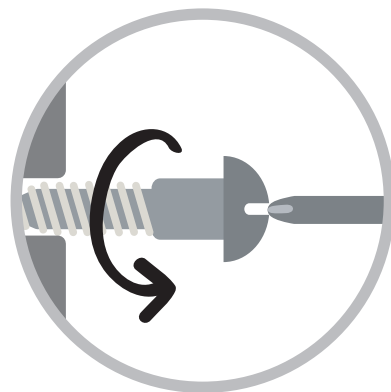

Turn clockwise to tighten and  
only tighten when step is  
completed or when instructed  
to do so.



Save the instructions and store  
any supplied tools for later  
maintenance.

Use the appropriate hand tools  
or power tools for assembly.  
Select steps, such as tightening  
screws and/or bolts, may require  
hand tools to avoid causing  
damage during assembly.

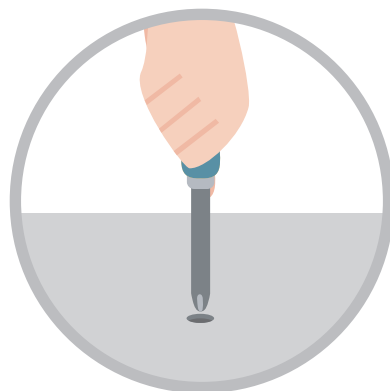

After two weeks, check and  
tighten any loose hardware and  
repeat again every six months  
thereafter.

**IT IS THE USER'S RESPONSIBILITY TO MAINTAIN THE FURNITURE. THE HARDWARE MAY LOOSEN OVER TIME AND MAY CAUSE THE FURNITURE TO BE WOBBLY AND UNABLE TO SUPPORT ITS INTENDED WEIGHT CAPACITY. THIS MAY LEAD TO COLLAPSE AND MAY CAUSE SERIOUS INJURY.**

# CAM LOCK FASTENER ASSEMBLY INSTRUCTIONS

## Note :

Every cam lock bolt must have a cam lock connector in order to fasten the parts together.

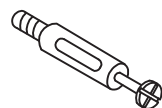

cam bolt



cam lock

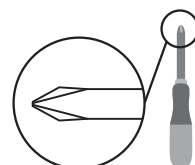

screwdriver

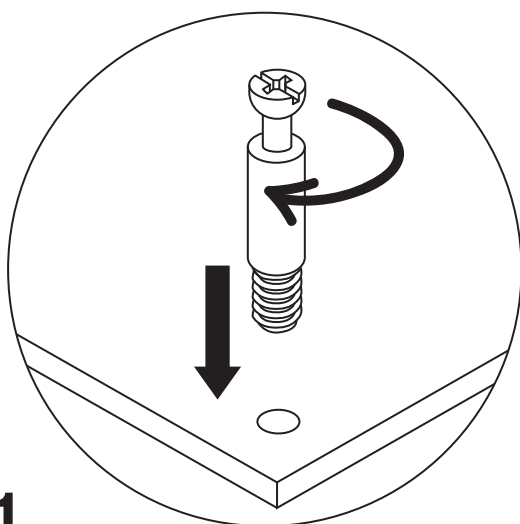

**1**

Screw the cam bolt into panel.

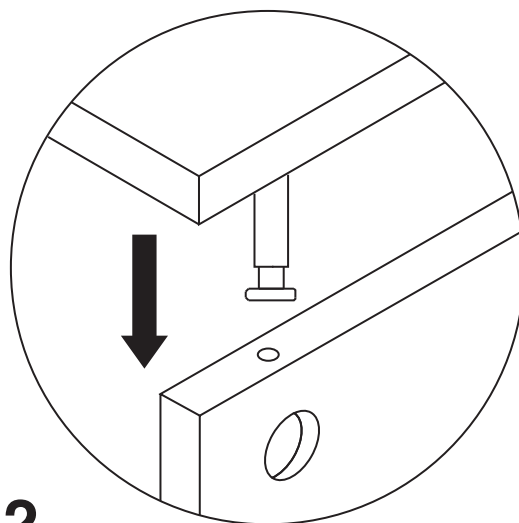

**2**

Insert the cam bolt into the bolt hole of joint panel.

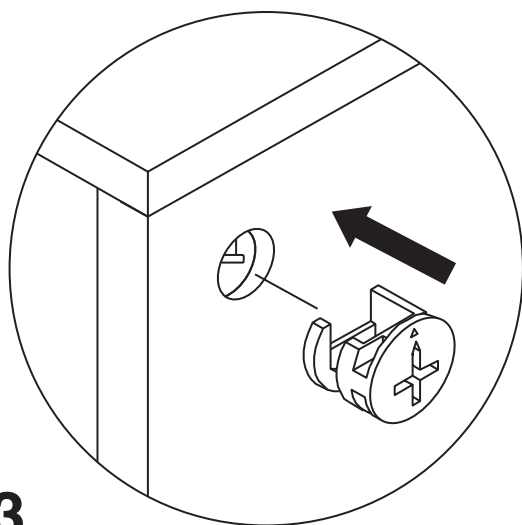

**3**

Align the cam lock with its side opening (or arrow) pointing to cam bolt.

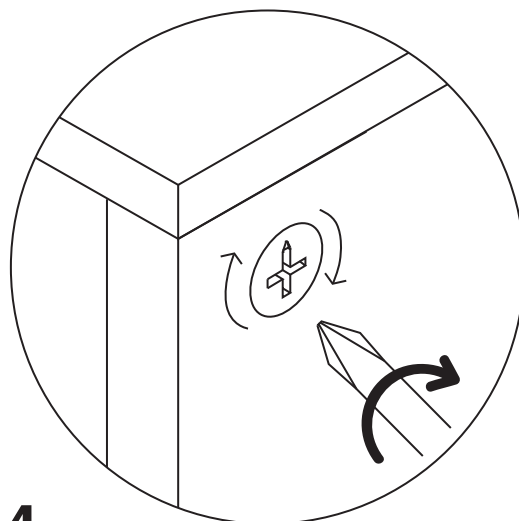

**4**

Turn the cam lock clockwise gently until it will not turn any more.

# COFFEE TABLE

FGI-2394C26

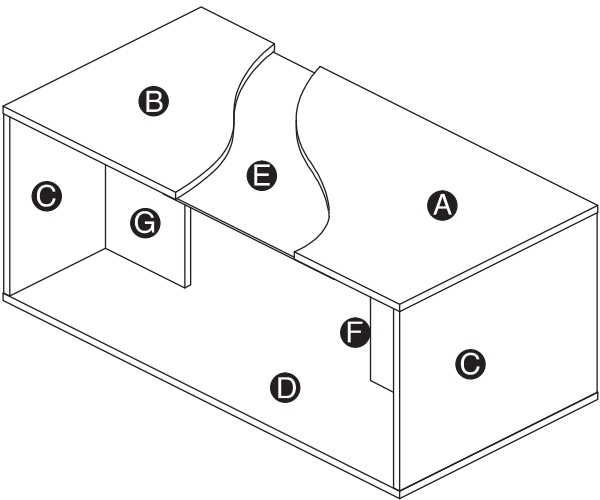
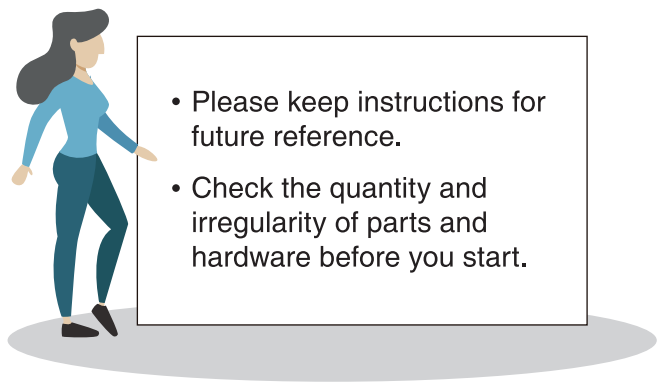

## PARTS

A1PC

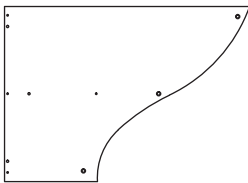

B1PC

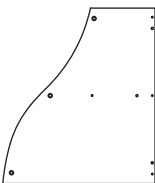

C2PCS

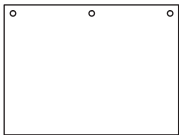

D1PC

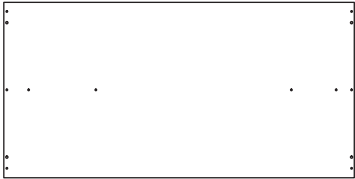

E1PC

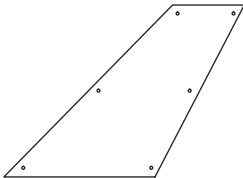

F1PC



G1PC



## HARDWARE

① 8PCS

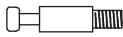

② 8PCS



0.47"

③ 10PCS



0.98"

④ 10PCS

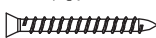

1.57"

⑤ 6PCS



⑥ 6PCS



## ACCESSORIES

A1 6PCS



A2 1PC



A3 1PC



A4 1PC



A5 1PC



A6 3PCS



A7 6PCS



# GET READY

Please group boards as below.

**A**1PC

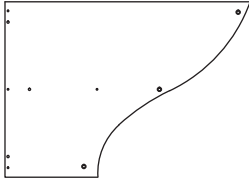

**B**1PC

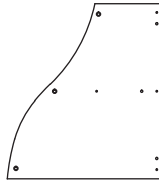

**E**1PC

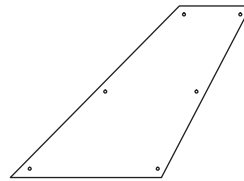

**C**2PCS

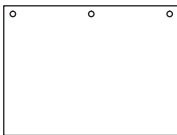

**F**1PC

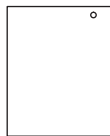

**G**1PC



**D**1PC

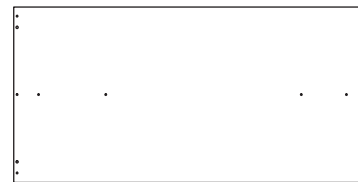

Body

# ASSEMBLY INSTRUCTIONS

# 1

Part **A** x1PC

Part **B** x1PC

Part **E** x1PC

Hardware **①** x 8PCS

Hardware **③** x 10PCS

Hardware **⑤** x 6PCS

Hardware **⑥** x 6PCS

Accessory **A2** x 1PC

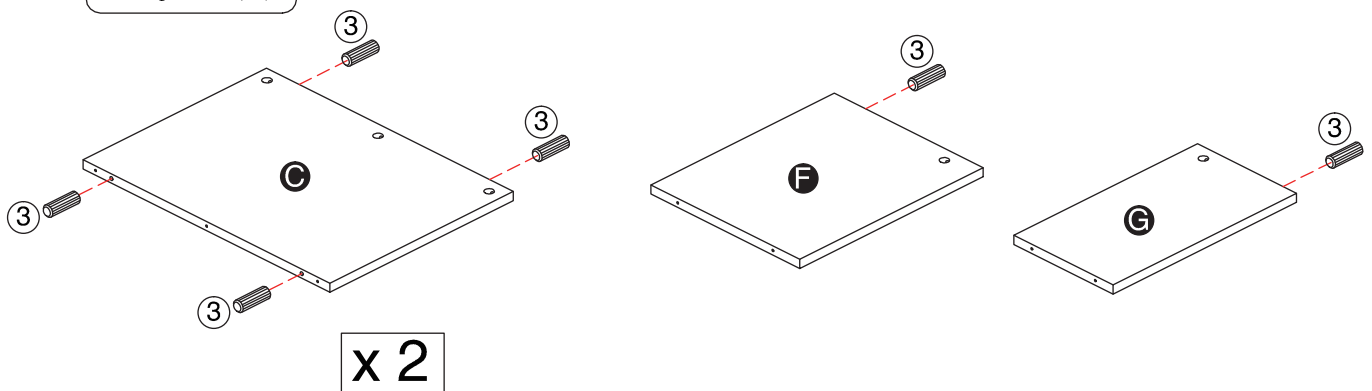
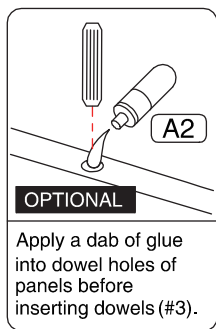
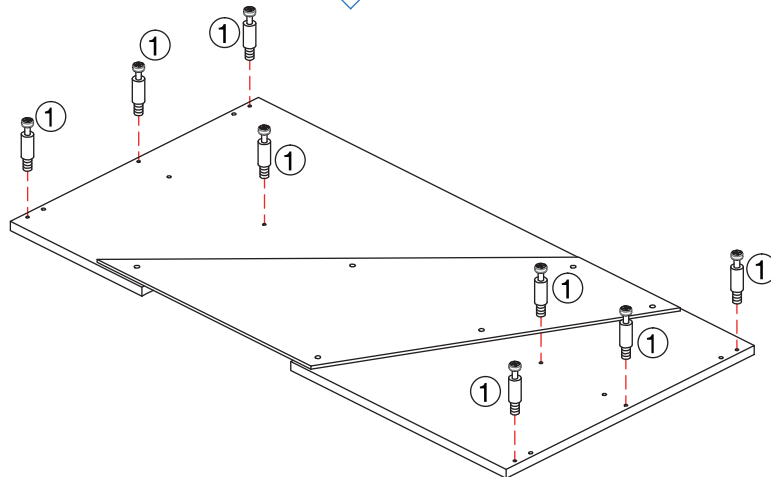
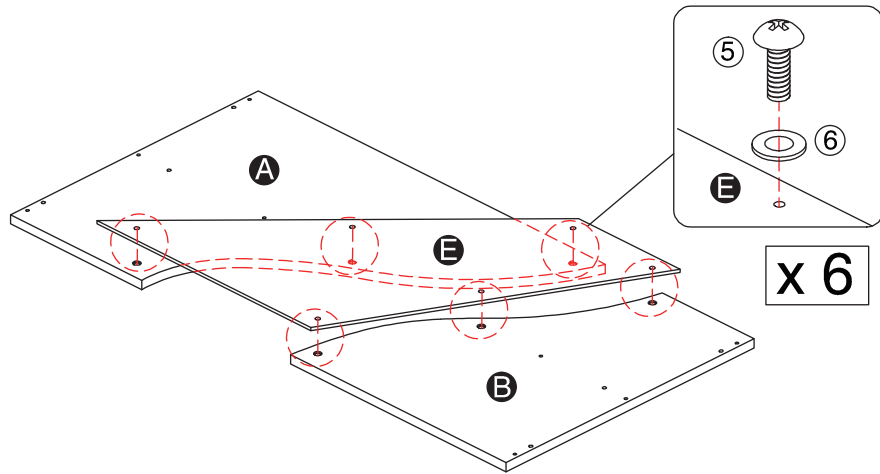



# ASSEMBLY INSTRUCTIONS

## 2

Part **C** x2PCS

Hardware **2** x 6PCS

Accessory **A1** x 4PCS

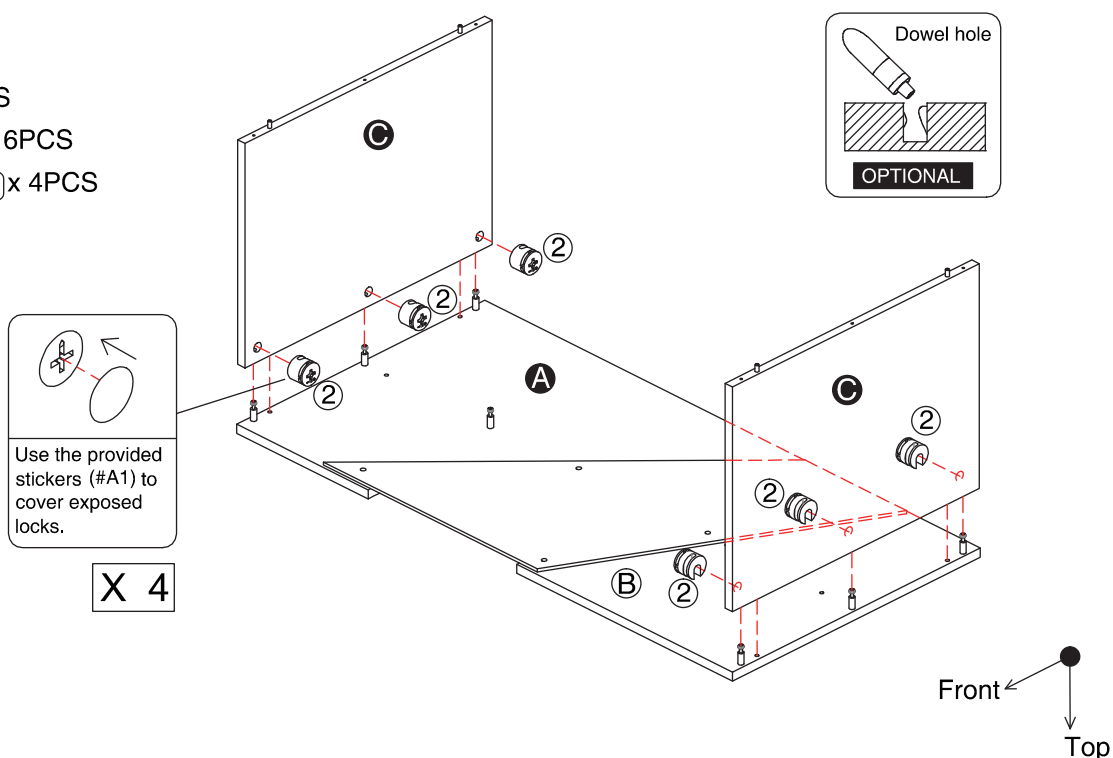

## 3

Part **F** x1PC

Part **G** x1PC

Hardware **2** x 2PCS

Accessory **A1** x 2PCS

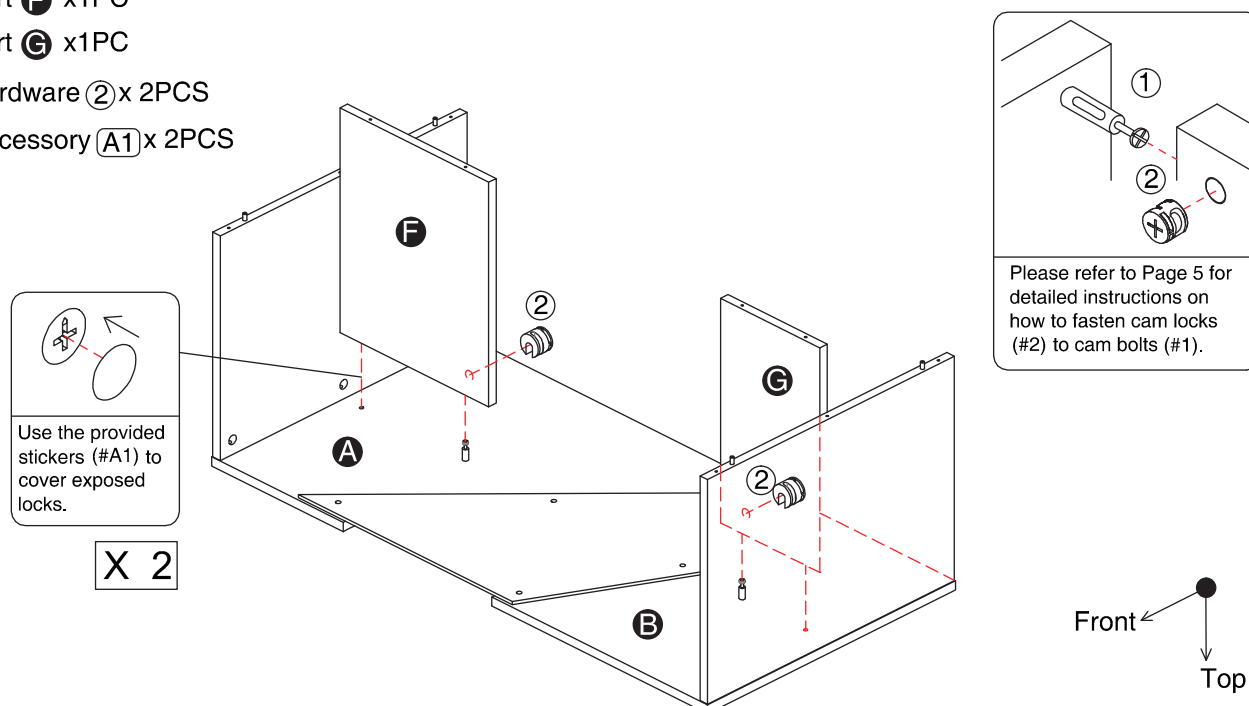

# ASSEMBLY INSTRUCTIONS

## 4

Accessory **A3** x 1PC

Accessory **A4** x 1PC

Accessory **A6** x 3PCS

Accessory **A7** x 6PCS

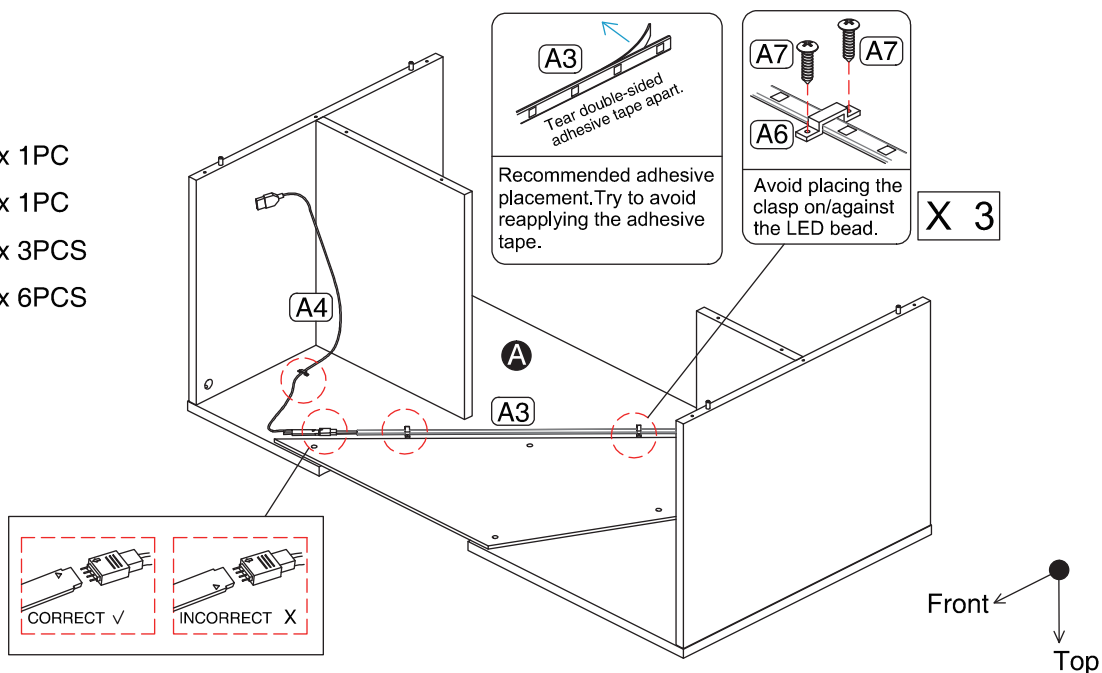

## 5

Part **D** x1PC

Hardware **④** x 10PCS

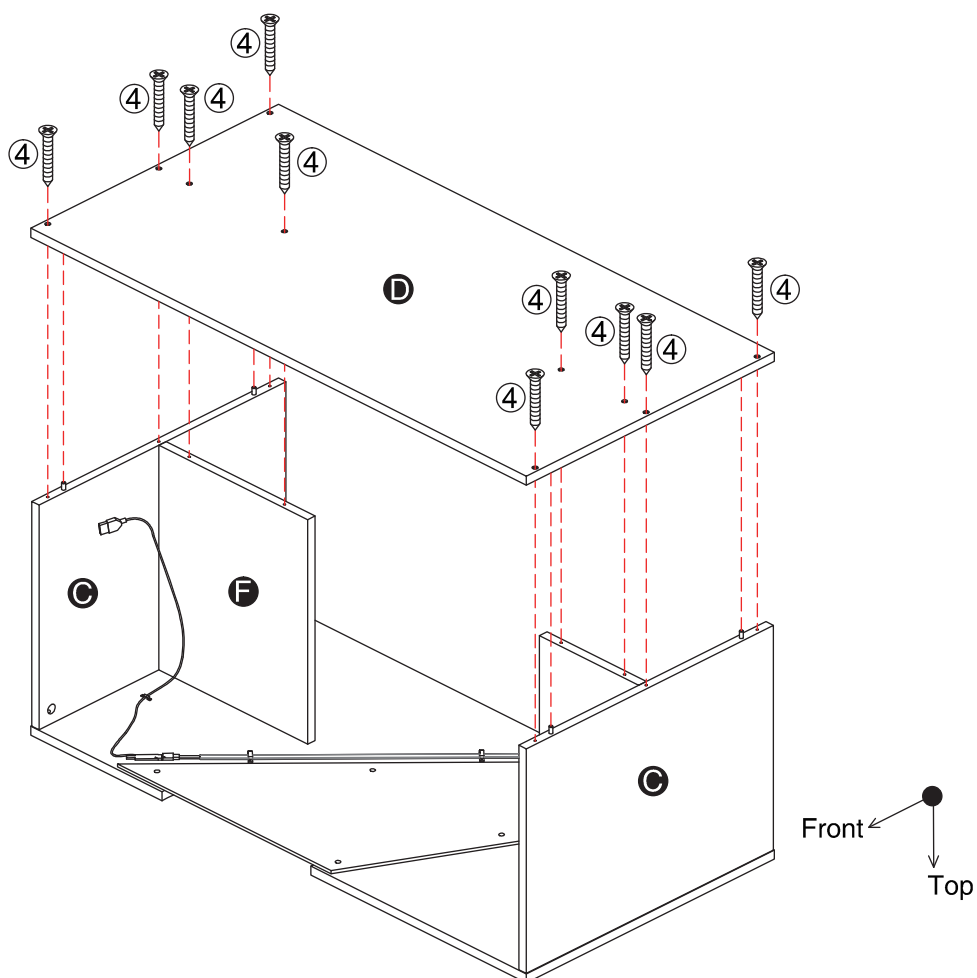

# ASSEMBLY INSTRUCTIONS

## 6

### ASSEMBLY COMPLETED



Please ensure the furniture rests on an even and flat surface. If the product wobbles or feels loose, double-check all bolts and/or screws are properly tightened and secured.



#### Keep this handy!

Please retain this instruction manual and any order-related information for future reference.



#### Lift, don't drag!

To avoid damage to product please always LIFT the product when transporting or adjusting the placement.

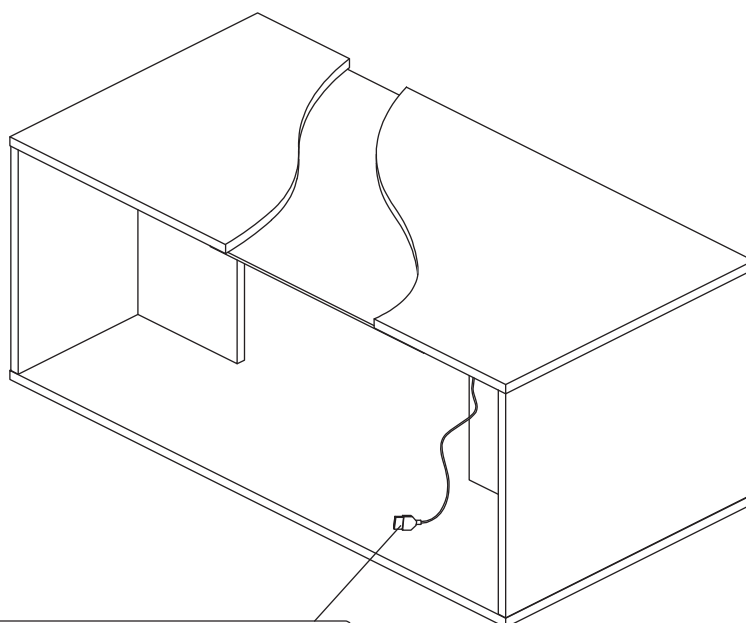

Compatible with portable charger  
(not included with this product)

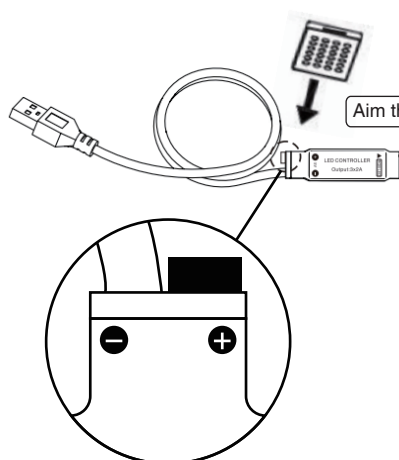

Aim the remote control at the Led controller

