

100 SERIES (SW5K) OWNER MANUAL

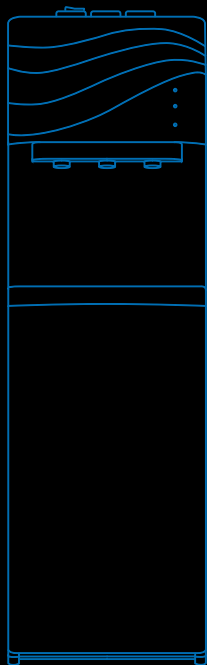

*Please read this manual carefully prior to operating
your Drinkpod. Retain for future reference.*



SAFETY CAUTION & USAGE

Troubleshooting

Should your appliance ever fail, please disconnect the power and water immediately before calling for assistance.

Maintenance

To avoid leakage and damage, never remove appliance parts.

Child Supervision

Unsupervised children should not be allowed to operate the machine.

Temperature

Please use the product in a dry place within the temperature ranges of 40 °F and 100 °F.

Electrocution Prevention

Ensure the power cord is always unplugged before performing any maintenance, troubleshooting, or filter upgrades.

Accessories & Filters

Only use Drinkpod accessories and filters to avoid causing damage and voiding product warranty.

Service & Support

For all service and support related issues, please immediately contact Drinkpod via any of the methods provided in the support letter, included with your product.

Professional Repairs

Any and all repairs should only be attempted by qualified persons designated by Drinkpod.

Avoid Direct Sunlight

Do not install the machine in a location exposed to direct sunlight.

Prevent Freezing

Never store or expose your Drinkpod in an environment less than 32 °F.

- This appliance is not intended for use by persons with reduced physical, sensory, or mental capabilities, or lack of experience and knowledge, unless they have been given supervision or instruction concerning use of the appliance by a person responsible for their safety. Children should be supervised to ensure they do not play with the appliance.
- If the supply cord is damaged, it must be replaced by the manufacturer, one of its designated service agents, or similarly qualified person, in order to avoid all hazards.
- Do not store explosive substances such as aerosol cans, or other items with a flammable propellant, in this appliance.
- This appliance is intended to be used in household and similar applications, kitchens, offices, and similar non-retail applications.
- The appliance should only be plugged into a grounded three prong socket. A surge protector is recommended.
- The appliance should never be turned upside down, or tilted more than 45°.
- The appliance should never be cleaned utilizing a compressed water stream.
- **WARNING:** To avoid any hazards due to instability of the appliance, it must be installed, maintained, and repaired, in accordance with this manual.

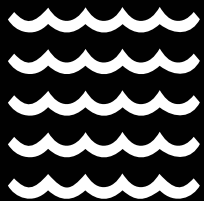

TABLE OF CONTENTS

1 Safety, Caution, & Usage

3 What's Included

5 Features & Specifications



6 Water Filtration System

7 Setup & Getting Started

17 Removing/Replacing Filters

20 Flushing Filters

21 Indicator Lights

22 Filter Cycles

23 Maintenance Notes

WHAT'S INCLUDED

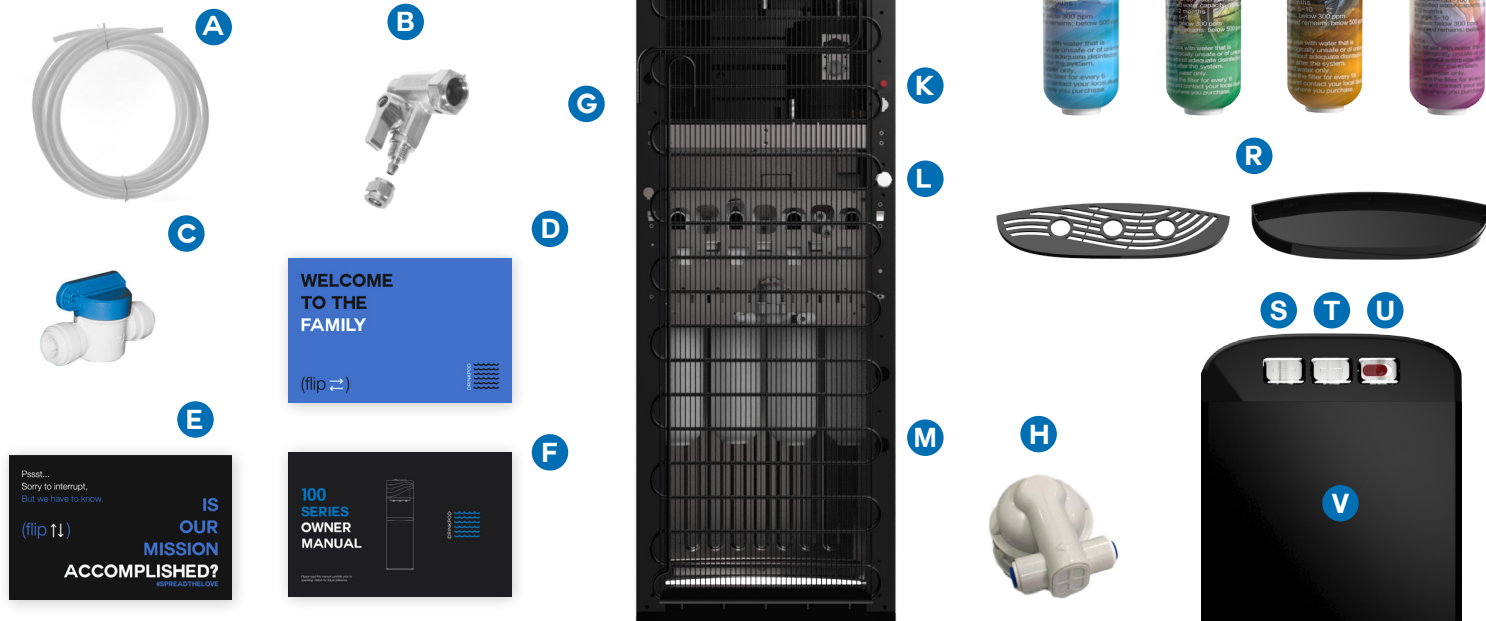

- A** 25' Industrial Grade PVC Tubing
- B** 3/4" x 3/4" x 1/4" Brass Quick Joint
- C** 1/4" PVC Shutoff Valve
- D** Service & Support Letter
- E** Feedback Request Letter
- F** Owner Manual
- G** 100 Series Drinkpod (SW5K)
- H** Flush Connector
- I** Cooling Mode Switch
- J** Heating Mode Switch
- K** Power Cable (Not Shown)
- L** Hot Water Outlet (Drain)
- M** Water Inlet (Source)
- N** Sediment Filter (1st Stage)
- O** Pre-Carbon Filter (2nd Stage)
- P** UF Membrane (3rd Stage)
- Q** Post Carbon Block (4th Stage)



- R** Drip Tray & Container
- S** Cold Water Dispenser Button
- T** Ambient Water Dispenser Button
- U** Hot Water Dispenser Button (w/Safety)
- V** Top Cover
- W** Status Indicator Lights
- X** Water Dispensers
- Y** Filter Access Door

Note: Please use the product in an environment with a temperature between 40 °F and 100 °F, and relative humidity that is less than 90%.

Notice: To enhance product performance, product parts may be changed by manufacturer without notice.

FEATURES & SPECS

Deliciously Pure & Healthy Water

Four stage, high precision filtration and purification to ensure incredible water quality.

Crisp & Refreshing Cold Temperature

Equipped with stable, high efficiency, low noise compressor.

Child Safe Intelligent Design

Out of reach controls & intuitive safety lock integrated into dispenser button.

Quadruple Redundant Overheat Protection

Filtered water is provided to hot tank through priority, water level control system. Utilizes redundant thermostats to identify and balance water level/temperature automatically.

EZ Twist Filter System

Dramatically increases speed and ease of replacing filter pods, using advanced seal technology to ensure zero water leakage.

Moisture Notification & Shutoff

All indicators on front panel will simultaneously blink when moisture buildup is detected on baseplate.

| | |
|--|--|
| Model | SW5K |
| Rated Power | 520 Watts |
| Heating Power | 420 Watts |
| Refrigeration Power | 90 Watts |
| Water Production Power | 10 Watts |
| Rated Pure Water Flow | 0.32 gal/min [43.5 psi] (1.2 L/min [0.3 MPa]) |
| Hot Water Production & Storage | Rate: 1.01 gal/hr (4 L/h) $\geq 185^{\circ}\text{F}$ (85°C) Storage: 0.26 gal (1 liter) |
| Cold Water Production & Storage | Rate: 0.53 gal/hr (2 L/h) $\leq 50^{\circ}\text{F}$ ($\leq 10^{\circ}\text{C}$) Storage: 0.8 gal (3 liters) |
| Environmental Requirements | Temperature: 40°F - 100°F (4.44°C - 37.78°C) Humidity: $\leq 90\%$ |
| Water Pressure Requirements | 14.5 psi - 58psi (0.1 MPa - 0.4 MPa) |
| Filter Stage #1 | Sediment Filtration Pod |
| Filter Stage #2 | Pre-Carbon Filtration Pod |
| Filter Stage #3 | Ultra Filtration (UF) Membrane Pod |
| Filter Stage #4 | Post Carbon Block (PCB) Pod |
| Water Source Quality | Tap Water |
| Appliance Size ($W \times D \times H$) | 12.25 inches (310 mm) x 14.17 inches (360 mm) x 40.94 inches (1040 mm) |
| Packaging Size ($W \times D \times H$) | 17.32 inches (440 mm) x 16.14 inches (410 mm) x 50.59 inches (1285 mm) |
| Net Weight | 39.9 lbs (18.1 kg) |
| Gross Weight | 51.43 lbs (23.33 kg) |

WATER FILTER SYSTEM

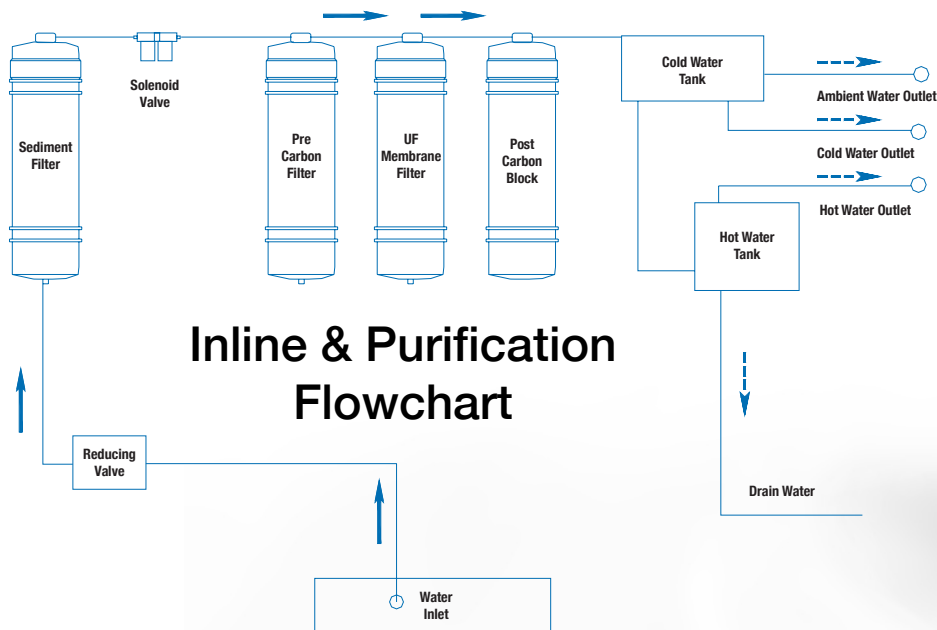



SETUP & GETTING STARTED



What You'll Need:

- **1x Nearby Waterline**
Optimally a kitchen sink.
- **1x Pair Of Pliers**
- **1x Drill & Drill Bit**
If you'll need/want to create a more direct route for your Drinkpod's water source line).
- **1x Sick Beat (song)***
Recommended for jamming along with, to ensure best installation experience.

** Country music should be avoided if possible, and only utilized with extremem caution.*



Step 2

Unpack product.
Remove accessories &
papers and set aside.
Remove Drinkpod, and
place on ground.

R

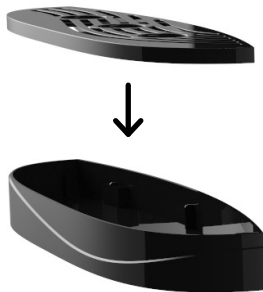

Step 3

Insert **R** drip tray & collector into the slot underneath the dispensers.



Read Before Proceeding

Unlike most of our competitors, we've upgraded our installation kit to include a premium **B** Brass Tee Union Adapter, rather than the traditional self-piercing saddle joint.

If, for any reason, you are unable to complete the installation using **B,**

we recommend contacting us or a plumber prior to trying a self-piercing saddle valve.

Step 4

Gather pliers, **A** 25' PVC tubing, **B** brass tee union adapter, and drill + drill bit (if hole is required and unavailable to connect watersource to Drinkpod).

Step 5

Identify cold water line source.



Step 6

Twist cold water source valve clock-wise to turn off.



Step 7

Unscrew (counter-clockwise) kitchen sink faucet hose from cold water shutoff valve.

Use pliers carefully if required to loosen tight connection.



Step 8

Screw **B** brass quick joint (clockwise) down onto cold water shutoff valve. Do not tighten with pliers more than 1/4 turn.

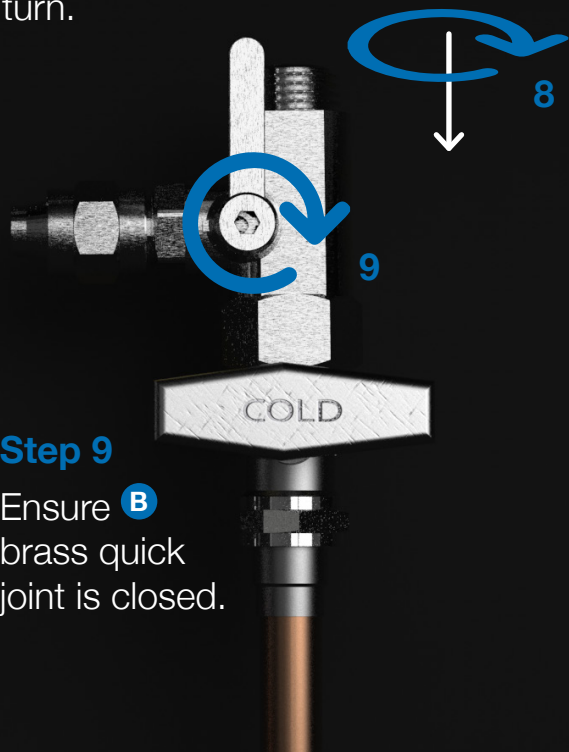

Step 9

Ensure **B** brass quick joint is closed.

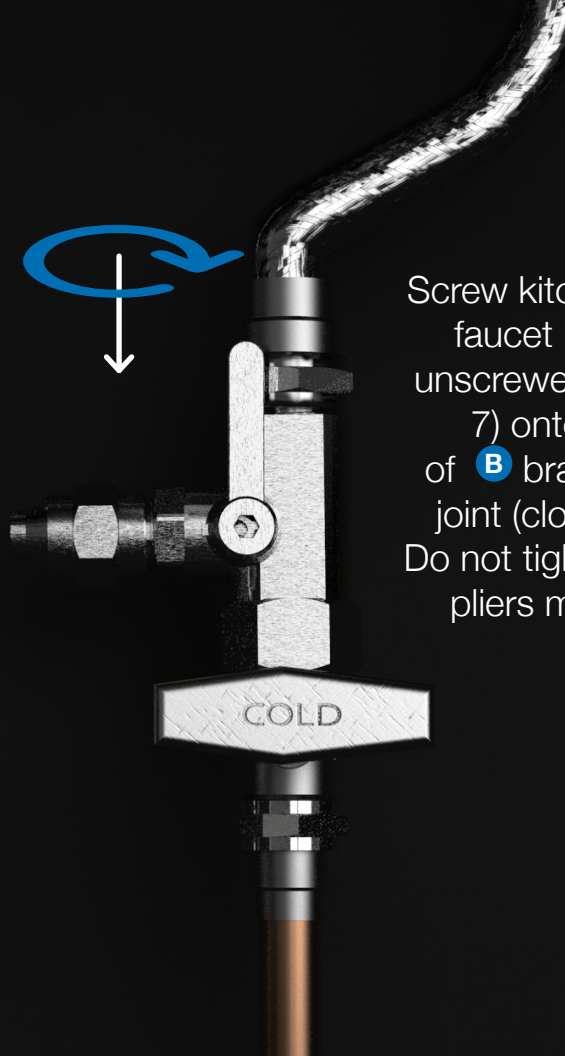

Step 10

Screw kitchen sink faucet hose (we unscrewed in step 7) onto the top of **B** brass quick joint (clockwise). Do not tighten with pliers more than 1/4 turn.

Step 11

Unscrew compression nut from **B** quick connect adapter.



Step 12

Thread **A** 25' x 1/4" PVC tubing through **B** quick connect adapter's compression nut.

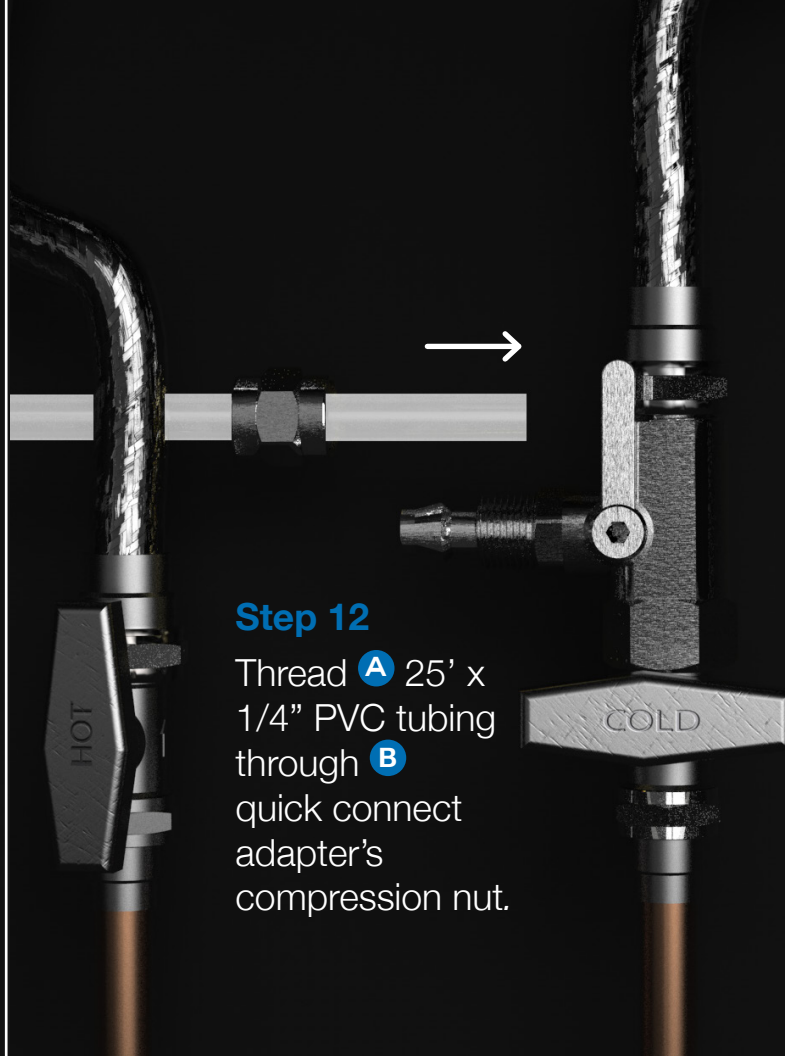

Step 13

Firmly slide **A** 25' x 1/4" PVC tubing over **B** quick connect adapter up to (but not overlapping) the threads.



Step 14

Firmly screw the compression nut back on to **B** quick connect adapter.

Do not tighten with pliers more than 1/2 turn.



Before You Continue

In our next steps, we will connect and setup your new Drinkpod. Before proceeding, please ensure that **A** 25' x 1/4" PVC can reach from your water source to the Drinkpod.

Should this require drilling holes along the path, please proceed with caution, and at your own risk. If you do not feel qualified, please contact a professional plumber, or give us a call, so that we may recommend an installation technician.



Step 15

Ensure Drinkpod is located where you plan to use it, and that **A** 25' x 1/4" PVC tubing has been laid so that it reaches **M** Water Inlet with at least several feet of slack.

Make sure Drinkpod is turned off and unplugged from electrical outlet.

Step 17

Connect one end of new tubing section, into one end of **C** 1/4" Shutoff Valve, and free end of **A** 25' x 1/4" PVC tubing, into the other end. Firmly push the tubing into the push-fitting until you cannot push it any further. Some resistance is normal.

Step 16

Use scissors or knife to cut approximately 1' section off the end of **A** 25' x 1/4" PVC tubing at a 90° angle.

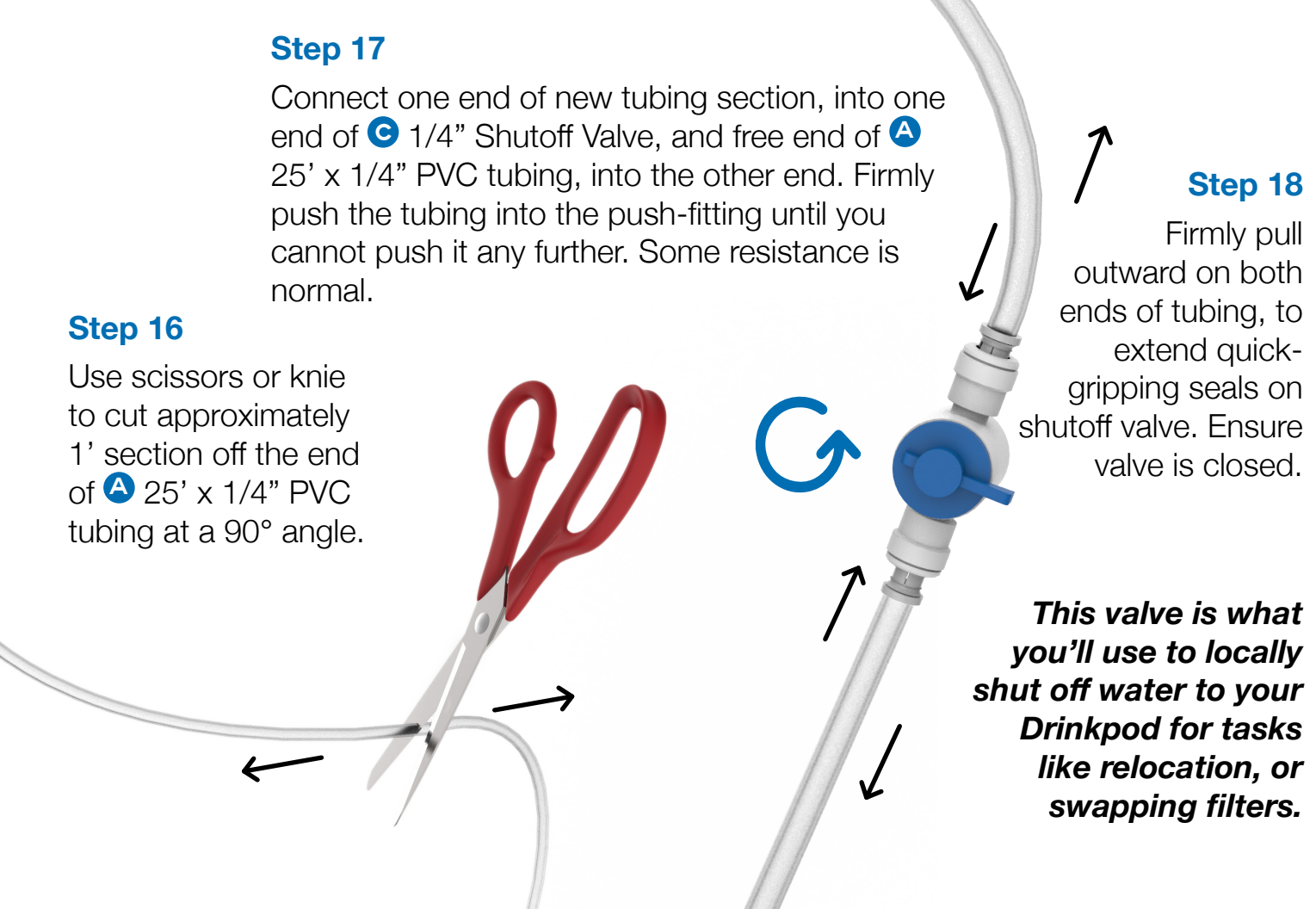

Step 18

Firmly pull outward on both ends of tubing, to extend quick-gripping seals on shutoff valve. Ensure valve is closed.

This valve is what you'll use to locally shut off water to your Drinkpod for tasks like relocation, or swapping filters.

Removing & Replacing Filters

Step 19

Firmly push the open end of new short tubing into **M** Cold Water Inlet, on the back of your Drinkpod until you cannot push it any further.

Step 20

Firmly pull outward on new short tubing section to engage quick-gripping seals.

Step 21
Open **Y** Drinkpod Cabinet Door to ensure Filters **N**, **O**, **P**, and **Q** are properly mounted.

STOP!!!

Before proceeding, immediately check for any leaks at the adapter site, pvc shutoff, water inlet, 4 individual filters, and hot drain cap for leaks.

#1 Sediment

#2 Pre-Carbon

#3 UF Membrane

#4 Post-Carbon



Step 22

To Remove:

1. Pull back filter pod.
2. Twist counter clockwise.
3. Gently pull filter out/down.

Step 23

To Replace:

1. Gently insert filter upwards.
2. Twist clockwise.
3. Gently push filter back in/up.

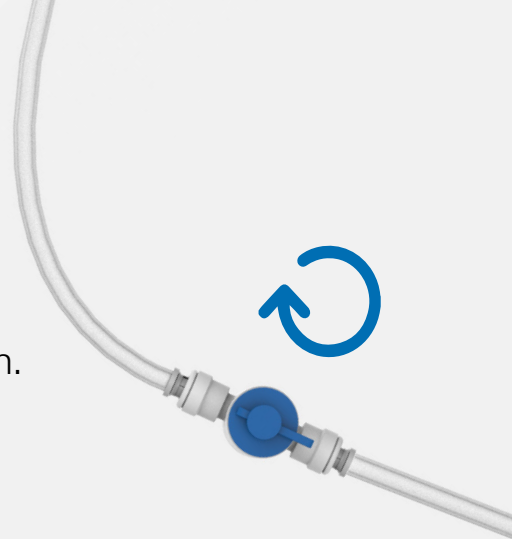

Step 24

Open  1/4" Shutoff Valve by twisting clockwise.

Step 25

Open **B** quick connect adapter.



Step 26

Open cold water source line.

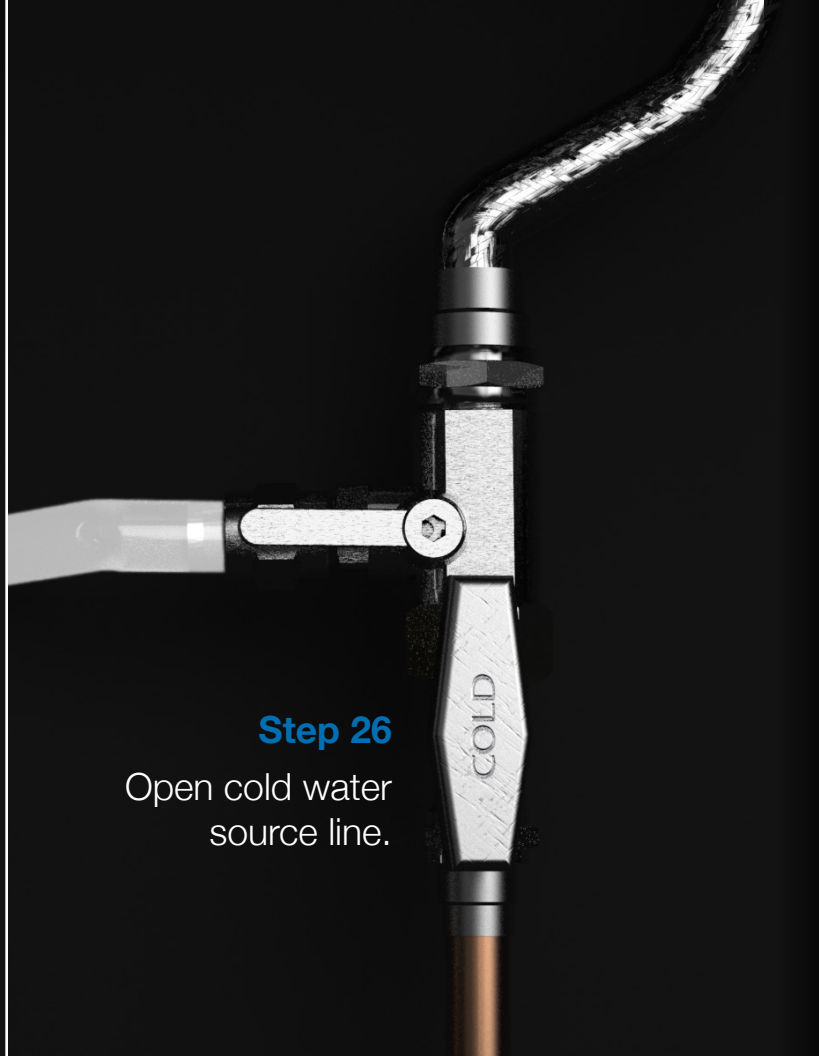

A black power cord is shown being plugged into a white wall outlet. The cord is on the left, and the outlet is on the right. The background is a light gray wall.

Step 27

Plug in.
Outlet should
always be
grounded.

**Always Flush New Pre & Post
Carbon Filters Prior To Use**

Step 28

You must flush the pre-carbon and post carbon filters until they discharge clean water, to ensure any loose particulates are removed prior to using. This will take about 10 minutes.

See page **25** for alternative method to extend filter life.



INDICATOR LIGHTS LEGEND

ON = Cooling Water

OFF = Not Cooling



ON = Heating Water

OFF = Not Heating



ON = No Water

OFF = Sufficient Water



FILTER CYCLES

Filters can be ordered from our website at drinkpodusa.com, Amazon, Ebay, and other online retailers.

The times below are for reference only. Data is based on 2.5 Gallons / 10 Liters usage per day. The actual lifespan of filters varies based on local water quality, and usage.



6
MONTHS



12
MONTHS



12
TO
18
MONTHS



12
MONTHS

ADDITIONAL MAINTENANCE NOTES

- Rear of appliance should be at least 9" / 12 cm away from the wall it backs up to.
- Never put appliance on paper or foam, which could retain water, and lead to creepage.
- Never use appliance outdoors, or somewhere it could be splashed by water.
- Never place anything flammable next to the machine.
- Remember to shut down heating and cooling mods, if appliance will go extended time without use.
- For long term storage: switch off, unplug power, shutoff and disconnect water, drain all water from dispensers, and finally from **L** hot water drain valve. Replace when finished.
- Following long term storage, repeat filter flushing procedure on page **20**.
- Should appliance ever become blocked from freezing, shut off cooling mode for 4 hours before trying to use machine.

- Never use chemical solvents like gasoline to clean appliance. Only clean with tap water and soft cloth.
- Never pull the power plug from wall socket prior to turning off machine's power switch.
- Never modify power cord.
- If power cord ever becomes damaged, cord should only be replaced by qualified technician.
- The tap water is the intended water source for this appliance.
- Never dismantle or modify any parts of the machine other than those indicated in this manual.
- Never turn appliance upside down, or lean more than 45 degrees.
- Every Drinkpod comes with a limited 12 month warranty from the date of purchase.

ENJOY

Alternative Flushing Method

To extend your filters lifespan, you can follow the steps below as an alternative flushing method. This method is specifically for the pre-carbon and post carbon filters. When using this method, filters should be flushed with **H** for an additional 10 minutes after they discharge clean water, to ensure any loose particulates are removed prior to using.

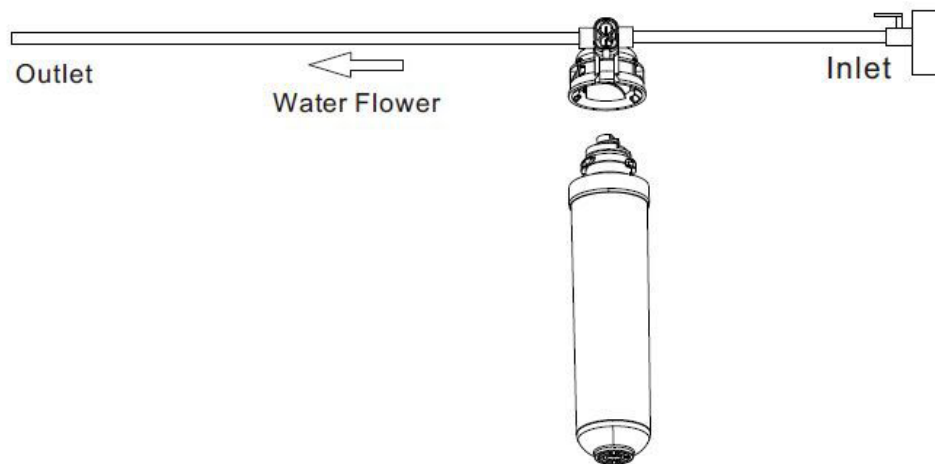

Copyright © Drinkpod, LLC. All rights reserved. The Drinkpod brand and logo are trademarks of Drinkpod,

