

**IQAir**

**Atem<sup>®</sup>**

Personal Air Purifier

User Guide

Benutzerhandbuch

Mode d'emploi

Guía del usuario

用戶指南

用戶指南

ユーザーガイド

사용자 설명서는

Руководство пользователя

دليل المستخدم



## Product Components

- 1 Atem® air purifier
- 2 PureJet™ diffuser
- 3 Back cover
- 4 Stand head
- 5 Stand base
- 6 HyperHEPA® filter
- 7 Silencer
- 8 Power adapter and plugs
- 9 Connector cover

## Produkt-komponenten

- 1 Luftreiniger Atem®
- 2 PureJet™ Diffusor
- 3 Abdeckung
- 4 Standfuß-Arm
- 5 Standfuß-Basis
- 6 HyperHEPA® Filter
- 7 Schalldämpfer
- 8 Netzteil und Stecker
- 9 Steckerhalter

## Composants du produit

- 1 Purificateur d'air Atem®
- 2 PureJet™ diffuseur
- 3 Plaque arrière
- 4 Tête du support
- 5 Base du support
- 6 HyperHEPA® filtre
- 7 Silencieux
- 8 Adaptateur électrique et fiches
- 9 Couvercle du connecteur

## Componentes del producto

- 1 Purificador de aire Atem®
- 2 PureJet™ difusor
- 3 Cubierta posterior
- 4 Cabezal del soporte
- 5 Base del soporte
- 6 HyperHEPA® Filtro
- 7 Silenciador
- 8 Adaptador y tomas de corriente
- 9 Cubierta del conector

## 产品组件

- 1 Atem®空气净化器
- 2 PureJet™扩散器
- 3 背板盖
- 4 支架头
- 5 支架座
- 6 HyperHEPA®滤芯
- 7 消音器
- 8 电源适配器和插头
- 9 连接器盖

## 產品組件

- 1 Atem®空氣淨化器
- 2 PureJet™擴散器
- 3 背板蓋
- 4 支架頭
- 5 支架座
- 6 HyperHEPA®濾芯
- 7 消音器
- 8 電源適配器和插頭
- 9 連接器蓋

## 製品の構成部品

- 1 Atem® 空気清浄機
- 2 PureJet™ ディフューザー
- 3 バックカバー
- 4 スタンドヘッド
- 5 スタンドベース
- 6 HyperHEPA® フィルタ
- 7 消音機
- 8 電源アダプタとプラグ
- 9 コネクタカバー

## 생성물구성 요소

- 1 Atem® 공기 청정기
- 2 PureJet™ 디퓨저
- 3 백 커버
- 4 스탠드 헤드
- 5 스탠드 베이스
- 6 HyperHEPA® 필터
- 7 소음기
- 8 전원 어댑터 및 플러그
- 9 커넥터 커버

## Компоненты изделия

- 1 Очиститель воздуха Atem®
- 2 Распылитель PureJet™
- 3 Задняя крышка
- 4 Верхняя часть подставки
- 5 Основание подставки
- 6 HyperHEPA® Фильтр
- 7 Глушитель шума
- 8 Сетевой адаптер и разъемы
- 9 Крышка соединителя

## مكونات الجهاز

- 1 منقي الهواء Atem®
- 2 موزع الهواء PureJet™
- 3 أغطية خلفية
- 4 رأس الحامل
- 5 قاعدة الحامل
- 6 مرشح HyperHEPA®
- 7 كاتم الصوت
- 8 محول التيار والمقابس
- 9 غطاء الموصل



Congratulations on your purchase of the IQAir Atem® personal air purifier. Please study this User Guide carefully to familiarize yourself with the special features and functions of this IQAir® product. Retain this document in a safe place for future reference.

Herzlichen Glückwunsch zum Kauf Ihres persönlichen Luftreinigers IQAir Atem®. Bitte lesen Sie diese Bedienungsanleitung sorgfältig durch, um sich mit den Besonderheiten und Funktionen dieses IQAir®-Produkts vertraut zu machen. Bewahren Sie diese Anleitung zum späteren Nachlesen an einem sicheren Ort auf.

恭喜您購買了此IQAir Atem®高性能空氣淨化系統。請仔細閱讀本用戶手冊，以熟悉IQAir®系統的特性和功能，並將其保存在安全的地方以備將來參考。

恭喜您购买了此IQAir Atem®高性能空气净化系统。请仔细阅读本用户手册，以熟悉IQAir®系统的特性和功能，并将其保存在安全的地方以备将来参考。

IQAir Atem® 개인용 공기 청정기를 구입하신 것을 축하드립니다. 본 사용자 설명서를 주의 깊게 읽고 본 IQAir® 제품의 특징과 특수 기능을 숙지하십시오. 나중에 참조할 수 있도록 본 문서를 안전한 장소에 보관하십시오.

English .....1-11

EN

Deutsch .....12-22

DE

Français .....23-33

FR

Español .....34-44

ES

简体中文 .....45-53

CN  
SP

繁體中文 .....54-62

CN  
TR

日本 .....63-72

JP

한국어 .....73-81

KO

Русский .....82-91

RU

العربية .....92-100

AR

## Important Safety Warnings

### Before you start

The IQAir Atem® personal air purifier is ideal for use anywhere you wish to create your own personal clean air zone.

The Atem should only be used in conjunction with the dedicated stand, power accessories, and/or hardware delivered in the package. Misuse can lead to injury, malfunction and/or damage.

**Read these instructions for use carefully before using the product and save them for future reference.**

- As with all electronic devices, please keep out of the reach of children under the age of 8. This device is not a toy!



- This product can be used by children aged from 8 years and above and persons with reduced physical, sensory or reasoning capabilities, or lack of experience and knowledge, only if they have been given

supervision or instruction by a responsible person concerning use of the appliance in a safe way and understand the hazards involved. Cleaning and user maintenance should not be performed by children without supervision.

**To reduce risk of fire, electric shock, or injury please read these warnings before using this product.**

- To avoid risk of electric shock or fire, only plug the product into suitable, easily accessible, mains power connections. Use only the IQAir provided power accessories.
- Use the power accessories only indoors and in dry environments.
- Do not use damaged power adaptor, cables or plugs. If damaged they must be disposed of and replaced with original IQAir Atem power accessories only.



- Do not allow any kind of liquid to spill on, or come into contact with the product. Including, but not limited to water, detergents or flammable solvents.

- To clean the device:
  - Disconnect from the power supply

## Important Safety Warnings

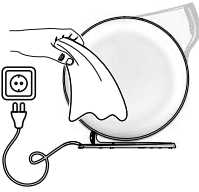

- Use a soft, dry cloth only
- Cables and plugs: Keep plugs clean and dry. Blow away any dirt lodged in the plugs of the connecting cables.

### Never immerse the product or any of its components in water or under running water.

- Never cover the unit nor otherwise impede the air intake and outflow in any way.
- Do not introduce a foreign object or finger into air flow openings.



- This product contains high-precision technology. **Do not drop,** tamper with nor expose to impact.



- Lift and carry the purifier using both hands to grasp firmly.

- Do not lift the assembled device by the stand.

- This product is intended for use in living and office environments. It helps to create a breathing zone with improved air quality.



- Only use this product in conjunction with its intended stand, as delivered in the original product packaging.

- Adverse use for this product would be in damp or wet environments such as bathrooms or kitchens.



- Use the purifier only in a dry environment.

- Do not use in an open window.

- Adverse use can lead to injury, malfunction and damage.

- Limits of use: Only use this product in an atmosphere appropriate for permanent human habitation. Not suitable for use in toxic or explosive environments, or for protection against hazardous airborne substances.

## **Electromagnetic Compatibility (EMC)**

- The term Electromagnetic Compatibility is taken to mean the capability of the product to function smoothly in an environment where electromagnetic radiation and electrostatic discharges are present, and without causing electromagnetic disturbances to other equipment.
- Electromagnetic radiation can cause disturbances in other equipment. Although the product meets the strict regulations and standards which are in force in this respect, IQAir cannot completely exclude the possibility that other equipment may be disturbed.

## **Environment**

Help to preserve the environment. Do not discard the device with household waste. Bring it to the official waste recycling service near you. Filters may be disposed of with household waste.

## **Product Storage**

When not in use, store your Atem in a clean dry place. Use the original packaging for optimal storage.

---

## **For Korea:**

As an electromagnetic wave equipment for home use (Class B), this equipment is intended to use mainly for home use and may be used in all areas.

This radio equipment cannot provide a service relevant to the human safety, as it can be crossed.

## For USA: FCC Statement

This equipment has been tested and found to comply with the limits for a **Class B digital device**, pursuant to part 15 of the FCC rules. These limits are designed to provide reasonable protection against harmful interference in a residential installation.

This equipment generates, uses and can radiate frequency energy and, if not installed and used in accordance with the instructions, may cause harmful interference to radio communication.

However, there is no guarantee that interference will not occur in a particular installation. If this equipment does cause harmful interference to radio or television reception, which can be determined by turning the equipment off and on, the user is encouraged to try to correct the interference by one or more of the following measures:

- Reorient or relocate the receiving antenna.
- Increase the separation between the equipment and the receiver.
- Connect the equipment into an outlet on a circuit different from that to which the receiver is connected.

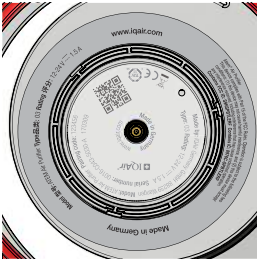

The location of compliance statements on the Atem air purifier is found under the back cover.

- Consult the dealer or an experienced radio/TV technician for help.
- Changes or modifications not expressly approved by the party responsible for compliance could void the user's authority to operate the equipment.

## For Canada:

This device complies with Industry Canada's licence-exempt RSSs. Operation is subject to the following two conditions:

- (1) This device may not cause interference; and
- (2) This device must accept any interference, including interference that may cause undesired operation of the device.



## Product Components and Assembly

### Product Components

See product illustration on the inside cover.

- 1 Atem® air purifier
- 2 PureJet™ diffuser
- 3 Back cover
- 4 Stand head
- 5 Stand base
- 6 HyperHEPA® filter
- 7 Silencer
- 8 Power adapter and plugs
- 9 Connector cover

### Assembly

After unboxing you will find the Atem personal air purifier (1) with the PureJet diffuser (2) attached.

#### Power adaptor and stand assembly

Remove and unpack the power adapter and plug box. Select the correct plug for your region and snap into place as shown.

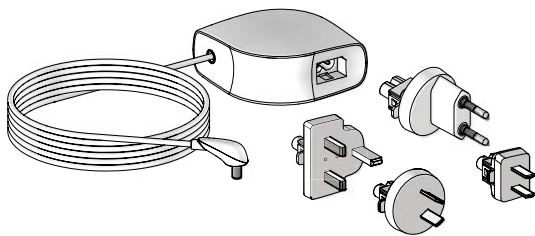

Select your region's plug

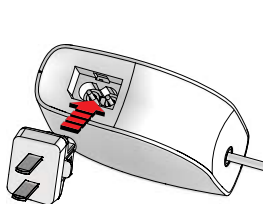

Snap into place

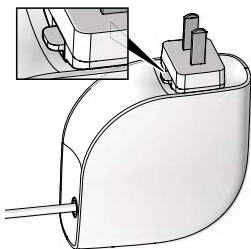

Assembled plug

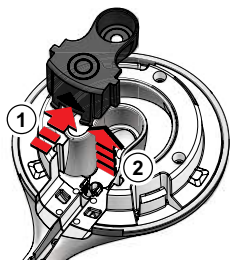

Remove the connector cover

Take the stand head (4) and remove the connector cover (black part) (9) and set aside.

Take the connector end of the power adapter cord (8) and snap into place. Replace the connector cover. Press the power cord into the channel on the stand head.

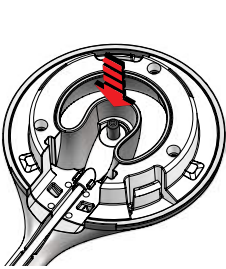

Snap in the power cord connector

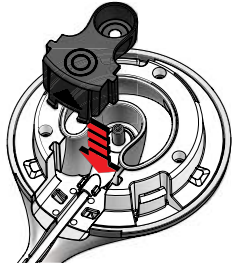

Replace the connector cover

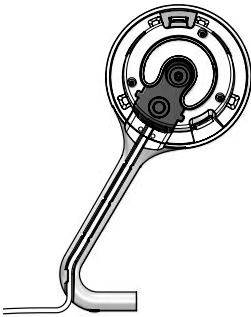

Press the cord into the stand channel

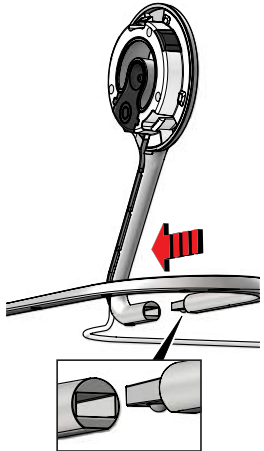

Connect the stand head to the stand base (5). Once assembled, set the stand upright.

Connect the stand head to the stand base

### Connecting the air purifier to the stand

Firmly grasp the air purifier and align with the stand head (4). Tilt and affix the air purifier onto the stand head. Snap the air purifier and stand together.

With your air purifier, diffuser and stand assembled, you are now ready to use your Atem personal air purifier.

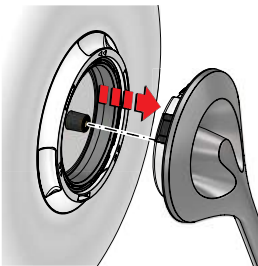

Align the stand head

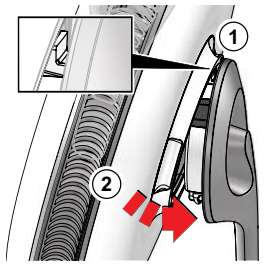

Angle and snap into place



Air purifier assembled and powered on

## Setting Up Your Personal Clean Air Zone

Place the Atem personal air purifier near you on a stable surface such as a desk or table. Point the PureJet diffuser toward your breathing zone.

For best results, place the Atem as close to you as possible.



## Using the Atem for the First Time

Upon initially connecting to the power supply, you will hear the Atem's power-on *chime* and see a red light.

### User interface & touch point settings

To change fan speed, use two fingers to touch the front center. With every touch, you will hear a *sound* and see the light change. The size of the light corresponds to the air speed.

Red light and *chime* = standby

Touch point

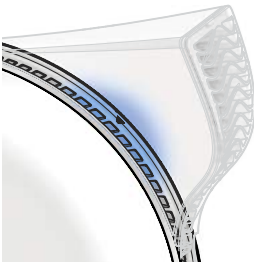

Small blue light and *sound* = low speed

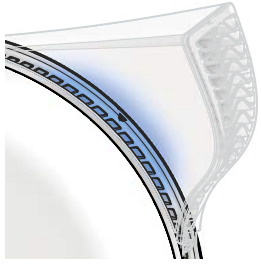

Medium blue light and *sound* = medium speed

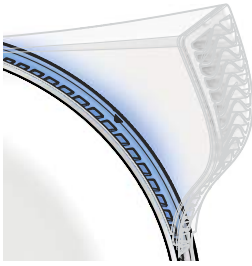

Full blue light and *sound* = high speed  
(Cooling Mode)

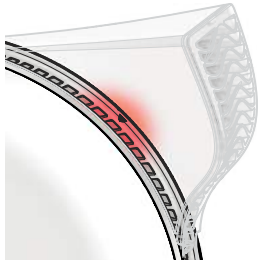

A double red flash with *sound* = change filter

## Filter Replacement

The Atem will indicate a necessary filter change with a double red flash accompanied by a sound.

### HyperHEPA filter

Follow steps 1-4 to change the filter in the Atem.

**Disconnect the Atem from the power source before changing the filter!**

**Step 1:** Remove the air purifier from the stand and place it face down on a cloth surface with the back facing up.

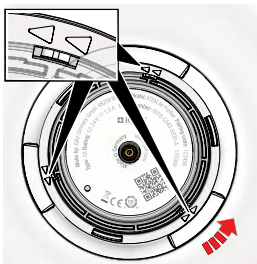

Opening direction

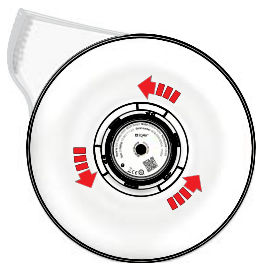

To unlock, turn the locking ring counter clockwise



Lift the back cover away

**Step 2:** On the back cover, note the direction indicators on the locking ring. Grasp the locking ring firmly and rotate in a counter-clockwise direction until the back cover (3) releases. You should be able to easily lift the back away.

EN

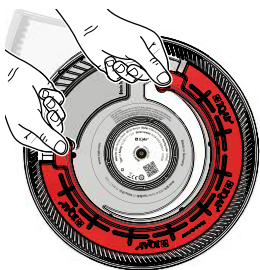

Lift tabs to remove filter

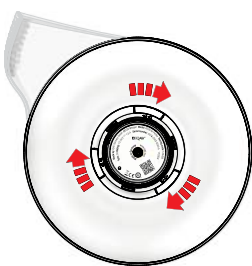

Turn clockwise to lock

**Step 3:** Remove the old filter by pulling on the tabs and then dispose of it. Replace with a new IQAir Atem HyperHEPA® filter (6) and firmly press into place.

**Step 4:** Put the back cover on and gently rotate until the lock pins align into place. Grasp firmly and press down on the locking ring and turn clockwise to lock. The back cover should now be closed securely. Attach the air purifier to the stand for use.

## PureJet Diffuser

To remove your PureJet diffuser, firmly grasp the air purifier and pull off the diffuser.



Removal of the diffuser

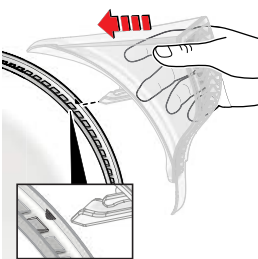

Align the large pins with the arrows

To attach your PureJet diffuser firmly grasp the air purifier and align the large pins on the diffuser with the arrows on the outlet vent. Note the outlet vent has larger openings.

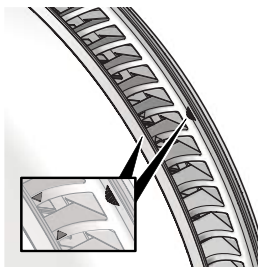

Locate outlet vent arrows

Once the diffuser pins are aligned with the vent arrows press firmly into place while holding the air purifier.

Should the PureJet diffuser grille become dislodged, align the hook at the bottom of the diffuser grille with the bottom of the diffuser body and snap firmly into place.

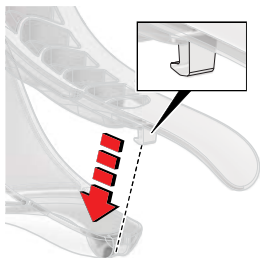

Connector hook

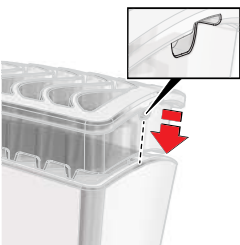

Diffuser grille snaps into place

## Cleaning the PureJet Diffuser

Completely remove the diffuser to facilitate safe cleaning.



## IQAir Atem App

To enhance your user experience and to unlock additional features of the IQAir Atem personal air purifier, download and

install the IQAir Atem App for Apple or Android. App features and benefits include:

**Smart on/off**

**Fan speed settings**

**Filter life notifications**

**Light and Sound settings**

With the App, you will be able to access all the features and custom setting available for your Atem. Please remember that the Bluetooth® mode must be activated beforehand on your smart phone. To install follow the set-up directions on the App.

## Bluetooth pairing

Pair your Smart Phone device with the Atem by using the IQAir Atem App. The Atem is automatically in discovery mode and will appear in the Bluetooth section of the App.

Tap the Atem name to pair. Enter the Bluetooth code PIN found on the back of this User Guide, the back of the air purifier and on the packaging label.

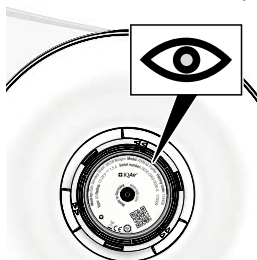

The location of product information & specifications is found on the back.

## Smart on/off

This feature in the App can be set to sense proximity of the user's smart phone device to the Atem. This enables a power-saving automatic on/off function if desired.

## Troubleshooting

Visit the Atem support section on the website.

## Accessories and Filters

A list of available filters and replacement parts for the Atem air purifier can also be found on the website at: [www.iqair.com](http://www.iqair.com)

## Technical specifications

### Model:

Atem Air Purifier

### Power Rating:

12-24V ~ 1.5A max

### Power Adaptor:

Model: IQS27-1801500

Input: 100-240V ~ 50/60Hz

Output: 18V ~ 1.5A

### Dimensions (Air Purifier on stand):

L x H x W 330 x 330 x 145 mm 13 x 13 x 5.8 in

### Weight (Air Purifier only):

1850g / 4.1lbs

RoHS



# Responsibilities, Warranty and Service Information

## Manufacturer of the Product

IQAir AG, herein referred to as IQAir, is responsible for supplying the product, including the User Manual and original accessories, in a completely safe condition. The manufacturers of non IQAir accessories for the product are responsible for developing, implementing and communicating safety concepts for their products, and are also responsible for the effectiveness of those safety concepts in combination with the IQAir product.

## International Limited Warranty and Service

The IQAir warranty will be honored, provided the product is handled in accordance with its intended use and operating instructions.

Tampering with the power adapter or the use of non-IQAir power accessories voids the warranty.

This product is subject to the terms and conditions set out in the International Limited Warranty which you can download from the IQAir home page at [www.iqair.com](http://www.iqair.com). The foregoing warranty is exclusive and is in lieu of all other warranties, terms or conditions, express or implied, either in fact or by operation of law, statutory or otherwise, including warranties, terms or conditions of merchantability, fitness for a particular purpose, satisfactory quality and non-infringement, all of which are expressly disclaimed.

For detailed instructions on how to claim your warranty for a defective device, please visit the IQAir website, contact a IQAir distributor or your closest IQAir representative.

If you need information on IQAir products or if you have a problem with your product, please visit the IQAir website at **[www.iqair.com](http://www.iqair.com)** or contact the retailer where you purchased the product for further assistance. ■

**Manufacturer:**

**IQAir Germany GmbH**

Karl-Maybach-Straße 18  
88239 Wangen im Allgäu  
Germany

**Distribution:**

**IQAir North America**

IQAir North America, Inc.  
14351 Firestone Blvd.  
La Mirada, CA 90638  
USA

**IQAir International**

Incen AG  
Hauptstrasse 104  
9422 Staad  
Switzerland

**IQAir China**

DRC Liangmaqiao Diplomatic  
Office Building, Suite 1305B  
No.19 Dongfang Dong Road  
Chaoyang District  
100600 Beijing  
Tel.: 400 108 5117