



**Hearthaven®**  
24" x 70" linen tower  
**K-33540-ASB**

**Features**

- Two full-extension 12-3/4" (325 mm) drawers with soft-close side-mount slides
- 18" (457 mm) cabinet interior with two shelves provides ample storage space
- Finish-matched cabinet interior
- Customize your storage with optional accessories such as floor liners, drawer organizers, and perfectly sized containers (sold separately)

**Material**

- Solid wood and moisture-resistant MDF
- Painted exterior

**Installation**

- Easy installation – no special tools required

**Required Products/Accessories**

K-33542 Cabinet knob



**Codes/Standards**



EPA TSCA Title VI/CARB P2

**KOHLER® One-Year Limited  
Warranty**

See website for detailed warranty information.

**Available Colors/Finishes**

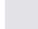
*Color tiles intended for reference only.*

Color	Code	Description
	0	White
	1WX	Slate Grey



**Hearthaven®**  
24" x 70" linen tower  
**K-33540-ASB**

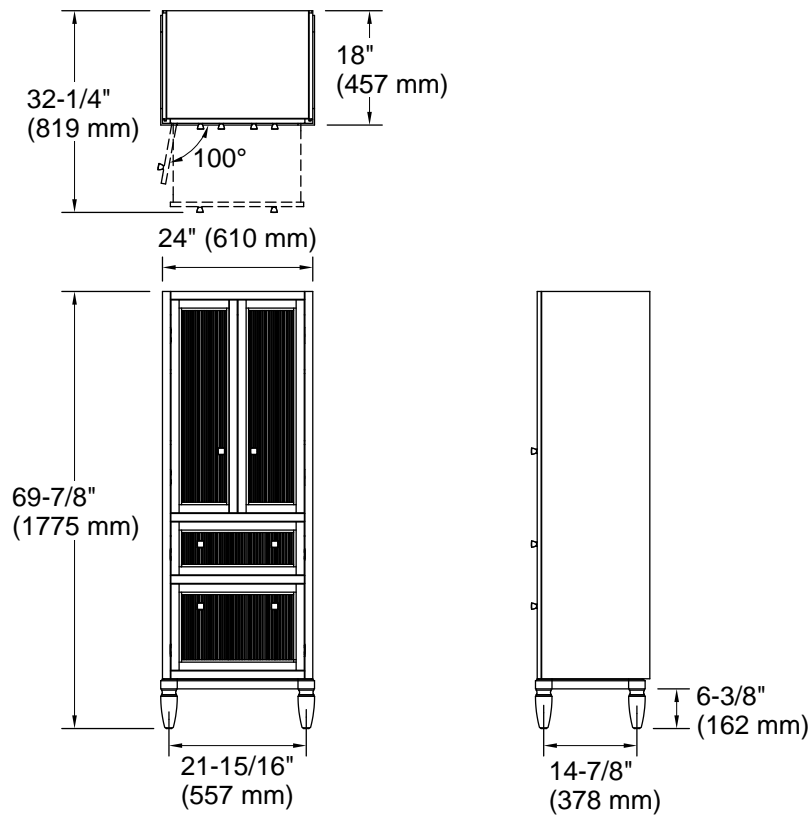

**Technical Information**

All product dimensions are nominal.