

READ INSTRUCTIONS CAREFULLY FOR SAFE INSTALLATION AND FAN OPERATION. IF UNCERTAIN, CONSULT A QUALIFIED ELECTRICIAN.

THANK YOU FOR YOUR PURCHASE

Thank you for purchasing a Carro Home product. To ensure correct function and safety, please read and follow all the instructions before using the product.

SAFETY GUIDELINES:

1. To avoid possible electric shock, turn off the electricity at the main fuse box or circuit panel before you begin the fan installation, servicing the fan or installing any accessories.
2. Read all instructions and safety guidelines carefully before installing your fan and follow all the instructions.
3. Make sure all electrical connections comply with the local codes or ordinances and the National Electrical Code. If you are unfamiliar with electric wiring, please consult a qualified and licensed electrician.
4. Make sure you have a location selected for your fan that allow clear space for the blades to rotate, and at least seven (7) feet of clearance between the floor and the fan blade tips. The fan should be mounted at least thirty (30) inches from walls and/or other upright structures.
5. **WARNING:** The outlet box and ceiling support joist used must be securely mounted, and capable of supporting at least 100 pounds. To reduce the risk of fire, electric shock or personal injury, mount to the outlet box marked acceptable for fan supported and use mounting screws provided with the outlet box. The box must be supported directly by the building structure.
6. **WARNING:** To reduce the risk of fire, electric shock or personal injury, mount to outlet box marked "acceptable for fan support" and use mounting screws provided with the outlet box. Most outlet boxes commonly used for the support of lighting fixtures are not acceptable for fan support and may need to be replaced. Consult a qualified electrician if in doubt.
7. Switches must be ETL, general use switches. Refer to the instruction packaged with the switches for proper assembly.
8. After installation is complete, check that all connections are firmly secured.
9. After making electrical connections, spliced conductors should be turned upward and pushed up carefully into outlet box. The wires should be placed apart with the grounded conductor and the equipment-grounding conductor on opposite side of the outlet box.
10. **WARNING:** To reduce the risk of electrical shock and fire, do not use this fan with any solid-state fan speed control device, or rheostat.
11. Do not separate the reverse switch until the fan has come to a complete stop.
12. Do not insert anything into the fan blades while they are rotating.
13. **WARNING:** To reduce the risk of personal injury, do not bend the blade brackets (also referred to as "flanges") during assembly or after installation. Do not insert objects in the path of the blades.
14. To avoid personal injury or damage to the fan and other items, be cautious when working around or cleaning the fan.
15. Do not use water or detergent when cleaning the fan or fan blades. A dry dust cloth or lightly dampened cloth will be suitable for most cleaning.

**NOTE:** The important safety precautions and instructions on the manual are not meant to cover all possible conditions and situations that may occur. It is understood that common sense and caution are necessary factors during the installation and operation of the fan.

**NOTE:** This product is not intended for use by persons (including children) with reduced physical, sensory or mental capabilities that are different or impaired, or lack of experience and/or knowledge, unless such persons are supervised and/or trained to operate the appliance by a person responsible for their safety.

**NOTE:** Children should be supervised to ensure that they do not use appliances as a toy.

**NOTE:** You must install a switch or circuit breaker that disconnects all power poles of at least 3 mm between each pole.

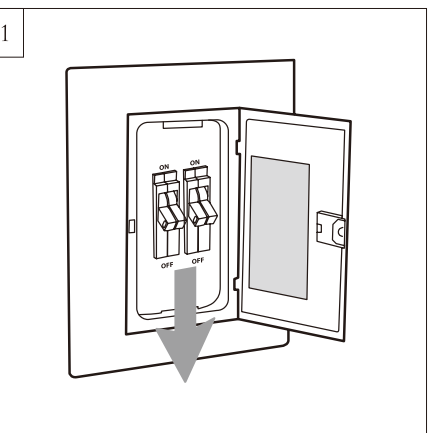
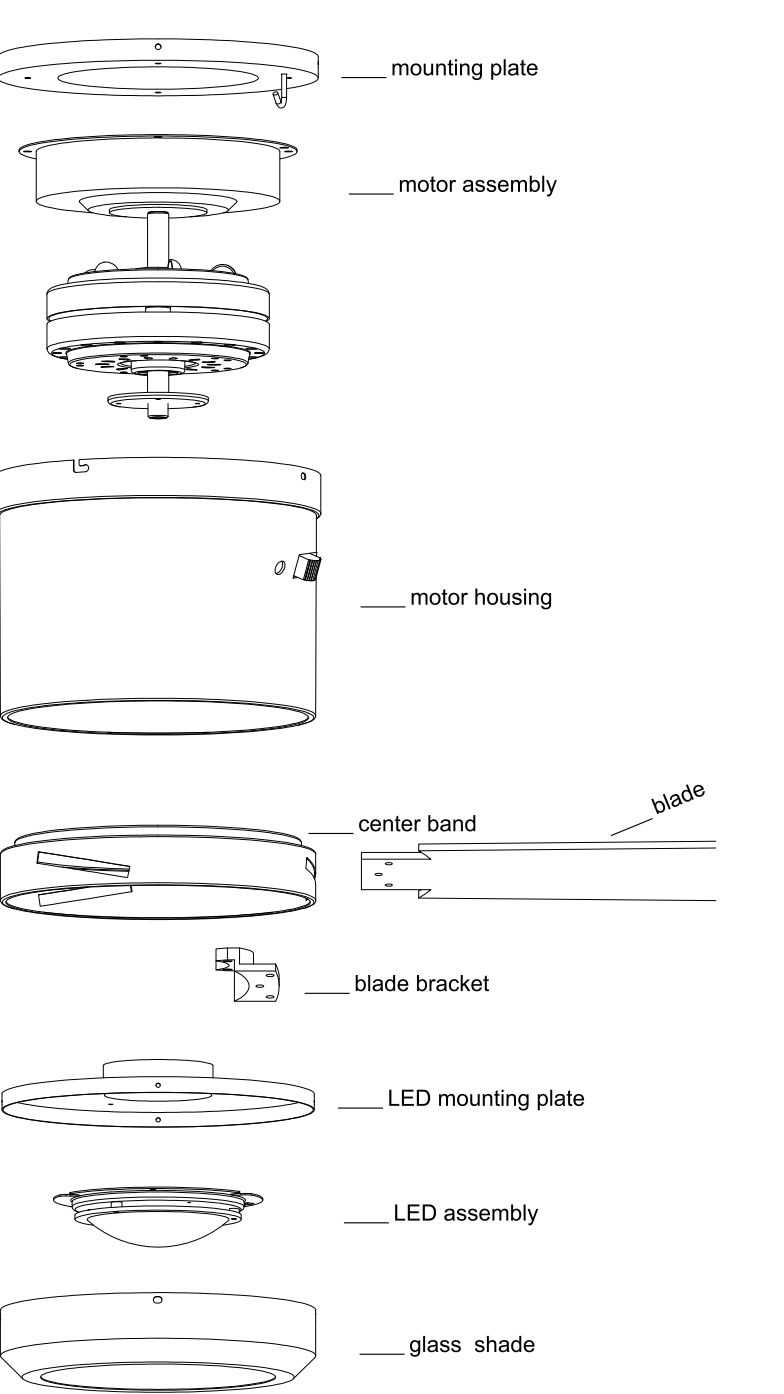

Before you begin installing the fan, Switch power off at Service panel and lock service disconnecting means to prevent power from being switched on accidentally. When the service disconnecting means cannot be locked, securely fasten a warning device, such as a tag, to the service panel.

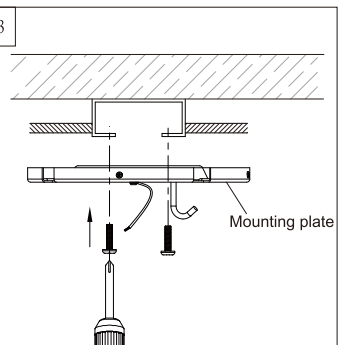

Use metal outlet box suitable for fan support and use only the screws provided with the outlet box (must support 35 lbs). Before attaching fan to outlet box, ensure the outlet box is securely fastened by at least two points to a structural ceiling member (a loose box will cause the fan to wobble). Remove the two outlet box screws provided with the box, aligning the holes of the mounting plate with the holes of the outlet box. Reinstall the 2 outlet box screws securely.

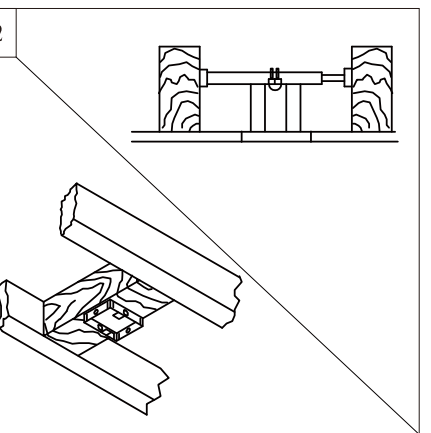

Before installing this fan make sure the outlet box is properly installed to the house structure. To reduce the risk of fire, electric shock, or personal injury, mount to outlet box or supporting system acceptable for fan support. (Mounting must support at least 35 lbs.)

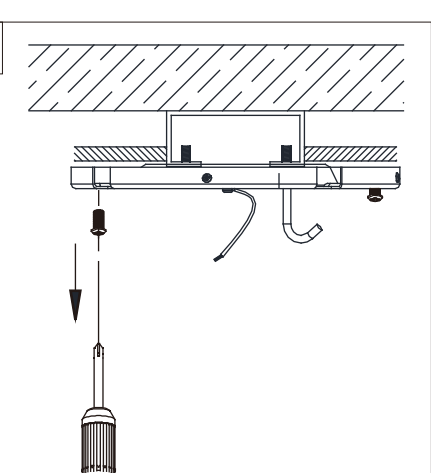

Remove the 4 preassembled screws from mounting plate (Corresponding to installation step 8). Save screws for later use.

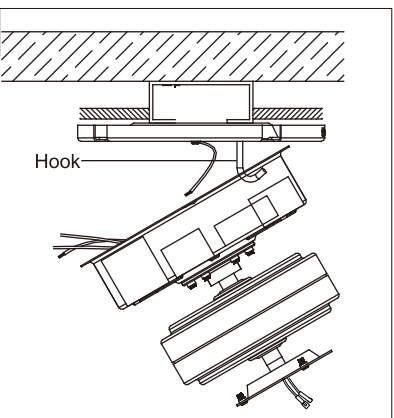

Hang motor assembly onto the hook on mounting plate for hands-free wiring installation.

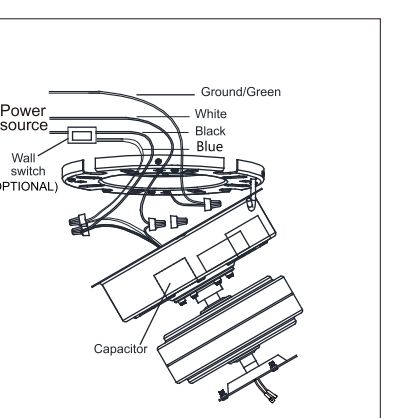

Make wiring connections using wire connectors provided as indicated on figure 6.

White from house to White from motor (AC N) Blue from house to Blue from motor. Black from house to Black from motor (AC L). Connect all green grounded wires to Grounded wire from House. Make sure that no filaments are outside of the wire connector.

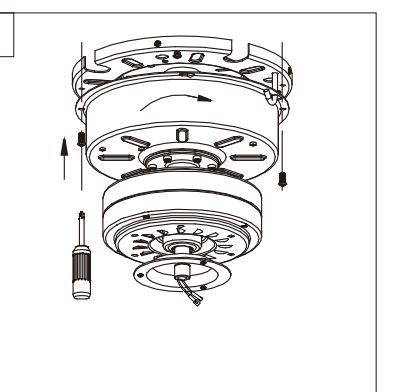

Lift motor assembly, aligning the keyhole slots with the preassembled screws on mounting plate, and twist clockwise till lock. Reinstall the screws removed in figure 4. Tighten all screws securely.

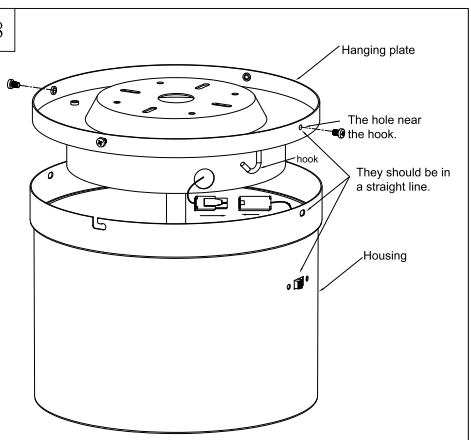

Installing the housing

There are 4 screws on the hanging plate, loosen 2 screws, remove 2 screws. The motor housing is directional, as shown in the picture. Insert the wire first, then lock the motor housing.

Attach housing onto hanging plate, aligning the keyhole slots on the housing with the screws on mounting plate and twist clockwise till tight. Reinstall the screw removed previously. Tighten all screws securely.

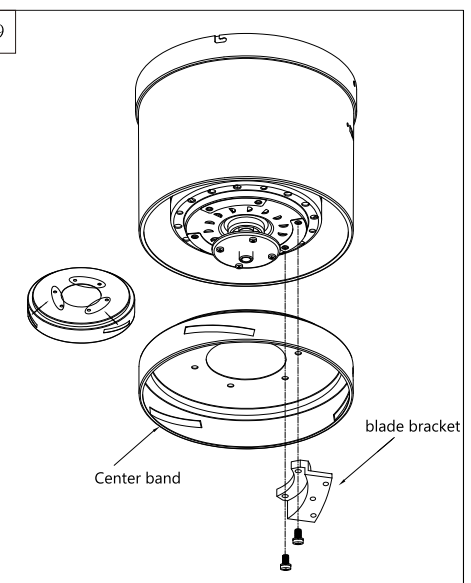

Installing the center band and blade bracket

The three groups of holes in the center band are aligned with the three groups of holes in the motor shell.

Note: Do not lock the first blade bracket tightly, because it may need to adjust the center band so that the hole in the center band is aligned with the hole in the motor shell when locking the second blade bracket. After all the blade brackets are installed, lock all the screws tightly.

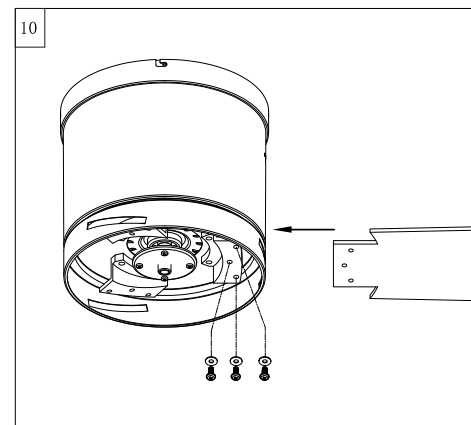

Install blade with screws provided, aligning each of the holes as shown and tighten all screws securely. Repeat this process for remaining blades.

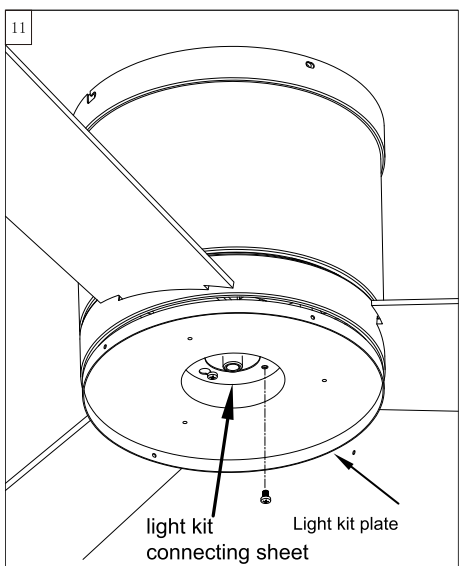

After finishing installed the blades, remove 1 screw and loosen 3 screws from the light kit connecting sheet before attaching the light kit plate to the center band. Lock back the 4 screws to secure the light kit plate.

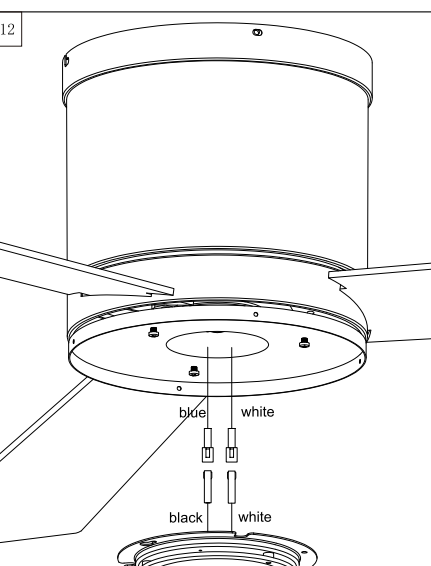

Find the two wires from the motor. Connect the blue wire from the motor to the black wire from the light kit, and connect the white wire from the motor to the white wire from the light kit.

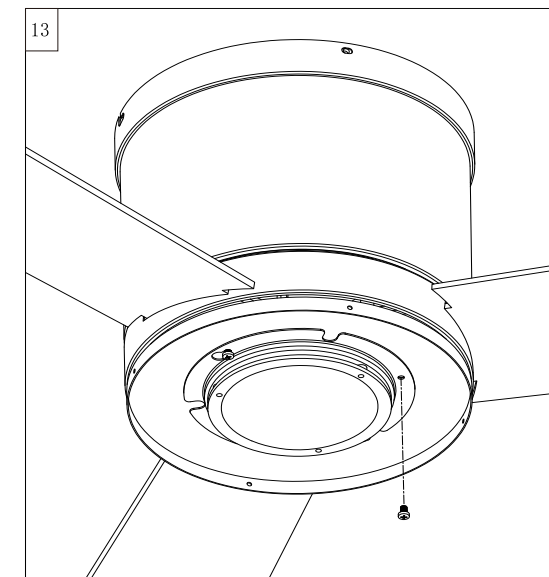

Installing the LED assembly

Loosen two screws and remove one screw on the light kit. Attach light kit to the light kit mounting plate using three screws provided.

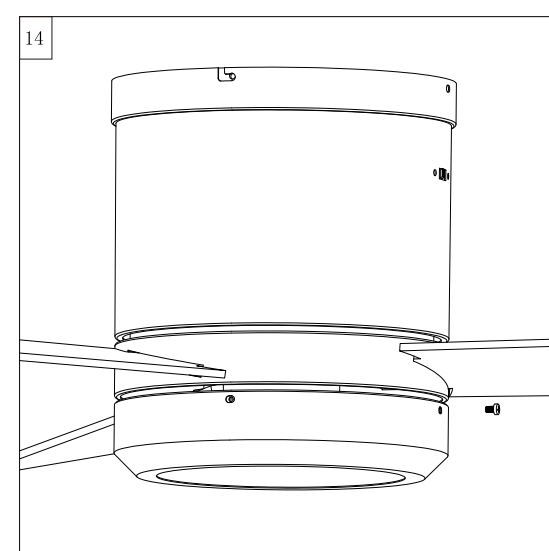

Installing the glass

Remove the 4 screws on the light plate, move up the glass shade, align the 4 holes then tighten the screws securely.



