

Series	Elite Workstation
Material	16 Gauge, Type 304 stainless steel
Installation Type	Apron front
Configuration	Double equal bowl
Finish	Satin brushed finish
Overall Dimensions	36" x 21"
Bowl Dimensions	16 3/8" x 16" x 10"
Drain Size	3 5/8"
Finish Available	Stainless Steel
Minimum cabinet size	36"
Template Included	No
Clips Included	No
Drain Locations	Rear
Accessories Included	Strainer (x2), Bottom grid (x2), Drying rack, and Cutting board



ACCESSORY
Strainer - L-1 x2
Bottom Grid - GR-3248 x2
Cutting Board - CB1711SW
Drying Rack - DR1713

MODEL	FINISH
WSA-48-PK1	Stainless Steel

Stocked Color Options



Stainless Steel

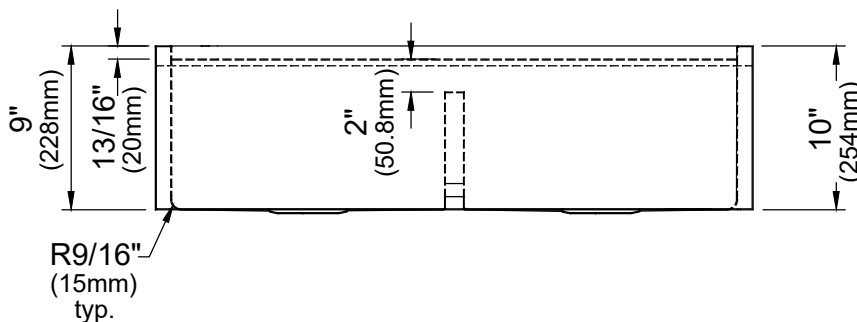
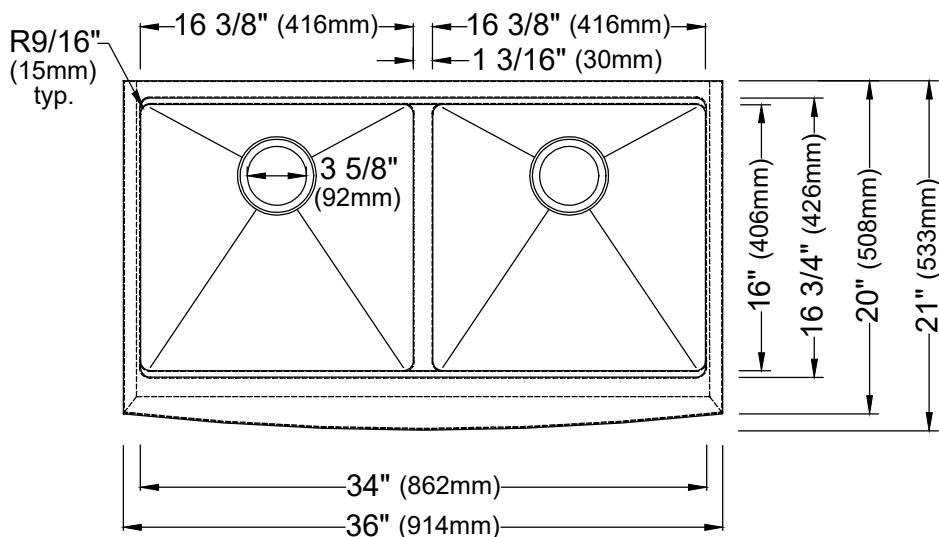

Listing and certifications:
cUPC

Limited lifetime warranty