

## RIVER USE, CARE AND SAFETY GUIDE.

# RIVER

## MOBILE POWER STATION

Congratulations! You now own the best quality Mobile Power Station in the world. This pamphlet is short and is meant to help you. Please take a few moments to read it and follow along on the unit itself. One pass and you will be a pro!

If you are the type of person that doesn't read instruction manuals, please at least note this:

**To turn on/off RIVER, you need to PRESS & HOLD the Power Button. To turn on the AC power outlet, you need to PRESS & HOLD the AC Button when RIVER is on.** This is designed purposefully. It will save the battery life so your RIVER's power is available when you need it.

**RIVER's Features:** Get to know your RIVER. Follow this step by step introduction to each of RIVER's ports, buttons, display screens and more.

**Technical Specifications:** Understanding the specs that make RIVER such an advanced piece of technology.

**How to Charge RIVER:** Everything you need to know about recharging your RIVER via wall charger, car charger or solar charger (if applicable).

**FAQs:** Answers to your most important questions about how to care for your RIVER, store your RIVER, and safely use your RIVER.

**What's in the Box:** What your purchase of RIVER should include. If your purchase does not include these items, please contact us at [support@ecoflowtech.com](mailto:support@ecoflowtech.com).

RIVER has built-in, intelligent, auto-sensing technology within its USB ports, TYPE-C ports, 12V DC ports and 12V car port. This means that when any of these ports sense that you have plugged in a device, our patented Battery Management System recognizes the most efficient charging voltage for each device and automatically adjusts the output voltage. All you have to do is plug in a device and RIVER does the rest. We call this carefree charging!

## RIVER'S FEATURES

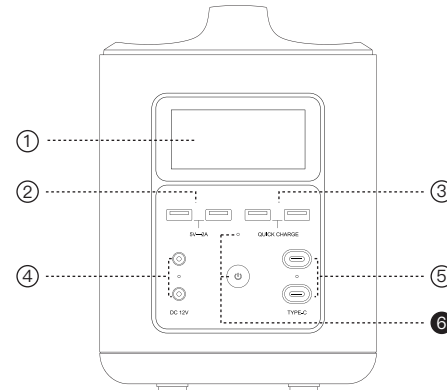

1. LCD Display
2. USB Ports
3. Quick Charge USB Ports
4. DC 12V Port  
DC 12V Output Indicator Light
5. Quick Charge Type-C Port  
Type-C Output Indicator Light
6. Power Button & LCD Display Screen On/Off  
Power Indicator Light

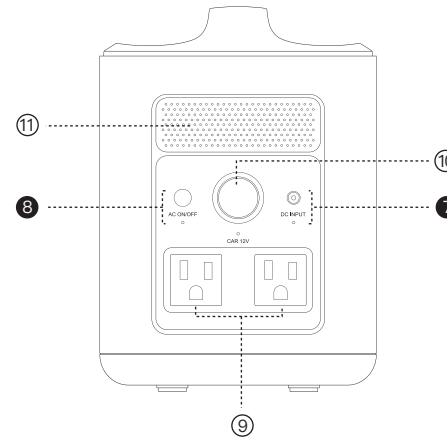

7. Input Port  
Input Indicator Light
8. AC Power Button (PRESS & HOLD for ON/OFF)  
AC Output Indicator Light
9. AC Outlet
10. 12V Car Port  
12V Car Output Indicator Light
11. Cooling Vent

### 1. LCD Display

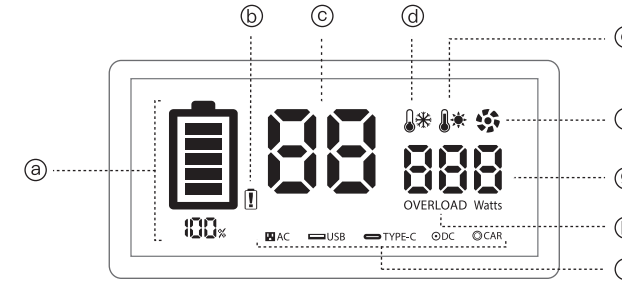

- a. **Battery Level Indicator** — Shows the remaining battery percentage. If your battery drops below 6%, the battery segment on the screen will begin to blink. When this happens, please immediately recharge your RIVER.
- b. **Battery Failure Warning Symbol** — If this symbol is illuminated, please contact [support@ecoflowtech.com](mailto:support@ecoflowtech.com), 1 844-GO-ECOFLOW, or 1-844-46-326-3569.
- c. **Remaining Charge Time** — Minute-level accuracy of the amount of charge time left in RIVER based on the current output level.
- d. **Low Temperature Indicator** — Indicates that RIVER's battery is lower than  $-4^{\circ}\text{F}$ . All input and output functions will stop working. Should this happen, take RIVER to a warmer place and she will automatically resume operating.
- e. **High Temperature Indicator** — Indicates that RIVER's battery temperature is too high. All input and output functions will stop and the fan will start. Once the battery cools, RIVER will automatically resume operating.
- f. **Cooling Fan Indicator** — The cooling fan will automatically turn on when RIVER's battery temperature is high.
- g. **Current Output** — Shows RIVER's current power output level in watts.
- h. **Overload Warning** — There are 2 levels of Overload Protection. First, **Software Level**, when the power pulled from the AC outlets steadily exceed the maximum AC power output 300W, the overload indicator and AC indicator will flash simultaneously for 15 seconds and the AC output will automatically and immediately turn off. Other ports will continue to work. Second, **Battery Level**, when the power pulled from the AC outlets immediately exceed the maximum AC power output 300W, the overload indicator and AC indicator will flash simultaneously for 15 seconds and RIVER will automatically and immediately turn off.
- i. **Port Usage Indicators** — Indicates when the USB, Type-C, DC 12V, or 12V Car Port is in use.

### 2. USB Port

Charge a wide array of devices such as your iPhone, tablet, GoPro, speakers, or anything else that charges through USB Port. The USB Output Indicator Light will automatically light up when a USB port is in use.

### 3. Quick Charge USB Port

Charge devices at 2x the speed using these ports. The USB Output Indicator Light will automatically light up when a USB ports is in use. If your device does not support quick charge, the device will charge at its normal speed.

### 4. DC 12V Port

RIVER's DC 12V Port can plug anything from your refrigerator to projector. The DC 12V Output Indicator Light will automatically lights up when the DC 12V Port is in use.

### 5. Quick Charge Type-C Port

Use Type-C to charge devices such as a select Android phones and any other devices that charge through a Type-C port. The Type-C Output Indicator Light will automatically light up when a Type-C port is in use.

### 6. Power Button & LCD Display Screen On/Off

PRESS & HOLD Power Button to turn RIVER on/off. When RIVER is turned on the LCD Display Screen will light up. To turn on/off LCD Display Screen and keep RIVER operating, press the Power Button. The Power Indicator Light will automatically light up when RIVER senses any of the output ports are in use. In addition, the **Power Indicator Light will blink when RIVER is in Idle State**. When in Idle State, none of RIVER's output ports are in use. After 1 minute of non-use, RIVER's screen will go to sleep, however the battery will remain active. **After 18 hours of non-use, RIVER will automatically turn off to protect its battery's health.**

### 7. Input Port

Recharge RIVER using AC in only 6 hours with the wall charger, 9 hours with the car charger, and 10-15 hours with the solar charger. Each purchase of RIVER comes with a 12V car charger and standard wall charger! The Input Port Indicator Light will automatically light up when Input Port is in use.

### 8. AC Power Button (PRESS & HOLD for ON/OFF)

The AC Power Button regulates the flow of AC out of RIVER. Since AC is less efficient than DC, we've designed RIVER to turn AC on only when a user needs it. To enable AC power, please PRESS & HOLD the AC Power Button. Please be sure to unplug the cord from the AC port and press the AC power button to turn AC off when you are not using it to charge your devices. The AC Indicator Light will come on when RIVER's AC power is enabled. **The AC Indicator Light will turn off after 8 hours of non-use.**

### 9. AC Outlet

Charge devices that require a 110V AC wall charger such as laptops, electric guitars, TVs, mini refrigerators, vacuums etc.

### 10. 12V Car Port

Charge devices such as drone batteries that require a 12V car port. The 12V Car Output Indicator Light will automatically light up when the 12V car port is in use.

### 11. Cooling Vent

The cooling vent prevents RIVER from overheating. A fan will automatically begin if RIVER's temperature exceeds the optimal range.

## TECHNICAL SPECIFICATIONS

### General

Shelf Life	1 Year (after fully charged)
Weight	11lbs (5.0kg)
Dimensions	9.8 x 6.3 x 8.2 in (25 x 16 x 20.8 cm)
Tested and Certified	CE, FCC, RoHS, UN38.3
Operating Temperature	Charge: 32 ~ 113°F (0~45°C) Discharge: -4 ~ 140°F (-20~60°C)
Optimal Storage Temperature	32 ~ 95°F (0~35°C)

### Inputs

Input Port (for solar, wall, or car charging)	10–22V, up to 110W
---	--------------------

### Outputs

AC Outlet (x2) 110V AC, 60Hz, pure sine wave 300W continuous, 600W peak	Quick Charge USB Port (x2) 5V/9V/12V, up to 2.4A
12V Car Port 12V, up to 8A (96W)	Quick Charge TYPE-C Port (x2) 5V/9V/12V, up to 2.4A
DC 12V Port (x2) 12V, up to 8A (96W)	USB Port (x2) 5V, up to 2.4A

### Internal

Battery Type	Lithium Ion
Battery Capacity	412Wh(14.48V, 28.5Ah)
Life Span	500 Cycles
Inverter	300W Pure Sine Wave

## HOW TO CHARGE RIVER



**6 Hours**  
(Included)



**10-15 Hours**  
(Weather Dependent)



**9 Hours**  
(Included)

### How do I charge my RIVER?

RIVER has one smart DC input port that can automatically adapt to any power source from 10V–22V without an extra adapter. This input is located on the back right-hand side of RIVER. RIVER can be charged via wall charger, car charger, or solar charger. It takes approximately 6 hours to recharge RIVER by AC wall charger, however in only 4 hours, RIVER will be 70% of the way there!

### Can RIVER power my devices while it's charging?

Yes, RIVER has state of the art flow through charging, meaning it can output power while being charged.

## FAQs

### How do I care for RIVER?

RIVER is designed for a variety of uses so there is a good chance RIVER will need a little cleaning every now and then. Please use a dry, non-abrasive cloth. We like the cleaners that have been designed for mobile phone and computer screens if you need a little extra oomph. Do not give if a bath!

### How do I store RIVER?

Please store your RIVER in a dry environment out of direct elements. For optimal battery health, store RIVER at room temperature after fully charged. EcoFlow Tech offers a water-resistant, dustproof case for maximum protection.

We suggest that you keep your RIVER connected to a power source when not in use, like a solar panel or a wall plug, so it keeps its battery healthy and topped off. This prolongs battery life and will ensure your RIVER is ready to recharge your gear at all times. If that is not possible, RIVER will hold its charge with very little drop off for over a year.

### How do I use RIVER safely?

RIVER has a tremendous operating temperature range, but using RIVER below -4 degrees Fahrenheit or over 140 degrees Fahrenheit (-20 degrees Centigrade and 60 degrees Centigrade) can push it beyond its safe and effective limits.

Do not submerge your RIVER. It is not waterproof and this will void your warranty. If you need to ensure she is water-resistant and dustproof, please utilize the RIVER Case.

Don't throw RIVER around. Treat RIVER like the equipment you are plugging into her, with care.

## WHAT'S IN THE BOX



RIVER  
Mobile Power Station

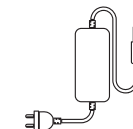

Wall Charger

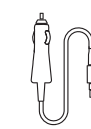

Car Charger

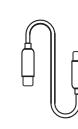

Type-C Cable

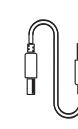

DC Cable

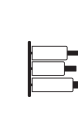

DC Tips



## User Guide



Contact Us:  
Toll Free: 1-844-46-326-3569  
support@ecoflowtech.com  
www.ecoflowtech.com



**WARNING**

1. Keep dry and do not expose to high heat.
2. Never disassemble, puncture, shock, crash, short or incinerate.
3. Recycle and dispose of RIVER in accordance with local regulation.