

allen + roth®

ITEM #5998254
MODEL #H24S7420G

42IN. ROUND TILE
GAS FIREPIT TABLE

ATTACH YOUR RECEIPT HERE

ALLEN + ROTH and logo design are trademarks
or registered trademarks of LF, LLC. All rights
reserved.

SEDGEBROOK

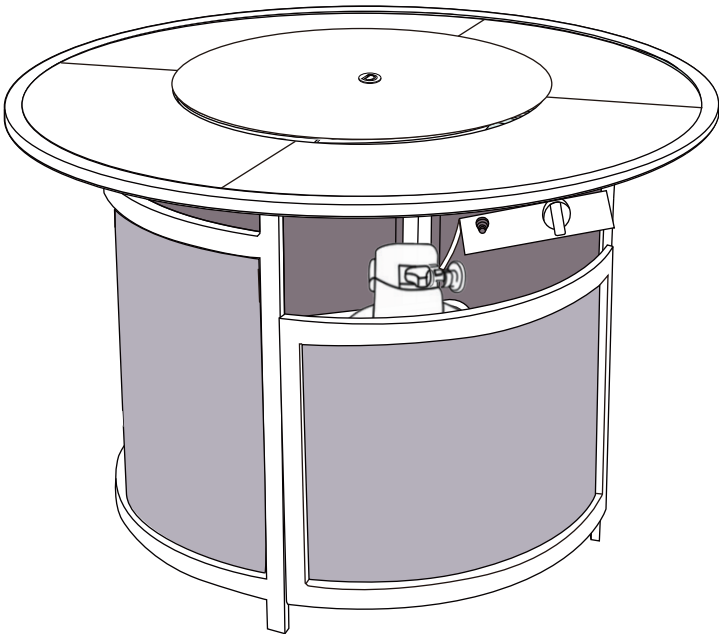

Serial Number _____

Purchase Date _____

Thank you for purchasing this ALLEN + ROTH product.
Questions, problems or missing parts?
Before returning, contact us on:
866-439-9800, 8 a.m. - 8 p.m., EST, Monday - Sunday or ascs@lowes.com.

TABLE OF CONTENTS

Package Contents.....3

Hardware Contents.....4

Safety Information.....5

Preparation.....5

Assembly or Installation Instructions.....8

Operating Instructions12

Care and Maintenance.....12

Troubleshooting.....12

Warranty.....13

Replacement Parts List13

PACKAGE CONTENTS

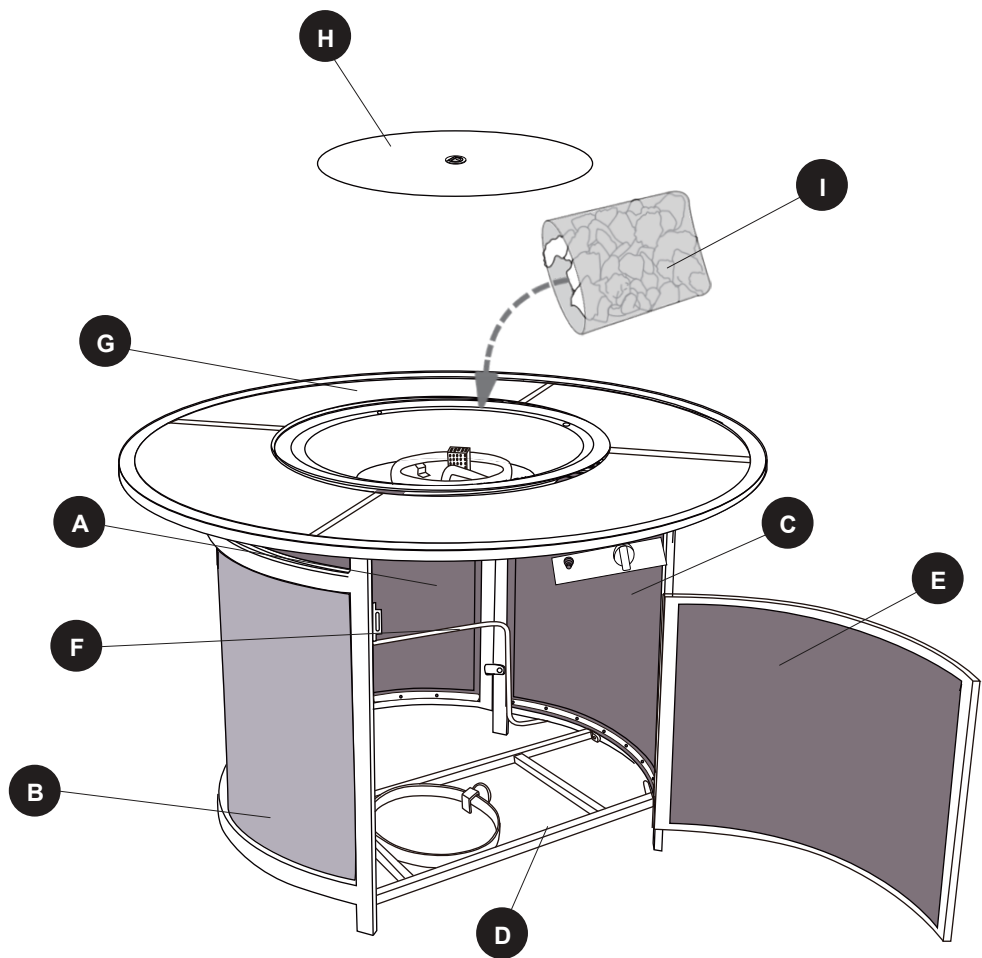

PART	DESCRIPTION	QUANTITY
A	Rear Frame	1
B	Frame A	1
C	Frame B	1
D	Bottom Frame	1
E	Front Door	1

PART	DESCRIPTION	QUANTITY
F	Cross Brace	1
G	Table Top	1
H	Cover	1
I	Lava Rocks	1

HARDWARE CONTENTS (Not actual size)

AA

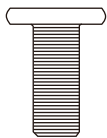

M6 x 15 mm
Bolt
Qty. 13

BB



ST4.8 x 16 mm
Screw
Qty. 2

CC



d6.5 x D13 x 1.0
Washer
Qty. 13

DD



Upper
Connector
Qty. 1

EE



4 mm
Wrench
Qty. 1

SAFETY INFORMATION

Please read and understand this entire manual before attempting to assemble, operate or install the product.

WARNING

- Use the correct bolts as indicated. Do not tighten any of the bolts until the chair is completely assembled.
- Some parts may contain sharp edges. Wear protective gloves as necessary.
- Children under the age of 16 should not be engaged in the assembly, removal or disassembly of the product.
- Children under the age of 10 should be supervised by a competent adult while using this furniture.
- This set is heavy, and may require two adults for safe assembly.
- Never use this product as a support. Do not shake, lean, or climb on the product at any time.
- Do not discard any of the packaging until you have checked that you have all of the parts and fittings required.
- Keep children away during assembly. This item contains small parts that can be swallowed by children. Children should always be under direct adult supervision while using this product.

CAUTION

- Do not overtighten any of the bolts as this may damage the threads.
- Repeated assembly can weaken the locking ability of the washers.
- Periodically check all bolted connections on the furniture to make sure they are tight and secure.
- Retain these instructions for future reference.
- Paint on this product might peel off if it is hit or used improperly.
- This outdoor furniture is designed and made for personal non-commercial use.
- This item should not be used as a toy or a tool.
- Do not locate the product near any heat source.
- Do not place heavy objects on the table top.

PREPARATION

Before beginning assembly of product, make sure all parts are present. Compare parts with package contents list and hardware contents list. If any part is missing or damaged, do not attempt to assemble the product.

Note:

- The labels marked “2” and “3” on the frames should coincide with Figure 1 to ensure proper assembly.

Estimated Assembly Time: 30 minutes



! WARNING: For Outdoor Use Only
Installation and service must be performed by a qualified installer, service agency, or the gas supplier.

! Warning: If the information in this manual is not followed exactly, a fire or explosion may result causing property damage, personal injury, or loss of life.

- Do not store or use gasoline, or other flammable vapors and liquids, in the vicinity of this or any other appliance.

An Propane-cylinder not connected for use shall not be stored in the vicinity of this or any other appliance.

! DANGER: FIER OR EXPLOSION HAZARD

If you smell gas:

- Shut off gas to the appliance.
- Extinguish any open flame.
- If odor continues, leave the area immediately.
- After leaving the area, call your gas supplier or fire department.

Failure to follow these instructions could result in fire or explosion, which could cause property damage, personal injury, or death.

! Warning: Improper installation, adjustment, alteration, service or maintenance can cause property damage, personal injury or loss of life. Refer to the owner's information manual provided with this appliance. Installation and service must be performed by a qualified installer, service agency, or the gas supplier.

INSTALLER: Leave this manual with the appliance.

CONSUMER: Retain this manual for future reference.

! DANGER



CARBON MONOXIDE HAZARD

This appliance can produce carbon monoxide which has no odor.

Using it in an enclosed space can kill you.

Never use this appliance in an enclosed space; such as a camper, tent, car, or home.

- ! Use the correct bolts as indicated. Do not tighten any of the bolts until the appliance is completely assembled.
- ! Do not sit or stand on this appliance.
- ! Keep children away during assembly. This item contains small parts that can be swallowed by children.
- ! Do not use indoors or inside of any enclosure.
- ! Retain these assembly instructions for future reference.
- ! Installer - Leave these instructions with the owner.
- ! Quote the following FQC No. when contacting the service center.

SERVICE CENTER TOLL FREE NO.
TEL: 866-439-9800

When an appliance is for connection to a fixed piping system, the installation must conform with local codes or, in the absence of local codes, with the National Fuel Gas Code, ANSI Z223.1 NFPA 54; National Fuel Gas Code; Natural Gas and Propane Installation Code, CSA B149.1; or Propane Storage and Handling Code, CSA B149.2, as applicable.

WARNING

Keep the appliance area clear and free from combustible materials, gasoline, and other flammable vapors and liquids.

Solid fuels should not be burned in this gas appliance.

Inspect the hose before each use of the appliance.

The hose assembly must be replaced prior to the appliance being put into operation if there is evidence of excessive abrasion, wear, or if the hose is damaged. The replacement hose assembly is specified in this manual.

The burner must be inspected before each use.

The burner must be replaced prior to the appliance being put into operation if it is evident that the burner is damaged. The replacement burner is specified in this manual.

The burner should always be cleaned:

Disconnect it from the appliance, use a cleaner to remove blockages attached on the ports, and drain the blockages from the gas inlet. A high pressured stream of water may also be used.

WARNING

Do not use this appliance if any part has been under water. Immediately call a qualified service technician to inspect the appliance and to replace any part of the control system and any gas control that has been under water.

This appliance is for outdoor use only in a well-ventilated space and should not be used in a building, garage, or any other enclosed area. Other cylinders may be acceptable for use with the appliance provided that they are compatible with the appliance retention means and accompanied by illustration(s) depicting the cylinder mounted to the appliance utilizing the cylinder retention means and the point of contact between the cylinder and the retention means. The cylinder should be 12 inches in diameter and 18 inches high. The capacity is 20 lbs. of propane.

WARNING

If the appliance is not in use, the gas must be turned off at the supply cylinder.

Storage of an appliance indoors is permissible only if the cylinder is disconnected and removed from the appliance.

Cylinders must be stored outdoors in a well-ventilated area and out of children's reach.

Disconnected cylinders must have a dust cap secured at the end of the valve and cannot be stored in a building, garage, or any other enclosed area.

The pressure regulator and hose assembly supplied with this appliance must be used. Replacement pressure regulators and hose assemblies must be the ones specified in this manual.

WARNING

The cylinder supply system must be arranged for vapor withdrawal.

The cylinder used must include a collar to protect the cylinder valve.

The Propane-gas supply cylinder to be used must be:

1. Constructed and marked in accordance with the U.S. Department of Transportation (D.O.T.) Specifications for Propane-Gas Cylinders, or the Standard for Cylinders, Spheres and Tubes for Transportation of Dangerous Goods; and Commission, CAN/CSA-B339 as applicable;
2. Provided with a listed overfilling prevention device;
3. Provided with a cylinder connection device compatible with the connection for the appliance.

The Procedure for Checking for Gas Leaks:

Never test for leaks with a flame. Prior to first use, at the beginning of each season, or every time your propane gas tank is changed, you must check for gas leaks.

Follow these three steps:

1. Make a soap solution by mixing one part liquid detergent and one part water.
2. Make sure that the burner is off and then turn the gas on at source.
3. Apply the soap solution to all gas connections, especially to the inlet/manifold pressure tap on the gas valve after reading the pressure. Bubbles will appear in the soap solution if the gas connections are not properly sealed. If you have a gas leak, tighten gas connections, turn off the gas at the source, disconnect the fuel line from your appliance, and call **866-439-9800** for repair assistance.



Locate the gas hose and make sure that it is not in any pathways where people may trip over it or in any areas where the hose may be subject to accidental damage.

ASSEMBLY INSTRUCTIONS

1. PARTS REQUIRED: AA, CC, A, B & C

Keep the bolts loose.

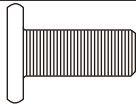
Hardware Used

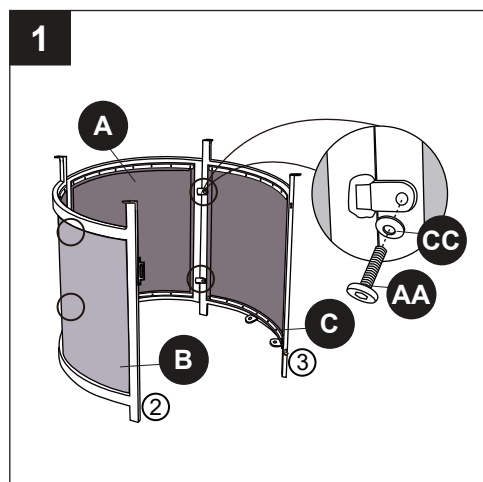

AA	M6 x 15 mm Bolt		x 4
CC	d6.5 x D13 x 1.0 Washer		x 4



2. PARTS REQUIRED: AA, BB, CC, B, C, D & F

Keep the bolts loose.

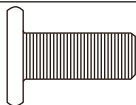
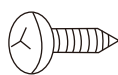
Hardware Used

AA	M6 x 15 mm Bolt		x 4
BB	ST4.8 x 16 mm Bolt		x 2
CC	d6.5 x D13 x 1.0 Washer		x 4

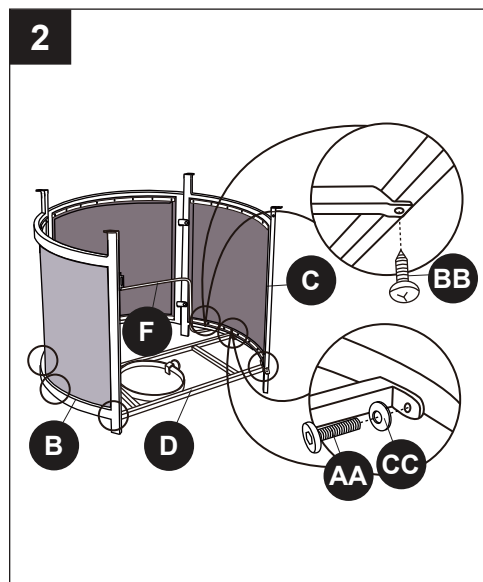

3. PARTS REQUIRED: C & E

Insert the front door into the connector tab of frame (B).

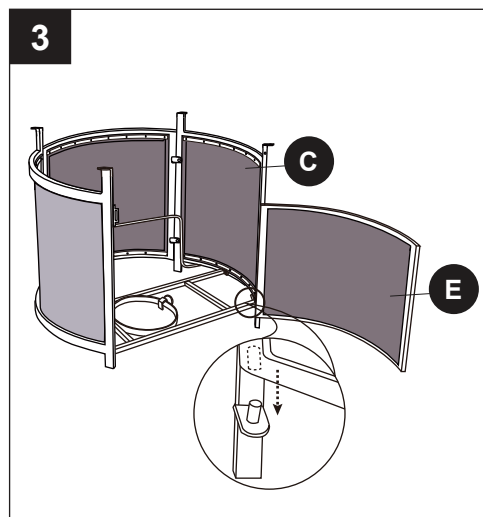

ASSEMBLY INSTRUCTIONS

4. PARTS REQUIRED: AA, CC, DD, C & E

Tighten all bolts by using the supplied Hex key.

Hardware Used

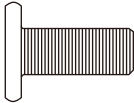
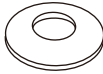

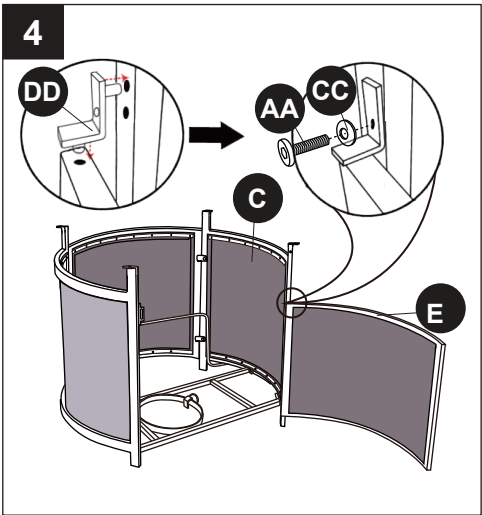
AA	M6 x 15 mm Bolt		x 1
CC	d6.5 x D13 x 1.0 Washer		x 1



5. PARTS REQUIRED: AA, CC & G

Tighten all bolts by using the supplied Hex key.

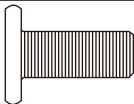
Hardware Used

AA	M6 x 15 mm Bolt		x 4
CC	d6.5 x D13 x 1.0 Washer		x 4

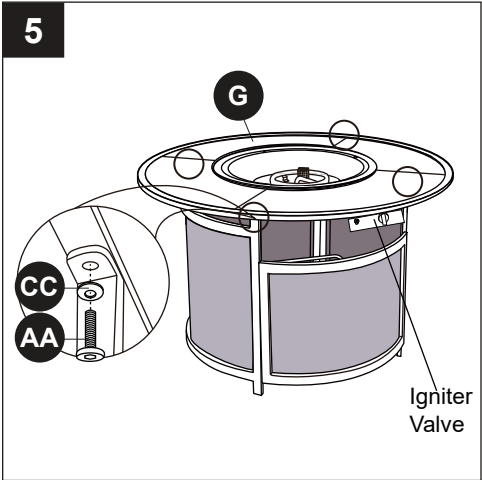

6. PARTS REQUIRED: E

Note:

Secure the tank in place by turning the plastic screw clockwise as illustrated above.

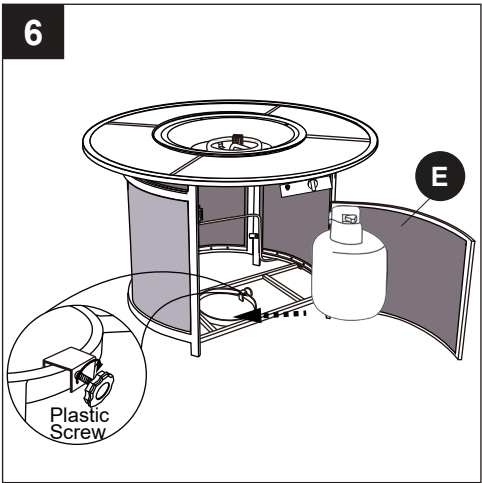

ASSEMBLY INSTRUCTIONS

7

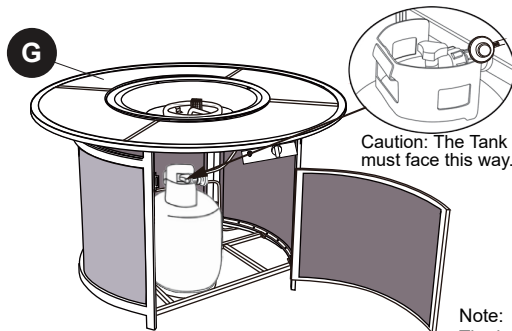

Caution: The Tank must face this way.

Note:

The igniter valve should be facing towards the front left side of the appliance.

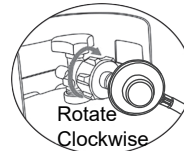

8

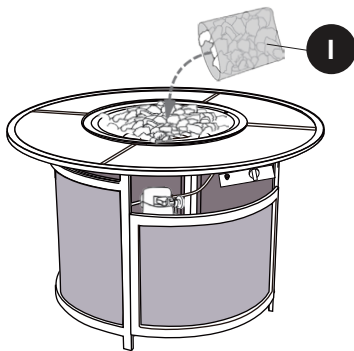

Fire Shield

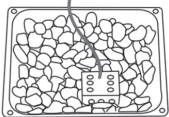

Note:
The fire shield on the burner system must be exposed.

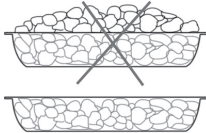

Note:
The glass cannot be exposed over top of the steel cover surface.

9

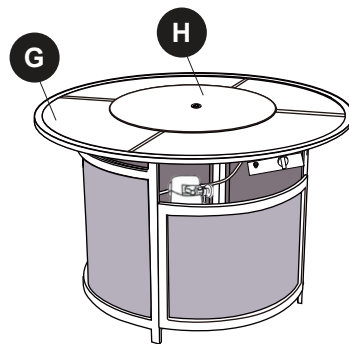

Note:

In order to protect the burner system, when the fire is not in use and on rainy days, the cover should be used.

8. PARTS REQUIRED: I

9. PARTS REQUIRED: H

SPECIFIC WARNINGS:

- 1) Both children and adults should be aware of the hazards of high surface temperatures and should keep their distance in order to avoid burns and ignition of clothing.
- 2) Children should be under adult supervision when in the vicinity of this appliance.
- 3) Clothing or any other flammable materials should not be hung from or near this appliance.
- 4) Any guard or protective device removed for servicing the appliance must be replaced prior to use.
- 5) Installation and repair should be done by a qualified person. The appliance should be inspected before use and at least annually by a qualified service technician. Frequent cleaning may be required. It is imperative that the control compartment, burners, and circulating air passageways of the appliance be kept clean at all times.

ASSEMBLY INSTRUCTIONS

INSTRUCTIONS FOR REMOVING THE TANK

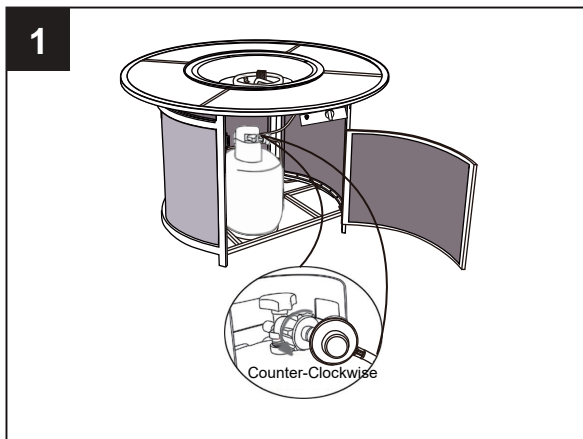

Note:

Close the valve tightly before removing the tank.

Step 1:

To remove the fuel supply hose from the tank, rotate counter-clockwise. See Figure 1.

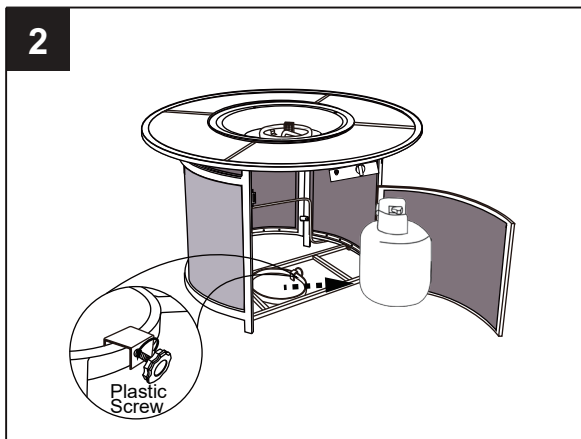

Step 2:

Remove the tank from the tank-support assembly and through the tank fastener. See Figure 2.

Note:

To replace the tank, repeat Step 6 and Step 7 in the assembly instructions.

CARE INSTRUCTIONS

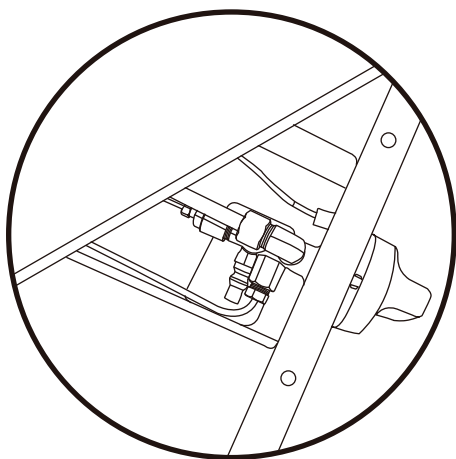

NOTE:

You must make periodic checks to ensure that all connections are secured.

NOTE:

Keep this manual for future reference.

OPERATING INSTRUCTIONS

Assemble on a soft surface, such as a carpet to avoid scratching the product.

CARE AND MAINTENANCE

- Wash frame, wicker, and fabric parts with mild soap and water, rinse thoroughly, and dry completely. Do not use bleach, acid, or other solvents on the frame, wicker, or fabric parts.
- The cushions may be washed on the surface only by using mild soap and water or a commercial foaming upholstery cleaner if necessary. If washed, rinse well and hang to dry. Do not machine wash or dry.
- We recommend the use of furniture covers when not in use.
- Inspect and tighten all of the bolts and fasteners on a regular basis to ensure the proper performance and safety of your chair.
- In order to prolong the life and beauty of your chair, we recommend that it be stored in a dry and protected area during off season periods.

TROUBLESHOOTING

PROBLEM	POSSIBLE CAUSE	CORRECTIVE ACTION
Parts won't properly align.	Bolts tightened before assembly complete.	Loosen all bolts, properly align all parts according to assembly instructions, and only tighten bolts once assembly is complete.

WARRANTY

Three years limited warranty.

Proof of purchase (dated register receipt) is required for warranty claims.

It remains the customer's responsibility for freight and packing charges to and from the service center.

This limited warranty is extended to the original purchaser and applies to defects in materials and workmanship of your patio furniture, provided your furniture is maintained with care and used only for personal, residential purposes.

Exclusions: Items used for commercial, contract or other non-residential purposes; display models; items purchased "as is;" or items damaged due to acts of nature, vandalism, misuse or improper assembly are not covered. Discoloration or fading of the finish or fabrics as a result of exposure to the elements, chemicals or spills; tabletop breakage; corrosion or rusting of hardware; and damages to frames or welds caused by improper assembly, misuse or natural causes are not covered.

If within the stated warranty period a product is found to be defective in material or workmanship, the purchaser must contact the manufacturer's customer service department at **866-439-9800**,

8 a.m. - 8 p.m., EST, Monday - Sunday. You could also contact us at **ascs@lowes.com**.

The manufacturer, at its option, will repair or replace the defective parts.

The warranty is to the original purchaser and is non-transferable. Any replacement of warranted items will be in the original style and color, or a similar style and color if the original is unavailable or has been discontinued. As some states do not allow exclusions or limitations on an implied warranty, the above exclusions and limitations may not apply. This warranty gives you specific rights and you may also have other rights which vary from state to state.

REPLACEMENT PARTS LIST

For replacement parts, call our customer service department at **866-439-9800**, 8 a.m. - 8 p.m., EST, Monday - Sunday. You could also contact us at **ascs@lowes.com**.

PART	DESCRIPTION	PART #	COVERED UNDER WARRANTY
A	Rear Frame	HTVS42GE-HJ	YES
B	Frame A	HTVS42GE-JA	YES
C	Frame B	HTVS42GE-JB	YES
D	Bottom Frame	HTVS42GE-DG	YES
E	Front Door	HTVS42GE-MK	YES
F	Cross Brace	HTVS42GE-ZG	YES
G	Table Top	HTVS42GE-ZM	YES
H	Cover	HTVS42GE-GB	YES
I	Lava Rocks	HTVS42GE-HSS	YES