



Thank you for selecting JELD-WEN products. Attached are JELD-WEN's recommended installation instructions for Mulling Premium Atlantic/Builders Vinyl Windows. Not all window types may be installed into every wall condition in all areas. Consult your local building code official for applicable building codes and regulations. Local building code requirements supersede recommended installation instructions. JELD-WEN does not endorse the installation of our products into a barrier-type install system unless a sill pan is present, incorporated with through-wall flashing and can drain to the exterior (along with other "required" components). Failure to do so may result in the denial of any warranty claims. Areas such as Florida and the Texas TDI region have different anchoring requirements based on product certification. For information on specific products, visit www.floridabuilding.org or www.tdi.texas.gov and follow the anchoring schedule given in the drawings for the product instead of the anchoring schedule in this document.

IMPORTANT INFORMATION | TABLE OF CONTENTS | GLOSSARY

JELD-WEN does not endorse the installation of our products into a barrier-type install system unless a sill pan is present, incorporated with through-wall flashing and can drain to the exterior (along with other "required" components). Failure to do so may result in the denial of any warranty claims.

PLEASE NOTE: Installations where the sill is higher than 35 feet above ground level, or any product installation into a wall condition not specifically addressed in these instructions, must be designed by an architect or structural engineer. Failure to install windows into a square, level, and plumb openings could result in denial of warranty claims for operational or performance problems.

NOTE TO INSTALLER: Provide a copy of these instructions to the building owner. By installing this product, you acknowledge the terms and conditions of the limited product warranty as part of the terms of the sale.

Table of Contents

Safety and Handling	2
Materials and Tools	2
Nail Fin or 'J'-Channel Windows	3
5/8" Flange Windows	4
1" x Aluminum Mull Bar with Goal Post Clip Anchor (Typical Application)	5
1 x Aluminum Mull Bar with Goal Post Clip Anchor (Typical Installation)	6
1" Aluminum Mull Bar with T-Clip Anchor (Typical Application)	7
1" x Aluminum Mull Bar with T-Clip Anchor (Typical Application) ..	8

NOTICE

JELD-WEN advises against product installation in high interior water exposure environments such as showers, steam rooms and enclosed pool areas. These areas are beyond the tested/certified design intent of the window and any related warranty claims could be denied on that basis.

Glossary

Buck

A wood framework attached to the masonry inside a window or patio door rough opening.

Mull Joint

The joint where two or more window units are structurally joined together.

Mulled Unit

Two or more window units structurally joined together.

Self-Adhered Flashing

An adhesive-backed tape material used to waterproof the rough opening and/or used to seal a window to the building's weather barrier.

Weep Hole (weep channel)

The visible exit or entry part of a water drainage system used to drain water out of a window.

SAFETY AND HANDLING

Safety

- Read and fully understand **ALL** manufacturers' instructions before beginning. Failure to follow proper installation instructions may result in the denial of warranty claims for operational or performance problems.
- **DO NOT** work alone. **Two or more people are required.** Use safe lifting techniques.
- Use caution when handling glass. Broken or cracked glass can cause serious injury.
- Wear protective gear (e.g., safety glasses, gloves, ear protection, etc.).
- Operate hand/power tools safely and follow the manufacturer's operating instructions.
- Use caution when working at elevated heights.
- If disturbing existing paint, take proper precautions if lead paint is suspected (commonly used before 1979). Your regional EPA (www.epa.gov/lead) or Consumer Product Safety Commission offices provide information regarding regulations and lead protection.

⚠ WARNING

Drilling, sawing, sanding or machining wood products can expose you to wood dust, a substance known to the State of California to cause cancer. Avoid inhaling wood dust or use a dust mask or other safeguards for personal protection. For more information, go to www.P65Warnings.ca.gov/wood.

Window Handling

- Make sure operable windows are locked prior to mulling/installation.
- Heed material manufacturers' handling and application instructions.
- Handle in a vertical position; **DO NOT** carry flat or drag on the floor.
- **DO NOT** put stress on joints, corners or frames.
- Store window in a vertical, leaning position to allow air circulation; **DO NOT** stack horizontally.
- Ensure the storage area is dry, well-ventilated and **protected from exposure to direct sunlight.**
- Only install into vertical walls when conditions and sheathing are dry.

IF INJURY OCCURS, IMMEDIATELY SEEK MEDICAL ATTENTION!

MATERIALS AND TOOLS

JELD-WEN exterior window and door products should be installed in accordance with JELD-WEN's recommended installation instructions, which are printed on the product label or can be found on our website: www.jeld-wen.com. **NOTE:** When using flashing, spray adhesive/primer, sealant and foam products, we recommend using the same manufacturer and verifying compatibility. It is the End User's responsibility to determine if dissimilar materials are compatible with the substrates in the application.

Needed Materials

- Sealant: An exterior grade (**High-Performing, Low VOC**) sealant is recommended for installation practices. Check with sealant manufacturers for color-match options and paintability.

Potential Needed Tools

- Utility knife/shears
- J-roller
- Hammer
- Tape measure
- Caulking gun
- Level (4' minimum recommended)
- Drill with bits
- Pry bar

NAIL FIN OR 'J'-CHANNEL WINDOWS

⚠ WARNING

Use caution and appropriate personal protective equipment (PPE) as the window(s) may be heavy requiring two or more people to lift, move and process without damage or injury.

Score Nail Fin.

1. Determine which side(s) the mull bar will be fixed to the window frame.
2. Score nailing fin with a utility/razor knife (or similar tool) where the nailing fin meets the main frame on both sides.

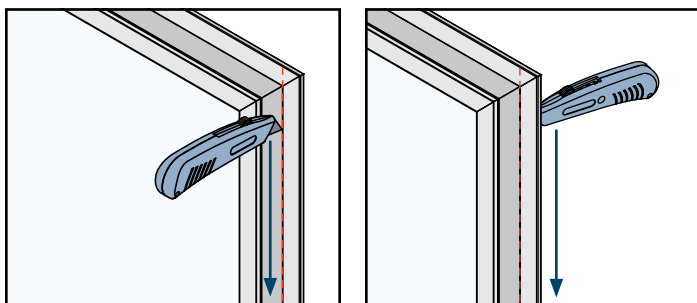

Remove Nail Fin.

1. Fold the nailing fin back and forth along the score line until the nailing fin can be removed.
2. Smooth any excessive burrs to ensure that the mull bar will sit flush against the frame.

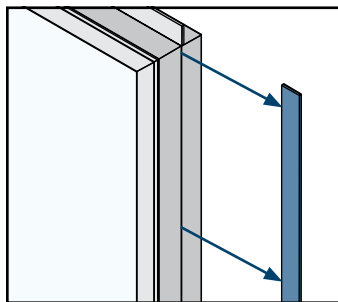

Drill a 3/8" Anchor Hole Through the Interior Wall of the Frame.

1. You will need to use the approved through-frame anchor spacing for your specific product which is available from your dealer or applicable certification agency (www.floridabuilding.org or www.tdi.texas.gov).
2. Drill a 3/8" hole through the interior wall/layer of the interior pocket at the locations detailed in the approval. **DO NOT** drill through the exterior wall.

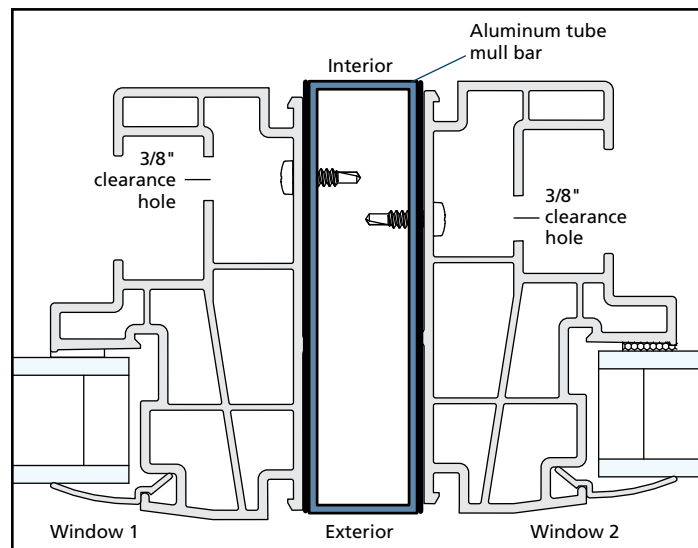

5/8" FLANGE WINDOWS

Score Back of Front Flange.

1. Determine which side(s) the mull bar will be fixed to the window frame.
2. Score the back of the front flange with a utility/razor knife or similar tool where the flange meets the main frame.

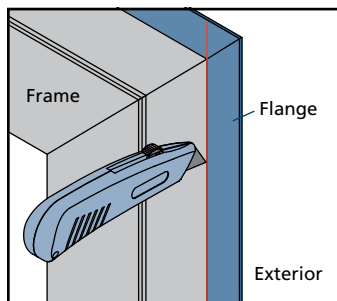

Remove Front Flange.

Fold the flange back and forth along the score line until the flange can be removed.

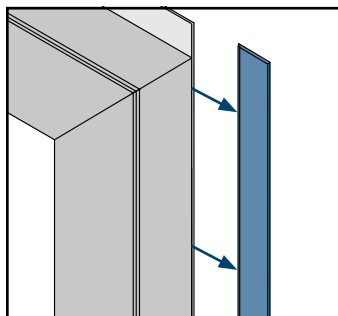
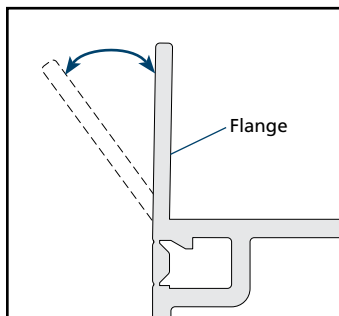

Open Exterior Accessory Groove.

Determine which side(s) the mull bar will be fixed to the window frame. Locate the concealed accessory groove along the edge of the frame (a thin vinyl webbing covering the accessory groove and defined by two faint scribe lines that define the walls of the groove). Using a utility/razor knife, push through the vinyl webbing and begin to cut along the edges.

NOTE: A drill can be used to generate a pilot hole as a starting point and pliers can assist with the removal of the webbing.

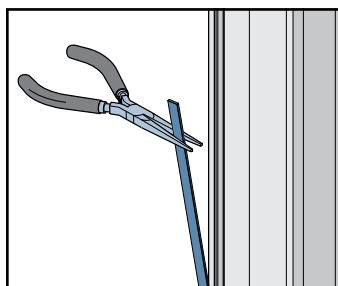
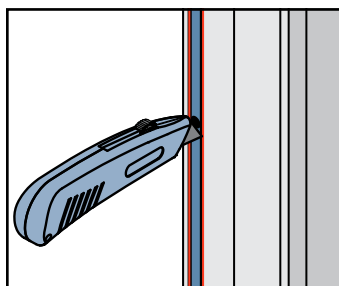
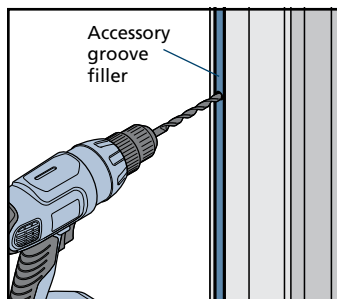
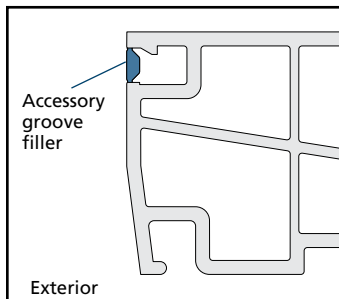

'J'-Channel Only: Drill 3/8" Anchor Hole Through the Interior Wall of the Frame.

1. You will need to use the approved through-frame anchor spacing for your specific product which is available from your dealer or applicable certification agency (www.floridabuilding.org or www.tdi.texas.gov).
2. If not pre-drilled, drill a 3/8" hole through the interior wall/layer of the interior pocket at the locations detailed in the approval. **DO NOT** drill through the exterior wall.

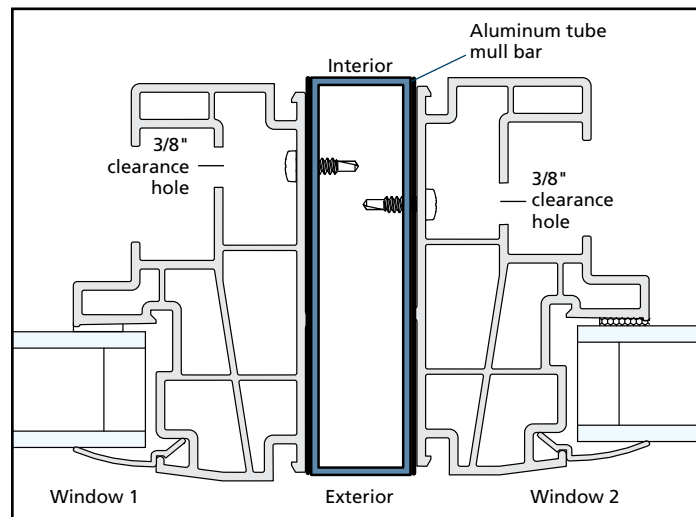

1" X ALUMINUM MULL BAR WITH GOAL POST CLIP ANCHOR (TYPICAL APPLICATION)

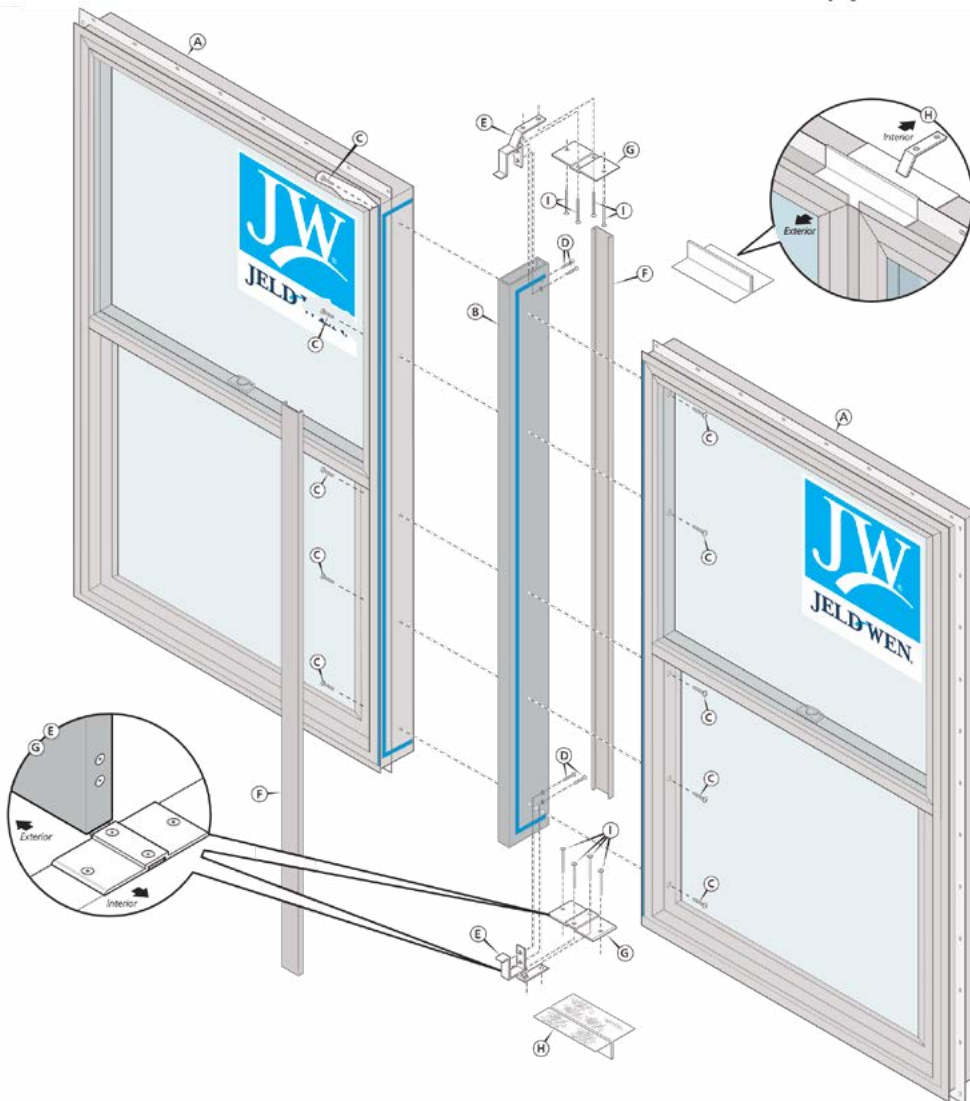

Item	Parts List
A	Premium Atlantic Vinyl/ Builders Vinyl Windows
B	1" x 3 1/4" x 4" Aluminum Tube Mull Bar
C	#10 x 3/4" Phillips Pan-Head, Self-Tapping
D	#10 x 3/4" Phillips Flat-Head, Self-Tapping
E	Goal Post Mull Clip
F	1 1/2" Mull Cover Strip
G	Goal Post Mull Anchor Plate
H	Mull Tape
I	Concrete/Masonry: 3/16" Concrete screw with minimum embedment of 1 1/4" into the structural framing (or as required by local code). Wood: #10 Wood screw with minimum embedment of 1 1/2" into the structural framing (or as required by local code).
	Silicone

IMPORTANT NOTES – READ FIRST!

- All mull covers covering weep holes must be notched to expose weep holes for proper drainage.
- 1" X 4" mulls do not use the interior cover strip (F).
- For units other than Single-Hung, use 3/8" color-match, hole plugs in jambs to cap screw holes.
- **DO NOT** apply silicone over product labels. Remove labels as necessary.
- Vinyl frames and components must be clean and dry. If the components are dusty or dirty, remove by wiping with a clean, dry cloth.

1 X ALUMINUM MULL BAR WITH GOAL POST CLIP ANCHOR (TYPICAL INSTALLATION)

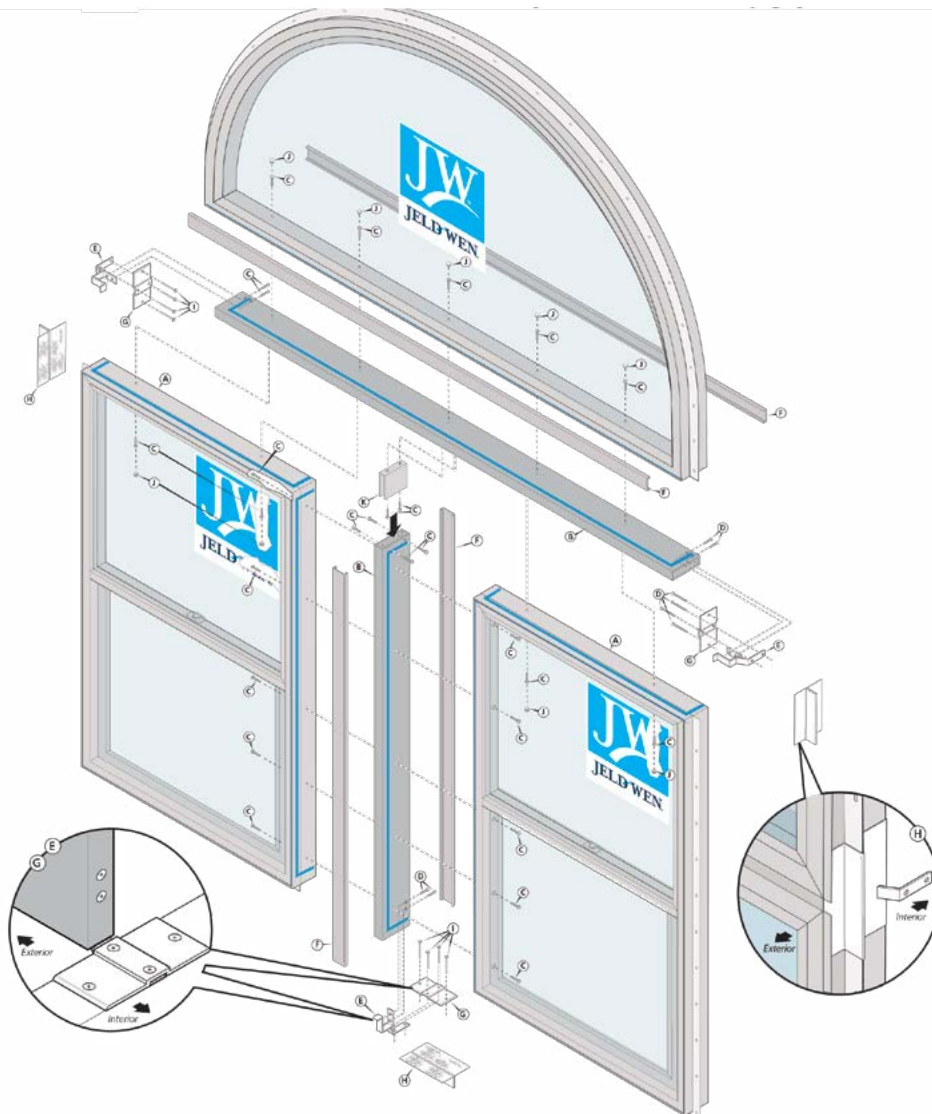

Item	Parts List
A	Premium Atlantic Vinyl/ Builders Vinyl Windows
B	1" x 3" or 1" x 4" Aluminum Tube Mull Bar
C	#10 x 3/4" Phillips Pan-Head, Self-Tapping
D	#10 x 3/4" Phillips Flat-Head, Self-Tapping
E	Goal Post Mull Clip
F	1 1/2" Mull Cover Strip
G	Goal Post Mull Anchor Plate
H	Mull Tape
I	Concrete/Masonry: 3/16" Concrete screw with minimum embedment of 1 1/4" into the structural framing (or as required by local code). Wood: #10 Wood screw with minimum embedment of 1 1/2" into the structural framing (or as required by local code).
J	3/8" Dust Plug
K	U-Clip Anchor 2 1/2" x 2 3/4"
	Silicone

IMPORTANT NOTES – READ FIRST!

- All mull covers covering weep holes must be notched to expose weep holes for proper drainage.
- 1" X 4" mulls **DO NOT** use the interior cover strip (F).
- For units other than Single-Hung, use 3/8" color-match, hole plugs in jambs to cap screw holes.
- The fixed window shown has an interior filler strip that must be removed and then re-installed after installing the sill fastener screw. **DO NOT** apply silicone over product labels. Remove labels as necessary.
- Vinyl frames and components must be clean and dry. If the components are dusty or dirty, remove by wiping with a clean, dry cloth.

1" ALUMINUM MULL BAR WITH T-CLIP ANCHOR (TYPICAL APPLICATION)

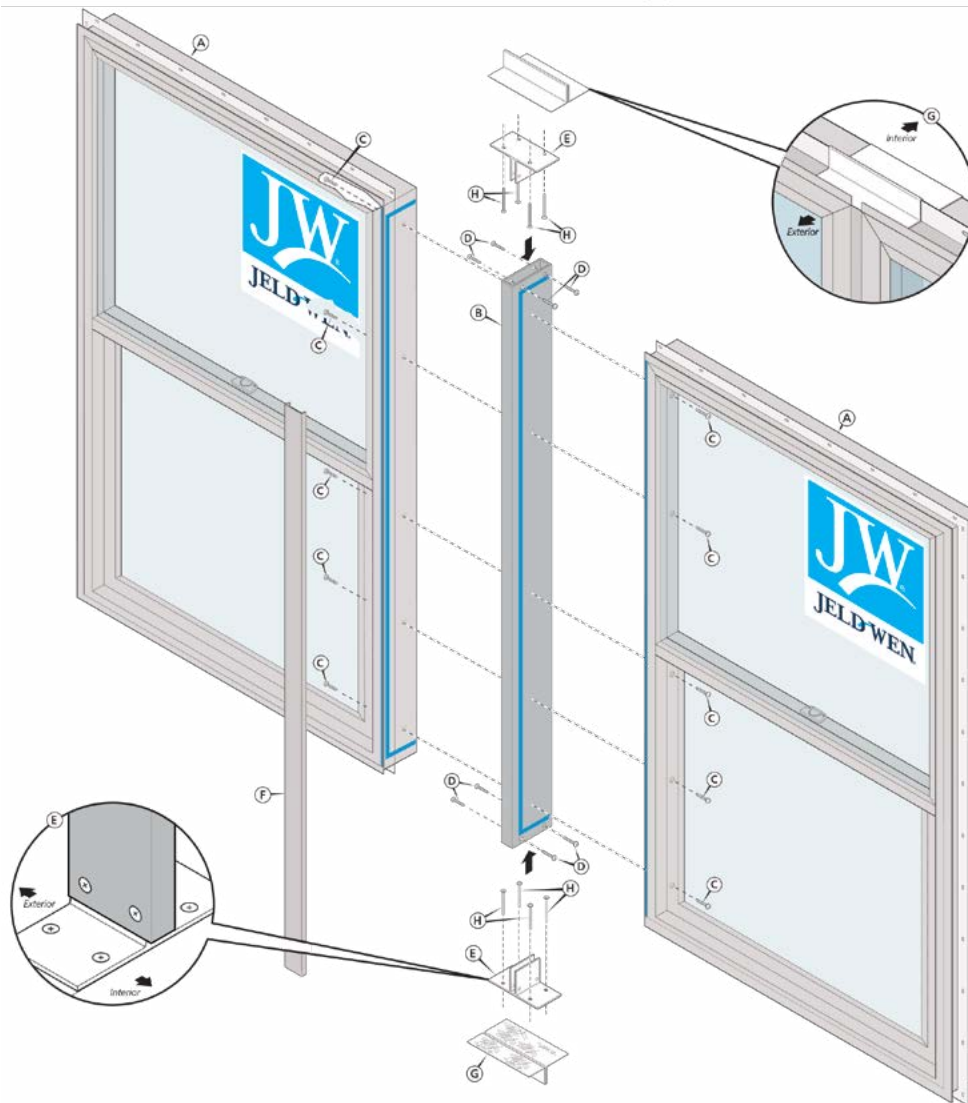

Item	Parts List
A	Premium Atlantic Vinyl/ Builders Vinyl Windows
B	1" x 3"/1" x 4" Aluminum Tube Mull Bar
C	#10 x 3/4" Phillips Pan-Head, Self-Tapping
D	#10 x 3/4" Phillips Flat-Head, Self-Tapping
E	T-Clip Aluminum Mull Anchor
F	1 1/2" Mull Cover Strip
G	Mull Tape
H	Concrete/Masonry: 3/16" Concrete screw with minimum embedment of 1 1/4" into the structural framing (or as required by local code). Wood: #10 Wood screw with minimum embedment of 1 1/2" into the structural framing (or as required by local code).
	Silicone

IMPORTANT NOTES – READ FIRST!

- All mull covers covering weep holes must be notched to expose weep holes for proper drainage.
- 1" X 4" mulls **DO NOT** use the interior cover strip (F).
- For units other than Single-Hung, use 3/8" color-match, hole plugs in jambs to cap screw holes.
- The longer mull strip cover is applied to the exterior and the shorter mull strip to the interior.
- **DO NOT** apply silicone over product labels. Remove labels as necessary.
- Vinyl frames and components must be clean and dry. If the components are dusty or dirty, remove by wiping with a clean, dry cloth.

1" X ALUMINUM MULL BAR WITH T-CLIP ANCHOR (TYPICAL APPLICATION)

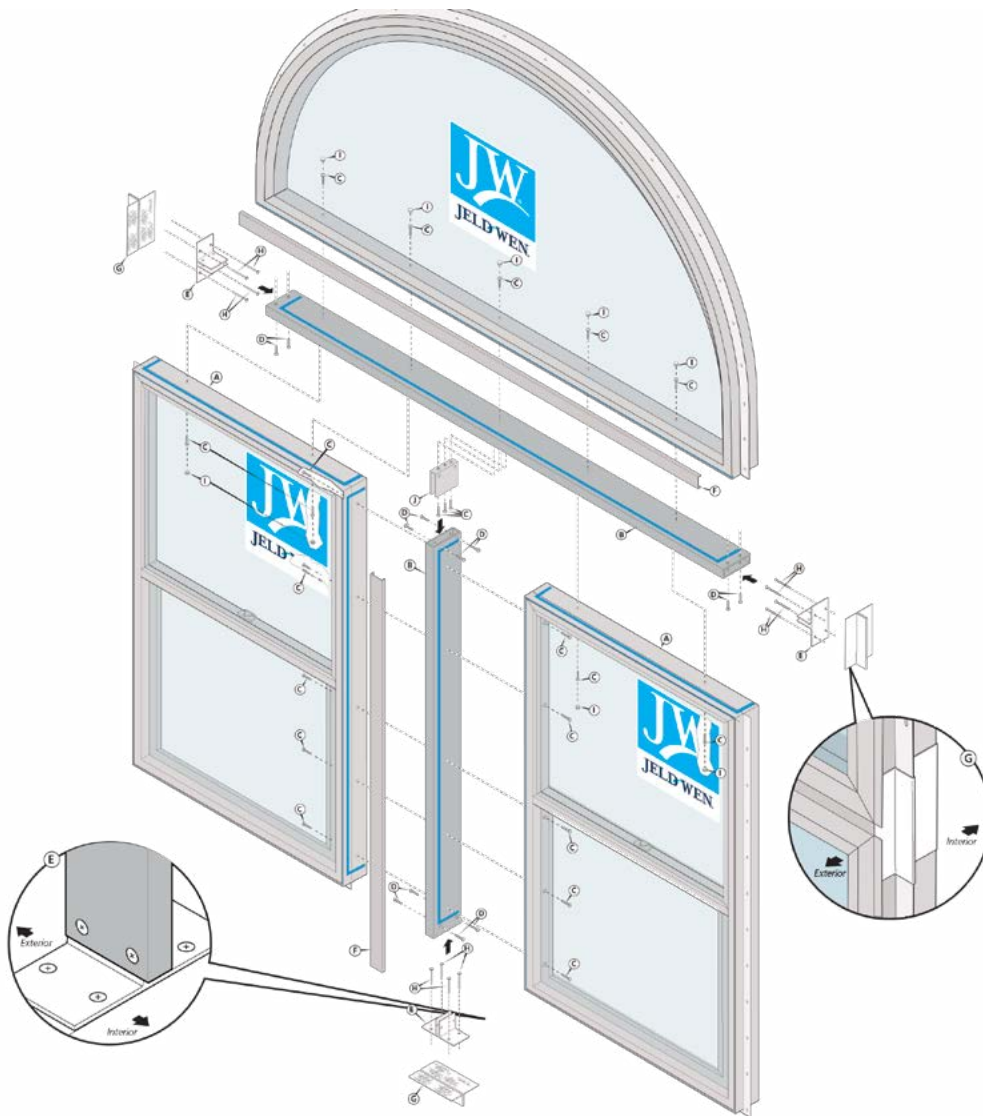

Item	Parts List
A	Premium Atlantic Vinyl/ Builders Vinyl Windows
B	1" x 3" or 1" x 4" Aluminum Tube Mull Bar
C	#10 x 3/4" Phillips Pan-Head, Self-Tapping
D	#10 x 3/4" Phillips Flat-Head, Self-Tapping
E	T-Clip Aluminum Mull Anchor
F	1 1/2" Mull Cover Strip
G	Mull Tape
H	Concrete/Masonry: 3/16" Concrete screw with minimum embedment of 1 1/4" into the structural framing (or as required by local code). Wood: #10 Wood screw with minimum embedment of 1 1/2" into the structural framing (or as required by local code).
I	3/8" Dust Plug
J	U-Clip Anchor 2 1/2" x 3 3/4"
	Silicone

IMPORTANT NOTES – READ FIRST!

- All mull covers covering weep holes must be notched to expose weep holes for proper drainage.
- 1" X 4" mulls do not use the interior cover strip (F).
- For units other than Single-Hung, use 3/8" color-match, hole plugs in jambs to cap screw holes.
- The fixed window shown has an interior filler strip that must be removed and then re-installed after installing the sill fastener screws.
- The longer mull strip cover is applied to the exterior and the shorter mull strip to the interior.
- **DO NOT** apply silicone over product labels. Remove labels as necessary.
- Vinyl frames and components must be clean and dry. If the components are dusty or dirty, remove by wiping with a clean, dry cloth.

**Please visit jeld-wen.com for warranty
and care and maintenance information.**

Thank you for choosing

