

Patent Pending

Curl Stop[®]
anti-curling rug system



Before



After

INSTALLATION

Step 1.



First, reverse roll curled area then immediately unroll and pull back to expose the bottom of the rug corner.

Step 2.

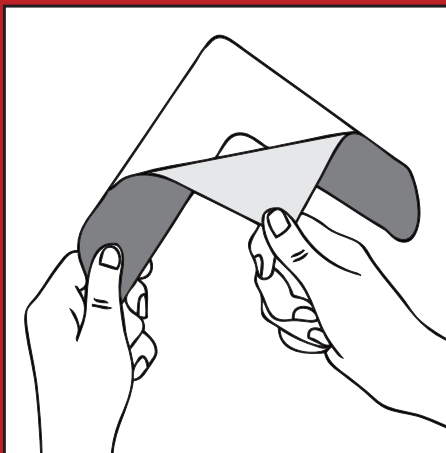

Carefully remove paper backing from a curl stop corner without touching adhesive.

Step 3.

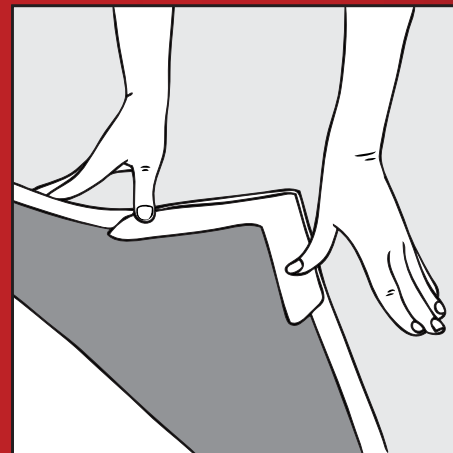

Firmly press curl stop to the problem corner of the rug. When properly installed curl stop is not visible under the rug corner when the rug is laid flat.