

VANITY TABLE

**918S-W, 918S-B, 918S-W-L, 918S-B-L,
918S-W-LS, 918S-B-LS
INSTALLATION MANUAL**

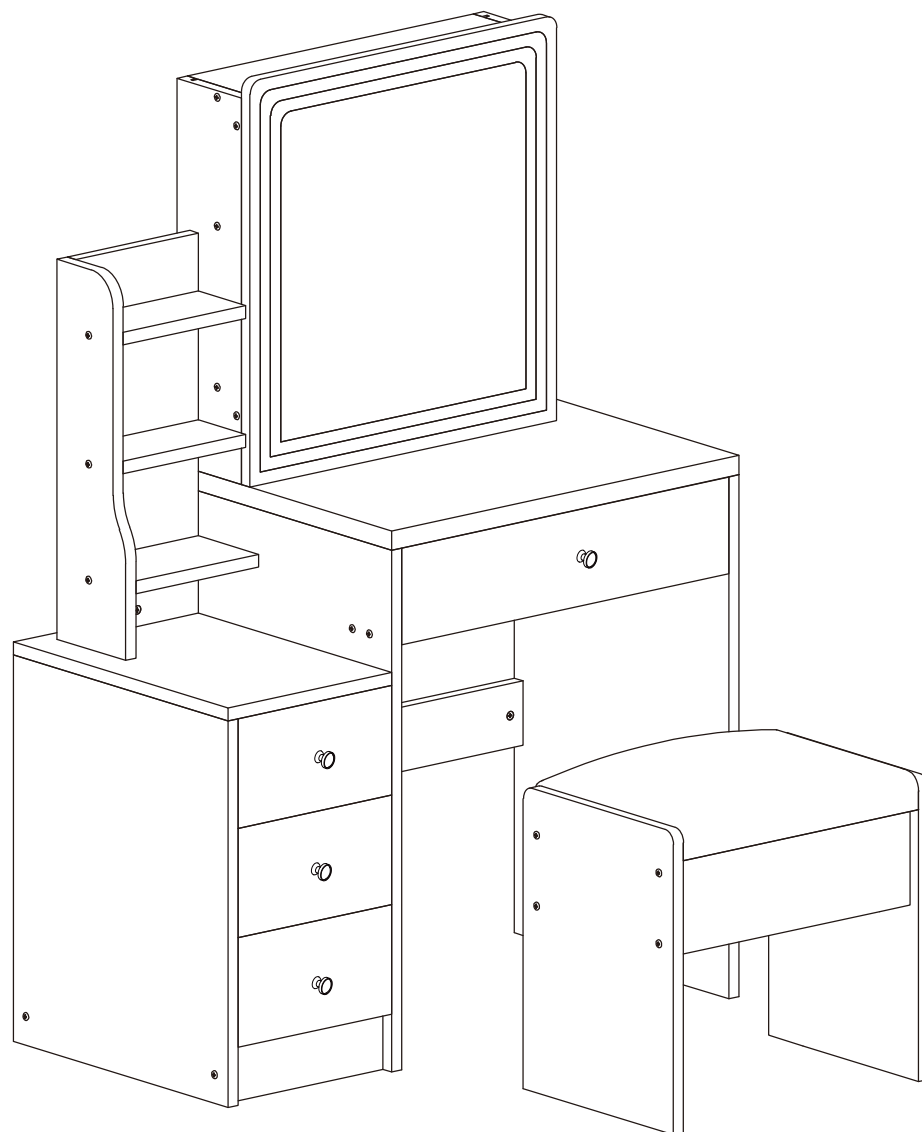

918 is the model name, S is small size, W is white, B is black, L represents with mirror light, S represents with built-in socket and hair dryer holder. If your product model is 918S-W, 918S-B, then the product does not come with a mirror light, built-in socket, and hair dryer stand. If your product is 918S-W-L or 918S-B-L, it does not come with a built-in socket and hair dryer stand.

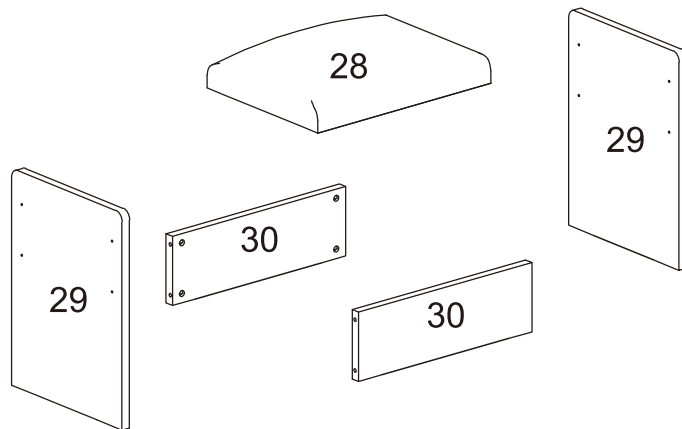
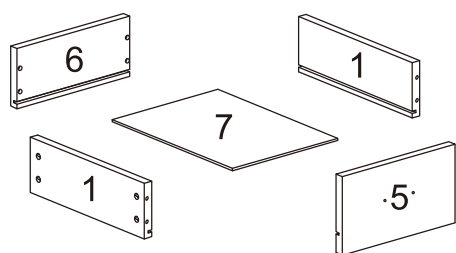
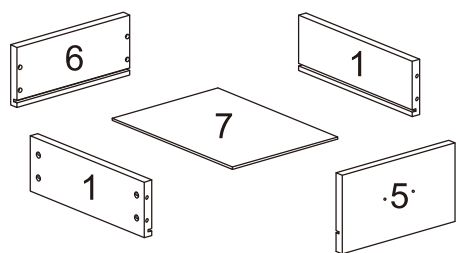
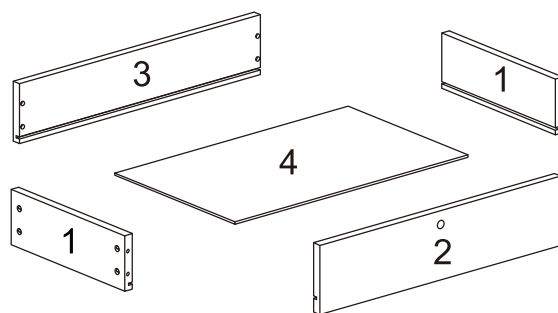
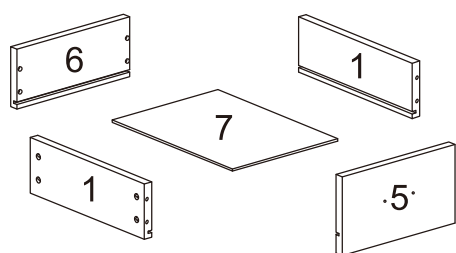
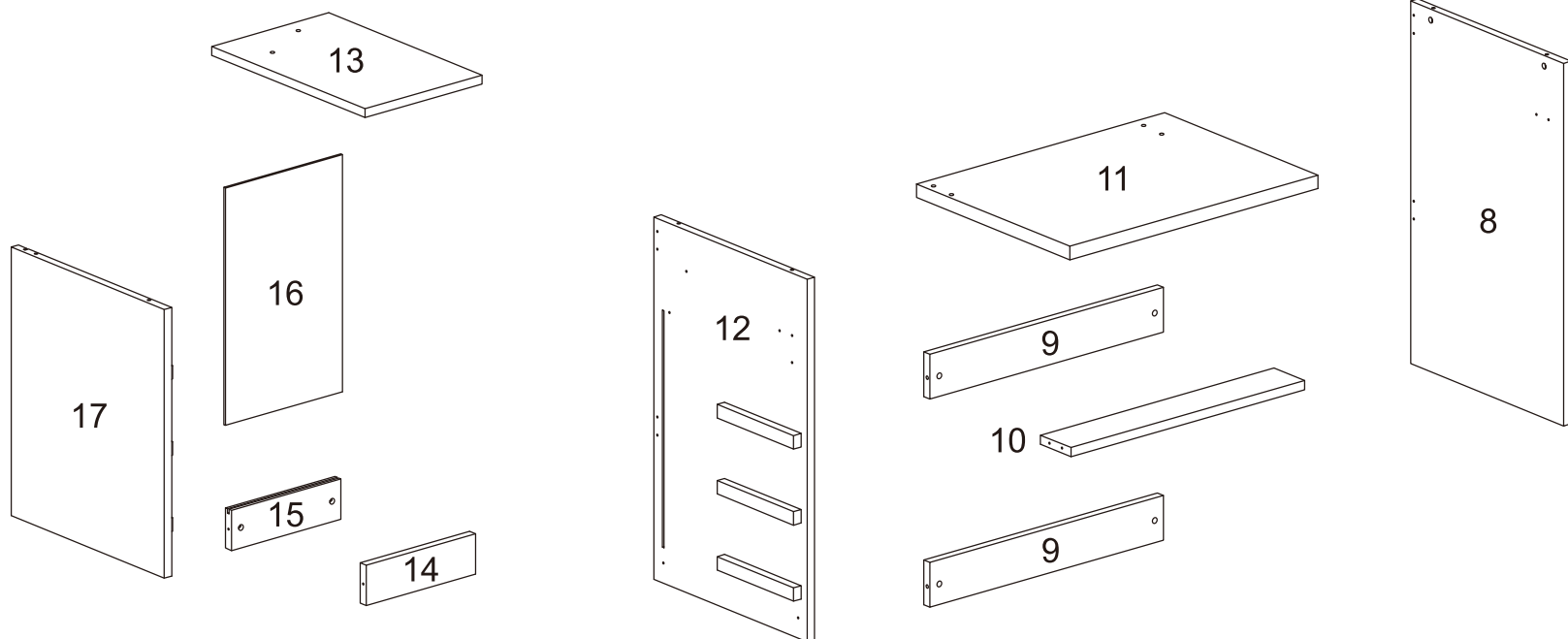
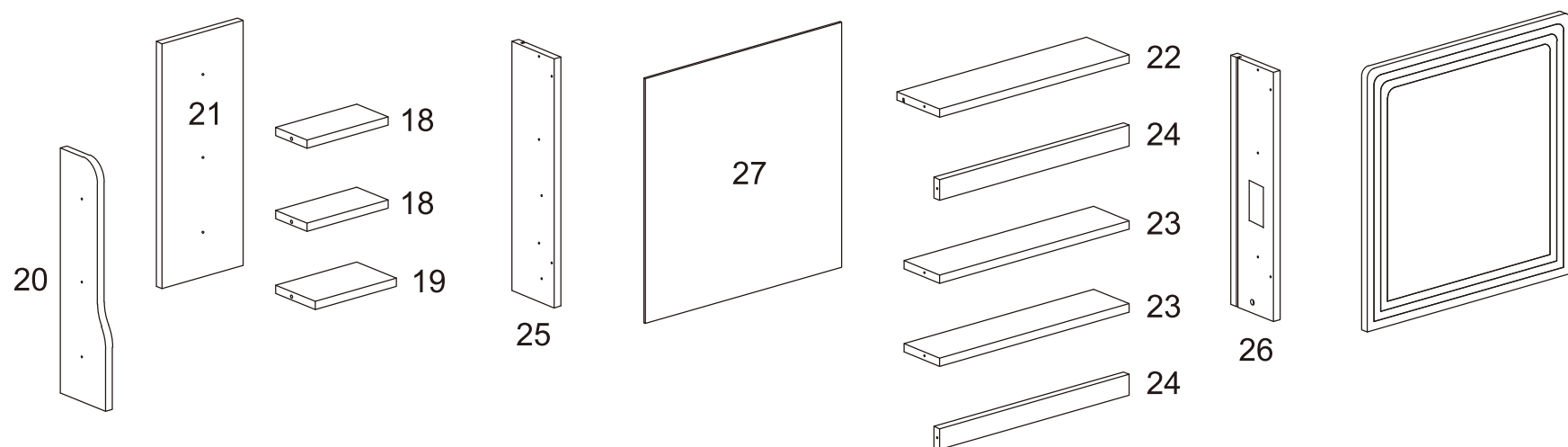

1 - x8	16 - x1
2 - x1	17 - x1
3 - x1	18 - x2
4 - x1	19 - x1
5 - x3	20 - x1
6 - x3	21 - x1
7 - x3	22 - x1
8 - x1	23 - x2
9 - x2	24 - x2
10 - x1	25 - x1
11 - x1	26 - x1
12 - x1	27 - x1
13 - x1	28 - x1
14 - x1	29 - x2
15 - x1	30 - x2

Before installation, please find a marker pen with erasable marks, distinguish each accessory based on the shape of the board and the position of the holes, and then write the corresponding number on the board.



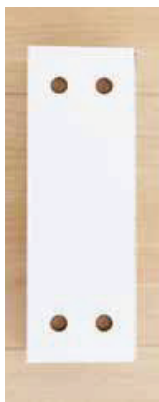

1 -x8

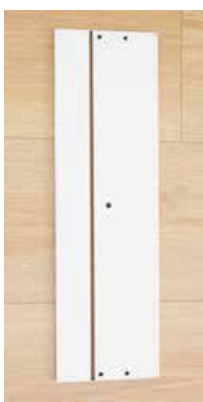

2 -x1



3 -x1

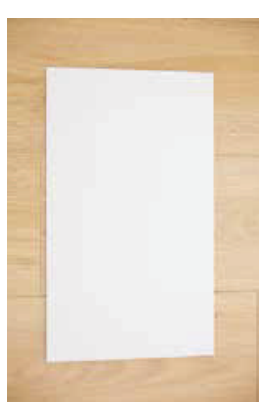

4 -x1



5 -x3



6 -x3



7 -x3

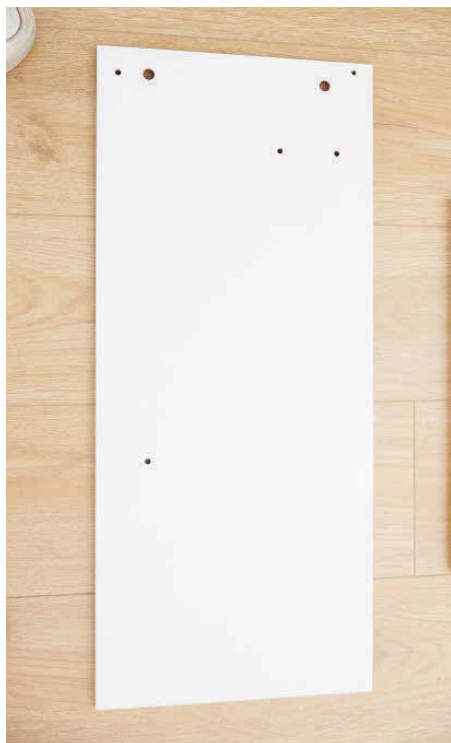

8 -x1

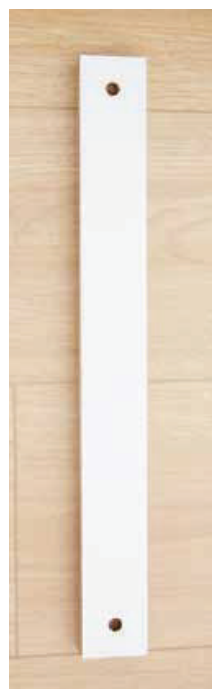

9 -x2



10 -x1



11 -x1



12 -x1



13 -x1



14 -x1



15 -x1



16 -x1



17 -x1



18 -x2



19 -x1



20 -x1



21 -x1



22 -x1



23 -x2



24 -x2



25 -x1



for 918S-LS



for 918S and 918S-L

or

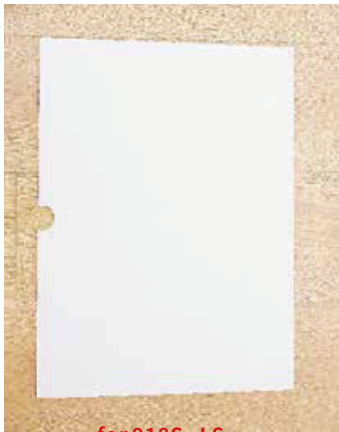

for 918S-LS

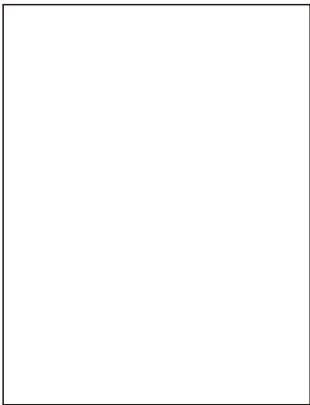

for 918S and 918S-L

or



26 -x1

27 -x1

28 -x1

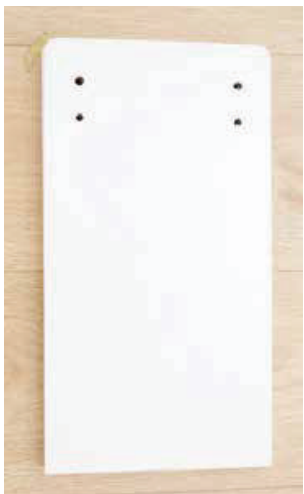

29 -x2



30 -x2



31 -x1

HARDWARE



A	SCREW & PLASTIC LOCK	x 46
---	-------------------------	------



B	SCREW & METAL LOCK	x 46
---	-----------------------	------



C	SCREW	x8
---	-------	----



D	SCREW	x16
---	-------	-----



E	HANDLE	x4
---	--------	----



G	L PLATE	x2
---	---------	----



J	RAIL	x2
---	------	----



K	SOCKET	x1
---	--------	----

Only for LS



L	HAIR DRYER BRACKET	x1
---	-----------------------	----

Only for LS

1. Screw installation method

When the screw is installed, please keep it in line with the board, and do not tighten it too tightly

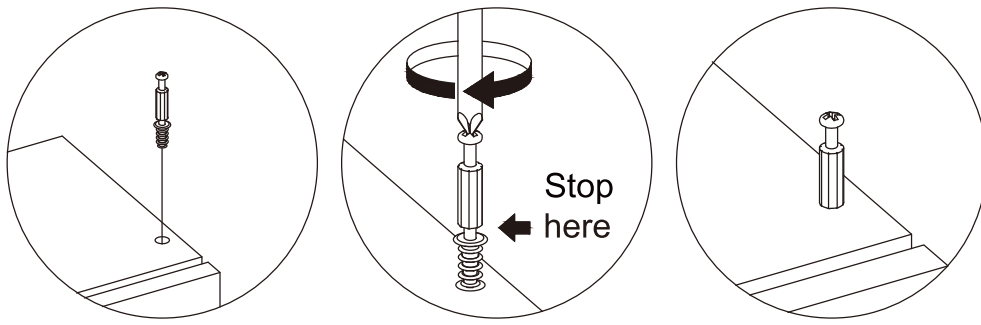

2. Check the Nut direction

This direction of the marked nut is consistent with the direction in which the screw is inserted

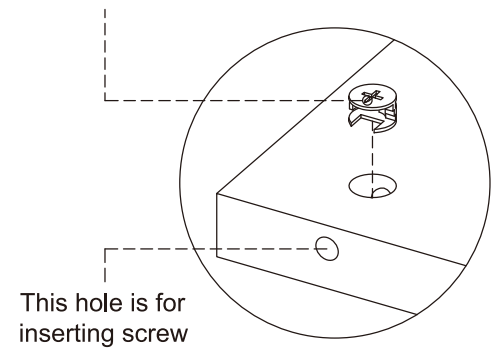

3. Installation on the board with fixing screws

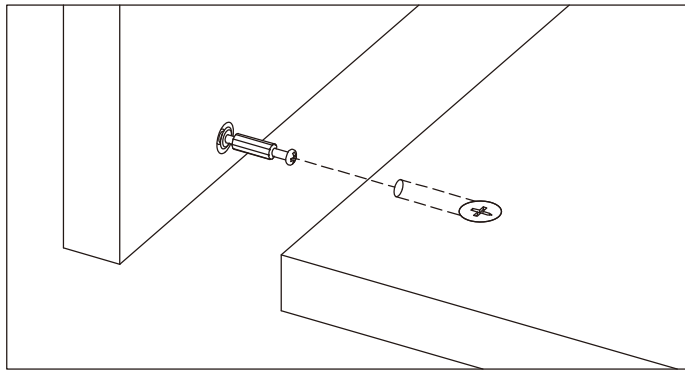

3. Rotate slowly until it stops

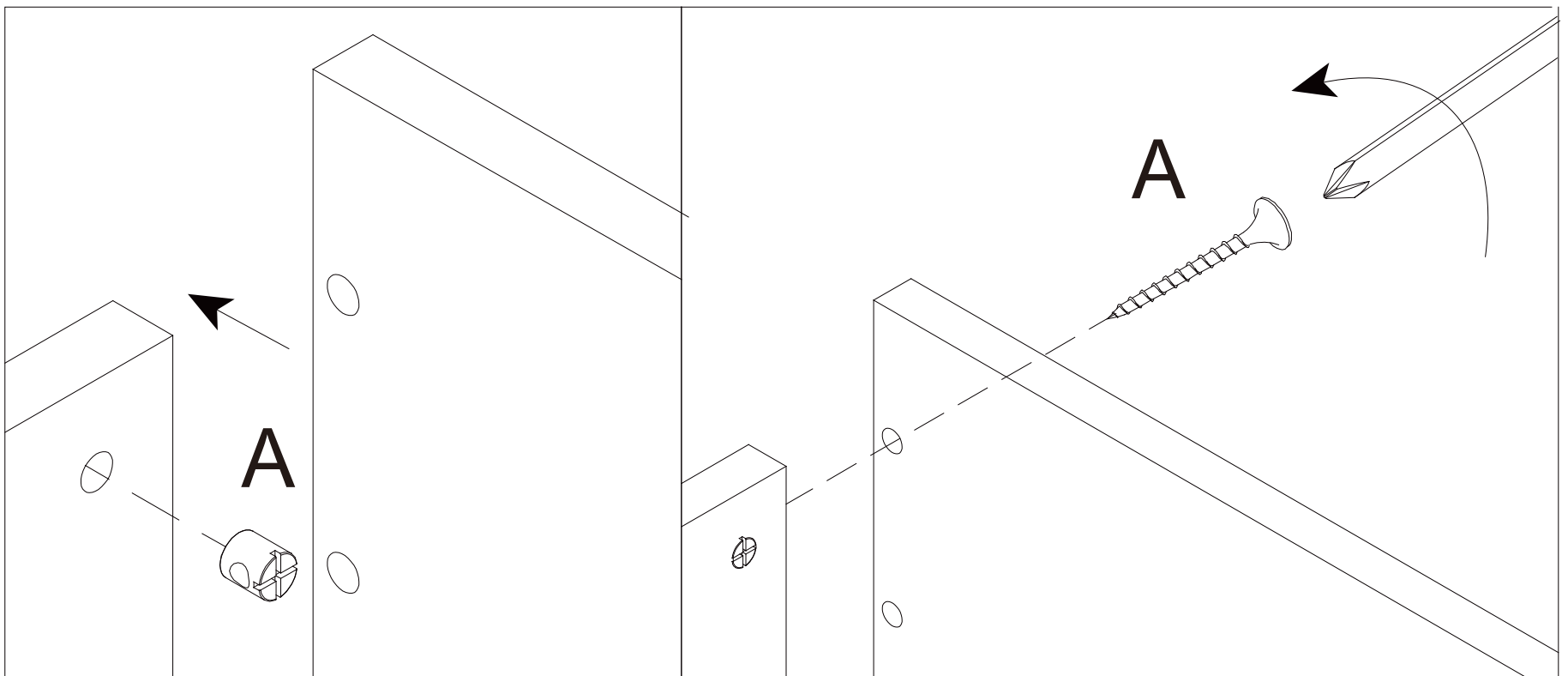
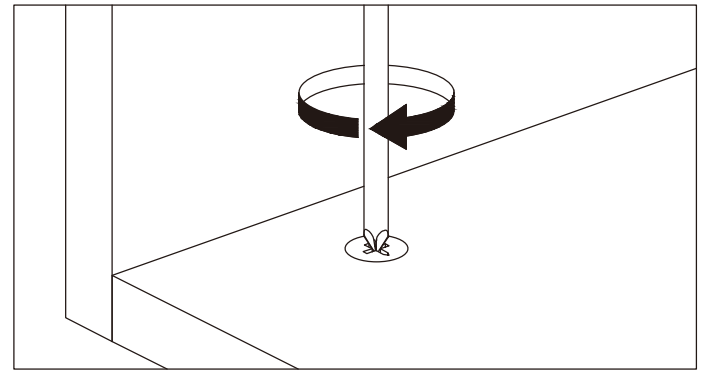

Step 01 pick up①x2,②x1,③x1,④x1

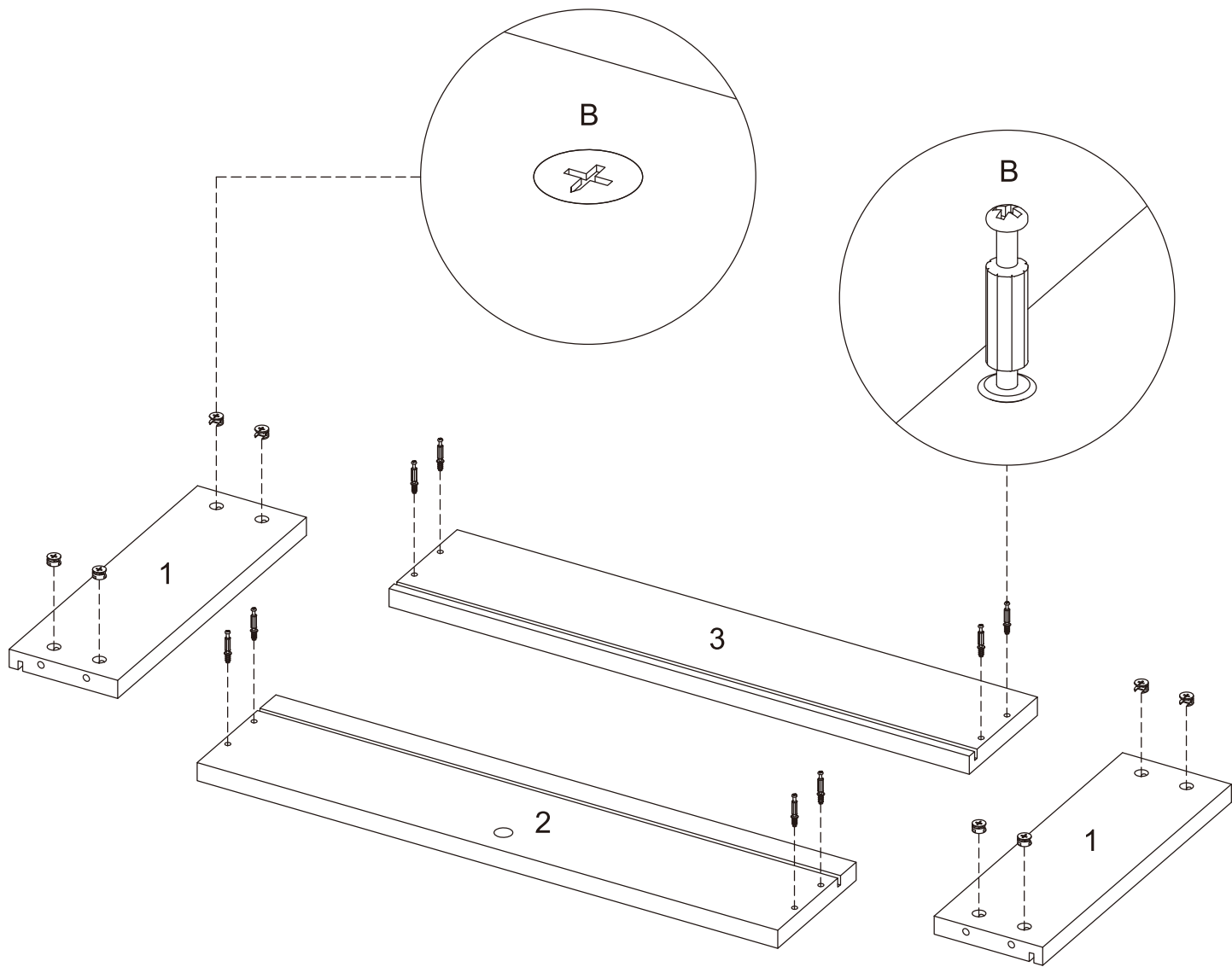

Step 02

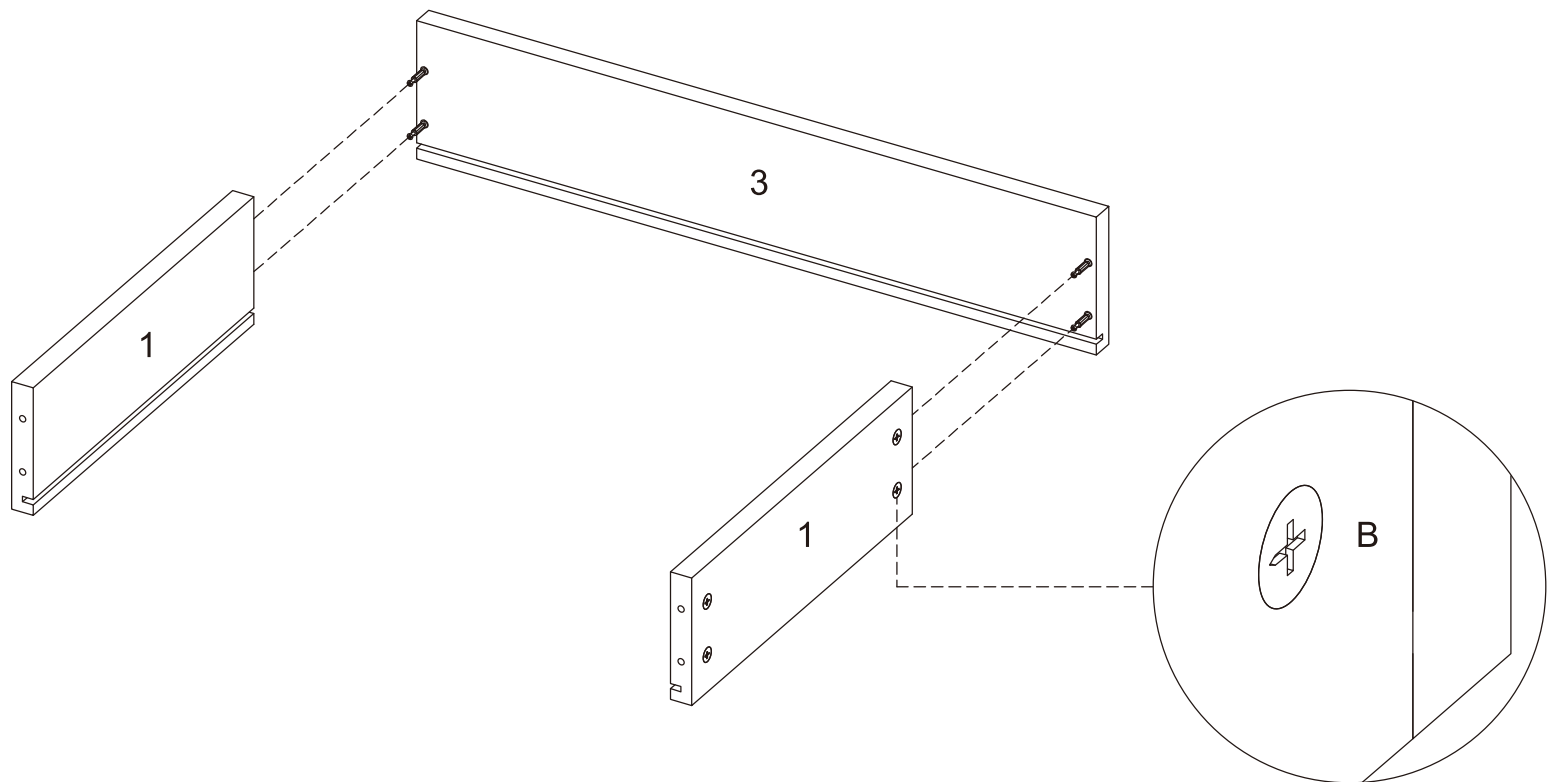

Step 03

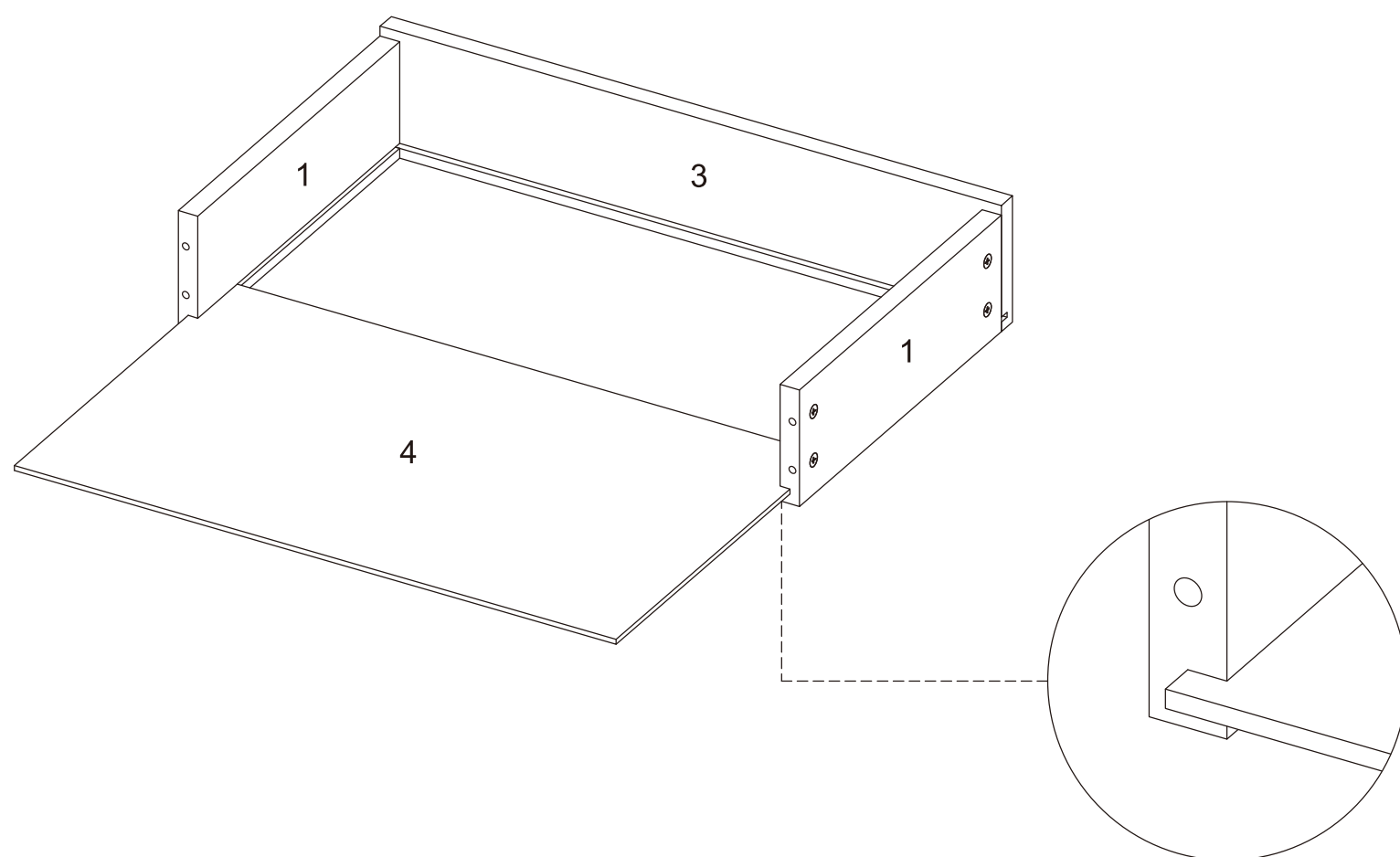

Step 04

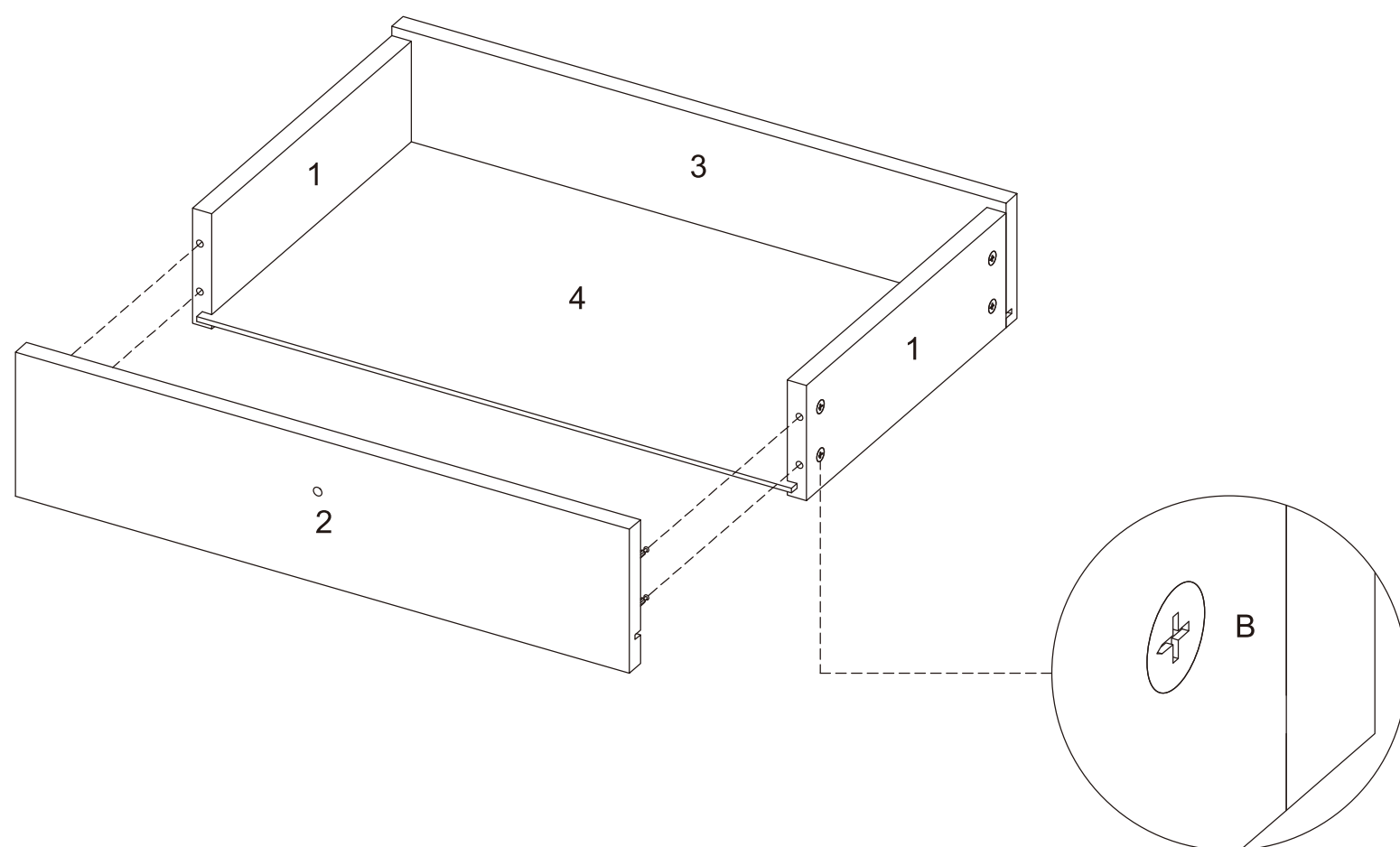

Step 05

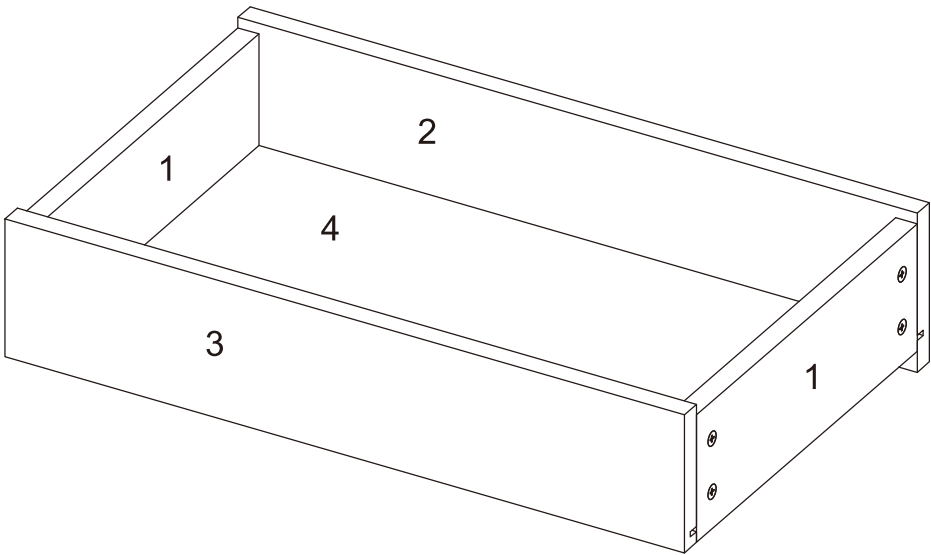

Step 06

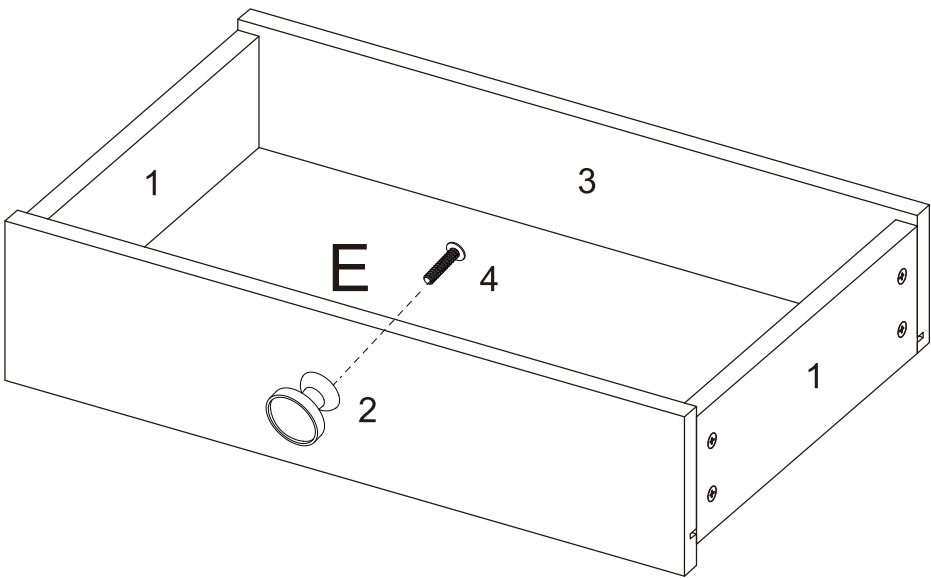

Step 07

pick up ①x6, ⑤x3, ⑥x3, ⑦x3

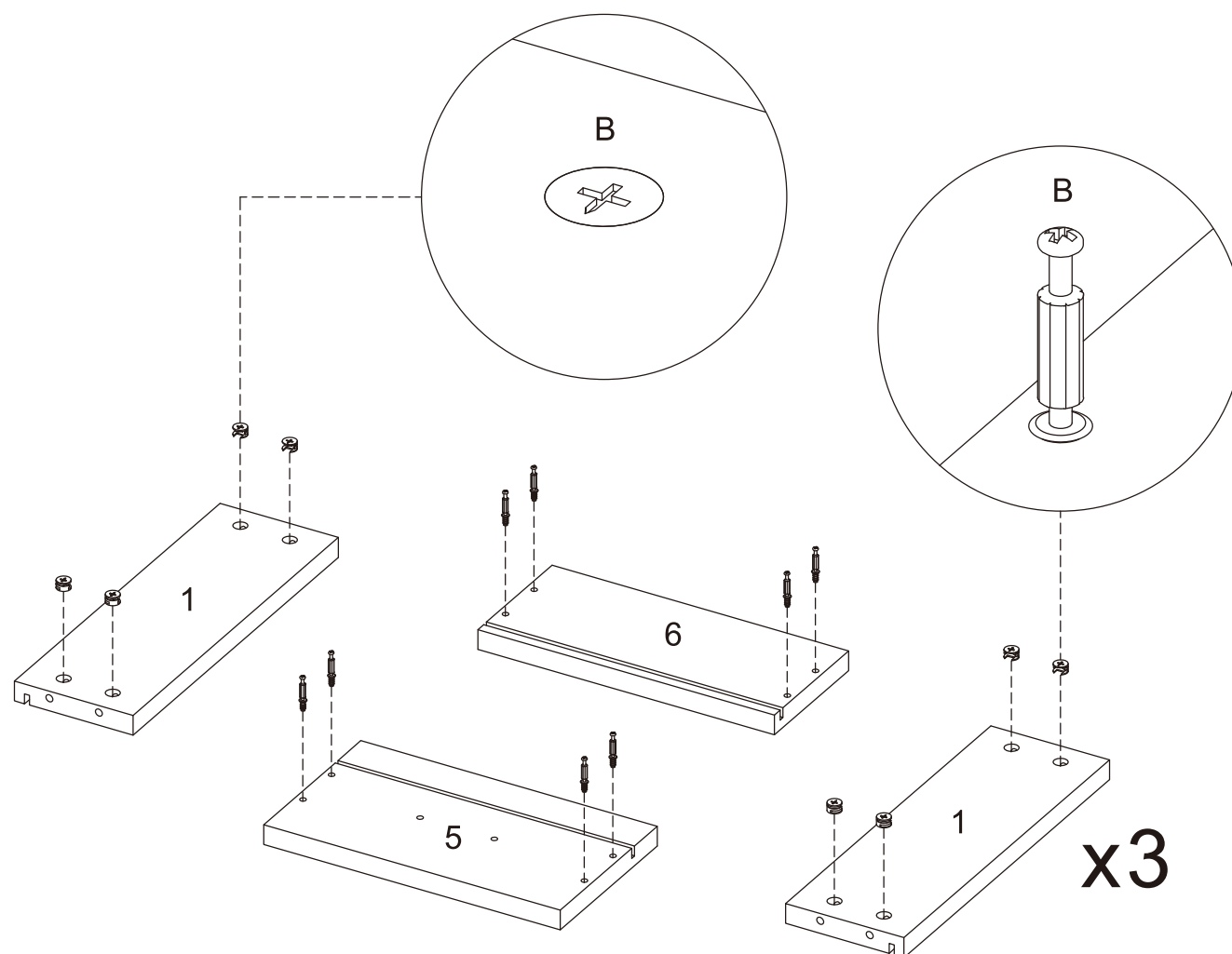

Step 08

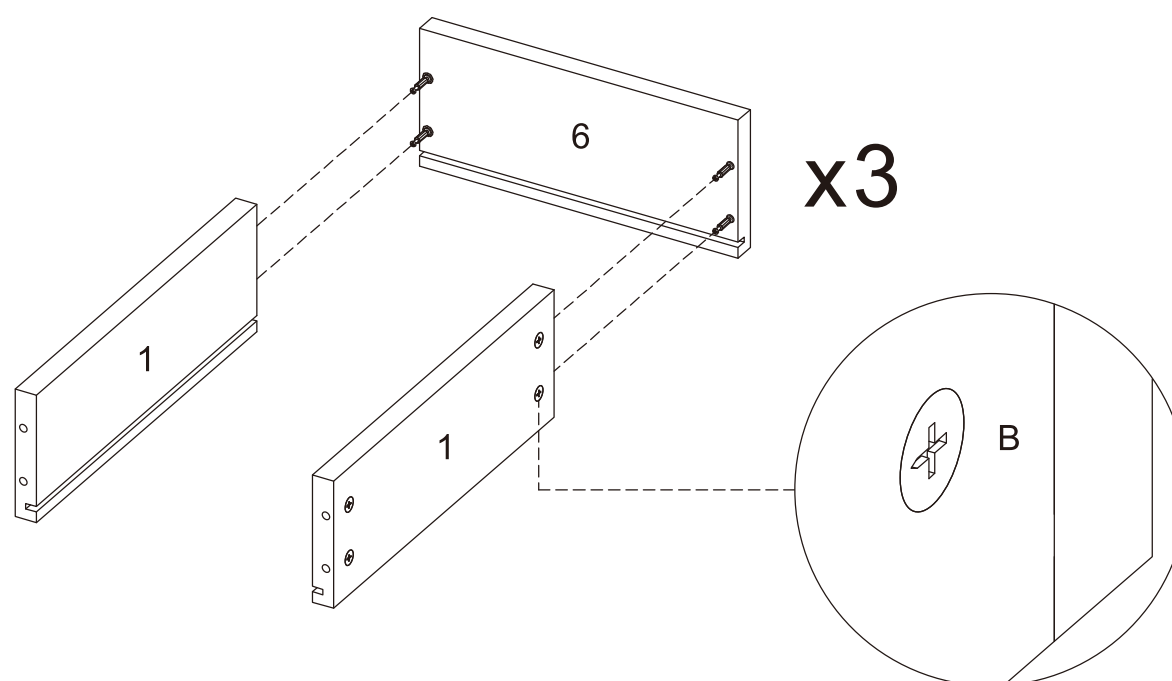

Step 09

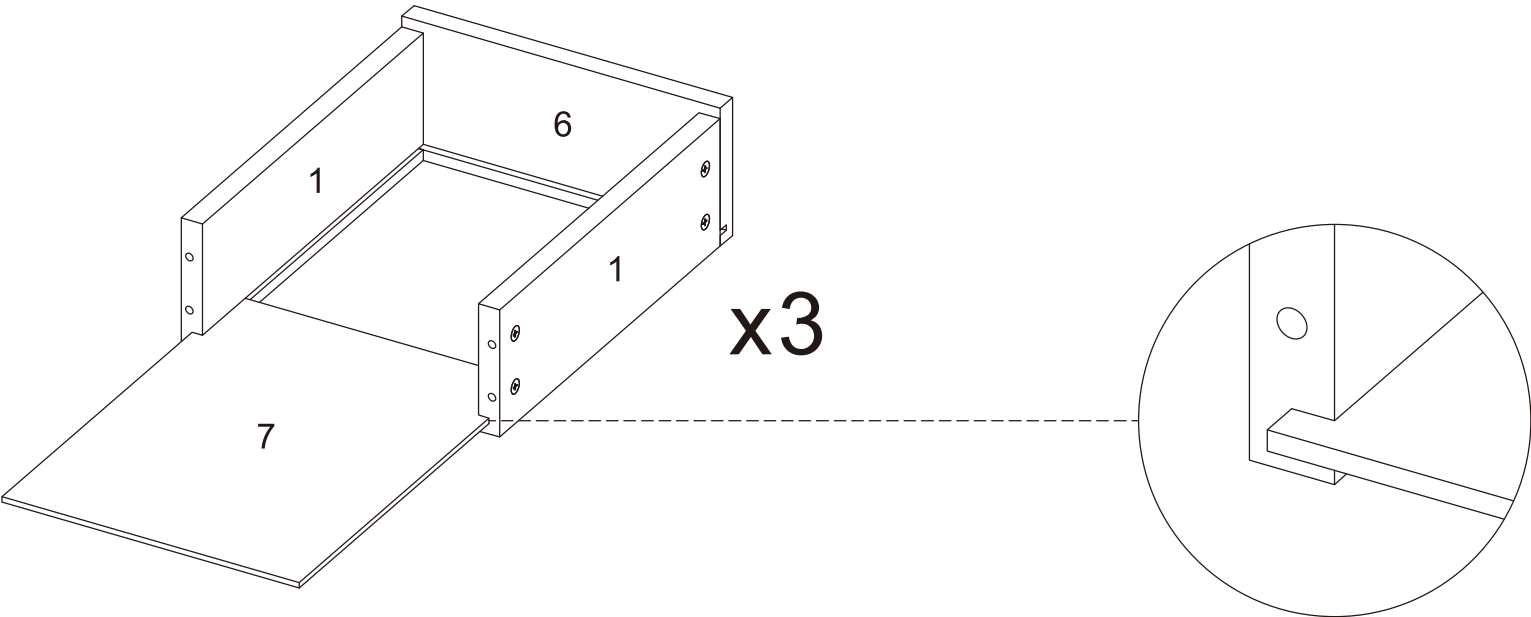

Step 10

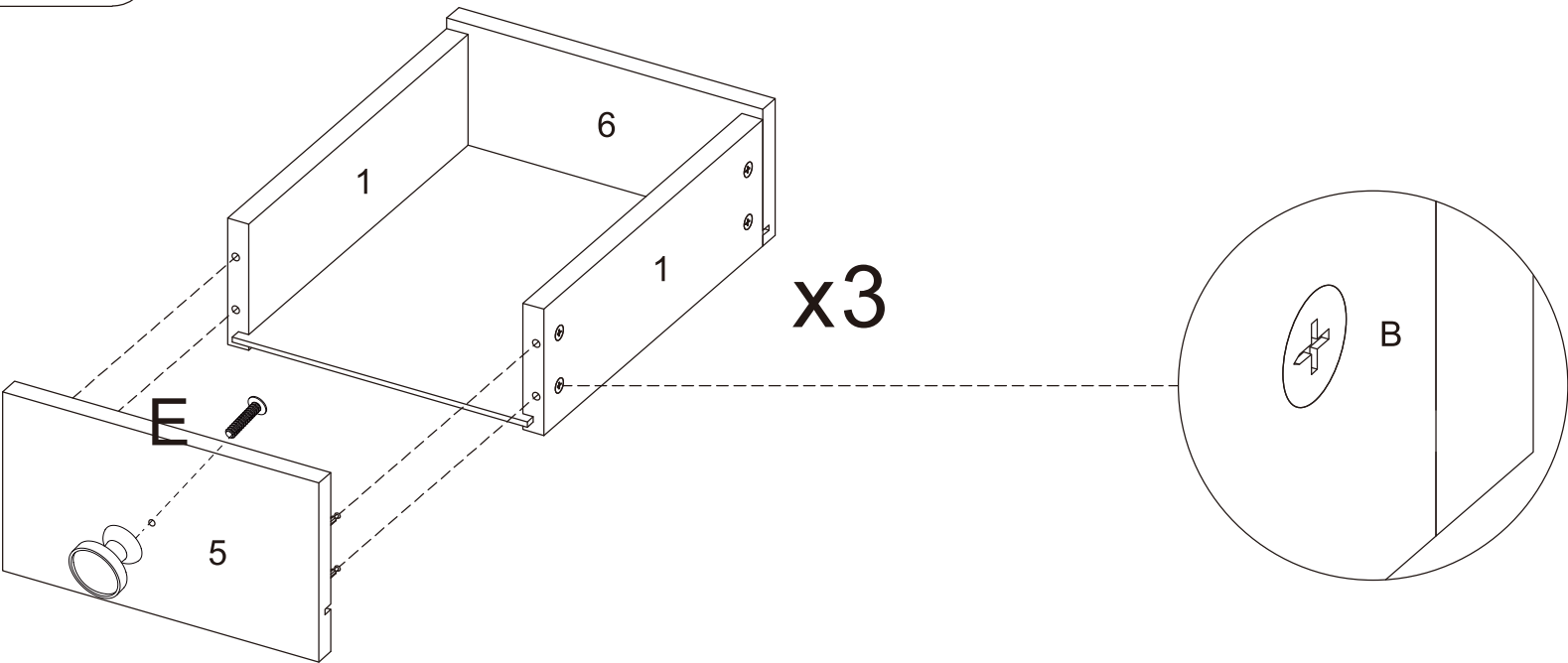

Step 11

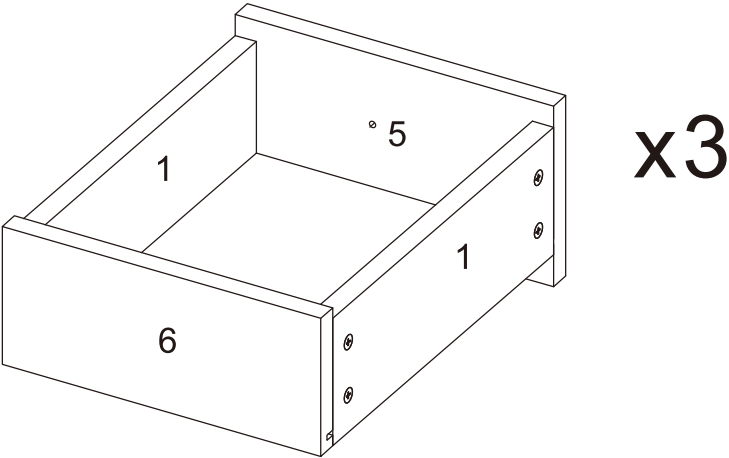

Step 12 pick up ⑧x1, ⑨x2, ⑩ x1, ⑫ x1, ⑪ x1

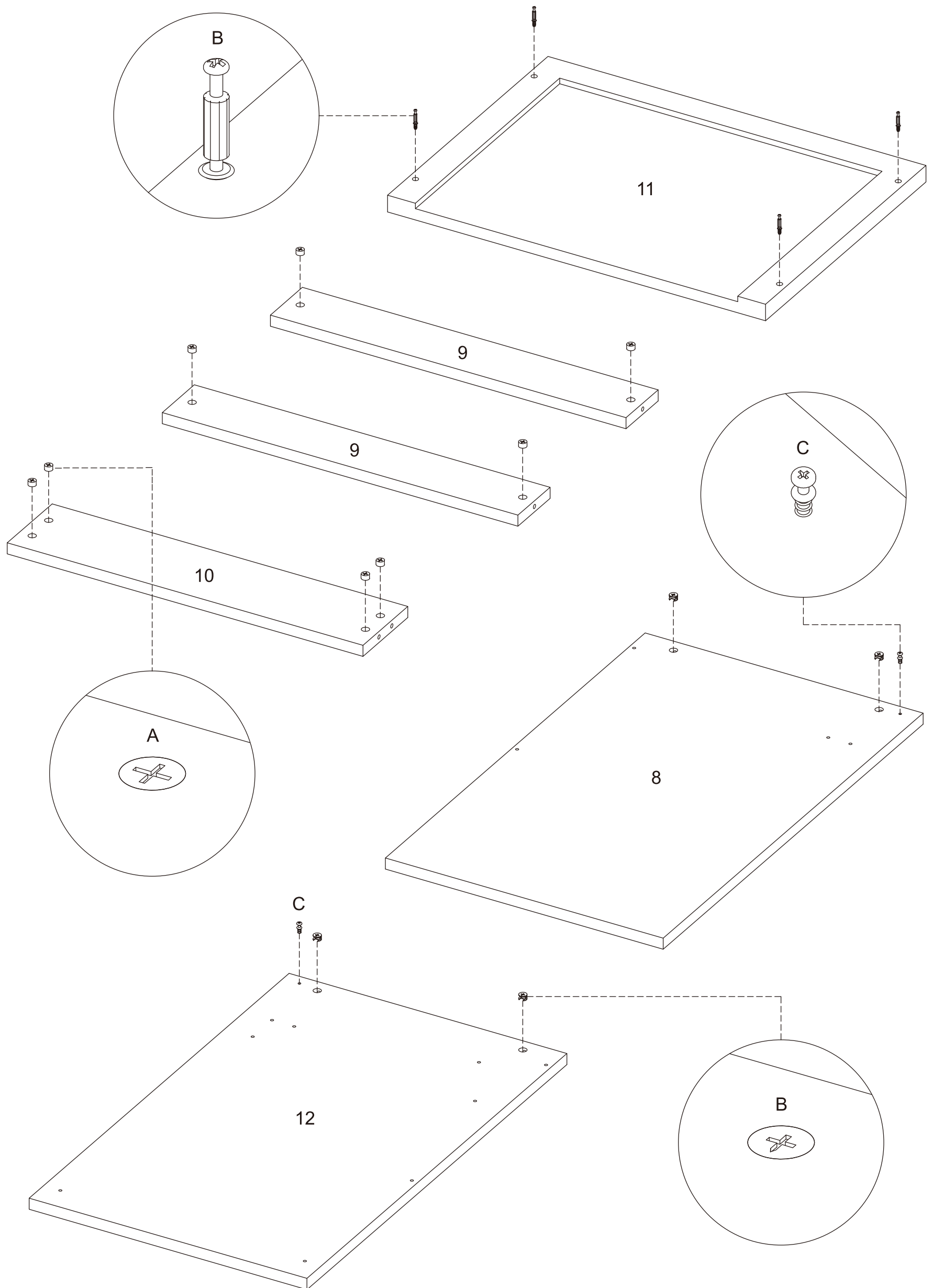

Step 13

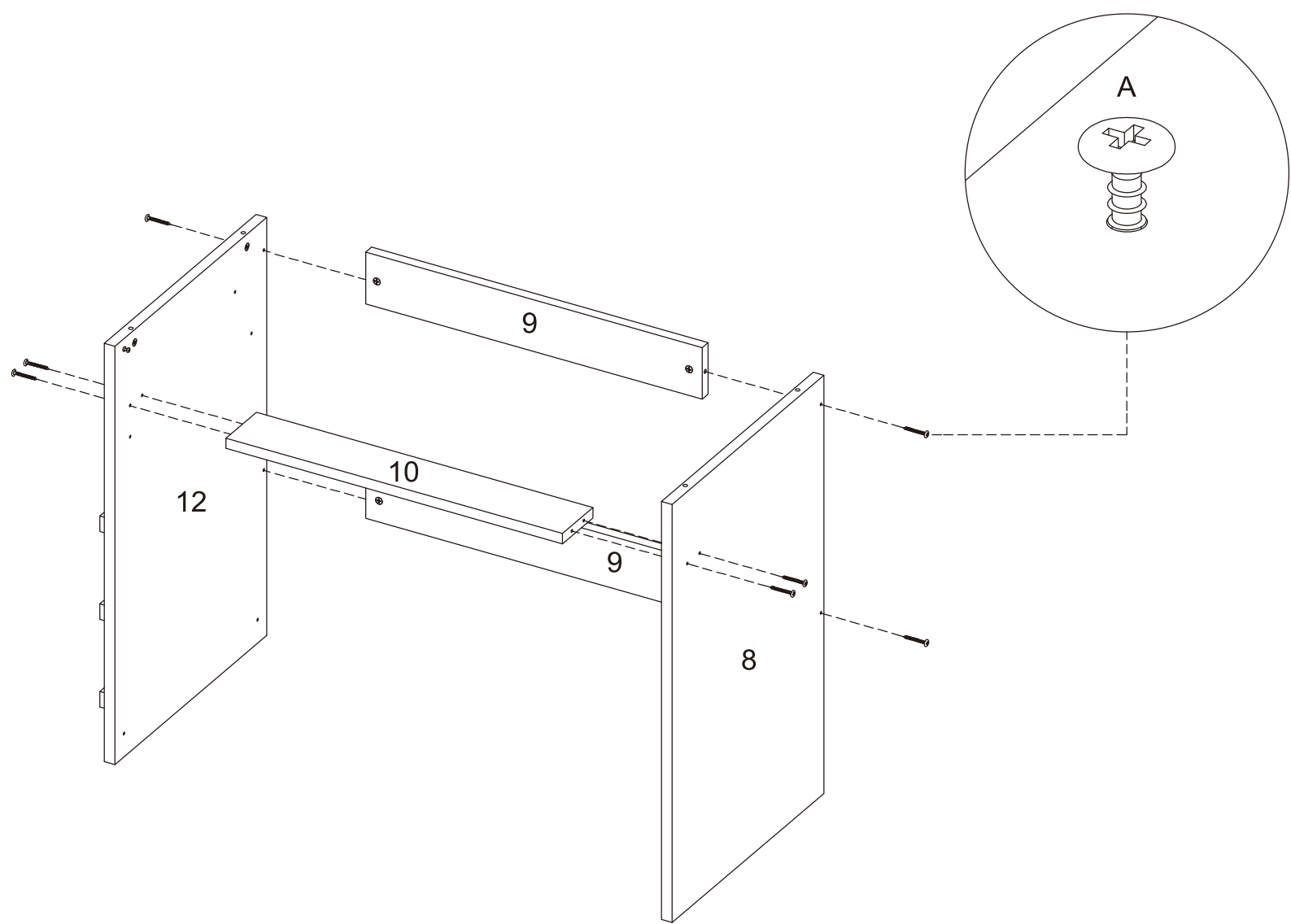

Step 14

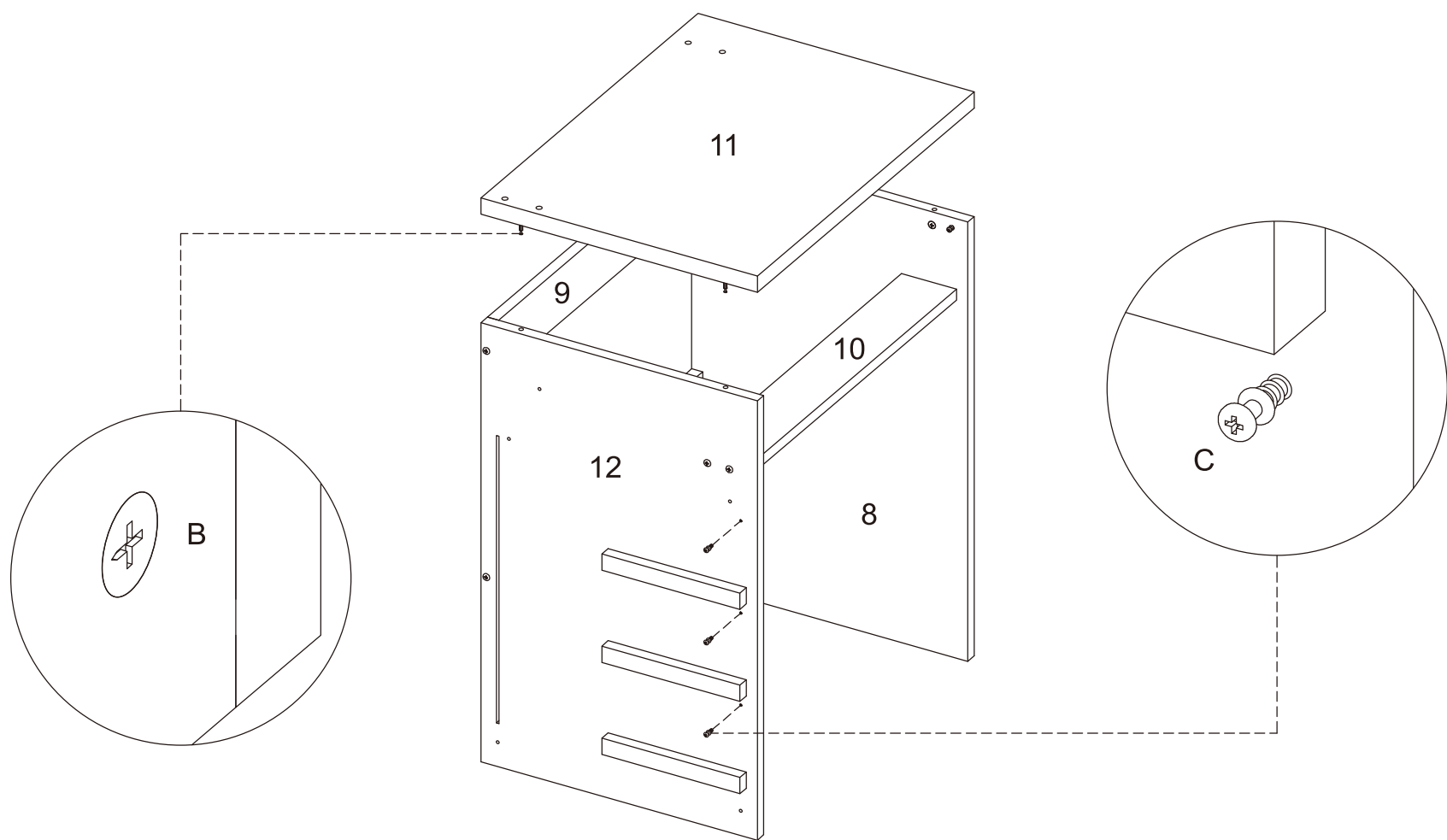

Step 15 pick up (13) x1, (14) x1, (15) x1, (16) x1, (17) x1

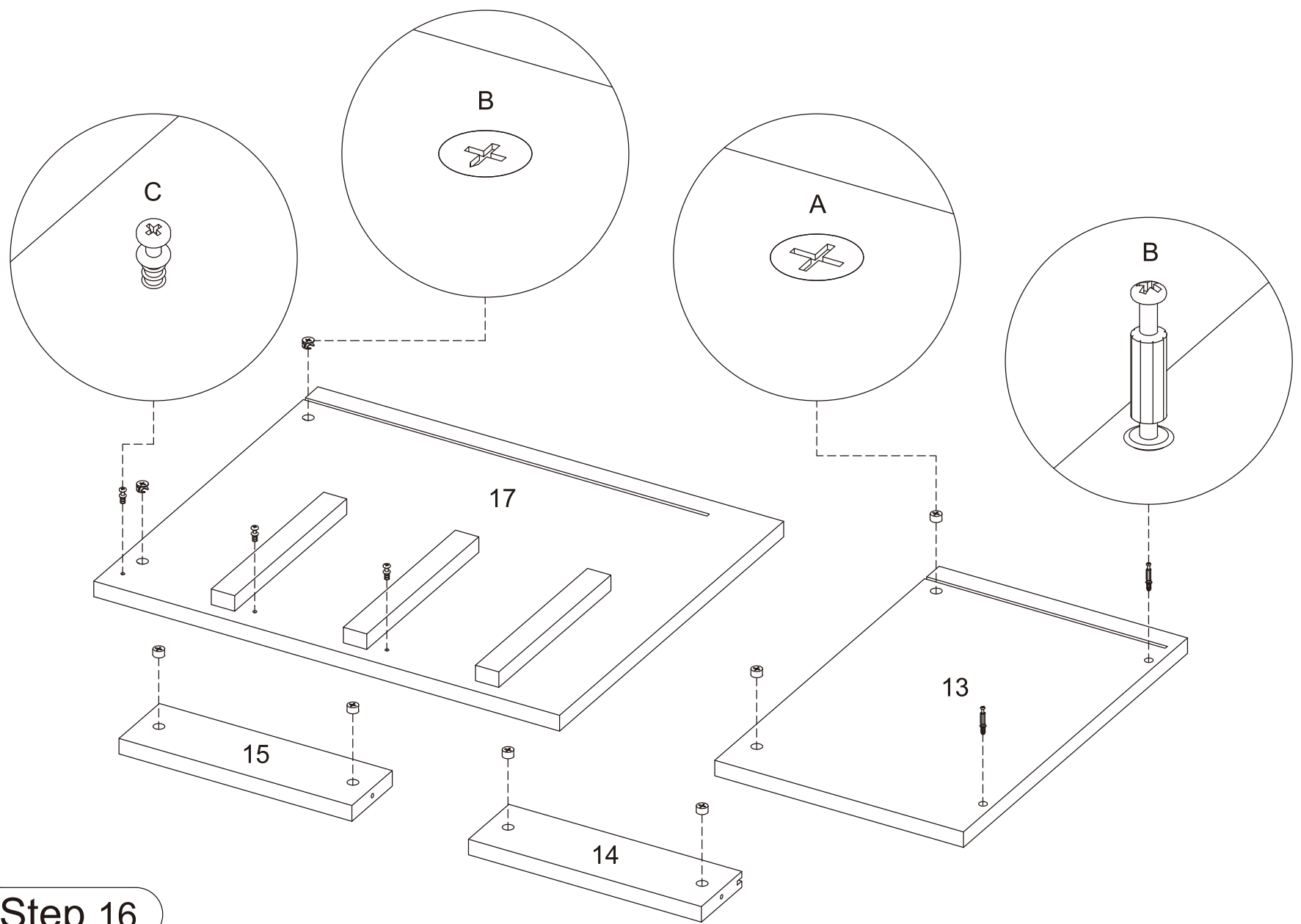

Step 16

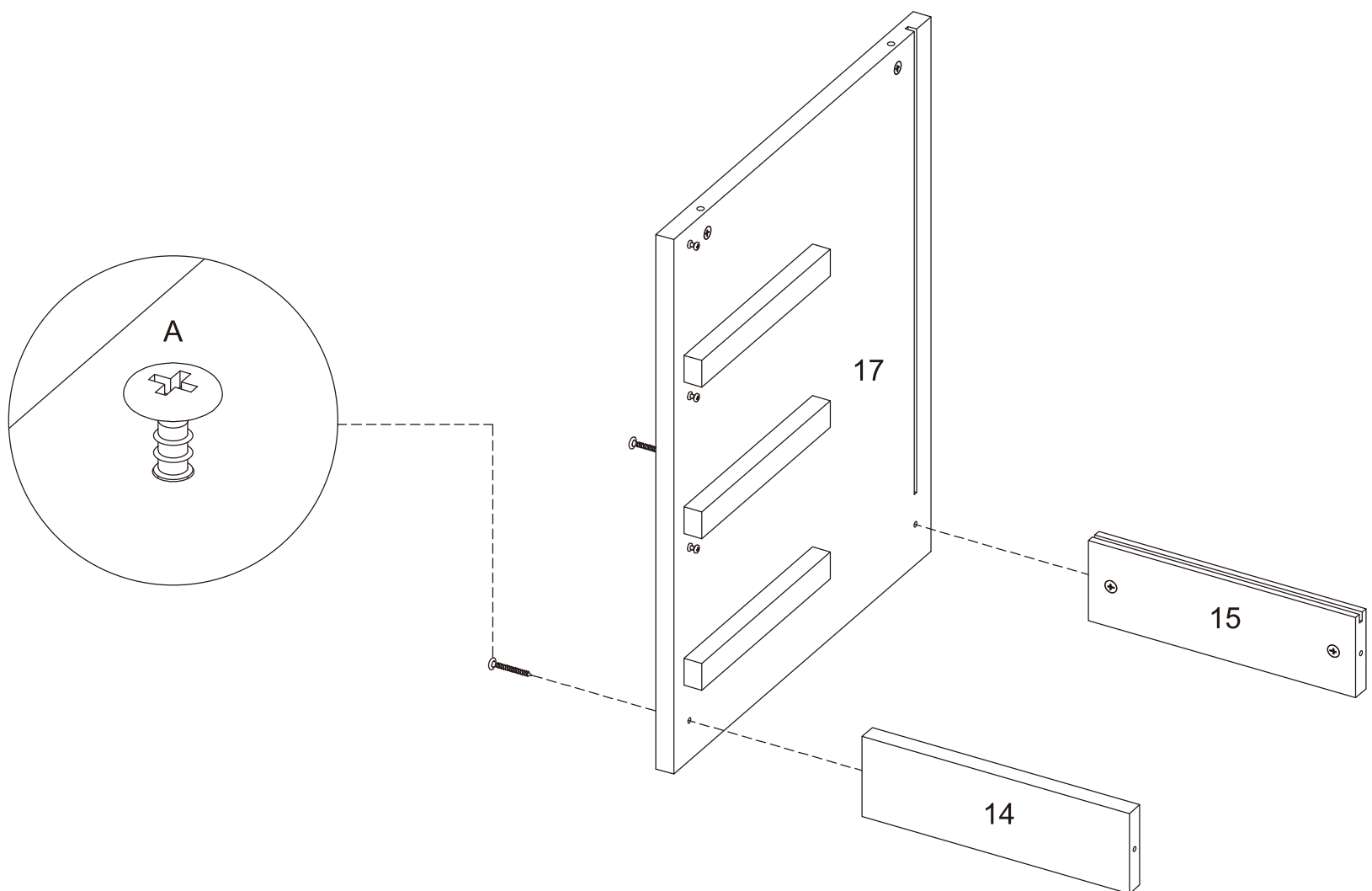

Step 17

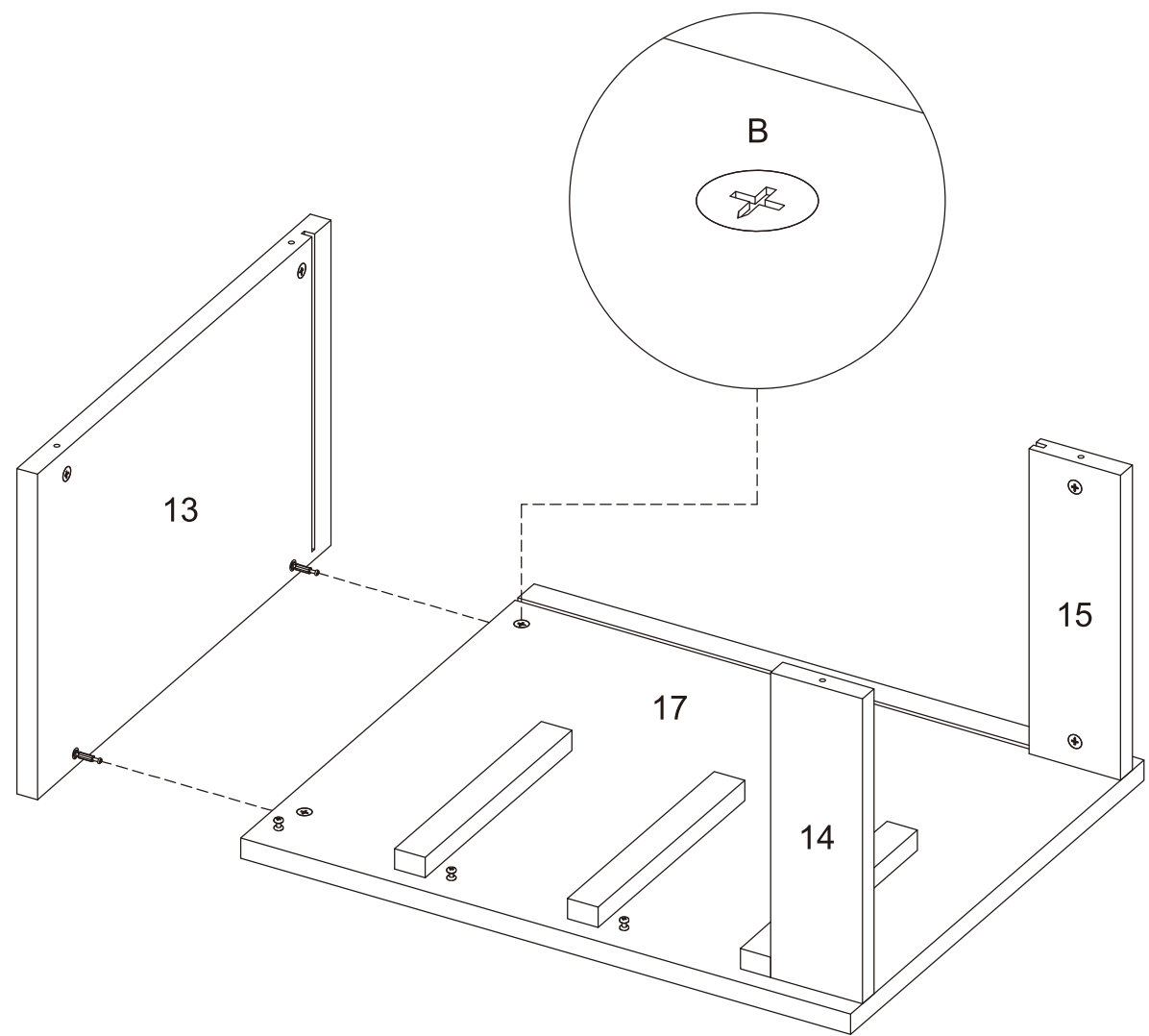

Step 18

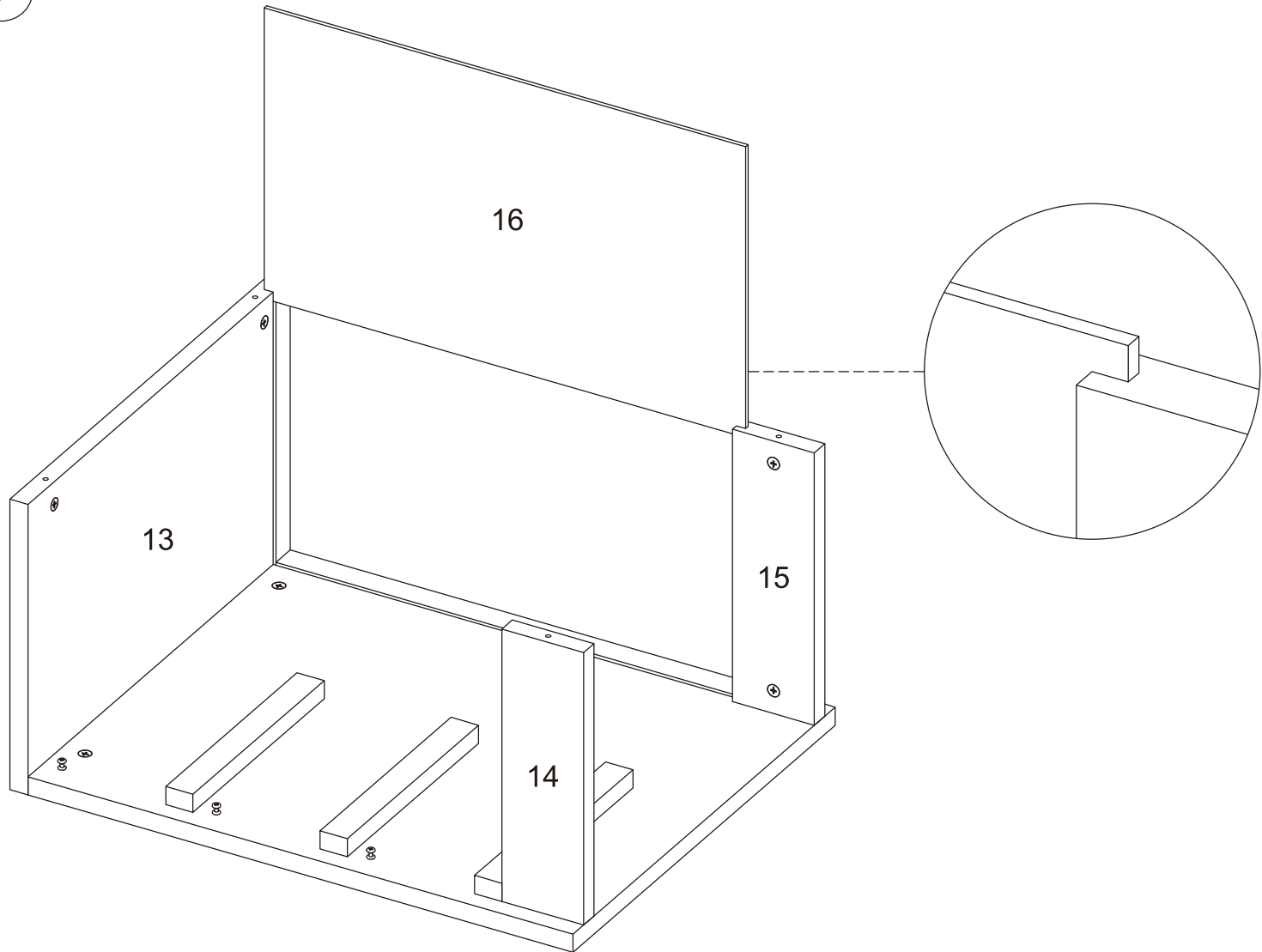

Step 19

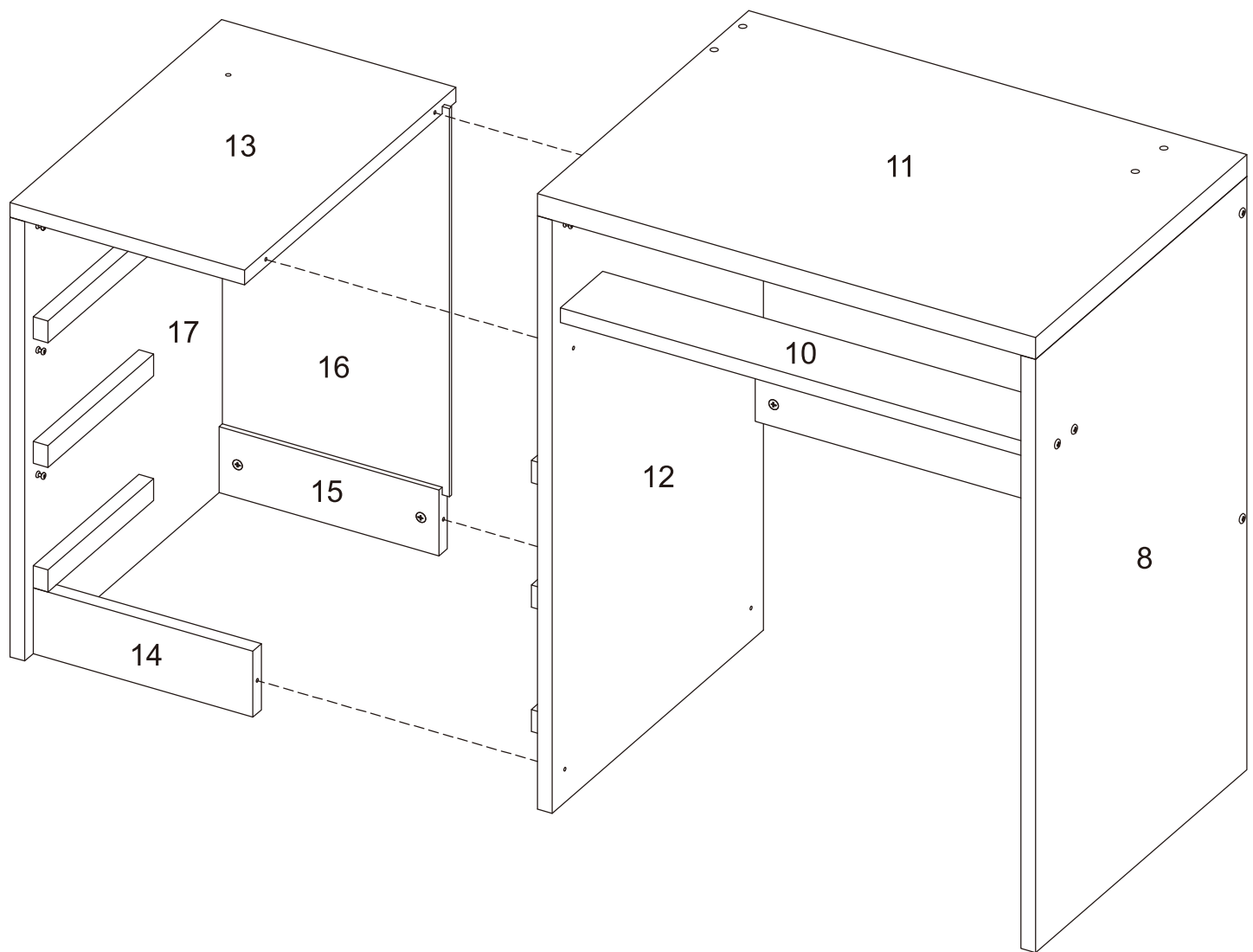

Step 20

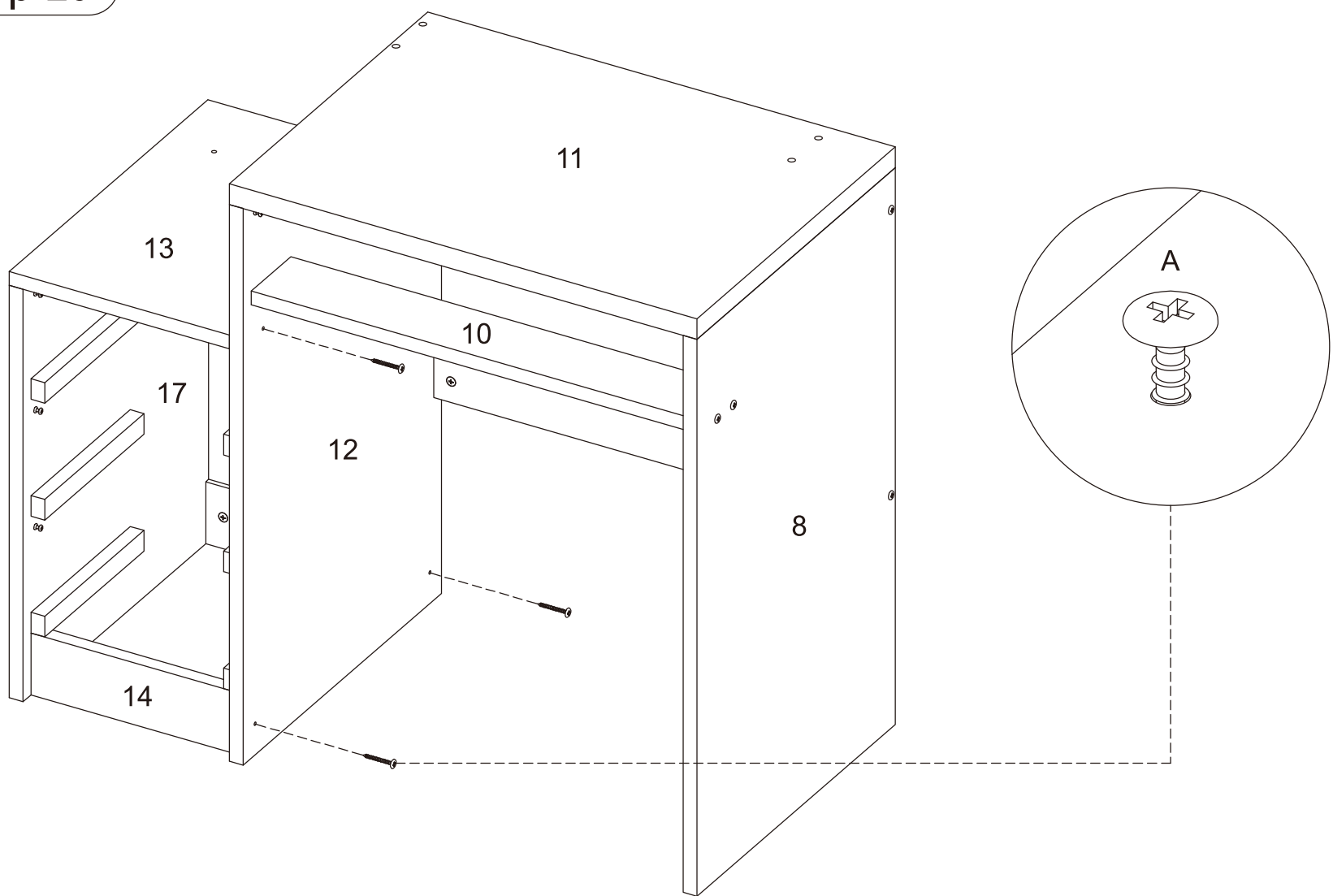

Step 21 pick up ⑱ x2, ⑲ x1, ⑳ x1, ㉑ x1

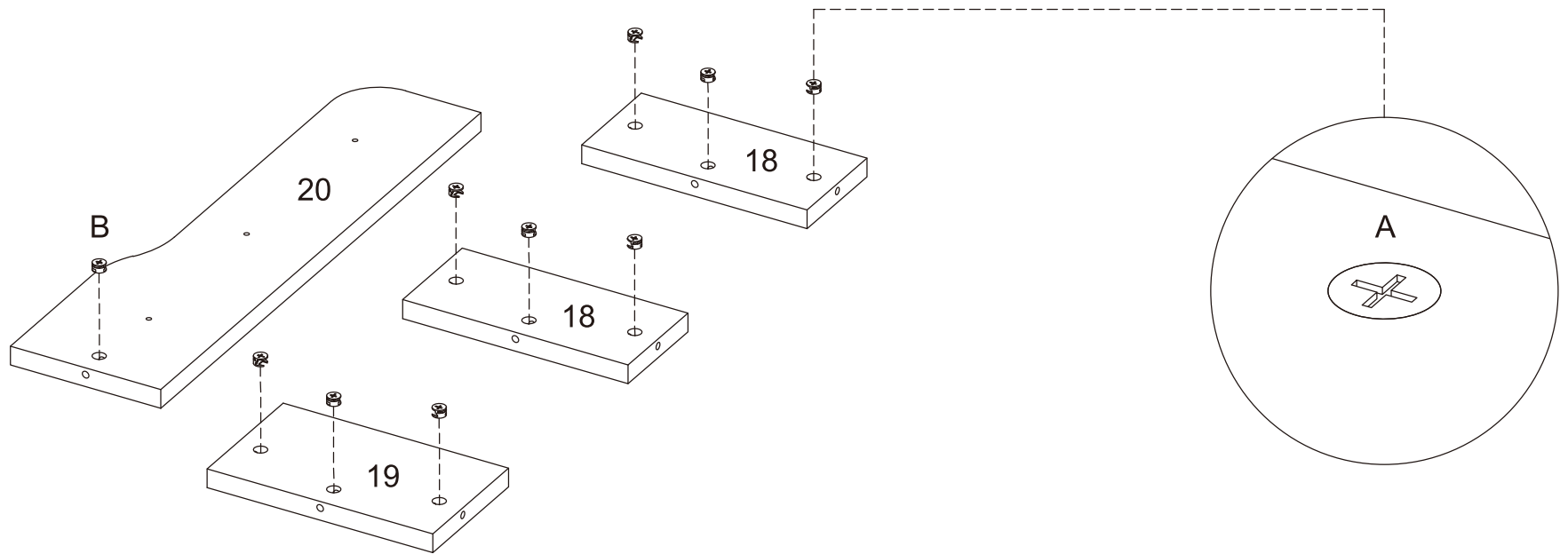

Step 22

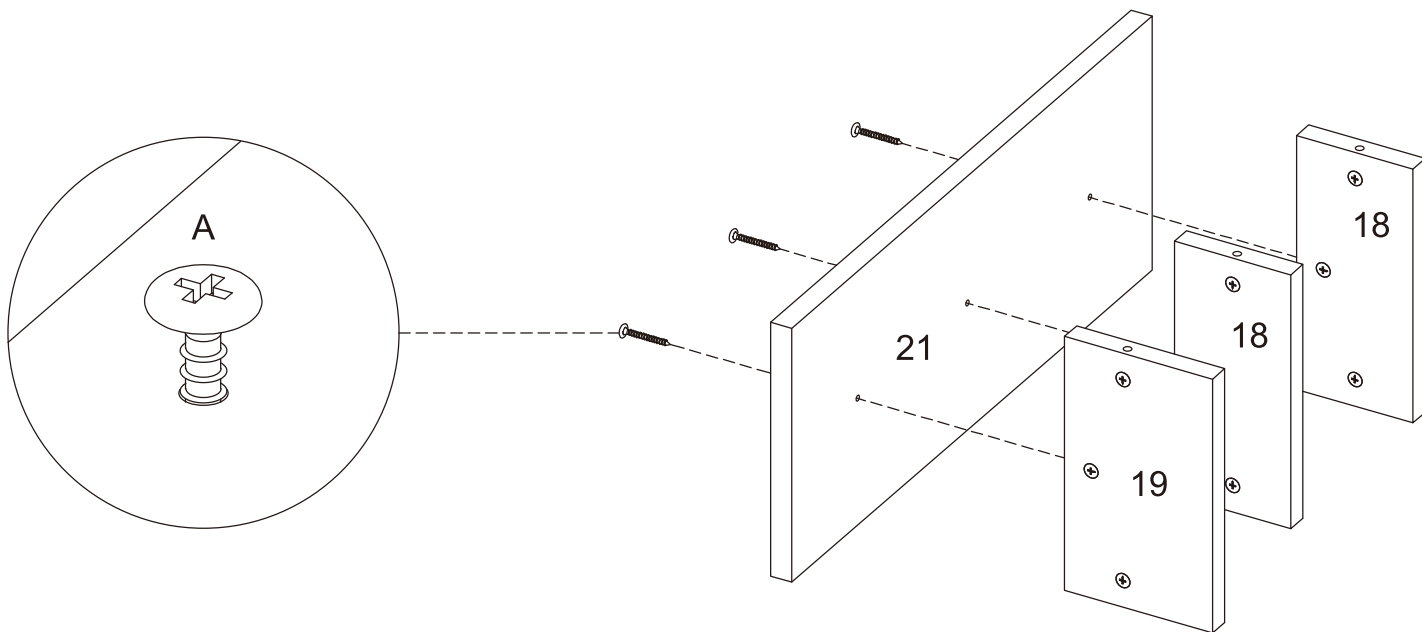

Step 23

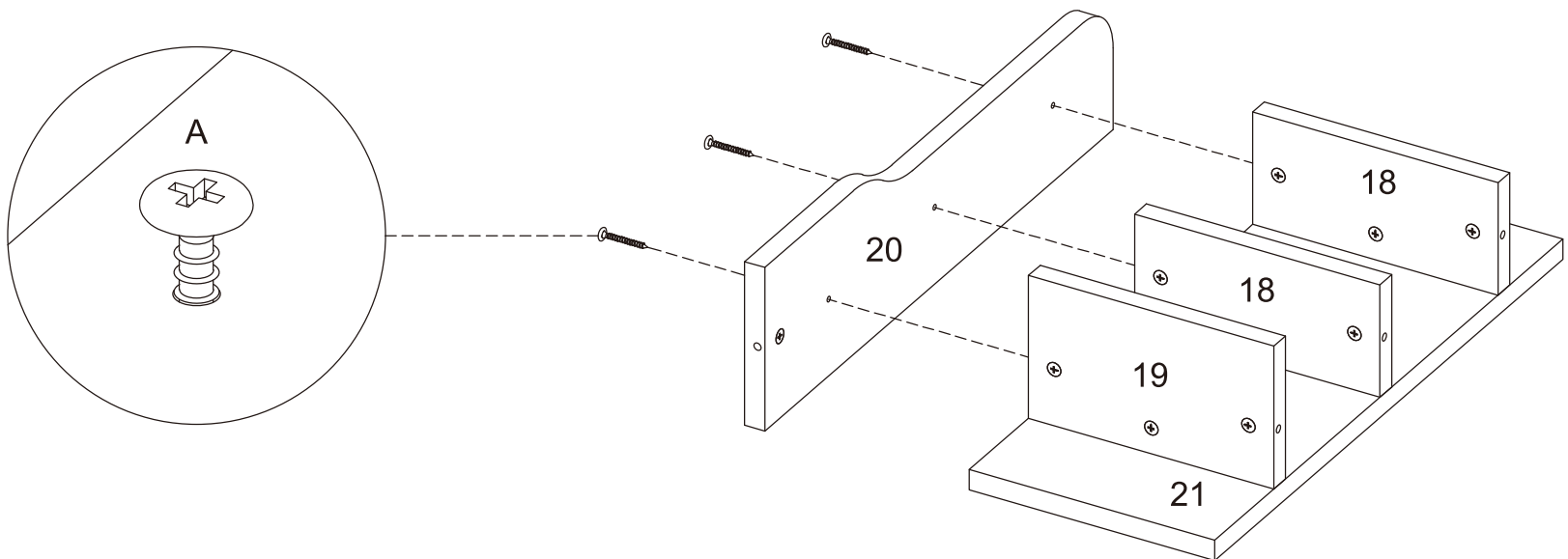

Step 24 pick up (22) x1, (23) x2, (24) x2, (25) x1, (26) x1, (27) x1

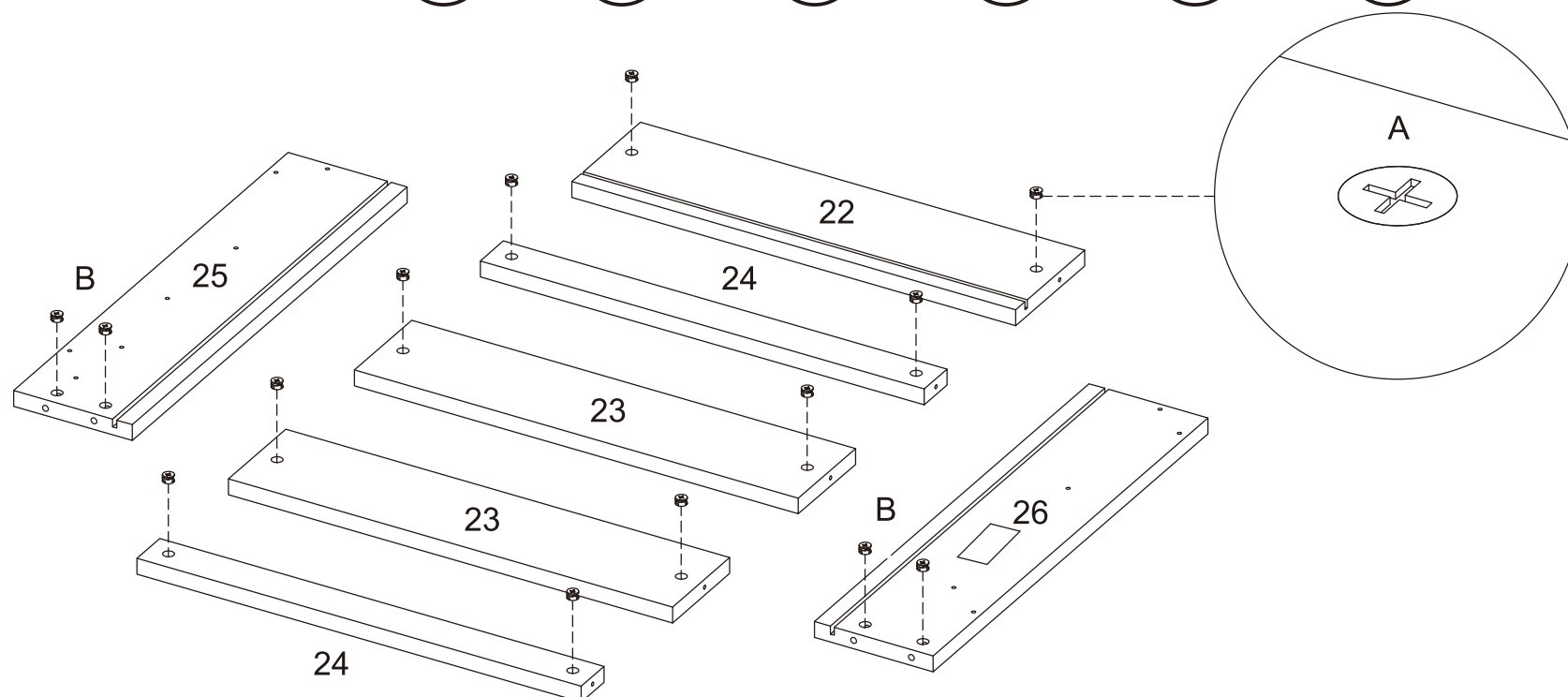

Step 25

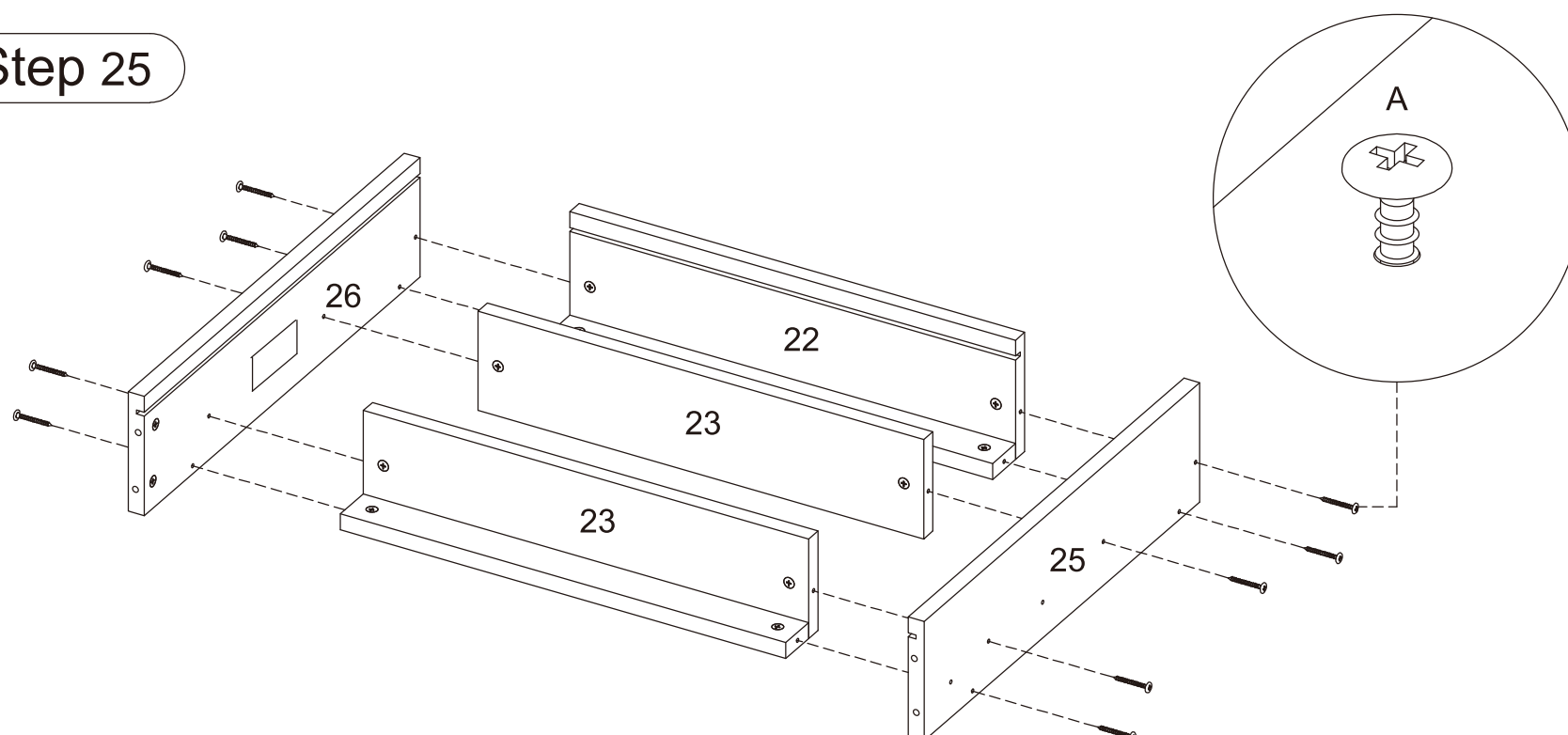

Step 26

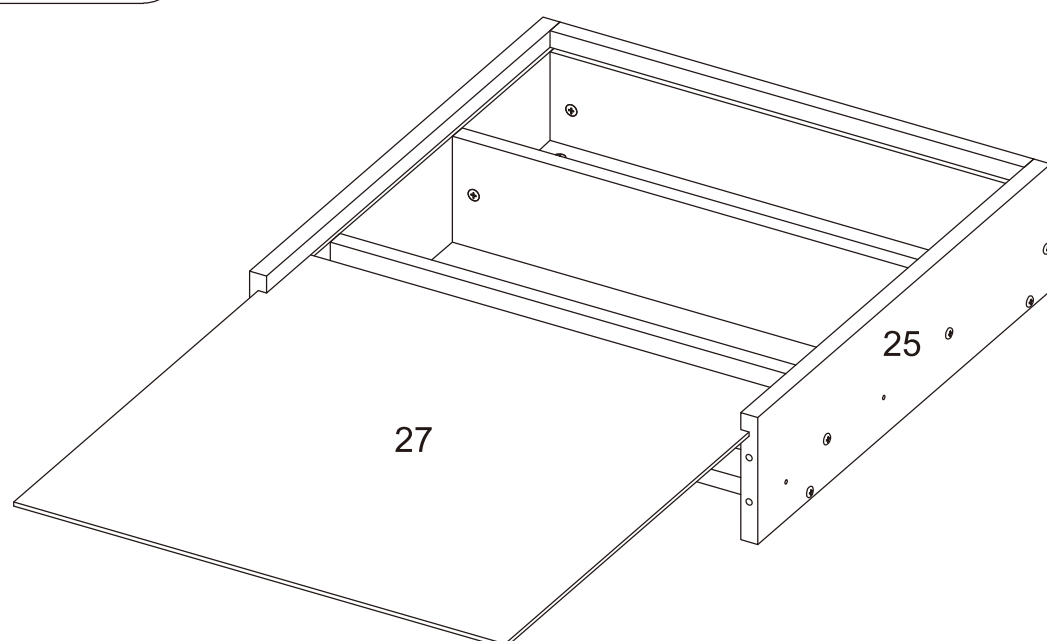

Step 27

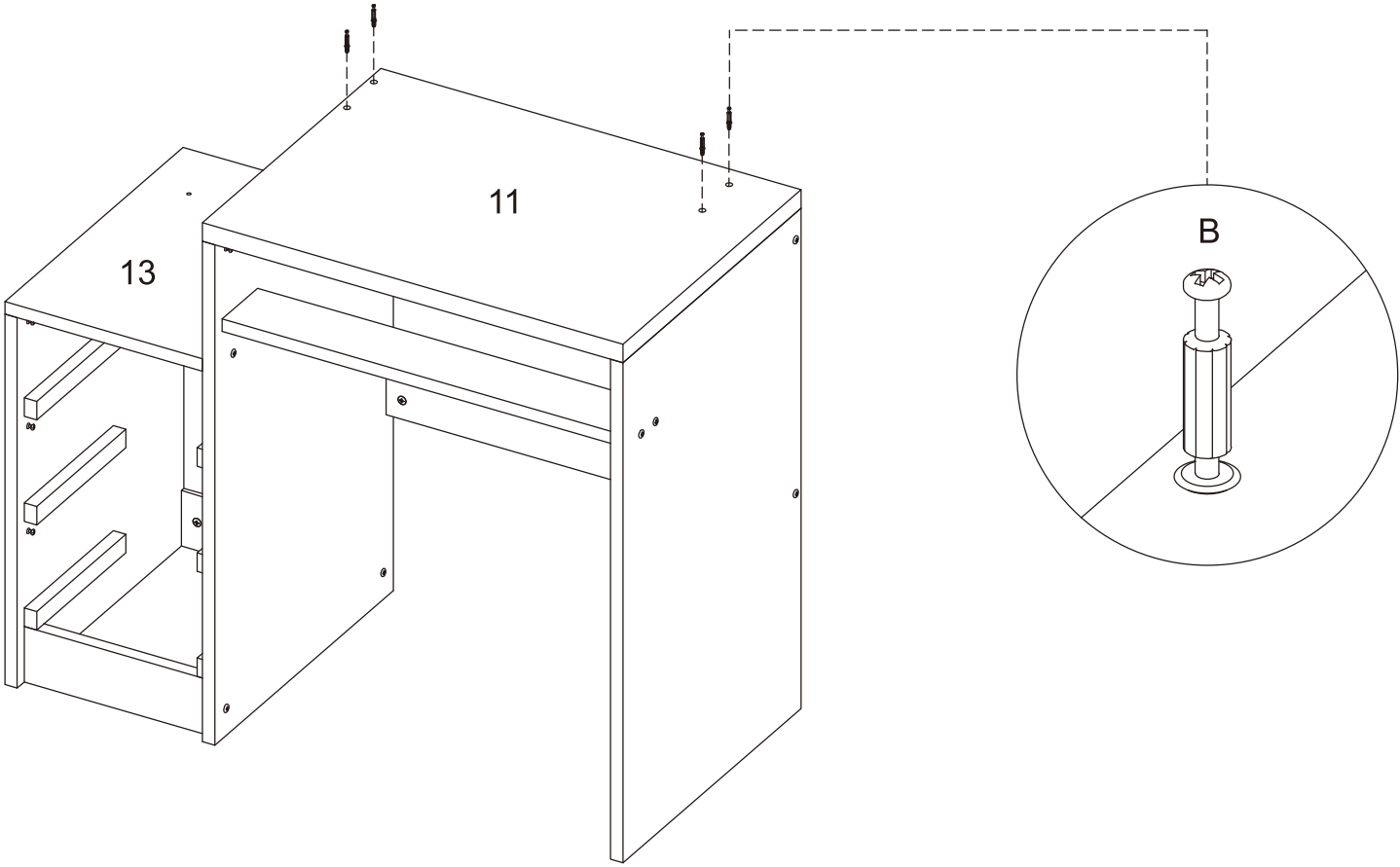

Step 28

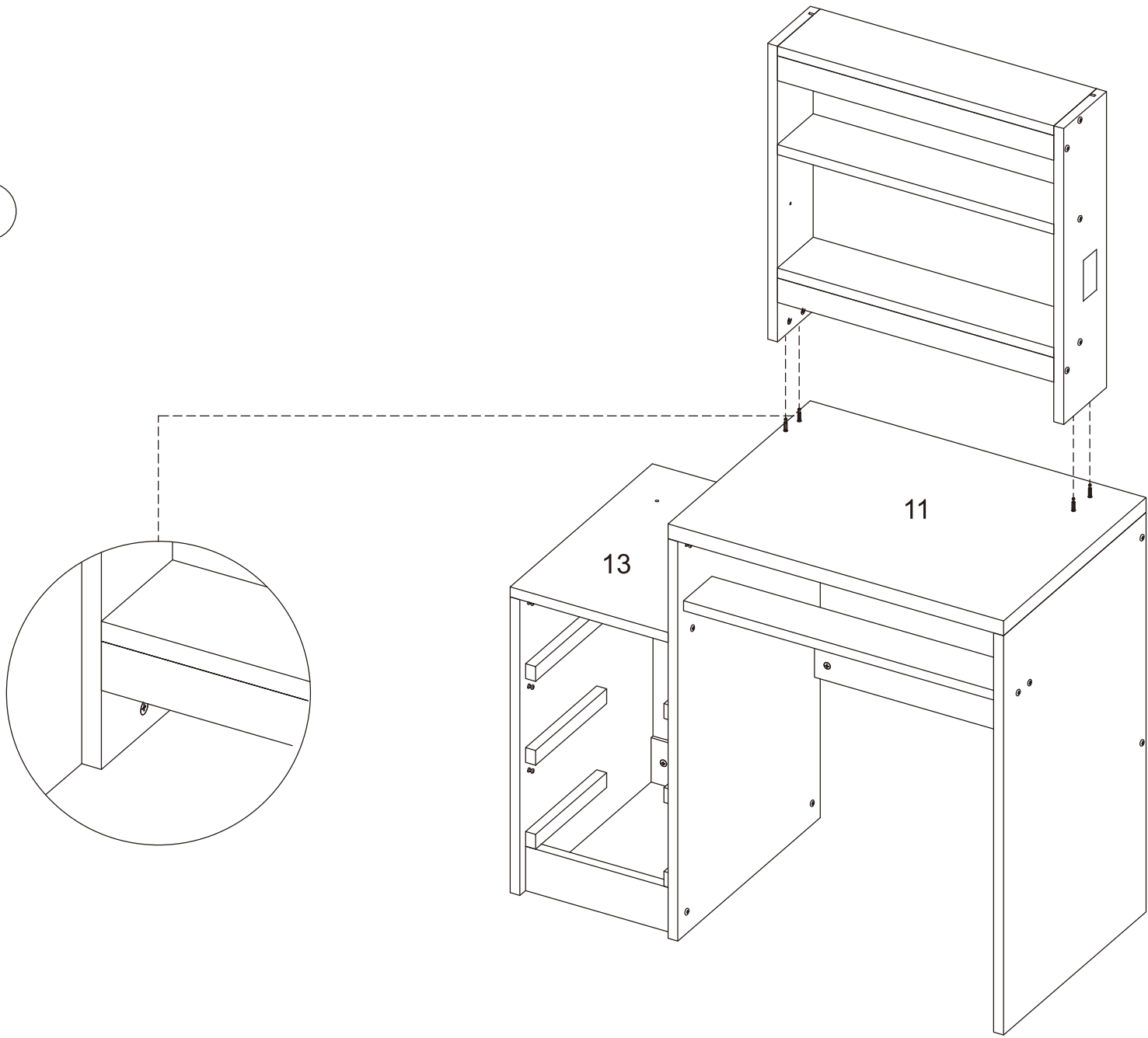

Step 29

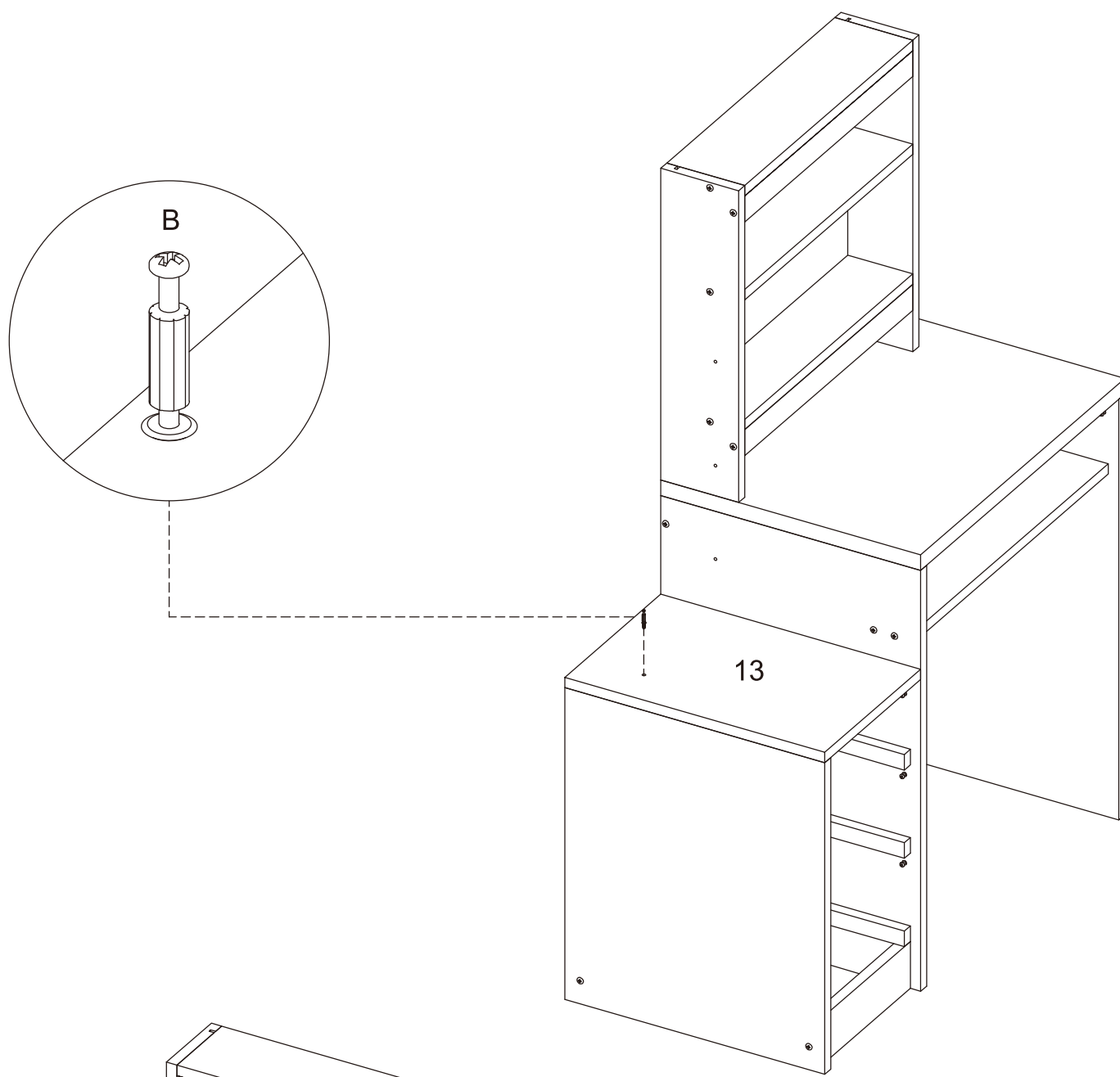

Step 30

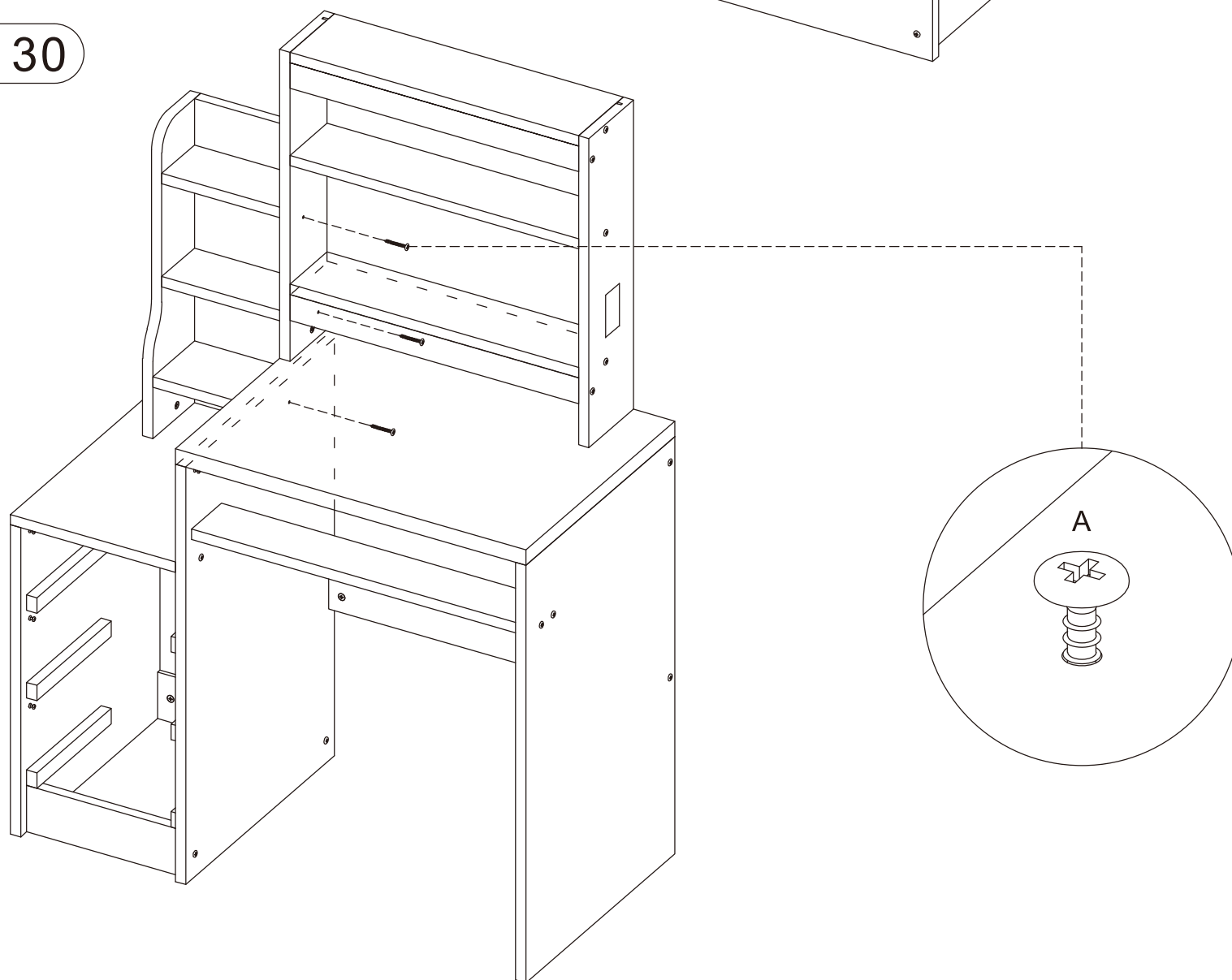

Step 31

For vanity table with light

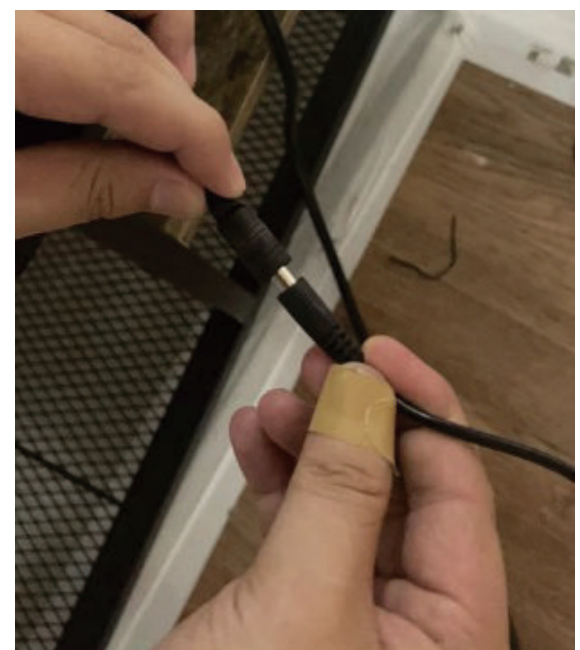
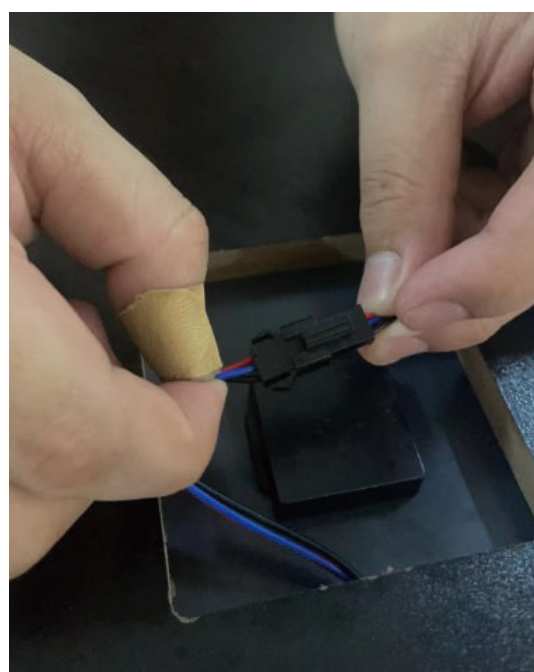
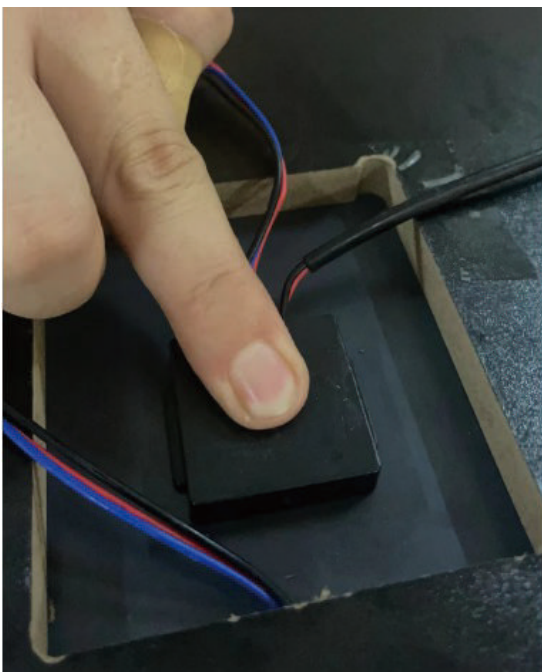
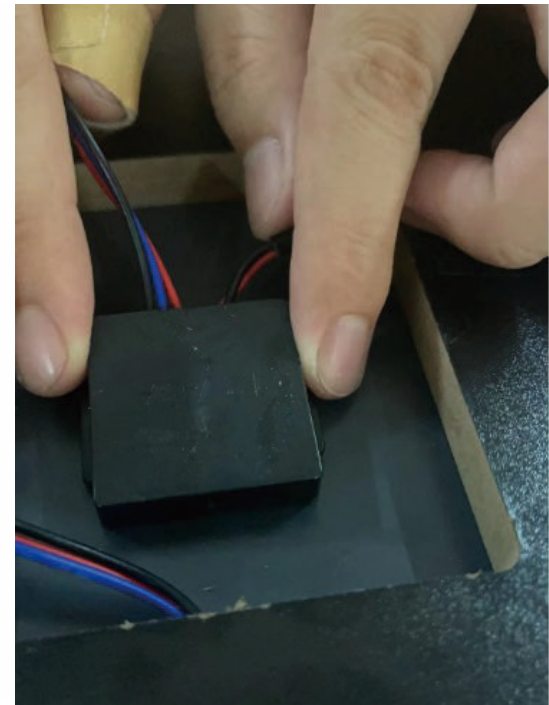
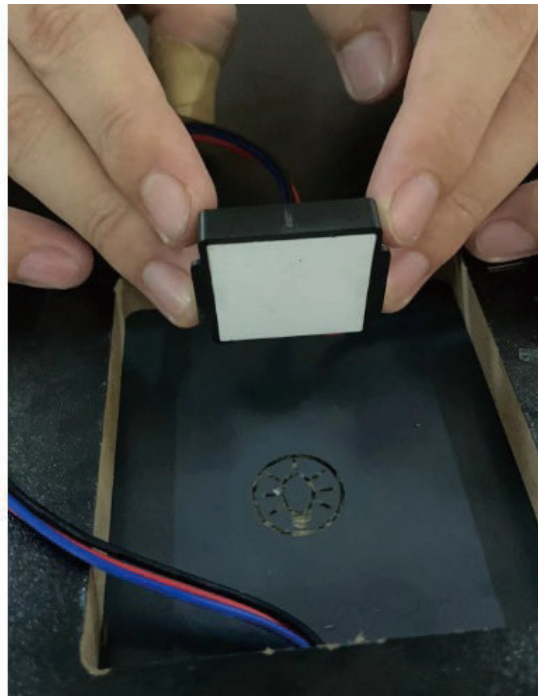
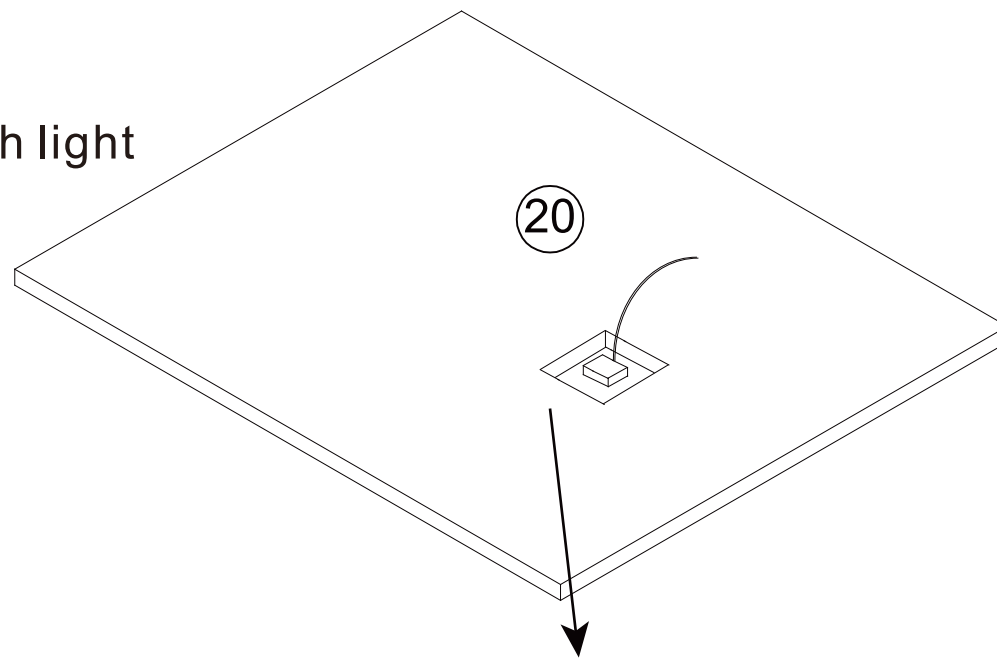

If your vanity table include a LED mirror light, please test the light in this step. Touch the switch botton on the mirror to turn on the mirror light, click the switch botton to change the color of the light, and long press the switch botton to adjust the brightness. If the switch botton is not sensitive, you can check whether the touch switch is tightly attached to the mirror back as shown in the diagram. If it is not tightly attached, please use your fingers to press the touch switch to the designated position and check if the connecting wire is OK.

Step 32

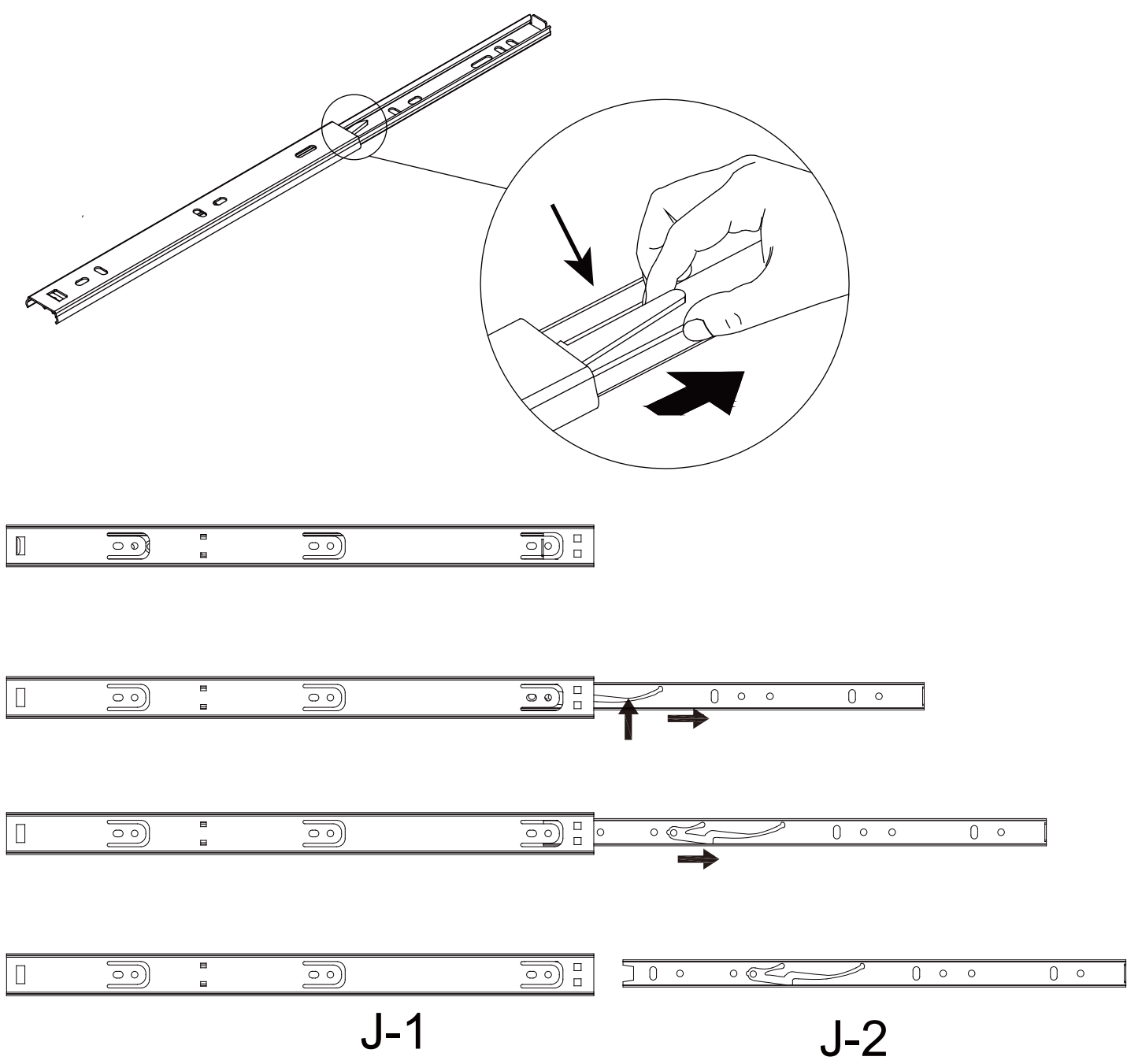

Step 33

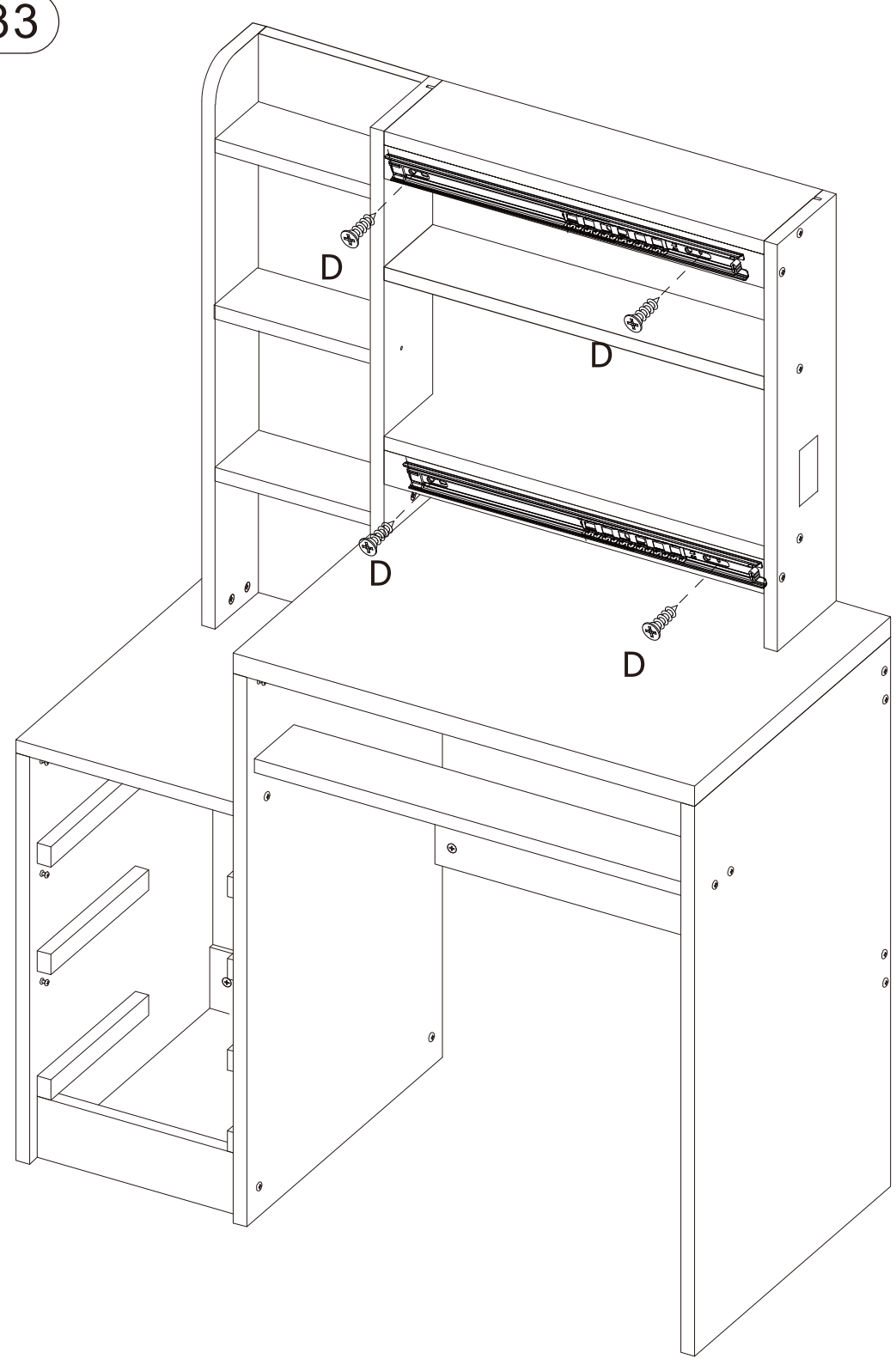

Step 34

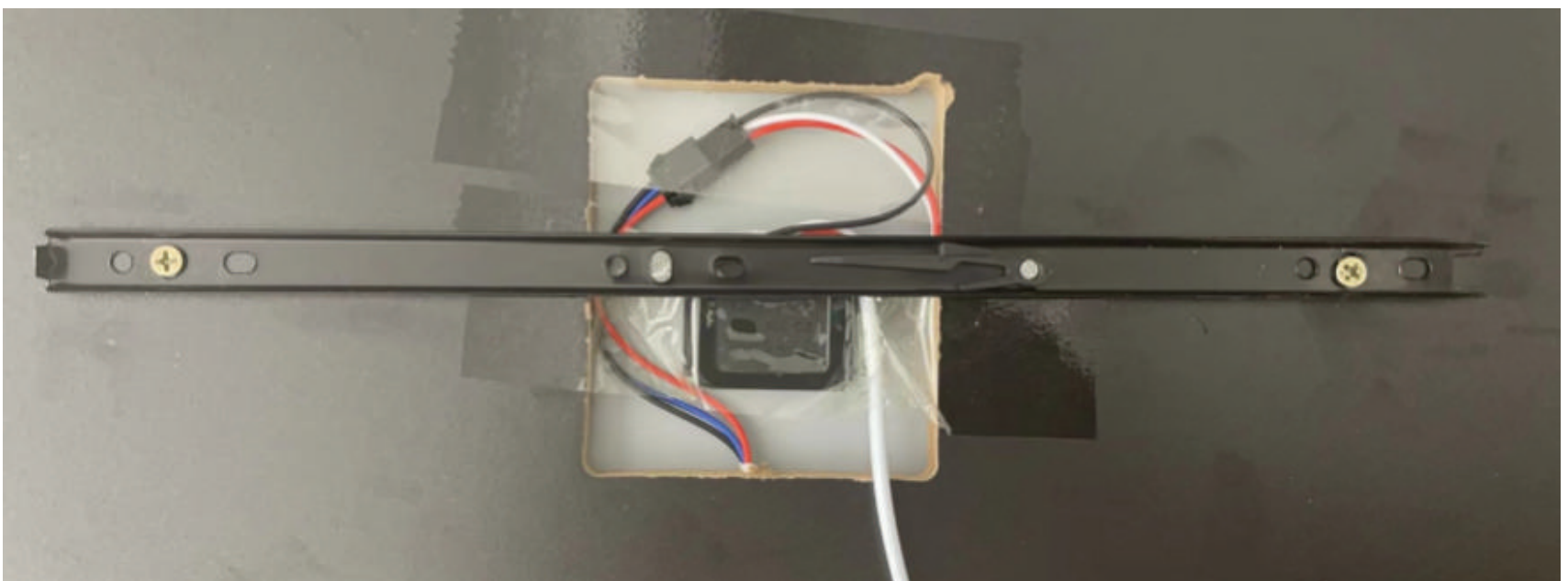
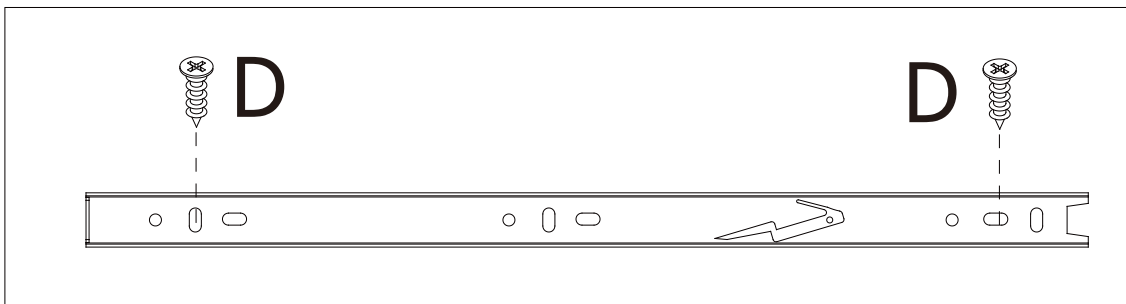
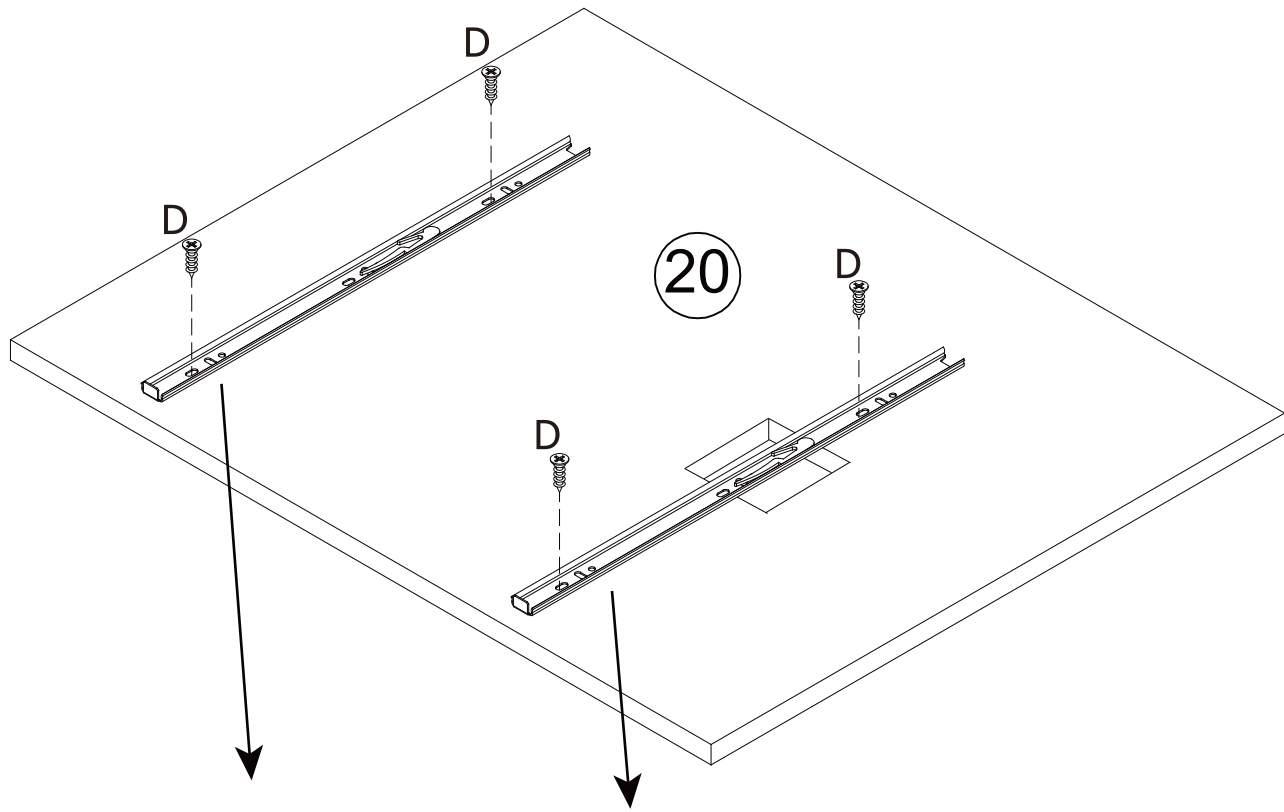

Step 35

K, L for 918S-LS

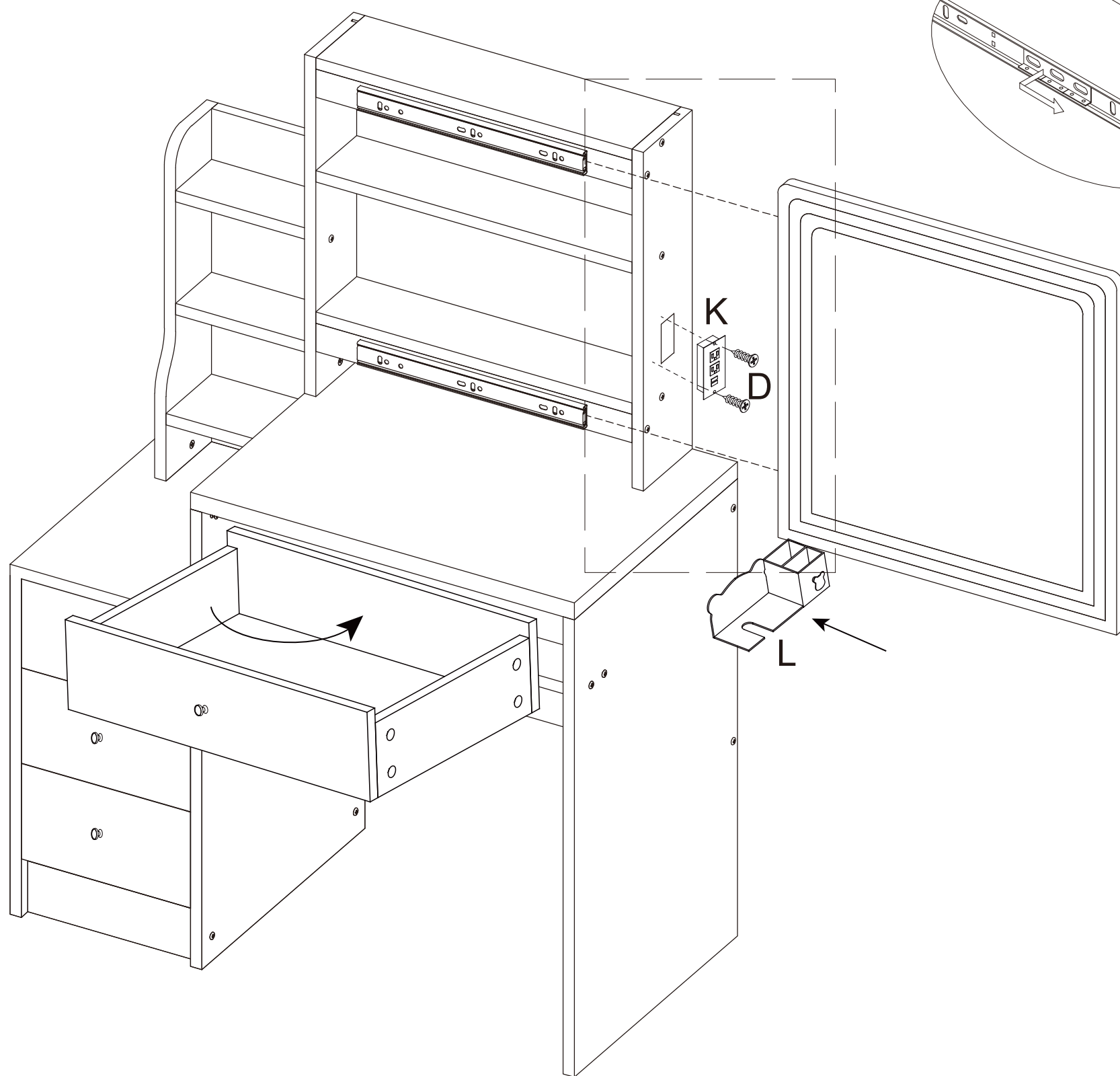

Please note that when placing the drawer in, the drawer positioning pin will block the drawer. Therefore, please follow the diagram to first insert the inner edge of the drawer using a concave method, and then push the drawer flat.

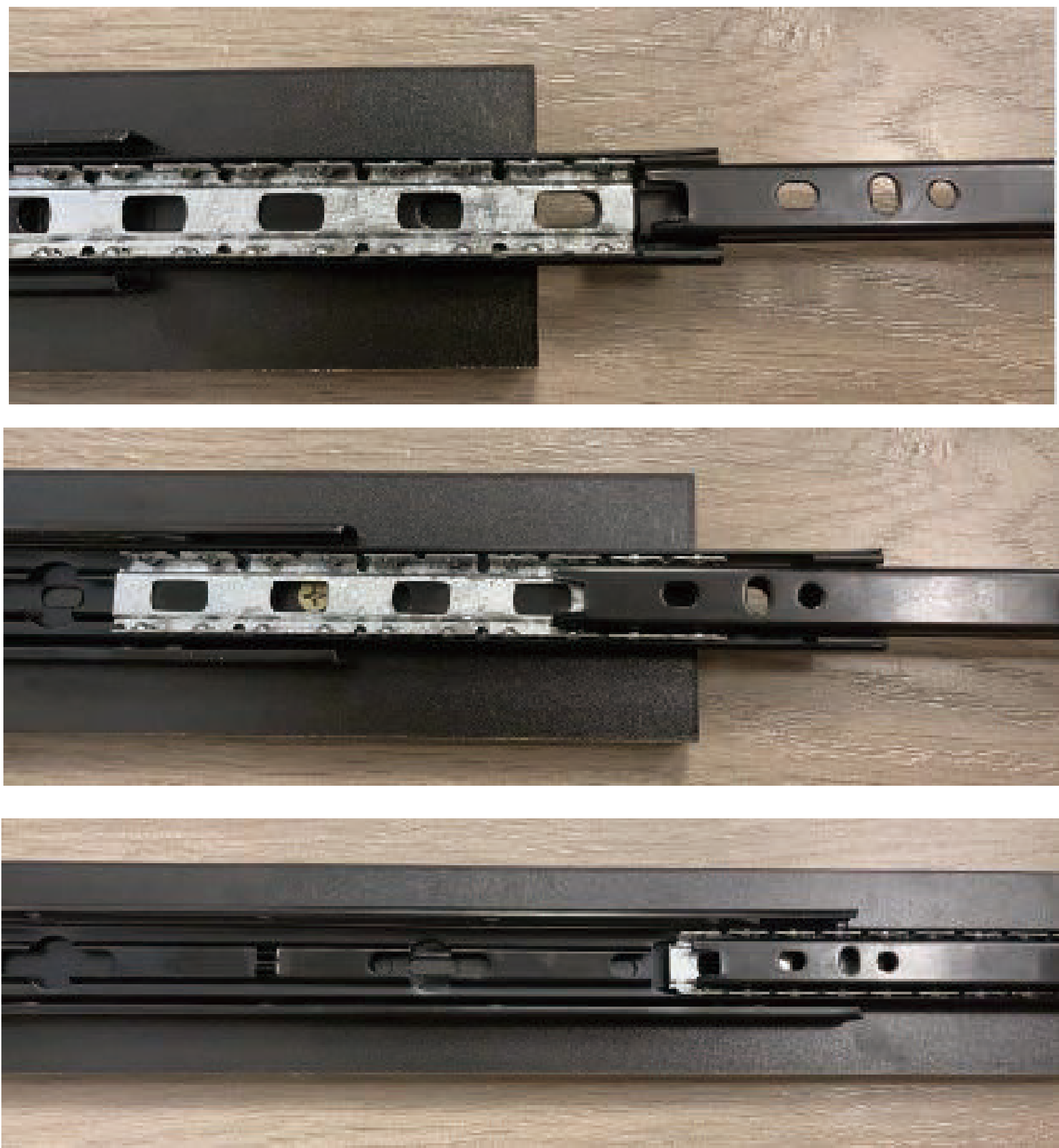



Only for vanity table with hair dryer
bracket and built-in socket

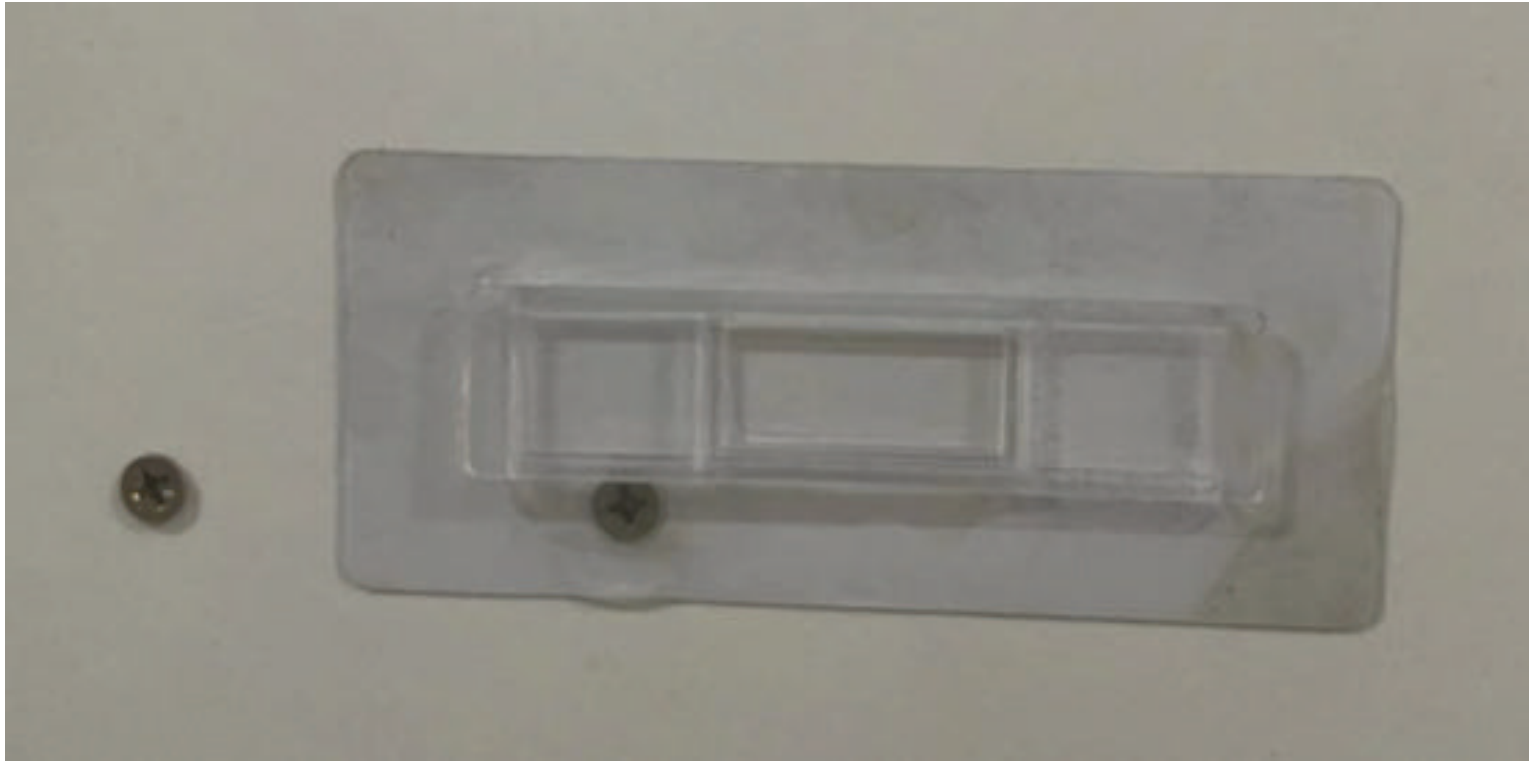

Only for vanity table with hair dryer
bracket and built-in socket

Step 37

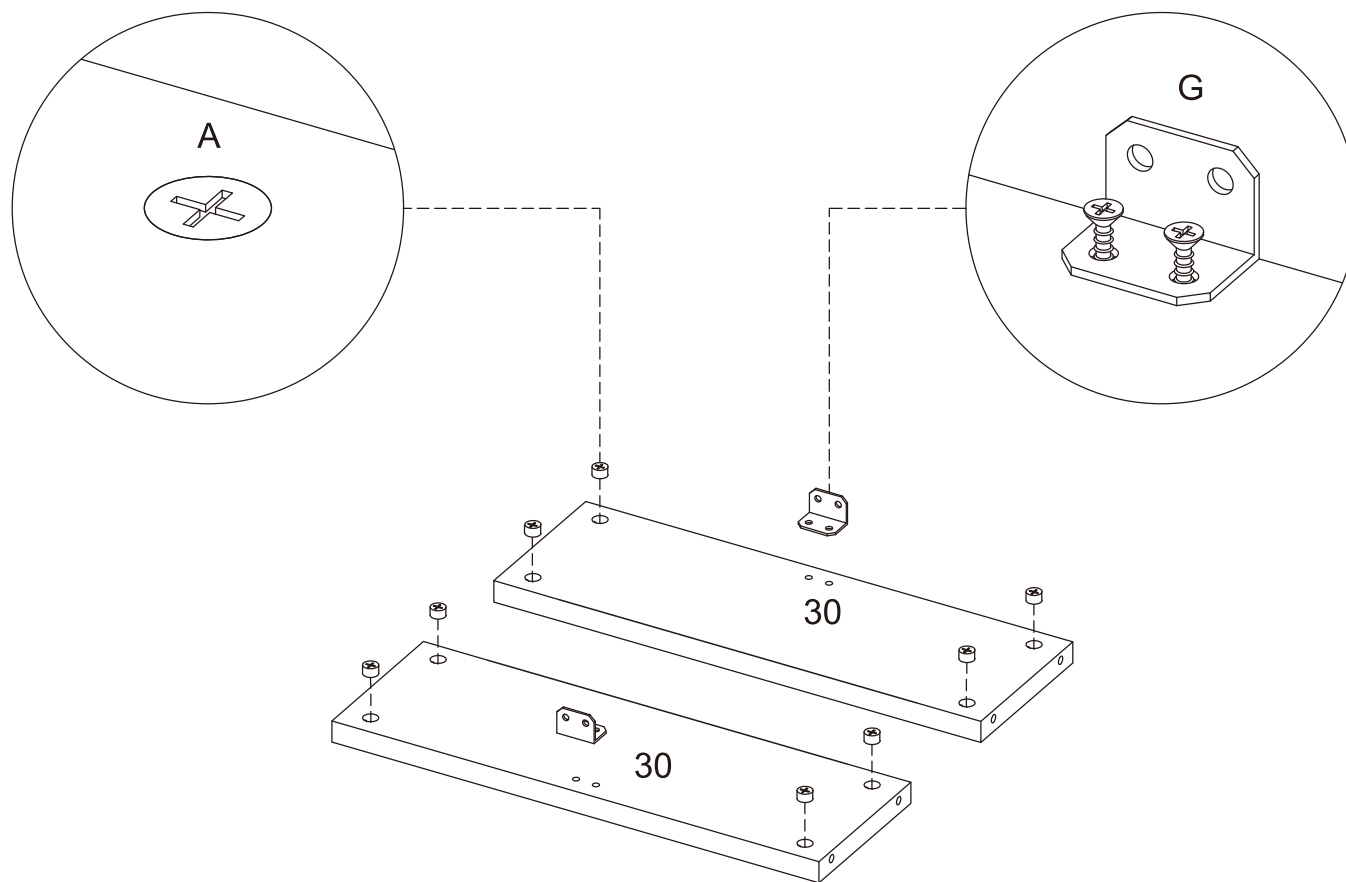

Step 38

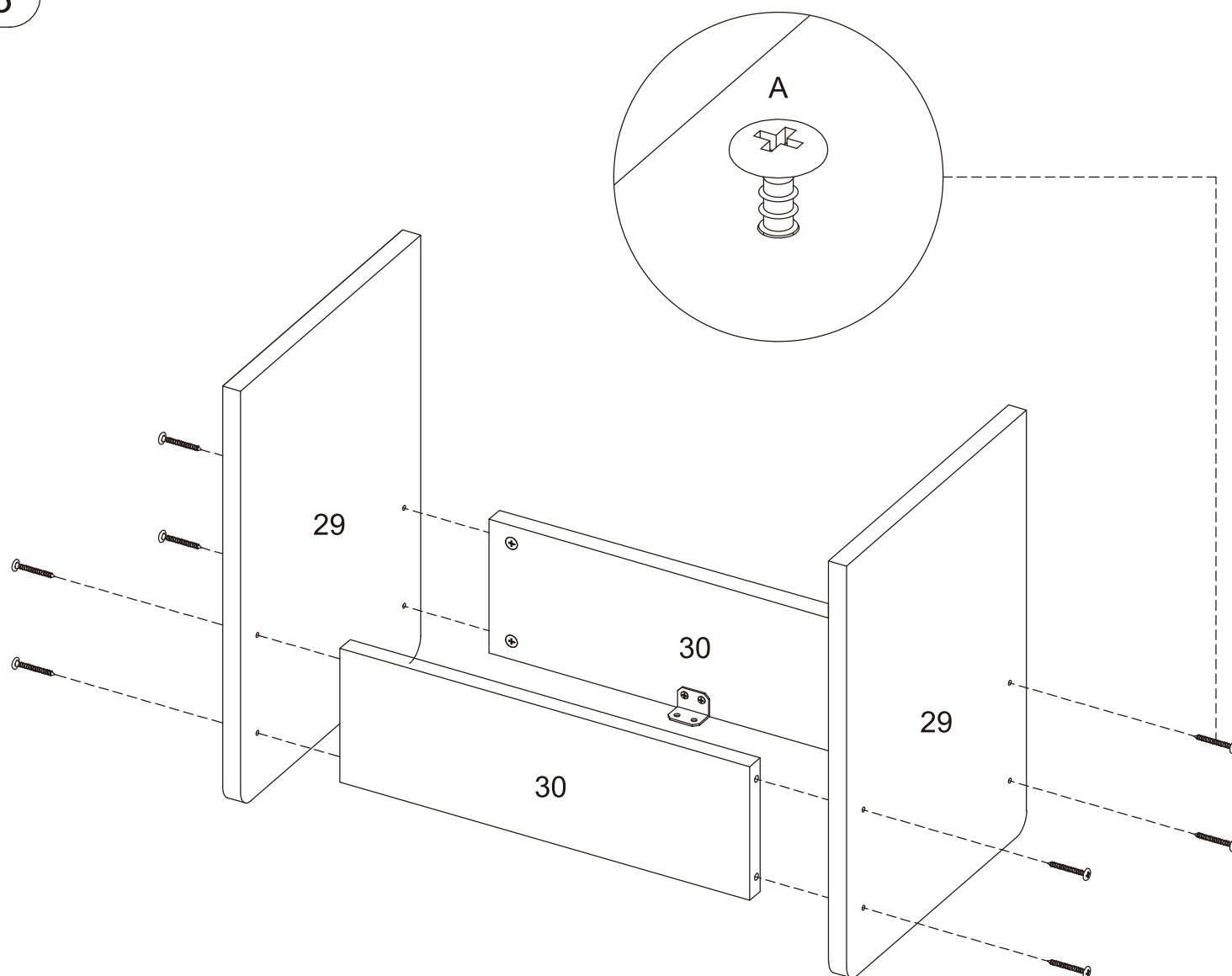

Step 39

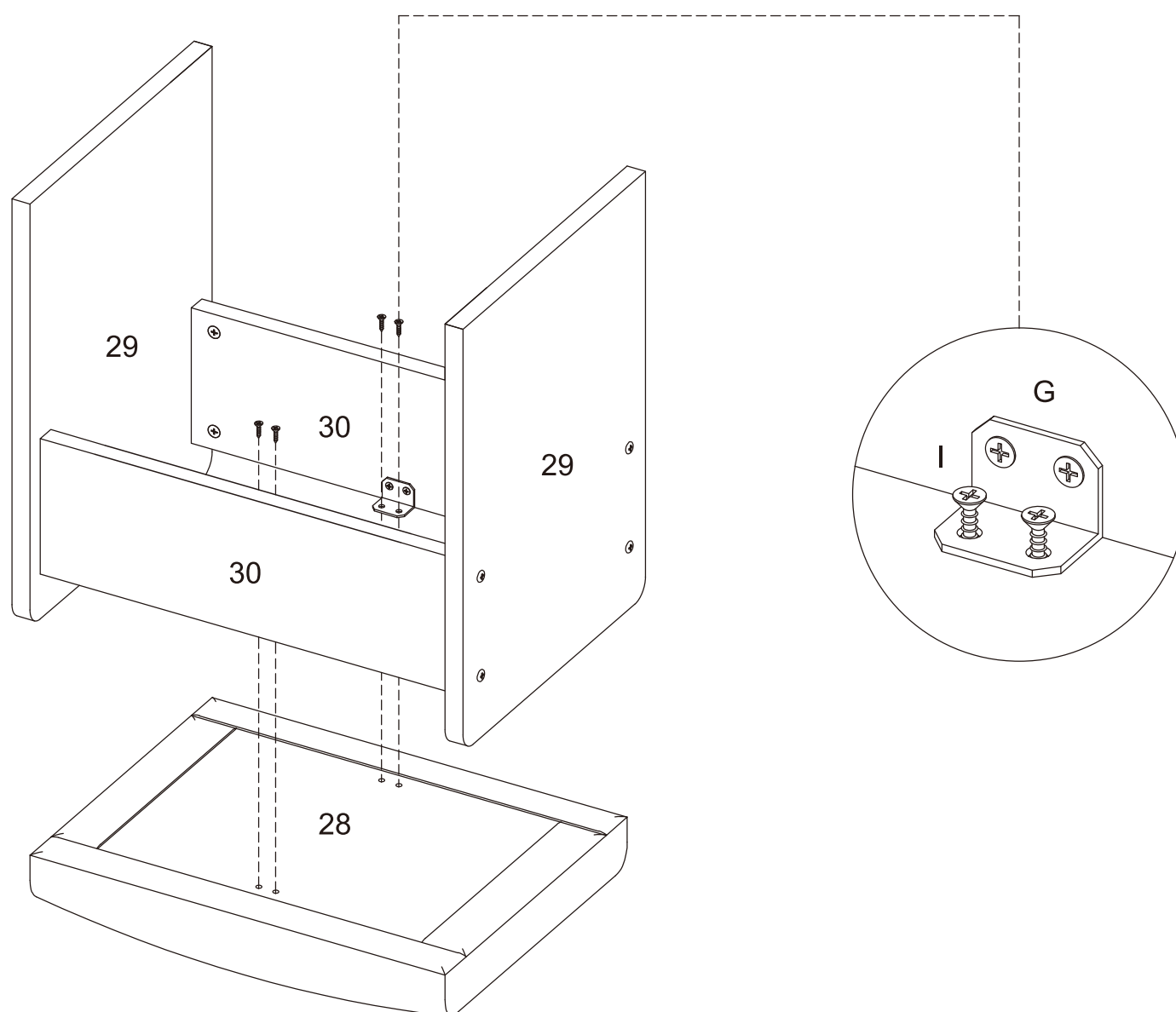

Step 40

