

INSTRUCTION MANUAL

12T SHOP PRESS



IMPORTANT: PLEASE READ THESE INSTRUCTIONS CAREFULLY. NOTE THE SAFE OPERATIONAL REQUIREMENTS, WARNINGS AND CAUTIONS.

1. Forward

This Shop Press is designed for automotive, truck, implement, fleet, and industrial repair shops where pressing, bending, straightening and forming, is required. Typical applications include installation and removal of alternator and power steering pump bearings, axle bearings, transmission bearings, seals, u-joints and others. **Unlike** presses equipped with a separately mounted pump, the power unit on this press **can not** be equipped with a pressure gauge,

2. Main specifications

Capacity	Max working distance	Min working distance	Stroke
12T	700mm	35mm	125mm

3. Safety instructions

IMPORTANT SAFETY INFORMATION

WARNING Read all safety warnings and instructions. *Failure to heed these markings may result in personal injury and/or property damage.* **Save all warnings and instructions for future reference.**

The warnings, precautions, and instructions discussed in this manual cannot cover all possible conditions and situations that may occur. The operator must understand that common sense and caution are factors, which cannot be built into this product, but must be supplied by the operator.

Work area safety

1. Keep children and bystanders away while operating. Distractions can cause you to lose control.
2. Keep work area clean and well lit. Cluttered or dark areas invite accidents.

Personal safety

1. Wear ANSI-approved safety goggles and heavy-duty work gloves during use and service.
2. Stay alert and use common sense when operating. Do not use when tired or under the influence of drugs, alcohol or medication.
3. Do not overreach. Keep proper footing and balance at all times.
4. Dress properly. Do not wear loose clothing or jewelry. Keep your hair, clothing and gloves away from moving parts. Loose clothes, jewelry or long hair can be caught in moving parts.

Tool use and care

1. **Do not force the tool.** Use the correct tool for the application. The correct tool will do the job better and safer at the rate for which the tool is designed.
2. **Store the tool when it is idle out of reach of children and other untrained persons.** A tool is dangerous in the hands of untrained users.

3. **Check for misalignment or binding of moving parts, breakage of parts, and any other condition that affects the tool's operation.** If damaged, have the tool serviced before using. Many accidents are caused by poorly maintained tools. There is a risk of bursting if the tool is damaged.
4. **Use only accessories that are identified by the manufacturer for the specific tool model.** Use of an accessory not intended for use with the specific tool model, increases the risk of injury to persons.

Service

1. ***Tool service must be performed only by qualified repair personnel.***
2. **When servicing a tool, use only identical replacement parts. Use only authorized parts.**
3. **Use only the lubricants supplied with the tool or specified by the manufacturer.**

Specific Safety Rules

1. Keep hands away from arbor plates and press pin during use.
2. Do not move workpiece while compressed.
3. Release load before service or maintenance.
4. Bolt to floor before use.
5. Keep area under arbor plates clear. If arbor plates rest on obstruction (i.e. bolt, debris, etc.), it creates an uneven press, causing excess stress and possible breakage.
6. Avoid off-center loads. Do not operate if workpiece tilts or binds during compression.
7. STOP and release compression if you suspect imminent structural failure. If safe, inspect thoroughly and reposition before proceeding.
8. Do not compress springs or other elastic objects. They could disengage hazardously.
9. Wear ANSI-approved safety goggles, heavy-duty work gloves, and steel-toe work boots during set up and/or use.
10. Keep bystanders out of work area.
11. Do not stand directly in front of the press when loaded. Do not leave the press unattended when loaded.
12. 20 Ton Limit. Do not operate the hydraulic jack beyond rated capacity.
13. Inspect before every use; do not use if parts are loose or damaged.
14. Jack service must be performed only by qualified repair personnel. Service or maintenance performed by unqualified personnel could result in a risk of injury.
15. When servicing a jack, use only identical replacement parts – refer to attached, product-specific parts list and diagram. Follow instructions in the “User - Maintenance Instructions” section of this manual. Use of unauthorized parts or failure to follow maintenance instructions may create a risk of injury.
16. Only use with accessories rated to handle the forces exerted by this tool during operation. Other accessories not designed for the forces generated may break and forcefully launch pieces.
17. Use only with bottle jack included with this press.
18. Industrial applications must follow OSHA requirements.
19. This product is not a toy. Keep it out of reach of children.
20. Maintain labels and nameplates on the Shop Press. These carry important safety information. If unreadable or missing, contact Harbor Freight Tools for a replacement.
21. The warnings, precautions, and instructions discussed in this instruction manual cannot cover all possible conditions and situations that may occur. It must be understood by the operator that common sense and caution are factors which cannot be built into this product, but must be supplied by the operator.



SAVE THESE INSTRUCTIONS.

5. Main construction

parts list

PART NO	DESCRIPTION	QTY	PART NO	DESCRIPTION	QTY
1	Beam	1	11	Foot	2
2	Jack	1	12	M14 Nut	6
3	Spring	2	13	Spring WasherΦ14	6
4	Pull Bolt	2	14	WasherΦ14	6
5	Jack Plate	1	15	M14x110 Bolt	6
6	Press Frame	2	16	M8 Nut	4
7	Arbor Plate	2	17	WasherΦ8	4
8	Work bench	2	18	Spring WasherΦ8	4
9	Pin	2	19	M8x25 Bolt	4
10	Rung	1			

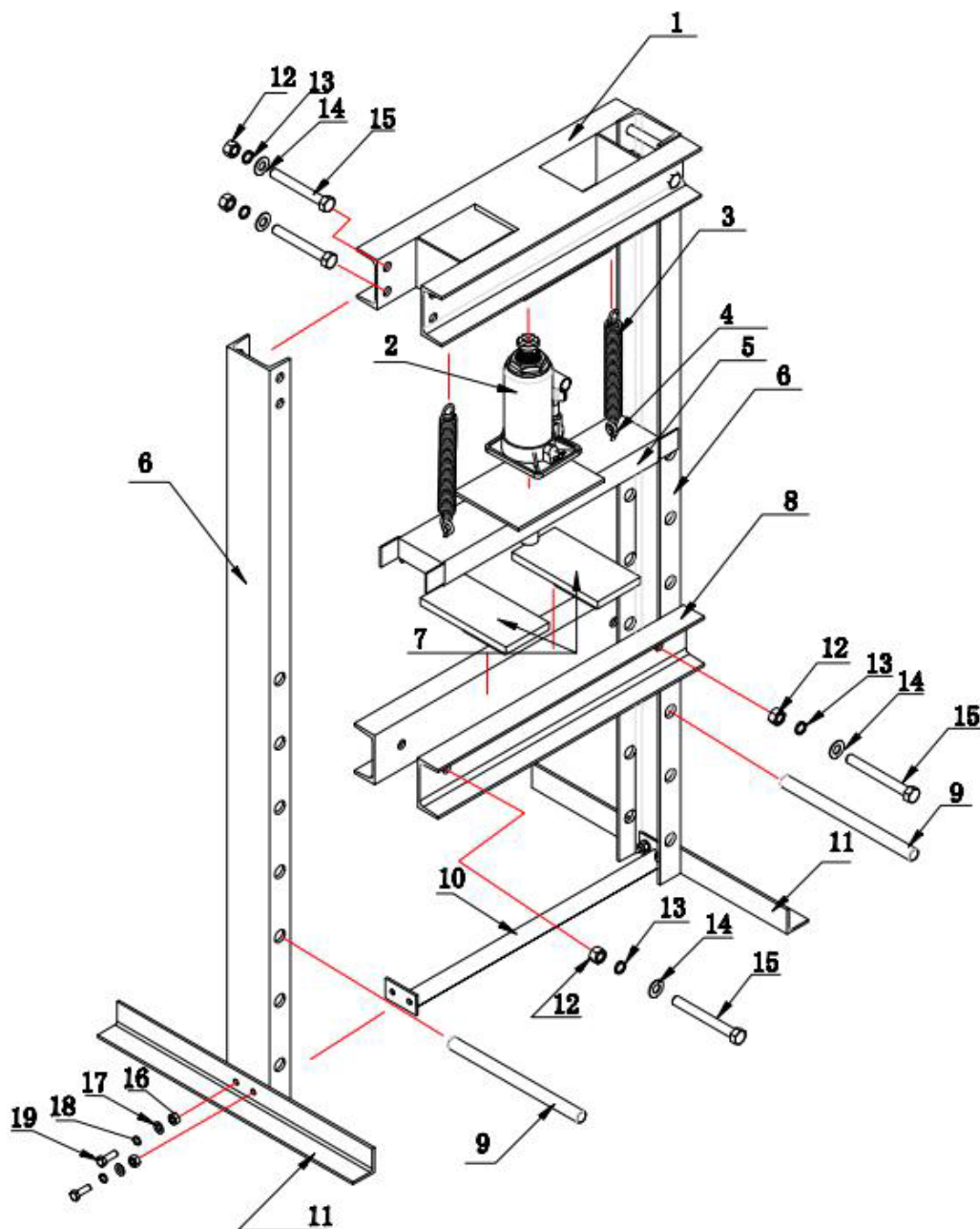

6. Operation instruction

1. 20-Ton Shop Press comes with two Arbor Plates. The Arbor Plates can be used individually or connected as shown below by the Arbor Lock.
2. To set the Aprons at a specific height, slide the two Pins through opposite adjustment holes on the Press Frame legs and secure in place using the two R-Clips.
3. Place the Arbor Plate onto the Press Apron, making sure to center it on the Press Apron.
4. **WARNING!** If the Arbor Plates rest on an obstruction (such as bolt, debris, etc.) an uneven base can be created. This can lead to unusual stress on the Arbor Plates and possibly a break and/or personal injury.
5. Insert the narrower jack handle (the end with the pin) into the larger handle and engage the pin into the “T” slot.
6. Using the slotted end of the jack handle, tighten (turn clockwise) the relief valve of the Jack.
7. Insert the larger tube of jack handle into the Jack Handle Connector located to the side of the Jack.
8. pump the handle up and down to extend the Jack and operate the Shop Press.
9. **WARNING!** Should you detect any kind of structural failure, stop using the Shop Press immediately. If necessary, have the unit repaired by a qualified service technician.
10. When finished, remove the jack handle from the Jack Handle Connector and loosen (turn counter-clockwise) the relief valve of the Jack.

bleeding

1. Remove the Oil Fill Plug located on the back of the Jack to expose the Oil Fill Hole.
2. Open the Release Valve located on the front of the Jack, above. Insert the Jack Handle into the Pump Core. Slowly pump handle to force air out of the Oil Fill Hole.
3. As soon as the oil starts to come out of the hole, stop pumping. Replace the Oil Fill Plug. Close the Release Valve.
4. Check the oil level. It must be just below the Oil File Hole. If necessary, fill with high quality hydraulic oil.

7. Maintenance

1. **Caution :** Always release load from the Shop Press before performing any inspection, maintenance, or cleaning.
2. Before each use, inspect the general condition of the Shop Press. Check for structural failure, loose, cracked, bent or damaged parts, misalignment or binding of moving parts, and any other condition that may affect its safe operation. **Do not use damaged equipment.**
3. To prevent rust, coat all exposed surfaces with a light weight oil.
4. **Always keep the Arbor Plates and Press Apron area clean and free of oil and other lubricants.**
5. To clean, wipe with a clean, damp cloth.
6. When storing, keep the Shop Press covered with a clean drop cloth in a cool, dry location.