



STJS0010

# STABILIZER JACK

---

## OPERATING MANUAL

Rev 12.13.24

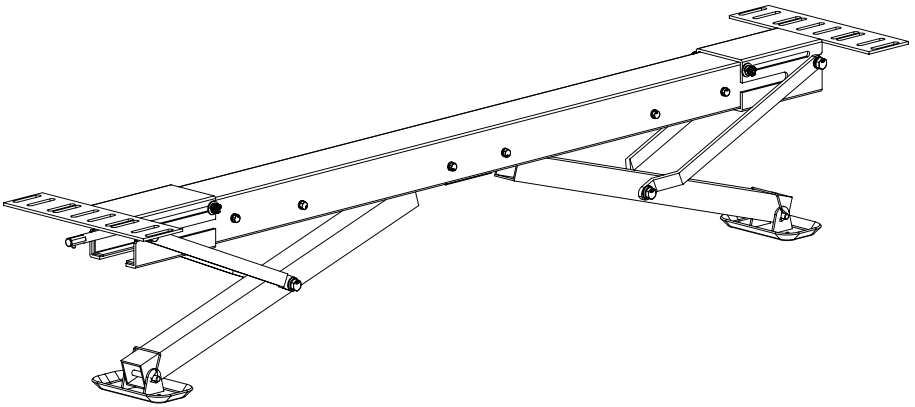

**MOVE *FORWARD.***



## WARNING

Carefully read and understand all the instructions before connecting your new Trailer Valet Stabilizer Jack.

Failure to follow these guidelines may result in serious injury to persons and property for which Trailer Valet will not be held liable. Do not allow persons to operate or assemble this unit until they have read this manual and have developed a thorough understanding of how the unit works.

## THANK YOU FOR YOUR PURCHASE!

Congratulations on your purchase of the Trailer Valet Stabilizer Jack. For your future reference, please complete the owner's record below:

Purchase Date: \_\_\_\_\_

Order No.: \_\_\_\_\_

Retailer: \_\_\_\_\_

Be sure to keep your receipt, owner's manual, and warranty information in a safe place.

## TABLE OF CONTENTS

WARNING AND TABLE OF CONTENTS.....	2
IMPORTANT SAFETY INFORMATION.....	3
SPECIFICATIONS.....	3
ASSEMBLY.....	4-5
OPERATING INSTRUCTIONS.....	6
LIMITED MANUFACTURER'S WARRANTY.....	7

Phone: (844) 846-9344

Email: [support@trailervalet.com](mailto:support@trailervalet.com)

Website: [www.trailervalet.com](http://www.trailervalet.com)



## IMPORTANT SAFETY INFORMATION

**Failure to heed these warnings may result in personal injury and/or property damage:**

1. The Stabilizer Jack is used to support and stabilize the frame of the trailer to reduce any movement while parked. Before moving the trailer, ensure that both jack legs are fully up in the stowed position.
2. This product is not designed as a lifting device or to support the weight of a trailer on its own. Damage to the trailer, Stabilizer Jack, or people can occur if it is misused in this manner. A trailer jack or other devices must be used to support the weight of the trailer.
3. If any damage occurs to the unit or if the jack legs do not raise or lower properly, discontinue use and contact the factory.
4. Use caution and controlled speed when lowering the jack legs with the drill. Excessive, uncontrolled speed during use can result in damage to the Stabilizer Jack.



## SPECIFICATIONS

**Product Dimensions (with Brackets Fully Retracted):** 14" x 6.3" x 68.5"

**Product Dimensions (with Brackets Fully Extended):** 14" x 6.3" x 77.2"

**Height Range:** 6.3" to 26.6"

**There is no lifting weight capacity since the stabilizer jack should not be used for lifting**

### The Trailer Valet Stabilizer Jack

1. Adjustable Mount Bracket
2. Position Locking Screw
3. Main Channel
4. Drive Shaft
5. Foot Plate
6. Support Bar
7. Support Leg
8. Gear Cover
9. Clevis Pin
10. Hand Crank
11. Drill Attachment

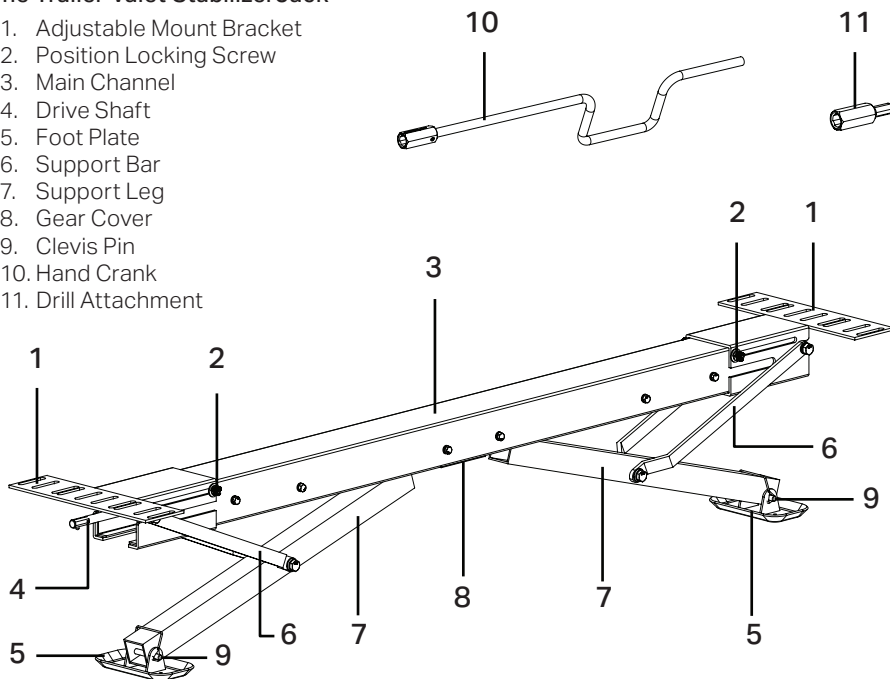



## ASSEMBLY

**STEP 1:** Unpack and inspect the Stabilizer Jack before it is installed. If there is any shipping damage to the stabilizer jack, do not install it and contact the factory.

**STEP 2:** Inspect and identify a section of the trailer frame where the Stabilizer Jack will be installed. Ensure that any pipes, wires, and accessories will be clear of the stabilizer jack prior to installation.

**STEP 3:** If the trailer currently has stabilizer jacks, remove them before installing this product.

**STEP 4:** If the trailer has mounting plates for stabilizer jacks but the jacks are not mounted, locate these threaded mounting holes on the frame. If there are no existing threaded holes in the frame, the frame will need to be drilled and tapped accordingly.

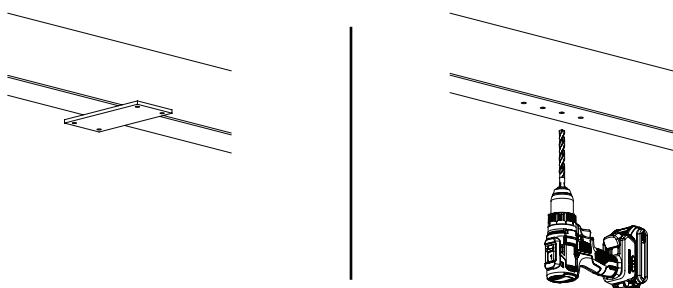

**STEP 5:** Adjust the mounting brackets to match the width of the trailer frame. Do not lock the position of the brackets at this point since they may need to be adjusted.

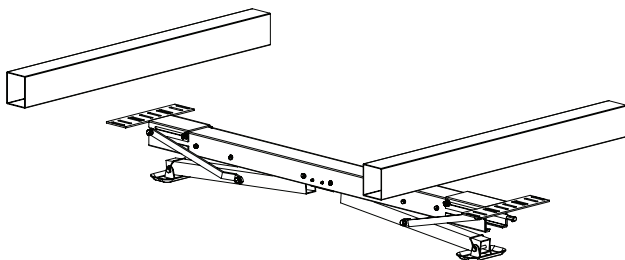

**STEP 6:** Install the TV Drill Adapter onto the drill and connect it to the drive shaft.

**STEP 7:** The shaft can be pushed in or pulled out to select the drive for either the far or near jack leg.

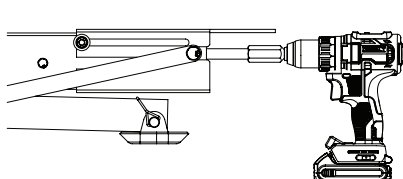

FAR JACK

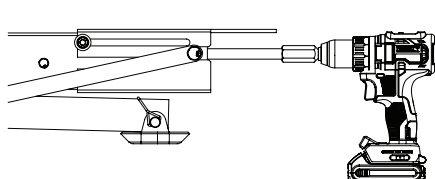

NEAR JACK



## ASSEMBLY

**STEP 8:** Once a jack leg is selected, use the drill to raise the Stabilizer Jack close to the frame. Repeat for the jack leg on the other side.

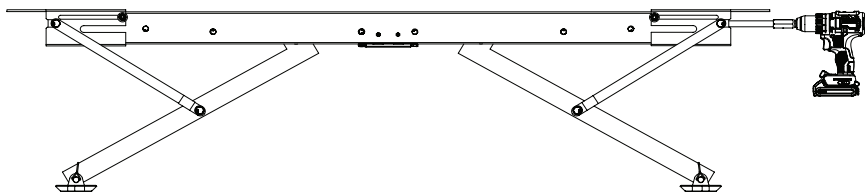

**STEP 9:** Raise the Stabilizer Jack up until it barely touches the frame.

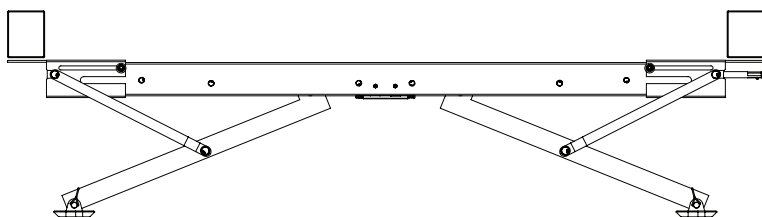

**STEP 10:** Use the proper bolts and fastening hardware to loosely connect the Stabilizer Jack mounting brackets to the frame. Then lock in the position of the brackets with the bolts on the sides of the stabilizer jack and tighten the mounting bolts to the frame.

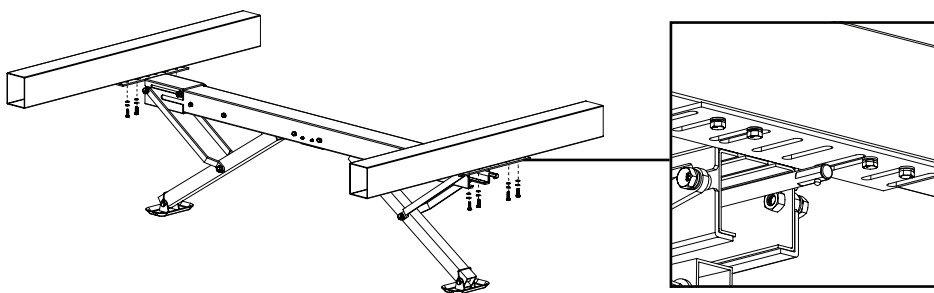

**STEP 11:** Once the stabilizer jack is installed and secure, the jack legs can be fully raised if it will not be immediately used.

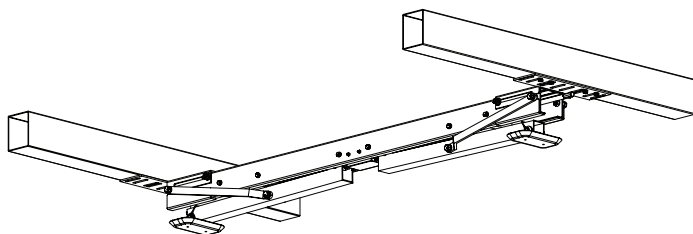



# OPERATING INSTRUCTIONS

## **OPTION 1: MANUAL OPERATION**

**STEP 1:** Attach the Hand Crank to the driveshaft located at the top of the unit. Turning the handle clockwise will extend the jack. Turning the handle counter-clockwise will retract the jack.

**STEP 2:** Lower the drop leg as needed for additional extension of the jack.

## **OPTION 2: DRILL OPERATION WITH THE DRILL ADAPTER**

**STEP 1:** After installation, shift the drive shaft to select a jack leg.

**STEP 2:** Use the drill and TV Drill Adapter on the drive shaft to lower the jack leg to the ground.

**STEP 3:** Once the leg touches the ground, the leg can be lowered slightly so the trailer is properly supported.

**STEP 4:** Shift the drive shaft to the other side and repeat the process.

## **STORING THE DEVICE (IF APPLICABLE)**

**STEP 1:** When not in use, the Stabilizer Jack can be stored on the trailer. Ensure that both legs are fully up if the trailer is being moved or transported.

**STEP 2:** If the Stabilizer Jack is removed for storage, it can be cleaned and stored in a dry location.



# LIMITED MANUFACTURER'S WARRANTY

SuperTech S Corp warrants for one year from the purchase date that the product will be in working condition and will be free from manufacturing defects, provided that installation and use of the product is in accordance with product instructions. This warranty is only made to the original consumer purchaser and is non-transferable.

**ALL OTHER WARRANTIES IMPLIED OR EXPRESSED ARE HEREBY DISCLAIMED.**

**THIS WARRANTY DOES NOT COVER:**

1. Normal wear and tear or normal aging of the product;
2. Consumable parts designed to diminish over time, unless failure occurred due to a manufacturing defect;
3. Cosmetic damage, including but not limited to scratches and dents;
4. Damage through accident, abuse, neglect, misuse, natural events, or other external causes;
5. Damage through misapplication, overloading, or improper installation;
6. Damage due to improper maintenance and repair; and/or
7. Product alterations.

**LIMITATION OF LIABILITY:**

EXCEPT AS PROVIDED IN THIS WARRANTY AND TO THE MAXIMUM EXTENT PERMITTED BY LAW, SUPERTECH IS NOT RESPONSIBLE FOR ANY DIRECT, INCIDENTAL, CONSEQUENTIAL DAMAGES, OR INJURIES RESULTING FROM ANY BREACH OF WARRANTY OR CONDITION; INCLUDING, BUT NOT LIMITED TO, LOSS OF USE, LOSS OF REVENUE, LOSS OF ACTUAL OR ANTICIPATED PROFITS, LOSS OF BUSINESS, LOSS OF OPPORTUNITY, LOSS OF GOOD WILL, LOSS OF REPUTATION, OR ANY DIRECT, INDIRECT, OR CONSEQUENTIAL LOSS OR DAMAGE WHATSOEVER CAUSED, INCLUDING THE REPLACEMENT OF EQUIPMENT AND PROPERTY.

**CUSTOMER RESPONSIBILITIES:**

Customers may be required to provide proof of purchase date, respond to questions designed to assist with diagnosing potential issues, and follow Trailer Valet's directions to make a claim on your warranty.

**TO MAKE A WARRANTY CLAIM:**

Contact us either through:  
PHONE: (844) 846-9344  
EMAIL: [support@trailervalet.com](mailto:support@trailervalet.com)  
WEBSITE: [www.trailervalet.com](http://www.trailervalet.com)

**TRAILER VALET SHALL HAVE THE EXCLUSIVE RIGHT TO DETERMINE IF A UNIT IS COVERED UNDER ITS LIMITED MANUFACTURER'S WARRANTY.**

**SEVERABILITY:**

The invalidity, illegality, or unenforceability of any provision of this warranty shall not render the other provisions invalid, illegal, or unenforceable.

**GOVERNING LAW AND JURISDICTION**

This warranty shall be governed by the laws of the State of California. The courts of California shall have the exclusive right to adjudicate any disputes arising under or in connection to this warranty.

Copyright 2024 by Supertech S. Corporation. All rights reserved. No portion of this manual or any artwork contained herein may be reproduced in any shape or form without the express written consent of Supertech S. Corporation.



For further information or if you have any questions, please contact:

**SUPERTECH S. CORP.**  
Customer Service: (844) 846-9344  
Email: [support@trailervalet.com](mailto:support@trailervalet.com)  
[WWW.TRAILERVALET.COM](http://WWW.TRAILERVALET.COM)