

IMPORTANT SAFETY INSTRUCTIONS

When using an electric appliance, basic precautions should always be followed, including the following:

Read all instructions before using this appliance.

DANGER

To reduce the risk of electric shock:

1. Do not reach for Groomer while plugged in that has fallen into water. Unplug immediately.
2. Use Groomer only in dry condition. Do not use Groomer while bathing or in a shower.
3. Do not submerge Groomer in water.
4. Do not place or store Groomer where it can fall or be pulled into a tub or sink. Do not place or drop Groomer into water or other liquid while plugged in.
5. Always unplug the Groomer from the electrical outlet immediately after use, except when Groomer is (re)charging.
6. Remove power supply cord from Groomer before cleaning.
7. When discarding Groomer, unplug Groomer before removing rechargeable batteries. See Battery Removal instructions.

WARNING

To reduce the risk of burns, fire, electric shock or injury to persons:

1. Close supervision is necessary when this Groomer is used by, on, or near children or invalids.
2. Use this Groomer for its intended household use as described in this manual. Do not use attachments not recommended by Philips Electronics North America Corporation.
3. Never operate this Groomer if it has a damaged cord or charging plug, if it is not working properly, if it has been dropped or damaged, or dropped into water. For assistance call 1-800-243-3050.
4. Keep the Groomer, cord and charging plug away from heated surfaces.
5. Never drop or insert any object into any opening.
6. Never operate the Groomer with the air openings blocked or while on a soft surface, such as a bed or couch, where the air openings may be blocked. Keep the air openings free of lint, hair, and the like.
7. Do not operate, charge or plug in Groomer outdoors or where aerosol (spray) products are being used or where oxygen is being administered.
8. Always check foil, cutters, trimmers and combs before using the Groomer. Do not use the Groomer if foil, cutters, trimmers or combs are damaged, as injury may occur.
9. Always attach plug to Groomer first, then charging plug into outlet. To disconnect, remove charging plug from outlet.
10. Use only the cord provided to charge and (re)charge the Groomer.
11. If the appliance is subjected to a major change in temperature, pressure or humidity, let the appliance acclimatize for 30 minutes before using.
12. Never put the Groomer in direct sunlight or store at a temperature above 140°F.
13. To prevent possible damage to the cord, do not wrap cord around the Groomer.
14. Only use the power plug and other accessories supplied with the Groomer.

SAVE THESE INSTRUCTIONS

IMPORTANT: The power plug contains a transformer. Do not cut off the power plug to replace it with another plug as this will cause a hazardous condition.

IMPORTANT: YOUR GROOMER CONTAINS A NICKEL METAL HYDRIDE RECHARGEABLE BATTERY.

See Battery Removal Instructions.

Registration

Congratulations on your purchase and welcome to Philips Norelco!

To fully benefit from the support that Philips Norelco offers, register your product at www.norelco.com/register

Features

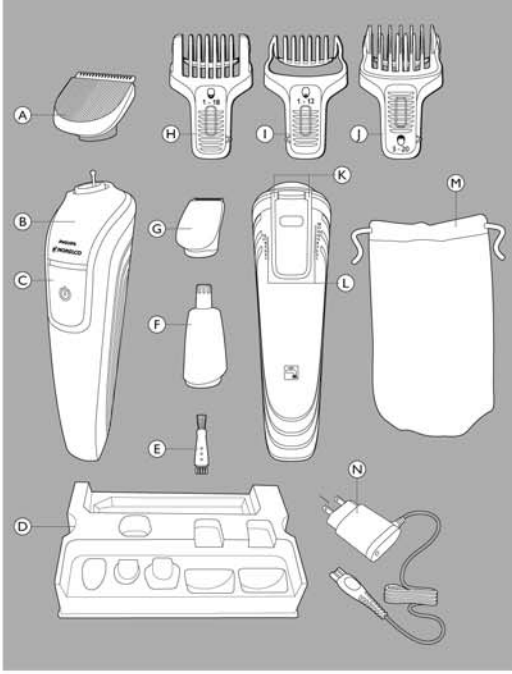

- A Beard Trimmer
 - B Handle
 - C On/Off Switch
 - D Storage Tray
 - E Cleaning Brush
 - F Nose/Ear Hair Trimmer
 - G Precision Trimmer
 - H Beard Comb
 - I Stubble Comb
 - J Hair Clipper Comb (QG3331 only)
 - K Guiding Grooves
 - L Hair Length Setting Indicator
 - M Storage Pouch (QG3331 only)
 - N Adapter
- Full Two-Year Warranty
45-Day Money-Back Guarantee

 The tap symbol on the groomer indicates that the groomer can be rinsed under running tap water.

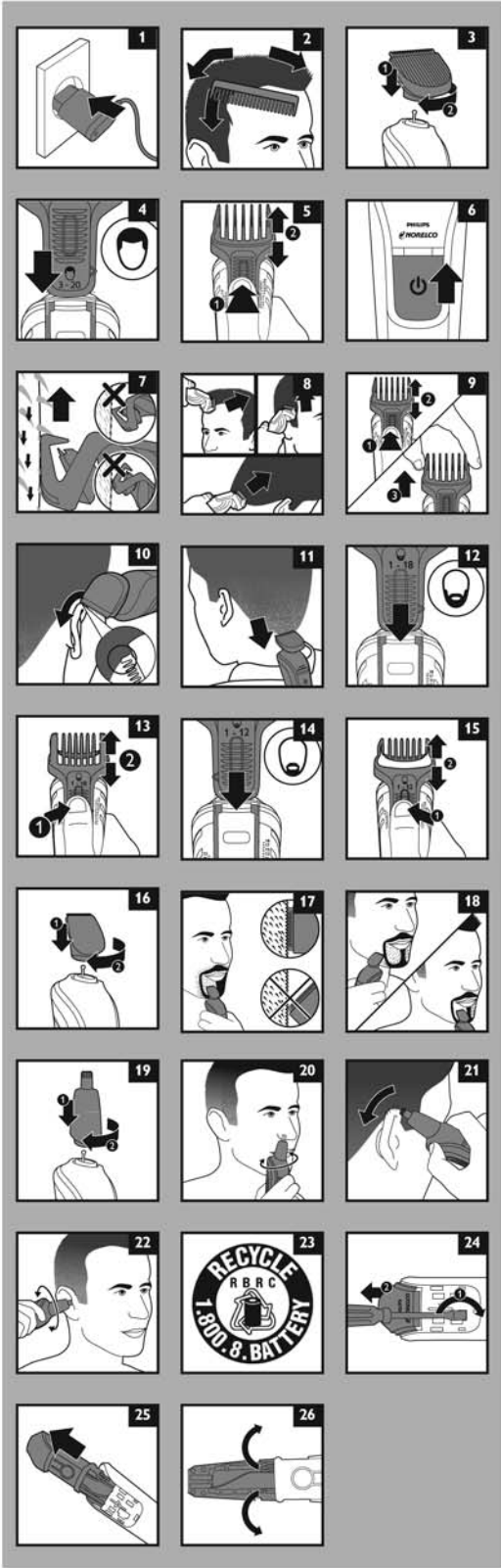

Put It To The Test

Like many new products, your Philips Norelco Grooming Kit may take a little getting used to. If you are using an electric Groomer for the first time, or if you've been using a different brand, take the time to acquaint yourself with your new Grooming Kit.

Your Grooming Kit features a full size trimmer with all the attachments to make trimming facial hairs or hair clipping goof proof.

Throw your scissors away and put your new Grooming Kit to the test. We guarantee precise, professional results or Philips Norelco will refund you the full purchase price as long as the request is received within 45 days of purchase.

To Charge/Recharge

- ▶ Fully charge Groomer before using for the first time or after non-use for a long period of time.
- ▶ Charging, recharging or using Groomer at temperatures below 40°F or higher than 95°F adversely affects lifespan of the battery.

1 Be certain Groomer is OFF.

2 Connect appliance plug directly into the Groomer. Plug adapter into any 120VAC outlet (Fig. 1). Use only the cord provided.

3 The charging light on the adapter will light to indicate the Groomer is charging.

- ▶ It will take approximately 10 hours to fully charge the Groomer for a cordless trimming time of up to 35 minutes.
- ▶ You can charge the Groomer for 16 hours for a cordless trimming time up to 45 minutes.
- ▶ The charging light does not turn OFF after Groomer is fully charged.

4 Disconnect the cord and unplug from electrical outlet.

Optimize the working life of the battery

- ▶ After the Groomer has been charged for the first time, do not recharge the Groomer between grooming sessions. Continue using it until the battery is completely empty.
- ▶ Do not charge for more than 24 hours.
- ▶ Do not keep cord permanently plugged in.
- ▶ Discharge/run down the battery completely twice a year by letting the motor run until it stops.
- ▶ If the Groomer hasn't been used for a long period of time, it must be recharged for a full 10 hours.

Cordless Trimming

1 Charge according to directions. Unplug Groomer from outlet and remove cord.

2 Slide ON/OFF switch ON to begin trimming.

3 When finished, turn Groomer OFF.

Hair Clipping (QG3331 only)

- ▶ Use this Groomer for its intended household use as described in this manual.
- ▶ Make sure that the Groomer is fully charged before you start clipping. This Groomer will not operate while cord is connected to electrical outlet.
- ▶ Before you start clipping, make sure that the head of the person whose hair you are cutting is at the same level as your chest so that all parts of his/her head are clearly visible and within easy reach.
- ▶ Make sure hair is clean and dry.
- ▶ Before you begin, comb the hair in the direction of growth (Fig. 2).
- ▶ To achieve optimal clipping results, always move the appliance slowly through the hair against the direction of hair growth.

Do not move the Groomer too fast. Make smooth and gentle movements.

Clipping with hair clipper comb

1 Put the beard trimmer on Groomer handle (1) and turn clockwise (2) to lock in place (Fig. 3).

2 Slide the hair clipping comb into the guiding grooves on both sides of Groomer handle (Fig. 4).

3 Press the Hair Length Setting Selector (1) and slide the comb to the desired hair length setting (2) (Fig. 5).

The hair clipping comb cuts hair to a length of 1/8 - 25/32 in. (3-20mm).

4 The setting selected will appear on the back of the Groomer.

When you are clipping for the first time, start at the maximum clipping length setting (#20) to familiarize yourself with the appliance and prevent accidentally trimming hairs too short. As you become familiar with the settings, adjust the Hair

Length Setting Selector to desired trimming length. Selector will 'click' into position at each setting.

- 5 Switch the Groomer ON (Fig. 6).
 - 6 Make sure that the flat part of the comb is always in full contact with the scalp to obtain an even result (Fig. 7).
 - 7 Move the appliance slowly over the crown from different directions to achieve an even result (Fig. 8).
 - 8 Always move the appliance against the direction of hair growth. Press lightly.
 - 9 Make overlapping passes over the head to ensure that all hair that should be cut has been cut.
 - 10 Turn the Groomer off and remove the hair clipper comb often to blow and/or shake out hair that has accumulated.
- **REMEMBER:** You must reset the hair length selector back to your desired setting every time you replace the hair trimmer comb on the appliance.

TIP: Write down the settings you have used to create a certain hairstyle as a reminder for future clipping sessions.

Contouring without the hair clipper comb

- Use the Groomer without a comb to clip hair very close to the skin (3/64 in./1 mm) or to contour the neckline and area around the ears.
- 1 Remove the hair comb by pressing the Hair Length Setting Selector (1) and slide the comb upwards (2). Pull comb off Groomer (Fig. 9).
- Be careful when you are clipping without comb attachment as when the Clipper is turned on it will remove every hair it touches.
- 2 To contour the hairline around the ears, comb the hair ends over the ears.
 - 3 Tilt the Groomer in such a way that only one edge of the cutter blades touches the hair ends when you shape the contours around the ears (Fig. 10).
- Only cut the hair ends. The hairline should be close to the ear.

- 4 To contour the nape of the neck or sideburns, turn the Groomer and hold it with the cutter blades pointing downwards (Fig. 11).
- 5 Move the Groomer slowly and smoothly following the natural hairline.

Beard and Stubble Trimming

- Always comb your beard and/or moustache with a fine comb before you start trimming.
- If you are trimming for the first time, be careful. Do not move the Groomer too fast. Make smooth and gentle movements.
- After trimming, residual hair length can vary depending on hair type.

Beard Trimming With Beard Comb

- Use the beard comb to trim your beard and moustache to different lengths.
- Trimming is easier when the skin and hair are dry.
- The hair length settings are indicated on the Groomer. The settings correspond to the remaining hair length after trimming.
- The beard trimming comb cuts hair to a length of 3/64 – 23/32 in. (1-18 mm).
- 1 Put the beard trimmer on Groomer handle (1) and turn clockwise (2) to lock in place (Fig. 3).
 - 2 Slide the beard comb into the guiding grooves of the Groomer (Fig. 12).
 - 3 Press the setting selector (1) and slide the comb to the desired hair length setting (2) (Fig. 13).
- If you are trimming for the first time, start by using the maximum trimming length setting of 23/32 in. (18 mm) to prevent accidentally trimming hairs too short. As you become familiar with the settings, adjust the comb to desired trimming setting.
- 4 Slide the On/Off switch ON to begin trimming (Fig. 6).
 - 5 To trim in the most effective way, move the Groomer against the direction of hair growth. Do not move the Groomer too fast. Make smooth and gentle movements and make sure the surface of the trimming comb always stays in contact with the skin.

NOTE: Since all hairs do not grow in the same direction, you may want to try different trimming

positions (i.e., upwards, downwards, or across). Practice is best for optimum results.

- 6 Turn the Groomer OFF.
- 7 Clean the Groomer (see section 'Cleaning').

Do not move the Groomer too fast. Make smooth and gentle movements.

Beard Trimming Without Beard Comb

Remove comb if you are:

- Defining hair lines
► Trimming nape of neck
► Removing single, unwanted hairs

- 1 Be certain the Groomer is OFF.
- 2 Remove the comb from the Groomer handle.
- 3 Switch the Groomer ON.
- 4 Make well-controlled movements. Touch the hair/skin lightly with the Groomer.

Stubble Trimming With Stubble Comb

- Use the stubble comb to trim your stubble to different lengths.
- The hair length settings are indicated on the Groomer. The settings correspond to the remaining hair length after trimming.
- The trimming comb cuts hair to a length of 3/64 – 15/32 in. (1-12 mm).
- 1 Put the trimmer on Groomer handle (1) and turn clockwise (2) to lock into place (Fig. 3).
 - 2 Slide the stubble comb into the guiding grooves of the Groomer (Fig. 14).
 - 3 Press the setting selector (1) and slide the comb to the desired hair length setting (2) (Fig. 15).
 - 4 Slide the On/Off switch ON to begin trimming (Fig. 6).
 - 5 To trim the most effective way, move the Groomer against the direction of hair growth. Do not move the Groomer too fast. Make smooth and gentle movements and make sure the surface of the trimming comb always stays in contact with the skin.

Styling/Contouring with Precision Trimmer

- Use the precision trimmer to cut shapes in beard hair or scalp hair.
- Be careful when using the precision trimmer as it removes every hair it touches.
- 1 Put the precision trimmer on the Groomer handle (1) and turn clockwise to lock into place (2) (Fig. 16).
 - 2 For best results, move the precision trimmer against the direction of hair growth making sure it is in full contact with the skin (Fig. 17).
 - 3 Make careful and controlled movements with the precision trimmer (Fig. 18).

Using Nose/Ear Hair Trimmer

- 1 Be certain the Groomer is in the OFF position.
- 2 Remove the trimmer by turning counter-clockwise and then pull off the handle.
- 3 Put the nose/ear hair trimmer on the Groomer handle (1) and turn clockwise to lock into place (2) (Fig. 19).

Trimming Nose Hair

- Make sure nasal passages are clean.
- 1 Switch the Groomer ON and insert the tip of the attachment into one nostril (Fig. 20).

CAUTION: Do Not insert the tip more than 3/16 in./5 mm into your nostril.

- 2 Slowly move the tip in and out while turning it around at the same time in order to remove unwanted hair. For best results, make sure the side of the tip is firm against skin. This will reduce the tickling effect that can occur during trimming of nose hair.
- 3 Turn off Groomer. Rinse attachment clean after each use.

Trimming Ear Hair

- Clean outer area of ear and ear canal. Make sure it is free of wax.
- Nose/ear hair trimmer should be on the Groomer.

1 Switch the Groomer ON and move the tip softly around the edge of ear to remove hairs extending beyond the outer ear (Fig. 21).

2 Carefully insert the tip into outer ear canal (Fig. 22).

CAUTION: Do not insert the tip further than 3/16 in./5mm into the ear as this could cause damage to the eardrum.

3 Turn off Groomer. Rinse attachment clean after each use.

Cleaning

- ▶ Clean the attachments after each use.
- ▶ Always switch Groomer OFF, unplug and remove power supply cord from Groomer before cleaning.
- ▶ Do not use compressed air, abrasive cleaning agents, scourers or aggressive liquids such as alcohol, gasoline or acetone to clean the Groomer and attachments.
- ▶ Never clean, replace or remove Groomer attachments with motor ON.
- ▶ Do not apply pressure to cutters.
- ▶ Do not touch cutters with hard objects as this may damage them.

During Use:

- ▶ If cut hairs have accumulated in the comb area, remove hairs by shaking, blowing or using cleaning brush provided. Remember to adjust the trimming length back to your selected setting when you replace the comb on Groomer.

After Each Use:

- 1** Make sure the Groomer is switched OFF and disconnected from the electrical outlet.
- 2** Remove any comb or attachment.
- 3** Blow and/or shake out any hair that may have accumulated in the comb or attachment.

- 4** Clean the handle, combs and attachments under lukewarm water or with the supplied cleaning brush.

Allow to air dry thoroughly.

- 5** Place the attachment back on the Groomer handle.

This Groomer has no other user-serviceable parts. For assistance call 1-800-243-3050.

Storage

- ▶ Be sure Groomer is turned OFF. Remove cord from outlet and Groomer before storing in a safe, dry location where it will not be crushed, banged, or subject to damage.
- ▶ Do not wrap cord around Groomer when storing.
- ▶ Store cord in a safe location where it will not be cut or damaged.
- ▶ Do not place or store Groomer where it can fall or be pulled into a tub or sink, water or other liquid.

Assistance

For assistance visit our website:

www.philips.com/support
or call toll free: 1-800-243-3050

Online information is available 24 hours a day, 7 days a week.

Battery Removal

- ▶ This Philips Norelco Groomer contains a rechargeable Nickel Metal Hydride battery, which must be disposed of properly (Fig. 23).
- ▶ Battery may only be removed when Groomer is to be discarded.
- ▶ For assistance, visit our website, www.philips.com/support or call toll free: 1-800-243-3050.

- 1** Unplug electrical cord from outlet and Groomer before dismantling Groomer.
- 2** Allow the Groomer to run until the batteries are completely empty/depleted. Turn Groomer off.
- 3** Remove any comb and/or attachment from Groomer.
- 4** Remove the On/Off switch of the appliance with a screwdriver.
- 5** Remove the front panel of the appliance with a screwdriver.
- 6** To pull out the inner, apply a tilting force in the indicated hole with a screwdriver. Pull upward on the top cover (Fig. 24).
- 7** Separate the inner and the tube (Fig. 25).

PHILIPS

NORELCO

Grooming Kit



QG3331

QG3330

Rechargeable
Cordless

Always here to help you

Register your product and get support at
www.norelco.com/register



4222 002 8293 2

- 8** Remove the on/off contact.

Be careful, the battery strips are very sharp.

- 9** Unhook and remove the rest of the cover to expose the rechargeable battery (Fig. 26).

- 10** Cut the wires to separate the rechargeable battery from Groomer.

- 11** Do not attempt to replace battery. Insulate battery ends by covering with tape and or place battery in a small plastic bag. Discard Groomer.

- 12** Contact your local town or city officials for battery disposal information or call 1-800-8-BATTERY or www.rbrcc.com for battery drop-off locations.

Full Two-Year Warranty

Philips Electronics North America Corporation warrants each new Philips Norelco product, Model QG3331, QG3330 (except cutters and combs) against defects in materials or workmanship for a period of two years from the date of purchase, and agrees to repair or replace any defective product without charge.

IMPORTANT: This warranty does not cover damage resulting from accident, misuse or abuse, lack of reasonable care, the affixing of any attachment not provided with the product or loss of parts or subjecting the product to any but the specified voltage.* Use of unauthorized replacement parts will void this warranty.

PHILIPS ELECTRONICS NORTH AMERICA CORPORATION WILL NOT PAY FOR WARRANTY SERVICE PERFORMED BY A NON-AUTHORIZED REPAIR SERVICE AND WILL NOT REIMBURSE THE CONSUMER FOR DAMAGE RESULTING FROM WARRANTY SERVICE PERFORMED BY A NON-AUTHORIZED REPAIR SERVICE.

NO RESPONSIBILITY IS ASSUMED FOR ANY SPECIAL, INCIDENTAL OR CONSEQUENTIAL DAMAGES.

In order to obtain warranty service, simply go to www.philips.com/norelco or call 1-800-243-3050 for assistance. It is suggested that for your protection you return shipments of product by insured mail, insurance prepaid. Damage occurring during shipment is not covered by this warranty. **NOTE:** No other warranty, written or oral, is authorized by Philips Electronics North America Corporation. This warranty gives you specific legal rights, and you may also have other rights which vary from state to state. Some states do not allow the exclusion or limitation of incidental or consequential damages, so the above exclusion and limitations may not apply to you.

*Read enclosed instructions carefully.

Manufactured for:
Philips Consumer Lifestyle
A Division of Philips Electronics North America Corporation
P.O. Box 10313, Stamford, CT 06904

This symbol on the product's nameplate means it is listed by Underwriters' Laboratories, Inc.

Norelco is a Registered Trademark of Philips Electronics North America Corporation.

PHILIPS is a Registered Trademark of Koninklijke Philips Electronics N.V.

© 2012 Philips Electronics North America Corporation. All Rights Reserved.

PHILIPS

NORELCO

45-DAY MONEY-BACK GUARANTEE

If you are not fully satisfied with your Philips Norelco Groomer send the product back and we'll refund you the full purchase price.

The Groomer must be shipped prepaid by insured mail, insurance prepaid, have the original sales receipt, indicating purchase price and date of purchase, and the money-back guarantee return authorization form enclosed. We cannot be responsible for lost mail.

The Groomer must be postmarked no later than 45 days after the date of purchase. Philips Norelco reserves the right to verify the purchase price of the product and limit refunds not to exceed suggested retail price.

To obtain money-back guarantee return authorization form, call 1-800-243-3050 for assistance.

Delivery of refund check will occur 6-8 weeks AFTER receipt of returned product.